

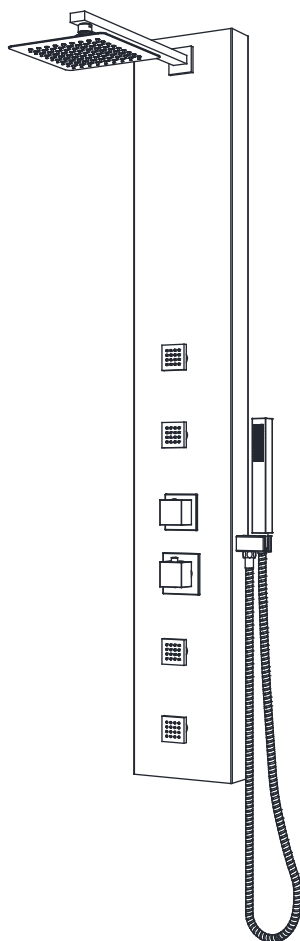

ITEM: SP-AZ012
ANZZI MONSOON SHOWER PANEL
INSTALLATION & OPERATION MANUAL

V3.1

09/30/2024



DON'T WAIT! REGISTER NOW!

Register your product within 90 days to ensure your product is recognized as an official purchase and is eligible for warranty coverage.

Register online at <https://anzzi.com/pages/register> or scan the QR code at PG. 2.



PRODUCT REGISTRATION*

IMPORTANT: Warranty will not be recognized unless product is registered.

Register online at <https://anzzi.com/pages/register> or Scan the QR code below.

Registering online is fast, secure, and ensures we receive your information.

1

USE YOUR PHONE CAMERA
TO SCAN THE QR CODE

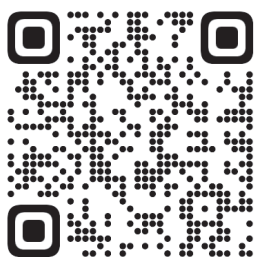

2

FILL IN A QUICK
REGISTRATION FORM

Thank you for your purchase!

Registering your products ensures you maximize your warranty benefits and receive prompt service and support.

Name*

Email*

City*

Order #*

Installer Name

Model Purchased*

Installer Phone Number

Customer Age Range

Submit

3

CLICK SUBMIT AND
ENJOY PEACE OF MIND

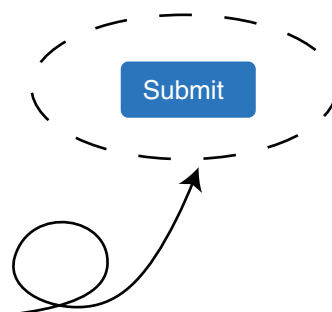

Need help? For technical support call **305-614-4070** or visit us at www.ANZZI.com

PARTS LIST



IAPMO IGC 154
ASME A112.18.1/
CSA B125.1

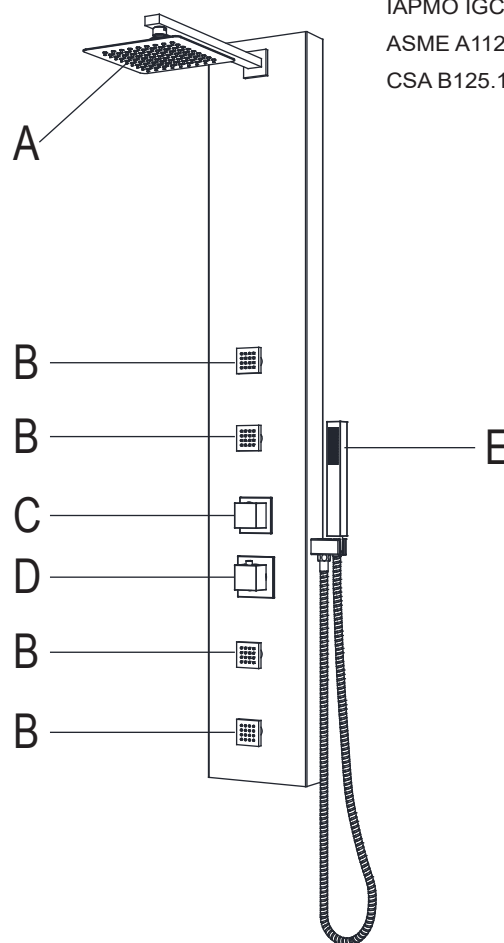
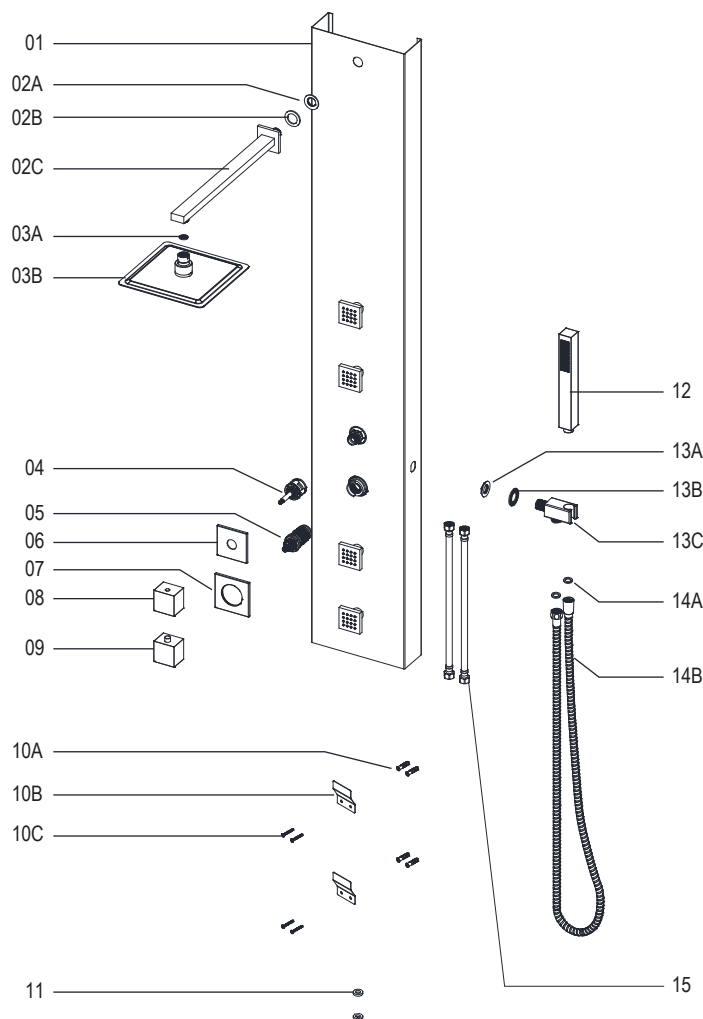

Part	Description	Qty
[01]	Shower Panel	1
[02A]	Nut	1
[02B]	Washer	1
[02C]	Shower Arm	1
[03A]	Gasket	1
[03B]	Shower Head	1
[04]	Diverter Cartridge	1
[05]	Thermostatic Cartridge	1
[06]	Diverter Flange	1
[07]	Thermostatic Flange	1
[08]	Diverter Handle	1
[09]	Thermostatic Handle	1
[10A]	Anchor	4

Part	Description	Qty
[10B]	Bracket	2
[10C]	Screw	4
[11]	Washer	2
[12]	Hand Shower	1
[13A]	Nut	1
[13B]	Washer	1
[13C]	Hand Shower Holder	1
[14A]	Washer	2
[14B]	Shower Hose	1
[15]	Hose	2

A. Shower Head
B. Body Jets
C. Diverter
D. Thermostatic control
E. Hand Shower

PRODUCT FEATURES

- Thermostatic valve inside
- Anti-scold protection
- Preset water temperature providing constant warm water
- Single diverter controls water flowing between Rain Shower/ Body Jets/ Hand Shower
- Rust-free materials

BEFORE YOU START

Recommended Items

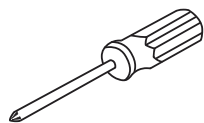

Screwdriver

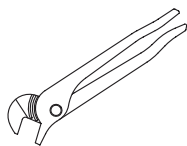

Channel Locks



Goggles

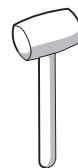

Rubber Mallet

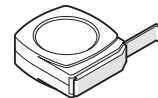

Measure

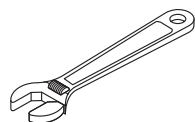

Adjustable Wrench



Teflon Tape

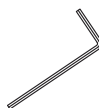

Allen Key



Pencil

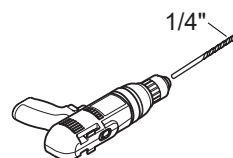

Electric Drill

Read Before Using Your New Shower Panel

Congratulations on purchasing our Shower Panel. Your new shower panel will be a great addition to your bathroom for years to come. Our luxury Shower Panel brings a spa experience into your life in the comfort of your personal bathroom. Adding the shower panel as a modification to your present shower will allow you to enjoy the pleasures of massaging body spray jets. Furthermore, the shower panel will operate with your existing plumbing supply lines with standard line pressure and flow rates. Before using our Shower Panel, please read this document carefully and thoroughly.

The instructions and safety information in this document are essential to the safe operation of your new unit. Additionally, neglect or improper or incorrectly performed installation, maintenance or repair, including failure to follow the applicable care and cleaning instructions, may affect your new product's warranty.

IMPORTANT

1. Prior to installation, please make sure your package is intact. Look over the product and contact your dealer or ANZZI if you find damaged sections.
2. In order to install this shower panel, simple understanding of plumbing techniques will be necessary. Please contact your dealer or a professional plumber if you are unfamiliar with plumbing techniques or have questions.
3. This shower panel is designed for indoor use only. It is not intended for outdoor or other uses.
4. The product is provided with flexible supply hoses. It is recommended to put stop valves between the hoses and water supplies.
5. Product requires between 20-125 psi supply pressure. Install a pressure reducing valve if your water pressure is too high.
6. Check all connections for leaks. Retighten if necessary, but do not overtighten.
7. For the product using thermostatic valve, the pressure difference between cold/hot supply shall not more than 30%. Otherwise, the product may not function.
8. For the product using thermostatic valve, the highest temperature is 49°C to avoid scald.

Mounting the Brackets of the Shower Panel

-It is recommended that the shower panel be mounted at a height that will make the unit accessible to people with varying heights. Establish the precise height and position of the unit on the wall. We recommend leaving a 6"(15cm) space between the shower head and the average height of the people in the house as well as a minimum distance of 1"(2.5cm) from the ceiling.(Figure A)

-Adjust the plumbing to ensure that there is adequate space for the shower panel to be installed.(Figure B)

-The height you choose shall allow the shower panel to completely cover up the connection points for the cold and hot water supplies. In order to determine your installation location of the shower panel, you should use a tape measure and a pencil.

(or some type of marking tool).

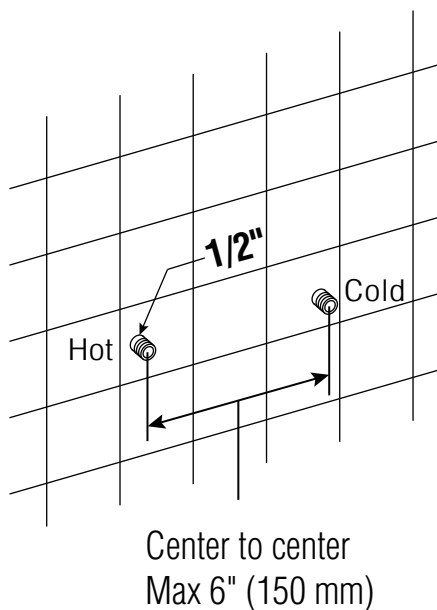

Figure B

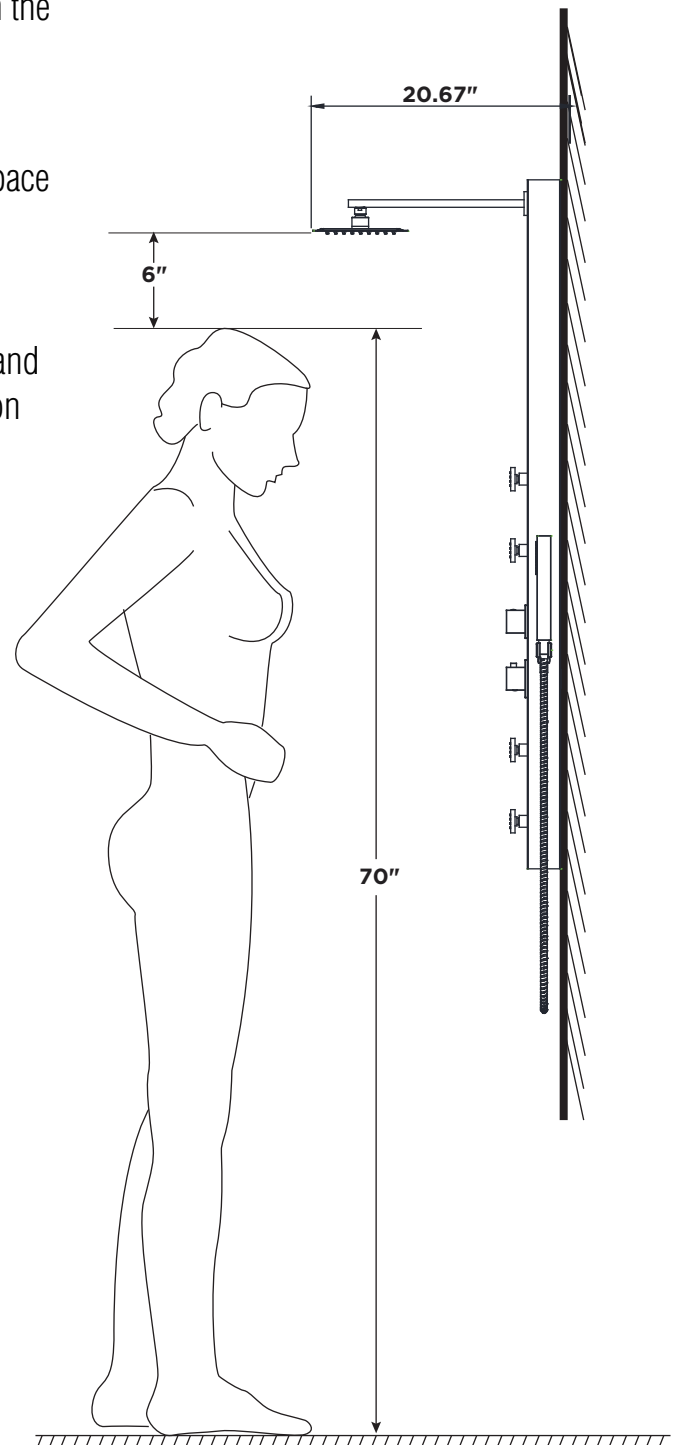
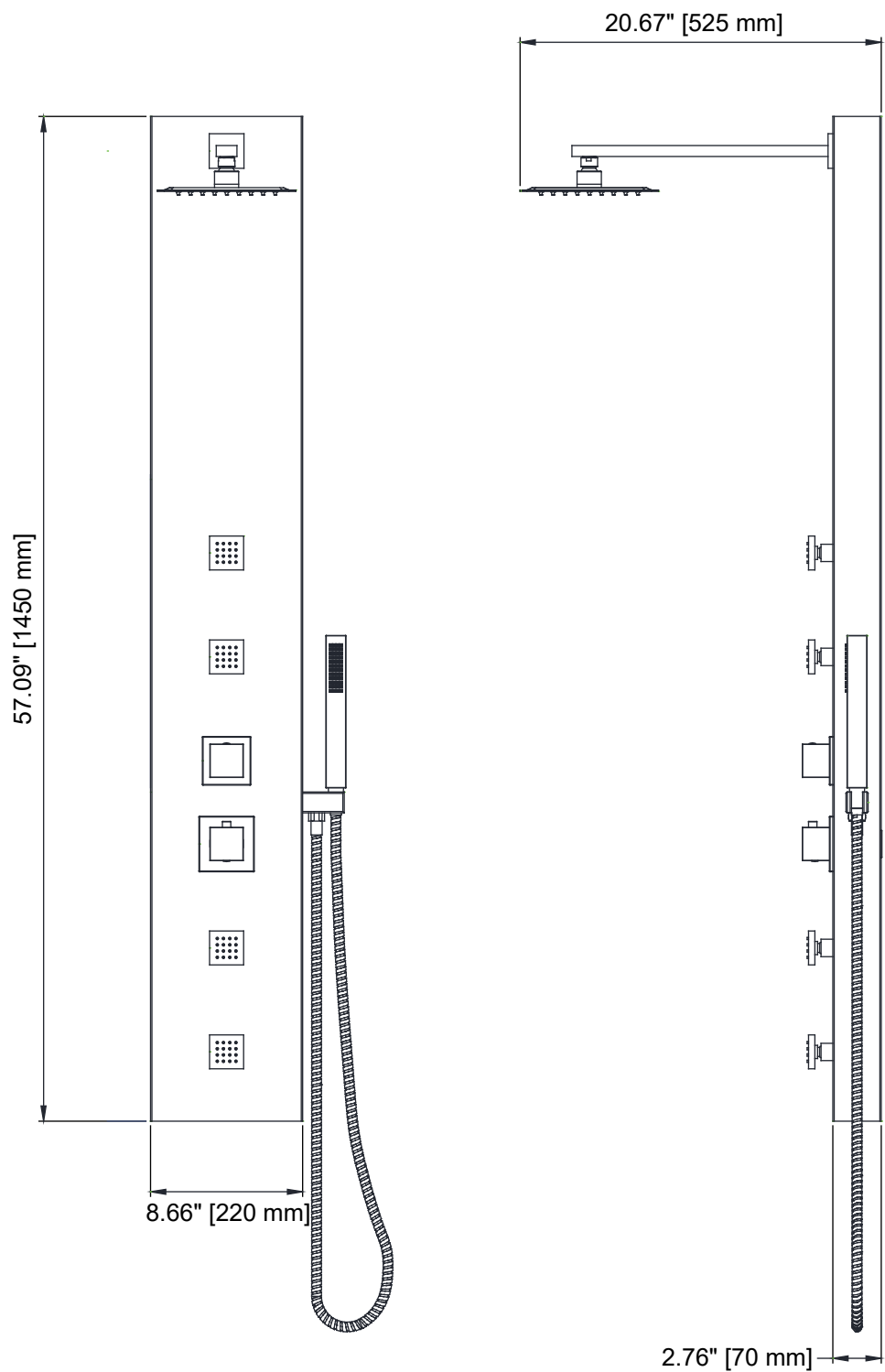

Figure A

PRODUCT SIZE CHART



STEP 1

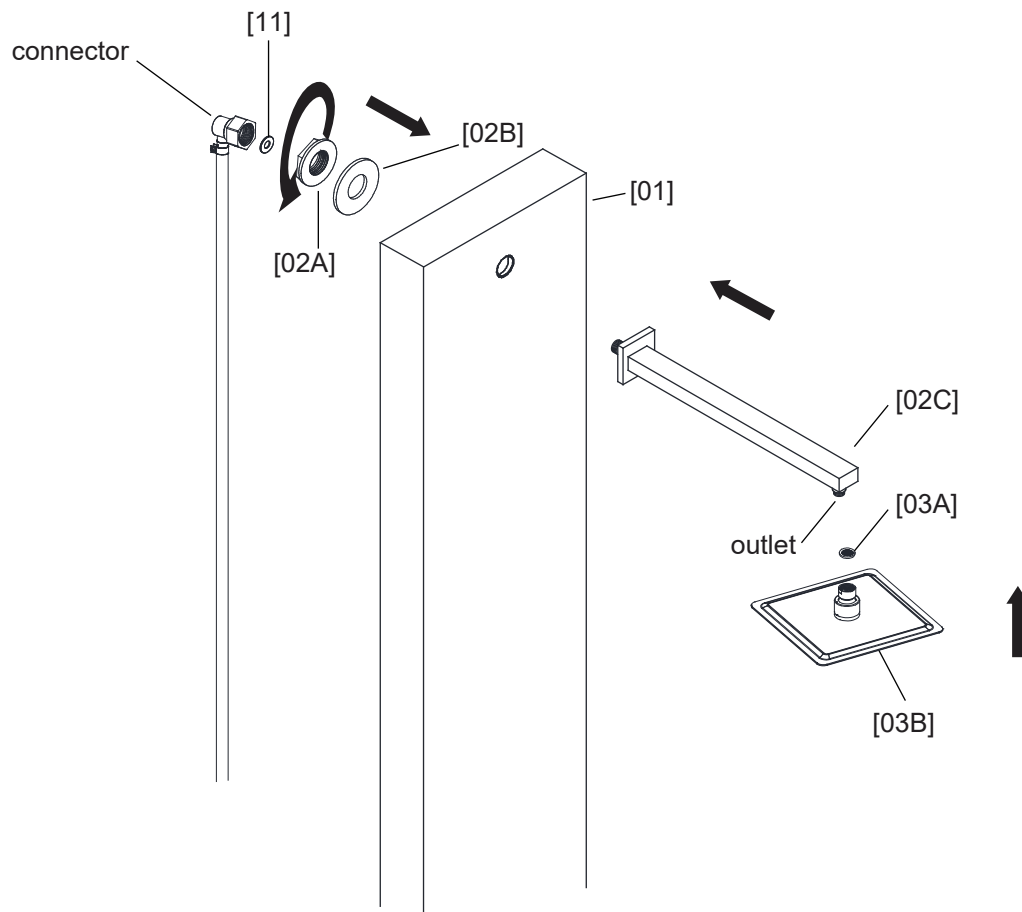

Fig 1

- 1-1** Remove the **Nut [02A]** and **Washer [02B]** from the **Shower Arm [02C]** and slide the **Shower Arm [02C]** into the **Shower Panel [01]** from the front. From the back of the **Shower Panel [01]**, slide the **Washer [02B]** onto the **Shower Arm [02C]** and secure it with **Nut [02A]**. **Do not over tighten!** Notice: Make sure the **outlet** of **Shower Arm [02C]** is pointing downward.
- 1-2** Install the **connector** with **Washer [11]** in it to the **Shower Arm [02C]** as figure shows.
- 1-3** Install the **Shower Head [03B]** onto **Shower Arm [02C]** and secure it. Notice: Make sure there is a **Gasket [03A]** inside the **Shower Head [03B]**.

STEP 2

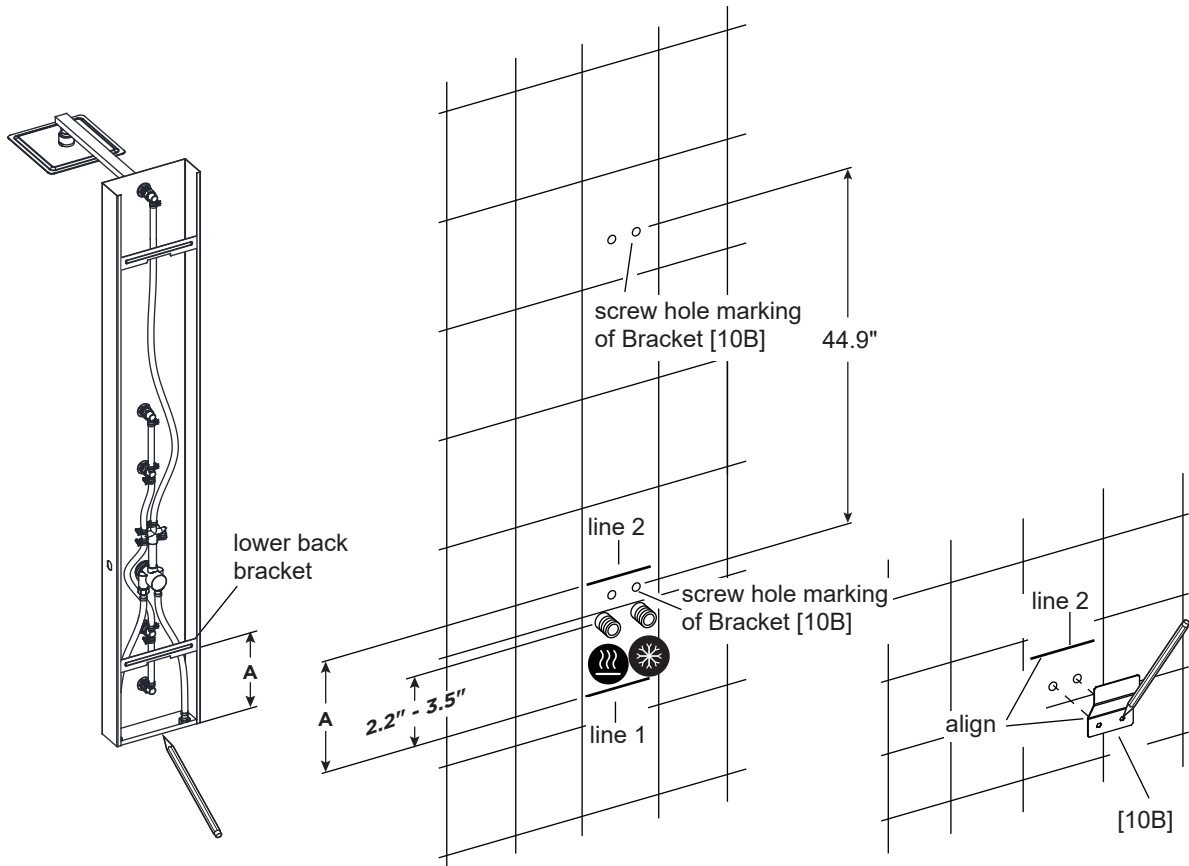

Fig 2.1

Fig 2.2

Fig 2.3

- 2-1** Position the shower panel on the wall according to figure A on page 5. Draw line 1 on the wall along the bottom of shower panel. (Fig 2.1)
Notice: Make sure the outlets are located 2.2" - 3.5" above the bottom of **Shower Panel [01]**.
- 2-2** Measure the distance A between the bottom of the shower panel and the lower **Bracket [10B]**. Then draw line 2 above line 1 at the distance A. (Fig 2.2)
- 2-3** Position the **Bracket [10B]** on the wall with its lower corners aligned with line 2 and center with the center line between the outlets. Then mark the wall through the screw holes of the **Bracket [10B]**. (Fig 2.3)
- 2-4** Position another **Bracket [10B]** above the previous one on the wall so the screw holes are 44.9" above the screw hole marks for the first bracket and center with the center line between the outlets. Then mark the screw holes of the second **Bracket [10B]** on the wall. (Fig 2.2)

STEP 3

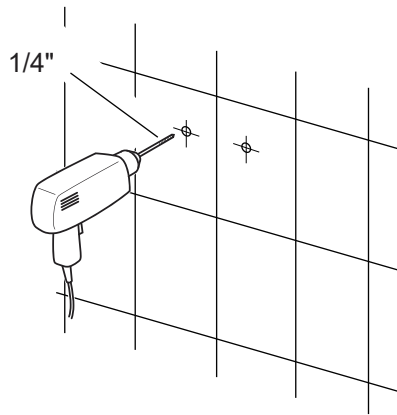

Fig 3.1

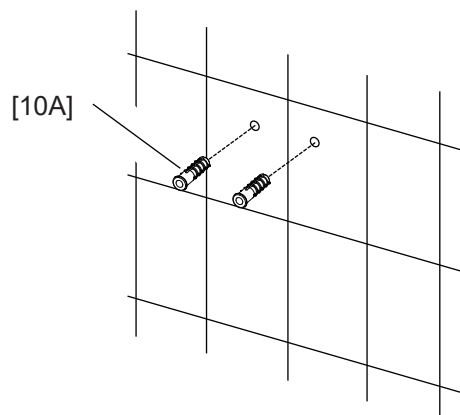

Fig 3.2

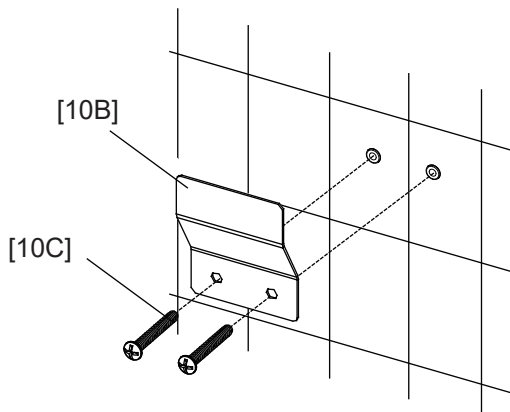

Fig 3.3

IMPORTANT Before drilling any holes for the shower panel brackets, be sure there are no hidden cables or pipelines aligned with the desired drilling position.

3-1 Drill 1/4" holes at the marked positions. (Fig 3.1)

3-2 Install the **Anchors [10A]** . (Fig 3.2)

3-3 Secure the **Brackets [10B]** with **Screws [10C]**. (Fig 3.3)

STEP 4

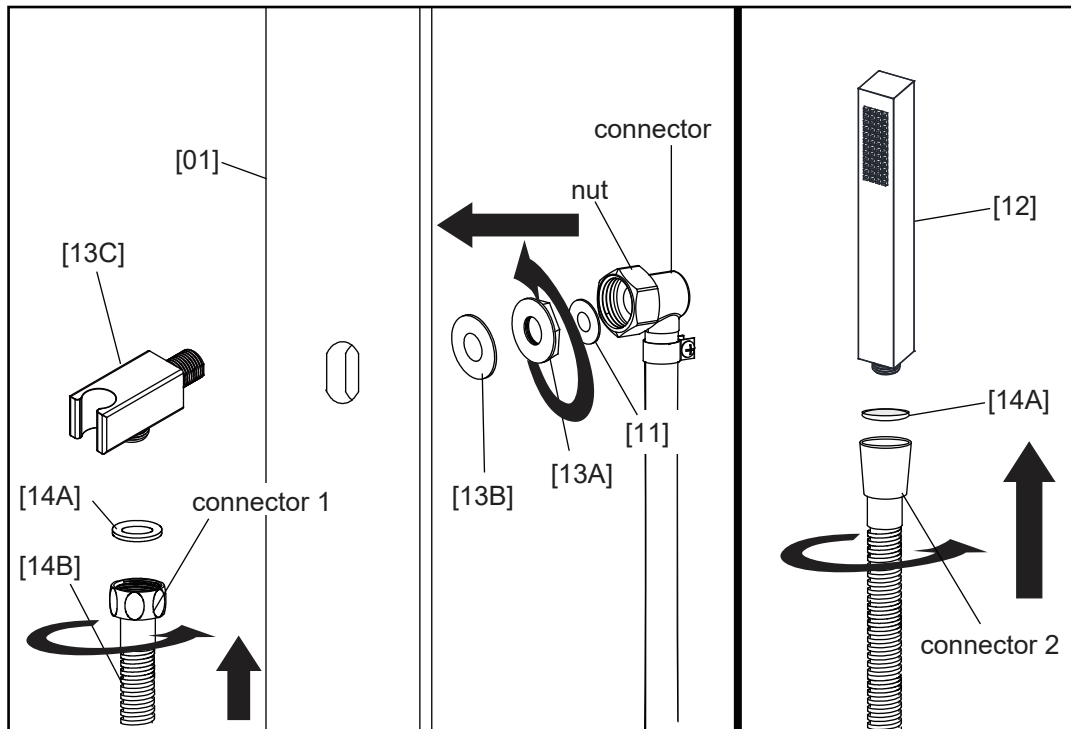

Fig 4.1

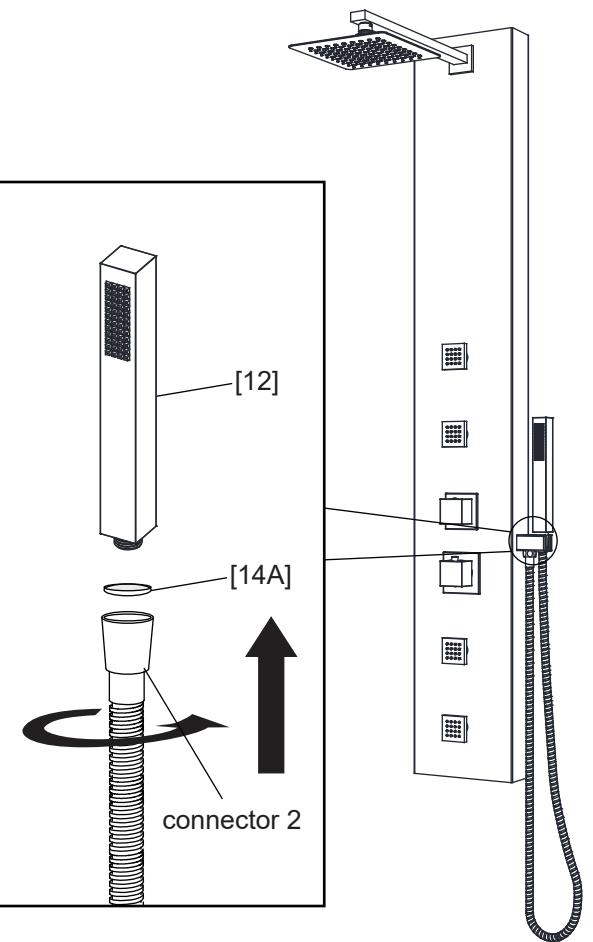

Fig 4.2

- 4-1** Install the **Shower Holder [13C]** through the hole from the right of **Shower Panel [01]**. Make sure the shower hose connector faces downward. (Fig 4.1)
- 4-2** Slide the **Washer [13B]** to the **Shower Holder [13C]** from the inside of **Shower Panel [01]** and secure it by tightening the **Nut [13A]**. Do not over tighten. (Fig 4.1)
- 4-3** Install the **connector** with **Washer [11]** in it to the **Shower Holder [13C]**. Then tighten the **nut** of the **connector** to secure. (Fig 4.1)
- 4-4** Connect the **connector 1** of **Shower Hose [14B]** to **Shower Holder [13C]** and **connector 2** to **Hand shower [12]**. Tighten the connectors to secure. Make sure there are washers inside the connectors. (Fig 4.1, Fig 4.2)

STEP 5

IMPORTANT: Before connecting the inlet hoses and water supplies, turn on cold and hot water supplies and flush water lines for one minute. **This flushes away any debris that could cause damage to internal parts.**

1



2

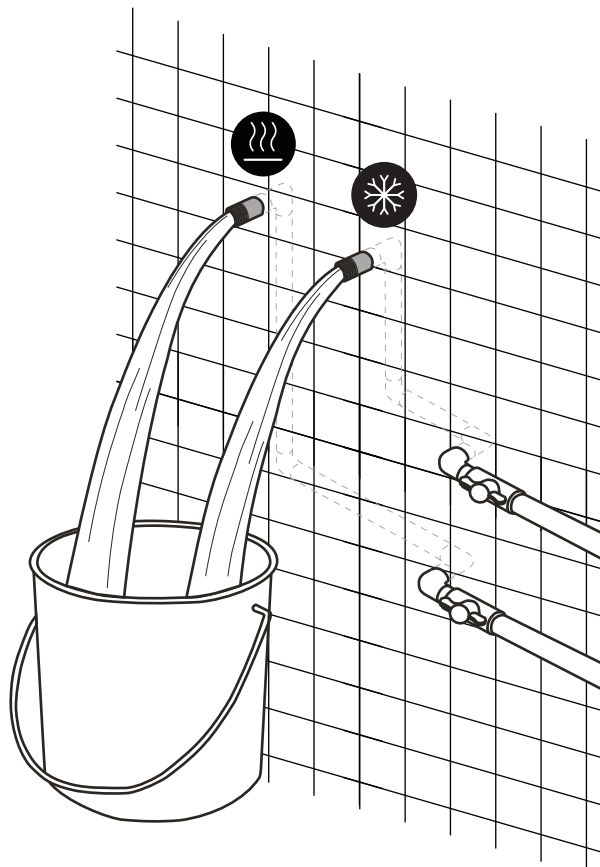

3



STEP 6

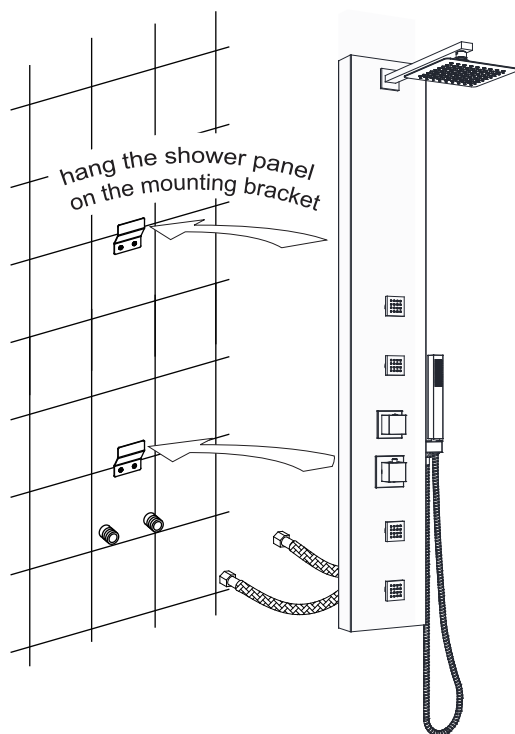

Fig 6.1

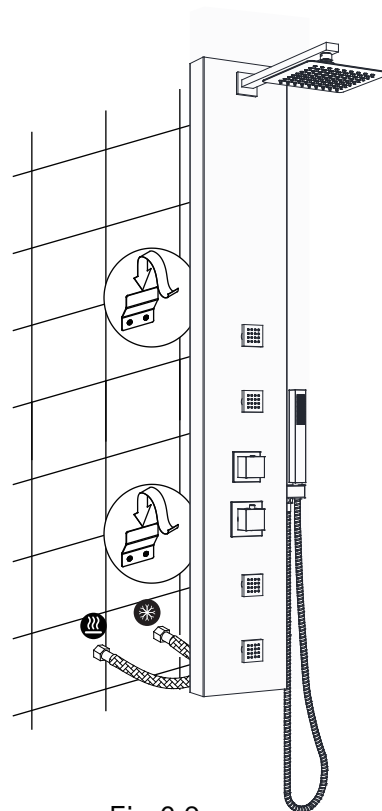

Fig 6.2

- 6-1** Connect the Hoses labeled with "Hot" or "Cold" to the outlets, then tighten the nuts of the hoses. **DO NOT OVER TIGHTEN!** (Fig 6.1)

Notice: Make sure the hose labeled with "Hot" connected to the hot water outlet, the hose labeled with "Cold" connected to the cold water outlet. Otherwise the outlet water won't be warm or can't maintain the water temperature.

- 6-2** Before hanging the shower panel onto the wall, turn on the faucet and test all water functions of the shower panel and check all connections for leaks. Retighten if necessary, but do not overtighten. (Fig 6.1)

- 6-3** Slide the shower panel down until it rests on the mounting brackets. Slightly pull down the shower panel to secure. (Fig 6.1, Fig 6.2)

CARE AND MAINTENANCE

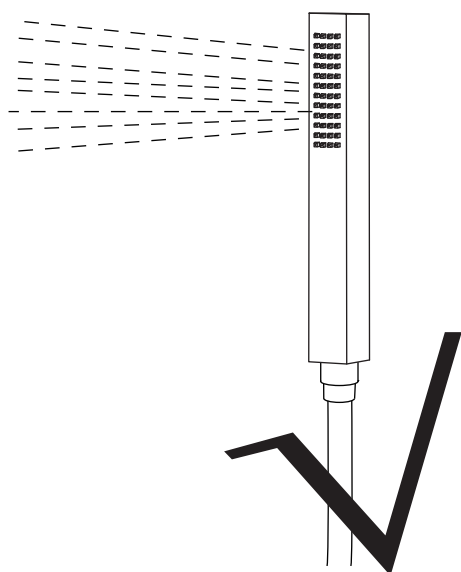

The water flow is normal

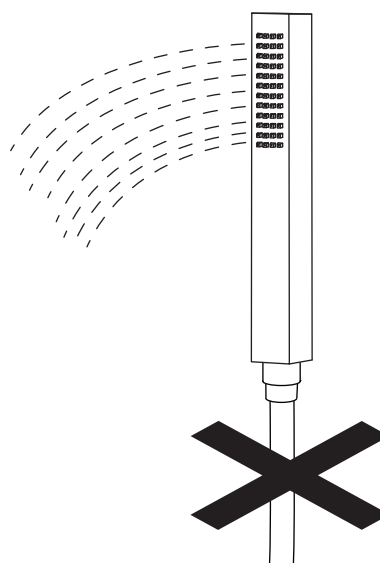

The water flow becomes smaller

1

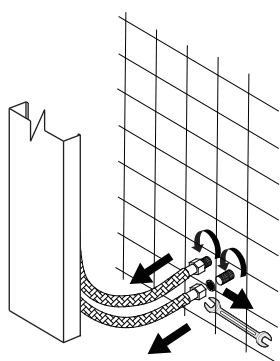

Remove the hot and cold water pipes and take out the filter screen.

2

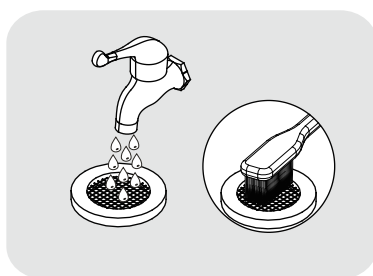

Clean the filter screen.

3

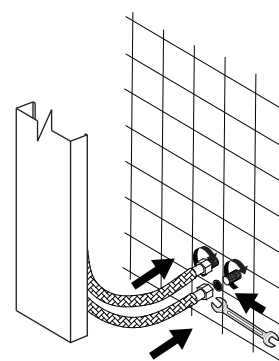

Install the filter and connect the hot and cold water pipes.

Note: If the water flow becomes smaller, please clean the filter screen at the inlet hoses. If the problem cannot be solved after cleaning, remove the thermostatic cartridge for cleaning by following the steps in page 14 to 15.

CARE AND MAINTENANCE

IMPORTANT:

It is not recommended that the user disassemble the thermostatic cartridge by himself, and it is recommended to ask professional personnel for treatment.

1

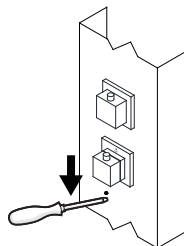

Remove the blue plug.

2

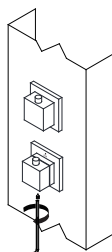

Loose the screw with the hexagon wrench.

3

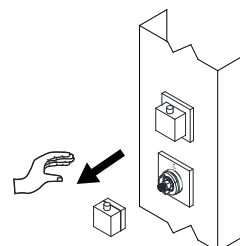

Remove the thermostatic handle.

Note: The rod of cartridge can only be rotated when the handle is right in place. Don't rotate the rod of cartridge during and after removing the handle.

4

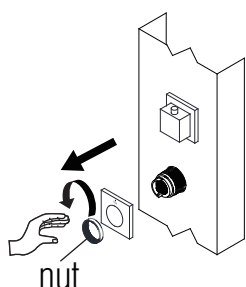

Remove the nut and thermostatic flange.

5

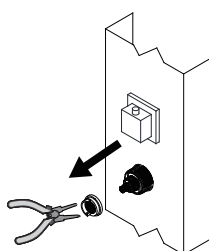

Remove thermostatic restrictor with the plier.

Note: We suggest recording the position of thermostatic restrictor by camera.

6

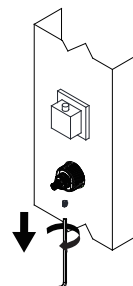

Remove the screw from below of the valve.

7

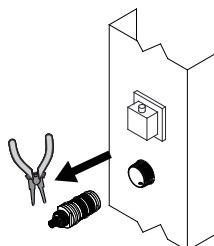

Unplug the thermostatic cartridge.

8

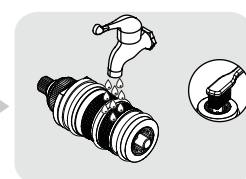
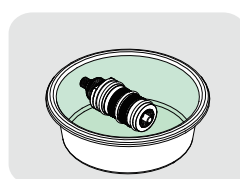
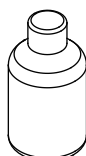

Soak the thermostatic cartridge in vinegar for 10 minutes
Rinse the cartridge with clean flowing water.

CARE AND MAINTENANCE

1

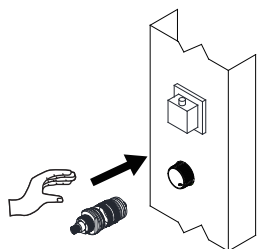

Put the cartridge back into the faucet.

Note: Beware the side hole of the cartridge is pointing downside and aligning with the side hole of body.

2

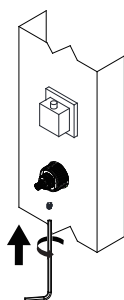

Secure the thermostatic cartridge by tighten the screw.

3

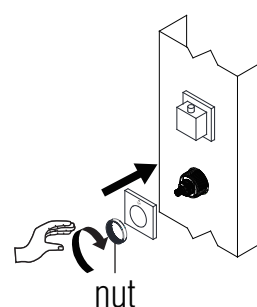

Install the thermostatic flange back to the valve again and secure it with the nut.

Note: Make sure the thermostatic flange is aligned with the shower panel and the figures are at the right place.

4

The white dot must be aligned with 104 degrees Fahrenheit and face up. ↑

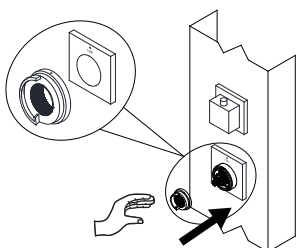

Install the thermostatic restrictor back again.

5

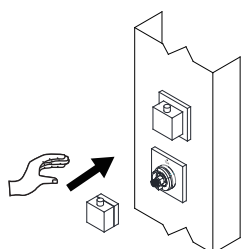

Install the thermostatic handle onto the cartridge with the button pointing upward.

6

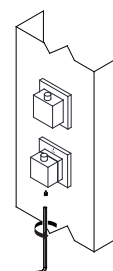

Screw the handle to finish the installation.

7

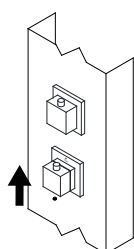

Put the plug on.

CARE AND MAINTENANCE

ANZZI® products are crafted with superior quality standards and workmanship and engineered to stand the test of time. However, that does not mean the product can be neglected - it will need some care and cleaning.

It is recommended to use regular soap and hot water along with a non-abrasive cloth or sponge to regularly clean the product. This avoids any build up or deposits which would be tougher to remove.

If you feel the use of stronger cleaning solutions or chemicals is necessary, always test the cleaning solution or chemical on an inconspicuous area before applying to the entire surface.

Wipe all surfaces clean and rinse completely with water immediately after applying cleaner. Rinse and dry any overspray that lands on nearby surfaces.

DO NOT ALLOW THE CLEANER TO SOAK.

Following these simple procedures will ensure your ANZZI® product remains as lustrous and stunning as the day it was first received. ENJOY!

Sincerely,

La Familia ANZZI®

