

FLEXSTEEL®

W1013-826

Buffet

IMPORTANT NOTES

Carefully remove all the parts from the carton and put them individually on a soft cloth to prevent damage to the parts.

We have taken great care in the design of this product and request that you carefully and accurately follow our assembly instructions to ensure proper set-up. We recommend at least two adults assemble this product.

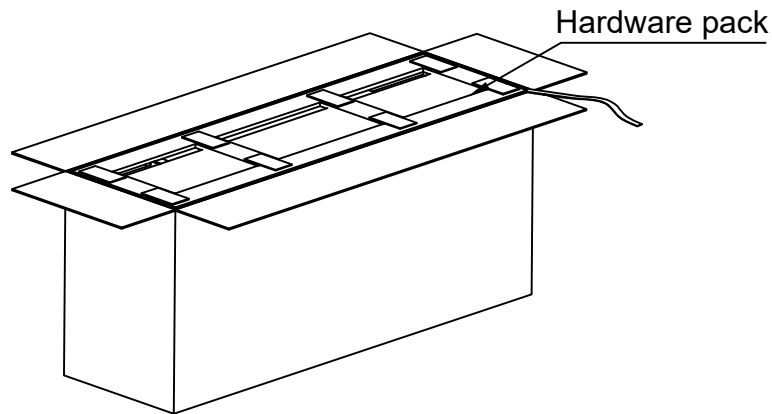
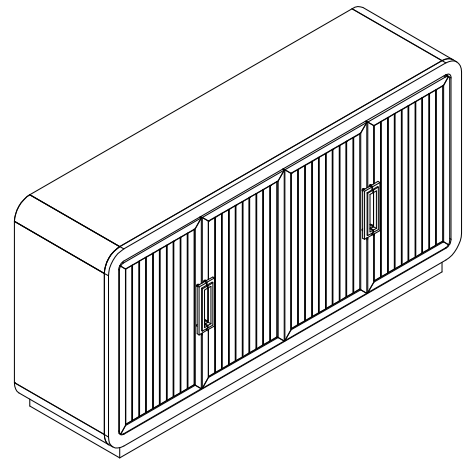

Part List

Assembly Instruction 1/4

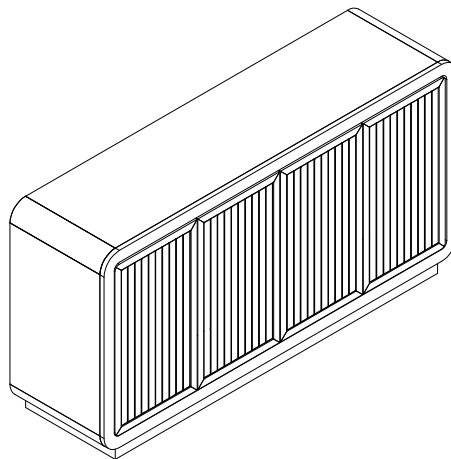

A. Buffet
1 piece

Hardware List

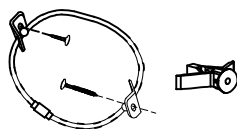

Anti-tipping
1 set



Not included
Phillips Screwdriver
PH2 x 100mm

IMPORTANT NOTES

- Do not tighten up all the screws until each part is properly assembled.
- Keep the Hex Key in a safe place as you may need to tighten up the bolts in the future.
- Use a soft cloth between these parts and the floor.
- We recommend this product be assembled by at least two adults.

STEP 1

Reverse each handle by removing the screws while each door is open and attach all handles to the front of the door with screws as shown below. (See Figure 1, 2).

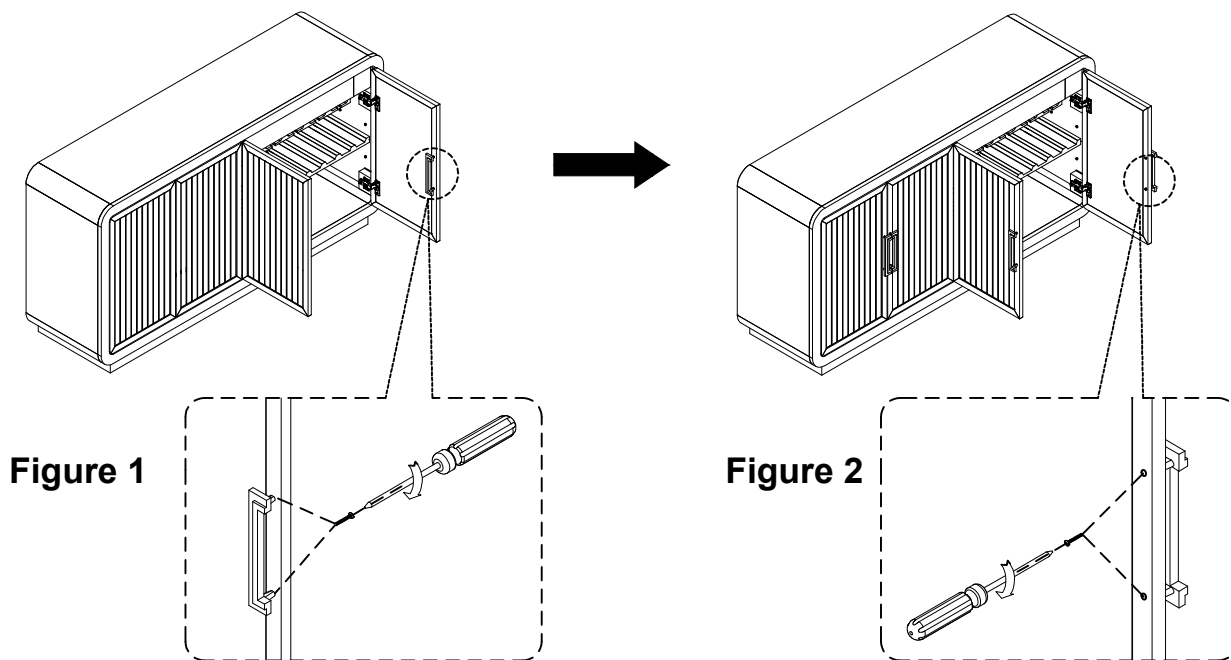

Figure 1

Figure 2

STEP 2

Adjust the levelers Upper the legs until the furniture is leveled. (See Figure 3).

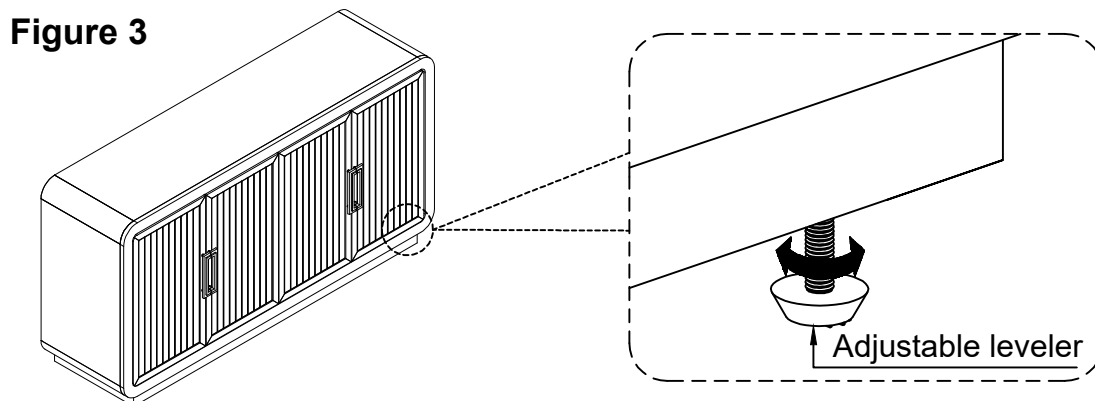

Figure 3

Adjustable leveler

STEP 3

Adjustable Shelf can use both sides.

1. With two right the doors open. (See Figure 1).
2. Tilt and take it out adjustable Shelf. (See Figure 2).
3. Tilt and insert adjustable Shelf. (See Figure 3).

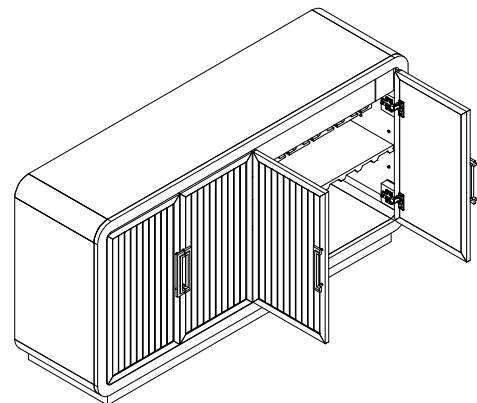
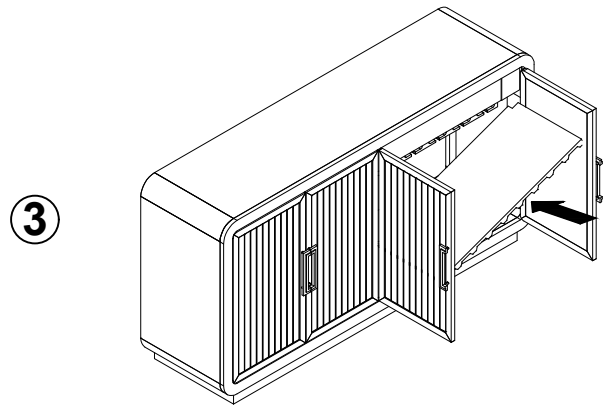
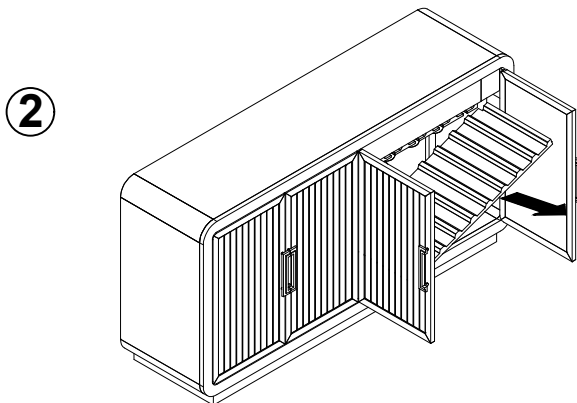
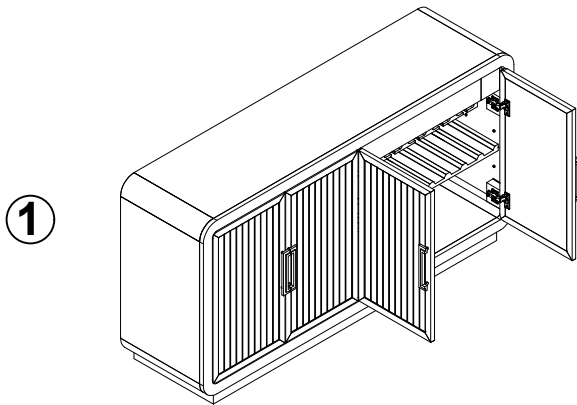

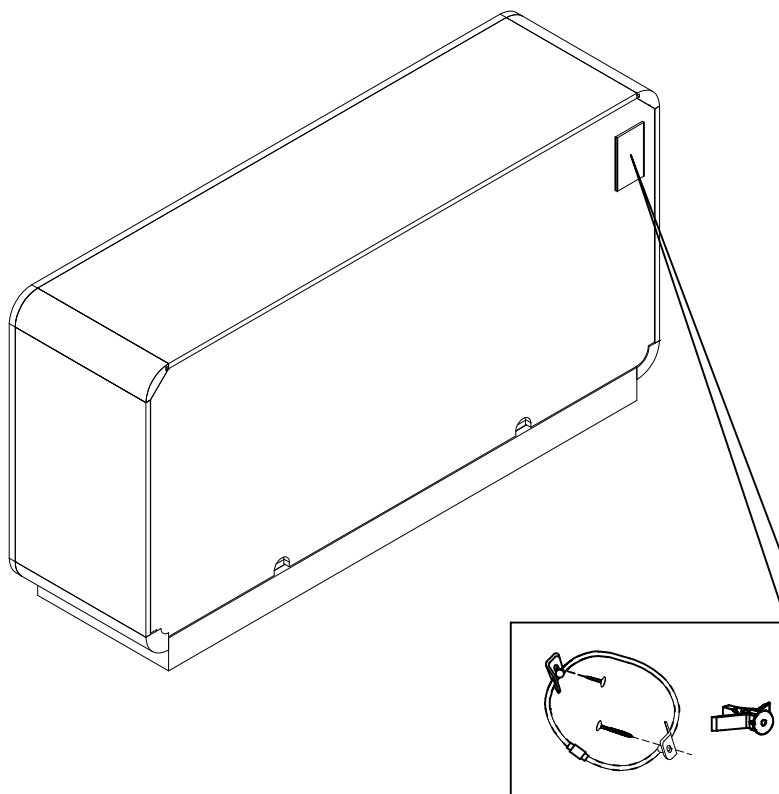

NOTE: There is a tip restraint kit provided on the back of this product. Take care to read the instructions thoroughly and install it immediately when placed in the home

CARE INSTRUCTIONS

- To avoid scratches, do not place sharp or jagged objects directly on the table top.
- Do not place hot items directly on the table top.
- Use placemats or trivets under hot items and coasters under beverages to prevent marks and stains.
- Avoid the use of harsh chemicals or abrasive cleaning materials.
- Wipe the table clean with a soft, dry cloth after each use.
- Wipe up spills quickly with a soft, dry cloth.

Flexsteel Industries, Inc.

For Parts or Customer Service call
toll-free:

1-888-415-3979

Monday-Friday

8:00 a.m. -5:00 p.m.

(Central Time)

Email:

customersolutions@flexsteel.com

www.flexsteel.com