

Hall Tree

IMPORTANT

Carefully remove all the parts from the carton and place them individually on a soft cloth to prevent scratches or other damage.

Carefully and strictly follow these assembly instructions to ensure a completed product as designed.

Do not use power tools above 8 volts to assemble.

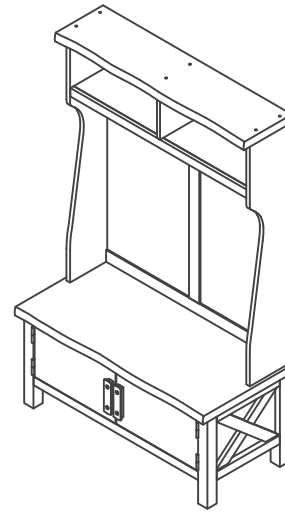

Part List

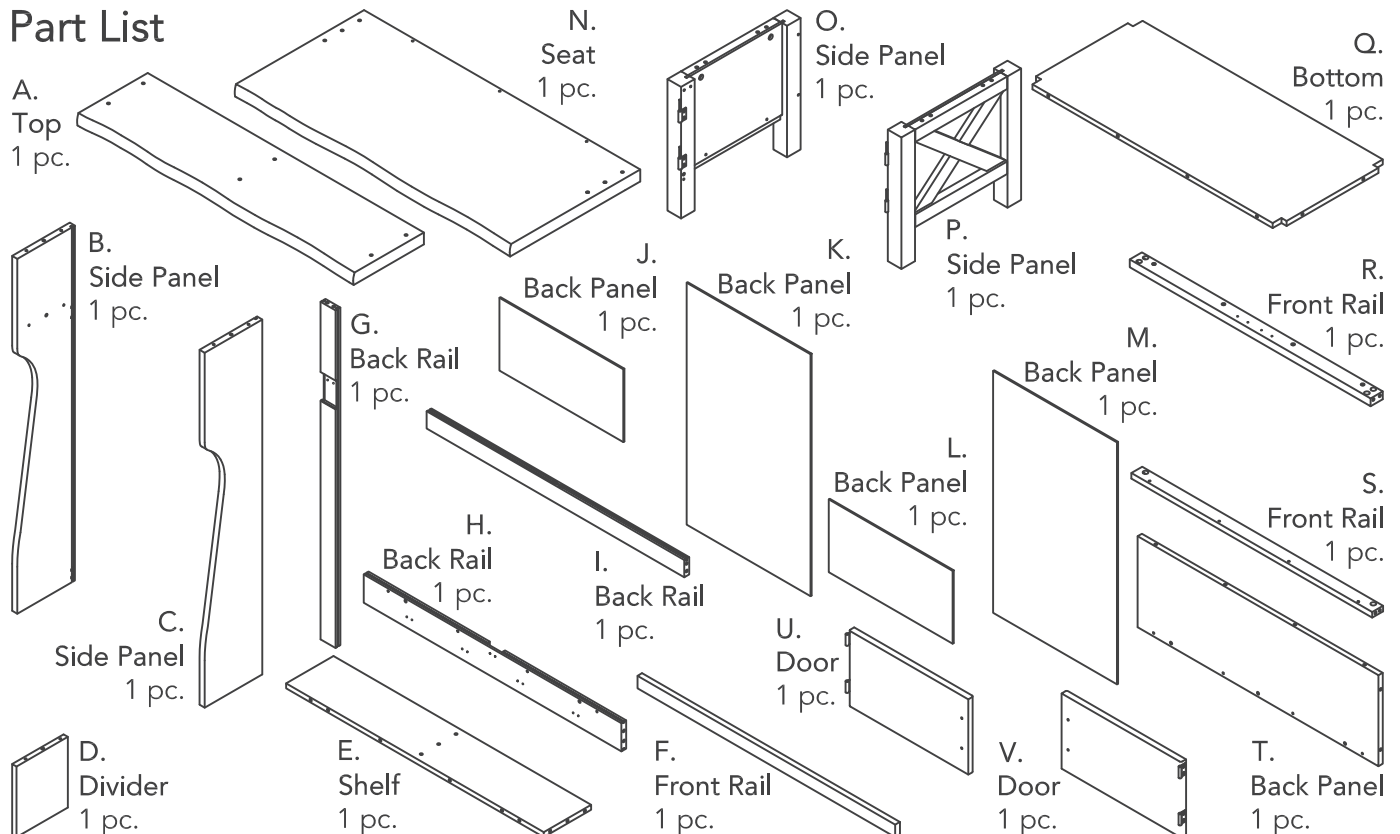

Hardware List

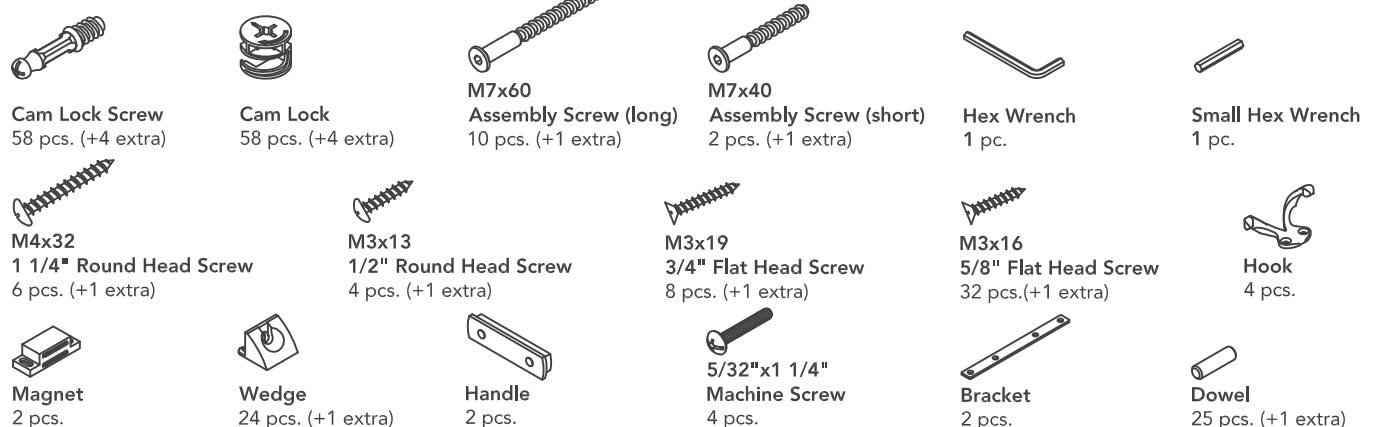

Tool(s) required for assembly: Phillips screwdriver, Level, Drill (8 volts or less), 3/8" Drill Bit

Home Styles Customer Service: www.homestyles-furniture.com,
servicedesk@homestyles-furniture.com, 888-680-7460, 877-831-0319

Assembly Instructions 2/13

IMPORTANT

- Use a soft cloth between these parts and the floor.
- Do not use power tools above 8 volts to assemble.
- Do not tighten all the bolts until each part is properly assembled.
- The unit must be level to work properly. Use the included adjustable levelers to level.
- Keep Hex Wrench as the Bolts may need to be tightened in the future.

STEP 1

Insert Cam Lock Screws into pre-drilled holes in Top (A), Side Panels (B), (C), (O), (P), Back Rails (H), (I), Front Rails (F), (S), Seat (N) and Back Panel (T), then tighten.

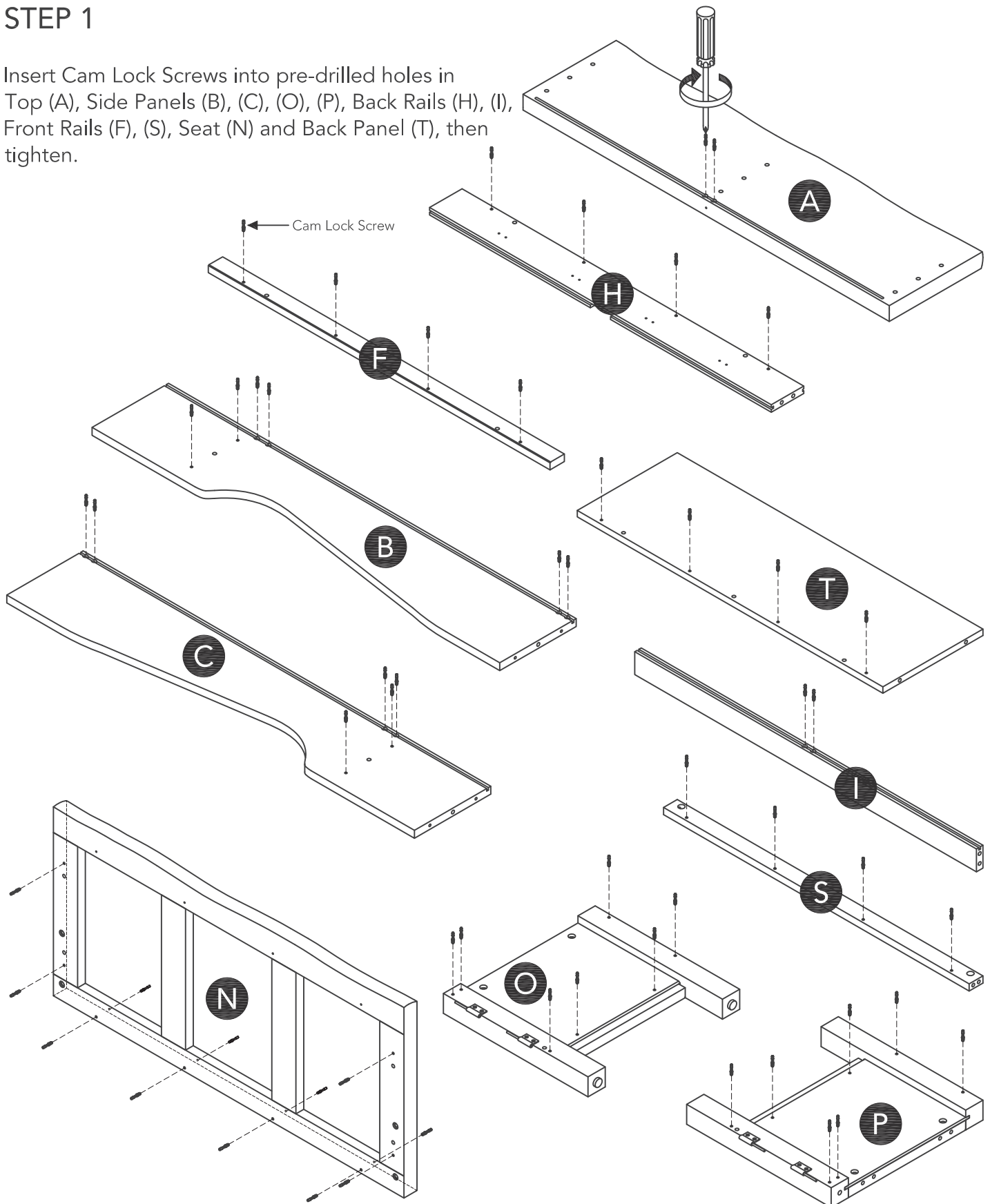

STEP 2

Attach Back Panel (T) and Front Rail (S) to Bottom (Q) with Dowels and Cam Locks.

(See Figure 1)

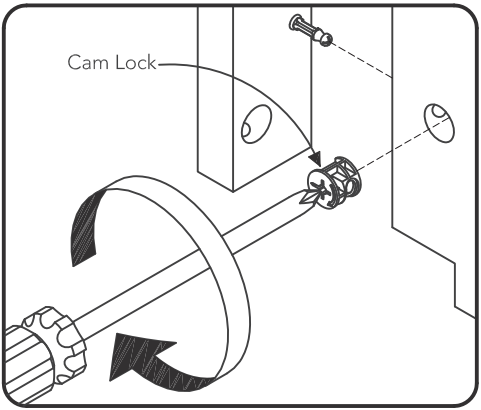
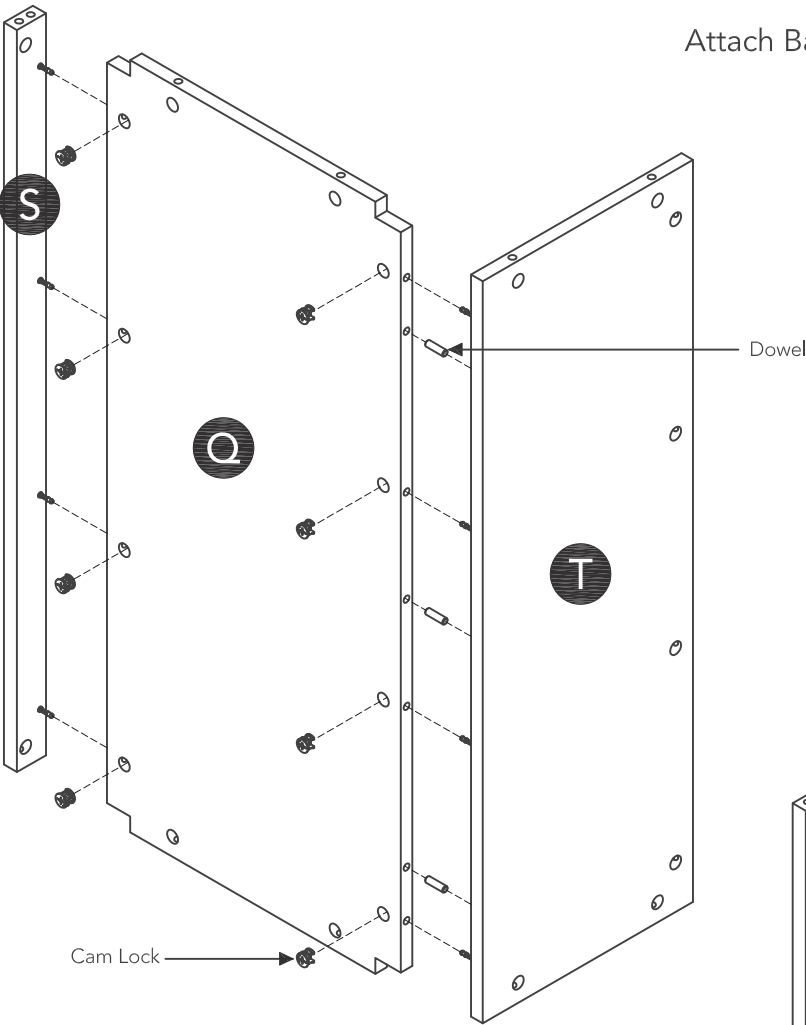
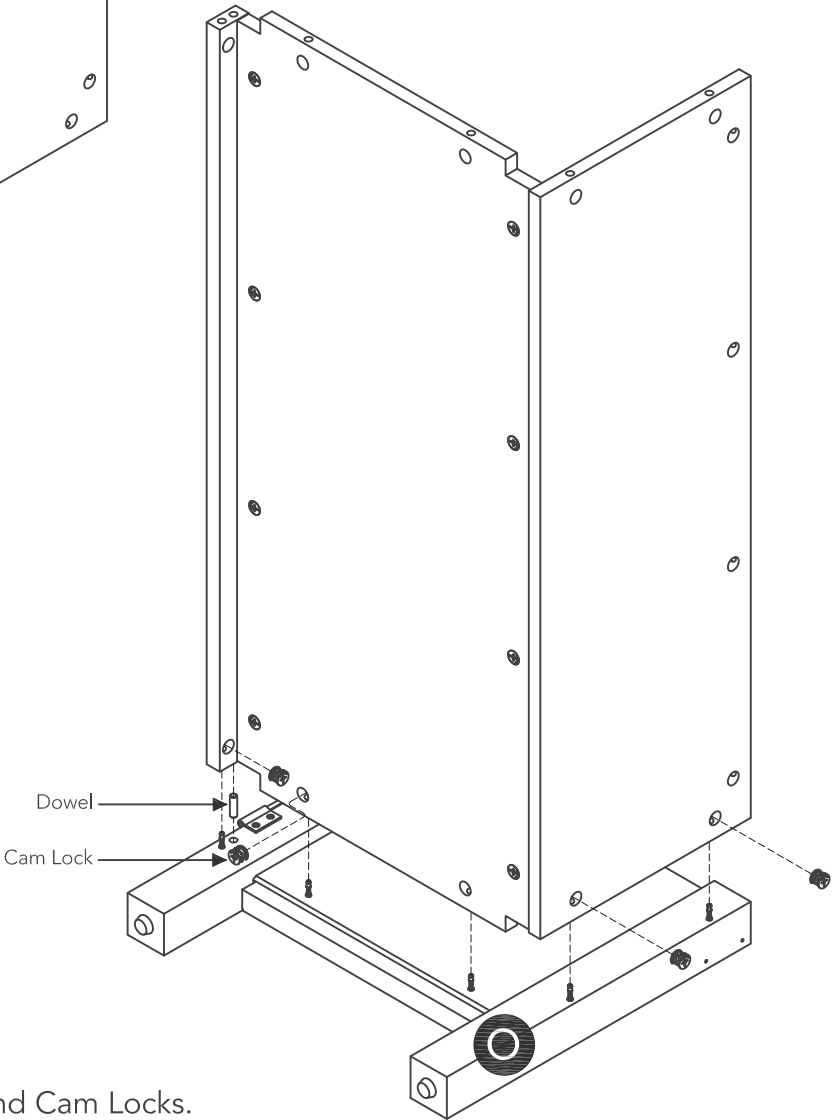

Figure 1



STEP 3

Attach unit to Side Panel (O) with Dowel and Cam Locks.

Assembly Instructions 4/13

STEP 4

Attach Magnets to Front Rail (R) with
1/2" Round Head Screws.

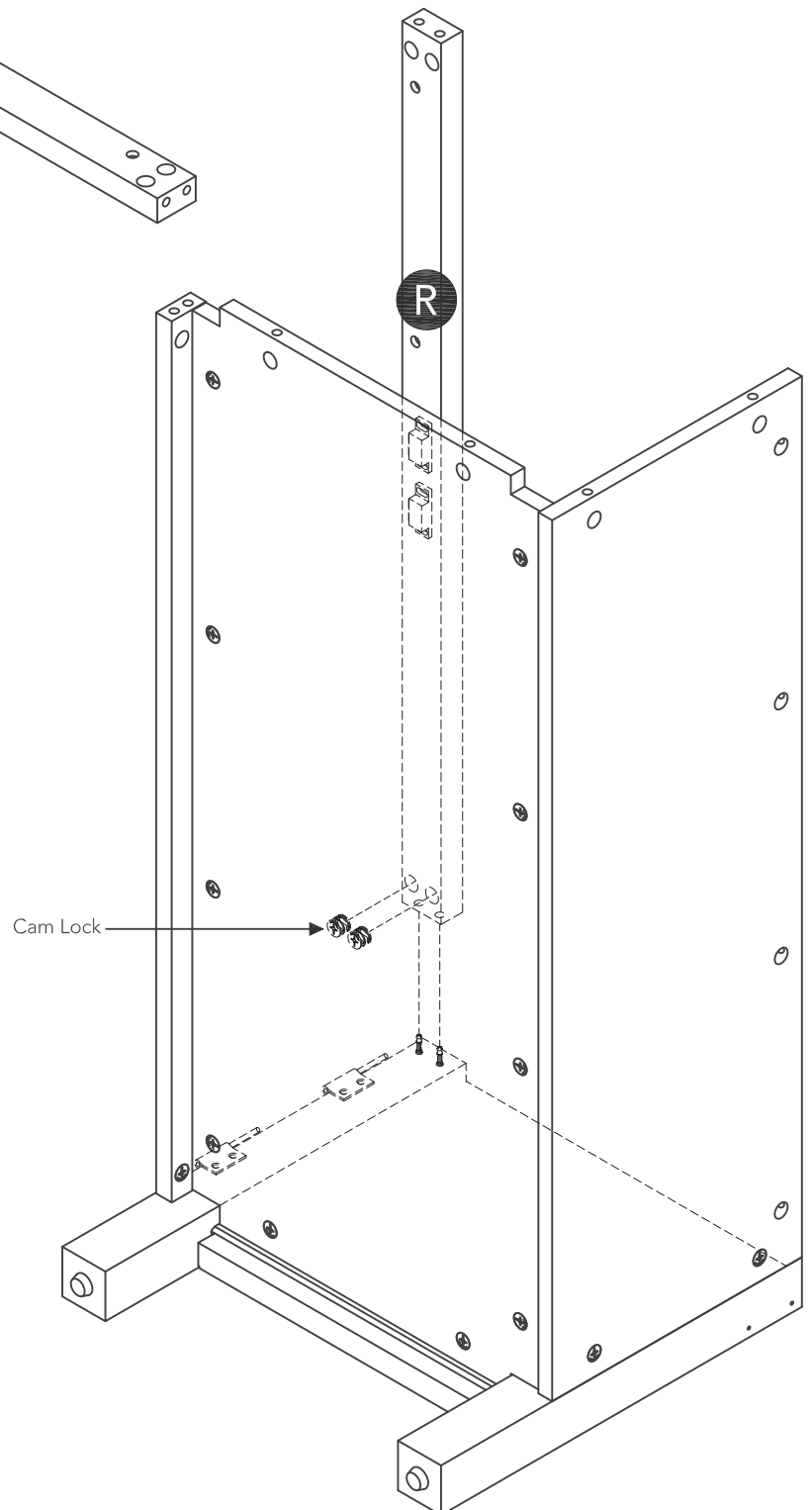
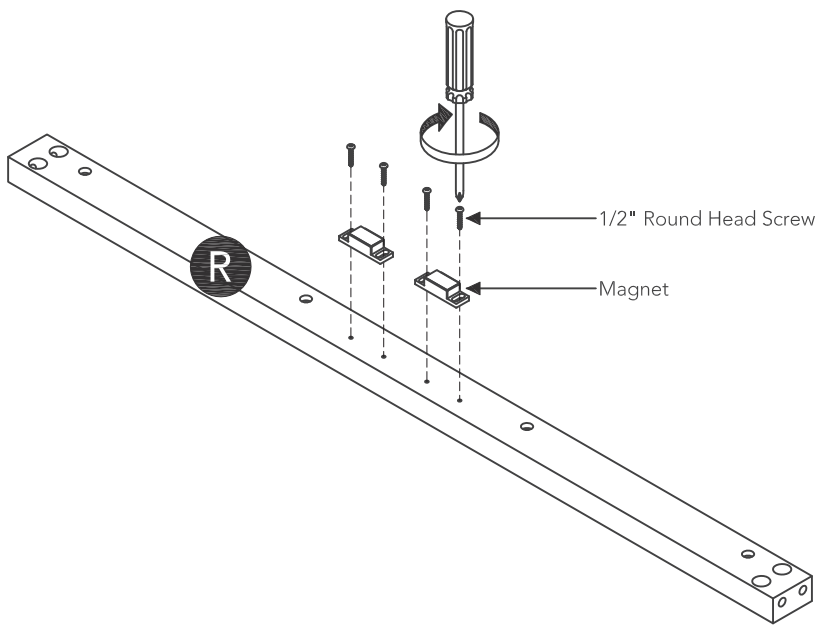

STEP 5

Attach Front Rail (R) to unit with Cam Locks.

STEP 6

Attach Side Panel (P) to unit with Dowel and Cam Locks.

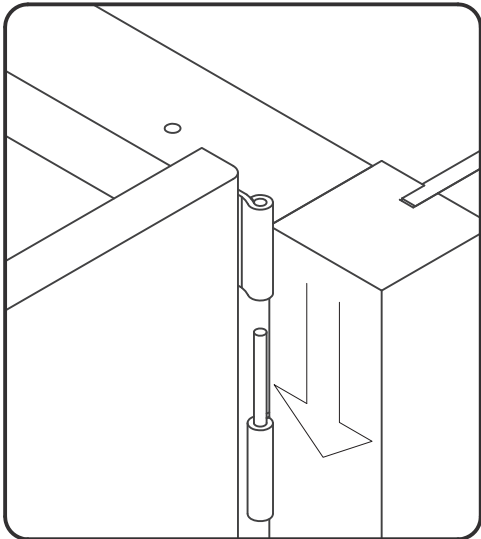
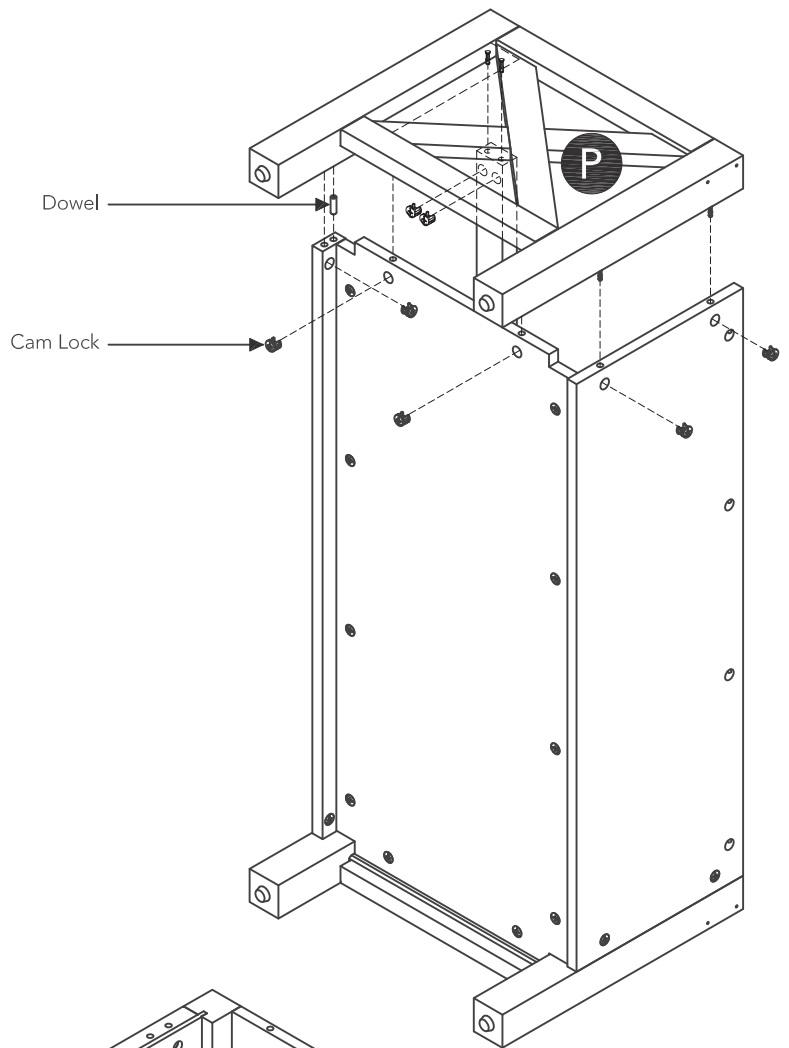
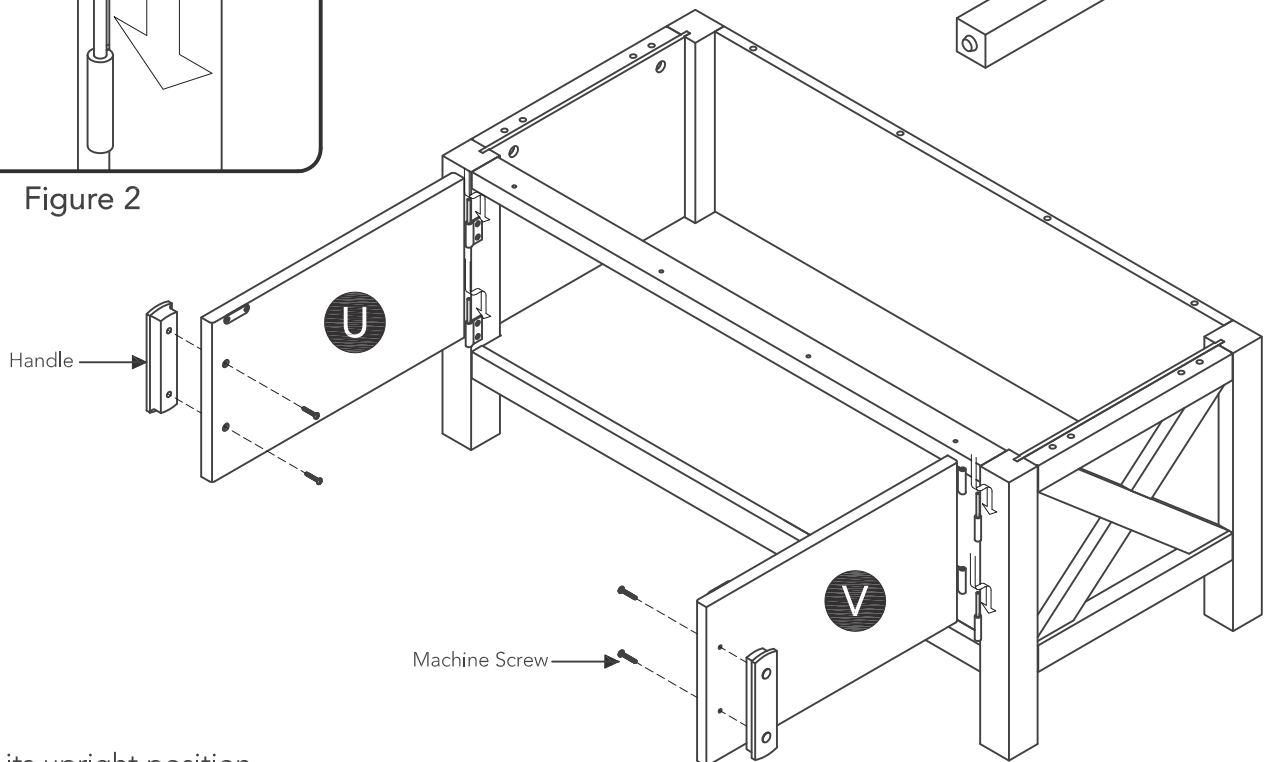

Figure 2



STEP 7

Turn unit to its upright position.

Attach Doors (U) and (V) by sliding door hinges into side panel hinges. (See Figure 2)

Attach Handles to Doors (U) and (V) with Machine Screws.

Assembly Instructions 6/13

STEP 8

Attach Front Rail (F) and Back Rail (H) to Shelf (E) with Dowels and Cam Locks.

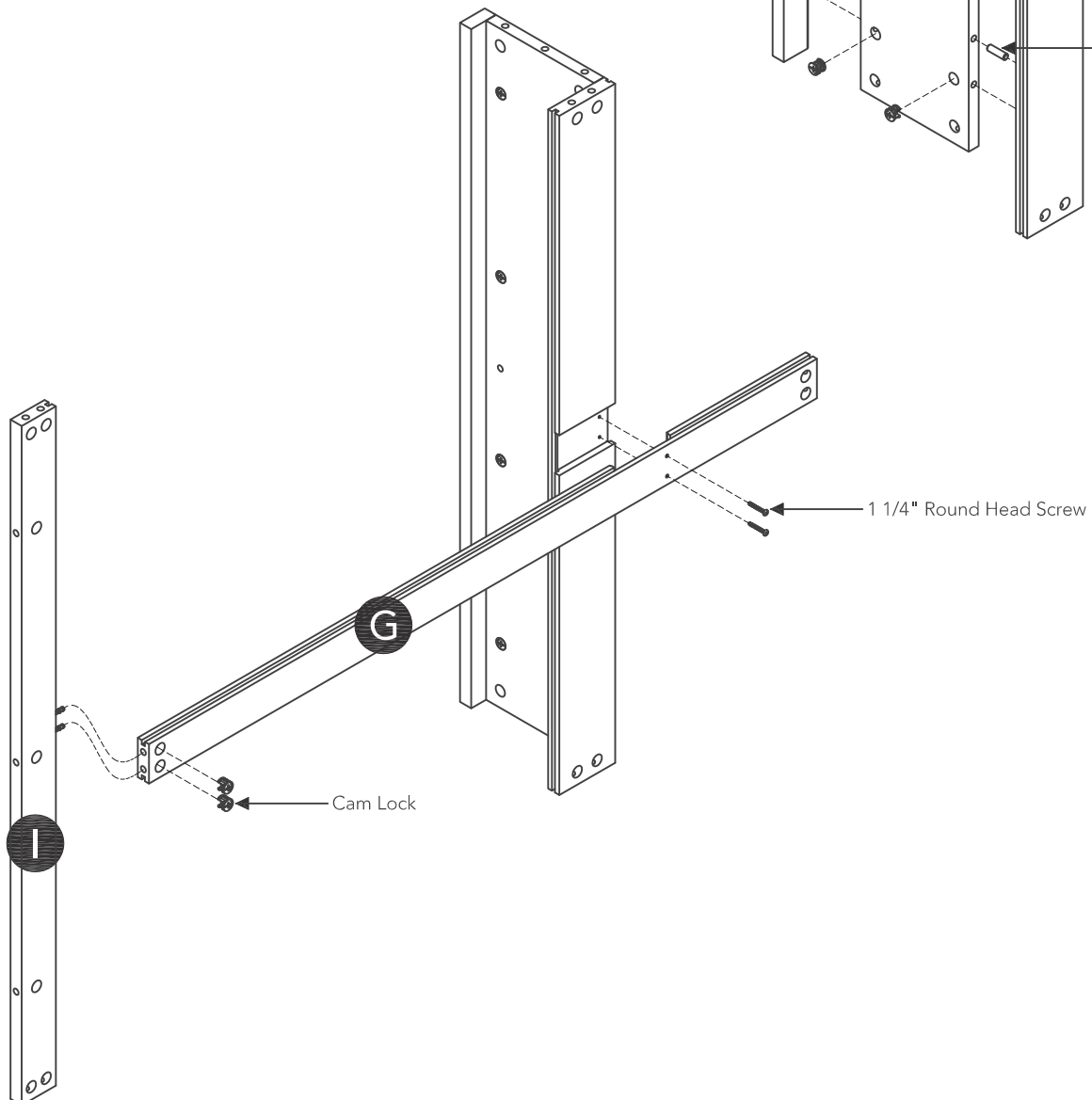
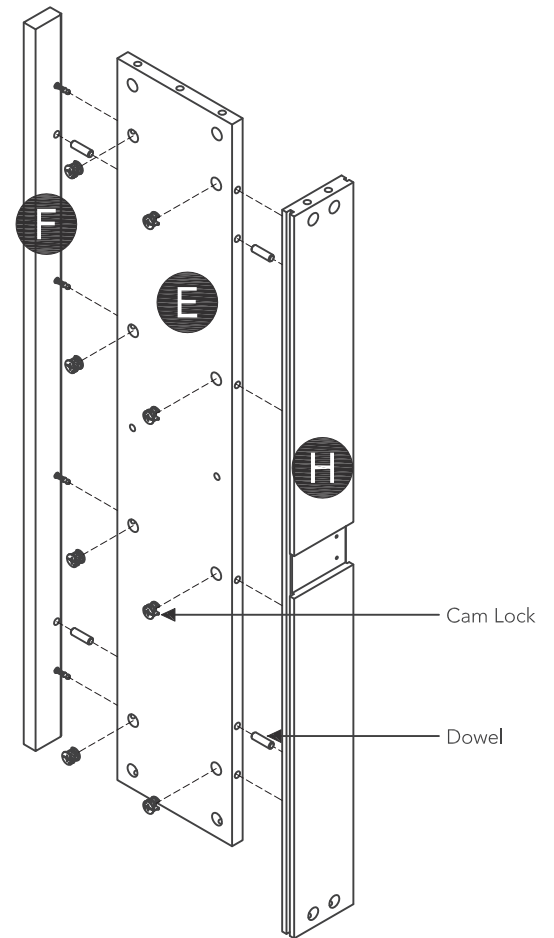

STEP 9

Attach Back Rail (G) to unit with 1 1/4" Round Head Screws.

Attach Back Rail (I) to Back Rail (G) with Cam Locks.

STEP 10

Orientate Back Panel (K) with Arrow label pointing down, then Slide Back Panel (K) into groove.

Attach Side Panel (B) to unit with Dowel and Cam Locks.

Note: Arrow label is on back side.

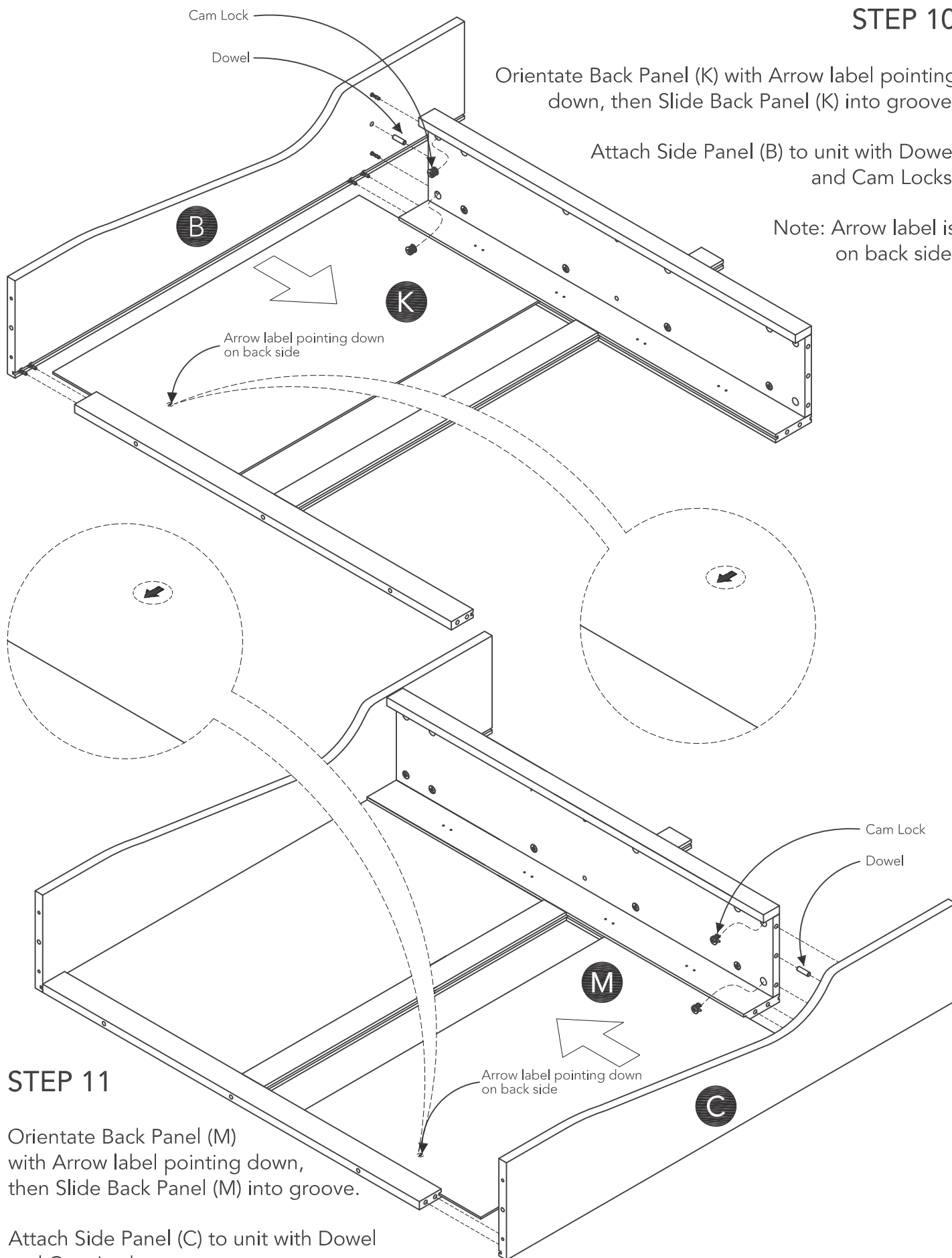

STEP 11

Orientate Back Panel (M) with Arrow label pointing down, then Slide Back Panel (M) into groove.

Attach Side Panel (C) to unit with Dowel and Cam Locks.

Note: Arrow label is on back side.

STEP 12

Insert Cam Locks into unit, then tighten.

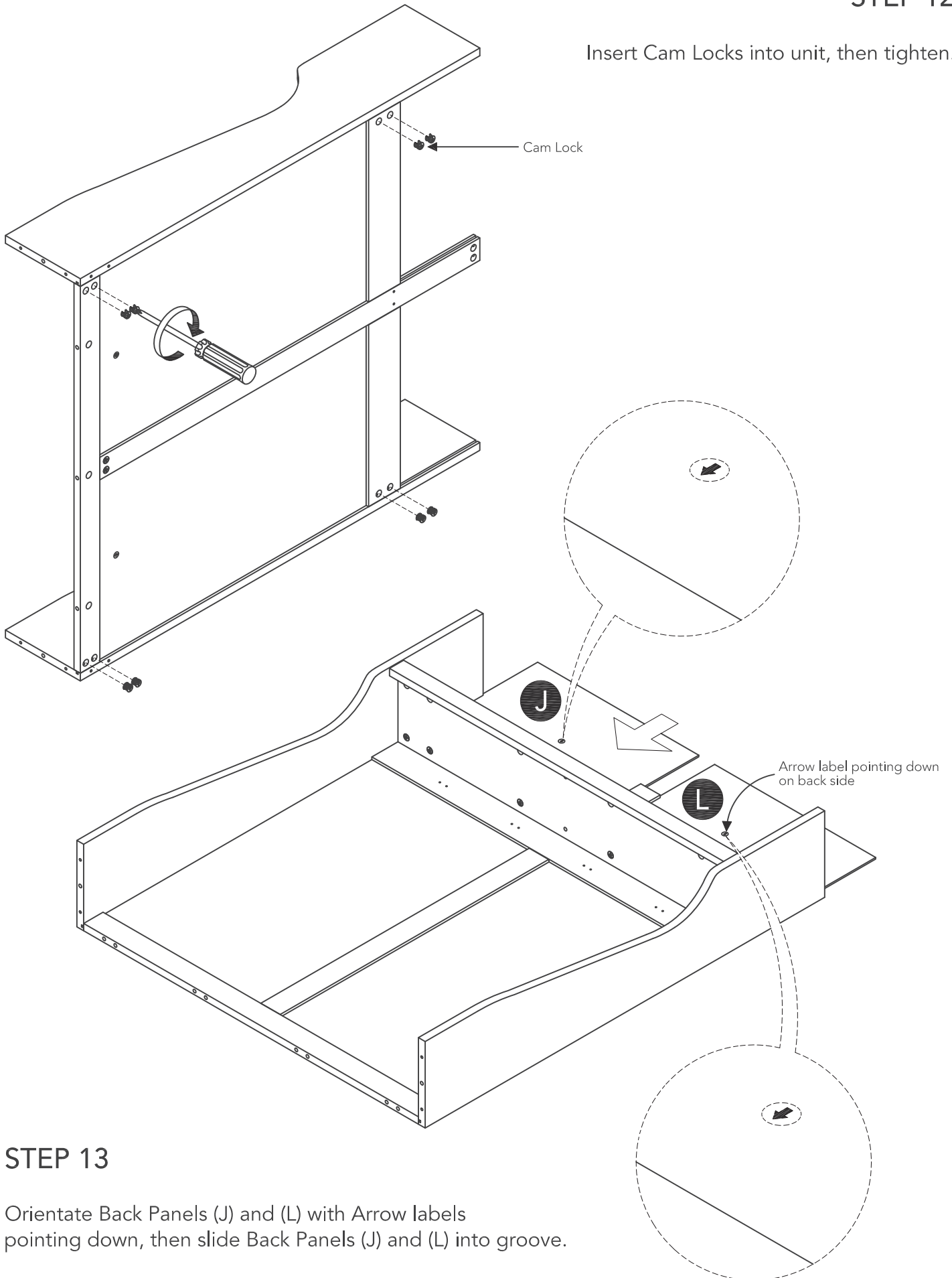

STEP 13

Orientate Back Panels (J) and (L) with Arrow labels pointing down, then slide Back Panels (J) and (L) into groove.

Note: Arrow labels are on back side.

Assembly Instructions 9/13

STEP 14

Attach Divider (D) to unit with Dowel and Assembly Screws (short).

Tighten Assembly Screws (short) with Hex Wrench.
(See Figure 3)

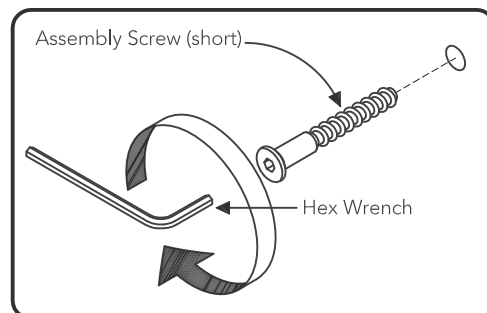
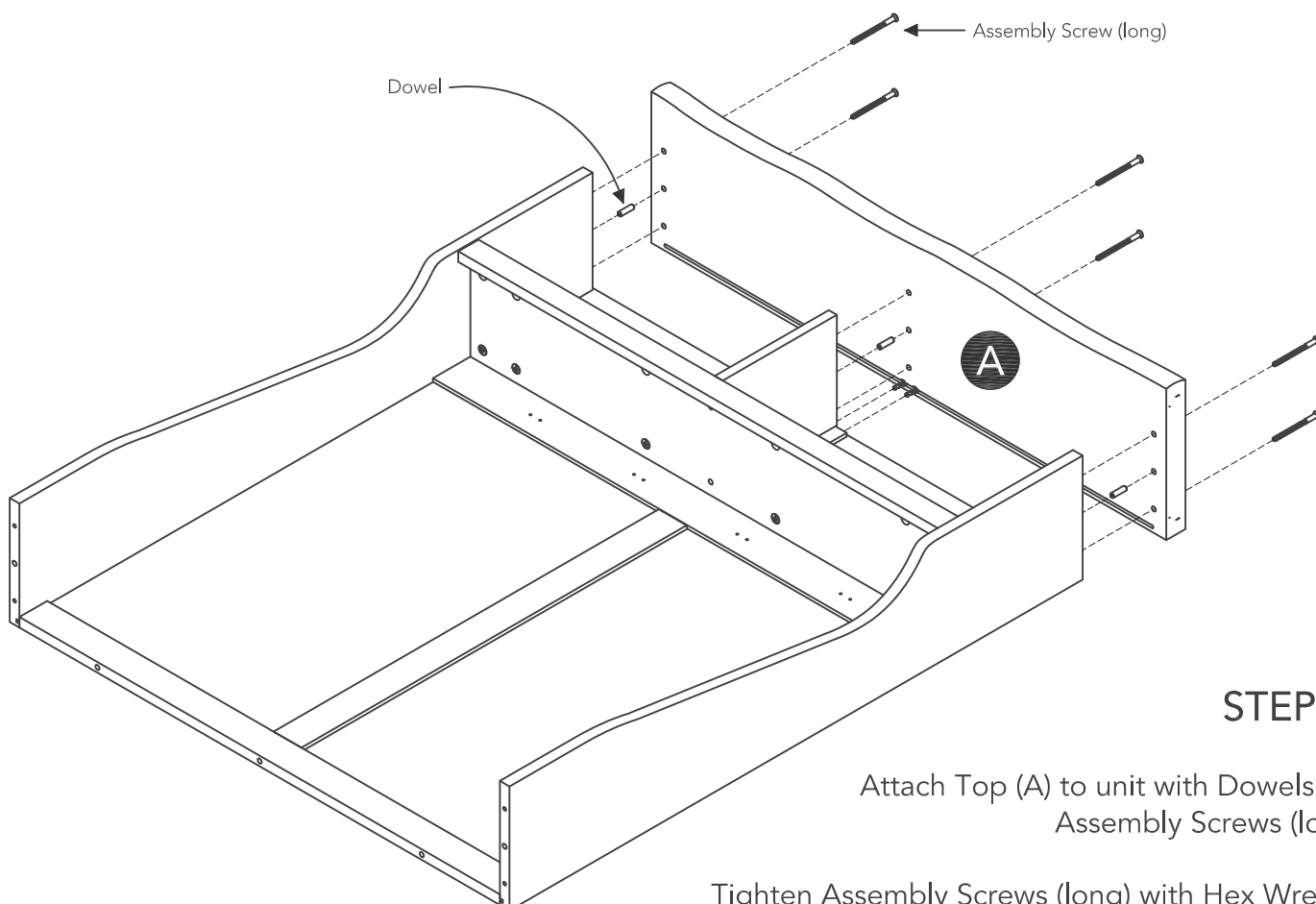
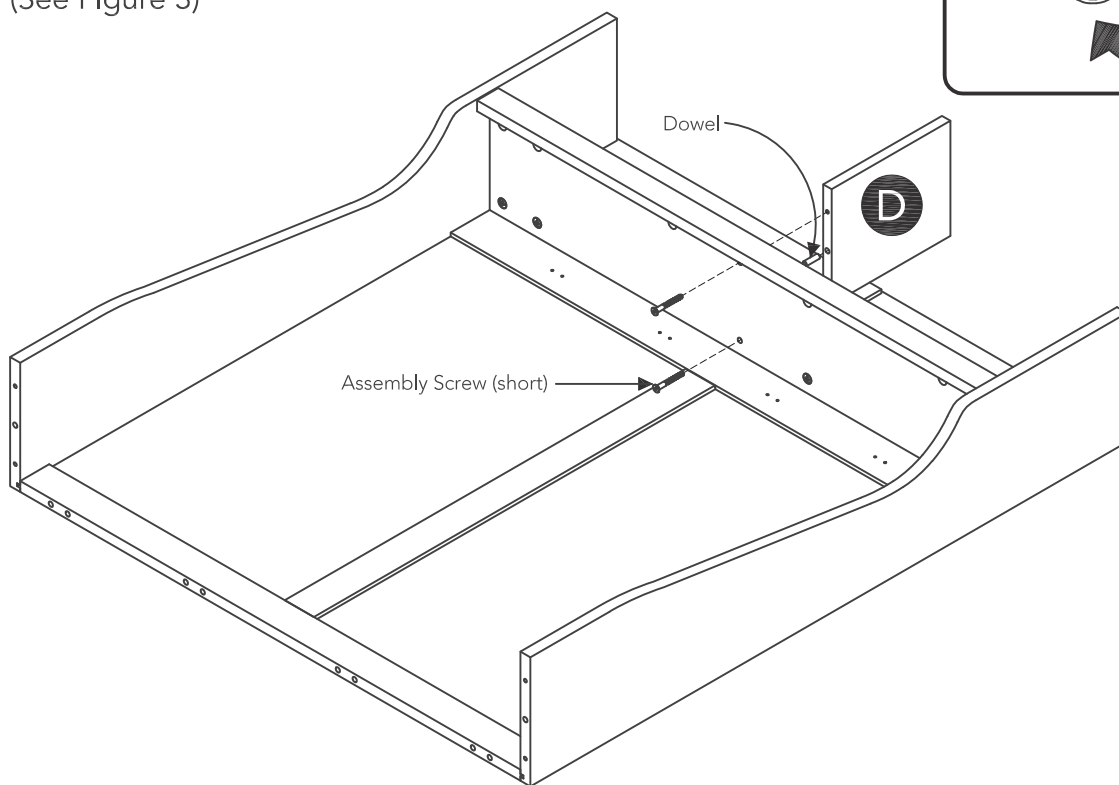

Figure 3



STEP 15

Attach Top (A) to unit with Dowels and
Assembly Screws (long).

Tighten Assembly Screws (long) with Hex Wrench.

STEP 16

Attach Hooks to unit with 5/8" Flat Head Screws. (See Figure 4)

Attach Seat (N) to unit with Dowels and Assembly Screws (long).

Tighten Assembly Screws (long) with Hex Wrench

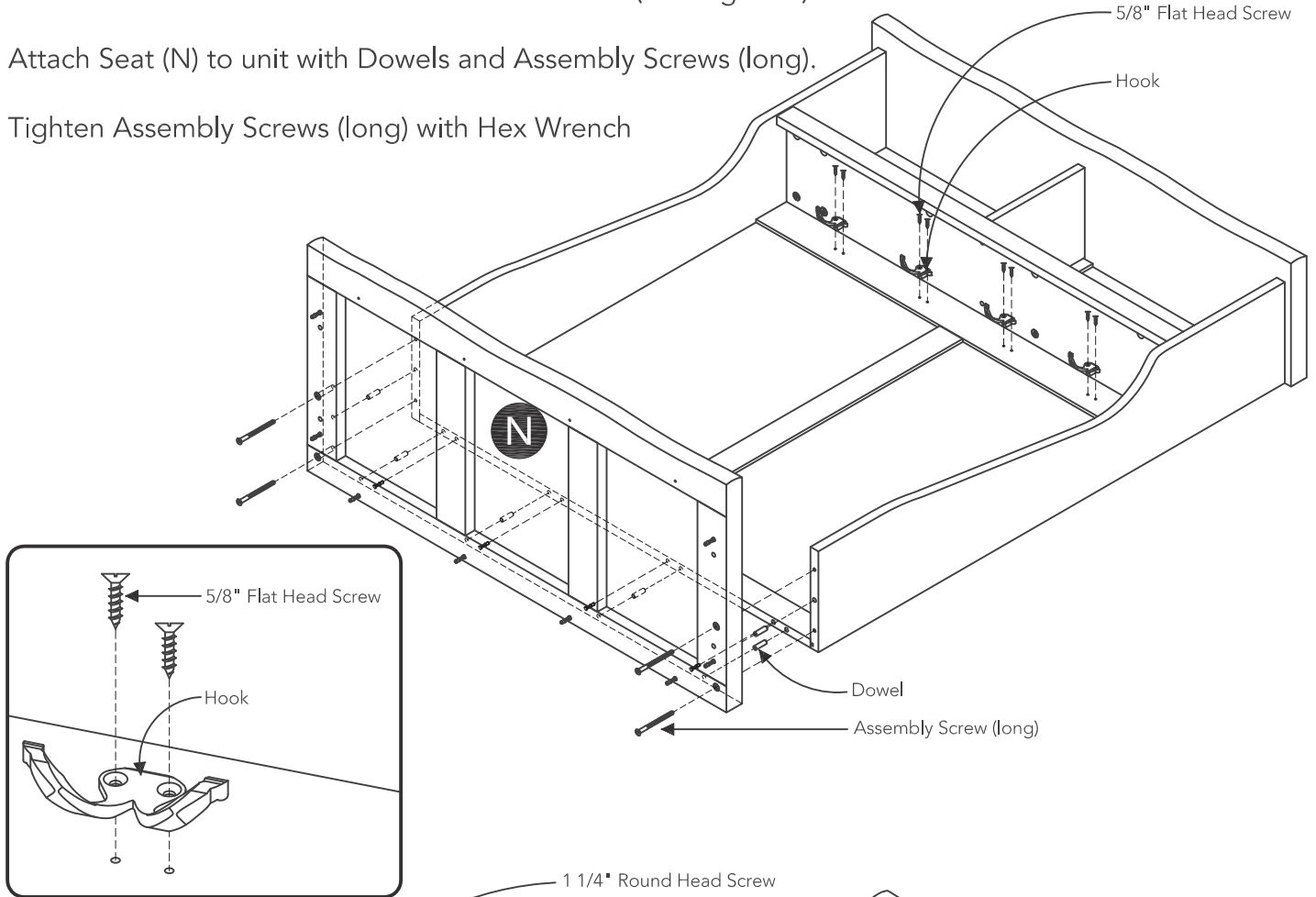
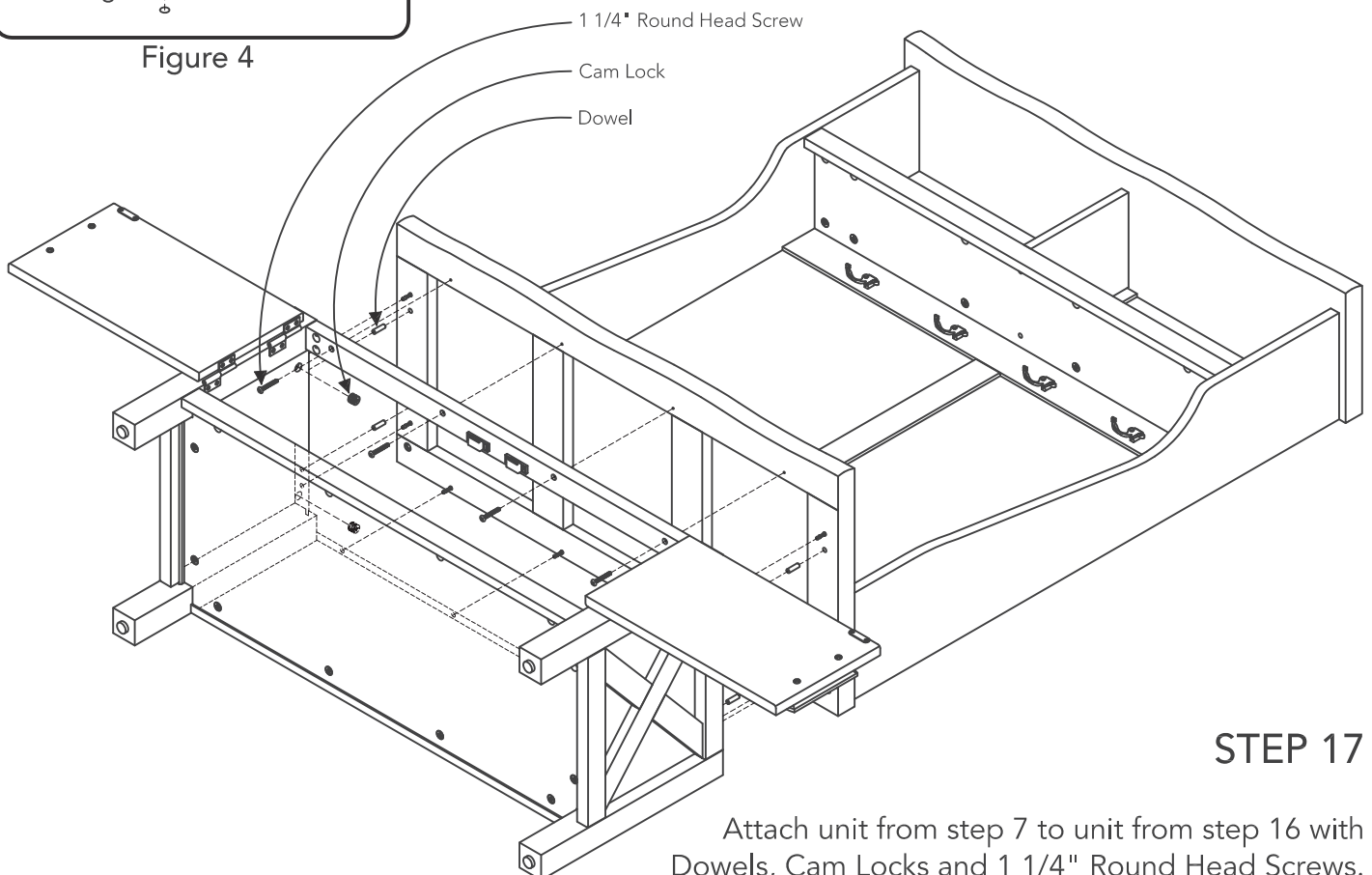

Figure 4



STEP 17

Attach unit from step 7 to unit from step 16 with Dowels, Cam Locks and 1 1/4" Round Head Screws.

STEP 18

Turn unit to its upright position.

Attach Brackets to unit with 3/4" Flat Head Screws. (See Figure 5)

Insert Cam Locks into unit, then tighten.

Level unit by adjusting the adjustable levelers on bottom of unit. (See Figure 6)

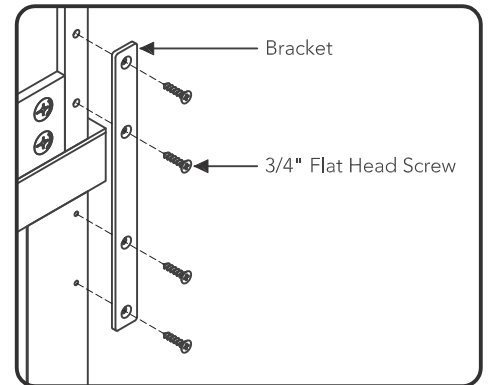
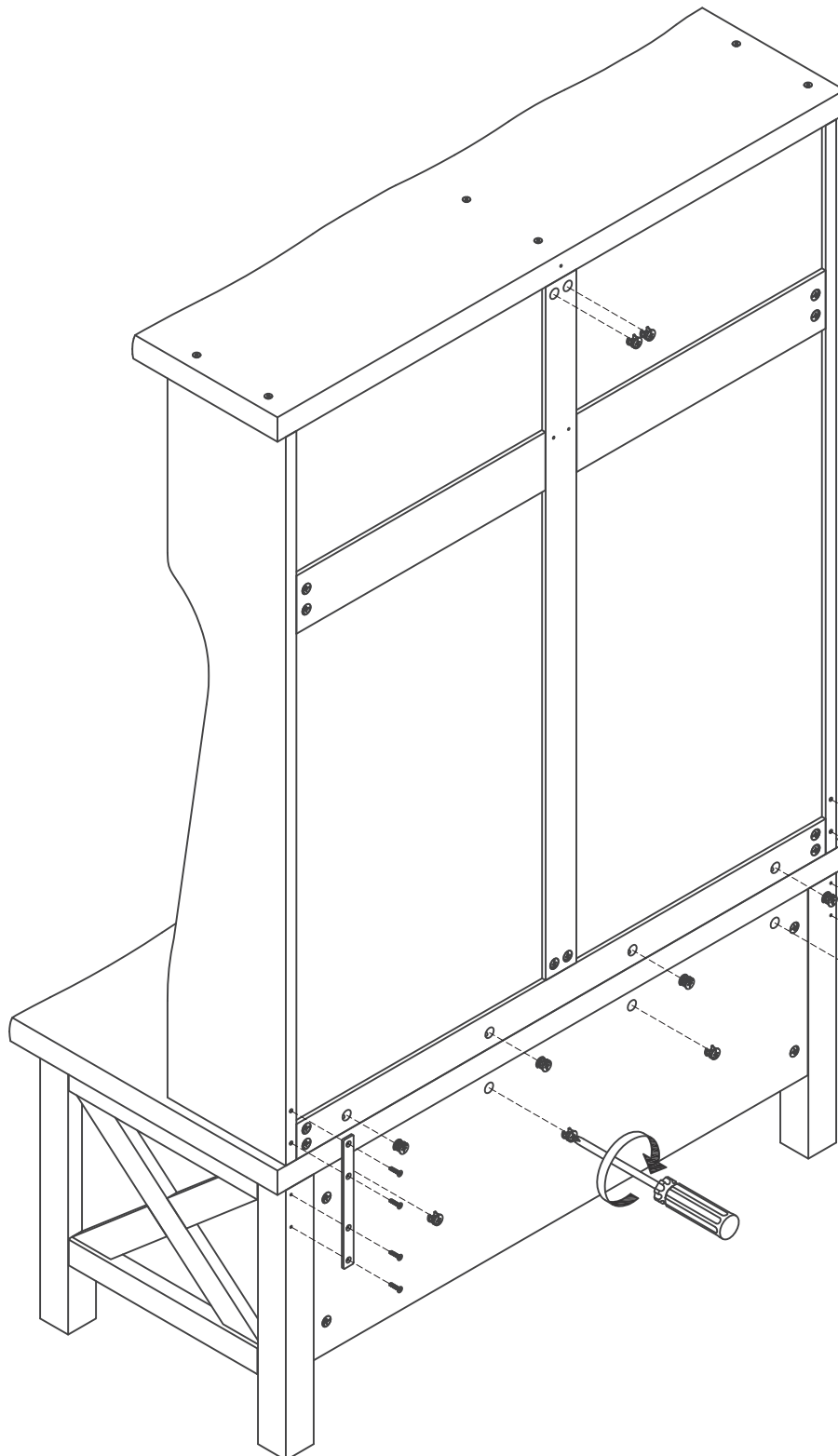

Figure 5

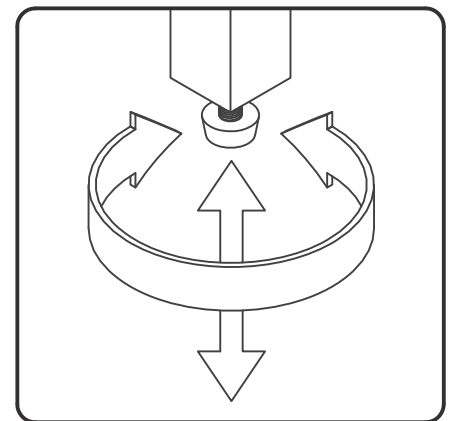
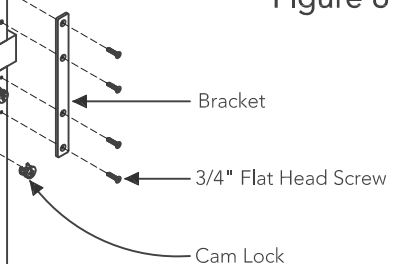
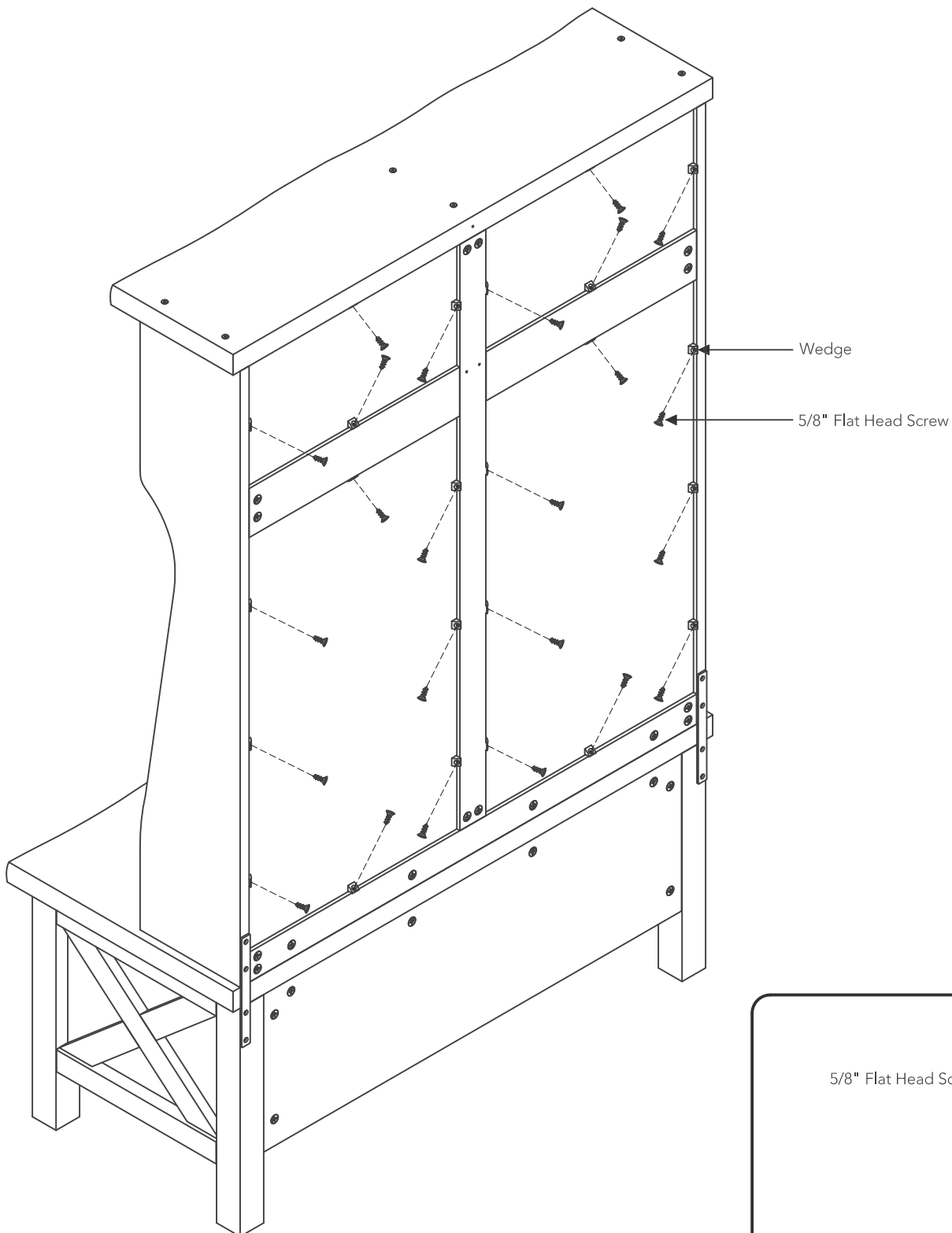

Figure 6





STEP 19

Attach Wedges to unit with
5/8" Flat Head Screws. (See Figure 7)

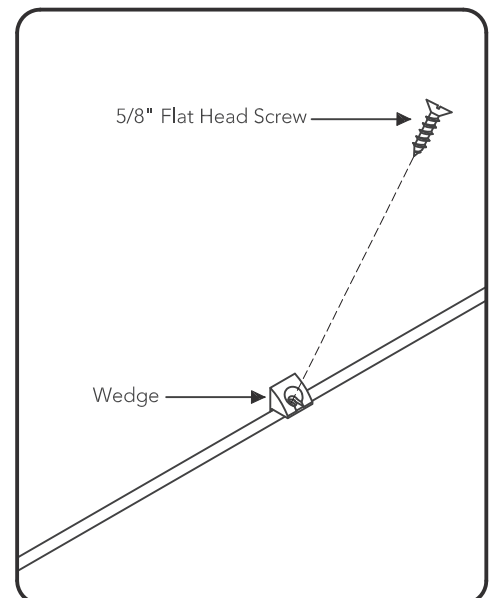

Figure 7

Assembly Instructions 13/13

IMPORTANT

- To help reduce the risk of the unit tipping over, the Tipover Restraint must be installed following these instructions exactly.

STEP 20

Place unit at desired location.

Drill a 3/8" hole in wall in-line with pre-drilled hole at top of unit.

Move unit.

Insert Anchor into the wall hole and attach Bracket with Wall Screw.

Attach Bracket at pre-drilled hole at top of unit with Wood Screw.

Move unit back into place.

Slide Tipover Restraint through Bracket on wall and Bracket on unit.
(See Figure 8)

Put tie end of Tipover Restraint into lock end of Tipover Restraint and pull until tight.

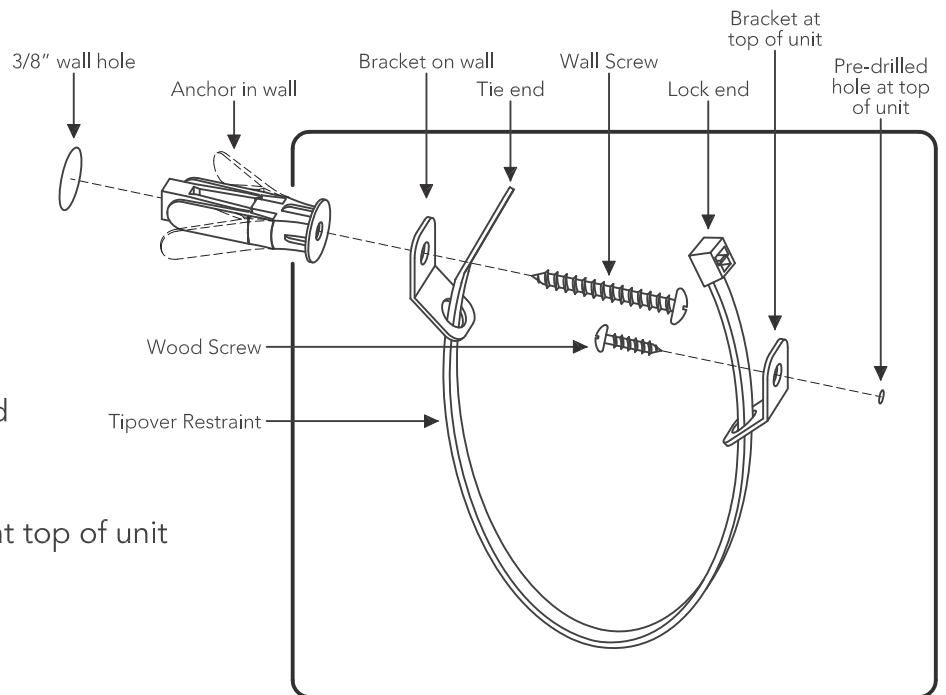
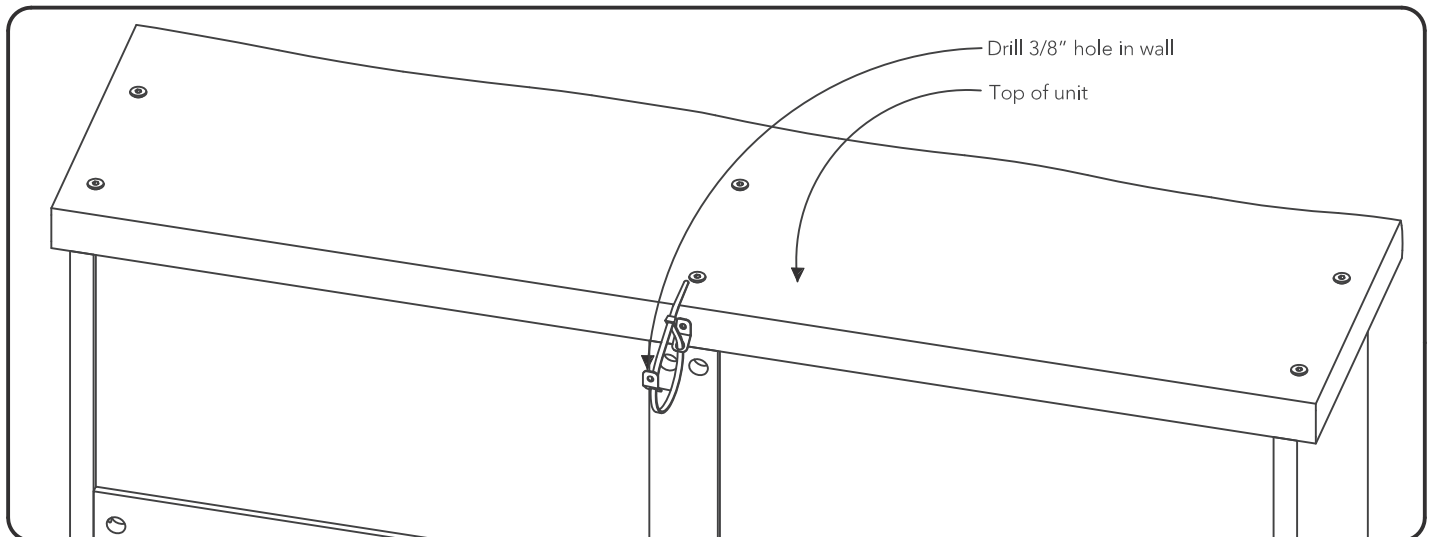
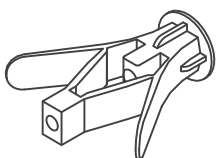

Figure 8



Hardware List



Anchor
1 pc. (+1 extra)

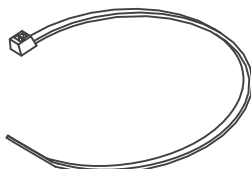

Tipover Restraint
1 pc.



Bracket
2 pcs.

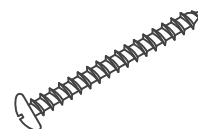

**M3x38
Wall Screw**
1 pc. (+1 extra)



**M3x13
Wood Screw**
1 pc. (+1 extra)

CARE INSTRUCTIONS

NEVER

allow liquids to remain on furniture.
Absorption causes parts to warp
and split and finishes to delaminate.

NEVER

use glass cleaners on
finished furniture. Ammonia
chemically attacks the finish.



Do not use power tools
above 8 volts to assemble.

**PREVENT
CRACKING**



Do not place
in direct sunlight.

**PREVENT
FADING**



Do not write
directly on surface.

**PREVENT
MARKING**



Do not place hot
objects on surface.

**PREVENT
FINISH DAMAGE**



Do not use rubber
based placemats.

**PREVENT
DISCOLORING**



Do not use commercial
waxes and polishes.

**PREVENT
YELLOWING**

CLEAN

with a soft cloth moistened
in lukewarm soap and water.
Buff with a dry clean cloth.



Home Styles will provide replacements free of charge for missing or damaged hardware or parts within 30 days of purchase. Digital images of the defective parts may be required. If the product was not purchased from an authorized retail affiliate, Home Styles is under no obligation to provide replacement parts. Parts are not available for fully assembled items nor are parts available for sale. Replacements for missing or damaged hardware or parts may be requested at:

www.homestyles-furniture.com/customer-service/replacement-parts

Home Styles Customer Service: www.homestyles-furniture.com,
servicedesk@homestyles-furniture.com, 888-680-7460, 877-831-0319