

Reorder Nos. 36110 & 36111

dynarex
Resp-O₂™

Peak Flow Meter

- Low Range 50-300 L/min
- Full Range 50-800 L/min

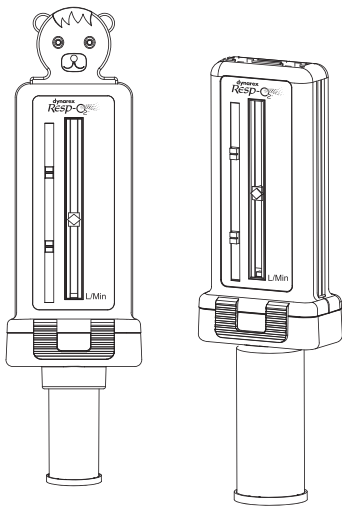

INDICATIONS FOR USE

Dynarex Resp-O₂ Peak Flow Meter is a respiratory monitoring device used to measure the Peak Expiratory Flow Rate (PEFR), which is the maximum burst flow rate during forced exhalation. This is helpful while monitoring respiratory conditions such as Asthma or Chronic Obstructive Pulmonary Disease (COPD). The device can be used anywhere the patient needs to measure their PEFR. It is designed for single-patient use in adults and children.

PRODUCT DESCRIPTION

Dynarex Resp-O₂ Peak Flow Meter is a hand-held monitoring device that measures Peak Expiratory Flow (PEF) generated by the patient during a forced exhalation maneuver. It can be used to measure PEF by tracking day-to-day changes in breathing patterns. Disposable mouthpieces are available for multi-patient screening.

SPECIFICATIONS

1. Universal Peak Flow covers full and low range. Suitable for adults and children.
2. Measurement Range: Full (50-800 L/min) and Low (50-300 L/min) ranges.
3. The device is intended for a single user only.
4. Three-zone design helps patients comply with treatment regimens. The color-coded indicators can be adjusted to delineate a patient's green, yellow, and red zones based on personal best peak flow. Zone Color set up shall be prescribed by your physician.

CAUTION

- Do not put the Peak Flow Meter in a damp, polluted, or heated place.
- The Peak Flow Meter is designed for single patient use.
- This product should be used under the supervision of a physician or licensed healthcare professional.

STORAGE

- Storage and transport temperature -4°F to 140°F (-20°C to 60°C).
- Keep the device in a cool, dry place out of direct sunlight before use.

MAINTENANCE and DISPOSAL

- After use, wipe the mouthpiece with a clean, dry cloth.
- The device does not contain any hazardous substances and may be disposed of with your normal household refuse.

OPERATION PROCEDURE

1. Hold the Peak Flow Meter so that your fingers are clear of the scale.
2. Check and make sure the indicator is at the bottom of the scale (closest to the mouthpiece) if not, gently slide it down into the correct starting position.

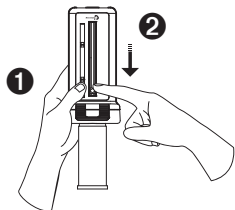

3. Stand or sit straight (A standing position is preferable).
4. Inhale as deeply as possible.

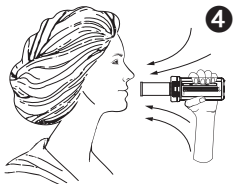

5. Place the mouthpiece in your mouth, and seal it tightly with your lips.



6. Exhale as quickly and completely as you can.
7. Indicator will move up the scale, the number beside the indicator is your peak flow measurement. (write down your reading).

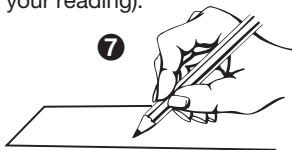

8. In order to repeat this test, return the indicator to its original position. (follow steps 1-7).
9. After three readings, record the highest one with the date and time in your Daily Diary.
10. The measurement records can be provided for monitoring respiratory conditions, self-evaluation and medication reference to your physician.

Peak Flow Meter DAILY RECORD CARD

Simply locate the point on the Daily Record, below the Date and Time that corresponds to the PEF you wish to record. Mark an "X" at that point.

Normal peak flow readings vary, depending on your age, size, and sex. In healthy people, peak flow readings vary slightly from time to time.

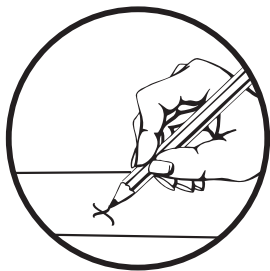

Name: _____

Age: _____

Height: _____

Sex: _____

PFM L/MIN:

DATE										
TIME	AM	PM	AM	PM	AM	PM	AM	PM	AM	PM
800										
750										
700										
650										
600										
550										
500										
450										
400										
350										
300										
250										
200										
150										
100										
50										

 **Manufactured for:**
Dynarex Corporation
10 Glenshaw Street
Orangeburg, NY 10962
USA • www.dynarex.com
Made in Taiwan R210209

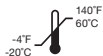

CAUTION: Federal (USA) Law restricts this device to sale by or on the order of a physician.



SYMBOL GLOSSARY

For an explanation of symbols used in Dynarex packaging, visit dynarex.com/symbols.php