

MCKINNEY C. KING BED
ASSEMBLY INSTRUCTIONS

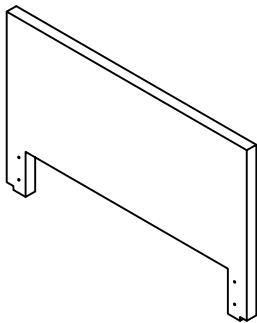

PARTS AND HARDWARE
PACKING CONFIGURATONS

BOX #1
A. HEADBOARD: 1PC



BOX #2
B. FOOTBOARD 1 PC.

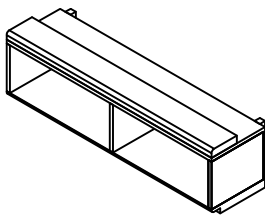

BOX #3
C. SIDE RAILS: 2 PCS

D. SLAT ROLL: 1 SET

E. CENTER LEG: 4 PCS

F. CENTER SLAT SUPPORT: 1 PC

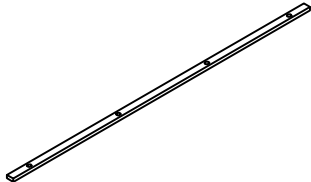
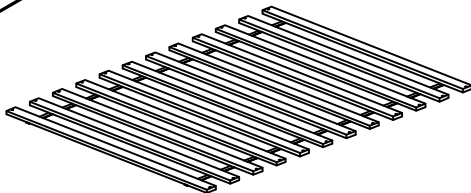
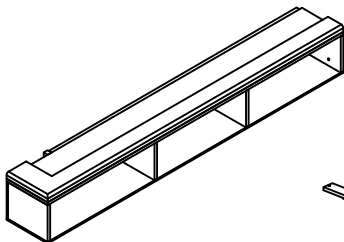

**MCKINNEY BED
ASSEMBLED**

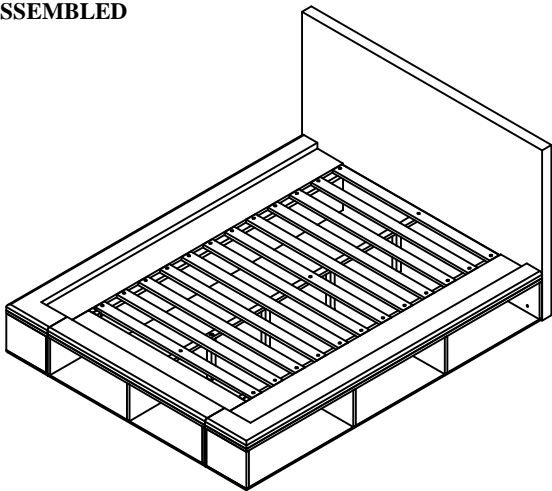

HARDWARE PACKED IN BOX #3

1. ALLEN BOLT M8X50 8 PCS



2. SPRING WASHER M8 8 PCS



3. FLAT WASHER M8 8 PCS



4. WOOD SCREW M4X30 29 PCS



5. ALLEN KEY M4 1 PC



MCKINNEY C. KING BED ASSEMBLY INSTRUCTIONS



STEP 1

ATTACH THE SIDE RAILS (C) TO THE HEADBOARD (A) USING TWO ALLEN BOLTS (1), SPRING WASHERS (2) AND FLAT WASHERS (3), PER SIDE. DO NOT TIGHTEN BOLTS COMPLETELY.

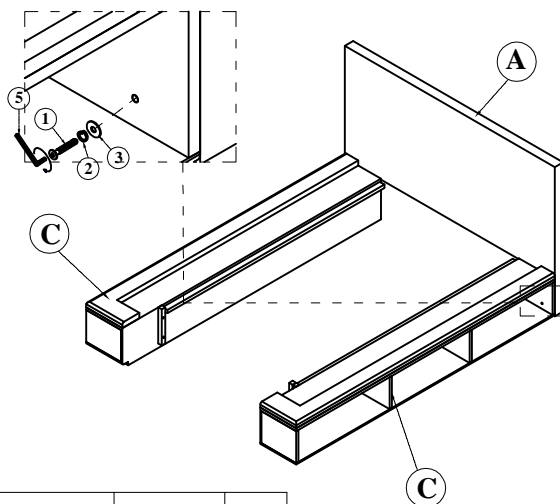

NO.	PICTURE	SIZE	QTY.
①		M8x50	4
②		M8xØ12xt1.7	4
③		M8xØ19xt1.7	4

STEP 2

ATTACH THE FOOTBOARD (B) TO THE SIDE RAIL ASSEMBLY USING TWO ALLEN BOLTS, SPRING WASHERS AND FLAT WASHERS. TIGHTEN ALL FOUR BOLTS AND BOLTS FROM STEP 1 COMPLETELY USING ALLEN KEY (5).

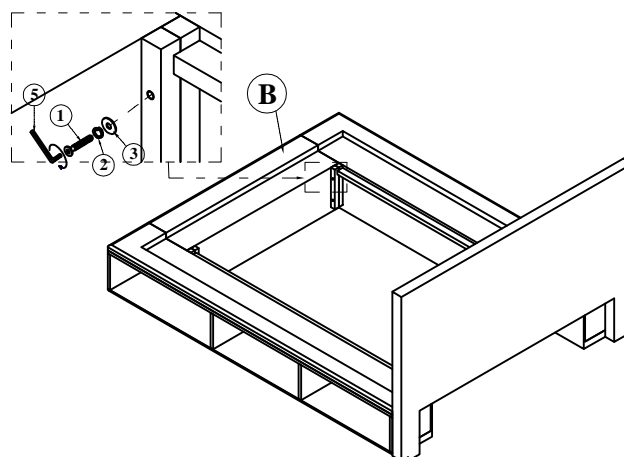

NO.	PICTURE	SIZE	QTY.
①		M8x50	4
②		M8xØ12xt1.7	4
③		M8xØ19xt1.7	4

STEP 3

ATTACH THE FOUR CENTER LEGS (G) TO THE CENTER SLAT SUPPORT (F).

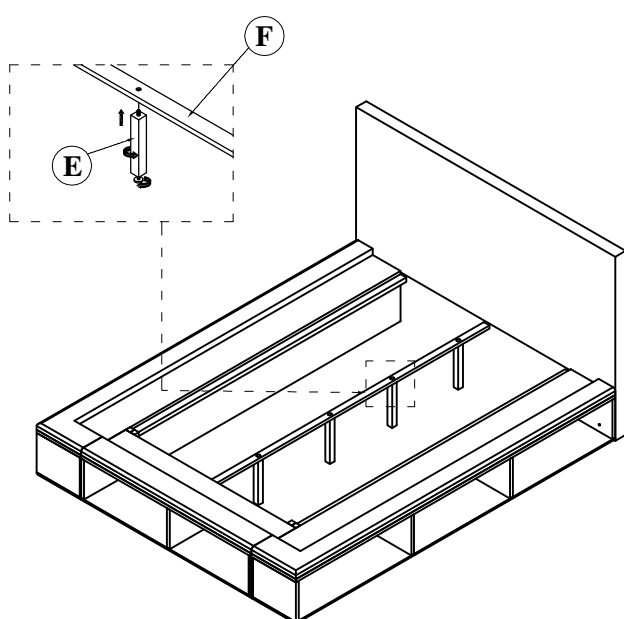

STEP 4

ATTACH THE SLATS TO THE BED AND CENTER SLAT SUPPORT USING THE PROVIDED WOOD SCREWS (4) [PHILIPS HEAD SCREW DRIVER NOT INCLUDED].

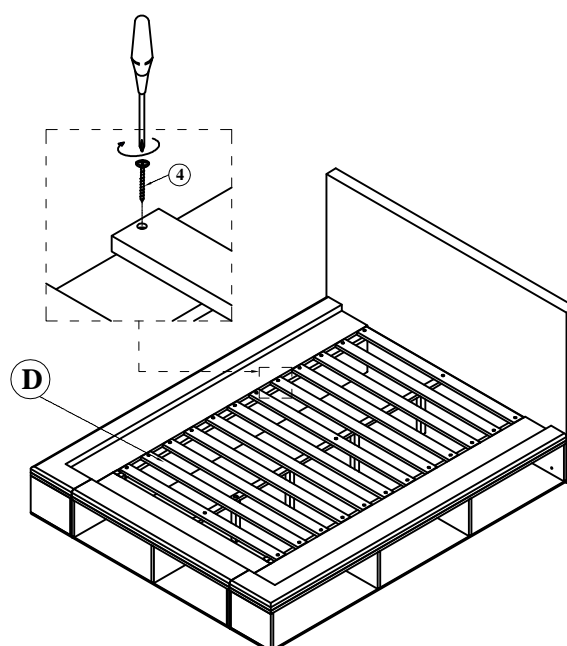

NO.	PICTURE	SIZE	QTY.
④		M4x30	29