

carstens®

Magnetic Storage Caddy

Versatile | Two Mounting Options

Secure a barcode scanner, non-contact forehead thermometer, hand sanitizer bottle, and more with this handy magnetic storage caddy. Designed for our wall-mounted workstations, storage cabinets, and mobile carts—where space is often at a premium—the caddy's movable magnet permits a parallel or perpendicular orientation without restricting access or sacrificing utility.

Features:

- Parallel or perpendicular mounting options
- Durable, non-scratch thermoplastic coating
- Available in white or black
- Sturdy, 18 gauge steel construction
- Accommodates items up to 4 pounds



+ 60010-03



+ 60010-01

Add convenient storage and function where it's needed



Parallel Mount

For interior mounting in 4" deep workstations or mobile cart drawers.



Perpendicular Mount

For interior mounting in 6" or 8" deep workstations or exterior mounting to workstations.

Create additional storage capacity from nearby metal surfaces, like the sides of our wall-mounted workstations, storage cabinets, and mobile carts with this versatile magnetic caddy that offers custom-tailored utility.

Use it as a dock for handy access to a barcode scanner or non-contact forehead thermometer. Or easily secure other caregiving essentials in the caddy, like an 8 oz. bottle of hand sanitizer, for more convenient use.

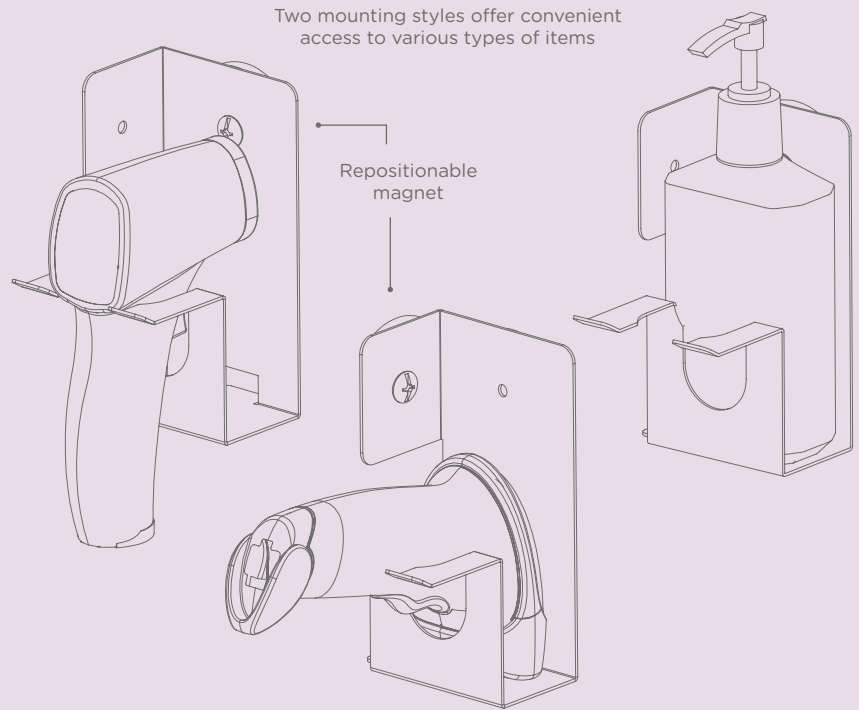
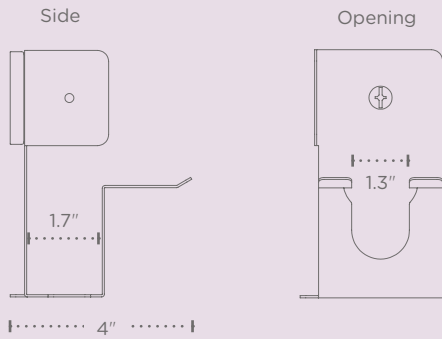
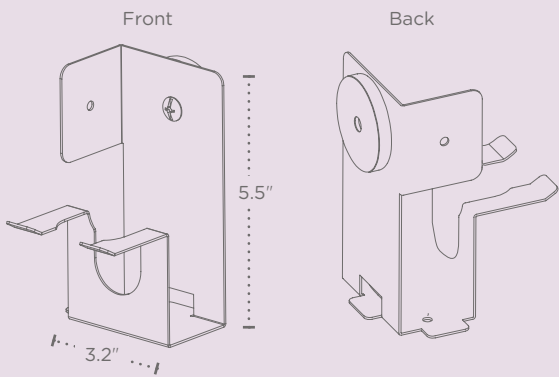

+ 60010-01/03

Magnetic Storage Caddy

Versatile | Two Mounting Options

Crafted of premium steel with a durable thermoplastic coating, our magnetic storage caddy is designed to withstand heavy everyday use, cleaning, and disinfection.

Product Dimensions	L3.2" × W4" × H5.5"
Product Weight	0.09 lbs
Shipping Dimensions	L6" × W5" × H5"
Shipping Weight	1 lbs
Weight Capacity	4 lbs*
Finish	Durable, anti-abrasion, BPA-free thermoplastic
Material	18 gauge steel with ceramic magnet
Warranty	90-day
Part Number	60010- 01 03

Storage Ideas	Barcode scanner, non-contact forehead thermometer, 8 oz. bottle of hand sanitizer, and more
Scanner Compatibility**	Honeywell 1900 Series Zebra 4600 Series Datalogic Gryphon 4200 Series
Sanitizer Compatibility	8 oz. rectangular bottles
Wall-Mounted Workstation Mounting	4" D interior parallel, side magnet 6-8" D interior perpendicular, back magnet 4-8" D exterior perpendicular, back magnet
Mobile Cart Mounting	Compatible with drawer models only. Parallel mount to side of drawer.

*When mounted to an 18 gauge or thicker, smooth steel plate.

**Not a comprehensive list. To ensure fit, test prior to purchasing.

[Click to buy now from Carstens.com](https://www.carstens.com)

MADE IN AMERICA
OF U.S. AND IMPORTED PARTS



For more information:
800.782.1524 / carepodsales@carstens.com
©Carstens, Inc. 03.2021
Literature made in the USA.
Content subject to change.