

Brookings Shaker 3-Door Vanity with Cultured Marble Single Hole Solid White Top, Fully Assembled, 61x22, Modern Birch Base

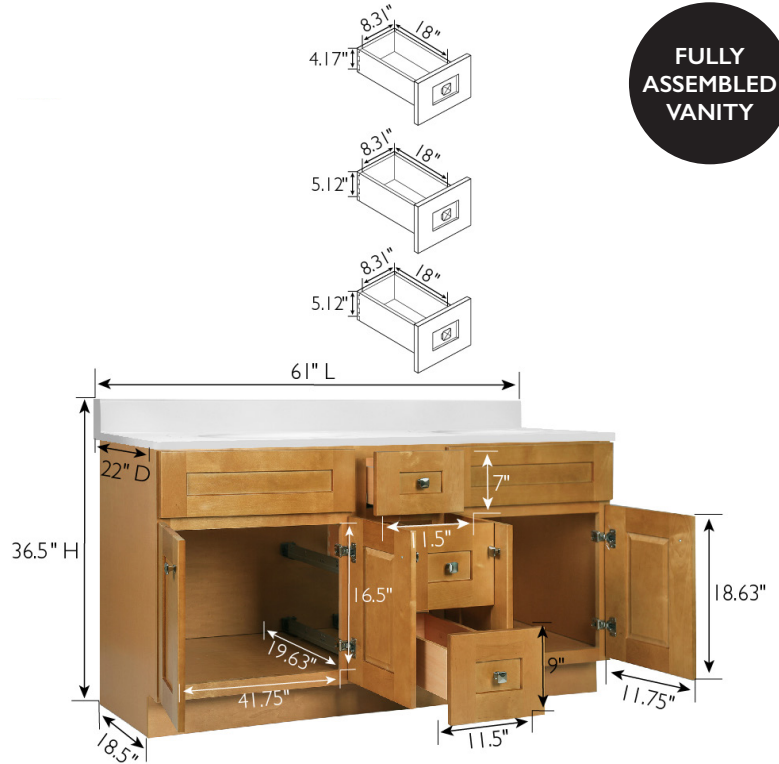

**FULLY
ASSEMBLED
VANITY**



SPECIFICATIONS

MATERIAL CONSTRUCTION:	Wood/Cultured Marble
ASSEMBLY REQUIRED:	No
ASSEMBLED DIMENSIONS:	36.5" H x 61" L x 22" D
ASSEMBLED WEIGHT:	172.35 lbs.
TOOLS NEEDED FOR INSTALLATION:	100% Silicone
CONSTRUCTION TYPE:	Face Frame
HINGE STYLE:	Soft Close
DOOR STYLE:	Shaker
DOOR MATERIAL:	HDF
DRAWER STYLE:	3 Drawers
DRAWER MATERIAL:	Solid Wood
GLIDE STYLE:	Soft Close
FAKE DWR STYLE:	N/A
DWR #1 DIMENSIONS:	4.17" H x 18" L x 8.31" D
DWR #2 DIMENSIONS:	5.12" H x 18" L x 8.31" D
DWR #3 DIMENSIONS:	5.12" H x 18" L x 8.31" D
DWR CONSTRUCTION:	Dove Tail
FACE FRAME MATERIAL:	Solid Wood
SIDES MATERIAL:	Plywood
BOTTOM MATERIAL:	Plywood

TOE KICK INSET WIDTH:	4.5"
BACK PANEL MATERIAL:	Plywood
BACK BRACE MATERIAL:	Solid Wood
FAUCET TYPE:	Lav Single Hole
NUMBER OF MOUNTING HOLES:	3
BOWL MATERIAL:	Cultured Marble
BACK SPLASH INCLUDED:	Yes
COLOR:	Solid White
NUMBER OF BOWLS:	1
BOWL DIMENSIONS:	5.63" H x 11.63" W x 16.85" D
BOWL SHAPE:	Oval
SINK THICKNESS:	1"
MOUNTING TYPE:	Single Hole
OVERFLOW HOLE:	Yes

WARRANTY:	1-Year limited warranty
TSCA TITLE IV COMPLIANT:	Yes
LEGAL FOR SALE IN CALIFORNIA:	Yes
PROP 65 HARMFUL MATERIAL:	Formaldehyde

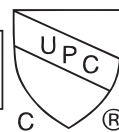

TYPE:
JOB:
ORDER CODE:
APPROVALS: