

AQUASPEC® FAUCETS

MODEL - Z82700 SERIES
SINGLE BASIN FAUCET



TECHNICAL INFORMATION

FLOW: 2.2 GPM [8.3 L] PRESSURE COMPENSATING AERATOR*

MAXIMUM PRESSURE: 125 PSI

MAXIMUM TEMPERATURE: 180°F

USES QUARTER TURN CERAMIC DISK CARTRIDGE

*OTHER AERATORS AVAILABLE BY REQUEST

IMPORTANT THE WATER SUPPLY LINES MUST BE THOROUGHLY FLUSHED BEFORE INSTALLATION TO PREVENT FOREIGN MATTER AND DEBRIS FROM CLOGGING AND/OR DAMAGING INTERNAL COMPONENTS AND THEREBY PREVENTING THE FAUCET FROM FUNCTIONING PROPERLY

INSTALLATION INSTRUCTIONS

1. REMOVE FAUCET BODY FROM CARTON AND PLACE RUBBER GASKET (#6A) ONTO SHANK OF FAUCET BODY.
2. PLACE FAUCET ON SINK THROUGH PRE-DRILLED MOUNTING HOLE IN SINK.
3. SECURE FAUCET TO SINK USING LOCKWASHER (#6B) AND MOUNTING NUT (#6C).
4. INSTALL HANDLE (#1C)
 - 4.1. PLACE HANDLE (#1C) ONTO CARTRIDGE STEM (#3) IN DESIRED ORIENTATION
 - 4.2. SECURE HANDLE WITH SCREW (# 1B)
 - 4.3. PRESS COLORED INDEX (#1A) INTO TOP OF HANDLE. INDEX MAY BE REMOVED BY PUSHING UP THROUGH HOLE IN UNDERSIDE OF HANDLE USING PAPER CLIP.
5. ATTACH LAVATORY SUPPLY TO SHANK OF FAUCET BODY (#4)
6. TURN SUPPLY WATER ON AND OPERATE FAUCET CHECKING FOR LEAKS.
7. INSTALL AERATOR INTO FAUCET AND HAND TIGHTEN INTO FAUCET SPOUT. IT MAY BE NECESSARY TO REMOVE AND CLEAN THE AERATOR AT START UP.

MAINTENANCE

1. YOUR ZURN FAUCET HAS A HIGHLY POLISHED NICKEL CHROME PLATED FINISH. CLEAN WITH SOAP AND WATER OR A MILD CLEANER WHICH IS SAFE FOR CHROME PLATING. DO NOT USE ACIDS OR TOILET BOWL CLEANER AS THEY WILL DAMAGE THE FINISH
2. AQUASPEC FAUCETS CONTAIN CERAMIC MIXING CARTRIDGES WHICH REQUIRE NO MAINTENANCE. TO REMOVE AND REPLACE THE CARTRIDGE:
 - 2.1. REMOVE HOT/COLD INDEX BUTTON (#1A) BY PRESSING UP THROUGH HOLE IN UNDERSIDE OF HANDLE (#1C)
 - 2.2. LOOSEN SCREW (#1B) HOLDING HANDLE ONTO STEM OF CARTRIDGE
 - 2.3. REMOVE HANDLE FROM CARTRIDGE STEM
 - 2.4. LOOSEN AND REMOVE HANDLE NUT (#2)
 - 2.5. PULL CERAMIC MIXING CARTRIDGE (#3) BY PULLING ON STEM WHILE ROCKING SLIGHTLY FROM SIDE-TO-SIDE
 - 2.6. INSTALL NEW CARTRIDGE (#3)
 - 2.7. REINSTALL HANDLE ASSEMBLY BY REVERSING STEPS 2.1 THROUGH 2.5

REPLACEMENT PARTS

SHORT COLD CERAMIC CARTRIDGE	59517001
HOT/COLD/TEMPERED COLOR CODED INDEXES	G60548

Metering Faucet Trouble Shooting Guide		
Problem	Cause	Solution
FAUCET LEAKS FROM UNDER FAUCET HANDLE. ALL SUPPLIES ARE ON.	HANDLE NUT TOO LOOSE	RE-TIGHTEN HANDLE NUT. DO NOT OVER TIGHTEN. TIGHTEN UNTIL NUT IS SNUG.
NO WATER COMES OUT OF FAUCET SPOUT. ALL SUPPLIES ARE ON.	AERATOR IS CLOGGED.	REMOVE AERATOR REMOVE DEBRIS AND REINSTALL AERATOR.
WATER DEFLECTS AT AN ANGLE FROM THE SPOUT	AERATOR HAS DEBRIS	REMOVE AERATOR REMOVE DEBRIS AND REINSTALL AERATOR.

Z82701 PICTURED

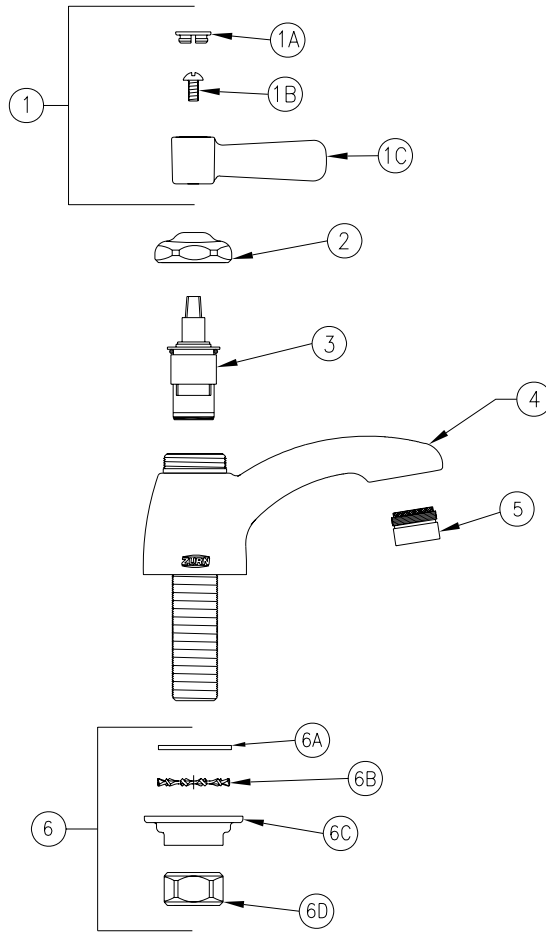

Z82701 PARTS LIST

Item	Part Number	Description	Qty.
1	G61071	2-1/2" Lever Handle	1
1A	G60548	Hot/Cold/Tempered Color-Coded Indexes	1
	59454001	Hot Color-Coded Index	1
	59454002	Cold Color-Coded Index	1
	59454003	Tempered Color-Coded Index	1
1B	62464001	10-32 Screw	1
1C	59487001	Lever Handle	1
2	59440001	Handle Nut	1
3	59517001	Short Cold Cartridge	1
4	60600001	Single Basin Body	1
5	G63505	13/16"-27 Male Aerator - 2.0 GPM	1
6	G63367	Mounting Hardware	1
6A	60549001	Gasket	1
6B	61613018	Lockwasher	1
6C	59530002	Mounting Nut	1
6D	59532001	1/2" [13mm] NPSM Riser Nut	1