

Model #: KD 1002

For  
Ages **6+**



# USE AND CARE GUIDE

## KIDS WHEELBARROW

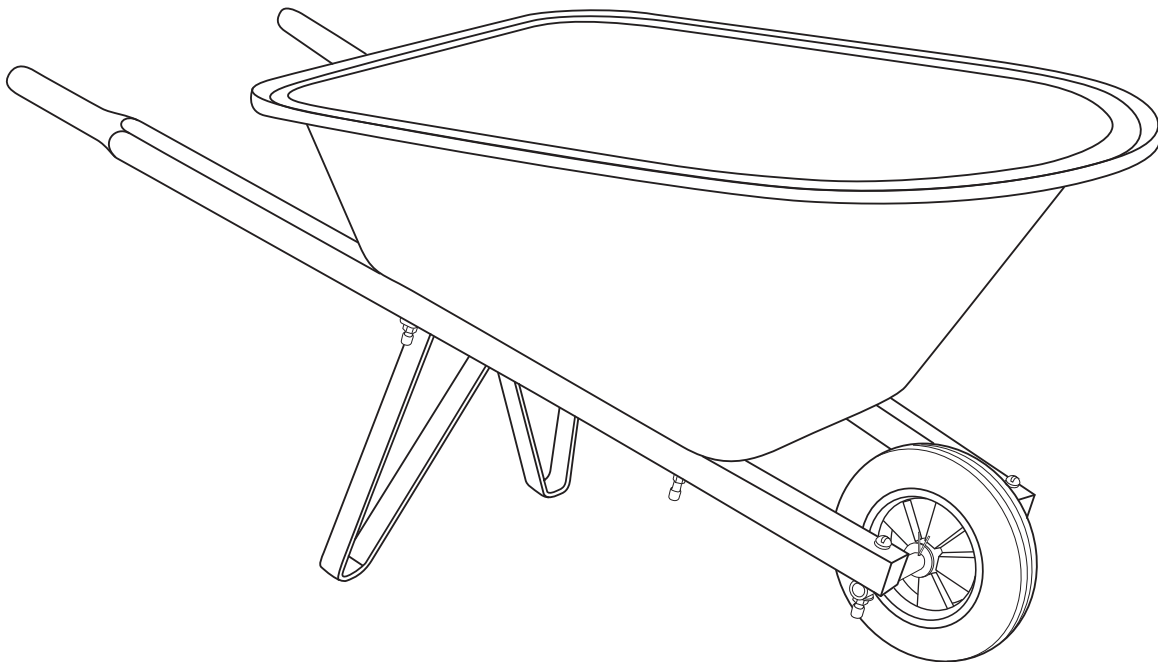

### ADULT ASSEMBLY AND SUPERVISION REQUIRED

Questions, problems, missing parts?  
Before returning to the store, call Corona Customer Service  
Mon - Fri, 7:30 AM - 4:30 PM PST

**(800) 847-7863**

**WWW.CORONATOOLSUSA.COM**

Retain this manual for future use.

# Safety Information



**DANGER:** Changing tires can be dangerous and should be done by trained personnel only.



**IMPORTANT:** Please read and understand this entire manual before beginning assembly or use of this product.

- Assembly by an adult.
- Wheelbarrow should be used by ages 6+ with the supervision of an adult.
- The wheelbarrow can tip easily, load only with soft and light materials, under 10 pounds and evenly distributed.
- If any parts become damaged, broken or misplaced, do not use the wheelbarrow until replacement parts can be obtained.

# Pre-Installation

## PLANNING INSTALLATION

Make sure all parts are present and correct.

## TOOLS REQUIRED



Large slotted screwdriver



10 mm wrench and/or ratchet and deep socket

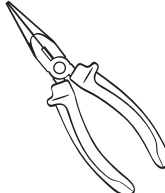

Needle nose pliers

## HARDWARE INCLUDED



**NOTE:** Hardware not shown to actual size.

Part	Description		Quantity
AA	13 mm Flat Washer		2
BB	Axle Split Pin		2
CC	6 mm Flat Washer		6
DD	6 mm Spring Shim		6
EE	5 mm Bolt		6
FF	Nut		6
GG	Red Cap		6

# Pre-Installation (continued)

## PACKAGE CONTENTS

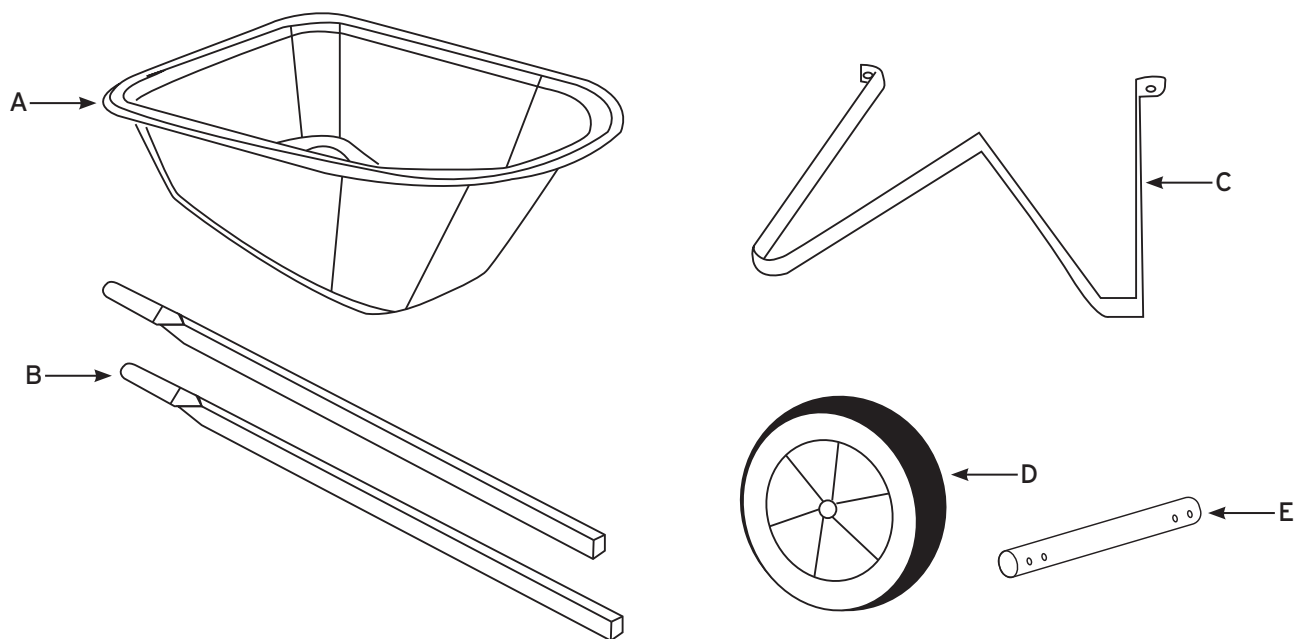

Part	Description	Quantity
A	Tray	1
B	Handle	2
C	Legs	1
D	Wheel	1
E	Axle	1

# Assembly

## 1 Attaching Handles and Legs



**RECOMMENDED:** All hardware should be installed only finger tight until wheelbarrow is completely assembled.

- Screw four 50 mm bolts (EE) into tray (A).
- Assemble handles (B) and legs (C) onto bolts. Be sure to orient the legs as shown.
- Tightening with washers (CC), spring shim (DD), nuts (FF) and cap (GG) as shown.

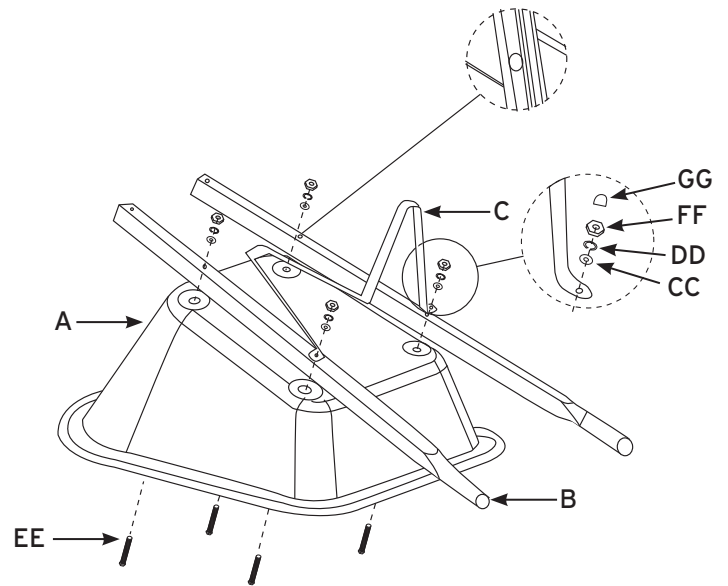

## 2 Attaching Wheel onto the Axle



**NOTE:** After placing the split pin in the bracket, secure it by bending the tips outward with needle nose pliers to keep it from falling out. See below.

- Insert axle (E) through wheel (D).
- Place a flat washer (AA) on either side of the wheel and securing to the axle (E) with split pin (BB) on each side.

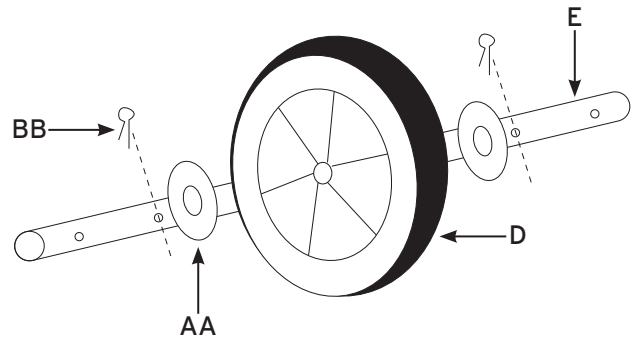

**Split Pin (BB)**  
Bend split pin tips outward

## Assembly (continued)

### 3 Attaching Axle to the Front of Handles



**NOTE:** The axle should be attached to the underside of the handles. DO NOT attach to the top of the handles

- Screw two 50 mm bolts (EE) into the ends of handle (B) and axle (E).
- Tightening with washers (CC), spring shim (DD), nuts (FF) and cap (GG) as shown.

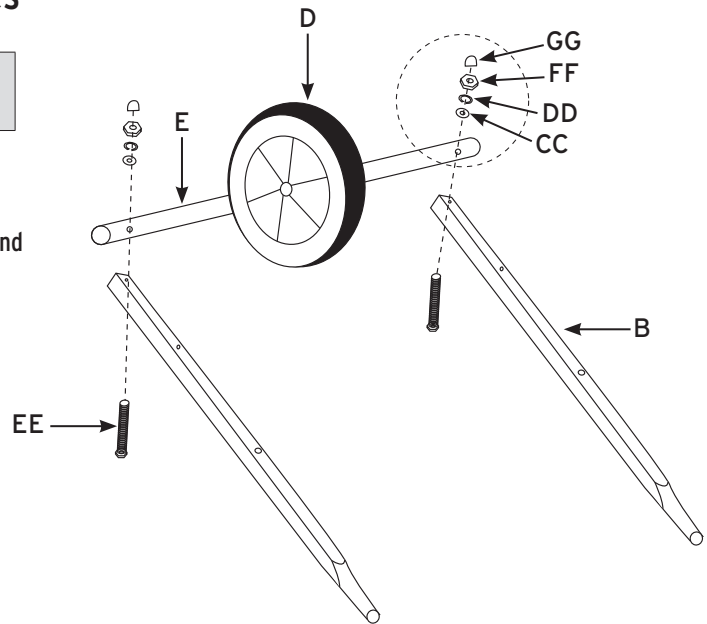

### 4 Tightening the Hardware

- Fully tighten all hardware prior to use.

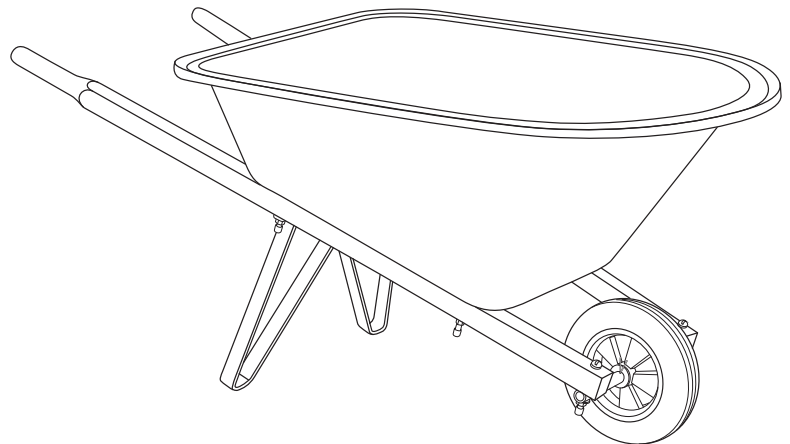

## Warranty

### 1-YEAR WARRANTY

For details, visit [coronatoolsusa.com/corona-cs-warranty](http://coronatoolsusa.com/corona-cs-warranty)