

Features

- Rounded glass shade joins pristinely with its decorative mount, creating an elegant simplicity
- A great piece for almost any space — master bathroom, guest bathroom, hallway, or bedside
- Integrated LED
- Suitable for damp locations, per UL 1598
- Includes installation hardware
- Coordinates with other products in the Crue collection

Material

- Manufactured with quality materials and complemented with a meticulous finishing process
- Durable finishes engineered to last and designed to coordinate with KOHLER faucet finishes

Installation

- Requires a 4" W (102 mm) x 1-1/2" D (38 mm) octagonal electrical outlet box



Codes/Standards



California Energy Commission (CEC)
UL 1598
CSA C22.2 No. 250.0
CA Title 24 JA8

KOHLER® Indoor Lighting Fixtures Limited Warranty

See website for detailed warranty information.

Available Colors/Finishes

Color tiles intended for reference only.

Color	Code	Description
	TTL	Titanium
	BNL	Brushed Nickel
	CPL	Polished Chrome
	BLL	Matte Black
	2GL	Brushed Moderne Brass

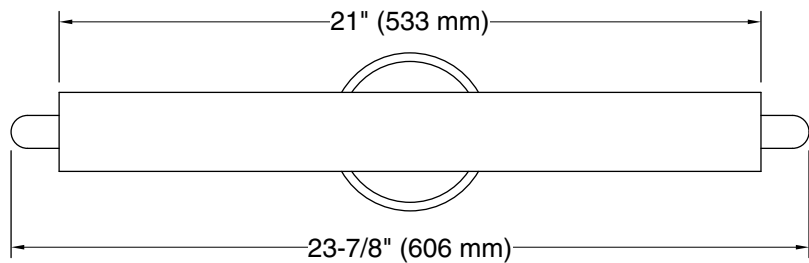
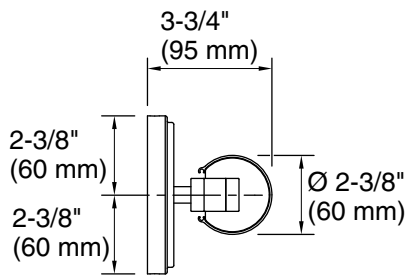

Technical Information

All product dimensions are nominal.

Material:	Polymer, Steel, Aluminum
Lighting Type:	Integrated LED
Socket Type:	LED Integrate
Number of Shades:	1
Shade Type:	Frosted Plastic
Hanging Type:	Non-hanging
CRI	>=90
Life Span	35000 Hours
Electrical component rating:	LED: 60 Hz, 23 W, 2087 Lumens

Notes

Install this product according to the installation instructions.