

# Ring Tongues - Non-Insulated Brazed Seam 22-18 AWG

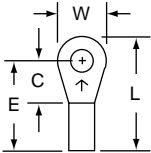

Product Number†	UPC (054007-)	Wire Range (AWG)	Stud Size	W	C	L	E	Thickness	Barrel Length	Barrel I.D.	Terminals per: Carton	Case
M18-4R/SX	49590	22-18	4	0.25	0.22	0.60	0.47	0.030	0.25	0.070	100	500
M18-4R/SK	01014	22-18	4	0.25	0.22	0.60	0.47	0.030	0.25	0.070	—	1000
M18-6R/SX	21635	22-18	6	0.25	0.22	0.60	0.47	0.030	0.25	0.070	100	500
M18-6R/SK	01016	22-18	6	0.25	0.22	0.60	0.47	0.030	0.25	0.070	—	1000
M18-8R/LX	21643	22-18	8	0.31	0.33	0.74	0.58	0.030	0.25	0.070	100	500
M18-8R/LK	01021	22-18	8	0.31	0.33	0.74	0.58	0.030	0.25	0.070	—	1000
M18-10R/LX	21650	22-18	10	0.31	0.33	0.74	0.58	0.030	0.25	0.070	100	500
M18-10R/LK	01023	22-18	10	0.31	0.33	0.74	0.58	0.030	0.25	0.070	—	1000
M18-14R/SX	49591	22-18	1/4	0.47	0.40	0.89	0.65	0.030	0.25	0.070	100	500
M18-14R/SK	01024	22-18	1/4	0.47	0.40	0.89	0.65	0.030	0.25	0.070	—	1000
M18-516R/SX	49592	22-18	5/16	0.47	0.40	0.82	0.65	0.030	0.25	0.070	100	500
M18-38RX	49593	22-18	3/8	0.56	0.40	0.93	0.65	0.030	0.25	0.070	100	500
M18-38RK	01028	22-18	3/8	0.56	0.40	0.93	0.65	0.030	0.25	0.070	—	1000



**M18-4R/S**  
Stud Size: 4  
Wire Range: 22-18

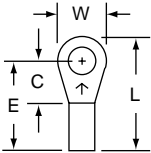

**M18-6R/S**  
Stud Size: 6  
Wire Range: 22-18

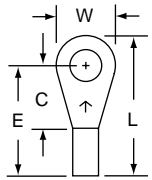

**M18-8R/L**  
Stud Size: 8  
Wire Range: 22-18

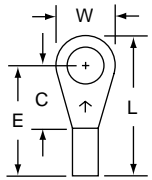

**M18-10R/L**  
Stud Size: 10  
Wire Range: 22-18

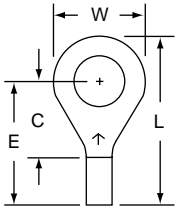

**M18-14R/S**  
Stud Size: 1/4  
Wire Range: 22-18

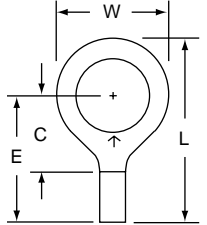

**M18-38R**  
Stud Size: 3/8  
Wire Range: 22-18

**Stud Size**  
**Wire Range**