

ASSEMBLY&INSTALLATION

Please read carefully and save these instructions,as you may need them a later date.

CAUTION

Turn off the main power at the circuit breaker before installing the fixture, in order to prevent possible shock.

GENERAL

All electrical connections must be in accordance with local and National Electrical Code(N.E.C) standards. If you are unfamiliar with proper electrical wiring connections obtain the services of a qualified electrician.

Remove the fixture and the mounting package from the box and make sure that no parts are missing by referencing the illustrations on the installation instructions.

ASSEMBLY AND INSTALLATION

1. Carefully unpack the fixture, lay out all parts on a clean surface.
2. Thread two mounting screws (12) through the mounting plate (1) and secure with the hex nut (19).
3. Attach the mounting plate (1) with box screw (3) to the outlet box (2).
4. Pull out the outlet wire and ground wire from the outlet box, make wire connections with wire nuts (10) as follow:
 - Connect the smooth-coated wire (w marking) or Black wire (8) from fixture to the Black wire (5) from power source.
 - Connect the ribbed-coated wire (w/o marking) or White wire (9) from fixture to the White wire (6) from power source.
 - Attach the fixture ground wire (7) to mounting plate (1) with the ground screw (16). Connect it to the house ground wire (4) with the wire nut (10).
5. Align the back plate (11) to the outlet box (2), secure it to the mounting plate (1) with the mounting screws (12), and screw it with the ball nut (20).
6. Unscrew the socket ring (15) (17) from socket (11). Set glass shade (14) onto socket (13) and secure with socket ring (15). Set glass shade (16) onto bottom socket (13) and secure with socket ring (17).
7. Install the bulbs (not included). Make sure they do not exceed the maximum wattage specified on the fixture's wattage rating label.
8. Turn on the power.

INSTALLATION IS NOW COMPLETED

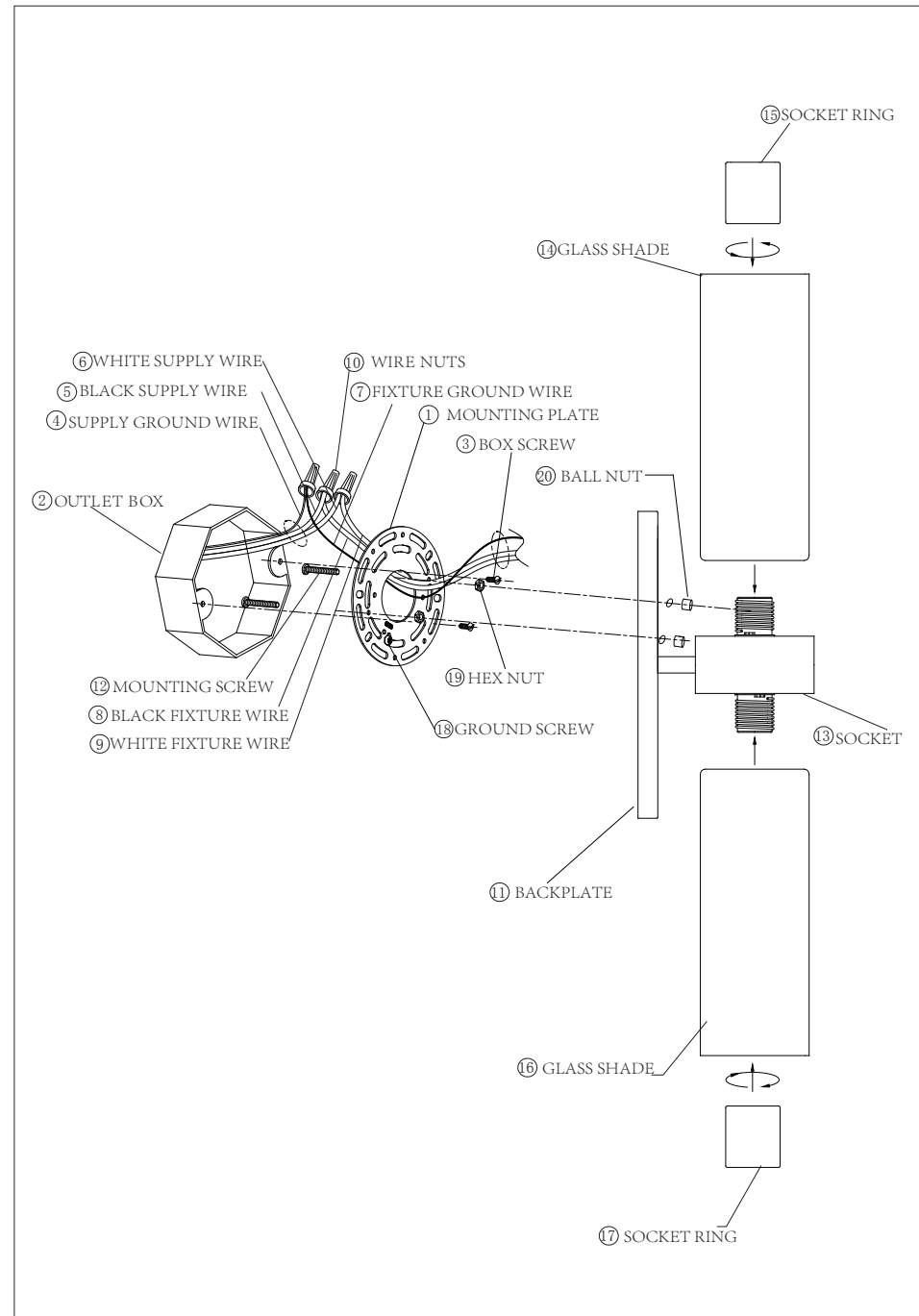

ITEM NO.: 15102