

# INSTRUCTION MANUAL

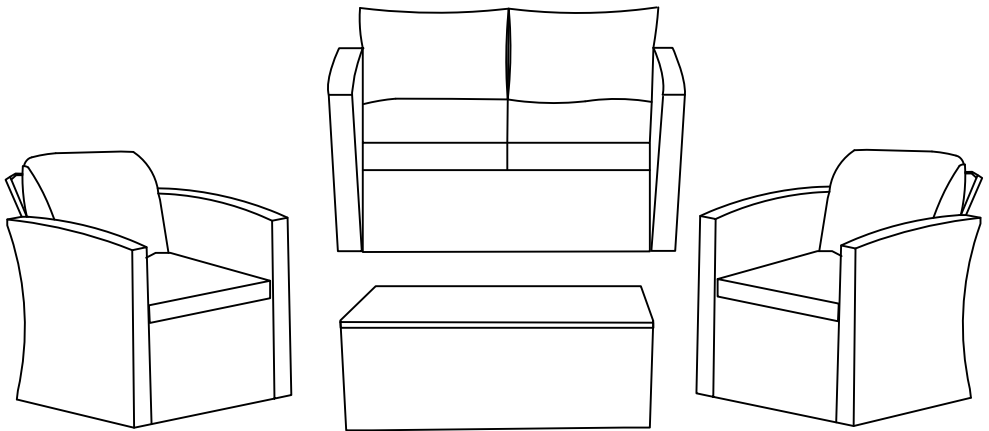

**4 Piece Rattan Seating Group  
with Cushion  
SKU: OP113**

V1.0

## ! NOTICE

### Do not overtighten screws. (Insert all screws before tighten screws.)

- Please do not exceed the weight limitations of this item.
- Do not stand on or use any part of this item as a step ladder.
- Firmly secure all bolts, screws and nuts before use.
- Reconfirm that all bolts, screws, and nuts are secure every 90 days.
- Do not use or store this item in the proximity of open flame or flammable/combustible chemicals.
- Be aware that some parts are heavy and have sharp edges.

## TOOLS REQUIRED



ALLEN WRENCH  
(PROVIDED)



CHAIR  
330 LBS  
CAPACITY



LOVESEAT  
660 LBS  
CAPACITY



TABLE  
110 LBS  
CAPACITY



2 PERSONS  
ASSEMBLY



UP TO 60 MIN.  
ASSEMBLY

## HARDWARE

1

M6 x 40MM  
BOLT



30 PCS

2

M6 x 35MM  
BOLT



22 PCS

3

M6 x 25MM  
BOLT



2 PCS

4

M6 WASHER



52 PCS

5

ALLEN  
WRENCH

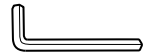

1 PC

6

M6  
THREADED PIN



6 PCS

7

SPACER



2 PCS

## PARTS

A

CHAIR SEAT

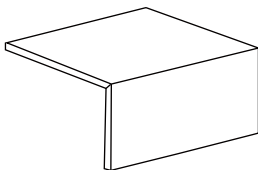

2 PCS

B

CHAIR BACKREST

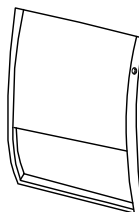

2 PCS

C

LOVESEAT TOP

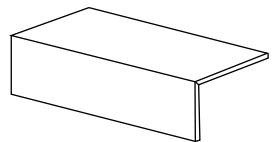

1 PC

## PARTS

**D**

LOVESEAT BACKREST

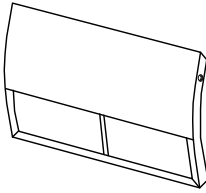

1 PC

**E**

CHAIR LEFT SIDE

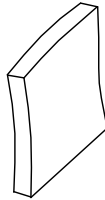

3 PCS

**F**

CHAIR RIGHT SIDE

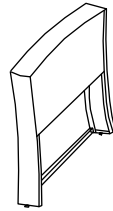

3 PCS

**G**

TABLE LEG - LEFT

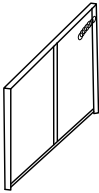

1 PC

**H**

TABLE LEG - RIGHT

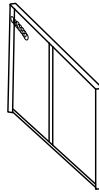

1 PC

**I**

TABLE TOP

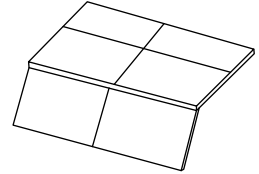

1 PC

**J**

TABLE BASE

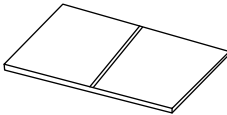

1 PC

**K**

TABLE RAIL

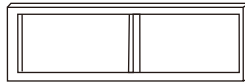

1 PC

**L**

LINING

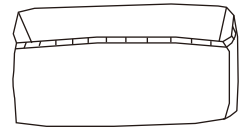

1 PC

## CUSHION

**Z1**

BACK CUSHION

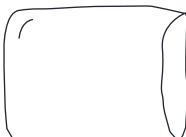

4 PCS

**Z2**

SEAT CUSHION

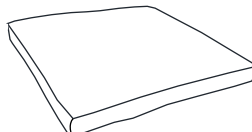

4 PCS

## PRODUCT ASSEMBLY - CHAIR

1

Attach part A Chair Seat to part B Chair backrest with 2 PCS of part 1 Bolt and part 4 Washer.

Do not tighten screws too much at this stage.

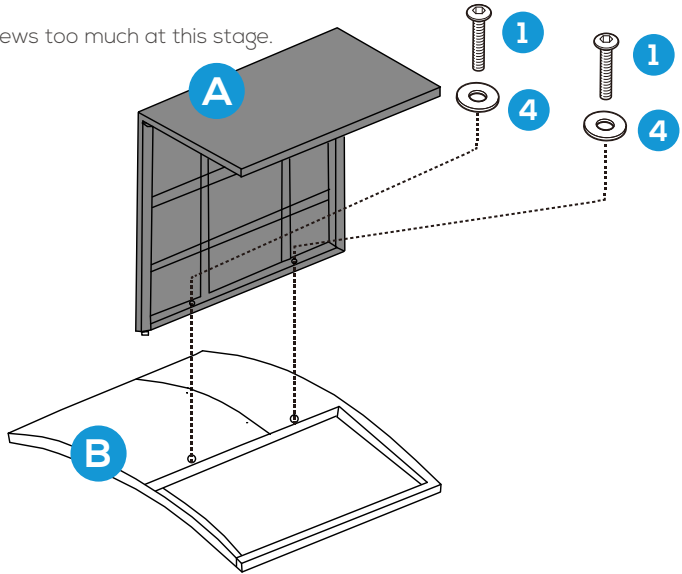

2

Attach part A Chair Seat and part B Seat Backrest to part F Chair Right Side with 4 PCS of part 1 Bolt and 1 PC of part 2 Bolt as well as 5 PCS of part 4 Washer as below.

Screw part 6 Threaded pin into the hidden nut firstly before this step.

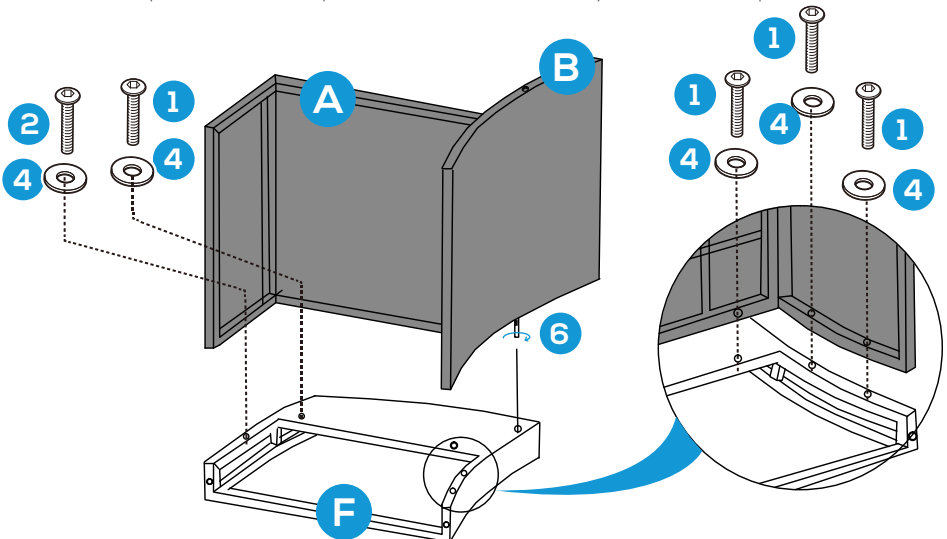

## PRODUCT ASSEMBLY - CHAIR

**3**

Attach the combined part (A+B+F) part E Chair Left Side with 4 PCS of part 1 Bolt and 1 PC of part 2 Bolt as well as 5 PCS of part 4 washer as below.

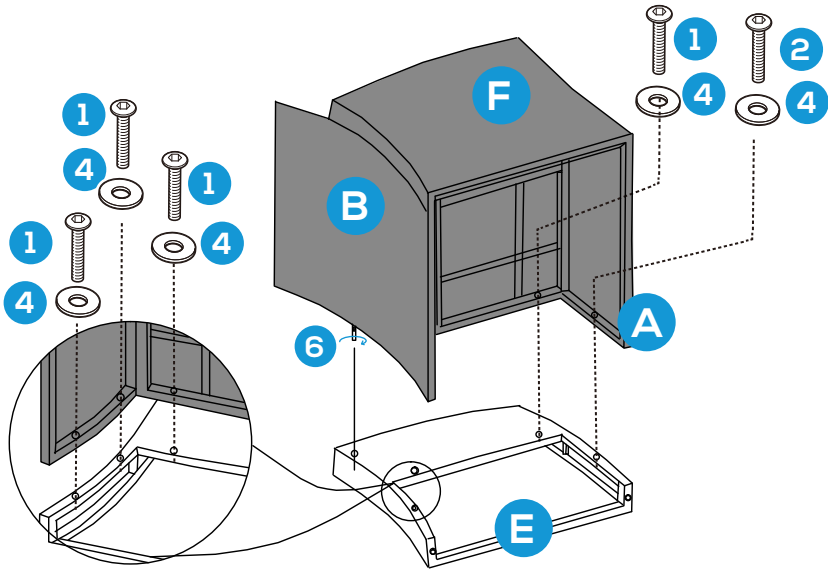

**4**

Tighten all bolts again to ensure the Chair is stable enough to use.

Place 1 PC of part Z2 Seat Cushion and 1 PC of part Z1 Back Cushion into the chair to finish the assembly.

Do the same to assemble another chair.

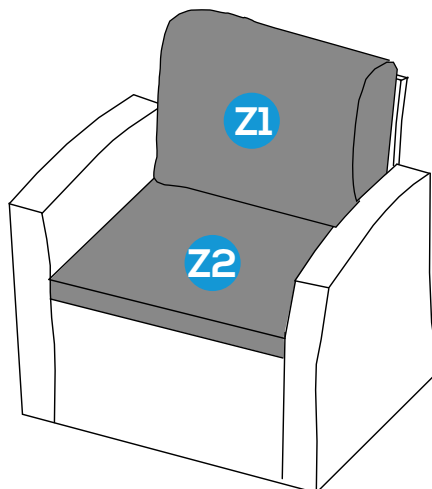

## PRODUCT ASSEMBLY - LOVESEAT

5

Attach part C Loveseat Top to part D Loveseat Backrest with 3 PCS of part 1 Bolt and part 4 Washer.

Do not tighten screws too much at this stage.

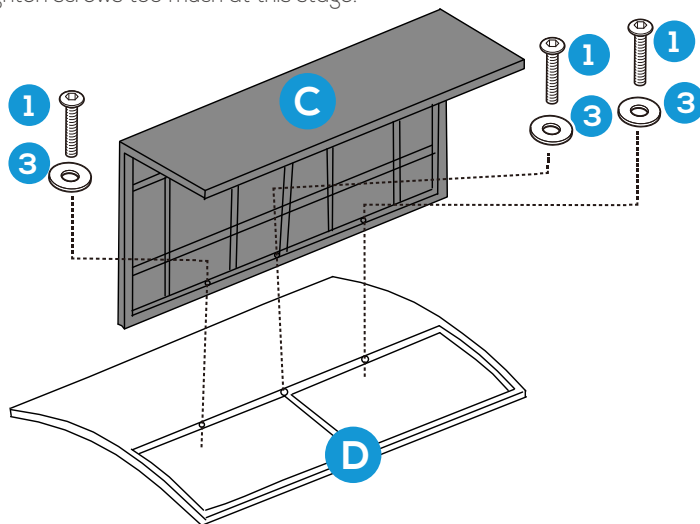

6

Attach part C Loveseat Top and part D Loveseat Backrest to part F Chair Right Side with 4 PCS of part 1 Bolt and part 2 Bolt as well as 4 PCS of part 4 Washer as below.

Screw part 6 Threaded pin into the hidden nut firstly before this step.

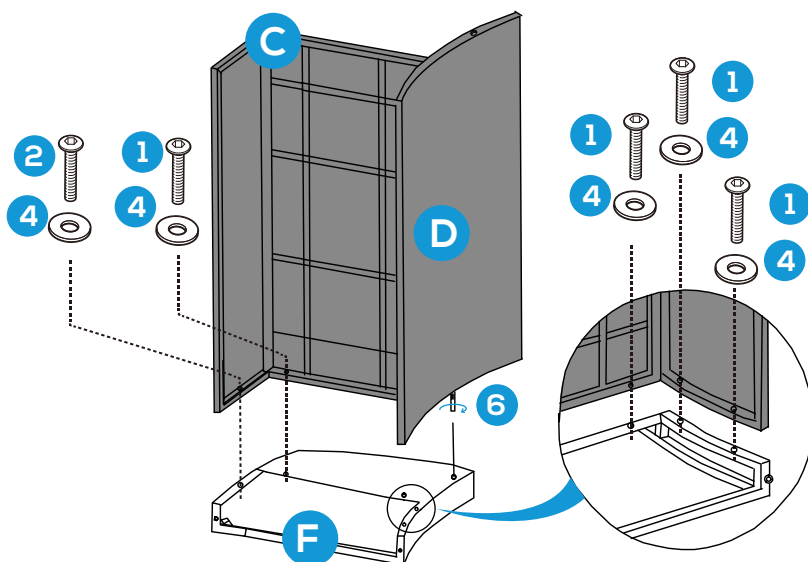

## PRODUCT ASSEMBLY - LOVESEAT

7

Attach the combined part (C+D+F) to part E Chair Left Side with 4 PCS of part 1 Bolt and 1 PC of part 2 Bolt as well as 5 PCS of part 4 Washer.

Screw part 6 Threaded pin into the hidden nut firstly before this step.

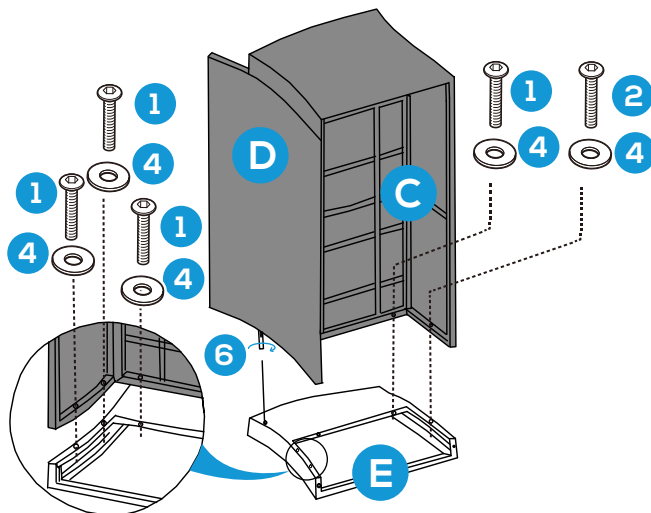

8

Tighten all bolts again to ensure this Loveseat is stable enough to use.

Place 2 PCS of part Z2 Seat Cushion and part Z1 Back Cushion into the loveseat to finish the assembly.

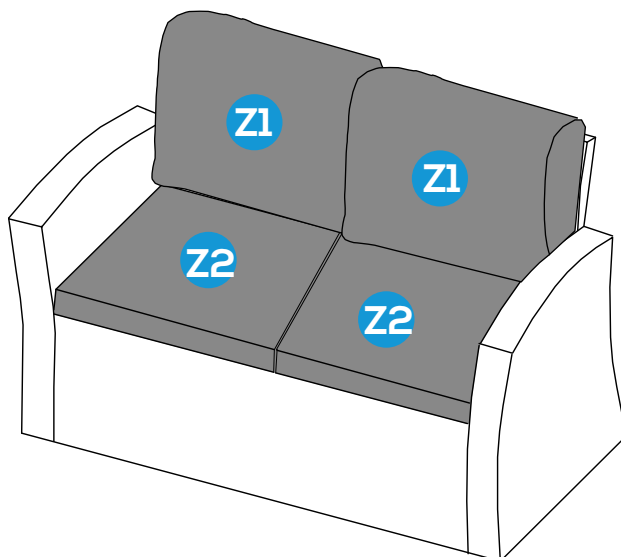

## PRODUCT ASSEMBLY - COFFEE TABLE

9

Attach part G and H Table Legs to part I Table Top with 4 PCS of part 2 Bolt and part 4 Washer.

Do not tighten screws too much at this stage.

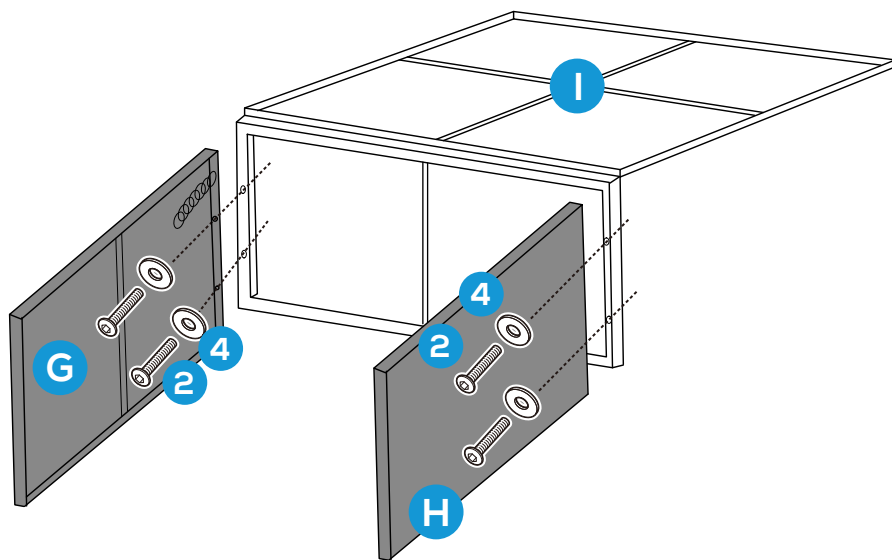

10

Attach part J Table Base to part G and H Table Legs with 6 PCS of part 2 Bolt and part 4 Washer.

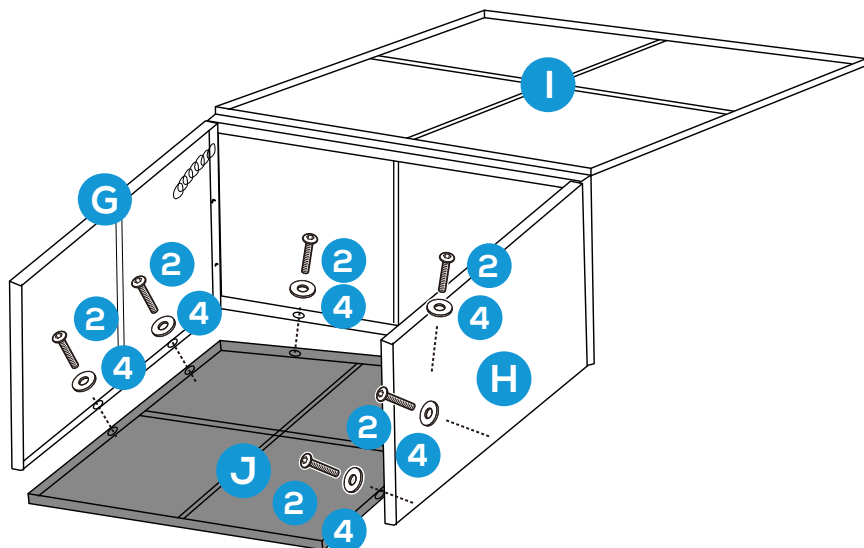



## PRODUCT ASSEMBLY - COFFEE TABLE

11

Attach part K Table Rail to part G and H Table Legs and part J Table base with 6 PCS of part 2 Bolt and part 4 Washer.

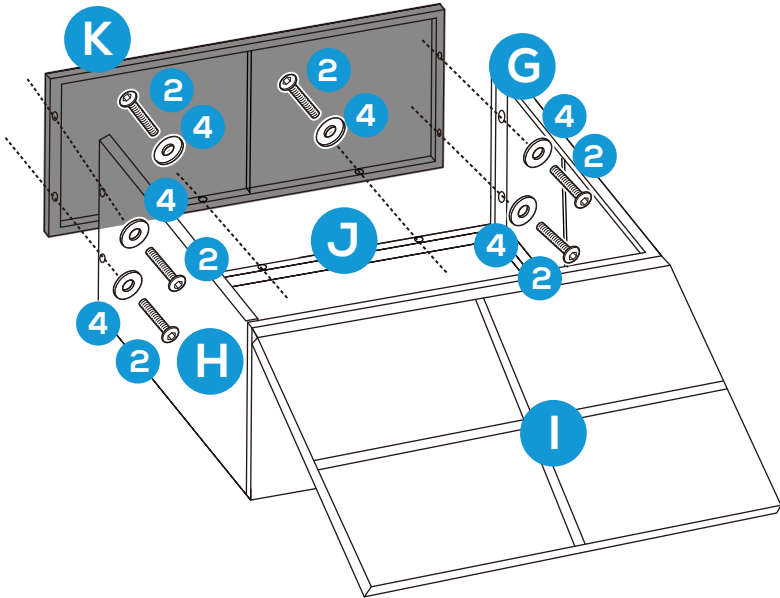

12

Attach the chain to Table Top with 2PCS of part 3 Bolt and part 7 Spacer and attach the Lining into the table with velcro.

Close the Table top to convert it to a Coffee Table while open it as a storage box.

The assembly finishes.

