

# INSTRUCTIONS FOR KANNAD SAFELINK SOLO

## How to Fit an Kannad Safelink Solo to the Atlas 190 UML Life Jacket

These instructions will guide you through fitting your device into an Atlas lifejacket. Follow each step carefully to ensure it functions safely and correctly. Handle the lifejacket and all device components with care to avoid damage during installation. "These instructions will guide you through fitting your device into an Atlas lifejacket. Follow each step carefully to ensure it functions safely and correctly. Handle the lifejacket and all device components with care to avoid damage during installation.

Many users of this PLB carry the device in a jacket or snug pocket. However, a tether should always be used to prevent loss at sea.

Refer to Fig. 8 for guidance on securing the device to your lifejacket after activation.

### Before You Begin

Make sure you're familiar with how your Personal Locator Beacon (PLB) works. If unsure, please refer to your Original Equipment Manufacturer's (OEM) manual.

You will need a flat surface to work on.

### Step 1: Attach the Cord

Thread the cord from the device's carrying case through the float case and then to the device. Use bowline knots to secure the connection (*Fig. 1a*). Ensure the cord is at least 46 cm (18.25 in) in length (*Fig. 1b*).

**Note:** The cord may not be included with your device—check before beginning.

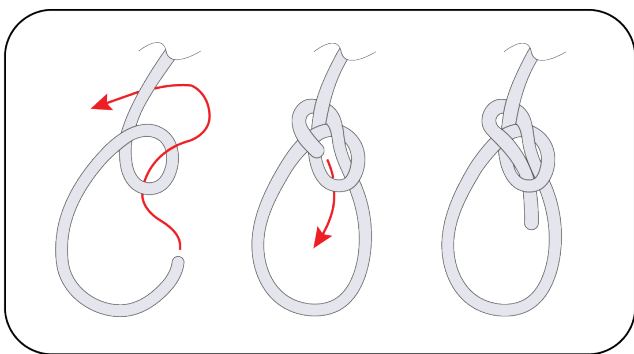

*Fig 1a*

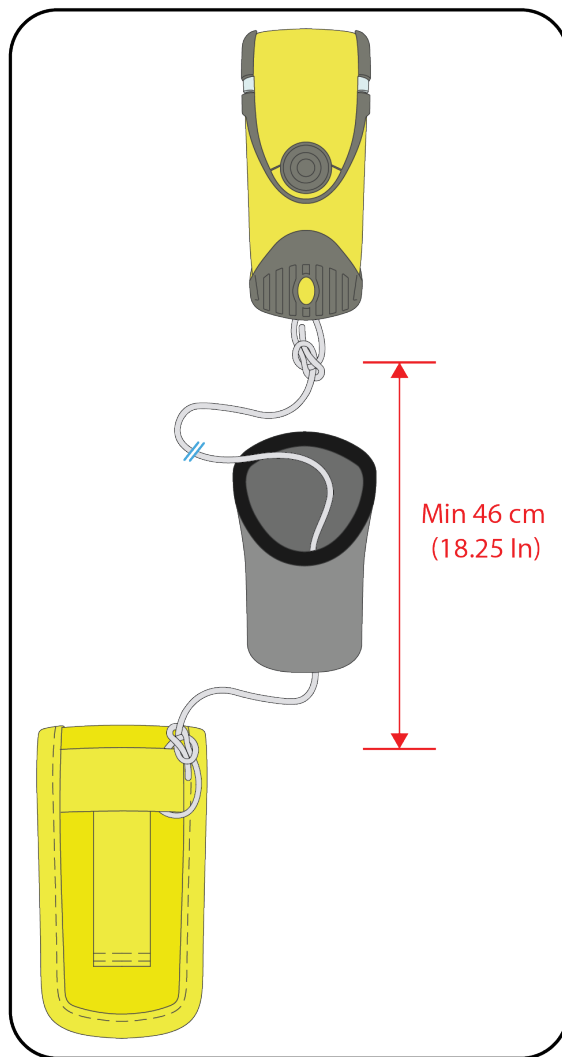
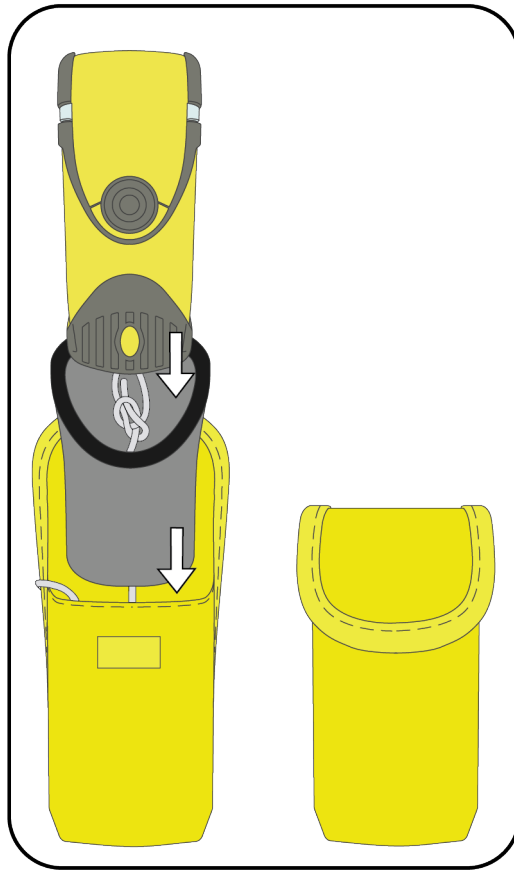

*Fig 1b*

## Step 2: Pack the Device

Place the device securely into its carrying and float cases as shown.

(Fig. 2)

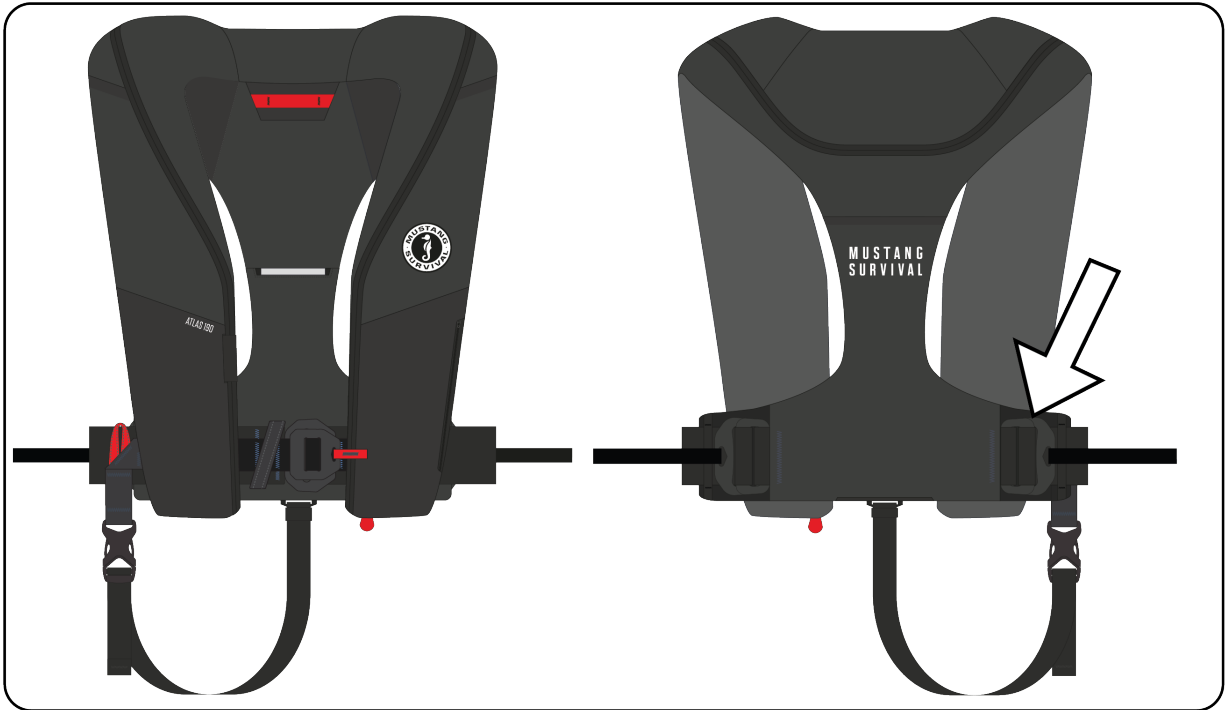

*Fig 2*

### **Step 3: Locate the Back Webbing Adjuster**

Find the back webbing adjuster on your lifejacket—it will be on the side opposite the inflator.

*(Fig. 3)*



*Fig 3.*

#### **Step 4: Unthread the Waist Belt**

Unthread the waist belt from the adjuster as shown.

*(Fig. 4)*

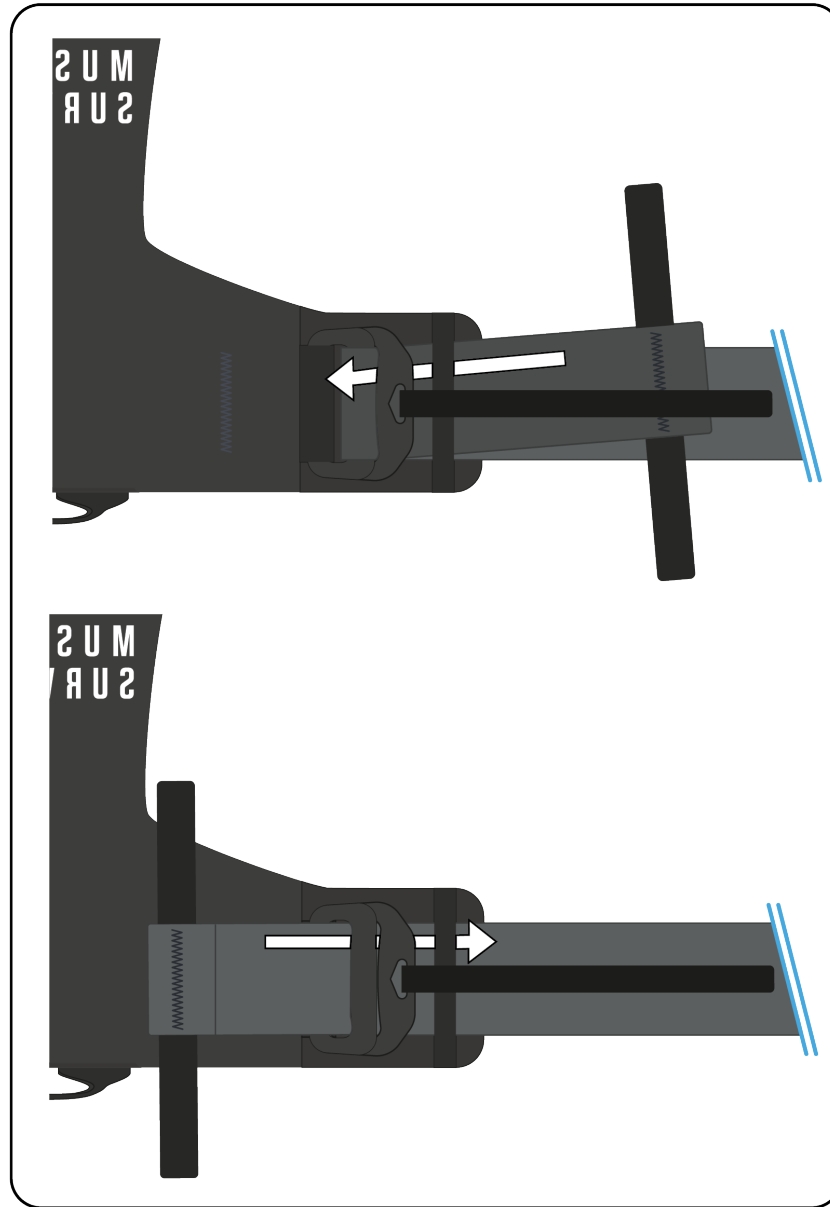
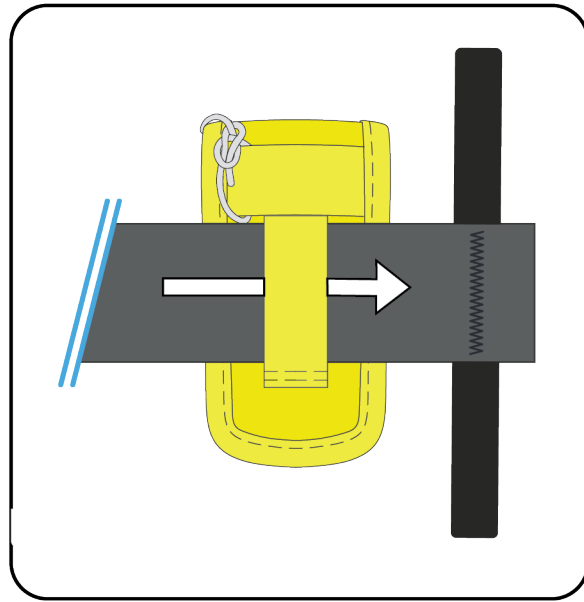

Fig 4.

### Step 5: Thread the Waist Belt

Pass the waist belt through the slot on the device's carrying case, as shown.

(Fig. 5)



*Fig 5*

### Step 6: Secure the Waist Belt

Re-thread the webbing through the back waist adjuster (*Fig 6.*)

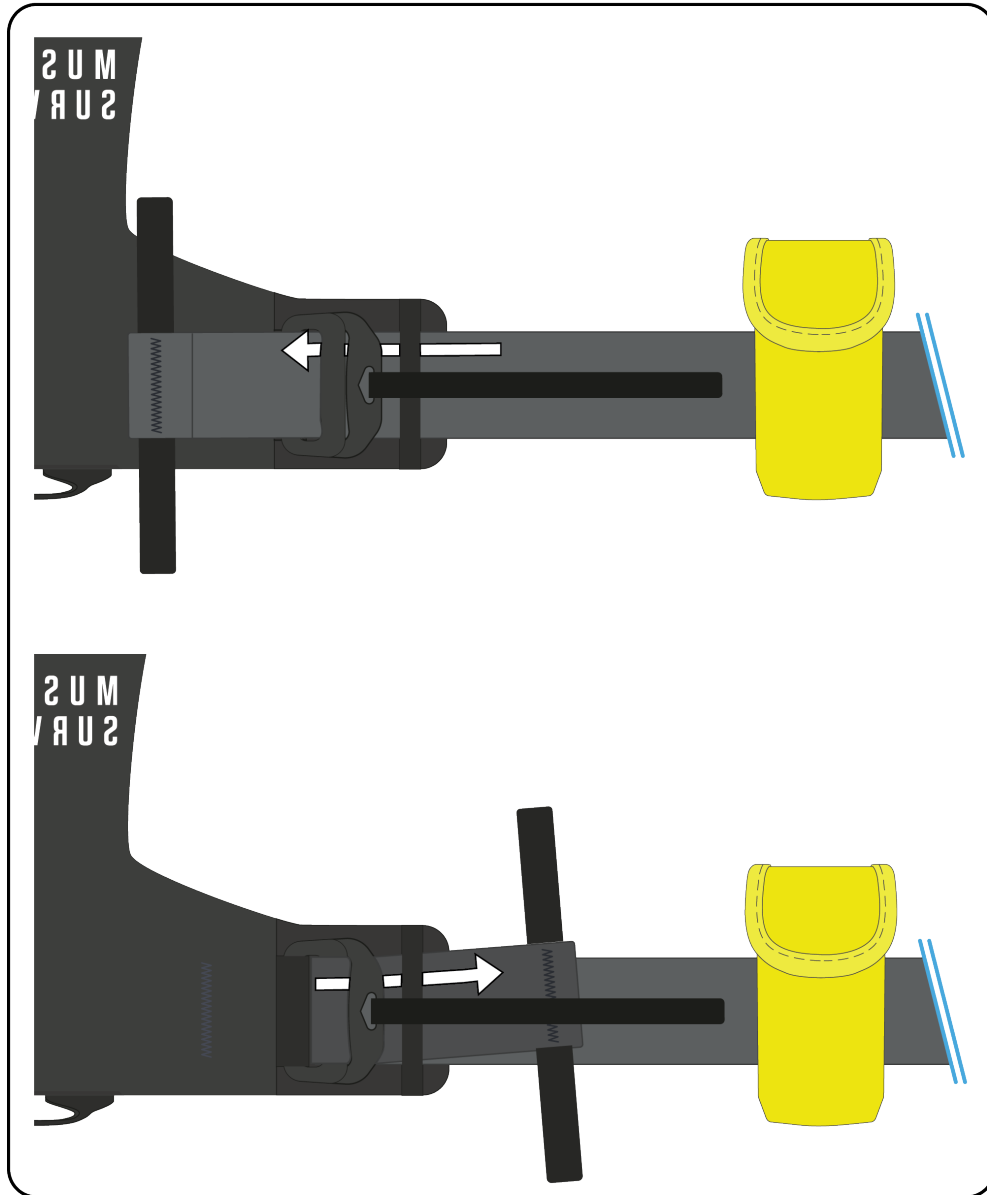

*Fig 6*

### Step 7: Final Check and Label

Your lifejacket is now equipped with your PLB. To complete the process, mark the label tucked into the center back panel with "PLB fitted". (*Fig. 7*)

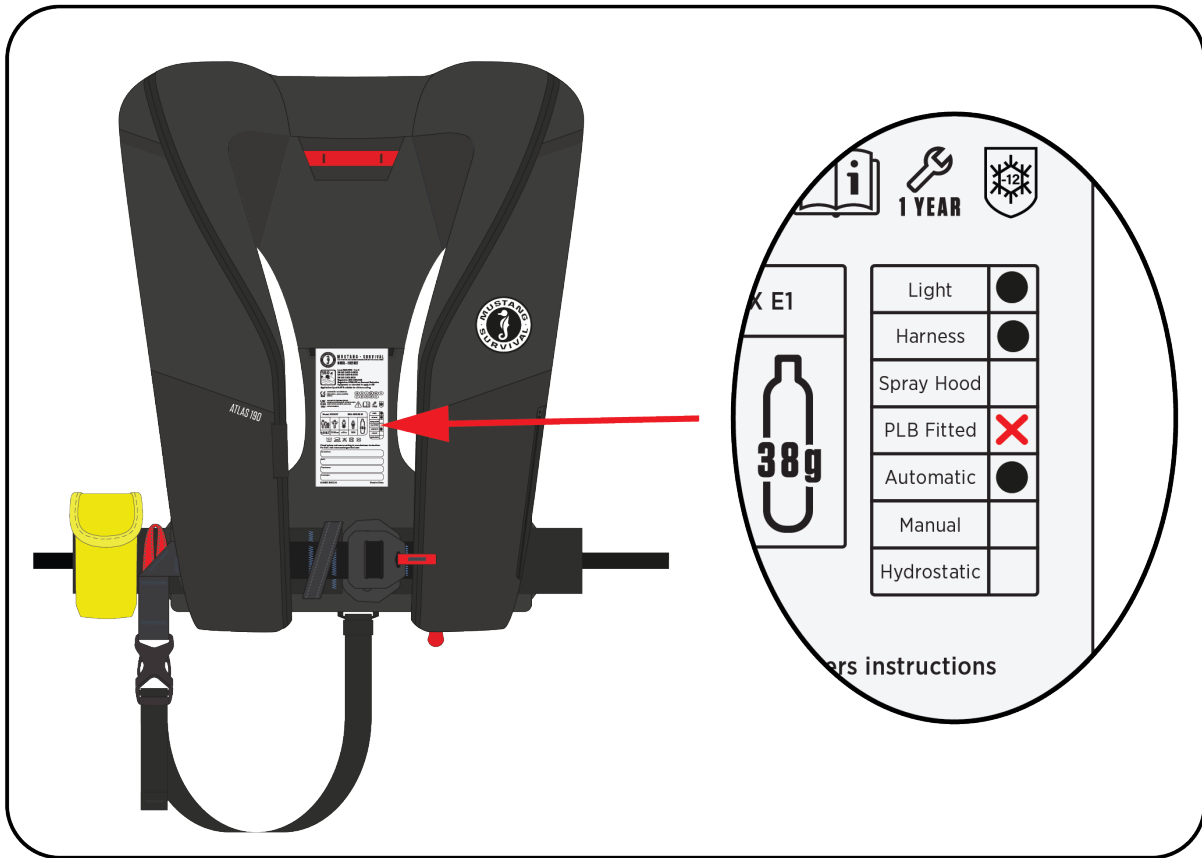

Fig 7

### Step 8: Device Activation

If the device needs to be activated, follow the instructions provided in the OEM (Original Equipment Manufacturer) manual. Once fully activated, tuck the device behind the bladder panel that holds the light.

(Fig. 8)



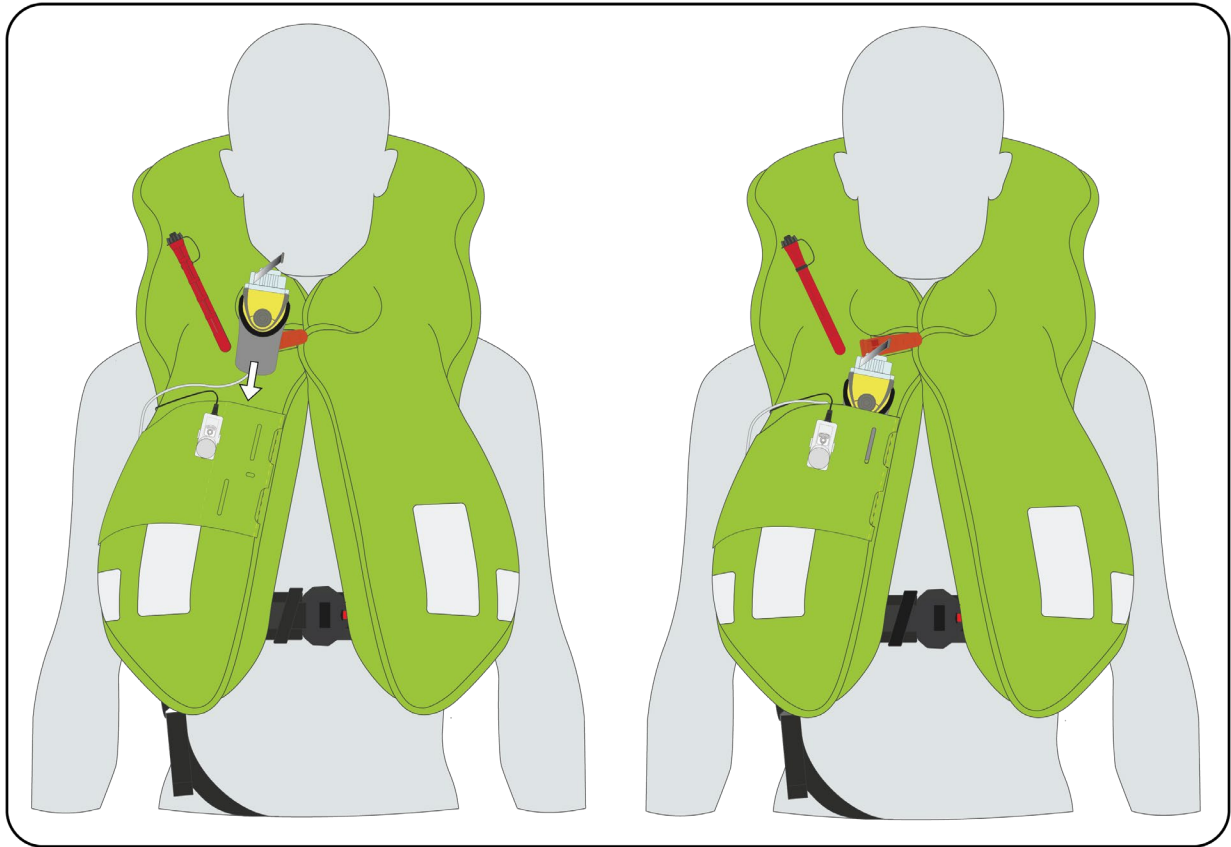

Fig 8