

# IMPORTANT SAFETY INSTRUCTIONS

When using electrical products, basic precautions should always be practiced including the following:

1. READ AND FOLLOW ALL SAFETY INSTRUCTIONS.
2. Maximum ambient temperature around the adapter must not exceed 40°C.
3. Read and follow all instructions that are on the product or provided with the product.
4. Use only power supplies that are certified according to the relevant safety standards UL1310
5. The output power taken from the power supply must not exceed the rating given on the adapter.
6. Unplug from outlet before installing the product.
7. Do not use in a bathroom.
9. This product is NOT a toy.
10. Do not open the product. Use only as intended.
11. Do not roll up the product when using. Spread out to full length before connecting power supply.
12. Do not operate if any component is damaged.

## SAVE THESE INSTRUCTIONS

This manual contains important safety and operating instructions to power the unit.

## CAUTION:

Dispose of used battery promptly according to local recycling or waste regulations. Clean battery contacts and also device contacts prior to installing battery. Ensure the battery is installed correctly with regard to polarity (+ and -). Remove battery from remote when not being used for an extended period of time. Remove used battery promptly. The LEDs in this strip light are not replaceable.

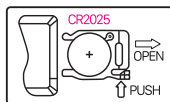

**USES 1 3V, TYPE CR2025 BATTERY**

### WARNING - KEEP BATTERIES OUT OF THE REACH OF CHILDREN.

- Remove immediately recycle or dispose of used batteries according to local regulations and keep away from children. Do NOT dispose of batteries in household trash or incinerate.
- Even used batteries may cause severe injury or death.
- Call a local poison control center for treatment information if needed.
- Always purchase the correct size and type of battery most suitable for the intended use.
- Non-Rechargeable batteries are not to be recharged.
- Do not force discharge, recharge, disassemble, heat above 45°C/113°F or incinerate. Doing so may result in injury due to venting, leakage or explosion resulting in chemical burns.
- Ensure the batteries are installed correctly with regard to polarity (+ and -).
- Do not mix old and new batteries, different brands or types of batteries, such as alkaline, carbon-zinc, or rechargeable batteries.
- Remove and immediately recycle or dispose of batteries from equipment not used for an extended period of time according to local regulations.
- Always completely secure battery compartment. If battery compartment does not close securely, stop using the product, remove the batteries, and keep them away from children.

## WARNING

- **INGESTION HAZARD:** This product contains a button cell or coin battery.
- **DEATH** or serious injury can occur if ingested.
- A swallowed button cell or coin battery can cause **Internal Chemical Burns** in as little as **2 hours**.
- **KEEP** new and used batteries **OUT OF REACH of CHILDREN**
- **Seek immediate medical attention** if a battery is suspected to be swallowed or inserted inside any part of the body.



### PARTS INCLUDED:

**NOTE:** Parts not shown to actual size.

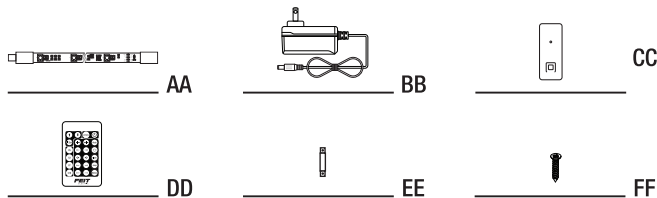

Part	Description	Quantity
AA	20 ft. Tape Light	1
BB	Power Supply	1
CC	Control Module	1
DD	Remote	1
EE	Mounting Clips	10
FF	Screws	20

**LIMITED WARRANTY.** This product is warranted to be free from defects in workmanship and materials for up to 1 year from date of purchase. If the product fails within the warranty period, please contact Feit Electric at [feit.com/help](http://feit.com/help). REPLACEMENT OR REFUND IS YOUR SOLE REMEDY. EXCEPT TO THE EXTENT PROHIBITED BY APPLICABLE LAW, ANY IMPLIED WARRANTIES ARE LIMITED IN DURATION TO THE DURATION OF THIS WARRANTY. LIABILITY FOR INCIDENTAL OR CONSEQUENTIAL DAMAGES IS HEREBY EXPRESSLY EXCLUDED. Some states and provinces do not allow the exclusion of incidental or consequential damages, so the above limitation or exclusion may not apply to you. This warranty gives you specific legal rights, and you may also have other rights which vary from state to state or province to province.

MODEL: TAPE240/CHASE

**FEIT**  
ELECTRIC

Chasing RGBW - 20 FT

# LED Tape Light

## Quick Install Guide

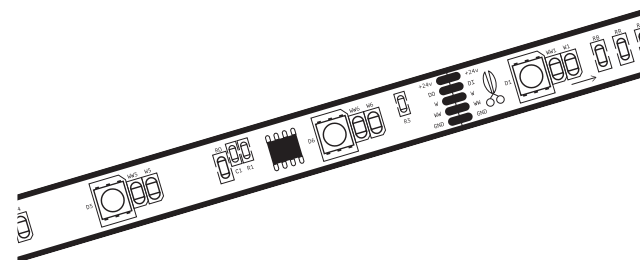

### INDOOR AND OUTDOOR USE

**Supplier's Declaration of Conformity:**

47 CFR § 2.1077

Compliance Information

**Responsible Party:**

Feit Electric Company

4901 Gregg Road,

Pico Rivera, CA 90660, USA

Unique Identifier: TAPE240/CHASE

### ELECTRICAL RATINGS:

LUMENS: 1000

WATTS: 24W MAX

VOLTS: 24VDC

KELVIN: 2700K-6500K+ RGB

CURRENT: 0.6A MAX

DO NOT USE WITH DIMMERS

MADE IN CHINA

This device complies with part 15 of the FCC Rules. Operation is subject to the following two conditions: (1) This device may not cause harmful interference, and (2) this device must accept any interference received, including interference that may cause undesired operation. Note: This equipment has been tested and found to comply with the limits for a Class B digital device, pursuant to part 15 of the FCC Rules. These limits are designed to provide reasonable protection against harmful interference in a residential installation. This equipment generates, uses and can radiate radio frequency energy and, if not installed and used in accordance with the instructions, may cause harmful interference to radio communications. However, there is no guarantee that interference will not occur in a particular installation. If this equipment does cause harmful interference to radio or television reception, which can be determined by turning the equipment off and on, the user is encouraged to try to correct the interference by one or more of the following measures: Reorient or relocate the receiving antenna. Increase the separation between the equipment and receiver. Connect the equipment into an outlet on a circuit different from that to which the receiver is connected. Consult the dealer or an experienced radio/TV technician for help. Any changes or modifications not expressly approved by the manufacturer could void the user's authority to operate the equipment. [www.feit.com](http://www.feit.com).

# Getting Started:

**WARNING:** These products may represent a possible shock or fire hazard if improperly installed or attached in any way. Products should be installed in accordance with this install guide, current electrical codes and/or the current National Electric Codes.

## CAUTION:

1. Use only insulated staples or plastic ties to secure cords.
2. Route and secure cords that they will not be pinched or damaged when furniture is pushed to the wall.
3. When mounting lights on furniture ensure product caution remains visible
4. Not intended for recessed installation in ceilings.
5. Electrical codes do not permit cords to be concealed where damage to insulation may go unnoticed.

To prevent fire danger, do not run cord behind walls, ceilings, soffits, or cabinets where it may be inaccessible for examination. Cords should be visually examined periodically and immediately replaced when any damage is noted. This product will not operate properly when connected to a dimmer or dimming control.

## 1

### Connect the Controller Module

Connect the strip light to the controller module then connect the plug as shown in the image below.

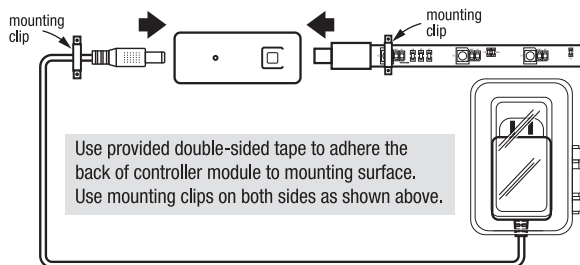

- Connect power supply to wall outlet.
- Use the included controller to control the tape light.
- Make sure you are pointing towards the control module as the product is IR.

**Note:** When using outdoors, plug the unit into an appropriately rated GFCI receptacle with cover.

If you are connecting two strip lights, use the included foam tape to secure male connector to mounting surface.



## 2

### Prepare the Strip Light

- Measure the desired length before installation.
- Clean the mounting area thoroughly (surface must be free of dust, dirt or grease).
- Avoid bending the strip light which may damage the LEDs.
- Avoid removing and relaying the strip light multiple times as the adhesive may wear off.



Do not bend at LED

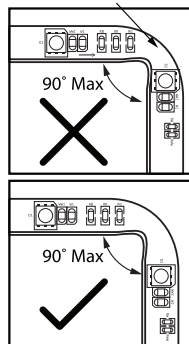

## 3

### Mount the Strip Light

Unroll strip light and place near mounting location. Ensure power supply and controller can reach to the start of the strip light. Do not connect to power yet.

- Peel adhesive tape from back of strip light to position strip light on mounting surface.
- Screw in mounting clips (required for all long term installations). Save two clips to use for installing the controller module (Step 4).

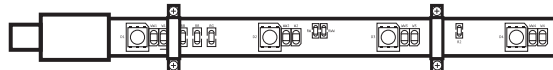

This strip light uses permanent tape and may cause surface damage if removed. Not recommended for mounting on brick or concrete.

Feit Electric is not responsible for damage to mounted surfaces.

Ensure the power supply is not plugged in at the wall outlet when mounting or cutting.

**Cut to length ONLY on the line or solder pads NEXT to the scissor markings on strip light**, where the copper or silver metal is visible. Cutting at any other area will permanently damage the strip.

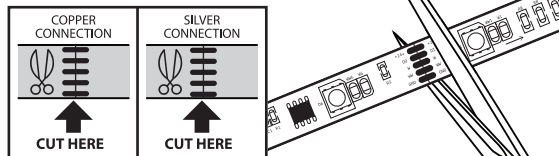

Once cut, the portion of the strip light that will not connect to the controller can be disposed of in accordance with local recycling or waste regulations.

Optional- Extend up to 40 ft. by adding one additional Feit Electric Smart LED Strip Lights (sold separately).

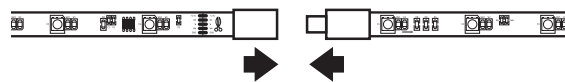

Connect a maximum of 2 units

## 4

### Connecting Multiple Tape Lights

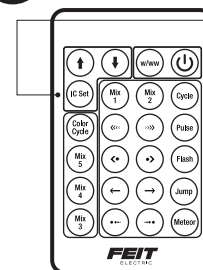

- Press the IC Set button, and the tape light will change to a mixed white RGB color.
- Use the up arrow keys on the remote to increase the number of tape segments or the down arrow keys to decrease them.
- Press the IC set button again to solidify the length.

**Note:** The total length will always remain at 40 feet max.

## 5

### Functions of the Remote

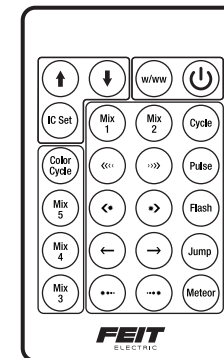

**Note:** Use up and down arrows keys for speed control.

- On/Off
- Cool to Warm White Color Temp.
- Increases Brightness for Static Colors Increase Speed for effects.
- Decrease Brightness for Static Colors Decrease Speed for effects.
- Connects Multiple Lights
- Color Cycle Solid Colors
- Color Mix 1
- Color Mix 2
- Color Mix 3
- Color Mix 4
- Color Mix 5
- Reverse Chasing Effect 1
- Forward Chasing Effect 1
- Reverse Chasing Effect 2
- Forward Chasing Effect 2
- Reverse Chasing Effect 3
- Forward Chasing Effect 3
- Reverse Chasing Effect 4
- Forward Chasing Effect 4
- Cycles Through Effects
- Fades In and out
- Sudden Burst of Light Cycling Through Colors
- Cycles Through Colors
- Meteor Chasing Effect



## Need Help?

For 24/7 customer support, visit [feit.com/help](http://feit.com/help)