

INSTRUCTIONS

1. Please count and make sure all pieces are present before assembly.
2. The pole pieces are delicate. To prevent damage, do not use excessive force.
3. Assemble crystal puzzle by putting the puzzle pieces together in the order shown below.
4. Missing a piece? Email info@ugames.com or call (415) 503-1600 with missing piece number.

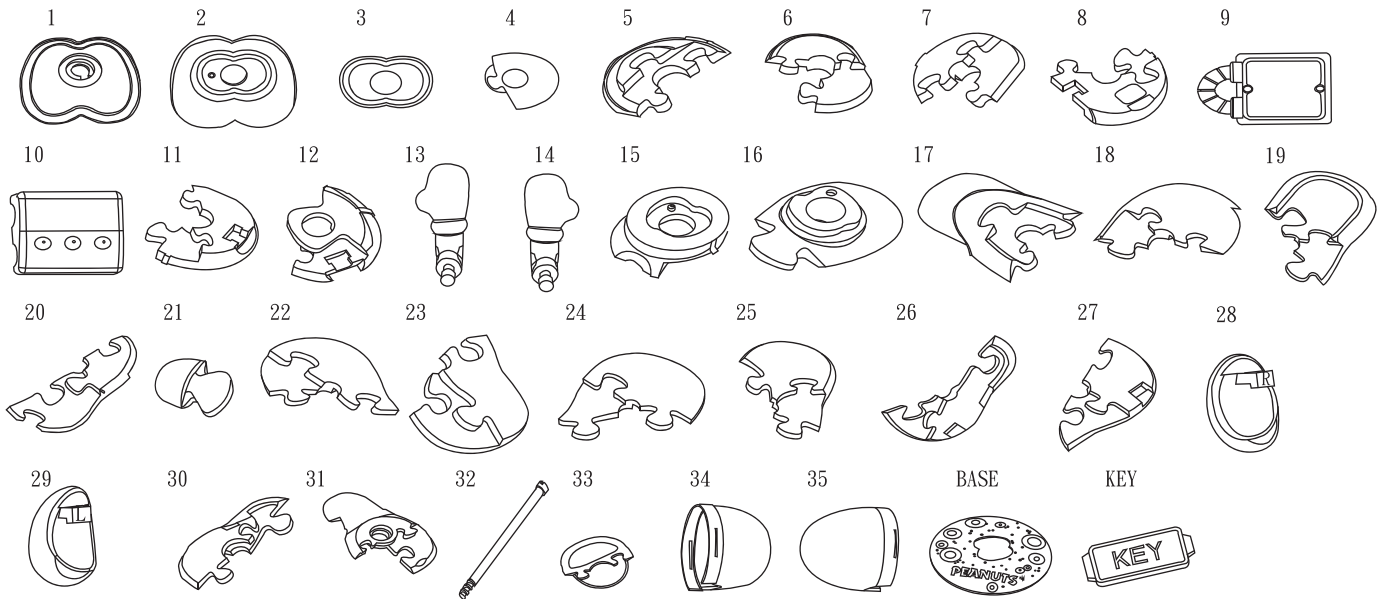

HINTS

Match the position on pieces #2 & #3, and #15 & #16

Thumbs point forward.
Note R/L marks on ears.

After piece #31, insert pole piece #32 and screw down tightly. Then, cover with top piece #33

The front cap is deeper than the rear. After the helmet is assembled put the planet base under the feet.

