

ITEM: AZ3060SHR-16 / AZ3060SHL-16
ALCOVE BATHTUB
INSTALLATION & OPERATION MANUAL

V2.0
12/23/2024

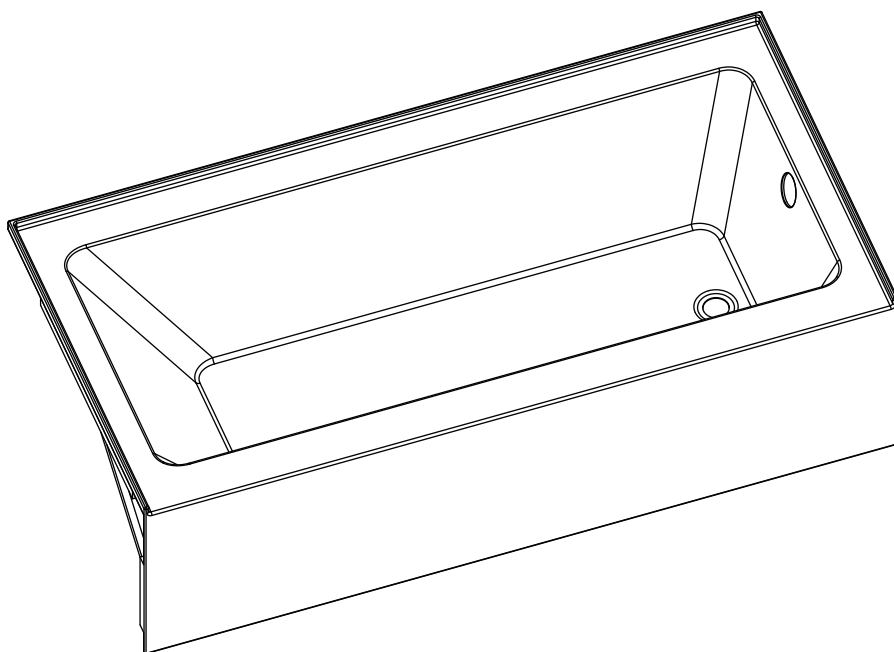

**DON'T WAIT!
REGISTER NOW!**

Register your product within 90 days to ensure it is recognized as a purchase and covered under warranty.

Register online at <https://anzzi.com/pages/register> or scan the QR code on PG. 2.



PRODUCT REGISTRATION*

IMPORTANT: Warranty will not be recognized unless product is registered.

Register online at <https://anzzi.com/pages/register> or Scan the QR code below.

Registering your product maximizes your warranty benefits and ensures prompt service and support.

1

USE YOUR PHONE CAMERA
TO SCAN THE QR CODE

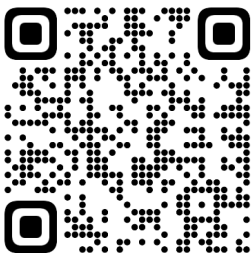

2

FILL IN A QUICK
REGISTRATION FORM

Thank you for your purchase!

Registering your products ensures you maximize your warranty benefits and receive prompt service and support.

Name*

Email*

City*

Order #*

Installer Name

...

Model Purchased*

Installer Phone Number

Customer Age Range

Submit

3

CLICK SUBMIT AND
ENJOY PEACE OF MIND

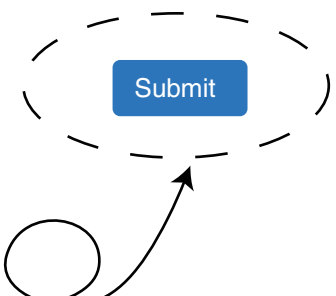

Need help? For technical support call **305-614-4070** or visit us at **www.ANZZI.com**

ANZZI®



ALCOVE BATHTUB

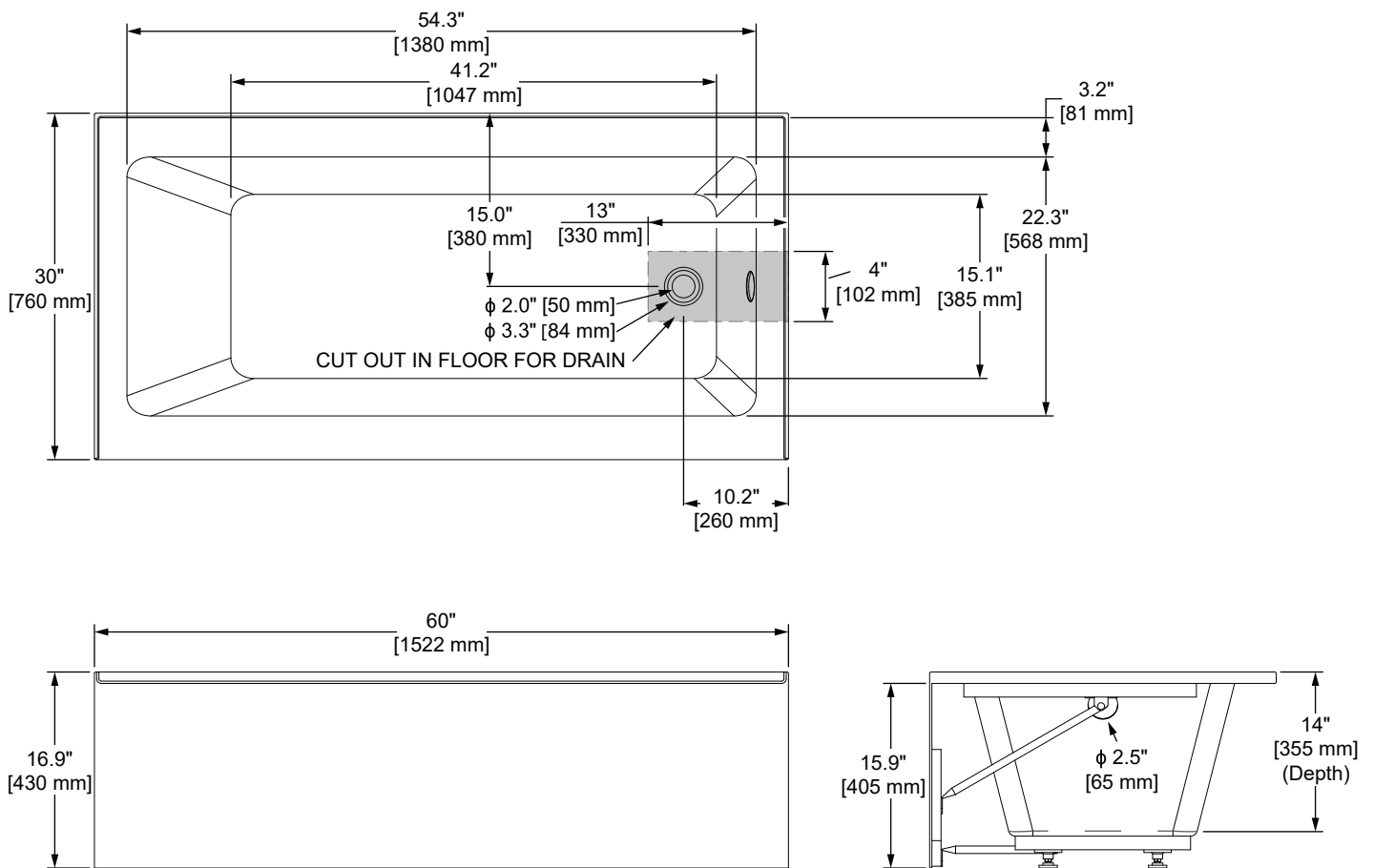



SAVE THIS MANUAL!

READ THESE INSTRUCTIONS COMPLETELY BEFORE INSTALLING THE PRODUCT. FAILURE TO DO SO COULD RESULT IN AN IMPROPER INSTALLATION AND COULD VOID THE WARRANTY.

RESPONSIBILITY OF THE INSTALLER!

THE INSTALLER MUST INSPECT AND WATER TEST THE PRODUCT PRIOR TO INSTALLATION TO ENSURE THE UNIT IS FREE OF DEFECT OR DAMAGE. IN THE EVENT OF A PROBLEM, THE UNIT MUST NOT BE INSTALLED. IF THE CRATE OR THE PRODUCT HAS BEEN DAMAGED DURING SHIPPING, PLEASE CALL US IMMEDIATELY.

THIS PRODUCT MUST BE INSTALLED BY A LICENSED/CERTIFIED CONTRACTOR!

LICENSED PLUMBERS SHOULD BE EMPLOYED TO INSURE PROPER INSTALLATION. INSTALLERS ASSUME ALL LIABILITY FOR THE CORRECT INSTALLATION PROCEDURES. ONLY ACCESSORIES AUTHORIZED BY THE MANUFACTURER SHOULD BE USED WITH THIS PRODUCT.

REPORT DAMAGE RIGHT AWAY! REPORT ANY DAMAGE TO THE BATHTUB WITHIN 5 BUSINESS DAYS. ANY DAMAGE REPORTED AFTER 5 BUSINESS DAYS WILL BE ASSUMED TO HAVE HAPPENED DURING OR AFTER THE INSTALLATION.

TEST THE TUB BEFORE INSTALLATION! BEFORE PERMANENTLY INSTALLING THE BATHTUB, YOUR INSTALLER MUST TEST THE TUB. FILL TUB AND INSPECT FOR ANY LEAKING. YOU SHOULD ONLY PROCEED TO PERMANENTLY INSTALL THE UNIT IF THERE ARE NO SIGNS OF MALFUNCTION OR LEAKAGE.

LEVEL THE TUB TO AVOID LEAKAGE! CHECK THE AREA PRIOR TO INSTALLATION. USE THE TUB'S LEVELING FEET TO ENSURE THE BATHTUB IS PERFECTLY LEVEL. IT IS ESSENTIAL THAT ALL THE FEET ARE TOUCHING THE FLOOR/SURFACE. AN UNLEVELED TUB WILL RESULT IN LEAKAGE.

SAFETY INSTRUCTIONS

READ THESE INSTRUCTIONS COMPLETELY BEFORE INSTALLING THE PRODUCT. FAILURE TO DO SO COULD RESULT IN AN IMPROPER INSTALLATION AND COULD VOID THE WARRANTY.

IMPORTANT SAFETY INSTRUCTIONS. INSTRUCTIONS IMPORTANTES RELATIVES A LA SECURITE.

READ AND FOLLOW ALL INSTRUCTIONS. LIRE ET SUIVRE TOUTES LES INSTRUCTIONS.

SAVE THESE INSTRUCTIONS. CONSERVER CES INSTRUCTIONS.



IMPORTANT

- A) An alcove bathtub is not designed to support weight on its rim. Therefore, do not sit or stand on the bathtub's rim.
- B) Please retain this manual after installation for future reference and maintenance.
- C) Installation of tub is a two-person job.

DELIVERY OF YOUR TUB

Unpack and check for damage.

Unpack the bathtub and inspect for damage or missing parts right away. Do not wait to do this. Damage reported after installation will not be covered by warranty. Repack the tub and keep it safely stored until installation begins.

Protect your tub.

Before commencing installation, ensure the tub is wholly protected and leave the covering in place until the bathroom is complete. The warranty does not cover scratches and damage incurred during installation.

TESTING THE TUB

1. Place the tub on a completely flat surface where the water can drain after testing.
2. Close the drain and fill the tub about halfway.
3. Allow the water to stand for 30 minutes. Then inspect the drain and plumbing for any leaks.

TEST THE BATHTUB WHILE YOU HAVE ACCESS TO THE BOTTOM AND BEFORE PERMANENT INSTALLATION.



COMPONENTS

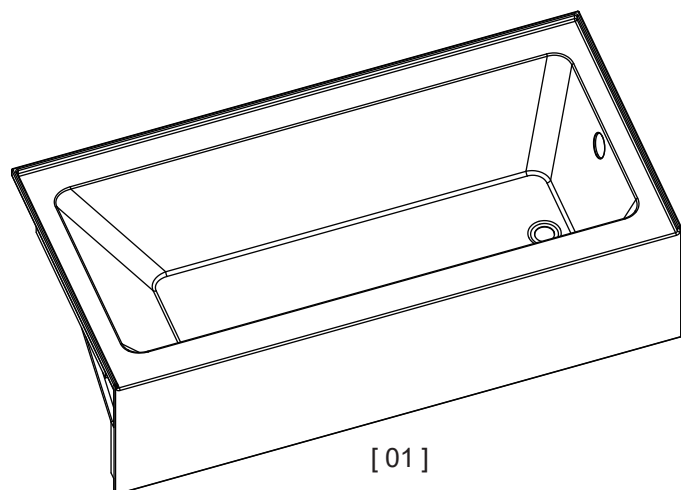

PART	Description	Qty.
01	Bathtub	1
02	Drain	1

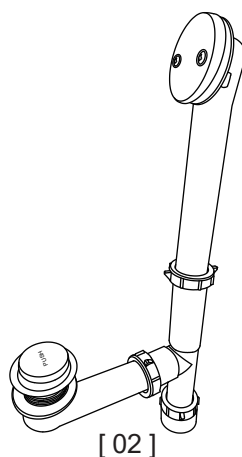

TOOLS AND MATERIALS

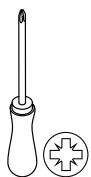

Screwdriver

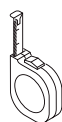

Tape Measure

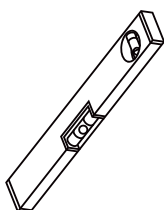

Level

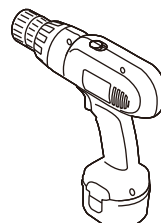

Drill

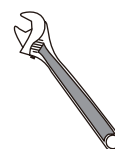

Adjustable Wrench



Drill Bit 3/16" (5 mm)

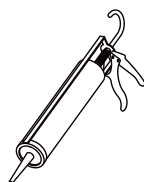

Caulk



Marker Pen



#6 or #8 1-1/4"
stainless or zinc
plated truss head
screws

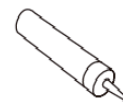

100% SILICON

INSTALLATION

1

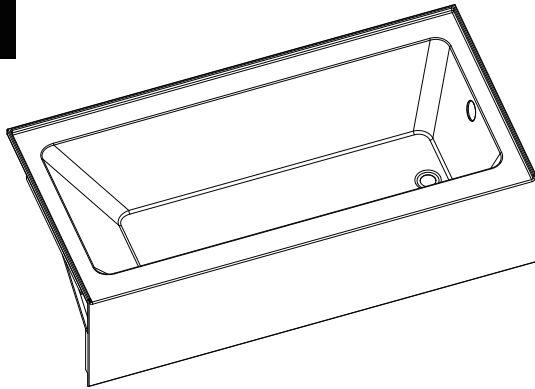

- a. Inspect the bathtub for any visible damage that may have occurred during transport.
- b. Do not proceed with installation if damage is present.

2

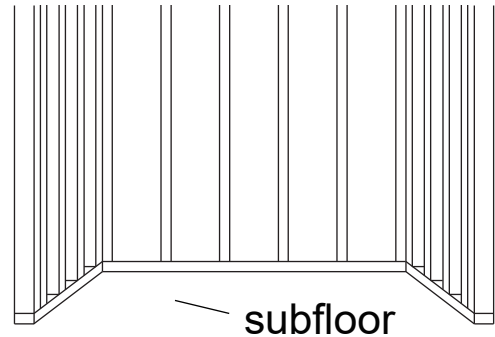

- a. Construct a frame area for the bathtub. Ensure that the subfloor is completely level.
- b. Install the rough plumbing for the drain connection.

3

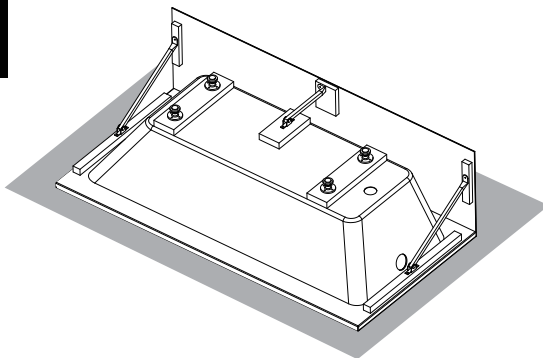

- a. Place a piece of cardboard or a blanket on the floor to protect the bathtub.
- b. Carefully turn the bathtub over to access its underside.

4-1

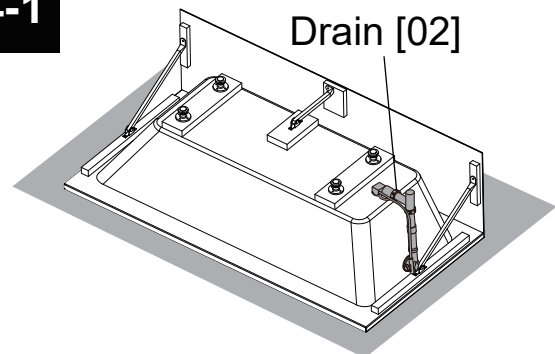

Install the drain on the bathtub by following the instructions provided on page 8.

Note: Do not use plumber's putty to seal the drain flange, as it may deteriorate the acrylic surface and cause damage. Instead, use an appropriate sealant if required.

INSTALLATION

4-2

Drain Installation

- Apply silicone sealant (not included) around the underside flange of the shoe strainer (H).
- Align the shoe elbow (J) and rubber washer (I) under the tub's drain hole. Screw the shoe strainer into the shoe elbow. Tighten it using pliers or a strainer wrench (not included).
- Place a slip nut (K) and washer (L) onto the shoe elbow (J). Ensure the threads of the slip nut and the beveled edge of the washer are facing the end of the tube.
- Insert the end of the shoe elbow tube (J) into the waste tee (N) and loosely tighten the slip nut (K).
- Place a slip nut (K) and washer (L) on the overflow elbow tube (A). Ensure the threads of the slip nut and the bevel of the washer are facing the end of the tube.
- Place the rubber washer (B) onto the overflow elbow (A), with the thicker lip of the washer facing the top of the overflow elbow (refer to the diagram for clarification).
- Insert the overflow elbow tube (A) into the waste tee (N) and loosely tighten the slip nut (K).
- Position the overflow elbow (A) over the overflow hole on the outside of the tub. From the inside, insert the longer arms of the retainer clips (C) into the slots below the screw holes of the overflow elbow. This temporarily secures the overflow elbow to the tub until the faceplate is installed in the next step.
- Attach the overflow plate (D) to the overflow elbow (A) using the two machine screws (E).
- Connect the waste tee (N) to the floor drain using the adapter (O), slip nut (K), and washer (L), if necessary.
- Thread the Easy Touch (G) mechanism into the shoe strainer (H) and tighten it securely.
- Tighten all slip joint connections firmly. Test the entire drainage system by filling the tub with water to the overflow opening. Inspect for any leaks.

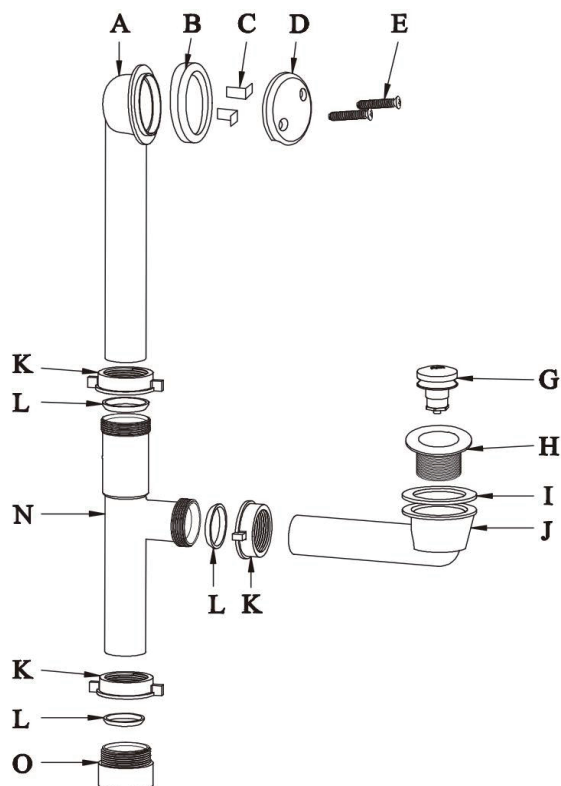

INSTALLATION

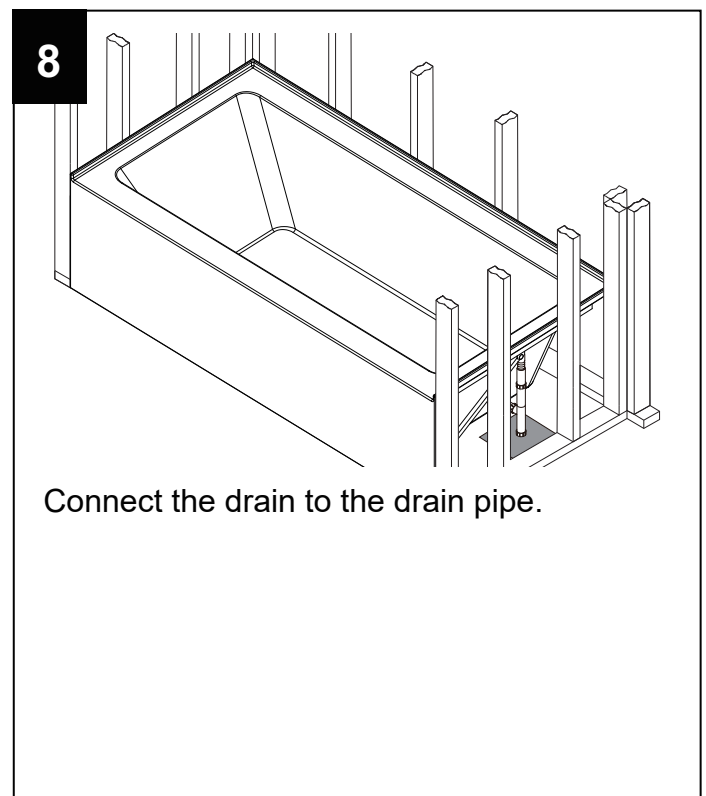
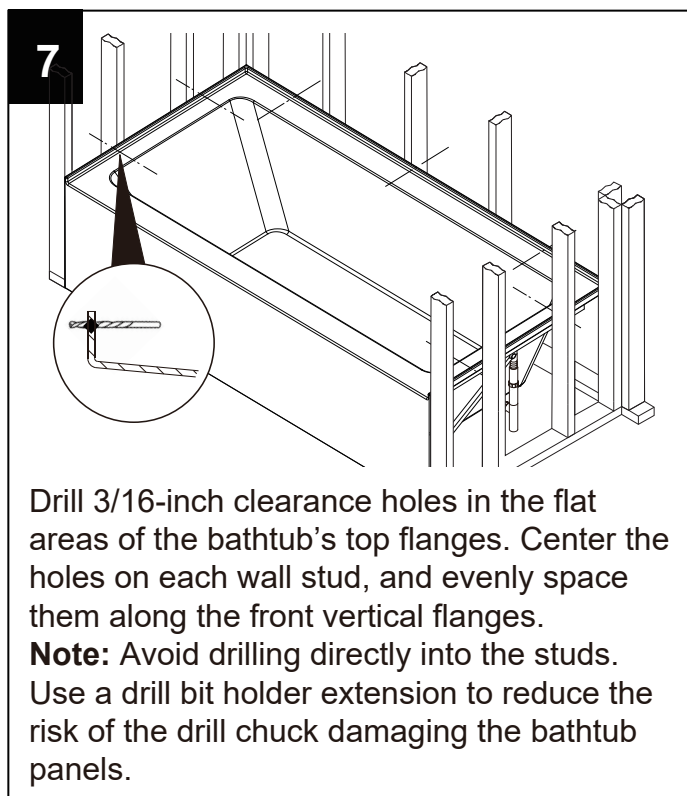
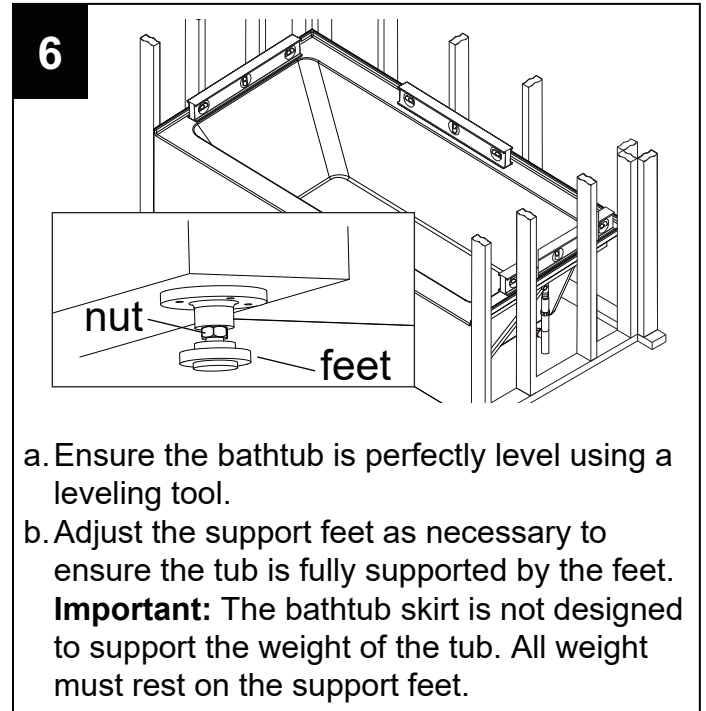
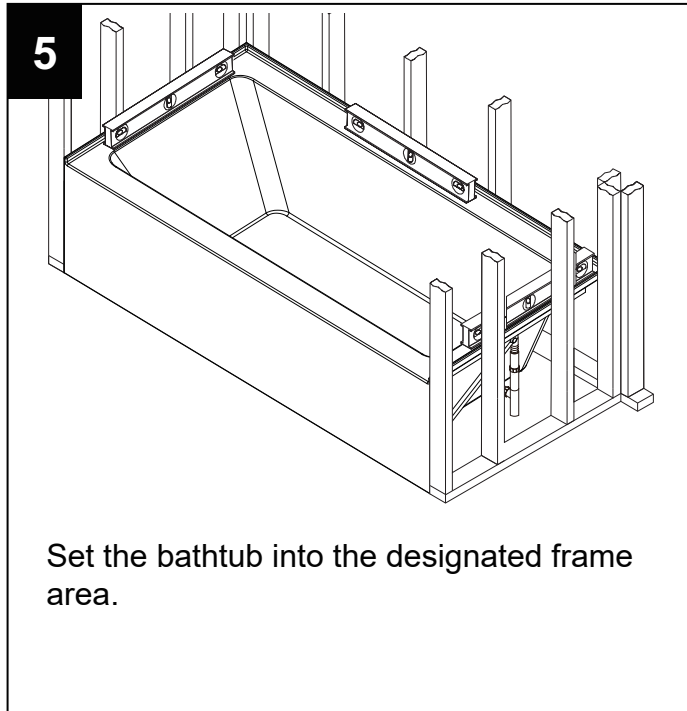

INSTALLATION

9

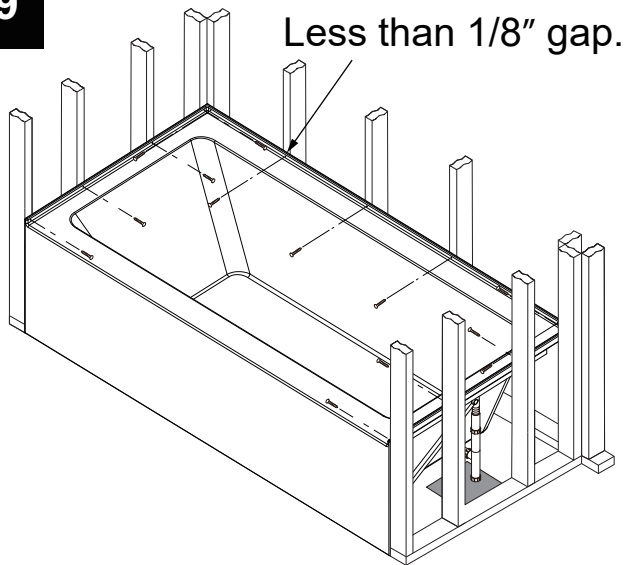

- a. Place a drop cloth in the bathtub to protect its surface. Stand inside the bathtub to press it firmly against the floor while securing it to the wall studs.
- b. Secure the front vertical flanges of the bathtub to the studs using 1-1/4-inch truss head screws. Insert shims to fill any gaps between the flanges and the studs.

- Note:** Ensure that the gaps between the flanges and studs are less than 1/8 inch after shimming.
- c. Fill the bathtub with water and inspect for potential leaks.
 - d. Allow the water to sit for 24 hours before draining.

10

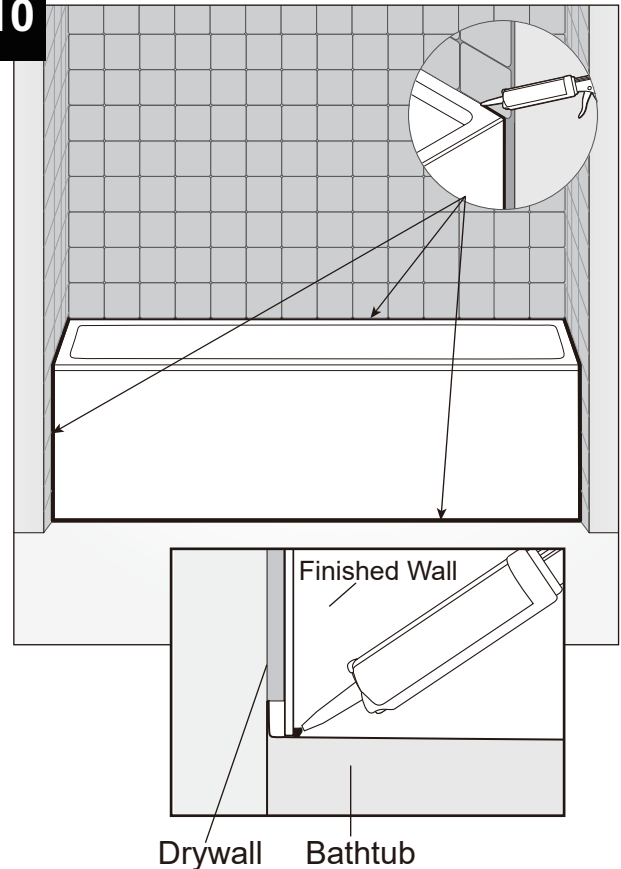

- a. Finish wall and tiles.
- b. Apply silicone recommended for acrylic bathtubs only to all outer edges, and where base and finished wall meet.
- c. Fill the bathtub with water.
- d. Let it sit for 24 hours before draining.

NOTE: Follow manufacturer's instructions for sealant curing time before use.



CLEANING AND MAINTENANCE

- Use only mild, non-abrasive cleaning products to clean the bathtub. Harsh chemicals or abrasive tools can damage the acrylic surface.
- Wipe the bathtub dry after each use to prevent the buildup of soap scum and mineral deposits.
- Avoid using harsh or abrasive materials, such as steel wool or scouring pads, as these can scratch the surface.
- Regularly inspect the silicone seals around the bathtub for any signs of wear or damage. Reseal as needed to maintain water-tightness.
- For stubborn stains, use a soft cloth or sponge with a mixture of warm water and a gentle cleaning agent. Rinse thoroughly after cleaning.
- Do not use products containing ammonia, acetone, or other solvents, as they may cause discoloration or surface damage.

