

5-AXIS MACHINE VISES

Designed specifically for multi-face machining, the Palmgren 5-Axis Machining Vises are the perfect solution for machining simple to complicated workpieces. Equipped with jaws that provide a work holding solution for a variety of workpieces. With their round style, these vises occupy less space and reduce the amount of vise interference.

- Reduced clamping times through self-centering jaws
- Jaws specifically designed to hold square, round or odd-shaped parts
- Unique vise design allows for 5-sided access to the workpiece
- Symmetrical design allows for accurate machining over multiple axes
- The low-profile design allows for increased clearance for movements within the machine
- 80,000 PSI ductile iron castings prevent vise bending

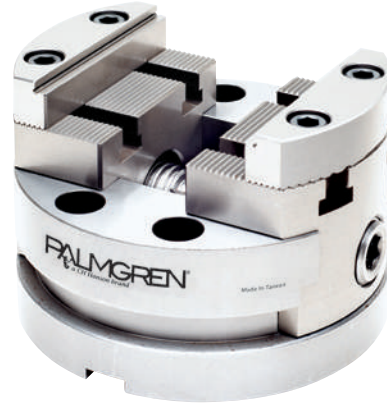

Item #	A	B	C	D	E	F	G	H	I	J	Weight
9625944	4.134	3.741	1.575	0.197	0.787	0.984	6.299	2.756	4.528	3.937	33 lbs.
9625945	5.315	4.921	1.969	0.197	0.787	0.984	8.268	3.151	4.921	5.118	76 lbs.
9625946	6.496	6.102	2.362	0.197	0.984	0.984	9.843	3.543	5.512	6.299	108 lbs.

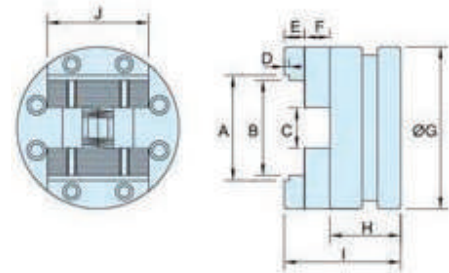

5-AXIS MACHINE VISE

The Palmgren 5-Axis Machining Vise is perfectly designed for quick and easy workpiece clamping on turning centers and 5-Axis machining centers. Their small stature occupies less machine space and reduces the amount of workpiece interference. This vise comes with various styles of jaws, able to hold a wide variety of workpieces.

- Simple and robust construction with smooth surfaces that makes for simple chip clean-up
- Self-centering, with both jaws moving simultaneously to reduce clamping times
- Jaws are suitable for cubical, round or oddly shaped parts
- Symmetrical design allows for accurate machining over multiple axes
- The low-profile design allows for increased clearance for movements within the machine
- 80,000 PSI ductile iron castings prevent vise bending

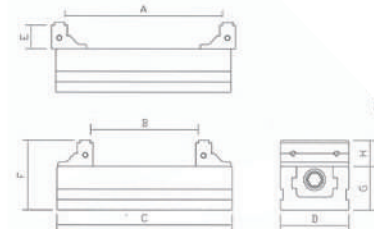

Item #	A	B	C	D	E	F	G	H	Weight
9625943	7.087	4.843	7.874	3.071	1.063	3.149	1.969	1.181	15 lbs.