

## VERSANORA Danna Arc Floor Lamp

VN-L00071B  
VN-L00071W  
VN-L00071B-EU  
VN-L00071W-EU  
VN-L00071B-UK  
VN-L00071W-UK

**TIME SAVER!**  
3D Interactive Instruction

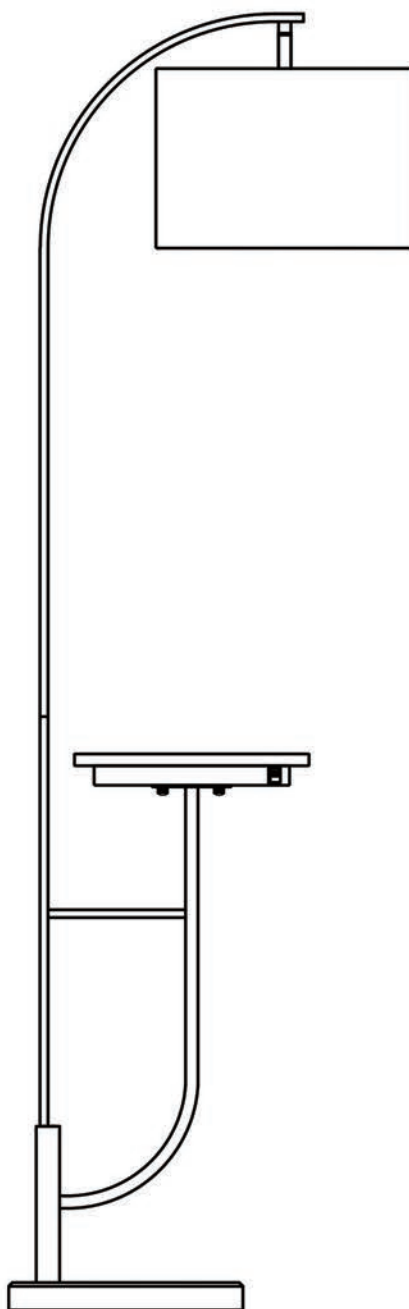

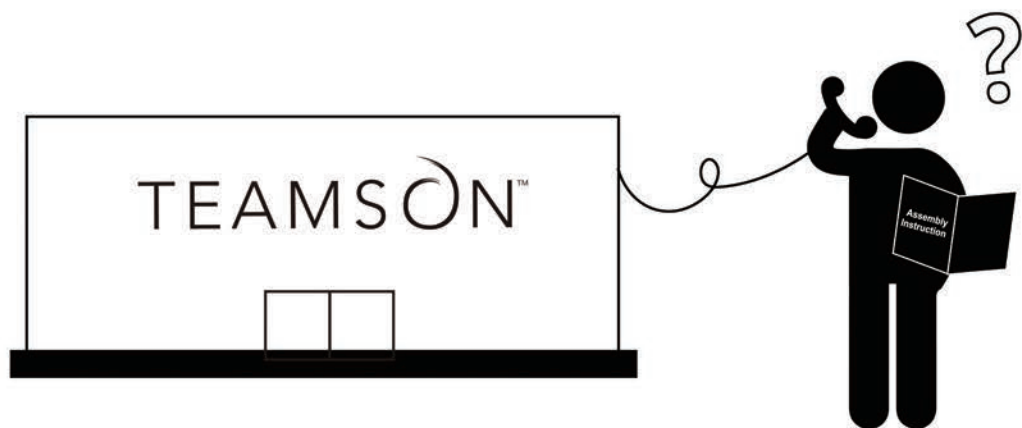
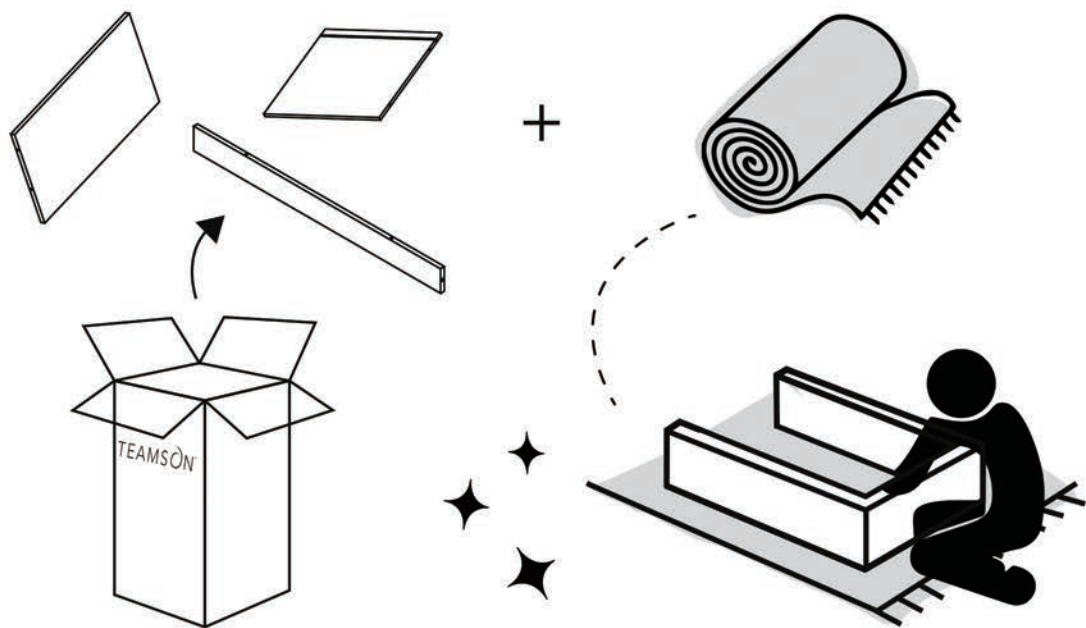
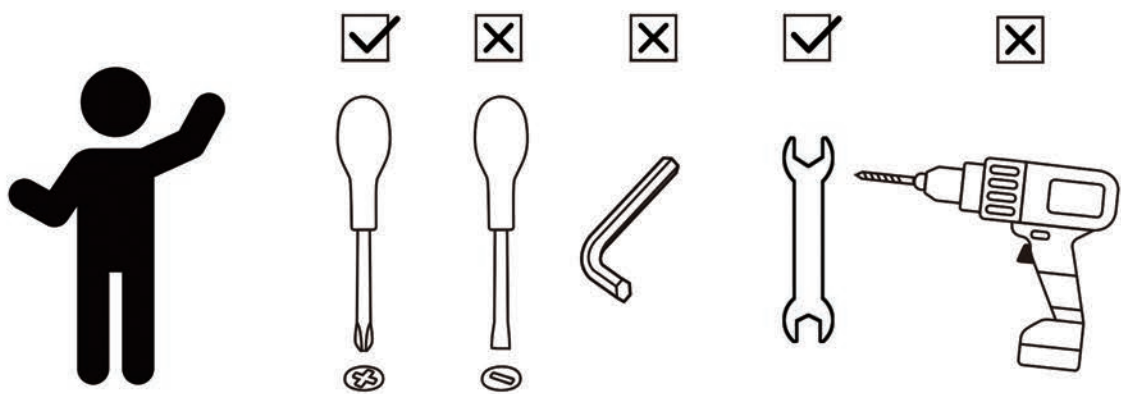

\*\* Got questions? Please have your product code (on the first page of this instruction, e.g. TD-12345A) and the order number ready, give us a call or email us through our customer care support! We are always ready to assist you!

# TEAMSON HOME



Warranty sign up

[www.teamsonhome.com](http://www.teamsonhome.com)

**Serving you well gives us great joy!**

**USA .... +1(800)935-3959**

Mon - Fri 10:00am ~ 2:00pm EST

✉ [support@teamson.com](mailto:support@teamson.com)

**EU ..... +44(0)1952-916-050**

Mon - Thu 9:00am ~ 5:00pm GMT

Friday 9:00am ~ 4:00pm GMT

✉ [support@teamson.co.uk](mailto:support@teamson.co.uk)

If the external flexible cable or cord of this luminaire is damaged, it shall be exclusively replaced by teamson.uk or a similiar qualified person in order to avoid a hazard.

**ASIA ... 深圳办公室:**

**+86(0755)8885-3558.分机号108**

Mon - Sat 9:00am ~ 5:00pm GMT+8

✉ [sales\\_ec@teamson.com](mailto:sales_ec@teamson.com)

台北辦公室:

**+886(2)2556-6268**

Mon - Fri 9:00am ~ 5:00pm GMT+8

✉ [sales\\_ec@teamson.com](mailto:sales_ec@teamson.com)

**Thank you for choosing Teamson Home**

## Exploded Drawing

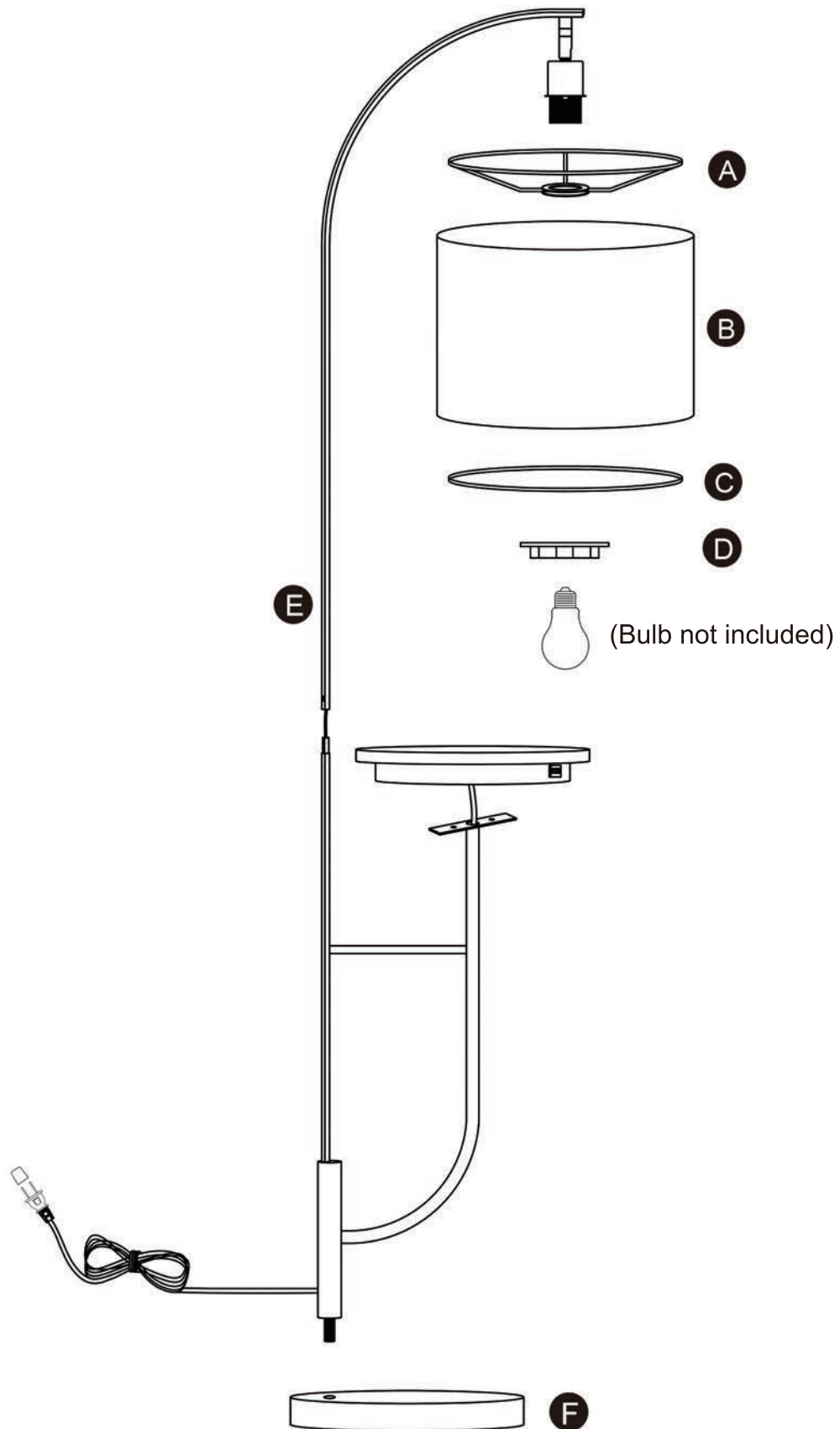

**Questions?**  
Scan Here

## Product Parts

A

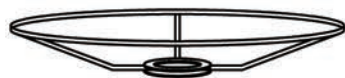

1 PC

B



1 PC

C

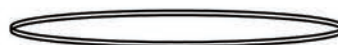

1 PC

D



1 PC

E



1 PC

F

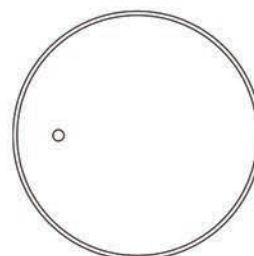

1 PC

## Hardware

1

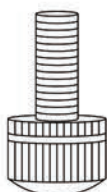

2 PCS

2



1 PC

3



1 PC

4



1 PC

5



2 PCS



**Questions?**  
Scan Here

### ! Care Instructions

Dust surface with a dry soft cloth.

Do not use window cleaners or cleaning abrasives as they will scratch the surface and could damage the protective coating

### ! WARNING

Small parts and sharp edges may be present prior to assembly.



Step 1

Step 2

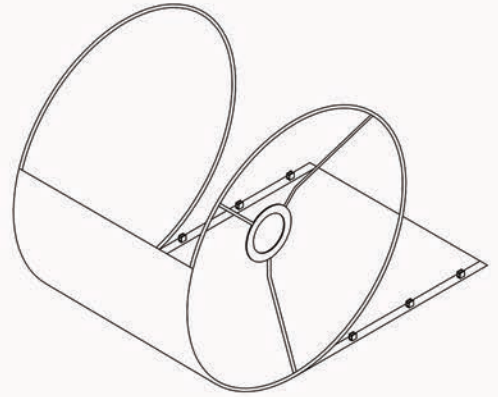
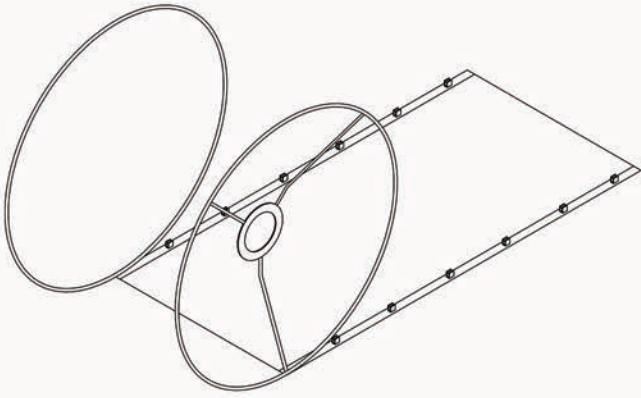

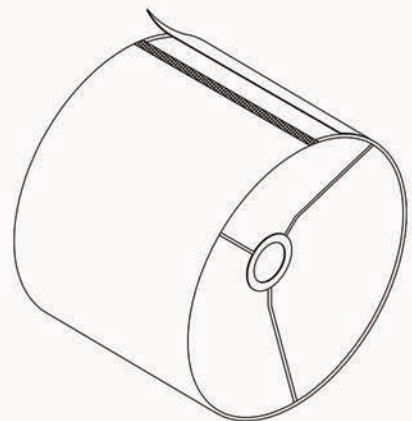
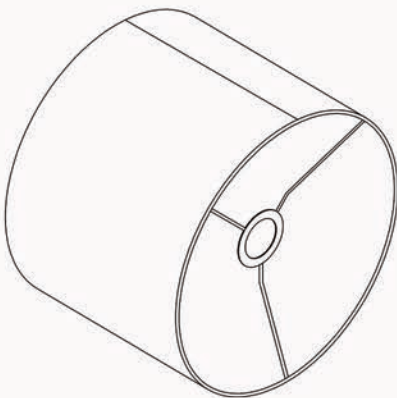

Step 3

Step 4

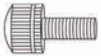
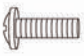

**Questions?**  
Scan Here

Remove the nut and screws before assembling			
	X 2		X 2
	X 1		X 1

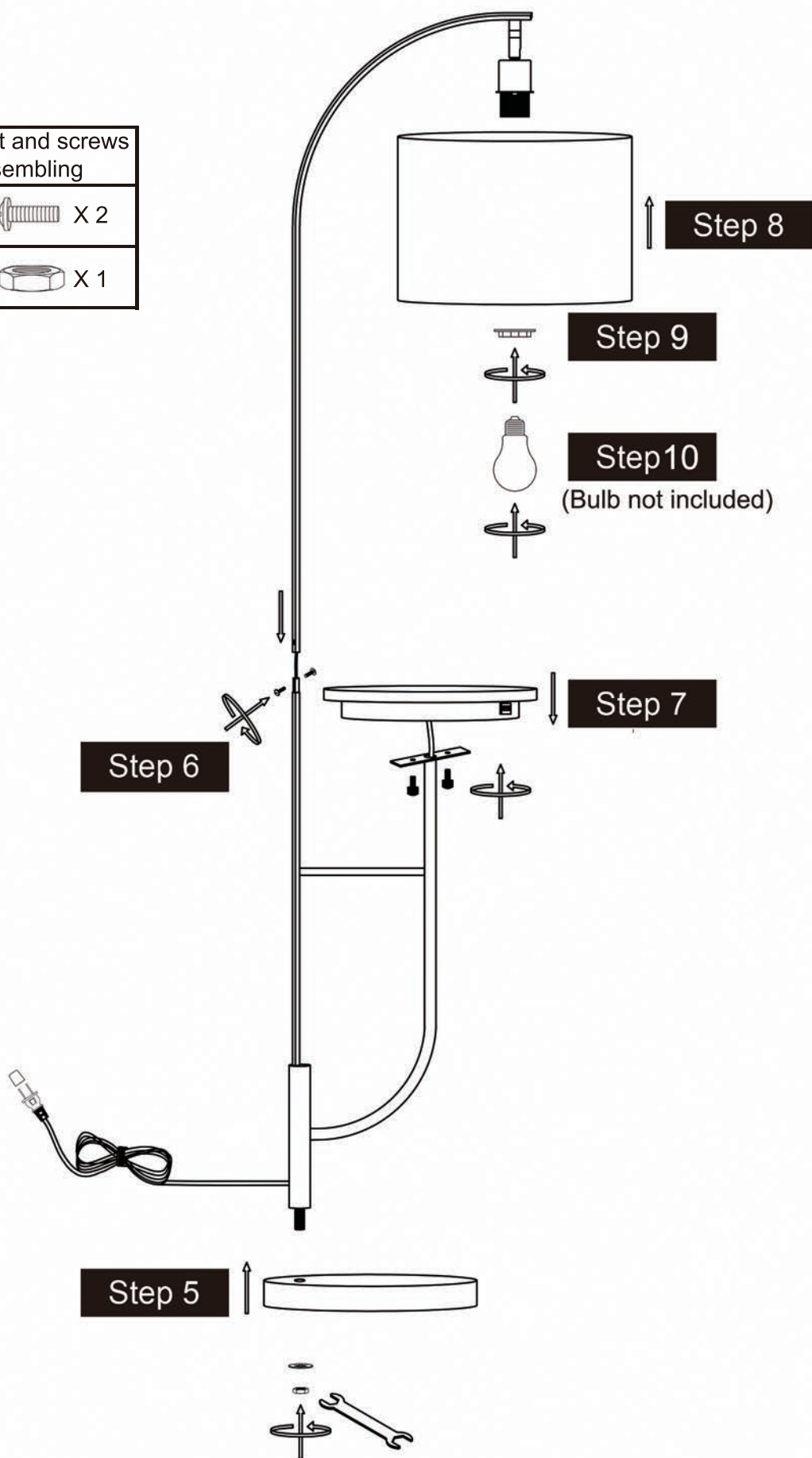

Questions?  
Scan Here