

SHIMANO

TALICA

TAC-10

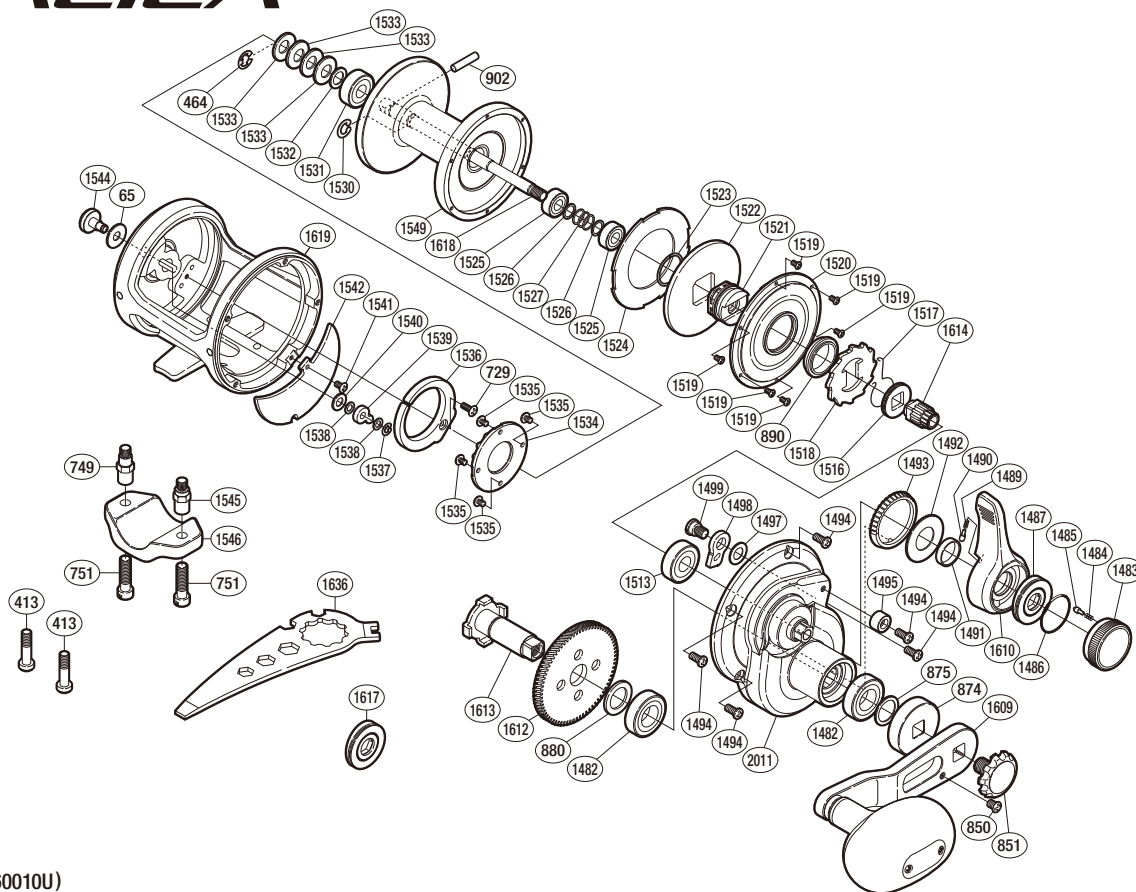

(51RJ260010U)

#	Part No.	Description	#	Part No.	Description	#	Part No.	Description
0065	104H2	Spacer	1498	10PKK	Anti-Reverse Pawl	1539	10GQV	Click Pawl
0464	105RY	E Lock	1499	10PE4	Anti-Reverse Pawl Pin	1540	10G88	Spacer
0729	103E9	Screw	1513	104VJ	Ball Bearing	1541	10LVE	Screw
0850	10MC5	Screw	1516	10CDJ	Anti-Reverse Pawl Spring Holder	1542	105WP	Set Plate
0851	106XM	Handle Bolt	1517	10CDH	Anti-Reverse Pawl Spring	1544	104GW	Click Button
0874	107QY	Gear Shaft Shield	1518	10DAK	Anti-Reverse Ratchet	1549	10GYR	Spool
0875	10J1C	Washer	1519	10PRS	Screw	1609	102VJ	Handle
0880	10J1B	Washer	1520	104R0	Cooling Shield	1610	108BA	Drag Control Lever
0890	10EW9	Waterproof Ring	1521	10AC0	Pinion Guard	1612	10QKC	Drive Gear
0902	10MCU	Cross Pin	1522	10G4E	Drag Plate	1613	10A2T	Drive Shaft
1482	104PW	Ball Bearing	1523	10EVW	Seal Lock	1614	10A4F	Pinion Gear
1483	108F8	Pre-Program Dial	1524	10G3T	Drag Washer	1618	10F00	Spool Shaft
1484	10K07	Click Spring	1525	105CA	Ball Bearing	1619	10KBF	One-Piece Frame
1485	10JX6	Click Pin	1526	10HV5	Washer	2011	109FY	Right Side Plate
1486	108WE	O Ring	1527	1060F	Pressure Release Spring			
1487	10CC9	Lever Shaft Body	1530	13JYP	C Lock	0413	10A7C	Rod Clamp Bolt (Accessory)
1489	10C3X	Lever Click Shoe	1531	108PJ	Ball Bearing	0749	10JC8	Rod Clamp Nut (Accessory)
1490	10C3V	Lever Click	1532	10G8H	Washer	0751	10JBV	Rod Clamp Bolt (Accessory)
1491	108DQ	Lever Thrust Ring	1533	10528	Coned Disc Spring	1545	10JCC	Rod Clamp Nut (Accessory)
1492	10G89	Washer	1534	104F3	Click Gear	1546	10AS3	Rod Clamp (Accessory)
1493	10F6A	Lever Click Gear	1535	10MPC	Screw			
1494	10K05	Screw	1536	1046F	Click Spring	1636	10MJ7	Wrench (Accessory)
1495	10CAB	Bolt Shield	1537	105S1	C Lock			
1497	10GA1	Washer	1538	10HV2	Washer	1617	10C62	Lever Shaft Body (Sfs) (Accessory)

Please note that the number of adjusting washers may not be the same as shown in the exploded views.
(Adjustment will vary with each individual product.)

(230306)_002