

# 88 5050 65 Oak Hill Hutch

## IMPORTANT NOTE

Carefully remove all the parts from the carton and put them individually on a soft cloth to prevent scratches or other damages occurring to the wood parts.

We have taken great care in the design of this product and request that you carefully and strictly follow our assembly instructions to ensure a completed product as it was designed.

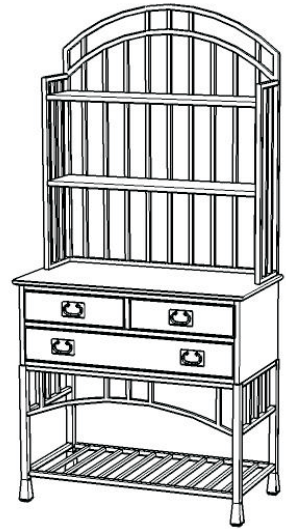
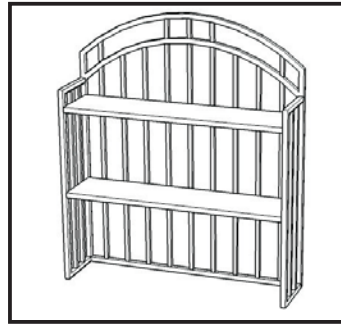

*Home Styles*

## Part List



**A.  
Back Frame**  
1 pc.

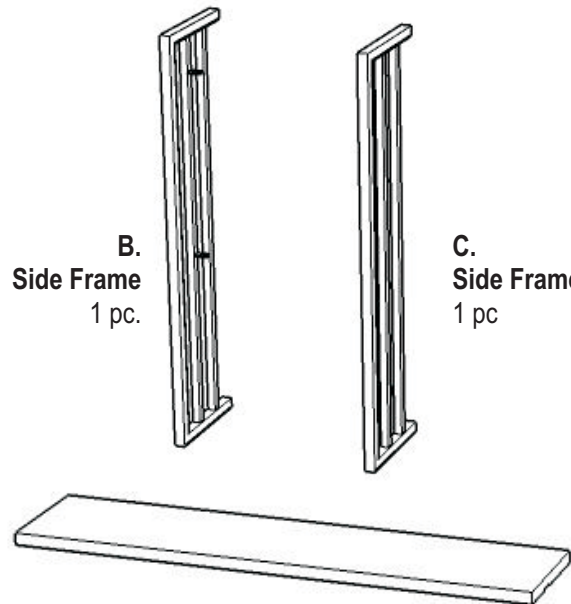

**B.  
Side Frame**  
1 pc.

**C.  
Side Frame**  
1 pc

**D.  
Shelf**  
2 pcs.

## Hardware List

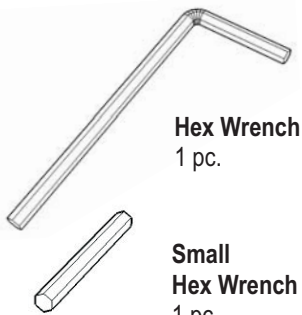

**Hex Wrench**  
1 pc.

**Small  
Hex Wrench**  
1 pc.



**Head Cap Bolt**  
4 pcs. (+1 extra)



**Wood Screw (long)**  
4 pcs. (+1 extra)



**Wood Screw (short)**  
8 pcs. (+1 extra)

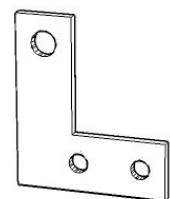

**Steel Plate Connector**  
2 pcs. (+1 extra)

Tools required for assembly : **Phillips** screwdriver

**Home Styles Consumer Assistance Line 888-680-7460 and 877-831-0319  
servicedesk@homestyles-furniture.com**

# Assembly Instructions

## IMPORTANT

You should keep Hex Wrench in a safe place as you may need to tighten up the Head Cap Bolts in the future.

## STEP 1

Attach Side Frame (B) and (C) to Back Frame (A) with Head Cap Bolts. (See figure 1)

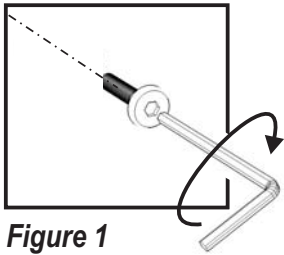
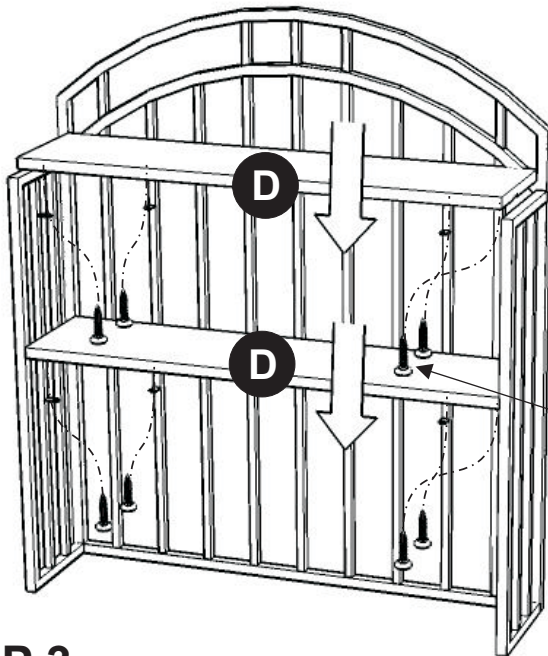
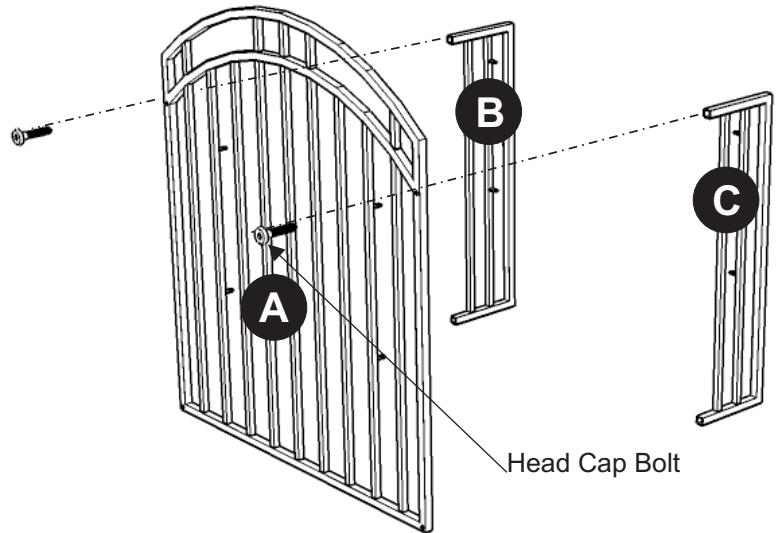

Figure 1



## STEP 2

Attach Shelves (D) to unit with Wood Screws (short).

Wood Screw (short)

## STEP 3

Place unit onto Buffet unit.

Attach Steel Plant Connectors to unit at the pre-drilled holes, then tighten Head Cap Bolts and Wood Screws (long). (See figure 2)

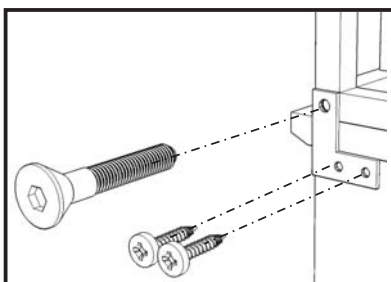

Figure 2

