

# ANZZI™

KF-AZ201CH  
 KF-AZ201BN  
 KF-AZ201ORB

**KITCHEN FAUCET**  
**SOLID BRASS**  
**CERAMIC CARTRIDGE**  
**FLOW RATE:1.8GPM**  
**LIMITED LIFETIME WARRANTY:**

**HAVE QUESTIONS?**

Call us at 1-844-44-ANZZI or visit [www.ANZZI.com](http://www.ANZZI.com)

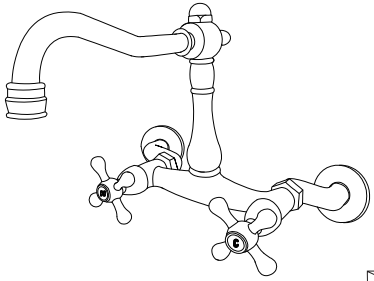

NSF/ANSI 61  
 NSF/ANSI 372



## STEP 1

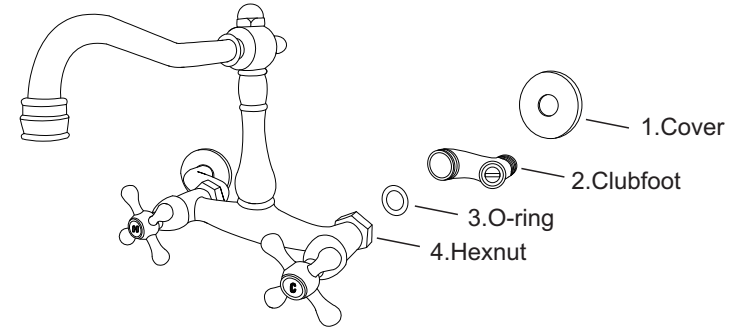

### PREPARATION

**MAKE SURE TO SHUT OFF THE WATER FLOW FROM YOUR HOT AND COLD SUPPLY LINES.**

**MAKE SURE YOUR MOUNTING HOLE IS CUT TO SIZE.**

The center of two holes Max distance is 6.6", Min distance is the 5"

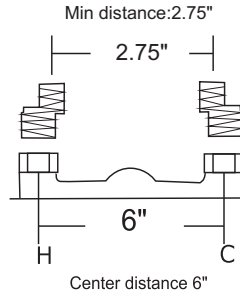
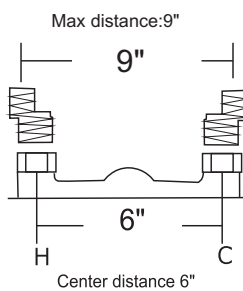
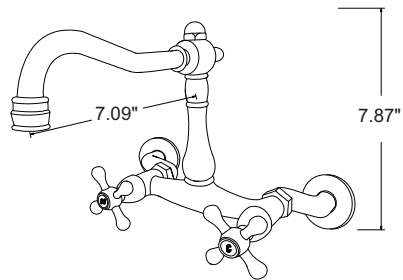

### ITEMS YOU MAY NEED.

NEED HELP? Give us a call at 1-844-44-ANZZI or visit us online at [www.ANZZI.com](http://www.ANZZI.com).

### Body installation

Note: Eliminate inner dregs before installation.  
 Protect faucet surface with a soft cloth when installing.

- 1.Run the cover(1)through clubfoot(2).
- 2.Wrap one side of 2 clubfeet(2) with sealing tape,screw clubfeet(2) into the hole in a wrench.
- 3.Insert O-ring(3) into hexnut(4),then rotate clubfeet(2) to the right position to hexnuts(4).
- 4.Wrap another side of 2 clubfeet(2)with sealing tape, tighten hexnuts(4) by wrench.