

## LOW VOLTAGE HOUSING(FOR NEW CONSTRUCTIONS)

### INSTALLATION INSTRUCTIONS

#### 1. BAR HANGERS

Insert bar hangers into the slots on the plaster frame (drawing 1). Position bar hangers so that nail in tabs point away from housing or point down to Ceiling.



#### 2. FASTENING FIXTURE TO CEILING

Joist-type ceiling-Extend bar hangers to fit between joists. Position fixture temporarily by hammering "nail-in" tabs into joists (drawing 2), then secure permanently with nails. Hangers should be level with bottom of joists.

Suspended (T-bar) Ceilings-extend bar hangers 1" past T-bars. then rest fixture on T bars. Secure fixture to T-bars with wire see drawing 3.

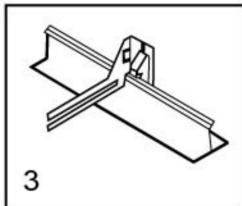
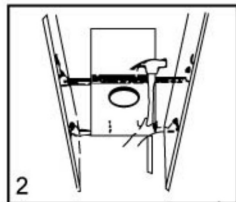

#### 3. ELECTRICAL CONNECTION

Junction box contains one black and one white wires which come out of transformers. Make sure to splice the one black one white wires to the house current feed wire regardless of wires color (drawing 4).

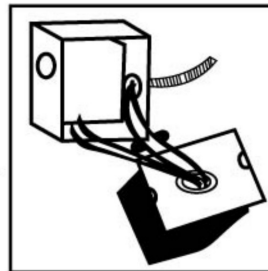

#### Grounding

For Romex or 3 wire BX, flexible Armour cable installations attach supply ground lead(green) to bare copper ground lead or ground screw in wiring box mounted on plaster frame.

Local electrical codes should be consulted to determine acceptable installation-conduit Romex, or flexible Armour cable.

#### 4. CUTTING A HOLE

Locate the center of proposed opening on your tile or ceiling material and mark it.

Rounds: Use a compass to draw a circle 4 " in diameter around the center point. Cut along this circular line (drawing 5).

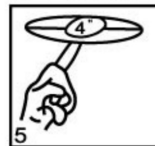

**WARNING-RISK OF FIRE. MOST DWELLINGS BUILT BEFORE 1985 HAVE SUPPLY WIRE RATED 60°C. CONSULT A QUALIFIED ELECTRICIAN BEFORE INSTALLING.**