

Lumination® AL10

LED ARCHITECTURAL SPECIALTY

Project Name _____

Date _____ Type _____

Notes _____

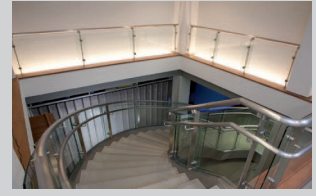

Lumination® AL10 is the linear LED system that combines versatility with superb quality of light. High color rendering (93 CRI) and ANSI bin color temperature consistency enable this versatile LED system to produce brilliant white light that meets the high standards of lighting designers.

For a variety of retail and architectural applications, this slim, low-profile, LED module offers multiple lengths, viewing angles and mounting angles—making it easy to incorporate into a wide array of designs.

Backed by a reputation for reliability in the LED industry, this robust, low-voltage system is rated to perform for 50,000 hours—reducing material and labor expenses associated with relamping.

Commercial Applications

Cove, retail under shelf, accent and task lighting applications.

Features & Benefits

- High color rendering: 93 CRI
- Multiple ANSI bin color temperatures: 2700K, 3000K and 4000K
- High light levels: up to 210 lm/ft (700 lm/m), 47 lpw
- Low energy consumption: 4.5 W/ft (14.8 W/m)
- Multiple lens options: 60°, 90° or 120° clear and 120° soft beam patterns
- Long rated life of 50,000 hours
- Low-voltage 12VDC system
- Dimmable 0-10V with LED driver
- Contains no lead, mercury or glass

Lumination® AL10

LED ARCHITECTURAL SPECIALTY

Specification Details

Project Name _____

Date _____ Type _____

Notes _____

Performance Data

White Module

Grey Module

| Product Code | Description Code | Product Code | Description Code | Voltage | *CCT | CRI | Lens Type | Length inches (mm) | Lumens per Module (ft./m) | Watts per Module (ft./m) | Lumens per Watt |
|--------------|------------------|--------------|------------------|---------|-------|-----|------------|--------------------|---------------------------|--------------------------|-----------------|
| 78878 | LPL-W18-120D-927 | | | 12 | 2700K | 93 | 120° soft | 18 (460) | 290 (193/633) | 6.8 (4.5/14.8) | 43 |
| 78864 | LPL-W09-120D-927 | | | 12 | 2700K | 93 | 120° soft | 9 (230) | 145 (193/633) | 3.4 (4.5/14.8) | 43 |
| 78868 | LPL-W18-060C-930 | | | 12 | 3000K | 93 | 60° clear | 18 (460) | 300 (200/656) | 6.8 (4.5/14.8) | 44 |
| 78872 | LPL-W18-090C-930 | 78897 | LPL-G18-090C-930 | 12 | 3000K | 93 | 90° clear | 18 (460) | 300 (200/656) | 6.8 (4.5/14.8) | 44 |
| 78875 | LPL-W18-120C-930 | | | 12 | 3000K | 93 | 120° clear | 18 (460) | 300 (200/656) | 6.8 (4.5/14.8) | 44 |
| 78879 | LPL-W18-120D-930 | 78903 | LPL-G18-120D-930 | 12 | 3000K | 93 | 120° soft | 18 (460) | 300 (200/656) | 6.8 (4.5/14.8) | 44 |
| | | 78891 | LPL-G09-120D-930 | 12 | 3000K | 93 | 120° soft | 9 (230) | 150 (200/656) | 3.4 (4.5/14.8) | 44 |
| 78870 | LPL-W18-060C-940 | | | 12 | 4000K | 93 | 60° clear | 18 (460) | 320 (213/699) | 6.8 (4.5/14.8) | 47 |
| 78873 | LPL-W18-090C-940 | | | 12 | 4000K | 93 | 90° clear | 18 (460) | 320 (213/699) | 6.8 (4.5/14.8) | 47 |
| 78877 | LPL-W18-120C-940 | 78901 | LPL-G18-120C-940 | 12 | 4000K | 93 | 120° clear | 18 (460) | 320 (213/699) | 320 (213/699) | 47 |
| 78880 | LPL-W18-120D-940 | | | 12 | 4000K | 93 | 120° soft | 18 (460) | 320 (213/699) | 6.8 (4.5/14.8) | 47 |

Components

| Product Code | Description Code | Product Description | QTY. |
|--------------|------------------------|---|-------|
| 74914 | GE020/G/V12T1-B | LED Driver (12VDC/20W); Input Voltage: 90-264VAC | 1/PK |
| 67824 | GEPS12-60UGL-IP | LED Driver (12VDC/60W); Input Voltage: 120-277VAC | 1/PK |
| 79044 | GE060/MV/D12T1-A 0-10V | Dimmable LED Driver (12VDC/60W); Input Voltage: 90-305VAC | 1/PK |
| 62819 | DFU120150 | LED Wall Transformer (12VDC/18W) (North America only) | 1/PK |
| 62816 | LPL-WTCS | Cable with Switch (used only with 62819) (North America only) | 1/EA |
| 75612 | GEDM1-A | Dimming Module | 1/PK |
| 78905 | LC-36 | Leader Cable - 36-inch (914mm) | 5/PK |
| 78906 | LC-120 | Leader Cable - 120-inch (3048mm) | 5/PK |
| 78907 | JC-12 | Jumper Cable - 12-inch (305mm) | 5/PK |
| 78908 | JC-72 | Jumper Cable - 72-inch (1829mm) | 5/PK |
| 62814 | MMB-W0 | Magnetic Mounting Bracket - White 0° Angle | 20/PK |
| 78909 | MB-W15 | Mounting Bracket - White 15° Angle | 20/PK |
| 78910 | MB-W30 | Mounting Bracket - White 30° Angle | 20/PK |
| 78911 | MB-G15 | Mounting Bracket - Grey 15° Angle | 20/PK |
| 78912 | MB-G30 | Mounting Bracket - Grey 30° Angle | 20/PK |
| 62187 | LPL-MTS36/0 | Mounting Track with Light Shield | 10/PK |

Product Description Codes

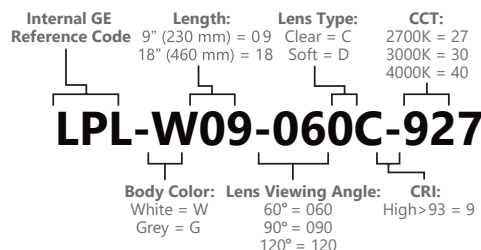

Technical Specifications

| Specification Item | Specification |
|---------------------|--|
| Operating Voltage | 12 VDC |
| Maximum Loading | 74914: 4 ft. (1.22m); 67824 & 79044: 13 ft. (3.96m); 62819: 4.5 ft. (1.37m) |
| Remote Mounting | Standard length of 1-30 ft. (0.3-9.14m) with 18AWG (0.82mm ²) supply wire; for greater lengths refer to the installation instructions. |
| Ambient Temperature | -20°C to +40°C |
| IP Rating | IP54: dry or damp location rated |
| Limited Warranty | 5 years |

System Certifications



Lumination® AL10

LED ARCHITECTURAL SPECIALTY

Dimensional Details

Project Name _____

Date _____ Type _____

Notes _____

Dimensional Drawings Typical dimensions shown in inches (mm)

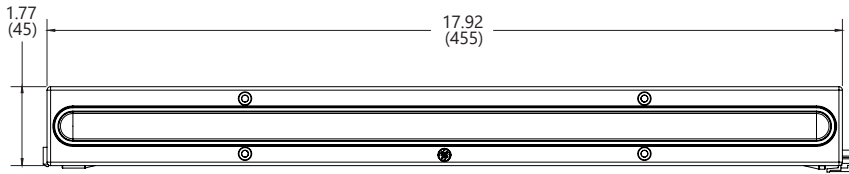

18" (460 mm) Top View

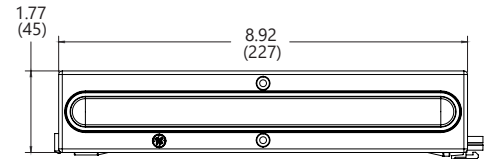

9" (230 mm) Top View



18" (460 mm) Bottom View

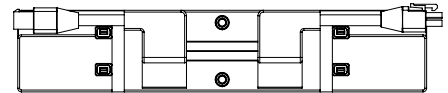

9" (230 mm) Bottom View

60° Clear Lens



18" (460 mm) Side View

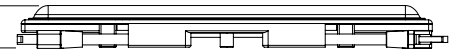

9" (230 mm) Side View

90° Clear Lens

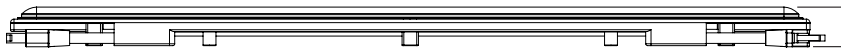

18" (460 mm) Side View

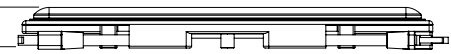

9" (230 mm) Side View

120° Clear Lens



18" (460 mm) Side View

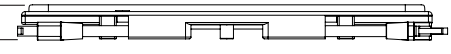

9" (230 mm) Side View

120° Soft Lens

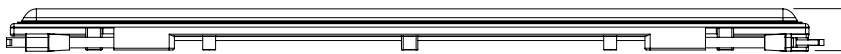

18" (460 mm) Side View

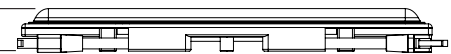

9" (230 mm) Side View

Leader Cable

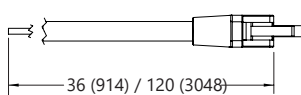

Jumper Cable

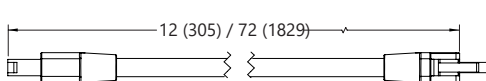

Cable with Switch

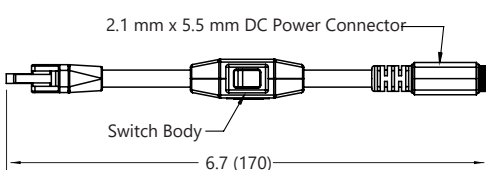

0° Mounting Bracket

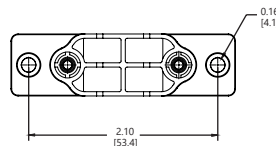
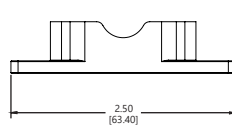

15° Mounting Bracket

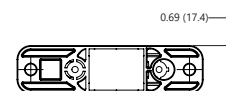
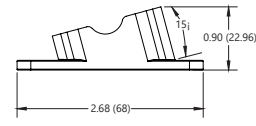

30° Mounting Bracket

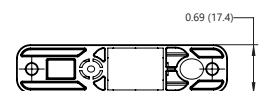
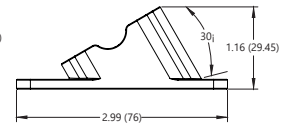

Lumination® AL10

LED ARCHITECTURAL SPECIALTY

Photometric Details

Project Name _____

Date _____ Type _____

Notes _____

60° Clear Lens

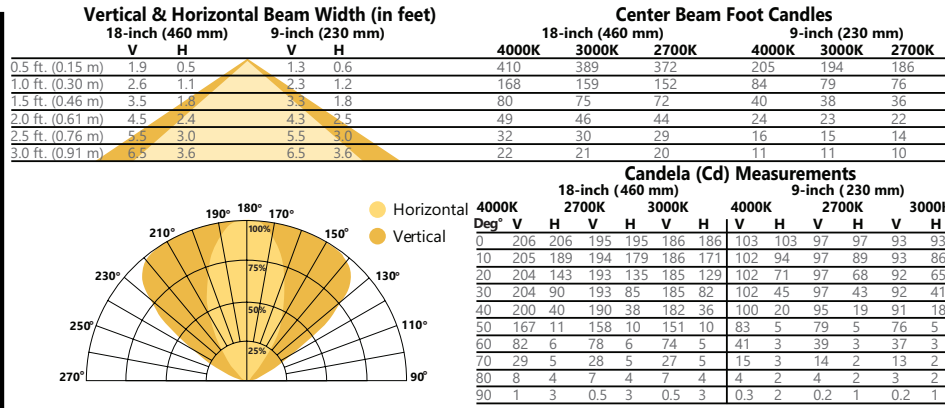

90° Clear Lens

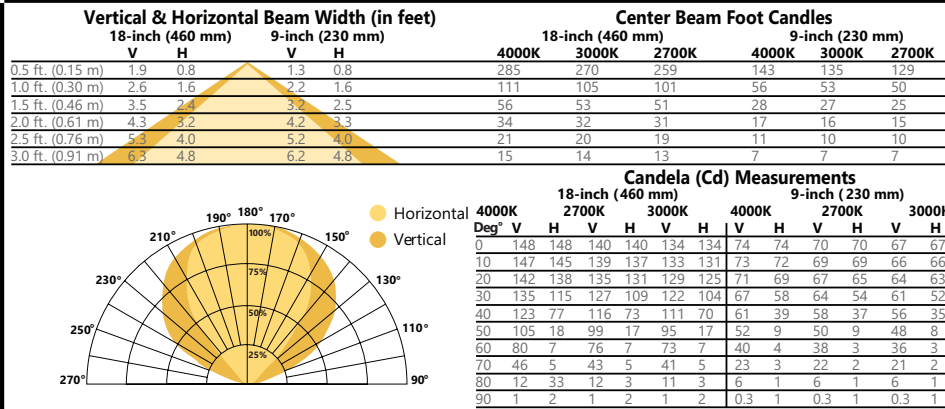

120° Clear Lens

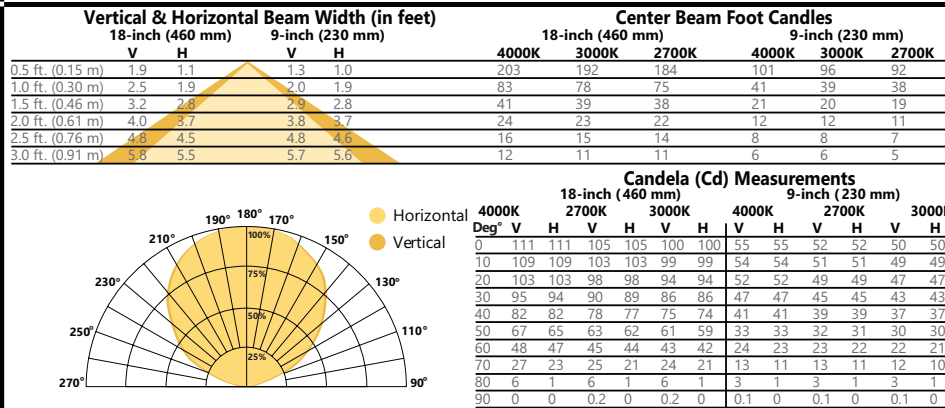

120° Soft Lens

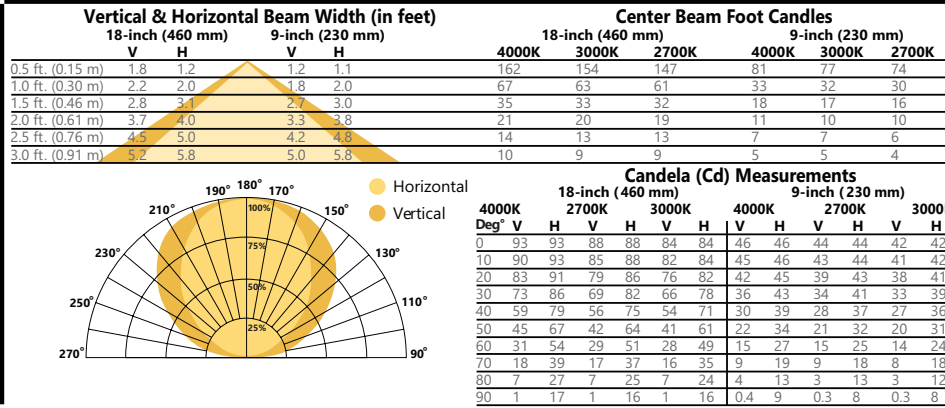

IES files can be downloaded at www.gecurrent.com