

TREX SELECT® HORIZONTAL MESH RAILING

Installation Instructions



NOTES:

- » TREX SELECT RAILINGS ARE DESIGNED TO BE INSTALLED OVER THE DECKING FRAME OR ON INSIDE OF RIM JOIST. NOTCHING OF PRESSURE-TREATED POSTS OR POSTS INSTALLED ON OUTSIDE OF RIM JOIST IS NOT ALLOWED.
- » All Trex Select Railing lengths are manufactured at CLEAR SPAN dimensions (spanning between space of posts): 72" for 6' clear span and 96" for 8' clear span. Note that railings are designed to be slightly longer than required to allow for very slight play in post placement trimming may be required. IT IS VERY IMPORTANT TO MEASURE FIRST.
- » IF INSTALLING RAILING OVER 6', THE TREX ALUMINUM RAIL STIFFENER MUST BE USED TO MEET CODE REQUIREMENTS.
- » Trex Aluminum Rail Stiffener is not included in 8' horizontal kits.

Care and Cleaning

Maintaining the appearance of your Trex Select railing is important. Occasional washing is recommended. Over time your railing may show signs of weathering as a result of exposure to the elements. The frequency of cleaning will depend on the environment and exposure to various types of elements.

- » For detailed cleaning recommendations, please refer to the Trex Railing Care and Cleaning guide found on www.trex.com.

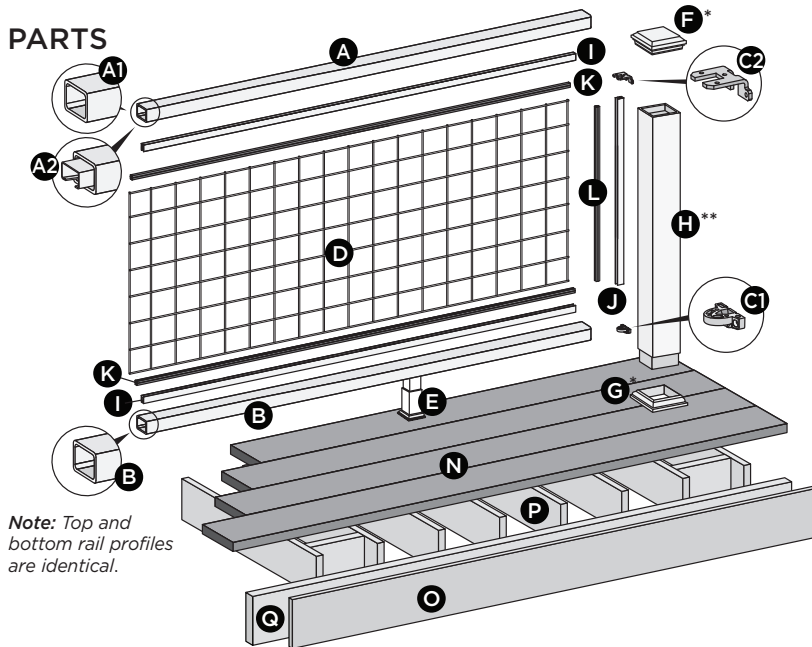

Note: Top and bottom rail profiles are identical.

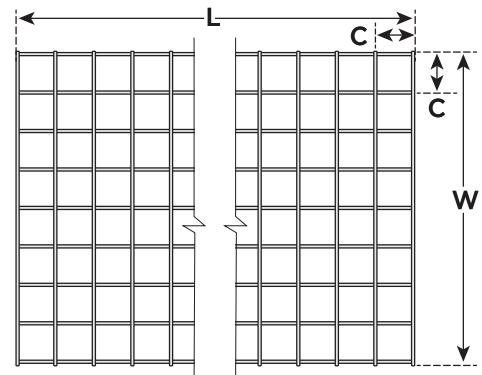

MESH DIMENSIONS CHART			
Carbon Steel-Black			
36" x 6'	36"	72"	4"
36" x 8'	36"	96"	4"
72" x 60"	72"	60"	4"

IMPORTANT NOTE: ALL MESH PANELS WILL HAVE TO BE CUT, SEE DETAILED INSTRUCTIONS REGARDING PROPER CUT SIZES

- A1. Top rail
 - A2. Top Rail with Stiffener (for over 72" installation-not included)
 - B. Bottom Rail
 - C1. Bottom Brackets
 - C2. Top Brackets
 - D. Mesh Panel
 - E. Adjustable foot block
 - F. Post sleeve cap*
 - G. Post sleeve skirt*
 - H. Post sleeve**
 - > Select 4x4 post sleeve
 - > Transcend 4x4 post sleeve
 - > Transcend 6x6 post sleeve
 - I. Top and Bottom Channels
 - J. Vertical Channels
 - K. Top and Bottom Anti-Rattle Gaskets
 - L. Side Anti-Rattle Gaskets
 - M. Mesh Caps (not shown above)
 - N. Trex Decking
 - O. Trex Fascia
 - P. Code-approved Wood Joist - 2" x 8"
 - Q. Code-approved Wood Rim Joist - 2" x 8" or Larger
- * Item not included in the railing kits. Note when using the Select post sleeve, the cap and skirt are included with this post sleeve.
- ** 4" x 4" (102 mm x 102 mm) and 6" x 6" (152 mm x 152 mm) post sleeves are designed to fit over 4x4 pressure-treated post.

NOTES:

- » Ensure pressure-treated posts are installed at proper heights. If installing 42" (1067 mm) railing, use longer post sleeves and measure accordingly to ensure a proper cut. DO NOT CUT TO ACTUAL 42" LENGTH WITHOUT CONFIRMING WHAT STYLE OF RAILING YOU ARE INSTALLING.
- » *See specific installation instructions for attachment of Trex post mounts or Trex Joist Mount Posts prior to installing any railing.

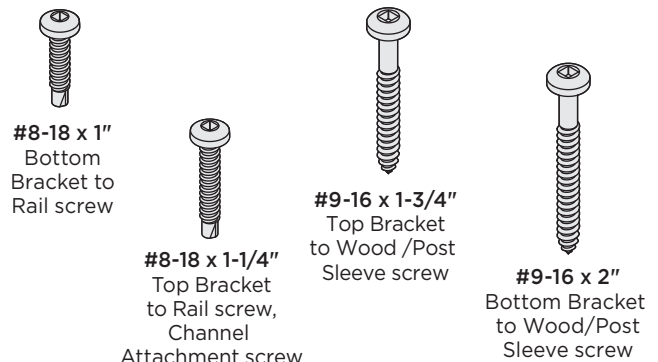

Have Questions?
1-800-BUY-TREX

NOTE: Construction methods are always improving. Please ensure you have the most up-to-date installation instructions by visiting: trex.com

TREX SELECT® HORIZONTAL MESH RAILING

Installation Instructions

HOW TO INSTALL HORIZONTAL MESH RAILING TREX SELECT®

Read all instructions BEFORE installation.

Important: Post sleeves are NOT to be cut for this design style.

Installing Pressure-Treated Posts

1. **PLEASE REFER TO LOCAL BUILDING CODE REQUIREMENTS PRIOR TO ATTACHING PRESSURE TREATED POSTS.**

» Posts are to be installed 6' or 8' clear span to accommodate appropriate railing length.

NOTE: Smaller spans are allowed.

Installing Post Sleeve Skirts and Post Sleeves

2a. If using a 1-piece skirt, slide post sleeve skirt over post and down to rest on decking surface. Slide post sleeve over post and position inside post sleeve skirt.

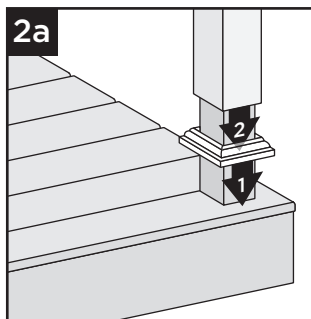

2b. If using a two-piece skirt Slide post sleeve over post and down to rest on decking surface. Snap two piece skirt over post sleeve.

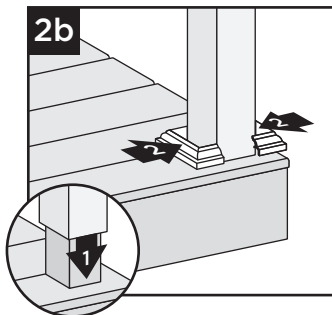

NOTE: Shims can be used to plumb post sleeves.

Cutting Railings (if required)

3a. Position bottom and top rails between posts and mark rails at post locations.

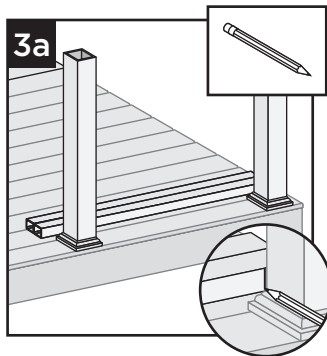

3b. Cut railing at marked locations.

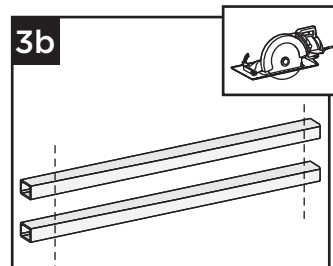

NOTE: For any rail lengths over 6' AND when using aluminum rail stiffener, remove this from the top rail and cut the stiffener 4" shorter than the top rail cut length.

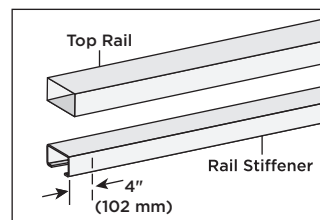

IMPORTANT NOTE REGARDING FOOT BLOCK INSTALLATION:

» Refer to detailed instructions (Trex Select rail instructions) included with foot block prior to installation of railing section as these include other required steps for proper installation.

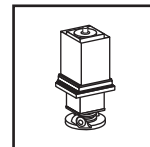

Attaching Foot Block to Bottom Rail and Adding Weep Holes

4a. Invert the bottom rail. Center and drill a hole using a 3/16" (5 mm) drill bit. This will be location for foot block attachment (to be installed last).

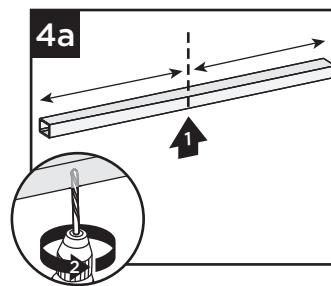

4b. Keeping bottom rail inverted, Use same drill bit, center and drill weep holes through bottom rail at 4 evenly spanned locations to allow for water drainage.

Attaching Bottom Brackets to Bottom Rails

5. Position brackets on each end of BOTTOM RAIL. Attach brackets using three #8-18 x 1" self-drilling screws (provided).

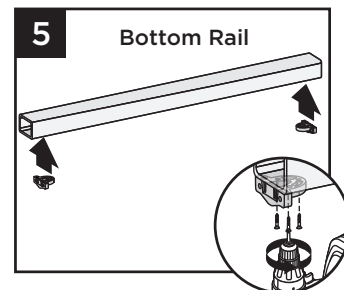

NOTE: For ease of bracket attachment place rail against stationary flat vertical surface along with bracket.

HOW TO INSTALL HORIZONTAL MESH RAILING/CONTINUED TREX SELECT®

6a. Using scrap material (i.e. 2 x 4s, decking boards, etc.) cut at least three support blocks at 3-1/2" (89 mm) in height. Place one each on decking surface beside each post and one near center of span.

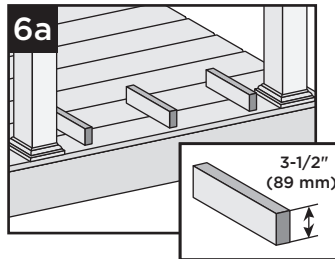

6b. Center bottom rail on support blocks and install bottom brackets on each post using two #9-16 x 2" wood screws (provided). If using a 6x6 post sleeve use two #9-16 x 2 1/2" screws (not provided).

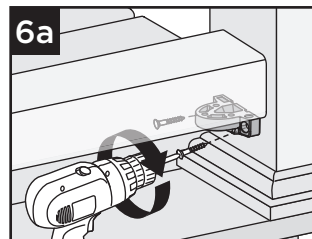

NOTE: screws go in at slight angle.

IMPORTANT NOTE: SET DRILL TO LOW SPEED AND LOW CLUTCH SETTING WHEN INSTALLING THESE SCREWS. DO NOT USE IMPACT DRIVER.

Attaching Foot Block

7. Attach Foot Block per foot block instructions.

Cutting (when required) and Installing Vertical Channels

8a. For 36" rail heights, measure and cut vertical channels to 28 3/4". For 44" rail heights, vertical channels will not require cutting.

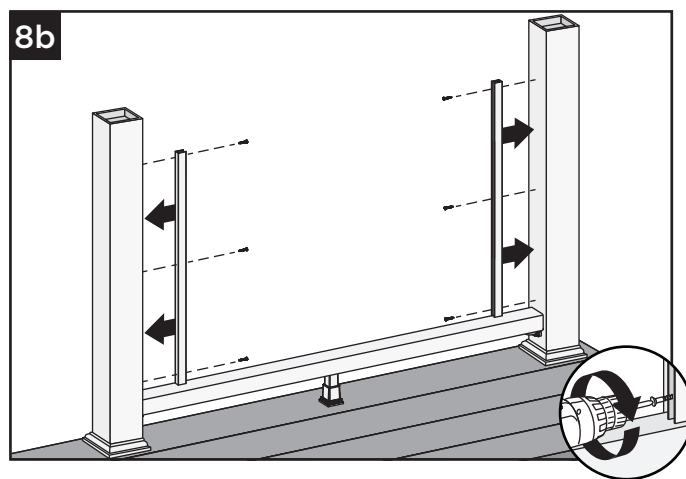

8b. Place vertical channels on bottom rail centered between posts, and attach screws into channel using three #8-18 x 1 1/4" self-drilling screws (provided). Install **lower** and **uppers** screws approximately 1" from each end of vertical channel. Center and install remaining screws.

Measuring and Cutting Top and Bottom Channels (when required)

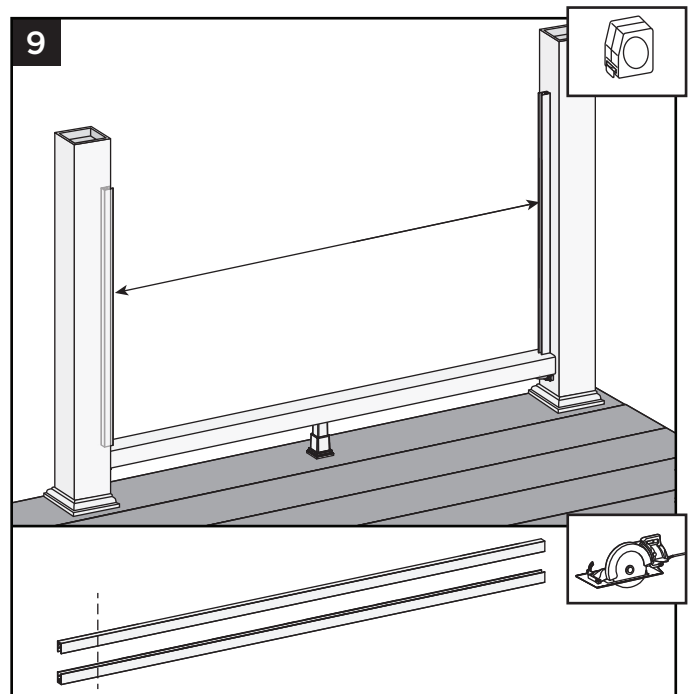

9. Measure distance between vertical channels, and cut top and bottom channels to this length.

Install Bottom Channels

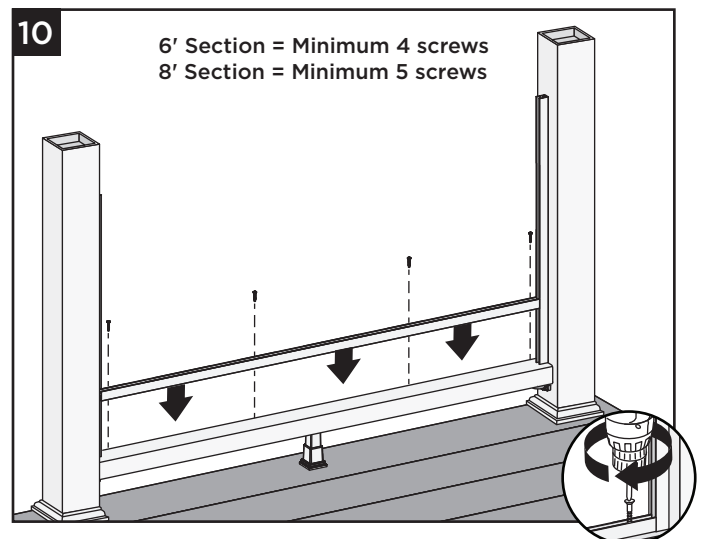

10. Center and install bottom channel using #8-18 x 1 1/4" self-drilling screws (provided), minimum four screws for 6' section and minimum five screws for 8' section.

TREX SELECT® HORIZONTAL MESH RAILING

Installation Instructions

HOW TO INSTALL HORIZONTAL MESH RAILING/CONTINUED TREX SELECT®

Measuring and Cutting Anti-Rattle Gaskets

11a. For 36" rail heights, measure, and cut side anti-rattle gaskets to 27". For 44" rail heights, side anti-rattle gaskets will not require cutting.

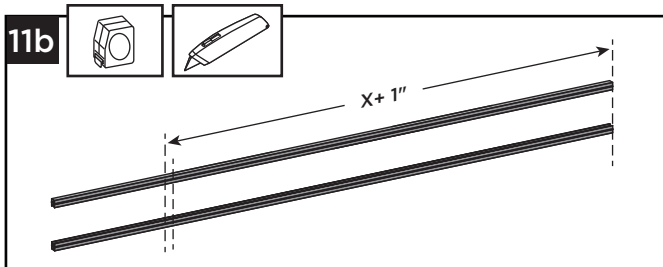

11b. For top and bottom anti-rattle gaskets, using same measurement from top/bottom channels (see step 9), add 1" and cut top and bottom anti-rattle gaskets to this measurement.

Cutting Mesh

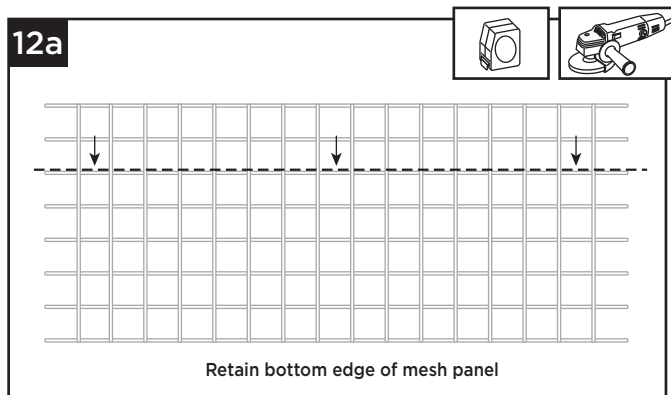

12a. WHEN INSTALLING 36" HEIGHT AT FULL SPAN:
For 36" rail heights, cut the top two rows of the mesh. **DO NOT CUT BOTTOM OF MESH PANEL.**

NOTE: An angle grinder (with proper blade) is recommended for cutting wire mesh. (ALWAYS USE PROPER SAFETY GEAR WHEN CUTTING WITH ANGLE GRINDER.) Note that heavy duty bolt cutters can also be used.

12b. WHEN INSTALLING 44" rail heights, mesh will not require cutting.

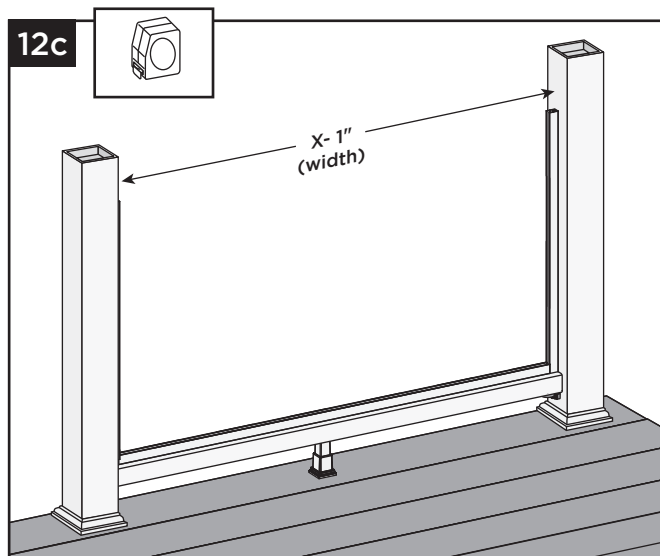

12c. CUTTING MESH WIDTH (REQUIRED FOR ANY SPAN): For width, measure distance between posts and subtract 1", and cut mesh to length calculated.

Installing Mesh Caps

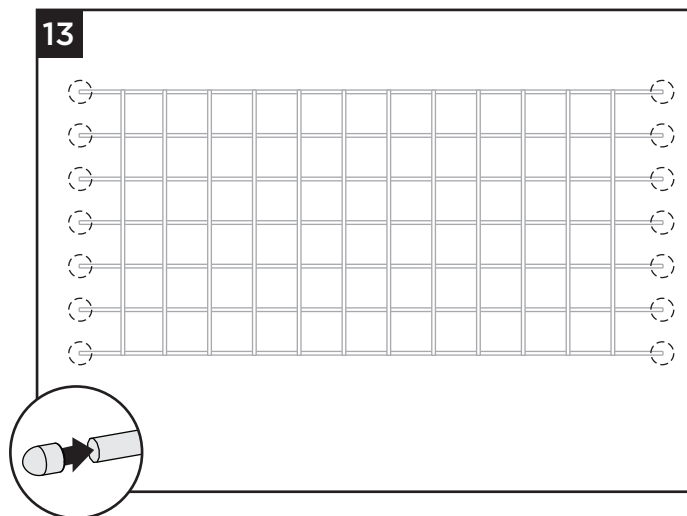

13. Place mesh caps on all cut ends of mesh for corrosion protection.

HOW TO INSTALL HORIZONTAL MESH RAILING/CONTINUED TREX SELECT®

Installing Anti-Rattle Gaskets onto Mesh

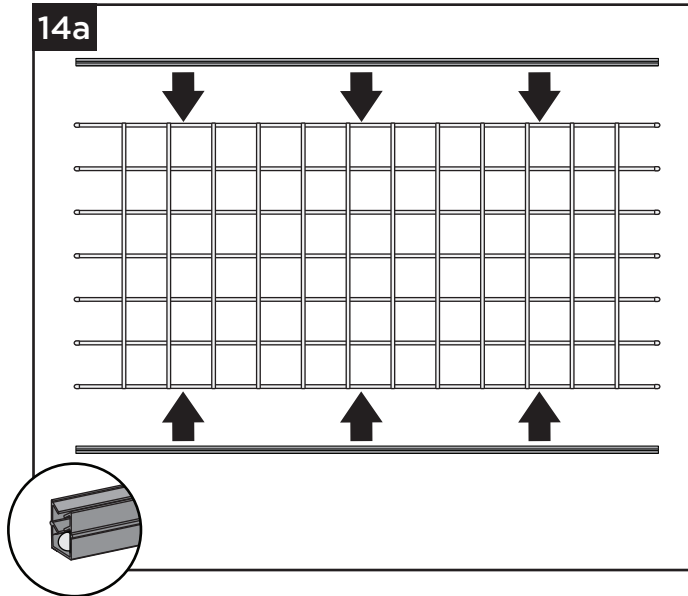

14a. Install top and bottom gaskets onto top and bottom of mesh panel. Make sure gaskets are centered and fully seated onto mesh.

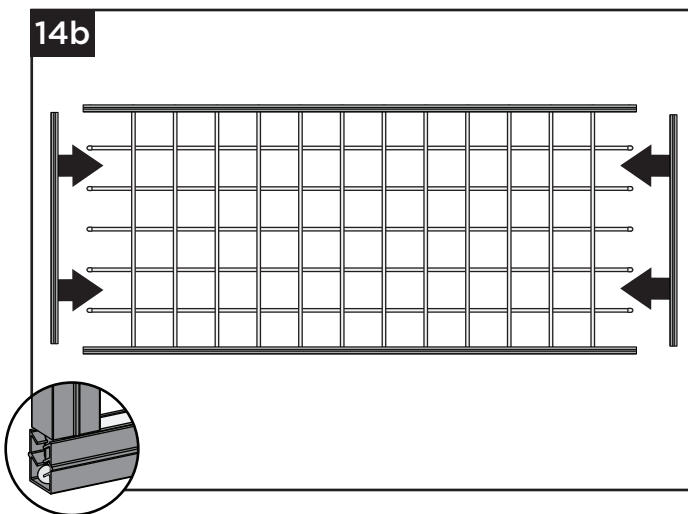

14b. Install side anti-rattle gaskets. Ensure gaskets are full seated.

Attaching Top Brackets on Top Rail

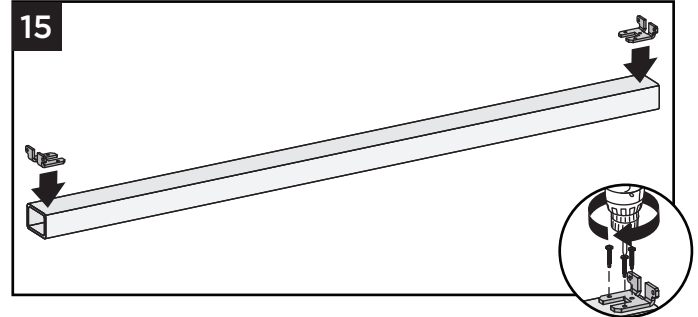

15. Center top brackets on each end of TOP RAIL. Attach bracket using three #8-18 x 1 1/4" self-drilling screws (*provided*).

NOTE: For ease of bracket attachment place rail against stationary flat vertical surface along with bracket.

Installing Top Channel to Top Rail

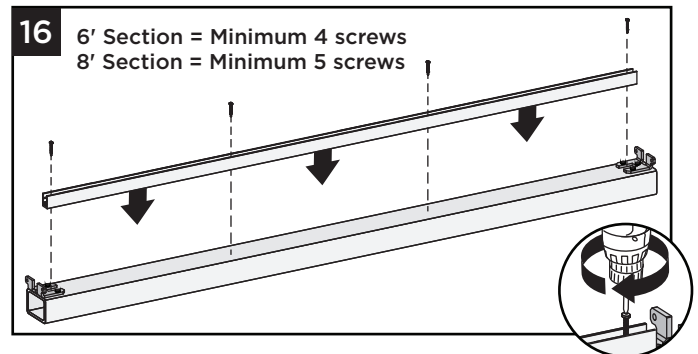

16. Center top channel in between slots in bracket, also centering on rail (**NOTE:** there will be a slight gap on each end between brackets and channel), and install using #8-18 x 1 1/4" self-drilling screws (*provided*): Using a minimum four screws for 6' section and minimum five screws for 8' section.

TREX SELECT® HORIZONTAL MESH RAILING

Installation Instructions

HOW TO INSTALL HORIZONTAL MESH RAILING/CONTINUED TREX SELECT®

Installing Mesh Panel

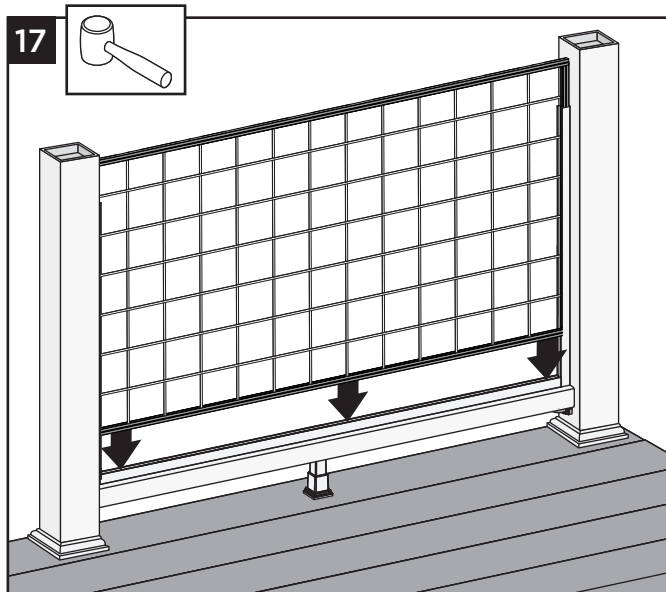

17. Slide mesh panel down into side channels/side anti-rattle gaskets and fully seat into bottom channel/anti-rattle gaskets.

IMPORTANT NOTES:

- » ENSURE THAT THE NON-CUT SIDE OF THE MESH PANEL IS PLACED IN THE BOTTOM CHANNEL.
- » IF NECESSARY USE SOAPY WATER ON THE VERTICAL ANTI-RATTLE GASKETS TO ALLOW MESH PANEL TO SLIDE DOWN MORE EASILY.

Installing Top Rail onto Mesh Panel

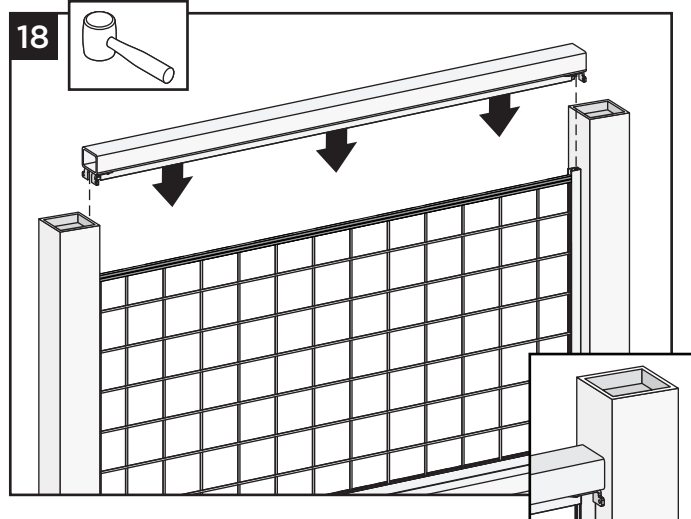

18. Place top rail assembly onto mesh rail, pressing down top rail until brackets fully rest on side channels.

NOTE: Use a rubber mallet if required to fully seat top rail.

19. Secure top bracket to post using two wood #9-16 x 1 3/4" screws (provided).

IMPORTANT NOTE: SET DRILL TO LOW SPEED AND LOW CLUTCH SETTING WHEN INSTALLING THESE SCREWS. DO NOT USE IMPACT DRIVER.

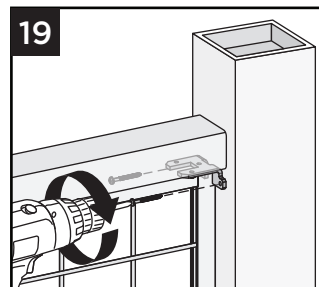

Attaching Post Caps

20. Secure post caps with silicone or PVC adhesive (apply adhesive on the inside self-centering/corner tabs).

NOTE: Clean up any excess adhesive before it dries.

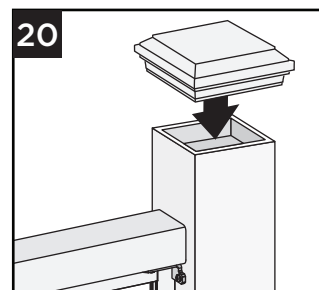

TREX SELECT® MESH STAIR RAILING

Installation Instructions



HOW TO INSTALL SELECT MESH STAIR RAILING TREX SIGNATURE®

TOOLS NEEDED

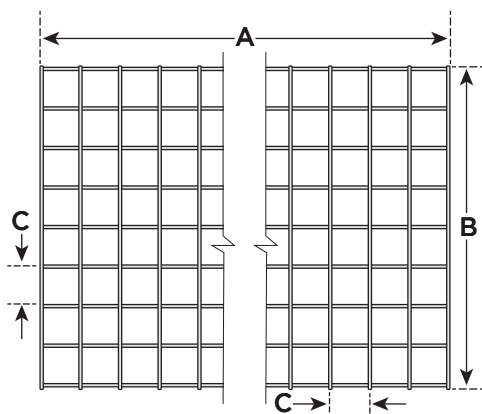
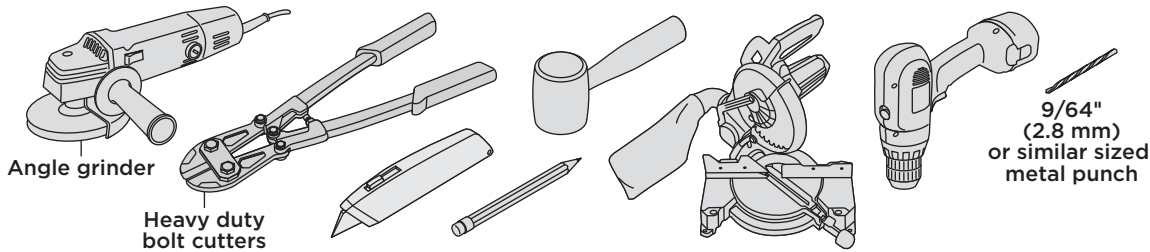

MESH DIMENSIONS CHART			
Carbon Steel - Black			
36" x 6'	36"	72"	4"
36" x 8'	36"	96"	4"
72" x 60"	72"	60"	4"

IMPORTANT NOTE: ALL MESH PANELS WILL HAVE TO BE CUT, SEE DETAILED INSTRUCTIONS REGARDING PROPER CUT SIZES

Screws Provided

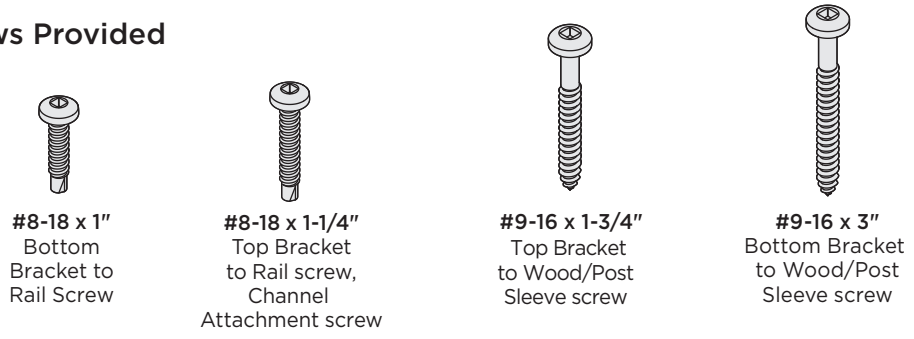

NOTES:

- » TREX SELECT RAILINGS ARE DESIGNED TO BE INSTALLED OVER THE DECKING FRAME OR ON INSIDE OF RIM JOIST. NOTCHING OF PRESSURE-TREATED POSTS OR POSTS INSTALLED ON OUTSIDE OF RIM JOIST IS NOT ALLOWED.
- » POST TO POST SPAN WILL BE LESS THAN 6'. PRIOR TO INSTALLING POSTS CALCULATE POST TO POST SPAN USING A MAXIMUM RAIL LENGTH REQUIRED AND THE ANGLE (32°-37°) AT WHICH THE RAILS WILL BE INSTALLED. DO NOT INSTALL STAIR POSTS AT 6' SPAN, AS STAIR RAILINGS WILL THEN BE TOO SHORT.
- » IF INSTALLING STAIR RAILING OVER 6', THE TREX ALUMINUM RAIL STIFFENER MUST BE USED TO MEET CODE REQUIREMENTS.
- » Trex Aluminum Rail Stiffener is not included in 8' horizontal kits.

Care and Cleaning

Maintaining the appearance of your Trex Select railing is important. Occasional washing is recommended. Over time your railing may show signs of weathering as a result of exposure to the elements. The frequency of cleaning will depend on the environment and exposure to various types of elements.

» For detailed cleaning recommendations, please refer to the Trex Railing Care and Cleaning guide found on www.trex.com.

TREX SELECT® MESH STAIR RAILING

Installation Instructions

PARTS

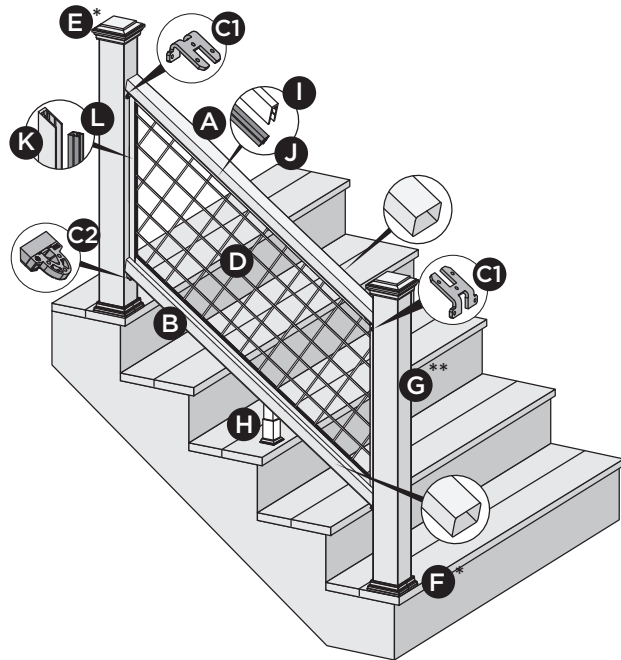

- A. Top Stair Rail
- B. Bottom Stair Rail
- C1. Top Stair Bracket
- C2. Bottom Stair Bracket
- D. Mesh Panel
- E. Post sleeve cap*
- F. Post sleeve skirt*
- G. Post Sleeve*#
 - > Select 4x4 post sleeve
 - > Transcend 4x4 post sleeve
 - > Transcend 6x6 post sleeve
- H. Adjustable foot block (quantity of one is required for all railing span lengths)
- I. Top and Bottom Channels
- J. Top and Bottom Anti-Rattle Gaskets
- K. Side Channels
- L. Side Anti-Rattle Gaskets
- M. Mesh Caps (not shown)

* Item not included in the Select railing kits.
Note: when using the Select post sleeve, the cap and skirt are included with this post sleeve.

*# 4" x 4" (102 mm x 102 mm) and 6" x 6" (152 mm x 152 mm) post sleeves are designed to fit over 4x4 pressure-treated post.

HOW TO INSTALL HORIZONTAL MESH RAILING

TREX SELECT®

1. Installing Pressure-Treated Posts

- » PLEASE REFER TO LOCAL BUILDING CODE REQUIREMENTS PRIOR TO ATTACHING PRESSURE TREATED POSTS.
- » PRESSURE TREATED POSTS MUST BE INSTALLED ON INSIDE OF STAIR STRINGER AND AT NOSE OF STAIR TREAD.
- » POST TO POST SPAN WILL BE LESS THAN 6'. PRIOR TO INSTALLING POSTS CALCULATE POST TO POST SPAN USING A MAXIMUM RAIL LENGTH REQUIRED AND THE ANGLE (32°- 37°) AT WHICH THE RAILS WILL BE INSTALLED. DO NOT INSTALL STAIR POSTS AT 6' SPAN, AS STAIR RAILINGS WILL THEN BE TOO SHORT.
- » Post sleeve longer than 39" (991 mm) will be needed on the lower section of stair rail to accommodate stair angle.

Installing Post Sleeve Skirts and Post Sleeves

- 2a. When using the Select post sleeve and one-piece skirt, slide post sleeve skirt over post and down to rest on decking surface. Slide post sleeve over post and position inside post sleeve skirt.

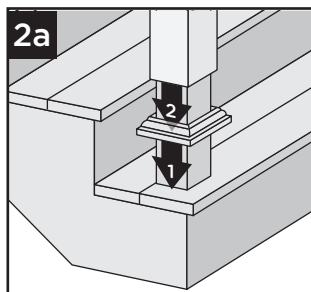

- 2b. When using the Transcend post sleeve and two-piece skirt, slide post sleeve over post and down to rest on decking surface. Snap two piece skirt over post sleeve.

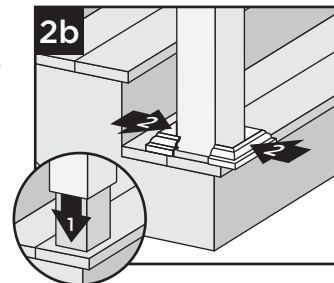

Note: Shims can be used to plumb post sleeves.

Measuring and Cutting Bottom Rail

3. Place a 1" deckboard on the nose of the stair tread.

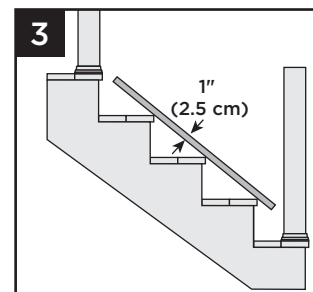

HOW TO INSTALL MESH STAIR RAILING TREX SELECT®

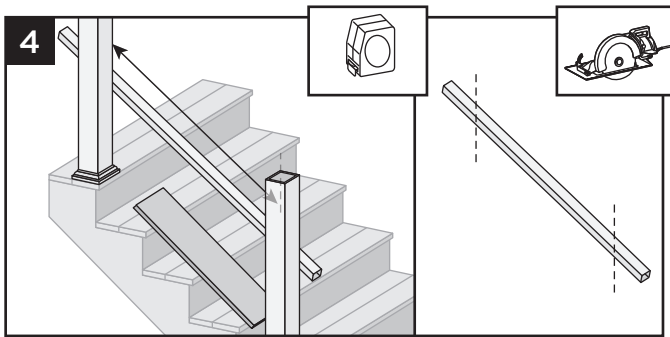

4. Set bottom rail on top of deckboard. Mark rail at post locations and cut bottom rail. **ENSURE POSTS ARE PLUMB BEFORE CUTTING RAILING.**

NOTE: For any rail lengths over 6' AND when using aluminum rail stiffener, remove this from the top rail and cut the stiffener 4" shorter than the top rail cut length.

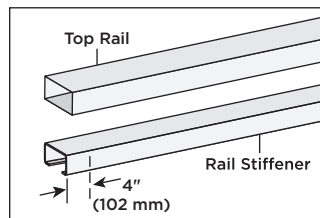

IMPORTANT NOTE REGARDING FOOT BLOCK INSTALLATION:

» Refer to detailed instructions (Trex Select rail instructions) included with foot block prior to installation of railing section as these include other required steps for proper installation.

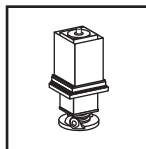

Marking Location for Foot Block to Bottom Rail

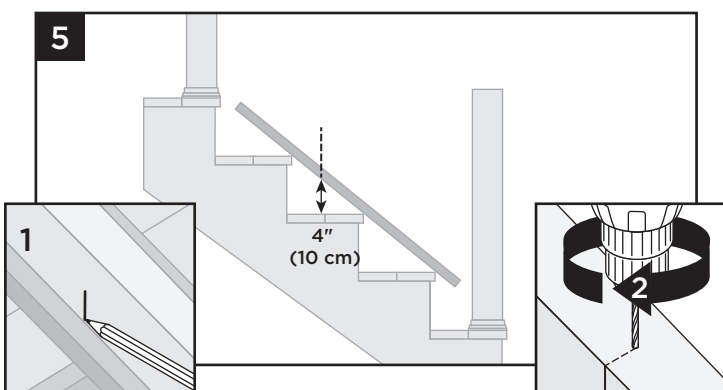

5. Mark approximate location for foot block, allowing a measurement of 4" maximum. Invert the bottom rail, and at marked location drill a hole using a 3/16" drill bit in the center of the channel. Foot block is to be installed at last step.

Attaching Brackets to Bottom Rail

6. Snap the top stair adaptor bracket (labeled TOP) to the standard bracket. Repeat for remaining bottom bracket.

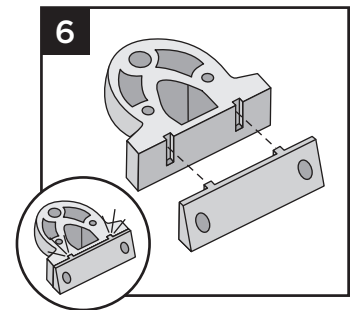

TIP: Use a dab of super glue when snapping bracket together. This will help stabilize bracket when installing.

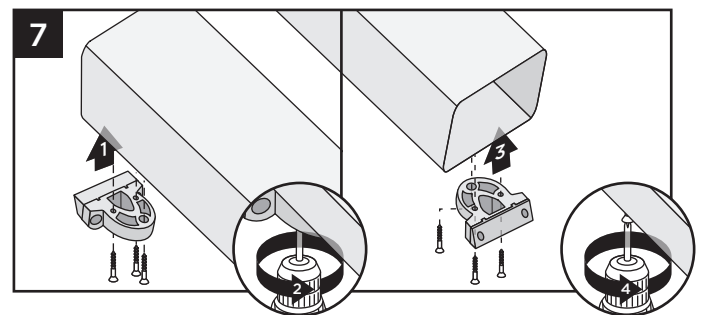

7. On the BOTTOM RAIL, attach the assembled bottom stair brackets to the OPPOSITE SIDE of the baluster holes. Attach both brackets using three #8-18x1" selfdrilling screws (provided).

Attachment of Bottom Rail to Post

NOTE: For attachment of brackets to posts, use at least a 3" long drill bit or extension so as not damage sides of rails when installing.

TIP: Pre-drill prior to screw installation using a 7/64" drill bit

- 8a. Keeping deck board on stair treads, center bottom rail between posts and attach bottom rail stair bracket to upper post using two #9-16 x 3" wood screws (provided).

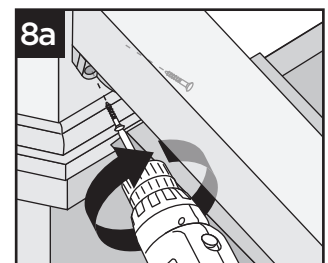

TREX SELECT® MESH STAIR RAILING

Installation Instructions

HOW TO INSTALL MESH STAIR RAILING/CONTINUED TREX SELECT®

- 8b. Attach bottom stair rail stair bracket to lower post using two #9-16 x 3" wood screws (*provided*). (deck board can now be removed).

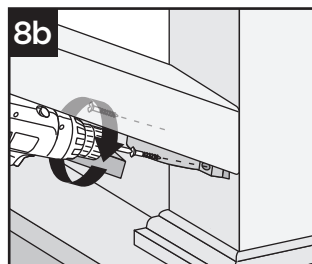

IMPORTANT NOTE:
SET DRILL TO LOW SPEED AND LOW CLUTCH SETTING WHEN INSTALLING THESE SCREWS. DO NOT USE IMPACT DRIVER.

Mark Location for Top Rail Height and Mark Location for Cutting Top Rail

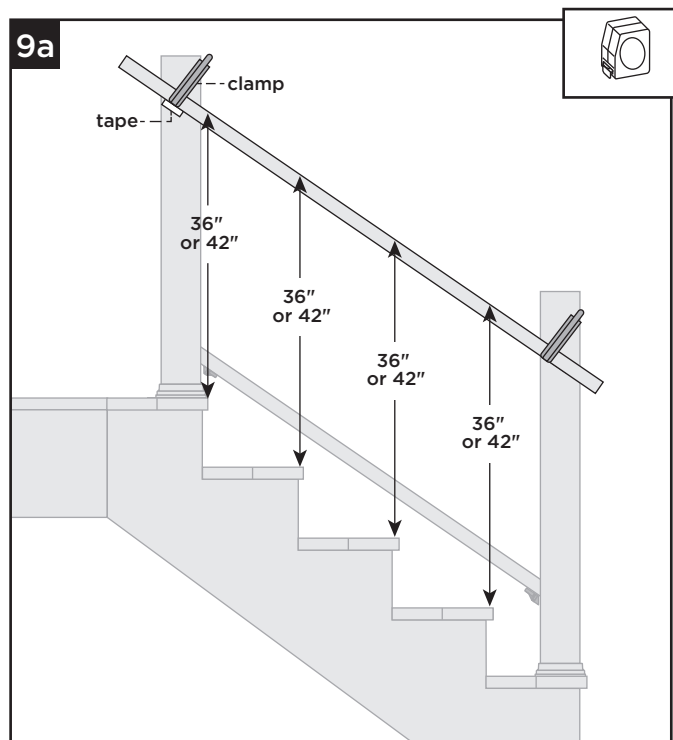

- 9a. Measure up from front/nose of stair treads as listed above depending on your rail height. Ensure that the measurement is the same at each location. Temporarily clamp top rail in this location, ensuring its parallel to bottom rail. Use a removable tape to mark intersection at top and bottom post. Do not remove top rail until after step 10.

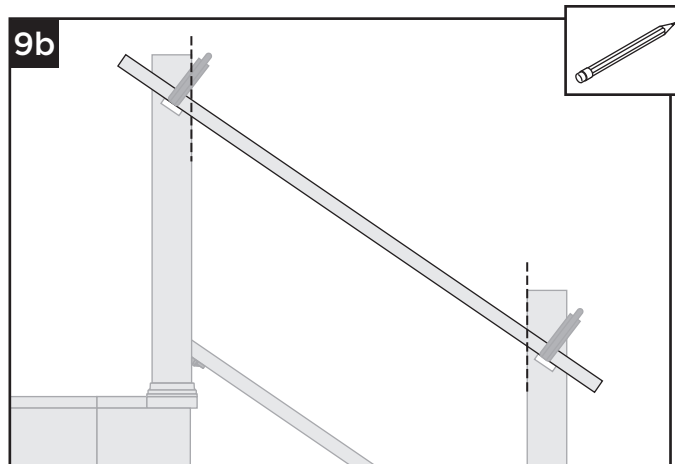

- 9b. Mark top rail at intersection of posts. Do not remove top rail until after step 10.

Cutting and Installing Vertical Channels

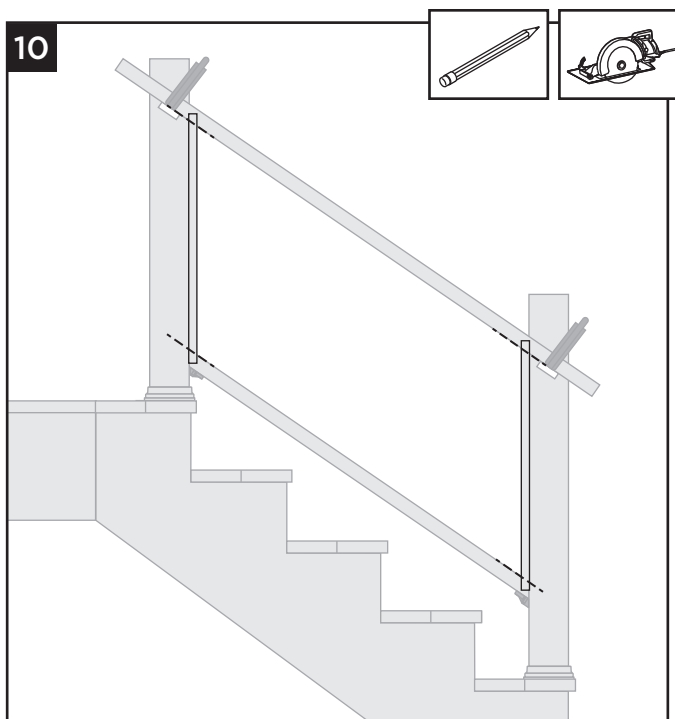

10. With top rail still in place, align vertical channels against the inside of each post, mark at intersections on top and bottom rails and cut at these locations. Remove the top rail.

HOW TO INSTALL MESH STAIR RAILING/CONTINUED TREX SELECT®

Installing Vertical Channels

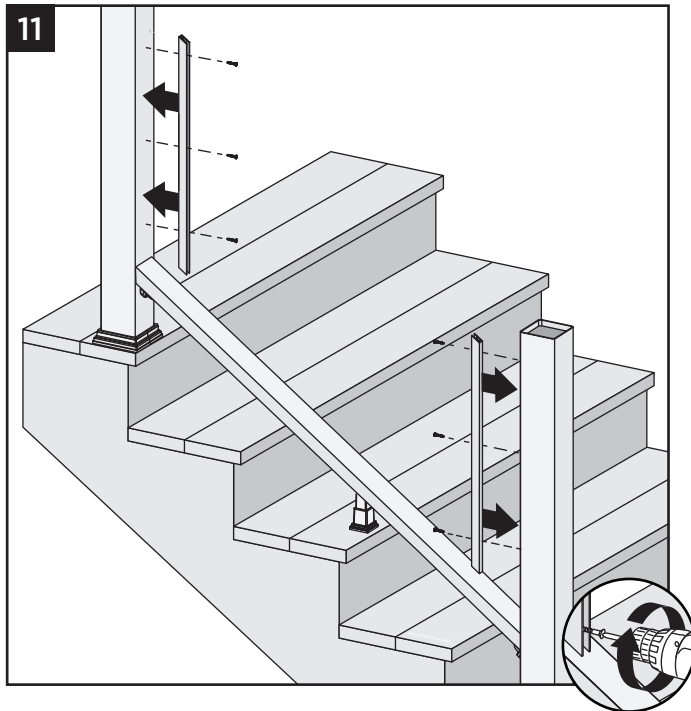

11. Center vertical channel between posts, and attach screws into channel using three #8-18 x 1/14" self-drilling screws (provided). Install lower and upper screws approximately 1" from each end of channel. Center and install remaining screws.

Measuring and Cutting Bottom and Top Channel

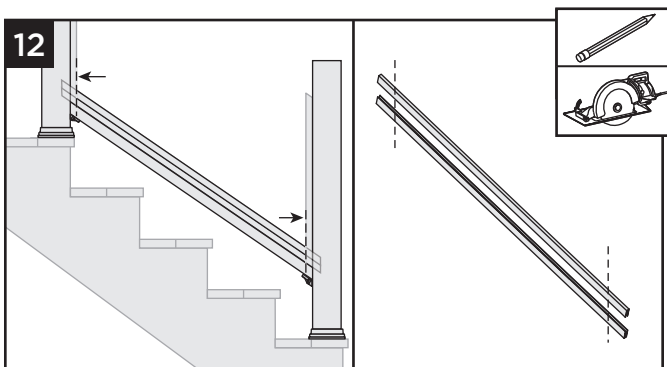

12. Align bottom and top channel so they run parallel to bottom rail, mark at location where these intersect with the side verticals, and cut both bottom and top channel to this length.

Installing Bottom Channel

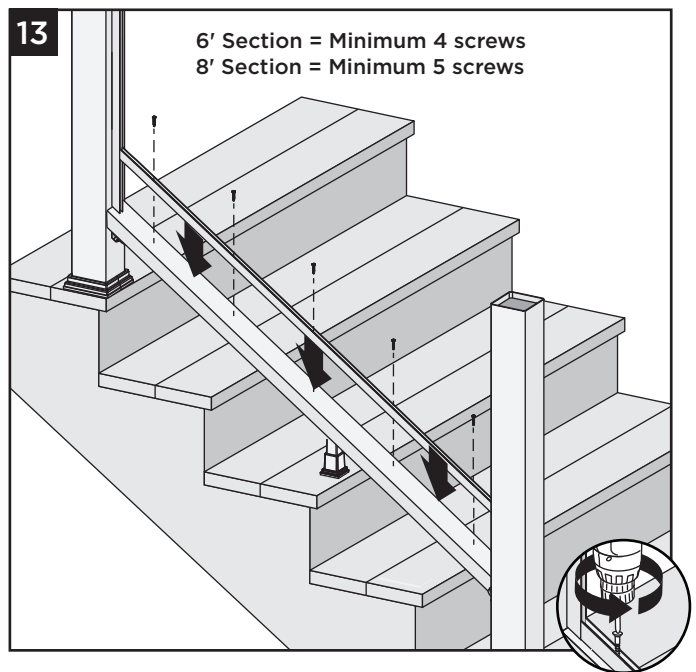

13. Center and install bottom channel using #8-18 x 1 1/4" self-drilling screws (provided), minimum 4 screws for 6' section and 5 screws for 8' section.

Measuring and Cutting Top and Bottom Anti-Rattle Gaskets

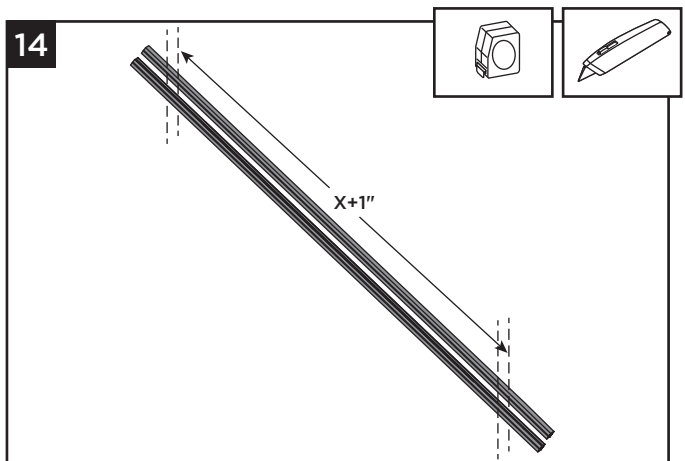

14. Using same measurement from top/bottom channels (see step 12, add 1" and cut top and bottom anti-rattle gaskets to this measurement).

NOTE: Both sides will have to be cut to accommodate angle.

TREX SELECT® MESH STAIR RAILING

Installation Instructions

HOW TO INSTALL MESH STAIR RAILING/CONTINUED TREX SELECT®

Cutting Side Anti-Rattle Gaskets

15. Using same measurement from side verticals (see step 10) subtract 1 3/4" and cut side gaskets at same angles as the verticals

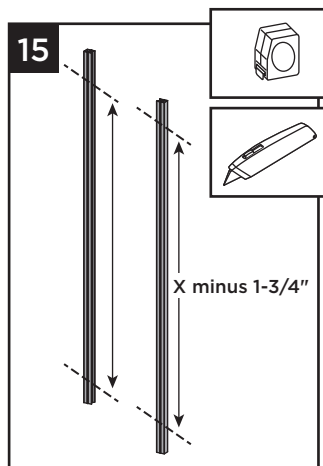

Cutting Top Rail and Attaching Top Stair Brackets

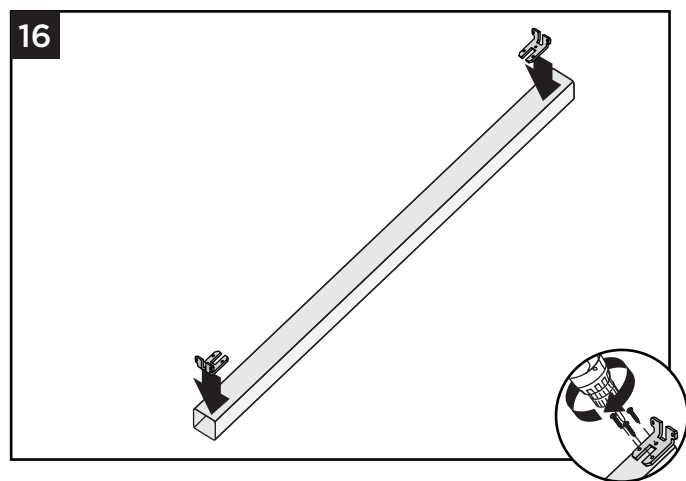

16. Cut top rail at previous marked locations. Center top stair brackets on each end of TOP RAIL. Attach brackets by placing end of rail onto flat surface along with back part of bracket, and attach using three #8-18 x 1 1/4" self-drilling screws (provided).

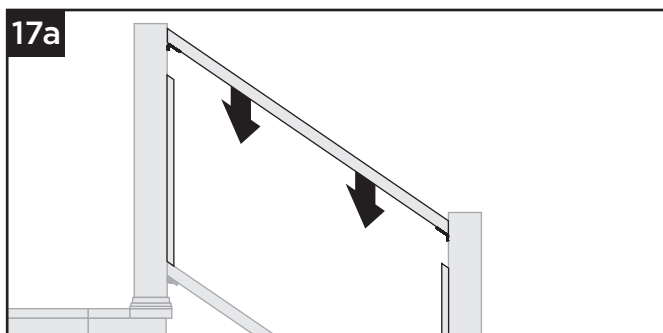

- 17a. Clamp or loosely place top rail onto side channels.

Measuring and Cutting Mesh Panels

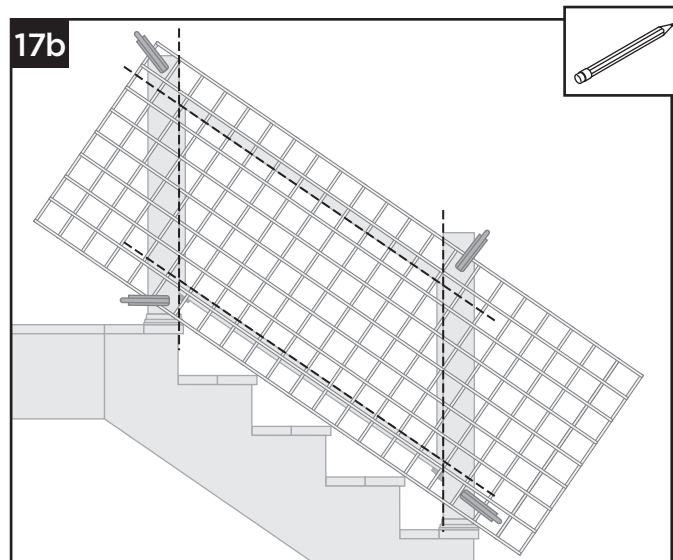

- 17b. Rest mesh panel on stair treads, and ensure mesh panel is running parallel to bottom rail. Mark mesh where this intersects at inside of rails and posts.

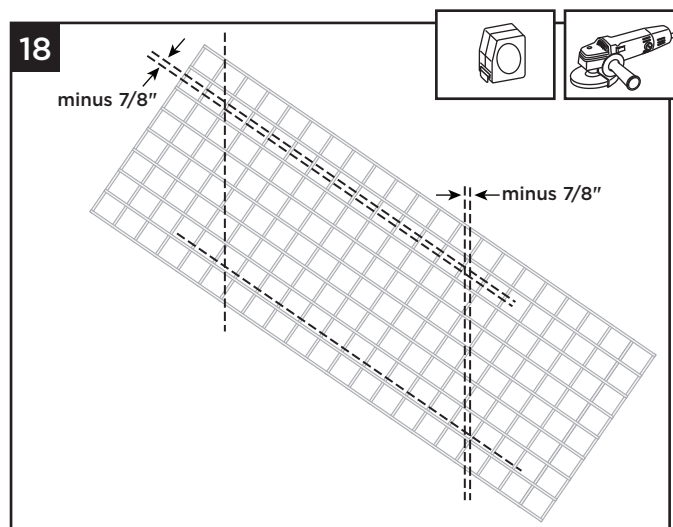

18. Remove mesh panel. Subtract 7/8" from top of mesh, and only ONE SIDE of mesh and mark these locations. Cut at all marked lines.

NOTE: An angle grinder (with proper blade) is recommended for cutting wire mesh. (ALWAYS USE PROPER SAFETY GEAR WHEN CUTTING WITH ANGLE GRINDER.) Note that heavy duty bolt cutters can also be used.

HOW TO INSTALL MESH STAIR RAILING/CONTINUED TREX SELECT®

Measuring and Cutting Top Channel

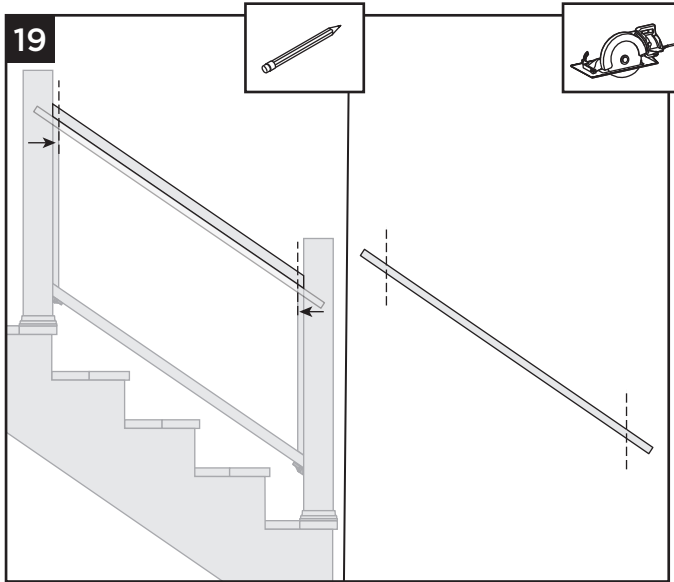

19. With top rail still in place align top channel so it runs parallel to the top rail, mark at locations where this intersects with the side channels as shown, and cut.

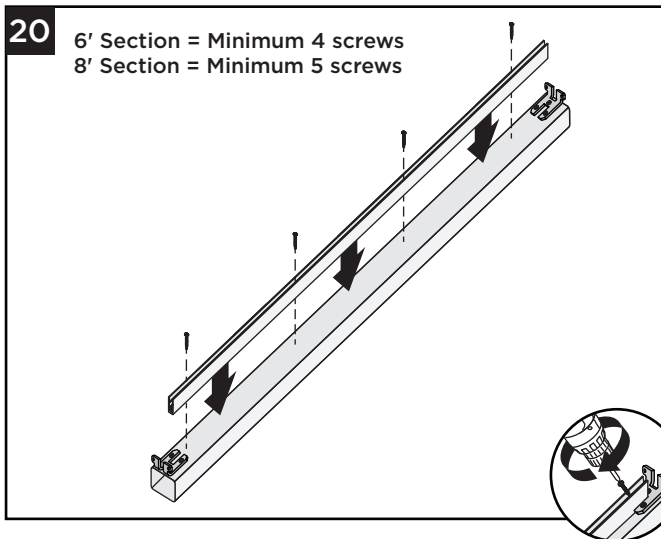

20. Remove top rail, and center top channel between slots in brackets and centering on rail (NOTE: There may be a slight gap on each end between brackets and channel), and install using #8-18 x 1 1/4" self-drilling screws (provided): Using minimum 4 screws for 6' section and minimum 5 screws for 8' section.

Install Mesh Caps

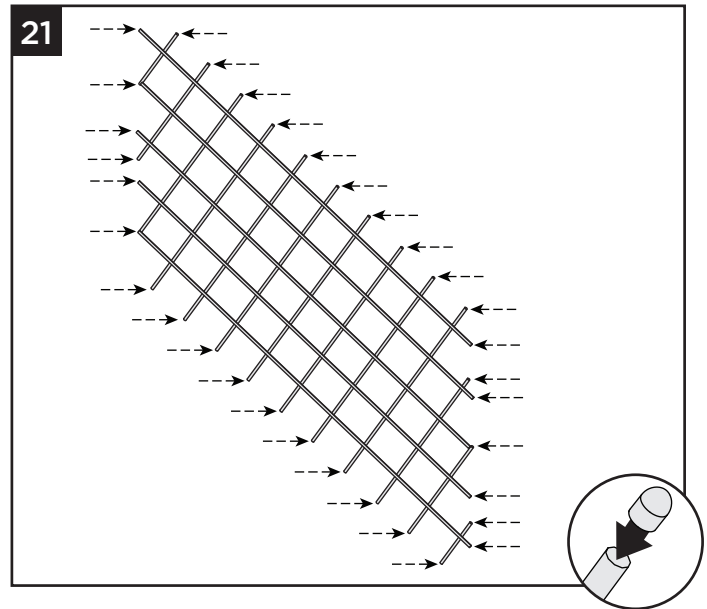

21. Install mesh caps on all cut ends.

Install Anti-Rattle Gaskets onto Mesh

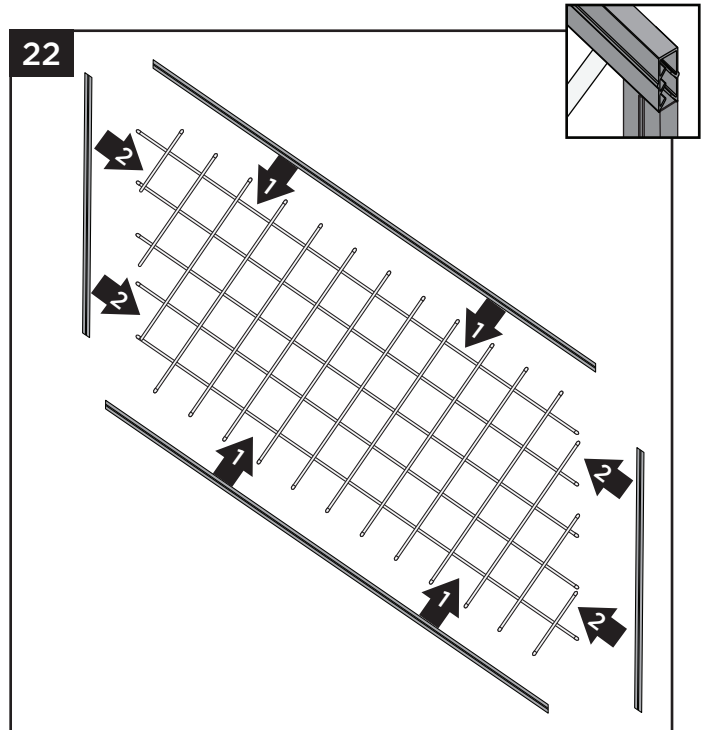

22. Install top and bottom gaskets onto mesh panel, followed by side gaskets. Make sure all gaskets are centered and fully seated.

TREX SELECT® MESH STAIR RAILING

Installation Instructions

HOW TO INSTALL MESH STAIR RAILING/CONTINUED TREX SELECT®

Installing Mesh Panel

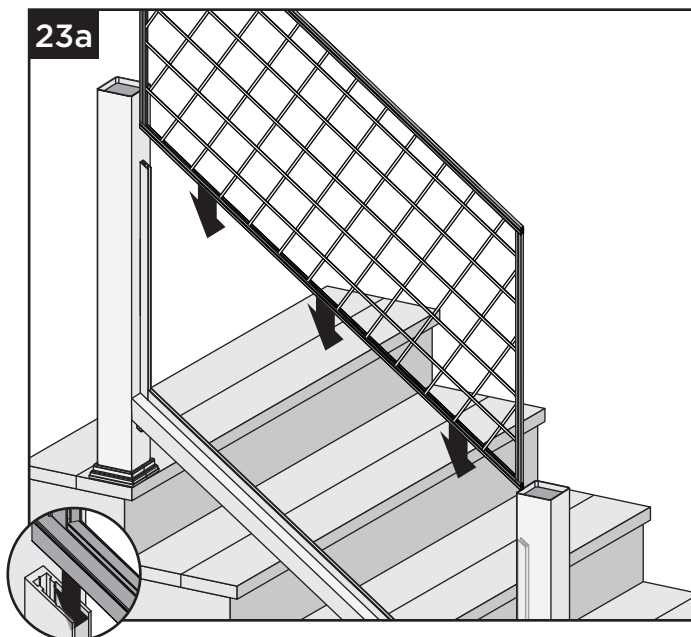

23a. Insert mesh panel with anti-rattle gaskets into side channels.

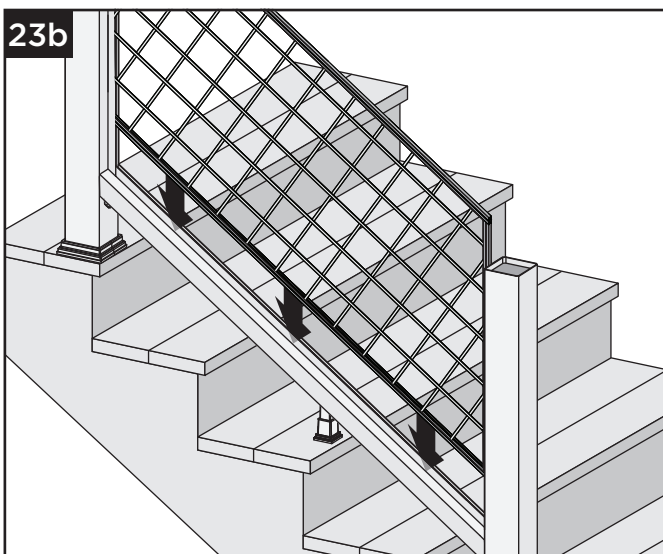

23b. Push mesh firmly into the bottom and side gaskets.

IMPORTANT NOTE: IF NECESSARY USE SOAPY WATER ON THE VERTICAL ANTI-RATTLE GASKETS TO ALLOW MESH PANEL TO SLIDE DOWN MORE EASILY.

Installing Top Stair Rail onto Mesh Panel

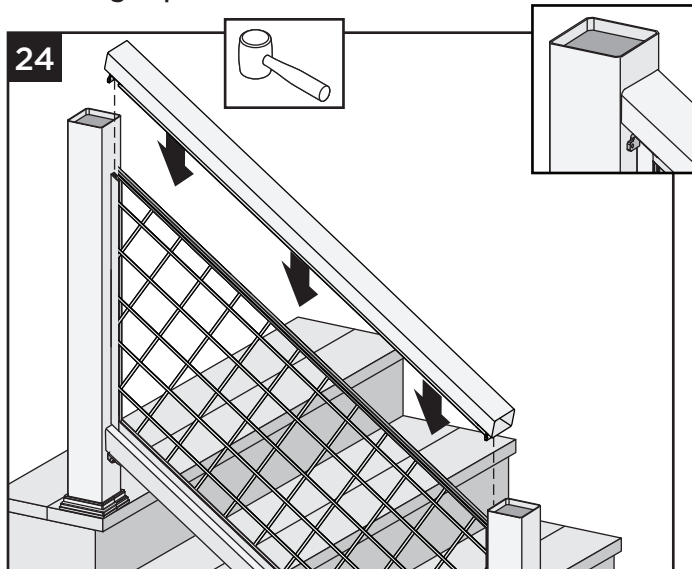

24. Place top rail assembly onto mesh rail, pressing down top rail until brackets fully rest on side channels.

NOTE: Use a rubber mallet if required to fully seat top rail.

25. Secure top bracket to post using two #9-16 x 1 3/4" screws (provided).

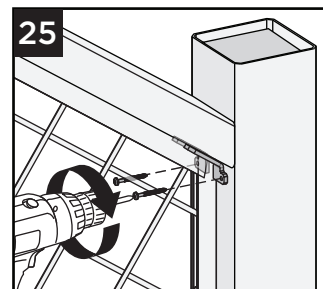

Attaching Post Caps

26. Secure post caps with silicone or PVC adhesive (apply adhesive on the inside self-centering/corner tabs).

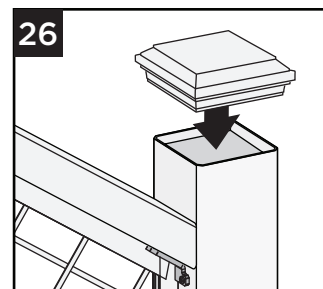

NOTE: Clean up any excess adhesive before it dries.