



Specification Features

- CORNER SHOWER WALL KIT
- CONFIGURATION: THREE WALL ALCOVE
- PATTERN: TRADITIONAL SUBWAY 12X24 IN WHITE
- DURABLE SOLID SURFACE MATERIAL. EASY TO CLEAN
- TRIM-TO-SIZE PANELS CAN BE CUT DIRECTLY ON-SITE
- INSTALL AGAINST A SOLID SURFACE

Technical Information

- Model: DreamStone
- Backwalls Style: Traditional Subway Pattern
- Backwalls Type: Three Wall Alcove
- Dimensions: 36 in. x 50 in. x 84 in.
- Product Width: 50 in.
- Product Depth: 36 in.
- Product Height: 84 in.
- Color: White

Shower Backwalls Finish

 White

Model SKU#:

WKDS503684XTS00 - Traditional Subway Pattern

Traditional Subway

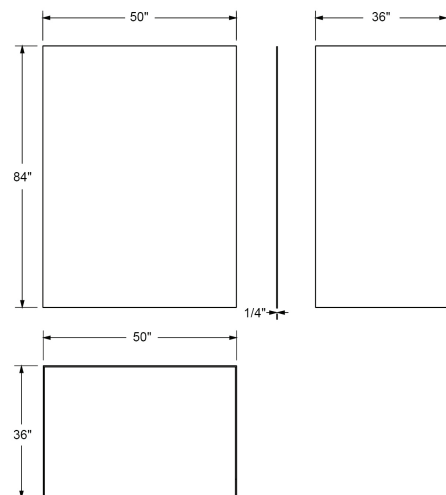
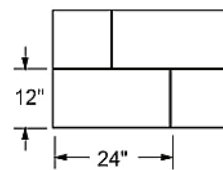

Product Details

Important Notes



Detailed Shot



Base Is NOT included

The DreamStone collection offers popular horizontal subway patterns without the hassle of difficult installation. The durable, non-porous solid surface material makes DreamStone wall panels resistant against mold, chips, and cracks while maintaining its beautiful color for years to come.

Please read Installation Manual thoroughly prior to installing this product.

Trim-to-size panels can be cut directly on-site.

Install against a solid surface, such as wonder-board or greenboard (not directly to studs).

Important Disclaimers

Please note that you should consult your local building codes with questions on installation compliance standards. Building and plumbing codes may vary by location, and DreamLine® is not responsible for code compliance standards for your project and will not accept any returns.

For commercial customers, we strongly recommend the use of Dreamline's Onsite Contractor Support option.

Dreamline's commercial warranty does not apply to damage or losses resulting from (i) other than normal and proper use and normal service conditions; (ii) improper installation, (iii) installation in or upon an unsuitable surface or areas; (iv) abuse, (v) accident, (vi) alteration, (vii) misuse, (viii) neglect, (ix) unauthorized repair or the failure to utilize suitably qualified and trained persons to perform service and/or repair of the Product, (x) improper maintenance, (xi) failure to follow installation, operating, cleaning or maintenance instructions, and (xii) use of "non-authorized" parts.