

HOMEDICS®

LEADERS IN HEALTH & WELLBEING

✓ Register your product today at
www.homedics.co.uk/product-registration



 mychill™ plus

PERSONAL
SPACE COOLER 2.0

.....
instruction manual

PAC-35WT-EU2

3 YEAR guarantee

READ ALL INSTRUCTIONS BEFORE USE.
SAVE THESE INSTRUCTIONS FOR FUTURE
REFERENCE.

IMPORTANT SAFEGUARDS:

WHEN USING ELECTRICAL PRODUCTS,
ESPECIALLY WHEN CHILDREN ARE PRESENT,
BASIC SAFETY PRECAUTIONS SHOULD
ALWAYS BE FOLLOWED, INCLUDING THE
FOLLOWING:

- ALWAYS unplug the appliance from the electrical outlet immediately after using and before cleaning. To disconnect, turn all controls to the 'OFF' position, then remove plug from outlet.
- NEVER leave an appliance unattended when plugged in. Unplug from the mains outlet when not in use and before putting on or taking off parts or attachments.
- This appliance can be used by children aged from 8 years and above and persons with reduced physical, sensory or mental capabilities or lack of experience and knowledge if they have been given supervision or instruction concerning use of the appliance in a safe way and understand the hazards involved. Children shall not play with the appliance. Cleaning and user maintenance shall not be made by children without supervision.
- DO NOT reach for an appliance that has fallen in water or other liquids. Switch off at the mains and unplug it immediately. Keep dry – DO NOT operate in wet or moist conditions.
- NEVER insert pins or other metallic fasteners into the appliance.
- Use this appliance for the intended use as described in this booklet. DO NOT use attachments not recommended by HoMedics.
- NEVER operate the appliance if it has a damaged cord or plug, if it is not working properly, if it has been dropped or damaged, or dropped into water. Return it to the HoMedics Service Centre for examination and repair.
- Keep cord away from heated surfaces.
- Excessive use could lead to the product's excessive heating and shorter life. Should this occur, discontinue use and allow the unit to cool before operating.
- NEVER drop or insert any object into any opening.
- DO NOT operate where aerosol (spray) products are being used or where oxygen is being administered.
- DO NOT operate under a blanket or pillow. Excessive heating can occur and cause fire, electrocution or injury to persons.
- DO NOT carry this appliance by the cord or use cord as a handle.
- DO NOT use outdoors.
- This product requires a 220-240 V AC power.
- DO NOT attempt to repair the appliance. There are no user serviceable parts. For service, send to a HoMedics Service Centre. All servicing of this appliance must be performed by authorised HoMedics service personnel only.
- Never block the air openings of the appliance. Keep air openings free of lint, hair etc.
- Do not place or store appliance where it can fall or be pulled into a bath or sink. Do not place in or drop into water or other liquid.
- Failure to follow the above may result in the risk of fire or injury.

SAFETY CAUTIONS:

PLEASE READ THIS SECTION CAREFULLY BEFORE USING THE APPLIANCE.

- **If you have any concerns regarding your health, consult a doctor before using this appliance.**
- This appliance should NEVER be used by any individual suffering from any physical ailment that would limit the user's capacity to operate the controls.
- If the product feels excessively hot, switch off at mains and contact the HoMedics Service Centre.
- This appliance is designed for personal, non-professional use only.
- Do not run cord under carpeting. Do not cover cord with throw rugs, runners or similar coverings. Do not route cord under furniture or appliances. Arrange cord away from traffic areas where it can be tripped over.
- Do not tilt or move the personal space cooler while it is in operation. Shut off and remove plug from outlet before moving.
- Always plug the Personal Space Cooler Plus directly into a wall outlet/receptacle. Never use with an extension cord.
- Be aware that high humidity levels may encourage the growth of biological organisms in the environment.
- Do not permit the area around the humidifier to become damp or wet. If dampness occurs, turn the output of the humidifier down. If the humidifier output volume cannot be turned down, use the humidifier intermittently. Do not allow absorbent materials, such as carpeting, curtains, drapes, or tablecloths, to become damp.
- Unplug the appliance during filling and

cleaning.

- Never leave water in the reservoir when the appliance is not in use.
- Empty and clean the humidifier before storage. Clean the humidifier before next use.
- **Warning:** Micro-organisms that may be present in the water or in the environment where the appliance is used or stored, can grow in the water reservoir and be blown in the air causing very serious health risks when the water is not renewed and the tank is not cleaned properly every 3 days.
- Empty the tank and refill every third day. Before refilling, clean it with fresh tap water or cleaning agents if required by the manufacturer. Remove any scale, deposits, or film that has formed on the sides of the tank or on interior surfaces, and wipe all surfaces dry.
- The instructions for ultrasonic humidifiers and impeller humidifiers provided with specific antibacterial components to be added to the water, shall state, if relevant, the type or characteristics of the antibacterial component to be used and shall clarify that these additives shall be added to the water at each refilling.

MAINTENANCE:

Cleaning

Unplug from the mains and use a soft damp cloth to clean the fabric if required. Never saturate the mat or use harsh chemical cleaners. No other maintenance is required.

Storage

Place the appliance in its box or in a safe, dry, cool place. Avoid contact with sharp edges or pointed objects which might cut or puncture the fabric surface. To avoid breakage, DO NOT wrap the power cord around the appliance. DO NOT hang the unit by the cord.

PRODUCT FEATURES:

Indoor Personal Space Cooling

This HoMedics MyChill™ Indoor Personal Space Cooler Plus is designed to reduce the temperature up to 12°F / 6.6°C and has a relaxing cooling effect up to 6 FT / 1.8 M from the front of the unit. The cooling effect increases as the relative humidity decreases. The dryer the surrounding air, the more cooling you get. The higher the relative humidity, the less cooling you get. The personal space cooler is most effective when used in warmer and less humid indoor conditions where the humidity is less than 60%.

It is designed for use in the office, dorm room, bedside, kitchen, or anywhere you want to cool your indoor personal space. HoMedics MyChill™ Indoor Personal Space Cooler Plus provides natural and efficient cooling, has low power consumption, no compressor, and does not use any ozone depleting refrigerants.

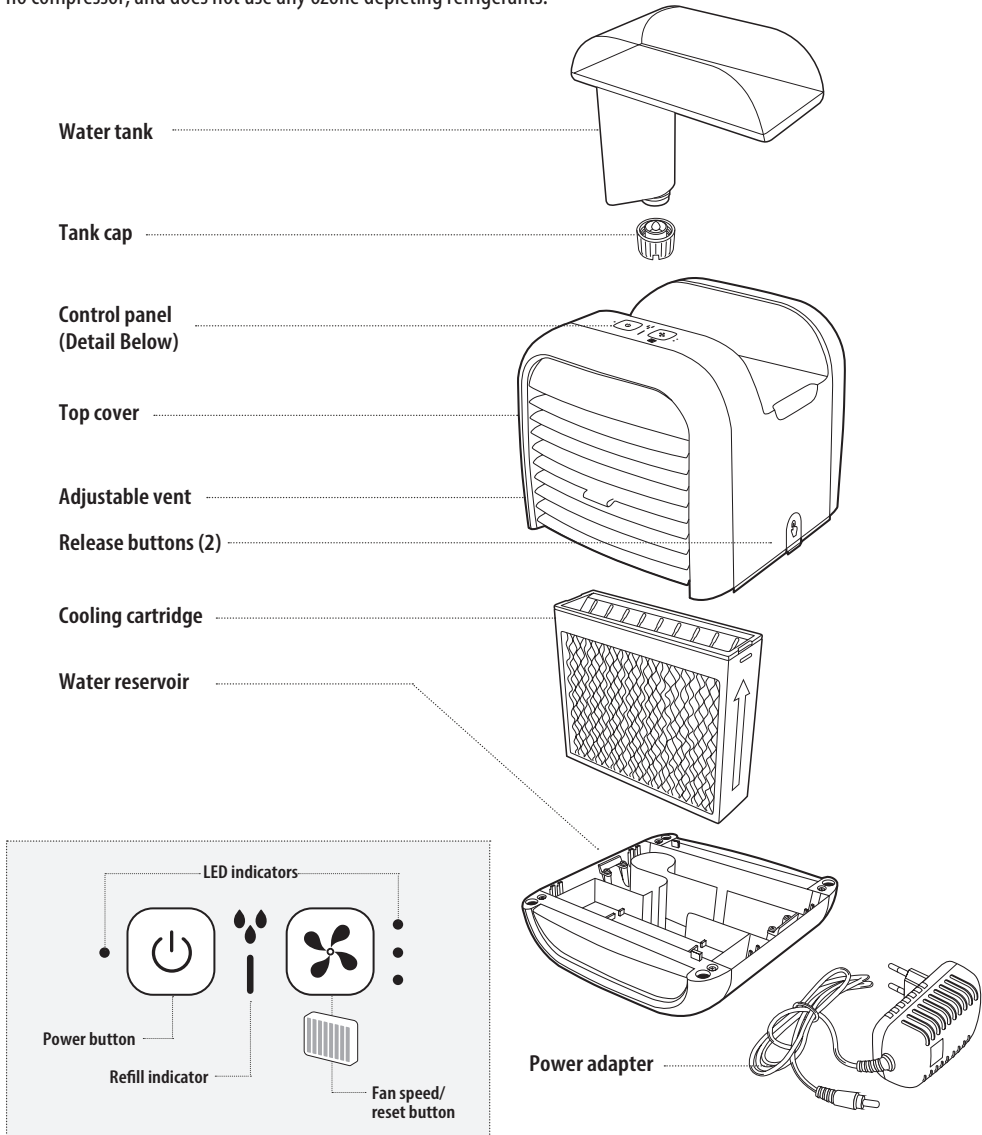

HOW TO FILL:

Caution: Before filling the unit with water, unplug the Power Adapter from the wall and from the unit.

Note: Always use two hands to carry the unit.

Personal Space Cooler Location

Place the Personal Space Cooler Plus in the desired location prior to filling with water. The front of the unit should be located within 6 FT / 1.8 M of the desired personal cooling zone. We recommend placing a waterproof pad under the unit.

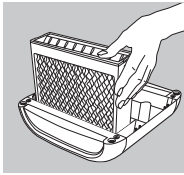

1. Be sure the cooling cartridge is positioned with the "V-shaped" vents facing upward. **Never operate the unit without the cooling cartridge.**

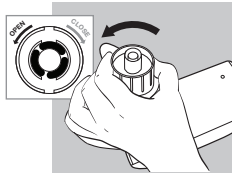

2. Remove the water tank and turn the tank upside down – remove the tank cap by turning it counter-clockwise.

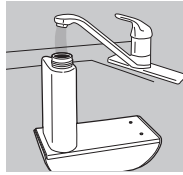

3. Fill the water tank with clean, cool (not cold) water. We recommend using distilled water if you live in a hard water area. **Never use any additive or place essential oils into the water. Even a few drops will damage the unit.**

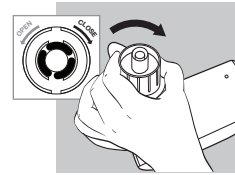

4. Replace the tank cap by turning clockwise until tight. **Do not overtighten.**

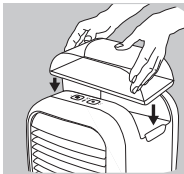

5. Place the tank into the MyChill cavity, making sure the tank is firmly seated. Water will begin to transfer into the water reservoir.

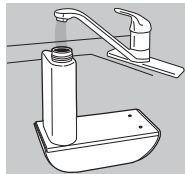

6. Once the water stops emptying into the water reservoir, remove the water tank and refill following steps 2-5 to fully fill the water tank and reservoir.

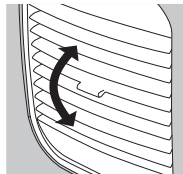

7. Adjust the front vents up or down to direct the airflow as desired.

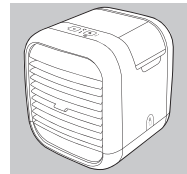

8. Your personal space cooler is ready for use.

HOW TO USE:

Plug the power adapter into the back of the unit and the other end into a household electrical outlet.

Speed Adjustment

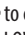
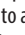
1. Power button  to control the on/off function. Press once. Fan motor to start at LOW speed, with LED lit.
2. Press  button once to adjust the fan speed to LOW, press twice for HIGH speed, pressing again to repeat the function.

Low Water Indicator

This unit is equipped with a low water Refill Indicator. It will flash Red indicating the water tank needs to be refilled. The pump will automatically turn off while the fan continues to run. At this time, please turn the unit off and unplug it to refill the tank. Once a full tank is placed in the unit and the unit is turned back on, the low water indicator is reset and the pump is turned on.

The Personal Space Cooler is equipped with a safety device that automatically shuts the unit off when the Top Cover is removed from the water reservoir.

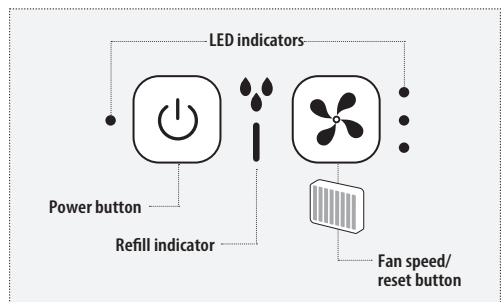

REPLACING THE COOLING CARTRIDGES

Replace the Cooling Cartridge seasonally or after 540 hours of use for optimal performance. The MyChill Personal Space Cooler Plus is equipped with a Replace Cooling Cartridge LED that illuminates Red after 540 hours of use indicating the cooling cartridge needs to be replaced.

To purchase genuine HoMedics replacement cooling cartridge, Model PP-PAC35FLTR, go to your retailer where you purchased your MyChill Personal Space Cooler Plus, or visit www.homedics.com.

NOTE: If you live in an area with hard water, it may need to be replaced more frequently. In these instances, you will notice mineral build-up on the cooling cartridge that over time may restrict air flow.

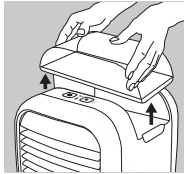

1. Unplug the Power Adaptor from the wall and from the unit. Remove the water tank from the top housing.

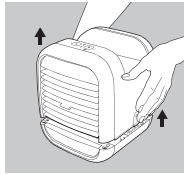

2. Press the release buttons on both sides and slowly lift the top cover, allowing time for the water to drain.

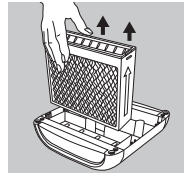

3. Pour out any excess water remaining in the Water Reservoir, then remove the old Cooling Cartridge and discard.

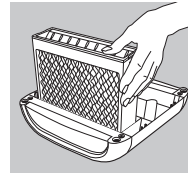

4. Set the new Cooling Cartridge in place. Be sure the Cooling Cartridge is positioned with the "V-shaped" vents upward.

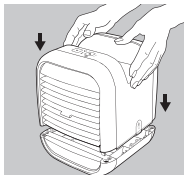

5. Replace the Top Cover onto the water reservoir.

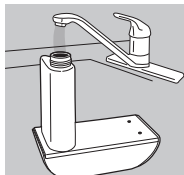

6. Refill the Water Tank and Reservoir as described in the "How to Fill" section.

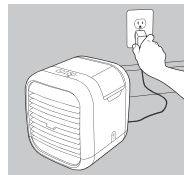

7. Plug the Power Adaptor into the back of the unit and the other end into a household electrical outlet to resume operation.

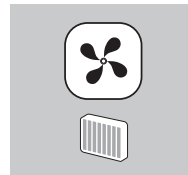

8. Turn the unit on, then press and hold the Cooling Cartridge Reset Button for 5 seconds. The LED will flash to indicate the Replace Cooling Cartridge Timer has been reset.

CLEANING AND CARE

CAUTION: Before cleaning the unit, turn power off and unplug the power adaptor from the wall and the unit.

1. To Clean the Tank and Reservoir

Remove the water tank from the personal space cooler by lifting it from the main unit. Unscrew the tank cap and rinse inside the tank with clean water. Empty, rinse and dry the tank, tank cap and water reservoir before refilling. To remove any scale or build up, use a 50/50 mixture of white vinegar and lukewarm water to clean the inside of the tank and reservoir as needed

2. To Clean the Cooling Cartridge

Rinse with clean water

3. To Clean the Pump Filter

Check and clean the pump filter as needed. Remove the pump filter, brush clean with a soft bristle brush (not included) and rinse clean. Dry and re-install.

NOTE: Never run water over the pump filter while it is installed.

4. To Clean the Surface

Clean the surface of the unit with a clean damp soft cloth as often as needed. **Never use detergents, excess water, treated cloths, harsh cleaning agents or sprays.**

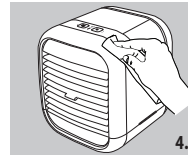
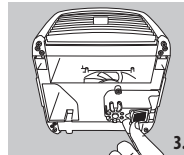
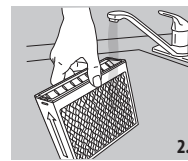
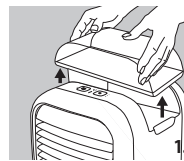

Storing your personal space cooler: Clean the Tank and Water Reservoir with a 50/50 mixture of white vinegar and water. Wipe the underside of the Top Cover with a soft, damp, cloth. Rinse the Cooling Cartridge with water and allow to air dry. Be sure to rinse thoroughly and let all parts dry completely before packing in the original carton and store in a cool, dry location.

TROUBLESHOOTING

PROBLEM	POSSIBLE CAUSE	SOLUTION
No Power	<ul style="list-style-type: none"> Unit is not plugged in No power at unit Top cover not seated properly 	<ul style="list-style-type: none"> Plug unit in Press the Power Button to turn the unit on Check circuits and fuses or try a different outlet Remove top cover and re-seat
Peculiar Odor	<ul style="list-style-type: none"> Cooling cartridge is new Unit may have a dirty tank or water reservoir Water in tank or reservoir may be old 	<ul style="list-style-type: none"> The cooling cartridge may emit a slight odor which will dissipate after a few days Follow instructions described in the Cleaning and Care Section
Discoloration of water in the reservoir	<ul style="list-style-type: none"> New cooling cartridge 	<ul style="list-style-type: none"> Discoloration will dissipate after a few days of operation
Mineral build-up on cooling cartridge	<ul style="list-style-type: none"> Hard water used 	<ul style="list-style-type: none"> Use distilled water
Not cooling	<ul style="list-style-type: none"> Out of water Outside of recommended cooling zone Cool ambient temperature and /or high humidity conditions Pump filter clogged 	<ul style="list-style-type: none"> Refill water tank Use within 4 FT / 1.2 M of the unit's front grill Use in warmer and / or less humid conditions Clean pump filter as instructed in the Cleaning and Care Section
Replace cooling cartridge LED is illuminated after cooling cartridge replacement	<ul style="list-style-type: none"> Cooling cartridge reset button not activated 	<ul style="list-style-type: none"> Turn the unit on, then press and hold the cooling cartridge reset button for 5-seconds until the LED flashes

WEEE explanation

 This marking indicates that this product should not be disposed with other household wastes throughout the EU. To prevent possible harm to the environment or human health from uncontrolled waste disposal, recycle it responsibly to promote the sustainable reuse of material resources. To return your used device, please use the return and collection systems or contact the retailer where the product was purchased. They can take this product for environmental safe recycling.

HOMEDICS®

LEADERS IN HEALTH & WELLBEING



Distributed in the UK by: FKA Brands Ltd, Somerhill Business Park, Tonbridge, Kent TN11 0GP, UK
EU Importer: FKA Brands Ltd, 29 Earlsfort Terrace, Dublin 2, Ireland
Customer Support: +44(0) 1732 378557 | support@homedics.co.uk

IB-PAC35WTEU2EN-0421-02