

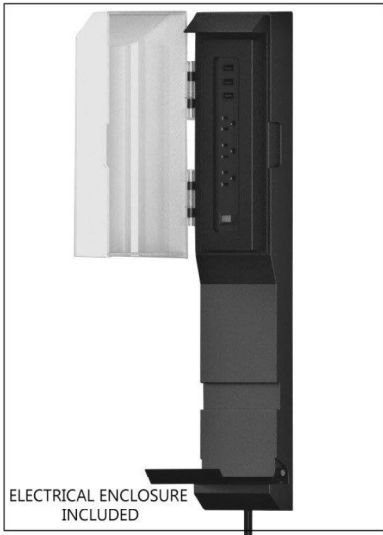

SOMERVILLE 10x14 PERGOLA

MANUFACTURED BY:
Backyard Discovery
3305 Airport Drive
Pittsburg, KS 66762
800-856-4445

Model # 2106529 | Owner's Manual & Assembly Instructions



Before you begin >>>

FOR QUICK & EASY ASSEMBLY

FIND 3D INSTRUCTIONS FOR THIS PRODUCT IN

BILT.

DOWNLOAD THE FREE APP

GET IT ON Google Play

Download on the App Store

For the most up to date assembly manual, to register your set, or to order replacement parts please visit www.backyarddiscovery.com

SAVE THIS ASSEMBLY MANUAL FOR FUTURE REFERENCE IN THE EVENT THAT YOU NEED TO ORDER REPLACEMENT PARTS.

Para obtener instrucciones en español, visite www.backyarddiscovery.com



It is critically important that you start with square and level footings, concrete pad or deck to attach your structure

- Pay close attention to the items needed for each step. Make sure you are using the correct hardware for each step. Using incorrect hardware may result in improper assembly.
- Remember to double check for underground utilities and overhead electrical lines.

Post mounts are provided with your structure which allows you to permanently install your structure to a pre-existing or new wood or concrete surface.

- The hardware to attach the post mounts to the structure is included.
- The hardware to mount the structure permanently to a concrete surface is included.
- The hardware to mount the structure permanently to a wood deck is NOT included and will need to be purchased separately. You must ensure there is ample structural support under the deck before permanently attaching.

Overall Dimension

EXAMPLE: 14' (4.3m) x 10' (3m) x 7' 11-1/8" (2.4m)

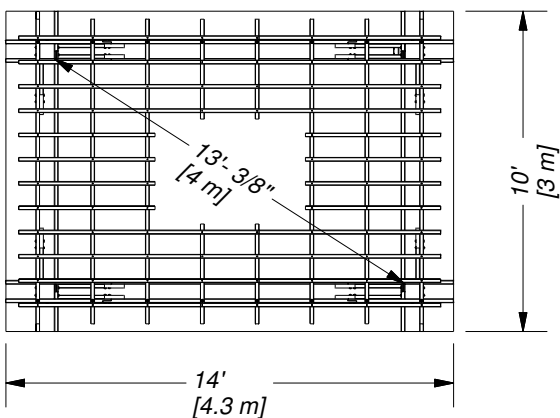

Footprint Dimension

EXAMPLE: 11'-11 3/4" (3.7m) x 8'- 3/4" (2.5m)

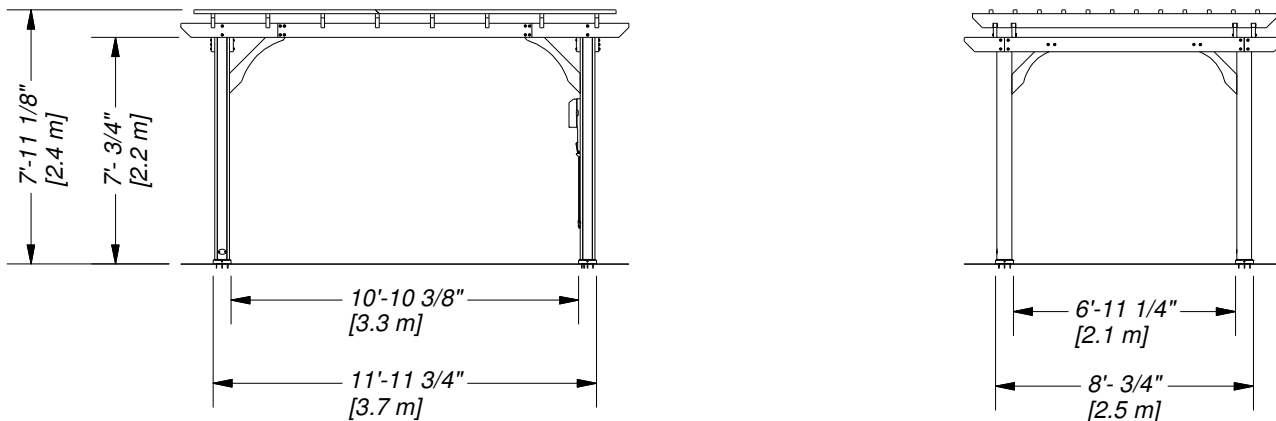



Wood Components (Not to Scale)



D01 | JOIST - W4L13787
(x2) | 1 3/8"x5 1/4"x95 1/4" (36x134x2420)



D02 | JOIST - W4L13796
(x2) | 1 3/8"x5 1/4"x95 1/4" (36x134x2420)



D03 | JOIST END - W4L13800
(x2) | 1 3/8"x5 1/4"x39 3/4" (36x134x1008)



D04 | JOIST END - W4L13786
(x2) | 1 3/8"x5 1/4"x39 3/4" (36x134x1008)



D05 | JOIST END - W4L13795
(x2) | 1 3/8"x5 1/4"x39 3/4" (36x134x1008)



D06 | JOIST END - W4L13799
(x2) | 1 3/8"x5 1/4"x39 3/4" (36x134x1008)



D07 | JOIST END - W4L13801
(x4) | 1 7/16"x5 1/4"x17 3/4" (36x134x451)



D08 | JOIST - W4L13790
(x2) | 1 3/8"x5 1/4"x90" (36x134x2286)



D09 | JOIST - W4L13788
(x2) | 1 3/8"x5 1/4"x90" (36x134x2286)



D10 | JOIST END - W4L13785
(x4) | 1 3/8"x5 1/4"x17 3/4" (36x134x451)



Wood Components (Not to Scale)



D11 | LONG ANGLE BRACE - W4L13793
(x8) | 1 3/8"x5 1/4"x37 1/8" (36x134x942)



D12 | SHORT ANGLE BRACE - W4L13794
(x4) | 1 3/8"x5 1/4"x29 3/4" (36x134x755)



D13 | SLOTTED JOIST - W4L13789
(x8) | 1 3/8"x5 1/4"x114" (36x134x2896)

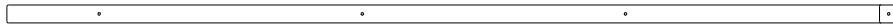

P01 | PURLIN - W4L13791
(x12) | 1 3/8"x1 3/8"x69 5/8" (36x36x1768)



P02 | PURLIN - W4L13792
(x12) | 1 3/8"x1 3/8"x90 1/4" (36x36x2291)



Wood Components (Not to Scale)

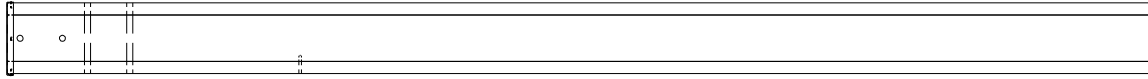

UP1 | PERGOLA POST - W2A02852
(2) | 5 1/2"x5 1/2"x89 1/2" (140x140x2273)

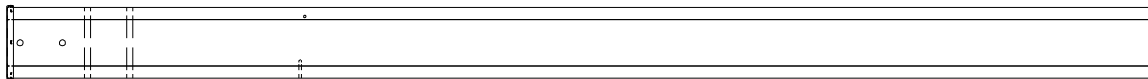

UP2 | PERGOLA POST - W2A02853
(2) | 5 1/2"x5 1/2"x89 1/2" (140x140x2273)



Hardware Components

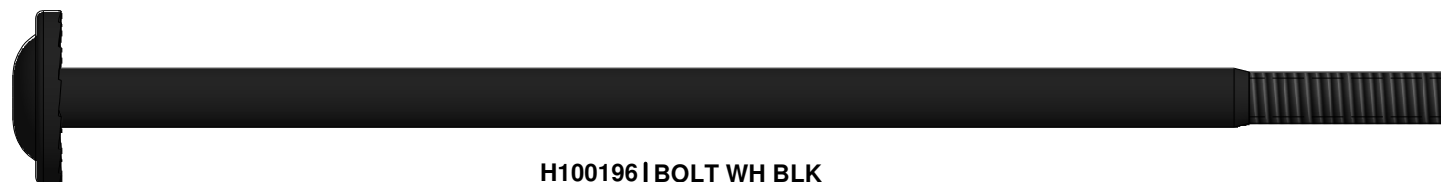

H100196 | BOLT WH BLK
(x26) | 5/16x7-1/4



H100205 | BOLT WH BLK
(x42) | 5/16x2-1/4



H100193 | NUT BARREL WH BLK
(x26) | 5/16x1-1/2



H100192 | NUT BARREL WH BLK
(x42) | 5/16x7/8

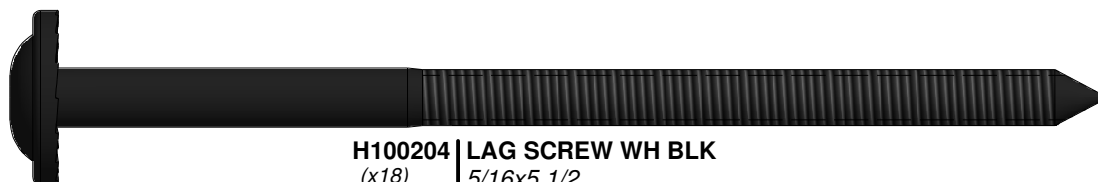

H100204 | LAG SCREW WH BLK
(x18) | 5/16x5 1/2



H100206 | LAG SCREW WH BLK
(x13) | 5/16x3

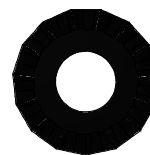

H100198 | WASHER LOCK EXT BLK
(x96) | 8x19



H100201 | SCREW PFH BLK
(x100) | 8x2-1/2



H100200 | SCREW PFH BLK
(x17) | 8x1 1/2

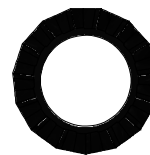

H100199 | WASHER LOCK EXT BLK
(x68) | 12x19



H100392 | SCREW PWH BLK
(x4) | 8x3/4



H100120 | SCREW CONCRETE ANCHOR
(x18) | 1/4x2



Hardware Components

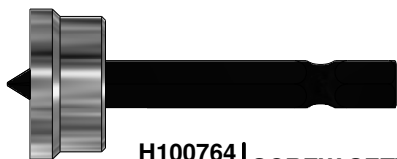

H100764 | SCREW SETTER
(x1)

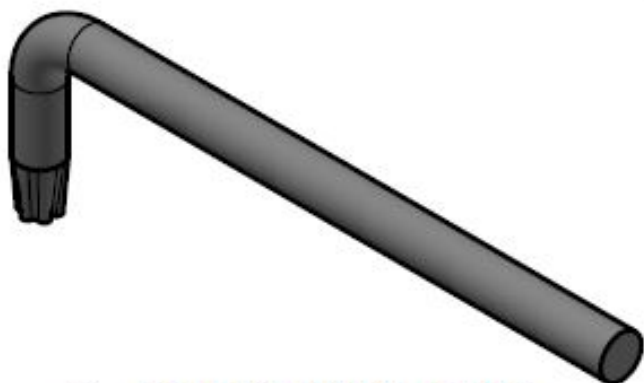

(1) - T-30 TORX WRENCH - H100114



(1) - T-30 TORX BIT - H100147



(1) - MAGNETIC DRIVER

9220119 TOOL KIT



Accessory Components (Not to Scale)

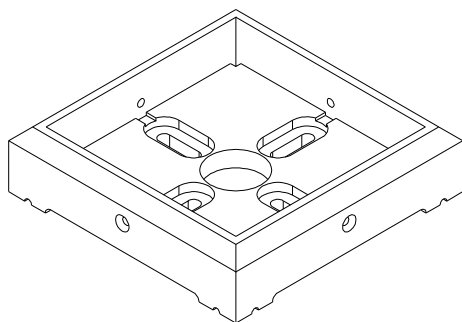

A100029 | FOOT 142 SQUARE POST
(x4)



A100241 | BYD ID TAG (SMALL) WITHOUT AGES
(x1)

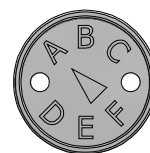

A100314 | "A" REVISION TAG
(x1)

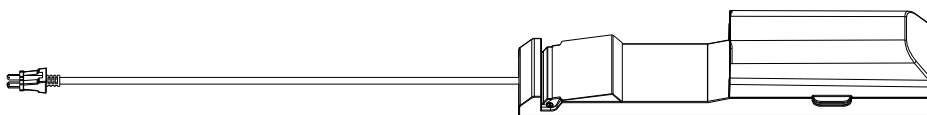

9205413 | ELECTRICAL ENCLOSURE
(x1)

PRE-ASSEMBLY STEP 1 - SORTING PARTS

It is critical for ease of assembly that you take the time to sort and organize the wood and hardware.

WOOD PARTS:

- Organize wood parts by the three-digit, alpha-numeric number stamped on each board (ex. P01).
- If there are multiple boards with the same stamped number, stack those pieces together.
- Stamps can be found on the flat surface of the boards or on the end of the boards.
- Allow yourself plenty of room - the wood pieces can take up a significant amount of space.

NOTE: CARTONS ARE NOT ORGANIZED BY BOARD NUMBER.

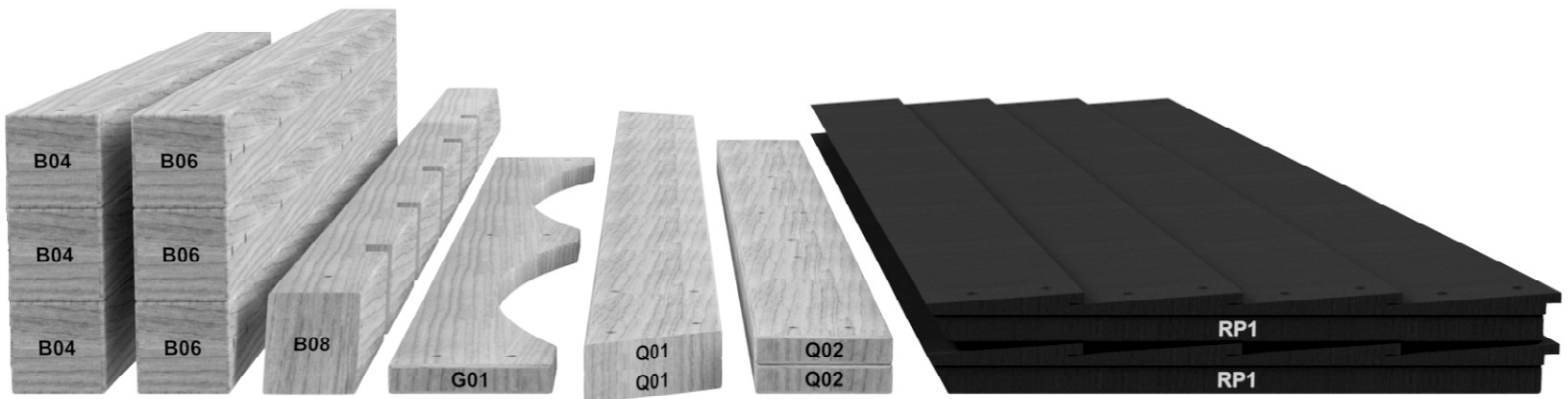

HARDWARE PARTS:

- We recommend that you have a separate table to organize the hardware.
- Hardware bags are printed with a seven-digit, alpha-numeric part number.
- You can organize your hardware by part number or group by hardware type (i.e. bolts, nuts, etc.).
- During assembly you only need to reference the last four digits of the number.

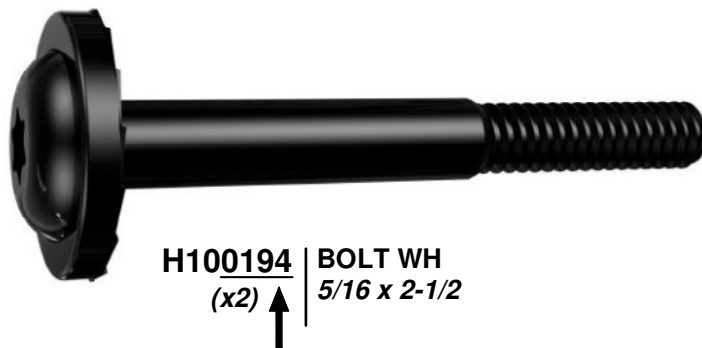

PRE-ASSEMBLY STEP 2 - TOOLS REQUIRED



**Cordless Drill or
Electric Drill**



**Drill Attachments:
Phillips Head**



**1/8", 3/16", 3/8" & 7/16"
Drill Bits**



Phillips Screw Driver



Open End Wrenches 1/2" & 9/16"



**3/8" Drive Ratchet, 1/2" &
9/16" STD Sockets 1/2" & 9/16" Deep
Sockets**



Claw Hammer



Rubber Mallet - Optional



Tape Measure

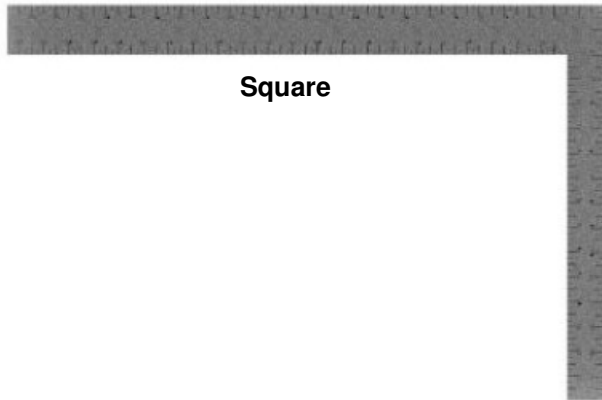

Square



Level 24"

PRE-ASSEMBLY STEP 3 - CHOOSE YOUR ASSEMBLY METHOD

There are several types of assembly instructions available to you.

1. Printed Assembly Manual included with your set
2. BILT APP - 3D interactive instructions
3. Combination of the Printed Manual and BILT APP (Note: Step numbers can differ between the two methods)

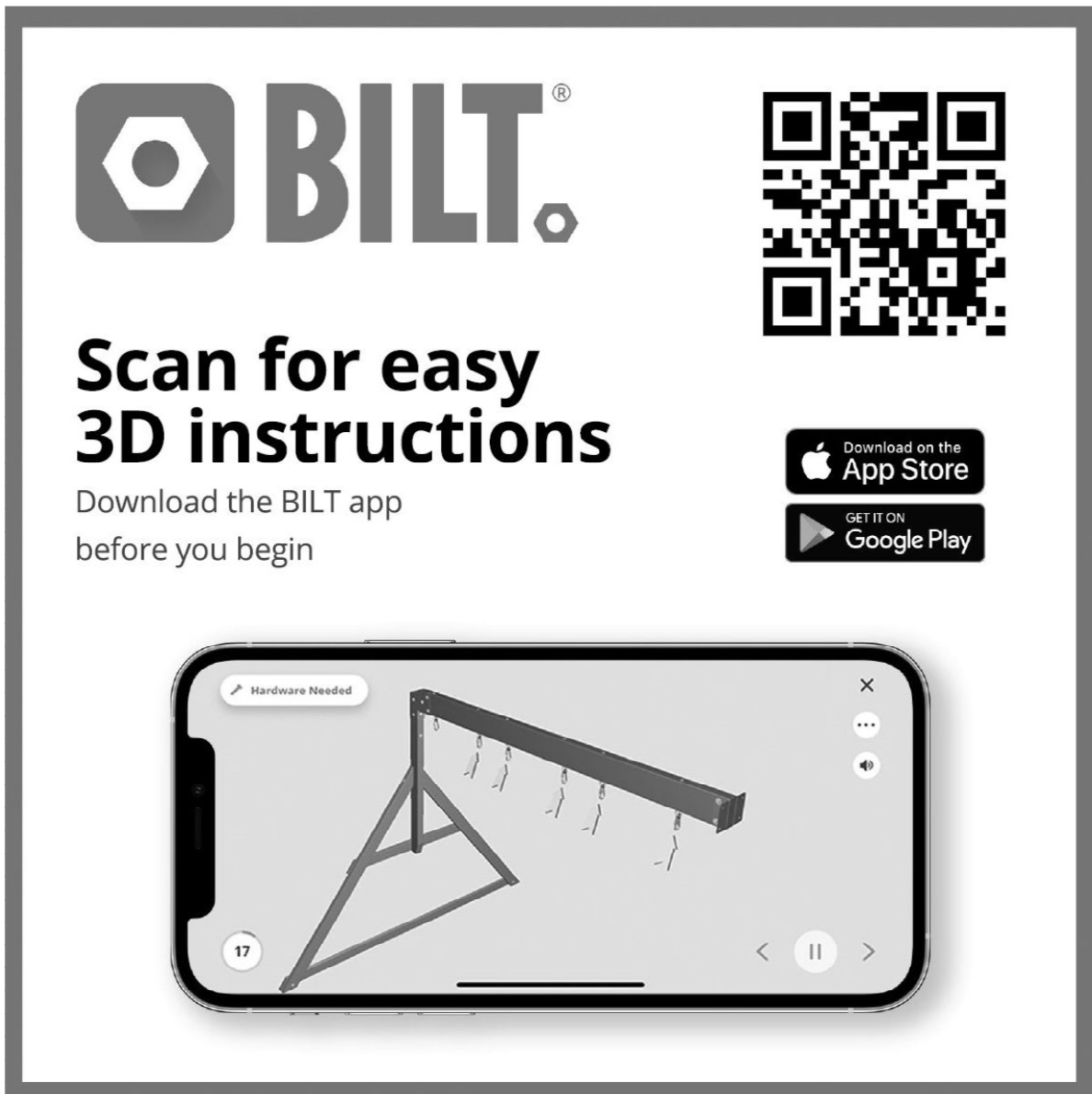

The advertisement features the BILT logo on the left, a QR code on the right, and the text "Scan for easy 3D instructions" in large bold font. Below this, it says "Download the BILT app before you begin". To the right of the text are two buttons: "Download on the App Store" and "GET IT ON Google Play". At the bottom, a smartphone screen displays a 3D assembly instruction for step 17, showing a metal frame with a horizontal beam and several hanging components. The screen also has a "Hardware Needed" label and navigation icons.



STEP 1

D07 | JOIST END - W4L13801
(x4) | 1 7/16"x5 1/4"x17 3/4" (36x134x451)

UP1 | PERGOLA POST - W2A02852
(2) | 5 1/2"x5 1/2"x89 1/2" (140x140x2273)

D09 | JOIST - W4L13788
(x2) | 1 3/8"x5 1/4"x90" (36x134x2286)

D10 | JOIST END - W4L13785
(x4) | 1 3/8"x5 1/4"x17 3/4" (36x134x451)

UP2 | PERGOLA POST - W2A02853
(2) | 5 1/2"x5 1/2"x89 1/2" (140x140x2273)

D08 | JOIST - W4L13790
(x2) | 1 3/8"x5 1/4"x90" (36x134x2286)

D12 | SHORT ANGLE BRACE - W4L13794
(x4) | 1 3/8"x5 1/4"x29 3/4" (36x134x755)

H100196 | BOLT WH BLK
(x16) | 5/16x7-1/4

H100206 | LAG SCREW WH BLK
(x4) | 5/16x3

H100198 | WASHER LOCK EXT BLK
(x28) | 8x19

H100205 | BOLT WH BLK
(x8) | 5/16x2-1/4

H100193 | NUT BARREL WH BLK
(x16) | 5/16x1-1/2

H100192 | NUT BARREL WH BLK
(x8) | 5/16x7/8

H100199 | WASHER LOCK EXT BLK
(x24) | 12x19

TIP:
LAY PARTS ON GROUND OR SAW HORSES FOR EASE OF ASSEMBLY.

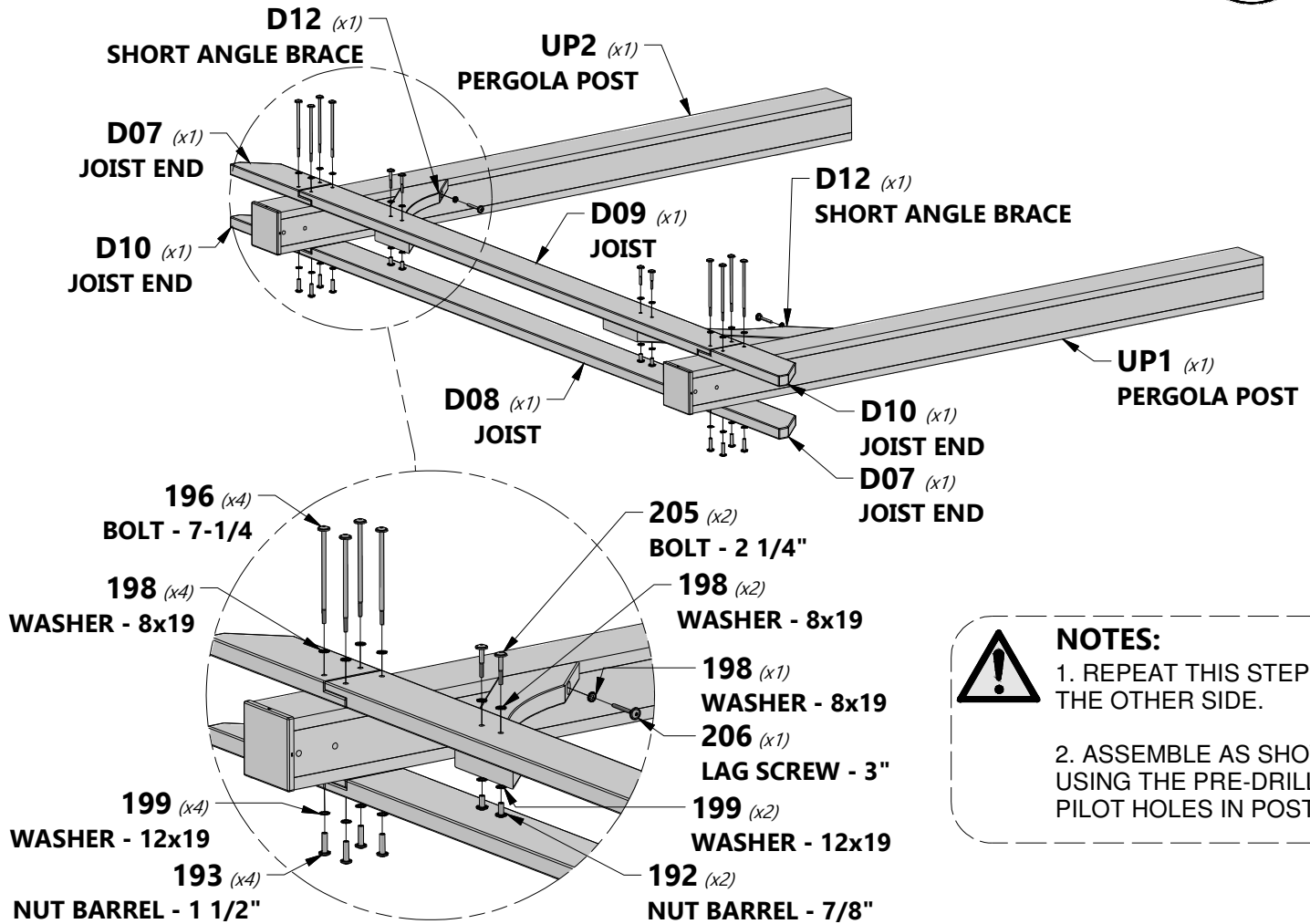
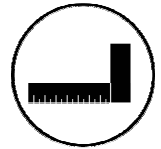

REPEAT ON OPPOSITE END



NOTES:

1. REPEAT THIS STEP FOR THE OTHER SIDE.

2. ASSEMBLE AS SHOWN USING THE PRE-DRILLED PILOT HOLES IN POSTS.



STEP 2



D02 | JOIST - W4L13796
(x2) | 1 3/8"x5 1/4"x95 1/4" (36x134x2420)



D03 | JOIST END - W4L13800
(x2) | 1 3/8"x5 1/4"x39 3/4" (36x134x1008)

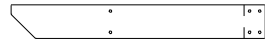

D05 | JOIST END - W4L13795
(x2) | 1 3/8"x5 1/4"x39 3/4" (36x134x1008)



D11 | LONG ANGLE BRACE - W4L13793
(x4) | 1 3/8"x5 1/4"x37 1/8" (36x134x942)



H100205 | BOLT WH BLK
(x16) | 5/16x2-1/4



H100198 | WASHER LOCK EXT BLK
(x16) | 8x19



H100199 | WASHER LOCK EXT BLK
(x16) | 12x19



H100192 | NUT BARREL WH BLK
(x16) | 5/16x7/8



NOTES:

REPEAT STEP TO COMPLETE TWO INNER JOIST ASSEMBLIES.

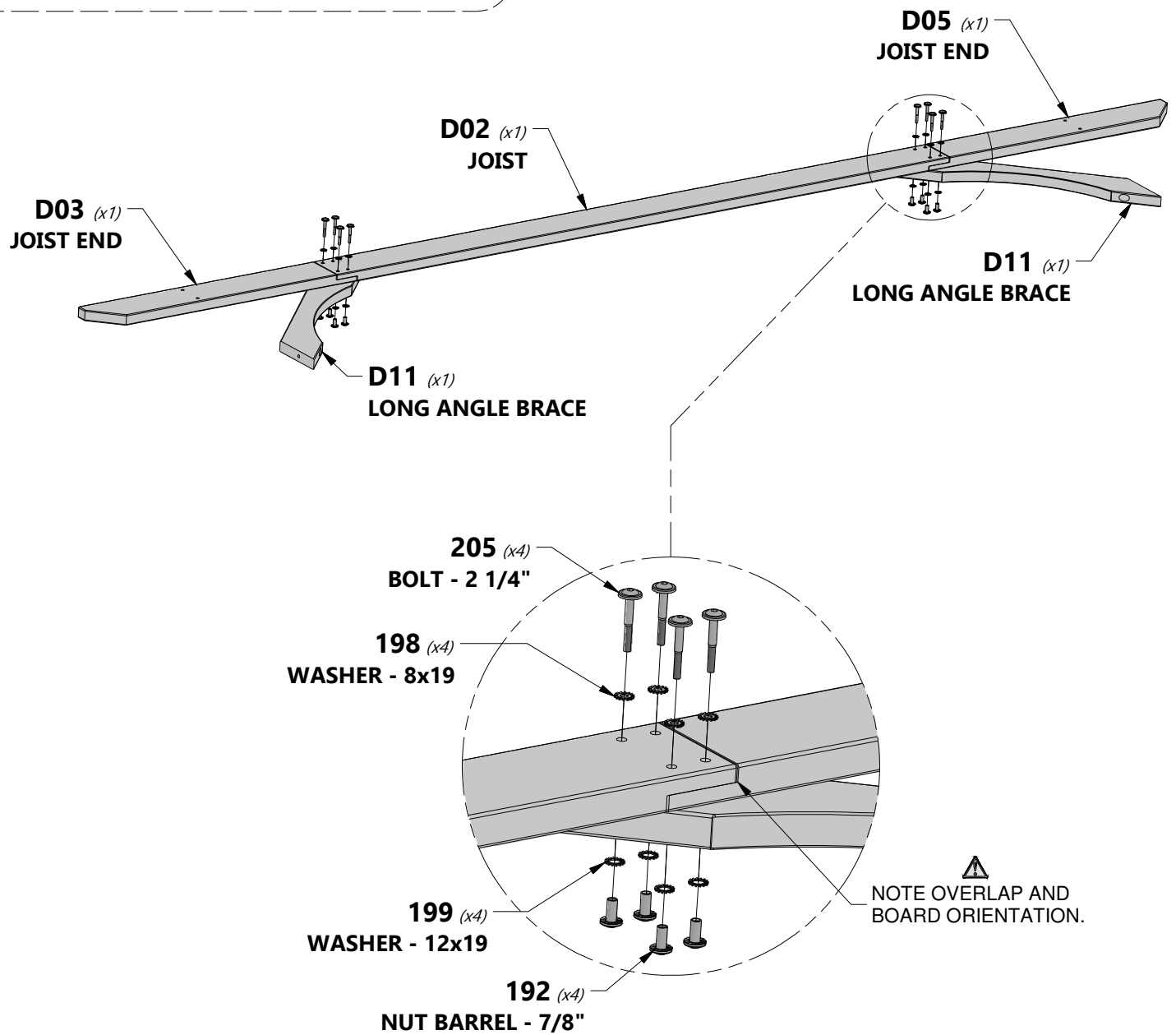

REPEAT ON OPPOSITE END



STEP 3



D01 | JOIST - W4L13787
(x2) | 1 3/8"x5 1/4"x95 1/4" (36x134x2420)



D04 | JOIST END - W4L13786
(x2) | 1 3/8"x5 1/4"x39 3/4" (36x134x1008)

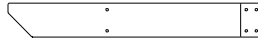

D06 | JOIST END - W4L13799
(x2) | 1 3/8"x5 1/4"x39 3/4" (36x134x1008)



D11 | LONG ANGLE BRACE - W4L13793
(x4) | 1 3/8"x5 1/4"x37 1/8" (36x134x942)



H100205 | BOLT WH BLK
(x16) | 5/16x2-1/4



H100198 | WASHER LOCK EXT BLK
(x16) | 8x19



H100199 | WASHER LOCK EXT BLK
(x16) | 12x19



H100192 | NUT BARREL WH BLK
(x16) | 5/16x7/8



NOTES:

REPEAT STEP TO COMPLETE TWO OUTER JOIST ASSEMBLIES.

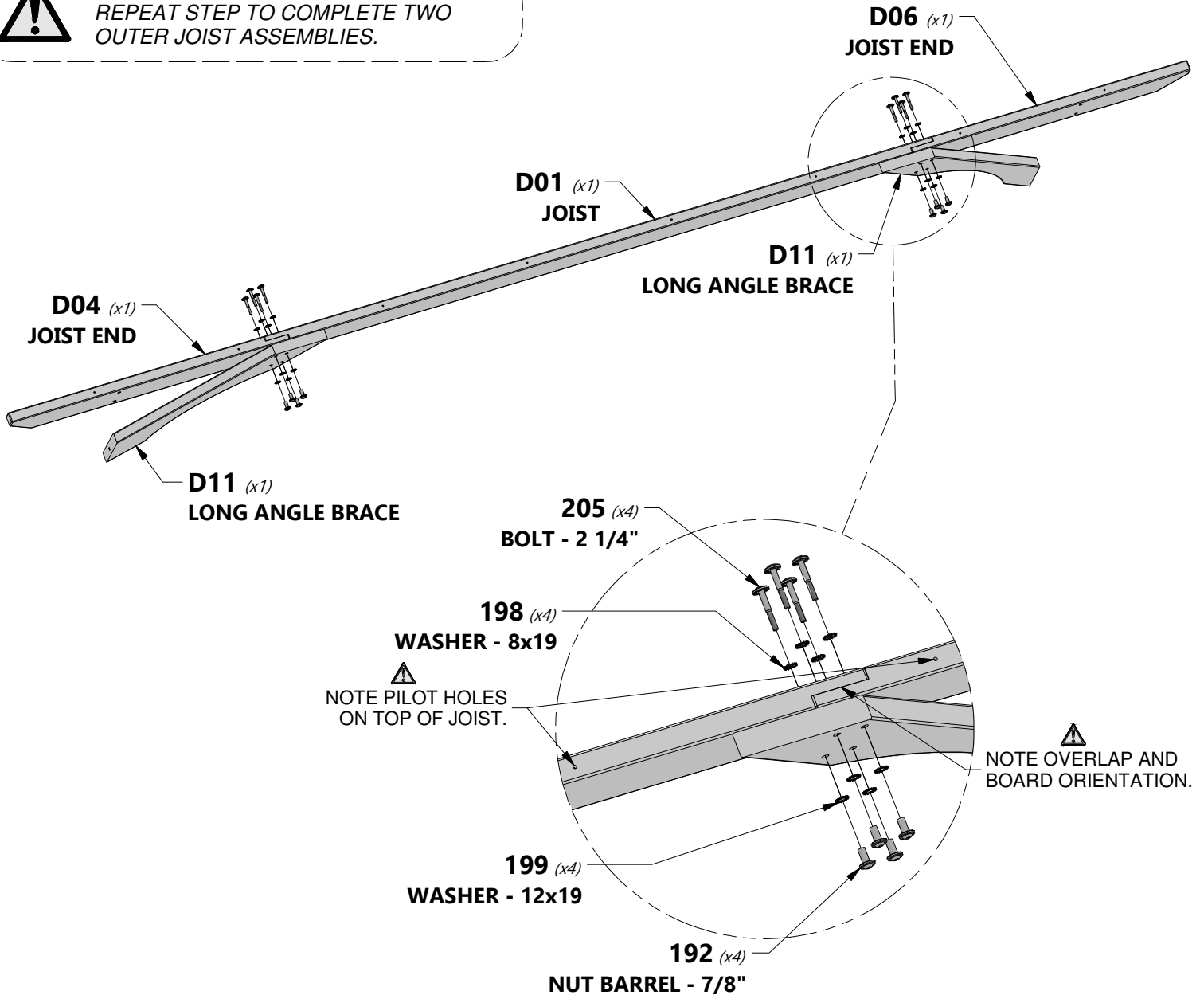

REPEAT ON OPPOSITE END



STEP 4

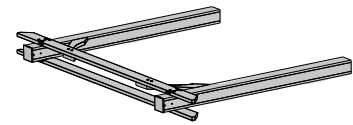

(x2) UPRIGHT ASSEMBLY FROM PREVIOUS STEPS



(x2) OUTER JOIST ASSEMBLY FROM PREVIOUS STEPS

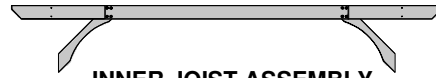

(x2) INNER JOIST ASSEMBLY FROM PREVIOUS STEPS



H100196 | BOLT WH BLK
(x8) | 5/16x7-1/4



H100206 | LAG SCREW WH BLK
(x8) | 5/16x3



H100198 | WASHER LOCK EXT BLK
(x16) | 8x19



H100199 | WASHER LOCK EXT BLK
(x8) | 12x19



H100193 | NUT BARREL WH BLK
(x8) | 5/16x1-1/2

REPEAT ON EACH CORNER

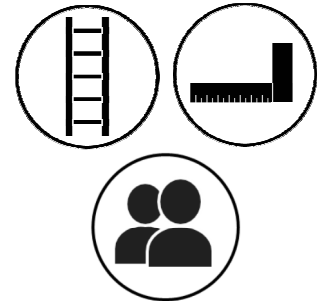

NOTE PILOT HOLES ON TOP OF THE OUTER JOIST ASSEMBLY

NOTE JOIST OVERLAP DIRECTION FOR PROPER ASSEMBLY.

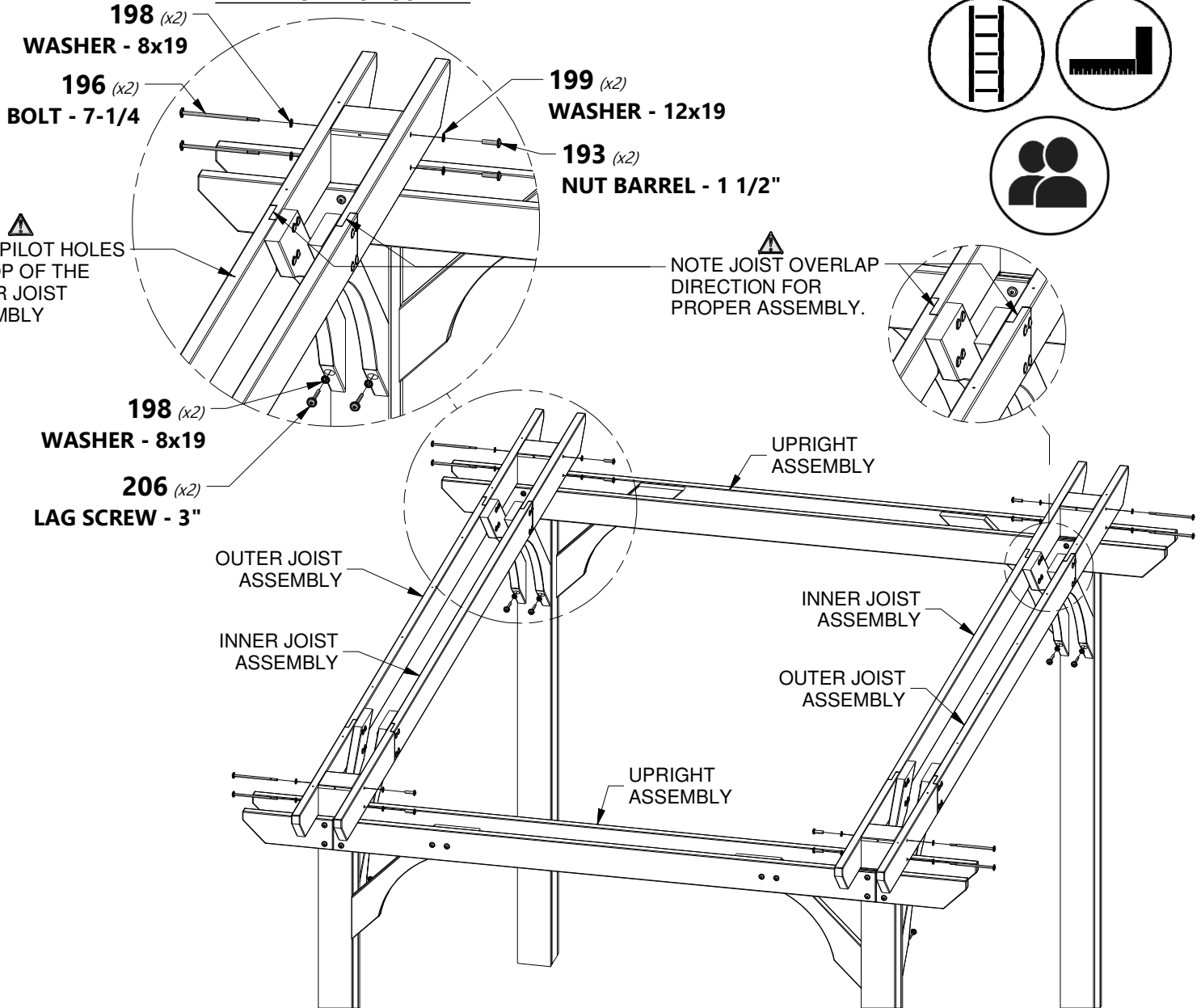



STEP 5

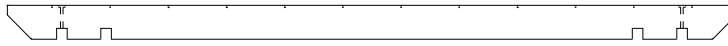

D13 | SLOTTED JOIST - W4L13789
(x8) | 1 3/8"x5 1/4"x114" (36x134x2896)



H100204 | LAG SCREW WH BLK
(x16) | 5/16x5 1/2



H100198 | WASHER LOCK EXT BLK
(x16) | 8x19



NOTES:

LOCATE AND USE PILOT HOLES IN THE OUTER JOISTS TO MOUNT D13 BOARDS AS SHOWN.

REPEAT ON OPPOSITE END AND ON ALL JOISTS



204 (x1)
LAG SCREW - 5 1/2"

198 (x1)
WASHER - 8x19

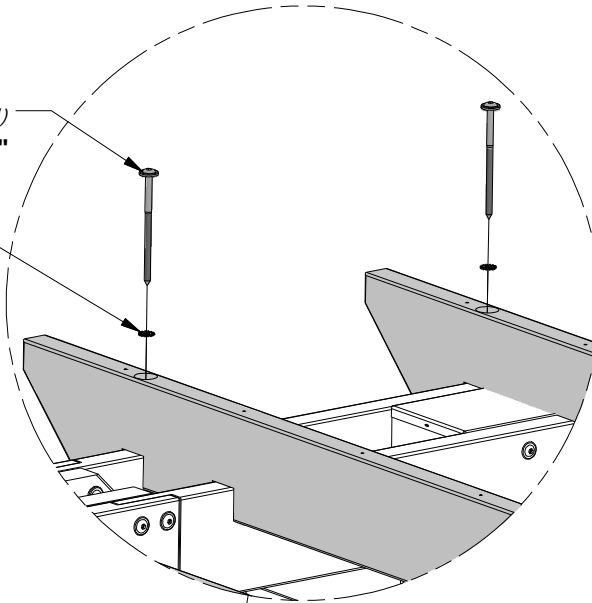

D13 (x8)
SLOTTED JOIST

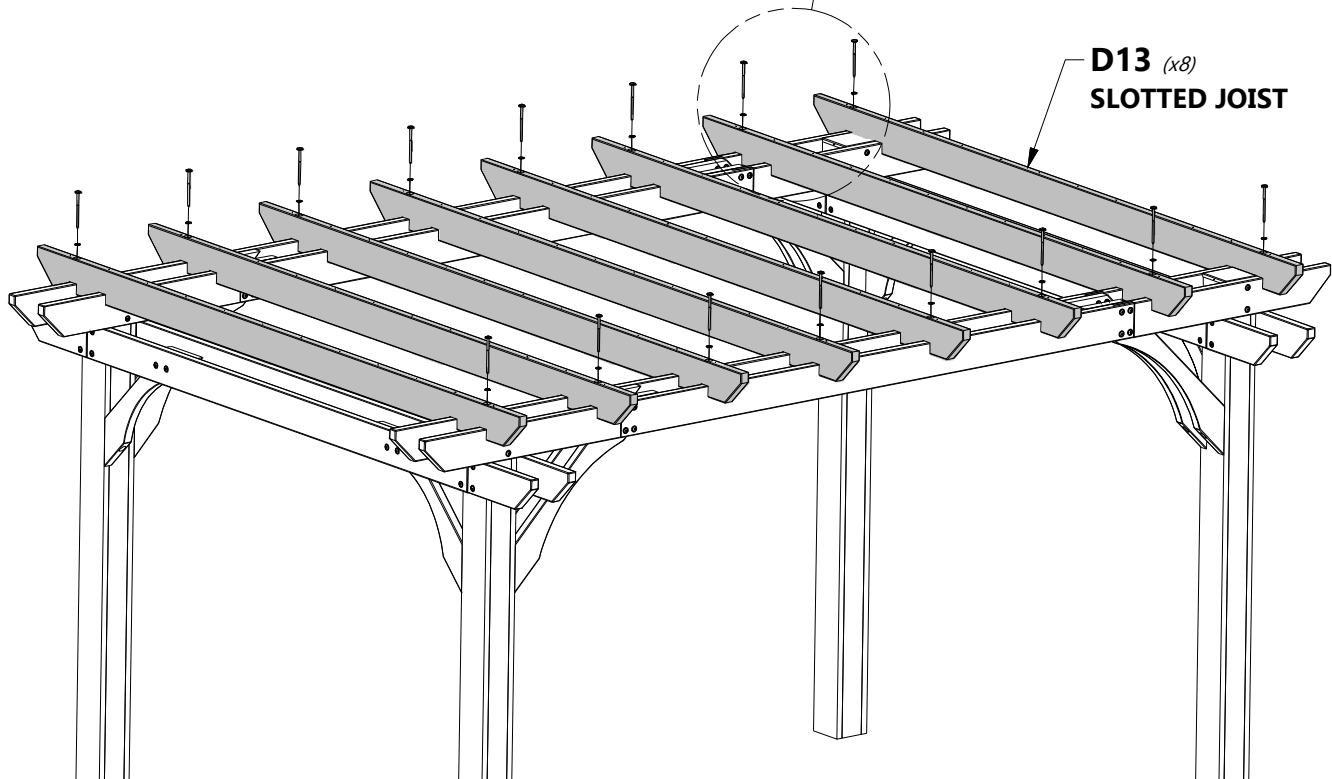



STEP 6

P01 | **PURLIN - W4L13791**
 (x12) | 1 3/8"x1 3/8"x69 5/8" (36x36x1768)

P02 | **PURLIN - W4L13792**
 (x12) | 1 3/8"x1 3/8"x90 1/4" (36x36x2291)

H100201 | **SCREW PFH BLK**
 (x96) | 8x2-1/2

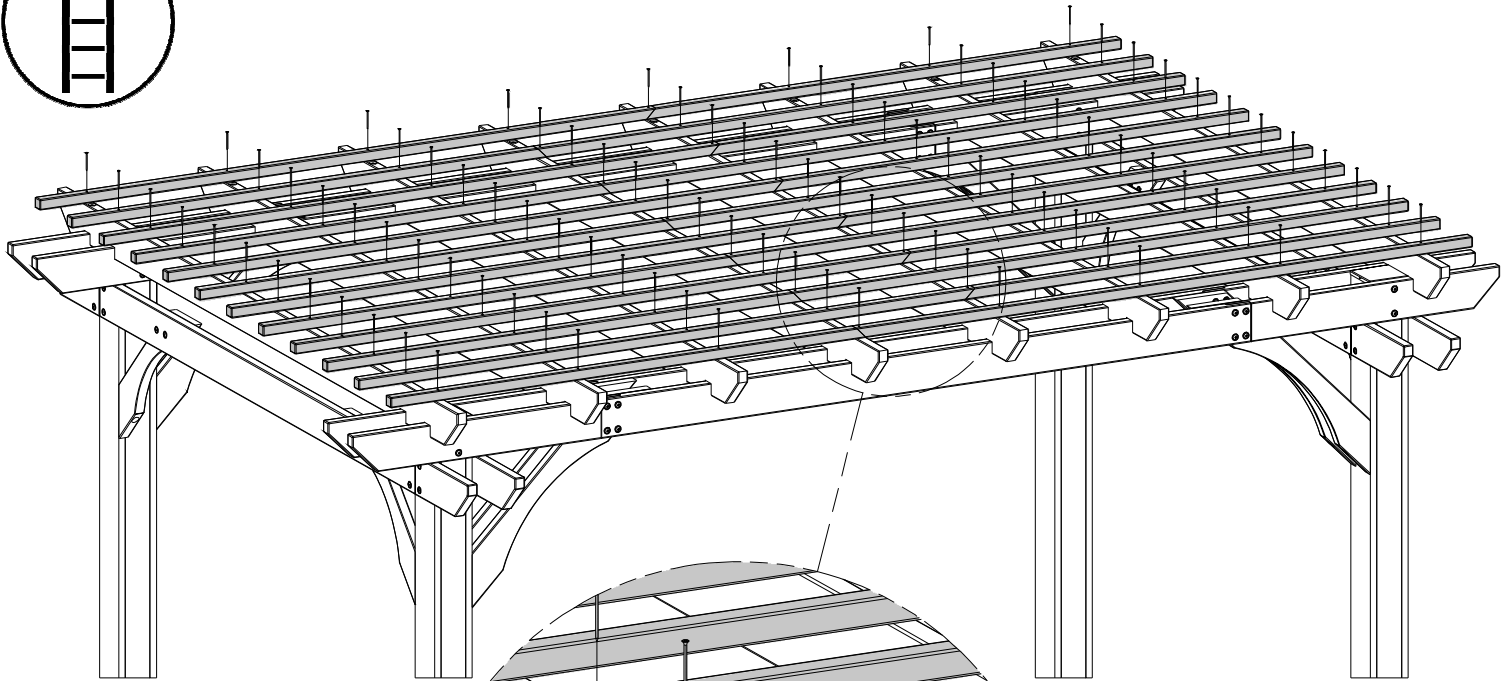
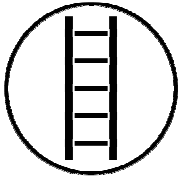

201 (x96)
SCREW - 2 1/2"

 **ANGLE CUT**

 **ANGLE CUT**

P01
PURLIN

P02
PURLIN

P01 (x12)
PURLIN

P02 (x12)
PURLIN



NOTES:

ASSEMBLE P01 & P02 BOARDS BY ALTERNATING THEM AS YOU WORK ACROSS THE JOIST BOARDS. AS SHOWN THE ANGLE CUT IN THE P01 & P02 BOARDS SHOULD ALTERNATE WHICH JOIST THEY LAND ON WHEN ASSEMBLED.



STEP 7

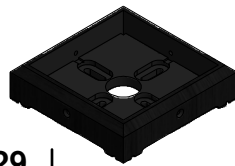

A100029
(x4)

FOOT 142 SQUARE POST



NOTES:

DECIDE WHERE TO PLACE THE PERGOLA. NOTE THIS MOUNTING PROCEDURE IS MEANT TO BE USED ON CONCRETE ONLY.

PLACE THE PERGOLA EXACTLY WHERE IT WILL BE ANCHORED WHEN COMPLETED AND SLIDE A FOOT UNDER EACH POST.

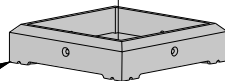
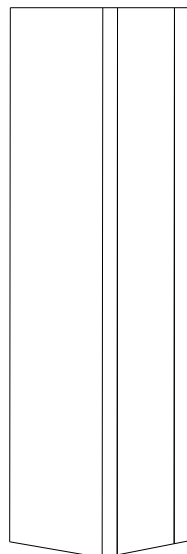

029 (x1)

FOOT 142 SQUARE POST

REPEAT ON ALL POSTS

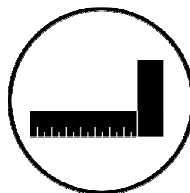

NOTES:

SQUARE POSTS AND TIGHTEN ALL BOLTS AND SCREWS AT THIS TIME.



STEP 8



NOTES:

USE CHALK TO TRACE AROUND THE EDGES OF EACH FOOT TO MARK THE FEET LOCATIONS.

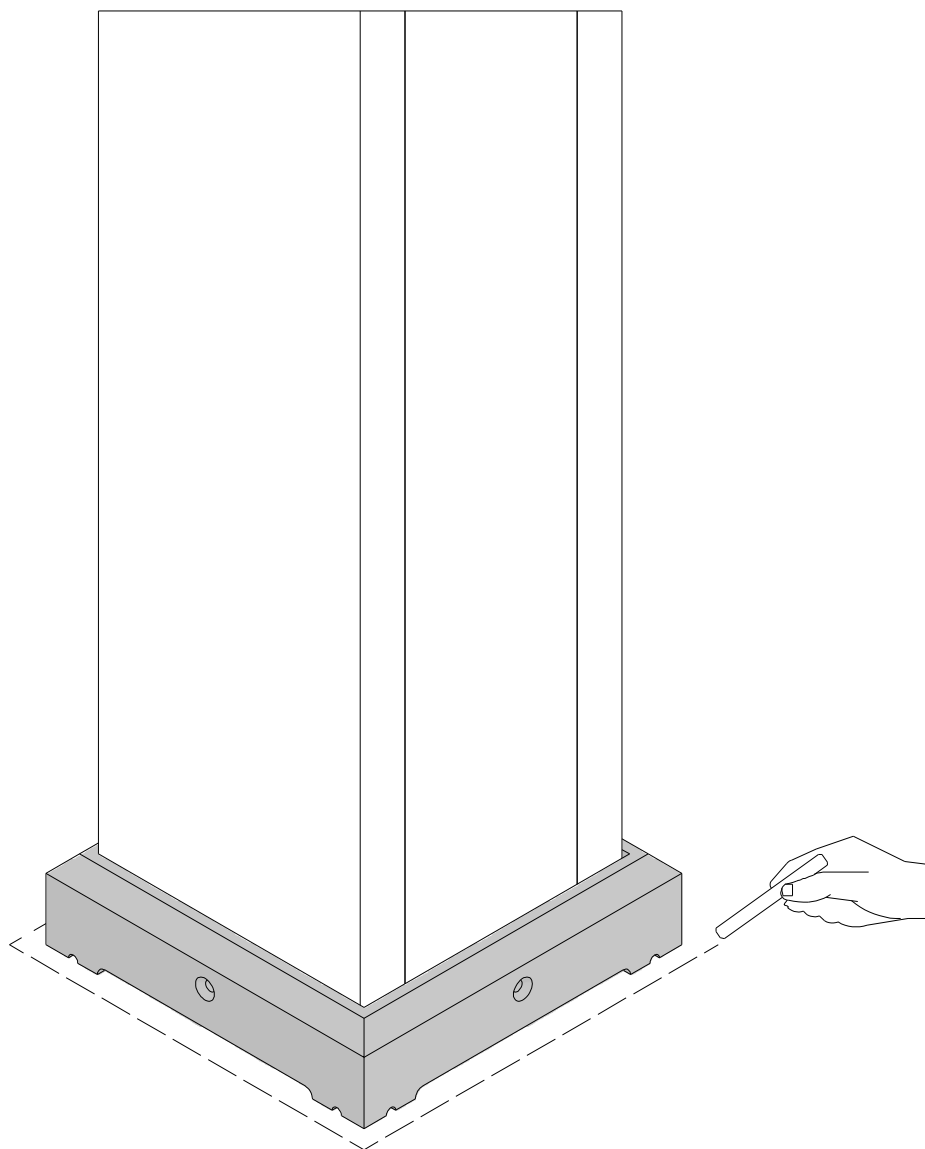



STEP 9



H100120 | SCREW CONCRETE ANCHOR
(x16) | 1/4x2



NOTES:

MOVE THE PERGOLA ASIDE AND PLACE EACH FOOT INSIDE THE LINES DRAWN IN THE PREVIOUS STEP. NOW, USE A 3/16" CONCRETE DRILL BIT TO DRILL PILOT HOLES INTO THE CONCRETE PAD.

NEXT, USE THE PROVIDED CONCRETE ANCHORS TO ATTACH EACH FOOT TO THE CONCRETE SURFACE.

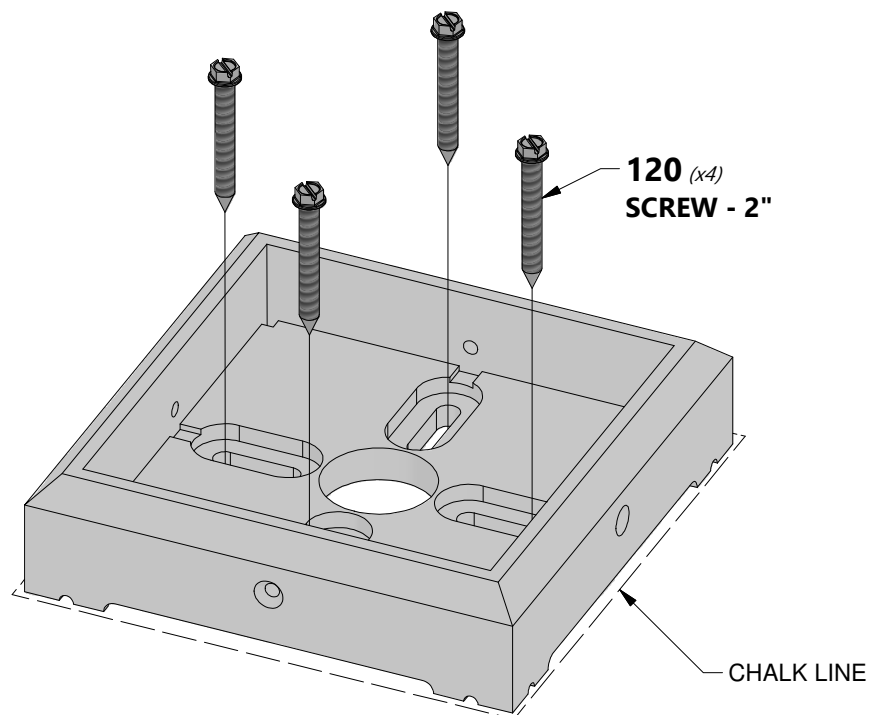

REPEAT ON ALL FEET



STEP 10



H100200 | SCREW PFH BLK
(x16) | 8x1 1/2



NOTES:

MOVE THE PERGOLA BACK INTO PLACE, SETTING EACH POST INSIDE A FOOT AND MOUNT AS SHOWN USING THE PROVIDED HARDWARE.

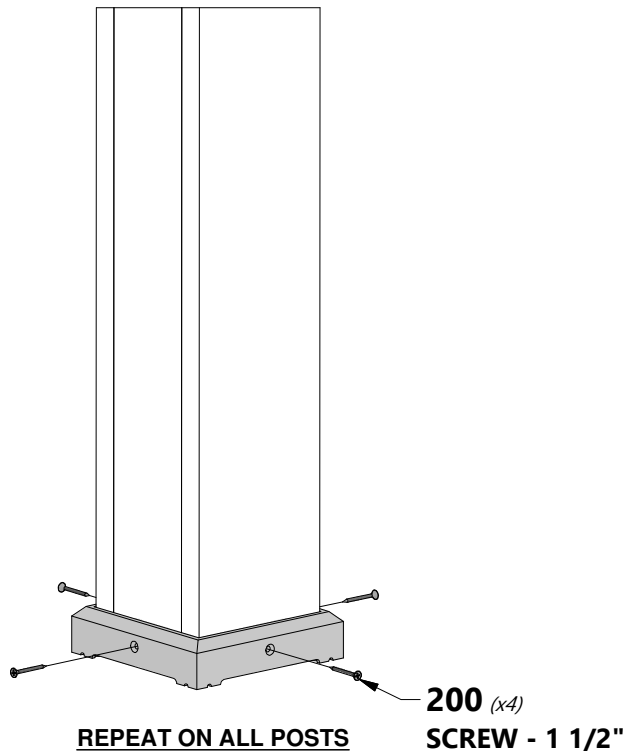



STEP 11



A100314 (x1) "A" REVISION TAG



A100241 (x1) BYD ID TAG (SMALL) WITHOUT AGES



H100392 (x4) SCREW PWH BLK 8x3/4

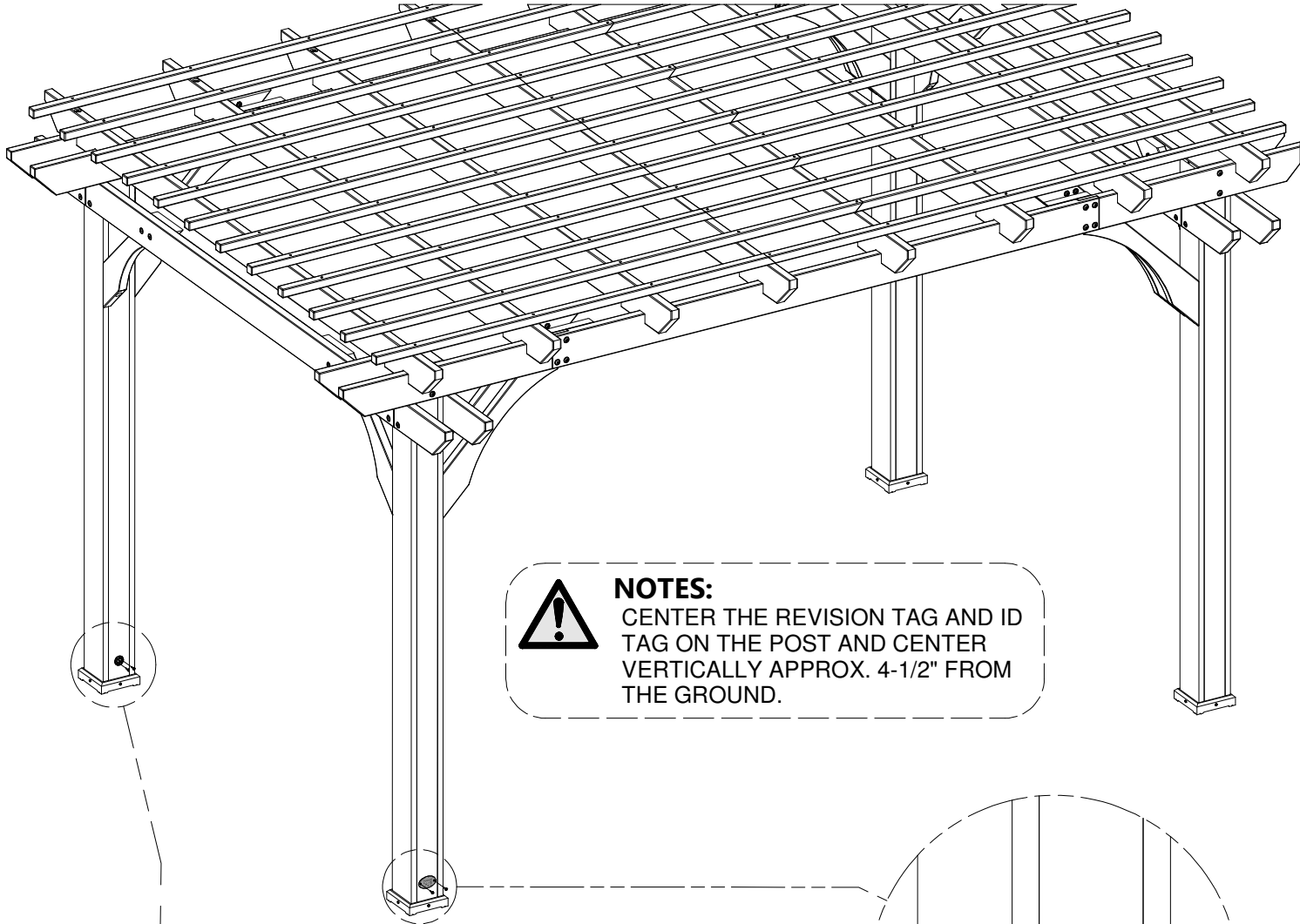

NOTES:

CENTER THE REVISION TAG AND ID TAG ON THE POST AND CENTER VERTICALLY APPROX. 4-1/2" FROM THE GROUND.

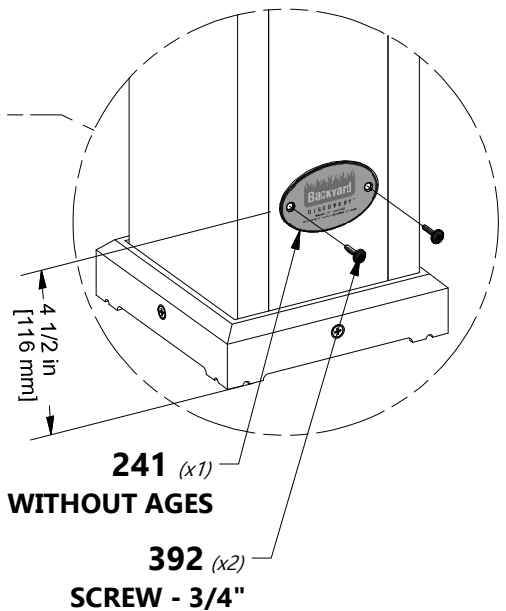
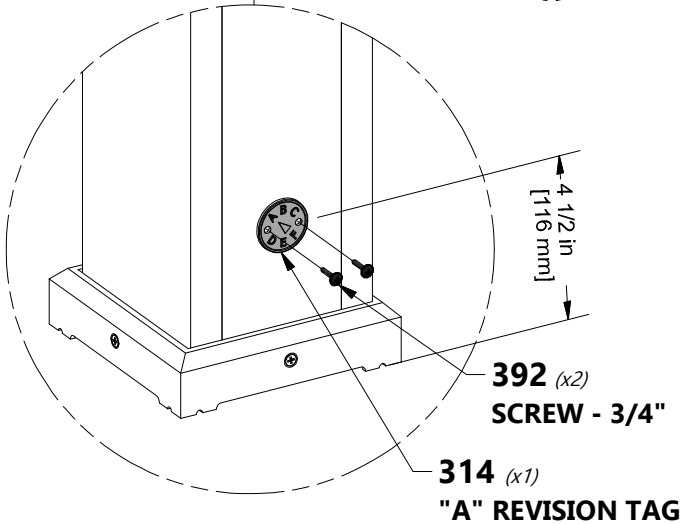

241 (x1) BYD ID TAG (SMALL) WITHOUT AGES

392 (x2) SCREW - 3/4"



STEP 12

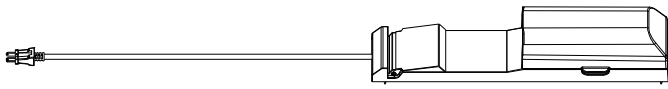

9205413 | **ELECTRICAL ENCLOSURE**
(x1)



H100966 | **SCREW RAISED HEAD**
(x4) | 8x1 1/2

(INCLUDED WITH ELECTRICAL ENCLOSURE)

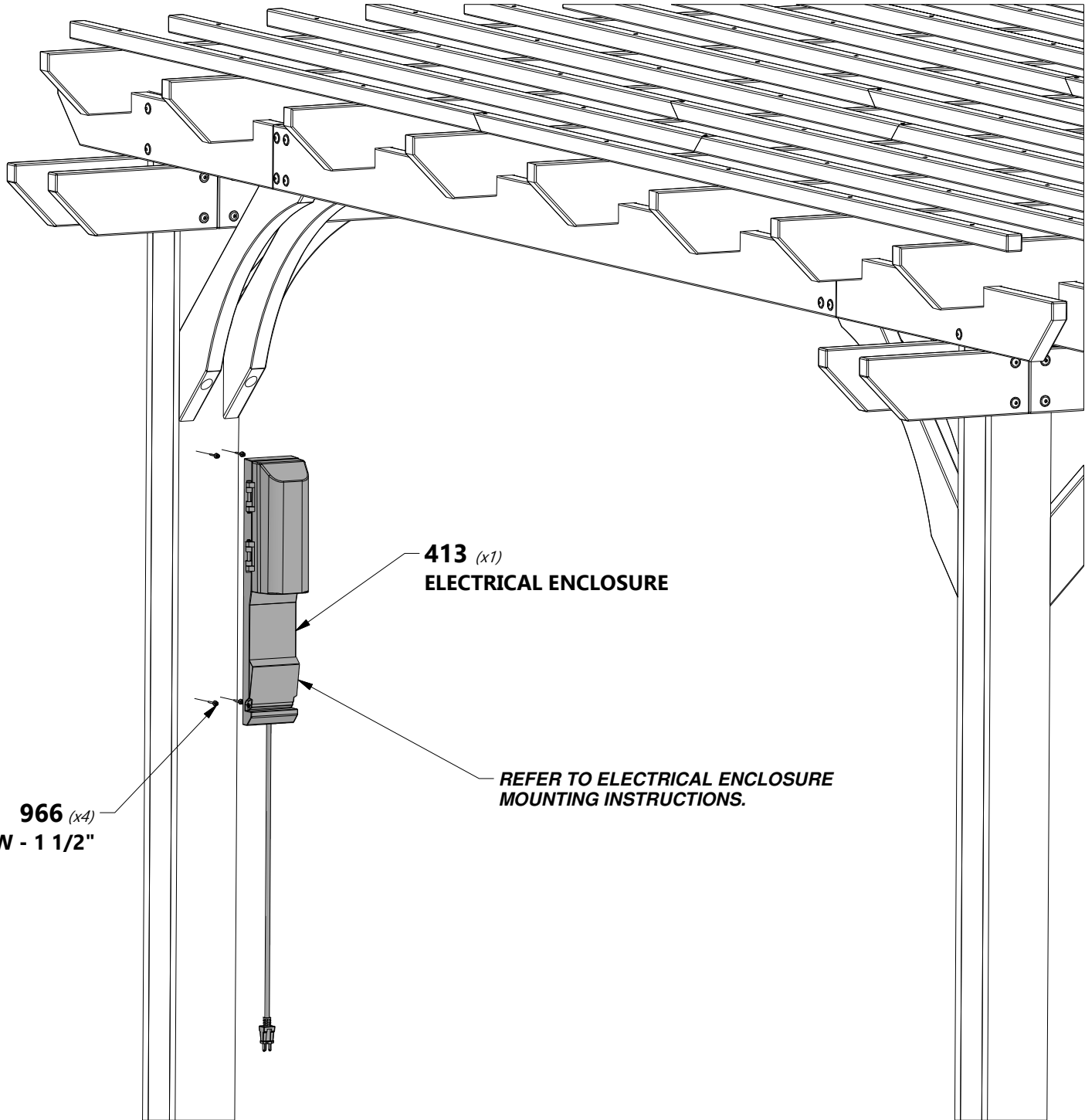

413 (x1)
ELECTRICAL ENCLOSURE

966 (x4)
SCREW - 1 1/2"

REFER TO ELECTRICAL ENCLOSURE MOUNTING INSTRUCTIONS.