

Instructions for registering purchased ALTAIR io™ devices to your MSA Grid Account

! BEFORE YOU START...

Please make sure you have an active Grid account. If you haven't created a Grid account, visit: <https://us.msasafety.com/mygrid>.

You will receive an email from Safety io within 2 business days, instructing you to log in. Once you are logged in, you can follow the below instructions to add your newly purchased ALTAIR io units to your Grid.

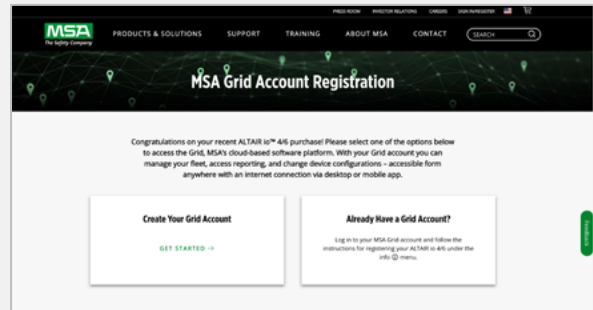

Registering your io Device via Mobile Device (recommended)

1. Download the MSA Grid Manager mobile app from the Apple or Google Play store.

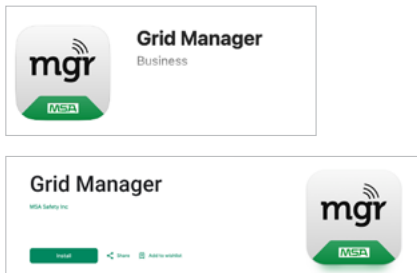

2. Log in using your grid credentials.

The first field is the **grid id** you selected when creating your grid account.

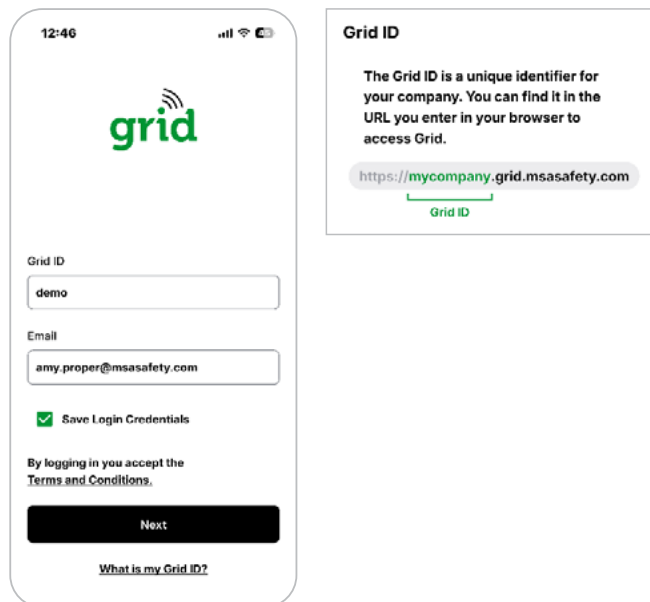

- 3.** Once logged in, tap on the **ALTAIR io** box and then **Register New Devices**.

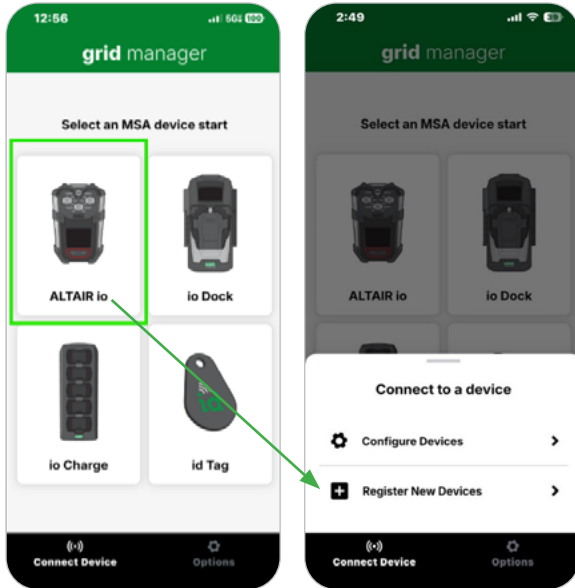

- 4.** Next, select how you'd like to enter the device information.

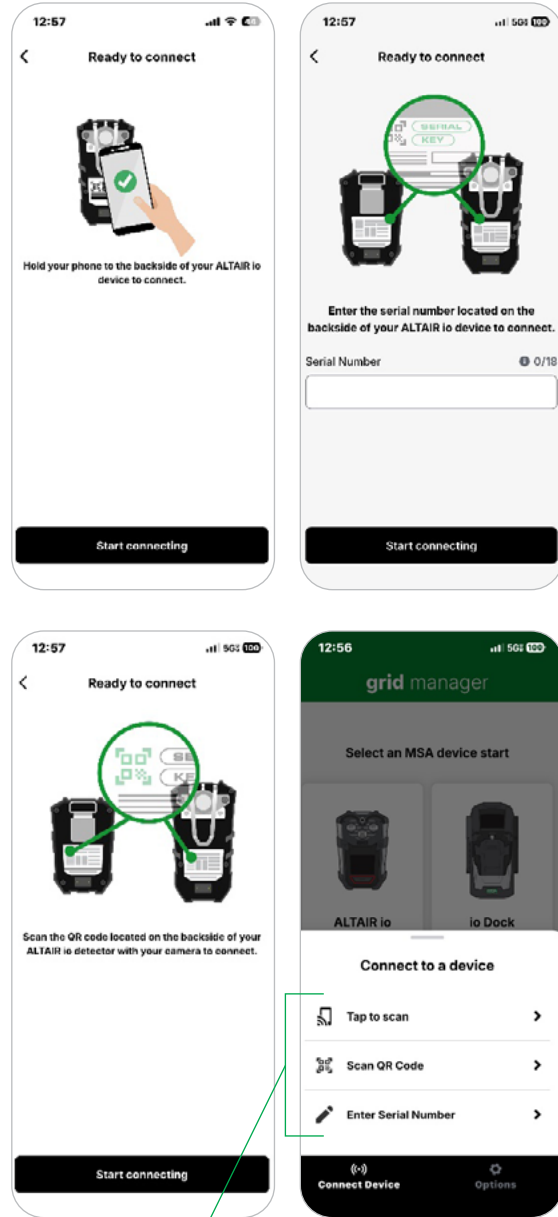

Tap one of the 3 options, then **Start Connecting** and follow the on-screen prompts to scan or manually enter your ioDevice's serial number and key, if applicable. The unit does not need to be powered on to complete this step.

5. The app will then prompt you to assign the device to a Company.

PLEASE NOTE: If you are a new Grid customer or want to apply a new Company Assignment, it will need to be created on your Grid website first. (See the Companies menu option—check out more in the [Grid Guide](#).)

6. Tap **Connect more devices** to register up to 20 io Devices (and repeat steps 4 & 5) or **Register 1 device / Register 2 devices** to get the units added to your grid.

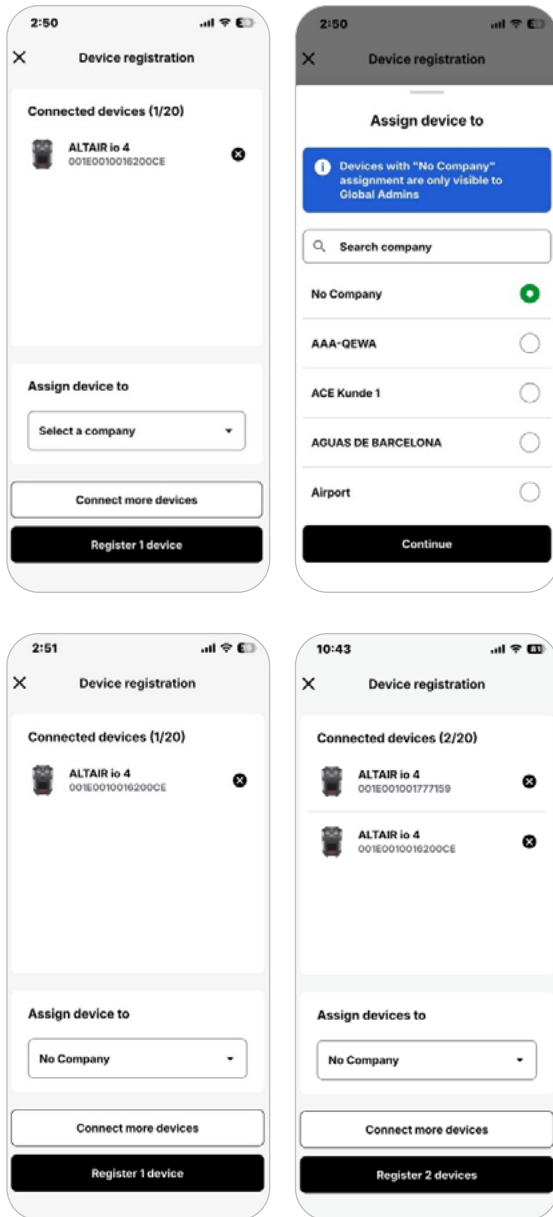

7. Finally, tap Register 1 device / Register 2 devices to get the units added to your grid.

The **Green Checkmarks** indicate you have successfully registered your ALTAIR ioDevices and should see them in the assets tab in your Grid account!

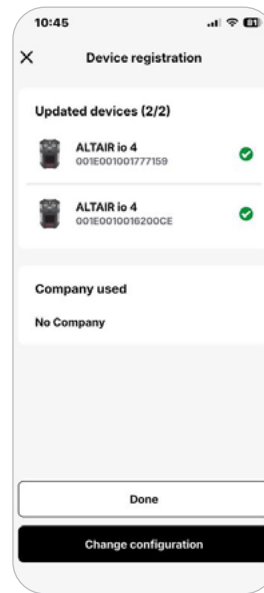

Registering your ALTAIR io Device via Grid web

1. Log in to the MSA Grid on your browser using your Grid credentials.

2. Click on the **Assets** menu.

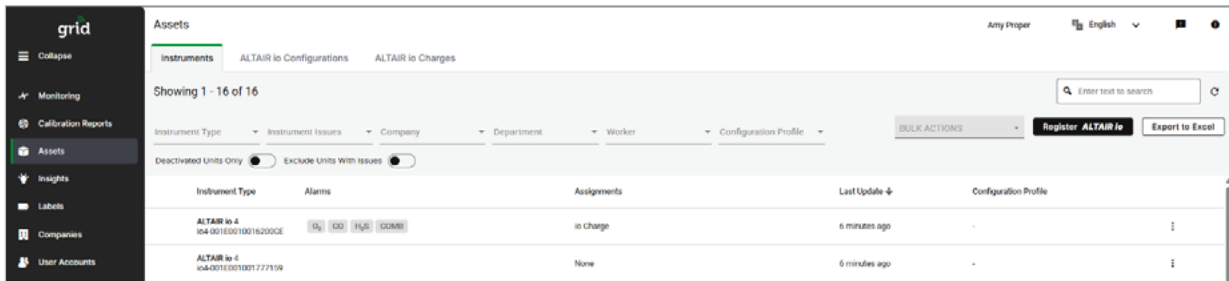

3. Next, click on the **Instruments** tab.
4. Once in the Instruments tab, click on the **Register ALTAIR io** box in the upper right.

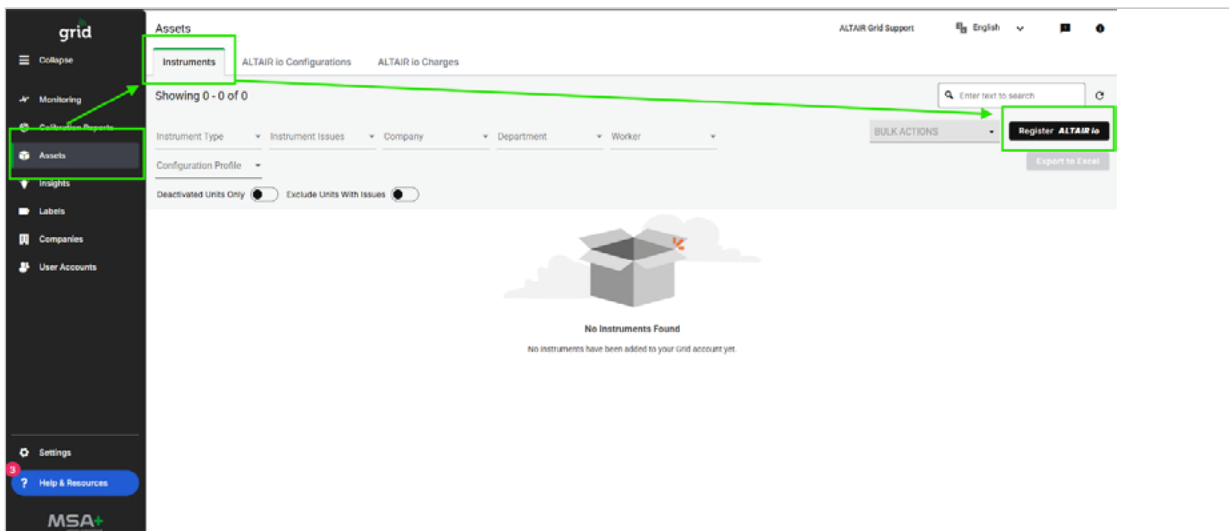

5. Manually enter the unit's **Serial Number** and **Activation Key**, located on the back of the instrument.
6. Click **Register**.

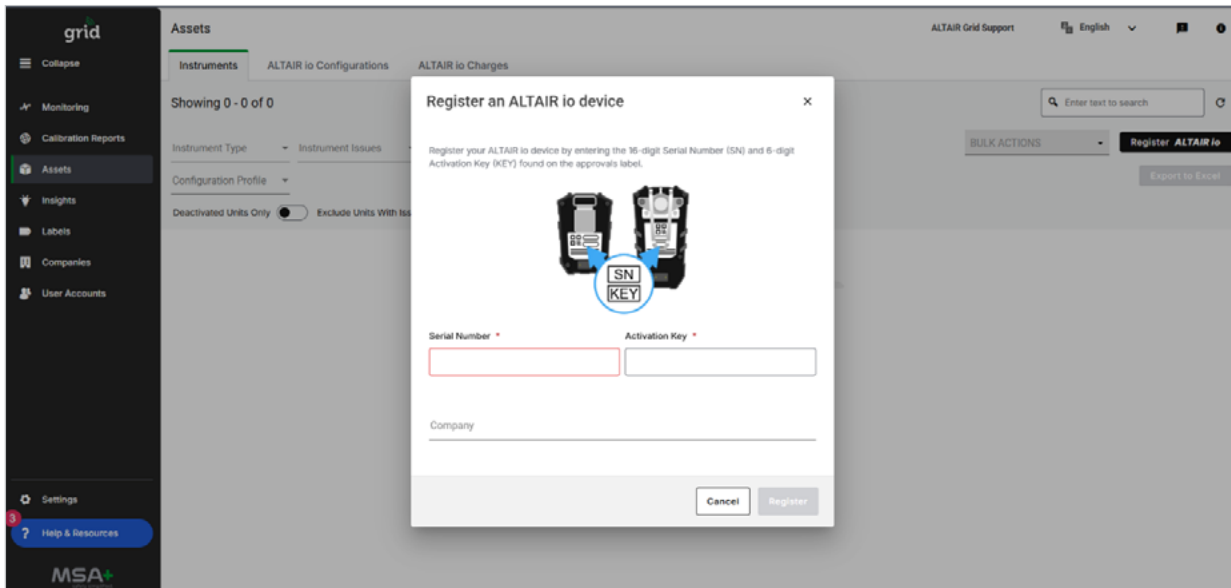

7. Repeat this process for any remaining ALTAIR io devices.
You have now successfully registered your ALTAIR io devices and should see them in the **Assets** tab in your Grid account.

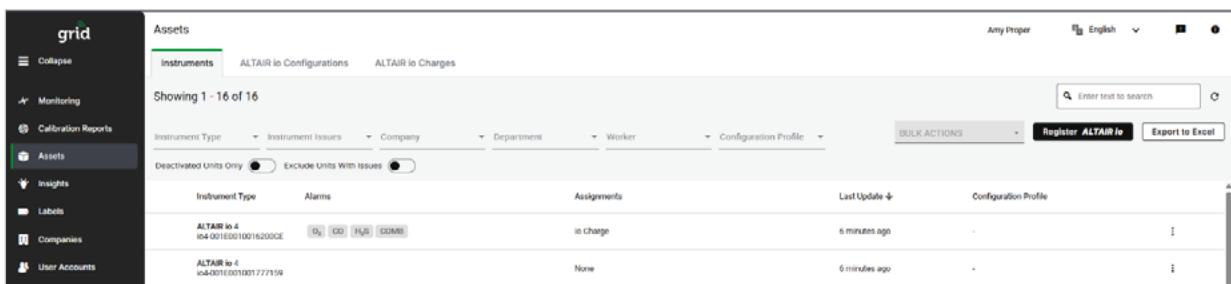

Registering your ALTAIR io Dock (Calibration Station) for use

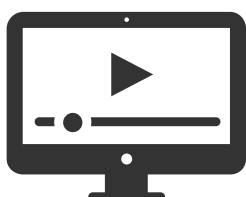

Click to watch the video.



Creating Custom Configurations for ALTAIR Devices

1. To change the settings profile or configuration of your ALTAIR io devices, log into your Grid account and navigate to the **Assets menu**, then click on the **ALTAIR io Configurations** tab.

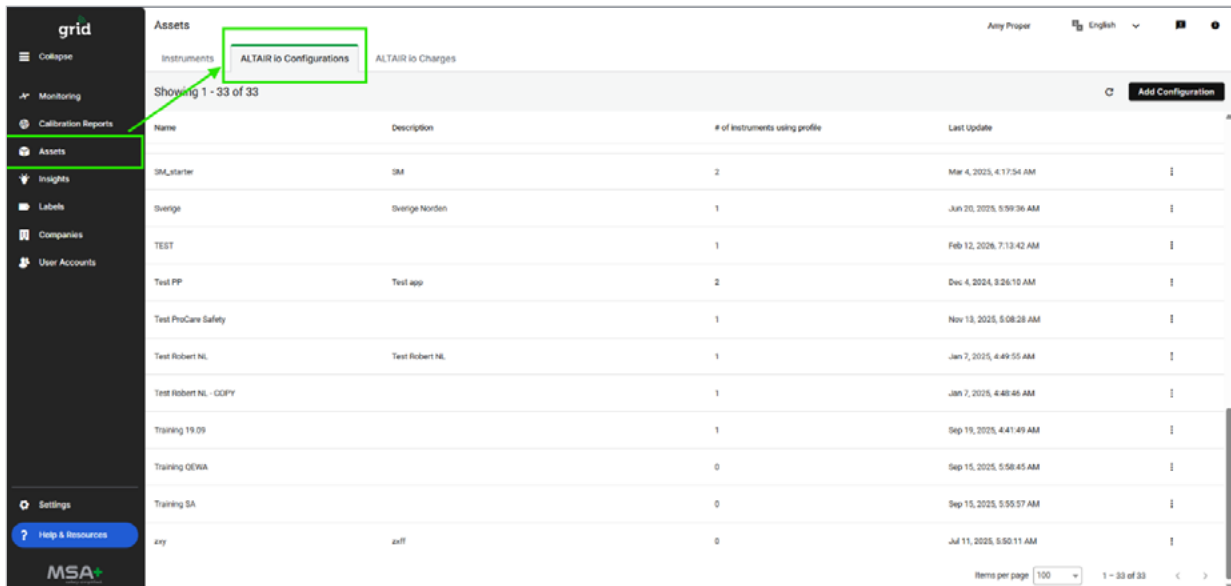

2. Once in the Configurations tab, click on **Add Configuration** to create a different, or custom configuration.

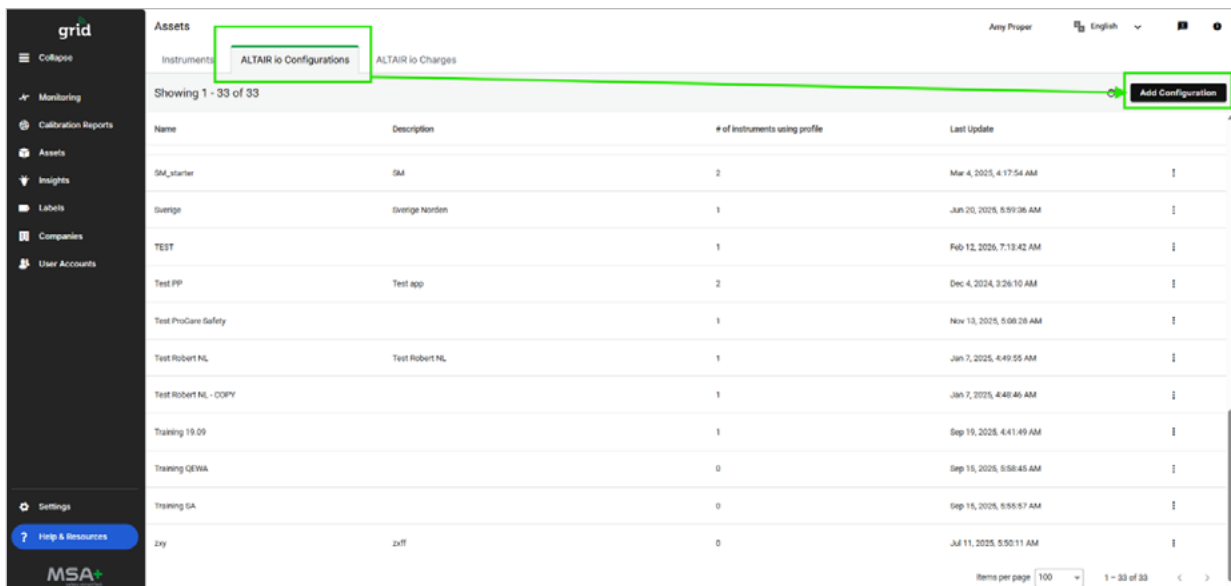

3. You can give this configuration a specific name and description.

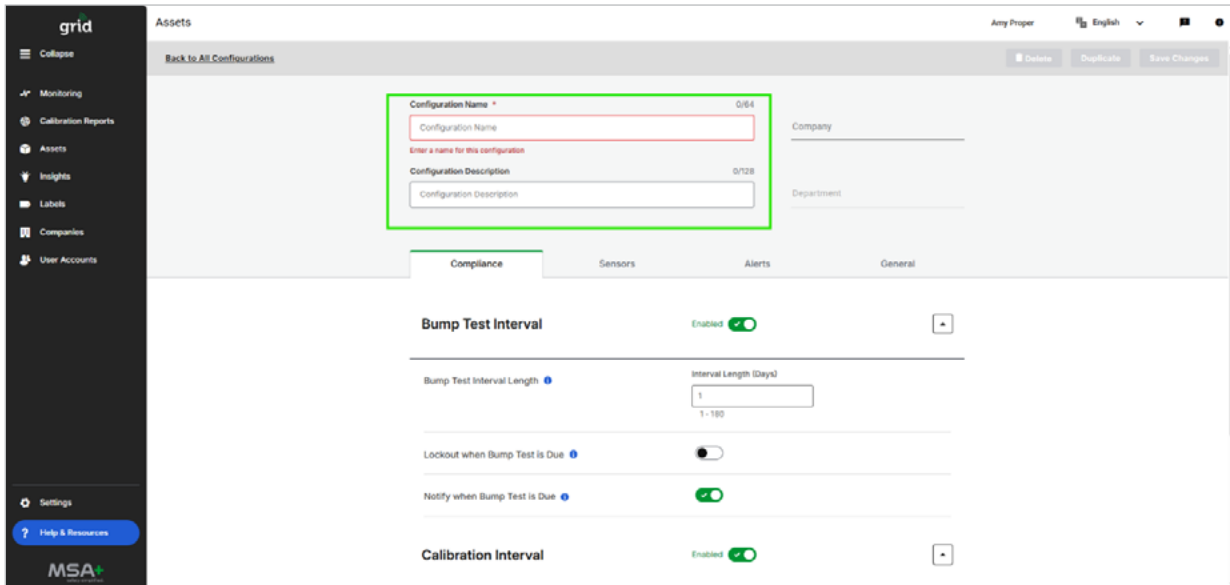

4. Review the various customizable settings. Hovering over the blue info (i) icons will provide details on each one. Example below:

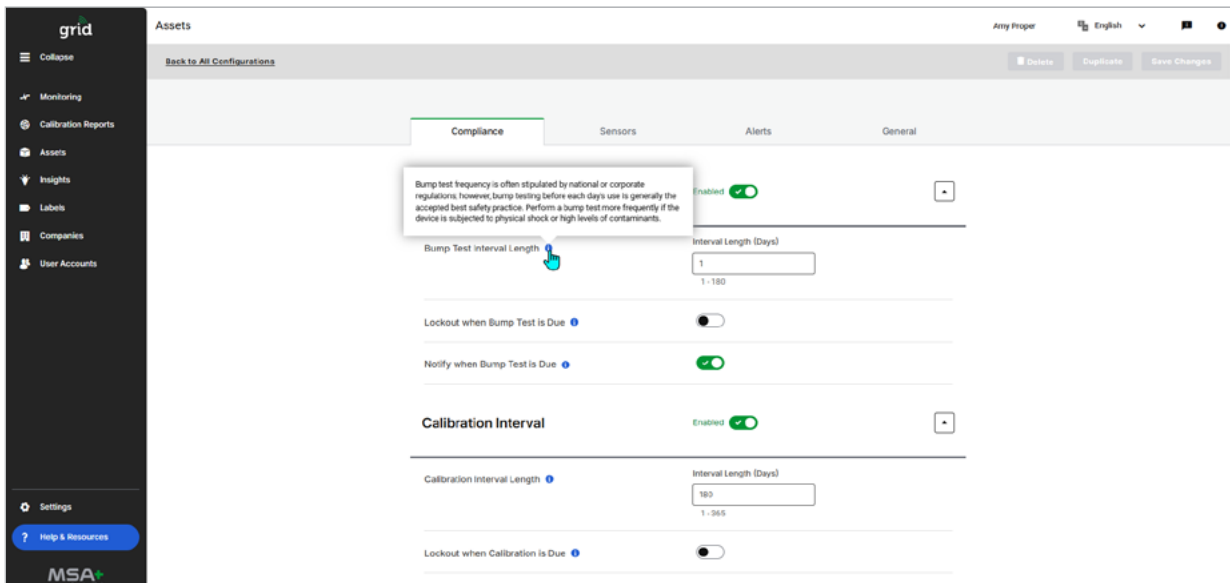

5. Adjust configurations as necessary, then click Save Changes in the upper right corner.

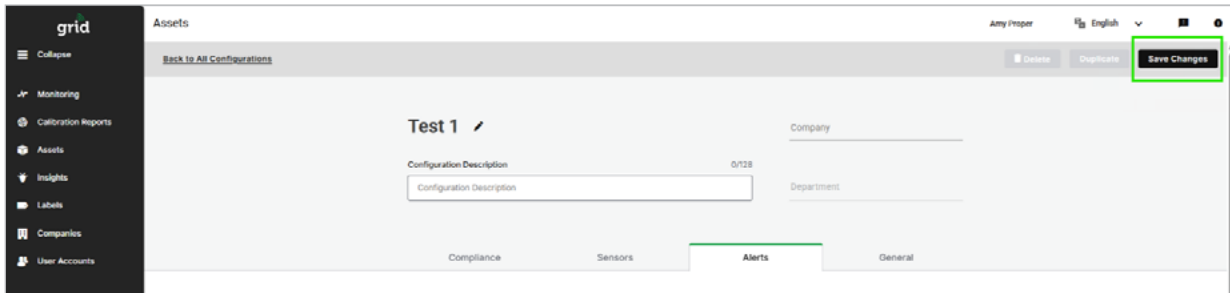

6. To apply this new configuration to some or all your ALTAIR io devices, navigate back to the **Instruments** tab, click on **BULK ACTIONS** and then **Configure (ALTAIR io)** from the drop-down menu.

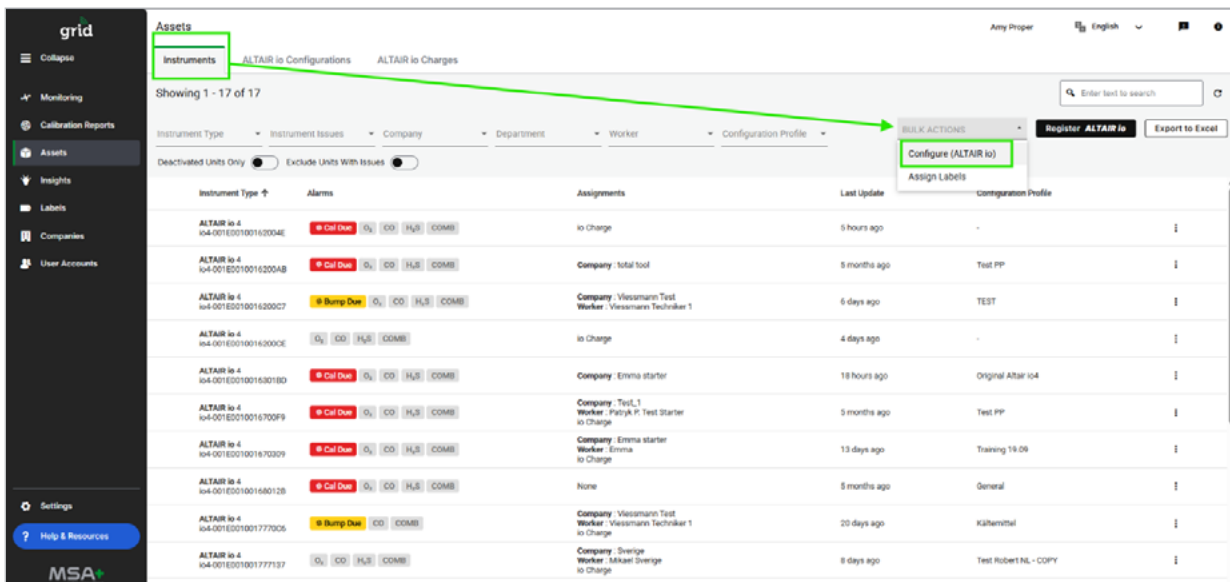

7. Adjust configurations as necessary, then click **Save Changes** in the upper right corner
8. Then, click box next to each instrument you wish to apply this configuration to. To select all instruments, click the box at the top next to “instrument type column.”
9. Select **Apply Configuration** and the devices will be updated when they are powered on and have established connectivity.

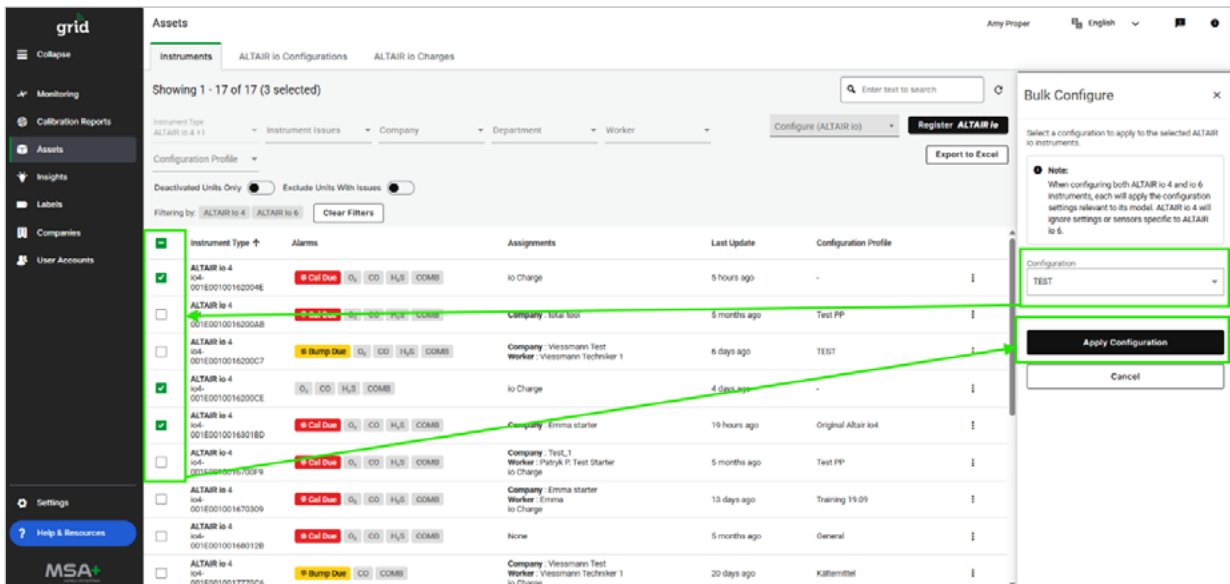

The screenshot shows the MSA grid Assets interface. The main table displays a list of instruments with columns for Instrument Type, Alarms, Assignments, Last Update, and Configuration Profile. A 'Bulk Configure' dialog box is open on the right, showing a 'Configuration' dropdown menu with 'TEST' selected and an 'Apply Configuration' button. Green lines highlight the selection checkboxes in the table and the 'Apply Configuration' button in the dialog.

Instrument Type	Alarms	Assignments	Last Update	Configuration Profile
ALTAIR io 4 04-001E00100162004E	Cal Due	io Charge	5 hours ago	-
ALTAIR io 4 04-001E00100162004B	Cal Due	Company - Test tool	5 months ago	Test PP
ALTAIR io 4 04-001E0010016200C7	Bump Due	Company - Vessmann Test Worker - Vessmann Techniker 1	6 days ago	TEST
ALTAIR io 4 04-001E0010016200CE	Cal Due	io Charge	4 days ago	-
ALTAIR io 4 04-001E00100163018D	Cal Due	Company - Emma starter	19 hours ago	Original Altair io4
ALTAIR io 4 04-001E001001630189	Cal Due	Company - Test L1 Worker - Patek P. Test Starter io Charge	5 months ago	Test PP
ALTAIR io 4 04-001E0010016470309	Cal Due	Company - Emma starter Worker - Emma io Charge	13 days ago	Training 19.09
ALTAIR io 4 04-001E001001648012B	Cal Due	None	5 months ago	General
ALTAIR io 4 04-001E001001677290A	Bump Due	Company - Vessmann Test Worker - Vessmann Techniker 1 io Charge	20 days ago	Kältemittel

Note: This Bulletin contains only a general description of the products shown. While product uses and performance capabilities are generally described, the products shall not, under any circumstances, be used by untrained or unqualified individuals. The products shall not be used until the product instructions/user manual, which contains detailed information concerning the proper use and care of the products, including any warnings or cautions, have been thoroughly read and understood. Specifications are subject to change without prior notice. MSA is a registered trademark of MSA Technology, LLC in the US, Europe, and other Countries. For all other trademarks visit <https://us.msasafety.com/Trademarks>.

MSA operates in over 40 countries worldwide. To find an MSA office near you, please visit [MSAsafety.com/offices](https://us.msasafety.com/offices).