



Manufactured by:  
Backyard Discovery  
3305 Airport Drive, Pittsburg, KS 66762  
800-856-4445

*Basepoint Business Centre: Rivermead Drive, Westlea, Swindon SN5 7EX Phone: 0800-118-2476 J.P. Coenstraat  
7, The Bridge, The Hague, 2595 WP, Netherlands Phone: 08005678990*

# SAVANNAH GREENHOUSE GUTTER KIT

**MODEL #: 9250215**



**Please visit [www.backyarddiscovery.com](http://www.backyarddiscovery.com)**

**For the most up to date assembly manual, to register your product, or to order**

**replacement parts Para obtener instrucciones en español, visite**

**[www.backyarddiscovery.com](http://www.backyarddiscovery.com)**

# OWNER'S MANUAL - PARTS IDENTIFICATION

## Hardware Components

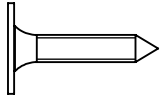

H101205 SCREW PWH BLK  
(x16) 8 x 3/4



H101414 SELF PIERCING SCREW BLK  
(x24) #8 x 1/2

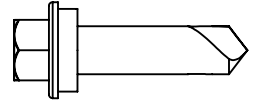

H101480 SCREW SELF TAPPING #9x1 BLK  
(x16) 1/4 x 1

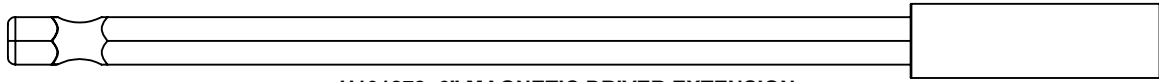

H101278 6" MAGNETIC DRIVER EXTENSION  
(x1)

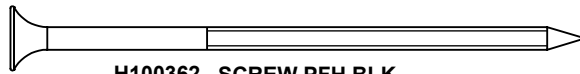

H100362 SCREW PFH BLK  
(x16) 8x3



A6P01531 10 OZ SILICONE TUBE  
(x2)

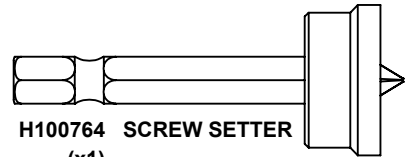

H100764 SCREW SETTER  
(x1)

## Wood Components (NOT TO SCALE)

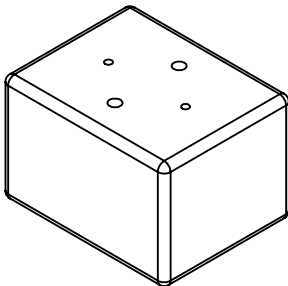

W4L21320 GUTTER SPACER  
(x4) 1 15/16"x2 3/8"x3"

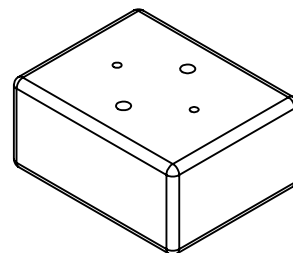

W4L21461 GUTTER SPACER  
(x4) 1 7/16"x2 3/8"x3"

# OWNER'S MANUAL - PARTS IDENTIFICATION

## Accessory Components (NOT TO SCALE)

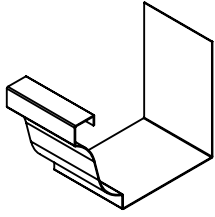

**A4M04765 GUTTER SPLICE**  
(x1) 2 1/2"x3 11/16"x5 1/16" [64x94x129]

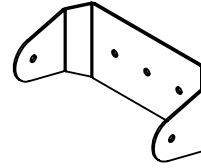

**A4M04782 DOWNSPOUT CLIP**  
(x8) 1 7/16"x1 7/16"x3 1/8" [37x37x79]

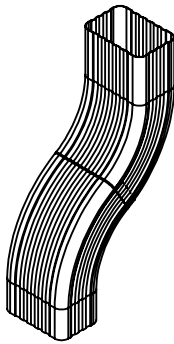

**A4M05872 DOWNSPOUT OFFSET - 4IN**  
(x4) 3"x6"x10 5/8" [76x152x270]

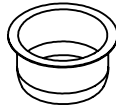

**A4M04761 DOWNSPOUT OUTLET**  
(x4) 1 7/16"x2 7/8" [37x73]

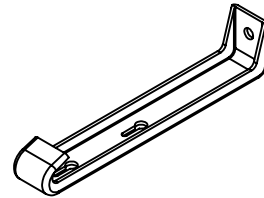

**A4M04759 GUTTER HANGER**  
(x16) 3/4"x1"x4 15/16" [19x25x125]

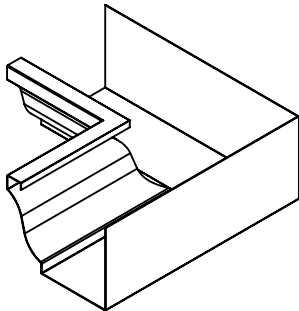

**A4M04767 GUTTER CORNER SPLICE**  
(x2) 3 11/16"x9 15/16"x9 15/16" [94x252x252]

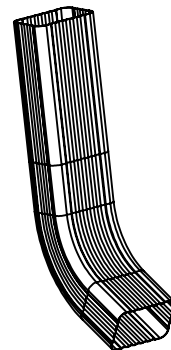

**A4M06238 LONG DOWNSPOUT ELBOW**  
(x4) 3"x10 5/8"x10 11/16" [76x270x271]



**A4M04783 DOWNSPOUT - 5FT**  
(x4) 2"x3"x60" [51x76x1524]

# **OWNER'S MANUAL - PARTS IDENTIFICATION**

## **Accessory Components (NOT TO SCALE)**

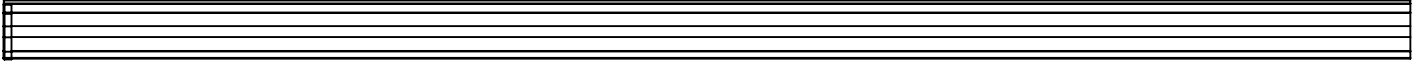

**A4M04764 REAR RIGHT GUTTER W/ OUTLET**  
(x1) 3 11/16"x5 1/8"x87 7/8" [93x130x2232]

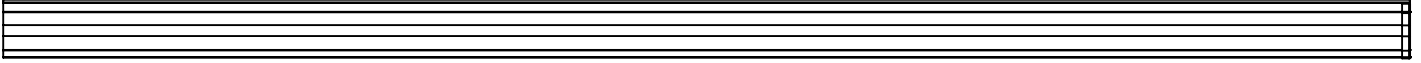

**A4M04758 REAR LEFT GUTTER W/ OUTLET**  
(x1) 3 11/16"x5 1/8"x87 7/8" [93x130x2232]

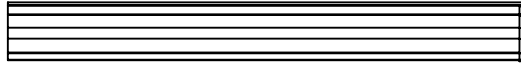

**A4M04768 FRONT RIGHT GUTTER W/ OUTLET**  
(x1) 3 11/16"x5 1/8"x32 7/16" [93x130x825]

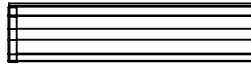

**A4M04769 FRONT RIGHT GUTTER**  
(x1) 3 11/16"x5 1/8"x15 7/16" [93x130x392]

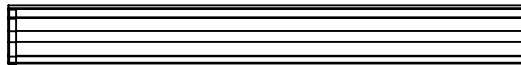

**A4M04770 FRONT LEFT GUTTER W/ OUTLET**  
(x1) 3 11/16"x5 1/8"x32 7/16" [93x130x825]

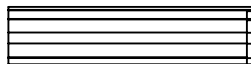

**A4M04771 FRONT LEFT GUTTER**  
(x1) 3 11/16"x5 1/8"x15 7/16" [93x130x392]

# PRE-ASSEMBLY STEP 1 - SORTING PARTS

It is critical for ease of assembly that you take the time to sort and organize the parts and hardware.

---

## **HARDWARE PARTS:**

- We recommend that you have a separate table to organize the hardware.
- Hardware bags are printed with a seven-digit, alpha-numeric part number.
- You can organize your hardware by part number or group by hardware type (e.g. bolts, nuts, etc.).
- During assembly you only need to reference the last four digits of the number.



---

## **TOOLS REQUIRED:**



Cordless Drill or  
Electric Drill



Caulk Gun



1/8" Drill Bit



Tape Measure

# GUTTER SPLICE PAGE

- NOTE:**
- APPLY SILICONE TO INSIDE CHANNEL ON BOTH SIDES.
  - ENSURE SILICONE IS EVENLY APPLIED ALONG THE CHANNEL.
  - AFTER GUTTER SPLICE HAS BEEN SLID ONTO GUTTERS AND SILICONE HAS HAD TIME TO CURE, USING HAND PRESSURE ONLY, FOLD THE TOP TAB OVER EDGE OF GUTTER

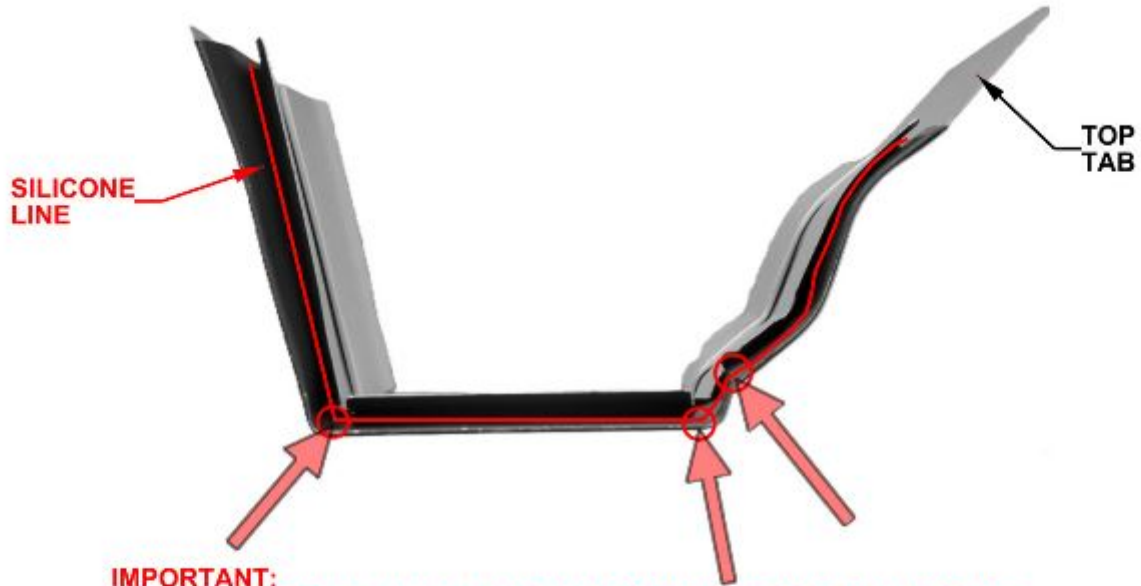

- IMPORTANT:**
- APPLY SILICONE LIBERALLY INTO CORNERS AS INDICATED ABOVE.

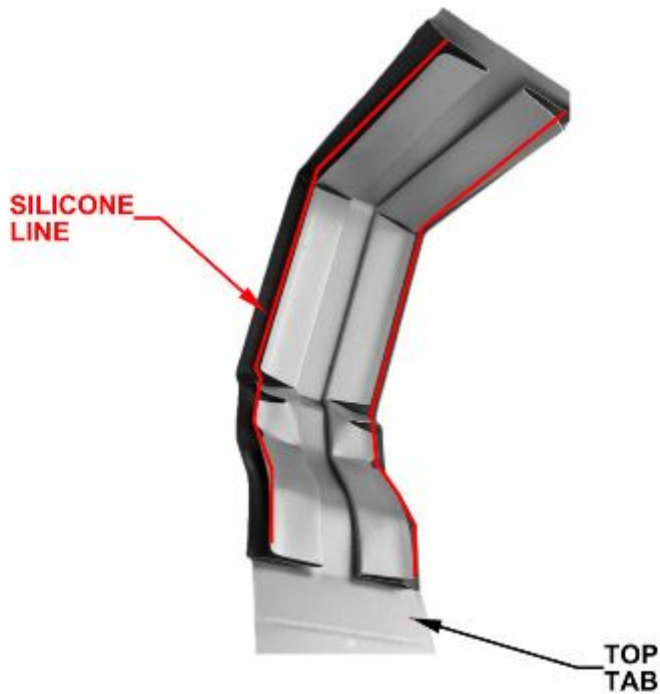

WAIT APPROXIMATELY 45 MINUTES FOR SILICONE TO BECOME TACKY.  
AFTER 24 HOURS, SILICONE HAS CURED AND CAN HOLD WATER

# OUTSIDE/INSIDE CORNER MITER PAGE

**NOTE:**

- AFTER GUTTER KIT HAS BEEN INSTALLED, IT IS CRITICAL TO CAULK CORNER MITER JOINTS TO PREVENT LEAKS.

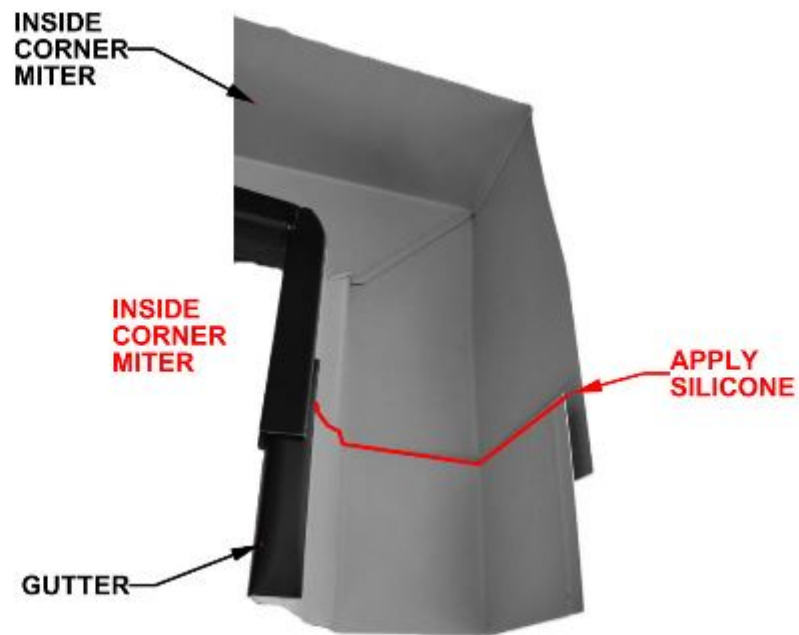
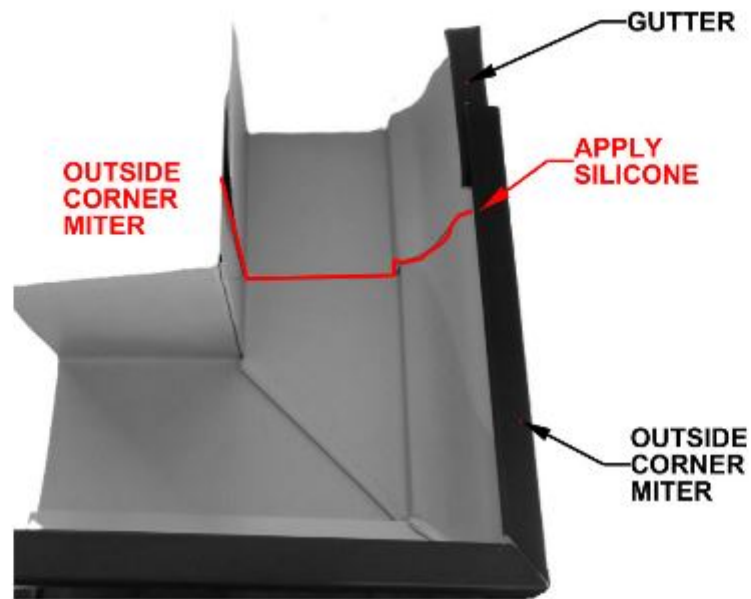

WAIT APPROXIMATELY 45 MINUTES FOR SILICONE TO BE COME TACKY.  
AFTER 24 HOURS, SILICONE HAS CURED AND CAN HOLD WATER

# OFFSET ORIENTATION

TO ENSURE WATER FLOWS PROPERLY, IT IS IMPORTANT TO ORIENT DOWNSPOUT PIPING CORRECTLY. STARTING AT THE TOP, DOWNSPOUTS MUST FEED INTO THE NEXT SECTION AS SHOWN.

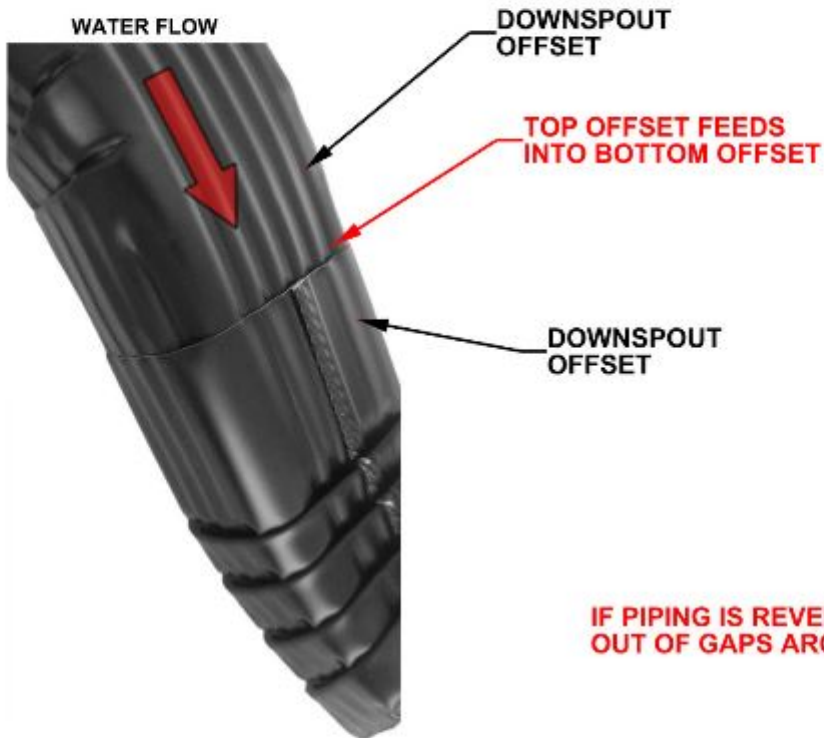

IF PIPING IS REVERSED, WATER WILL RUN OUT OF GAPS AROUND JOINTS



# STEP 1 - EDGE TRIM REMOVAL

QTY	PART NUMBER	DESCRIPTION
19	H101206	SCREW WOODGRIP 10-16X1-1/4"

- REMOVE EDGE TRIM, EDGE TRIM SPLICE, AND HARDWARE.
- SET EDGE TRIM AND HARDWARE ASIDE FOR FUTURE USE.

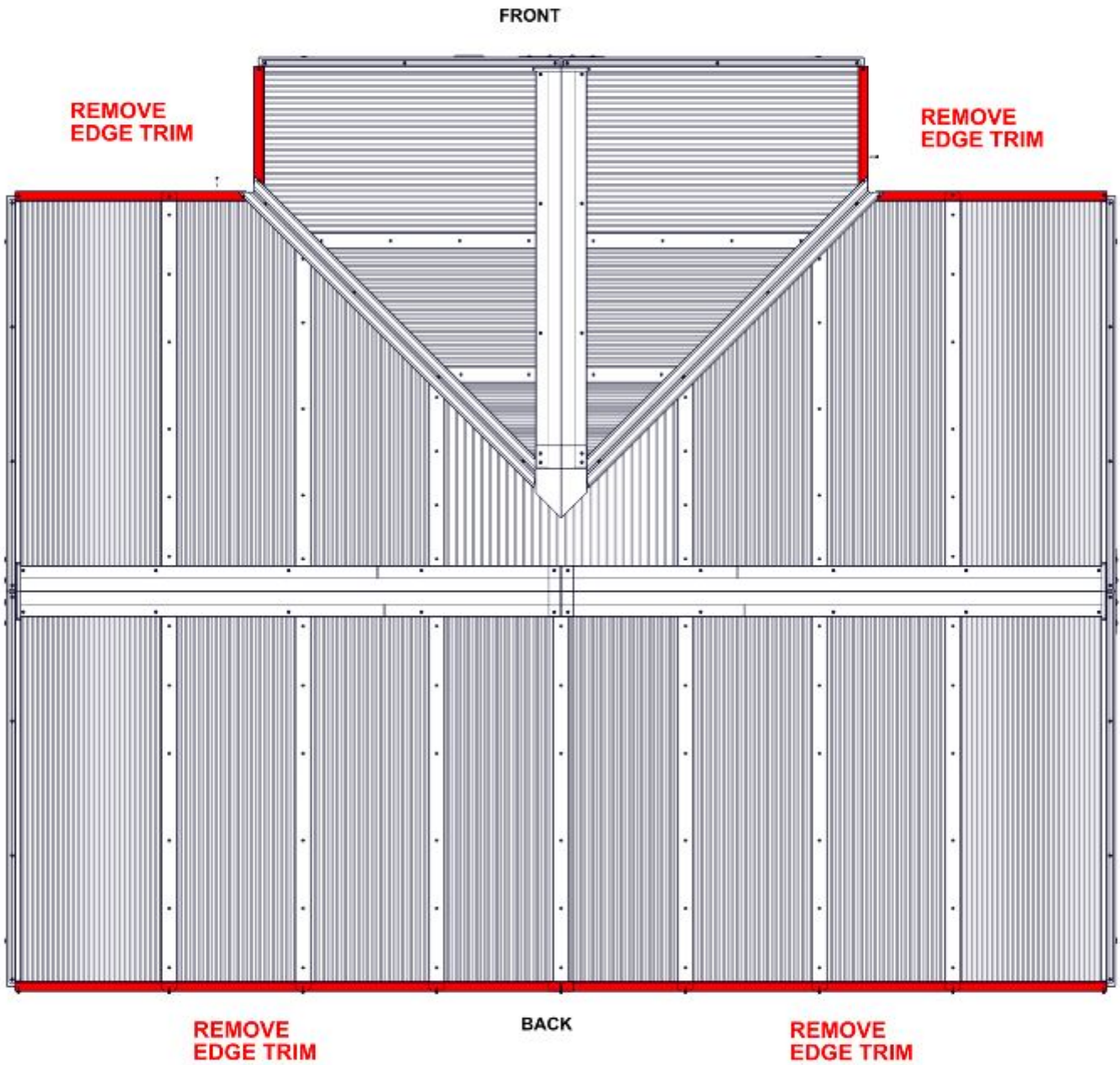

## STEP 2 - GUTTER ASSEMBLY

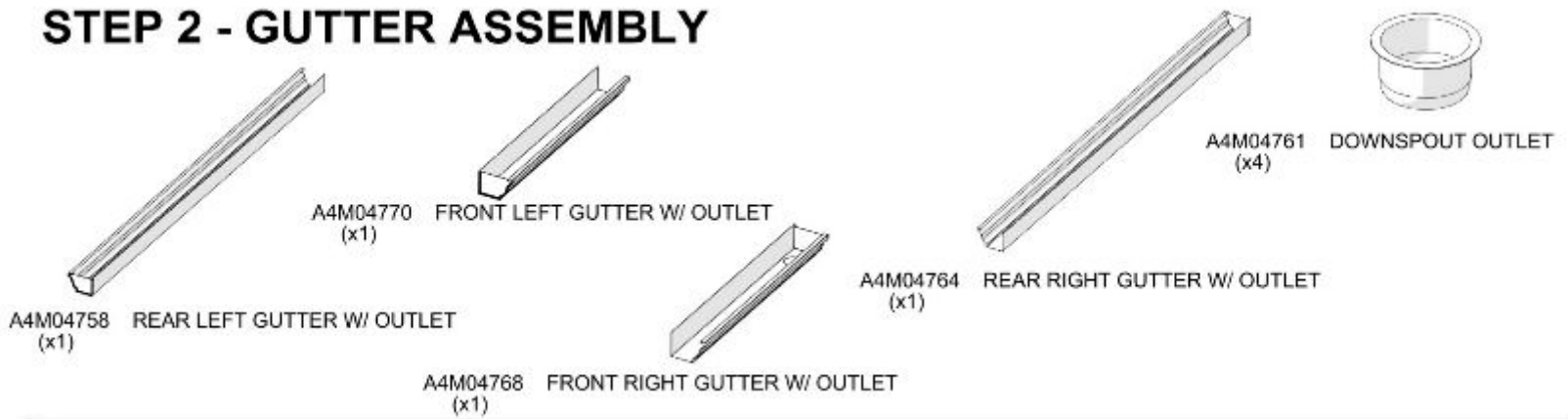

- APPLY A BEAD OF SILICONE AROUND THE UNDERSIDE OF THE LIP OF THE DOWNSPOUT OUTLET AND PLACE OUTLET INSIDE GUTTER.
- COMPLETE THIS STEP TWICE.

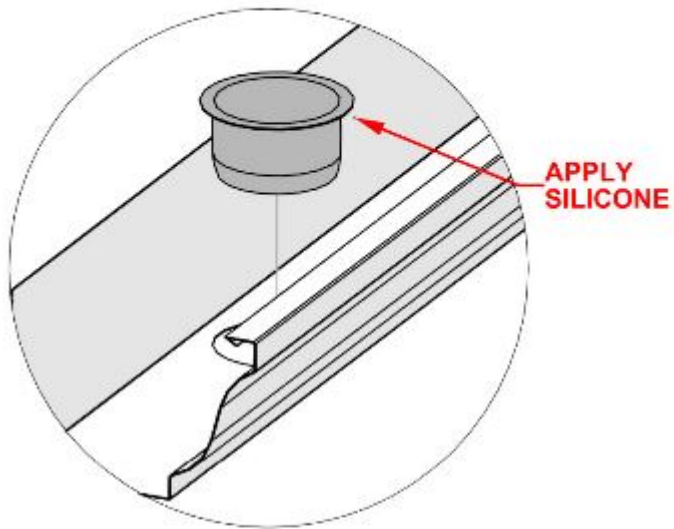

TIP: PRESSURE MAY NEED TO BE APPLIED TO GET OUTLET INTO POSITION. USE A WET FINGER TO FLATTEN SILICONE AFTER INSTALLED.

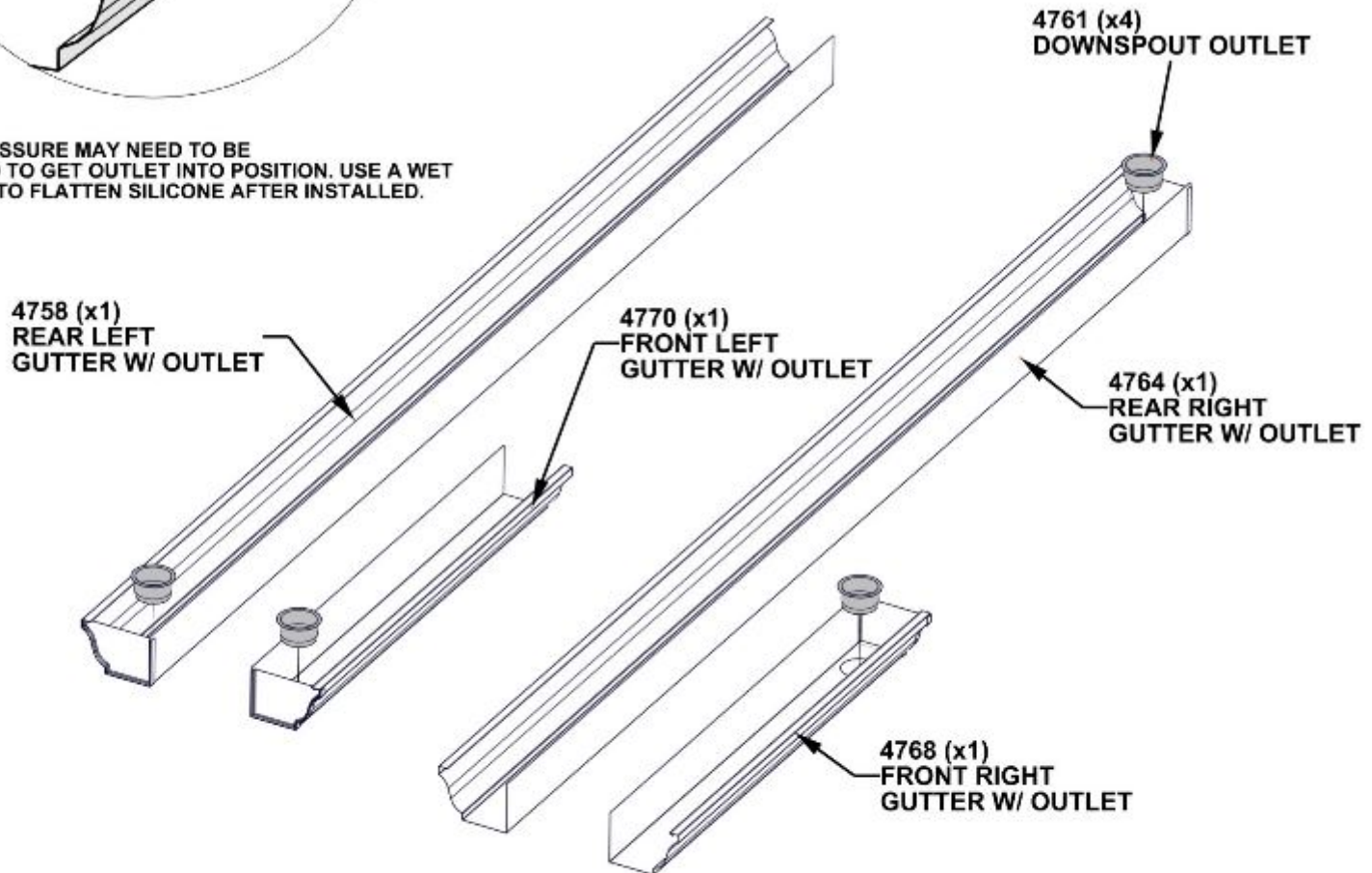

# STEP 3 - GUTTER ASSEMBLY

QTY	PART NUMBER	DESCRIPTION
2	H101480	SCREW SELF TAPPING #9x1 BLK

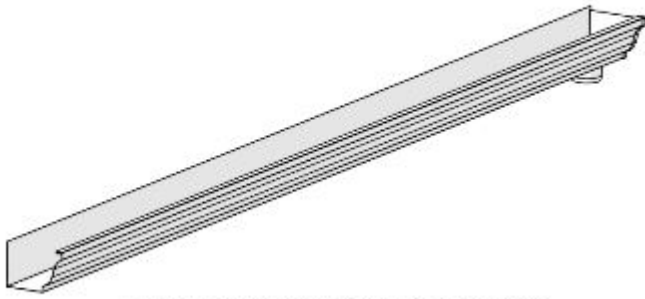

REAR LEFT GUTTER W/ OUTLET - STEP 2



A4M04759 GUTTER HANGER (x2)

- FLUSH BOTTOM OF GUTTER WITH BEAM AS SHOWN.
- DOWNSPOUT OUTLET MUST BE CENTERED WITH POST.
- ATTACH FIRST GUTTER HANGER 3" [75mm] FROM INSIDE OF GUTTER.
- ATTACH SECOND GUTTER HANGER APPROXIMATELY 48" [1235mm] FROM THE FIRST HANGER.
- PRE-DRILL PILOT HOLES FOR EASE OF ASSEMBLY.

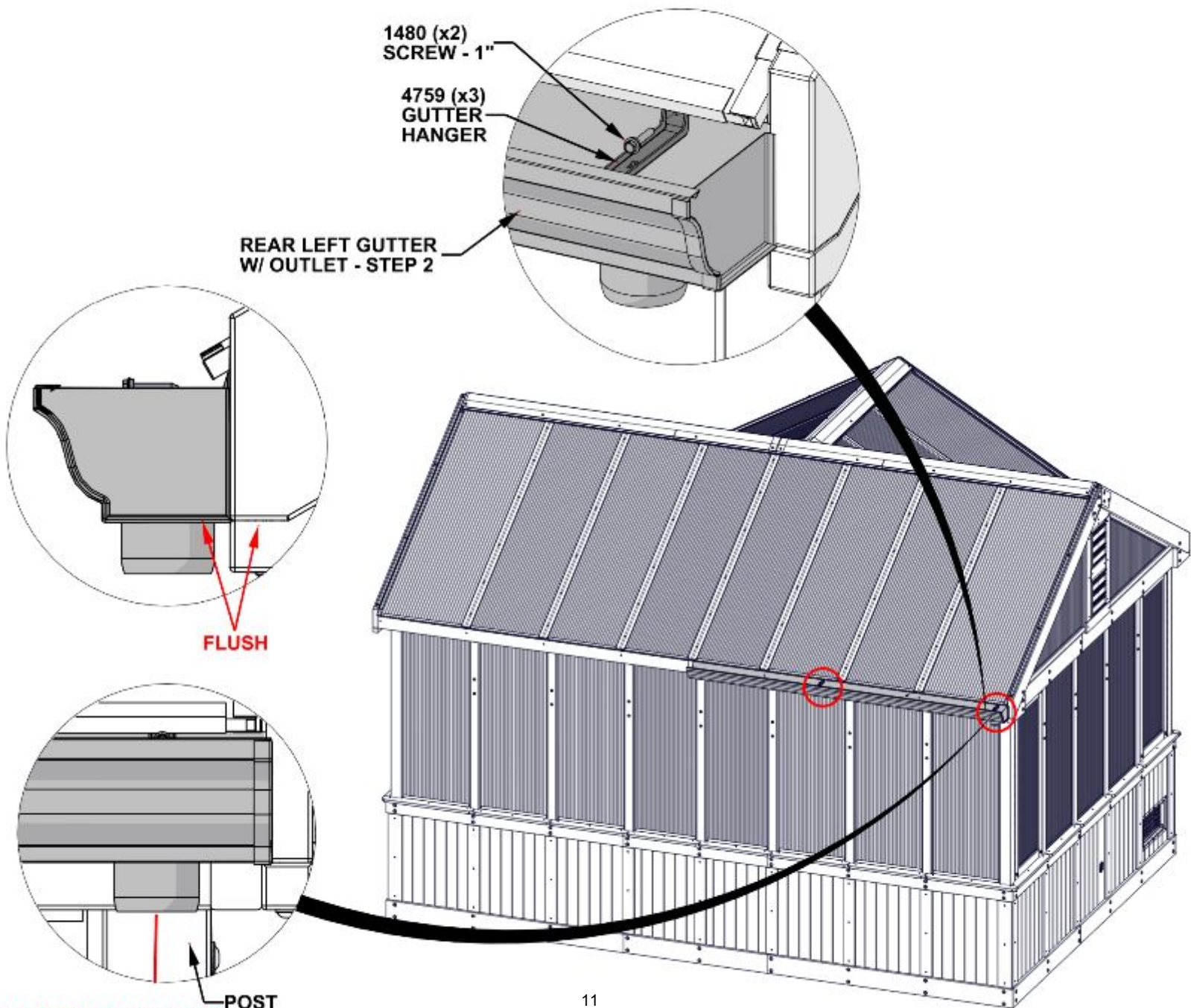

# STEP 4 - GUTTER ASSEMBLY

QTY	PART NUMBER	DESCRIPTION
2	H101480	SCREW SELF TAPPING #9x1 BLK

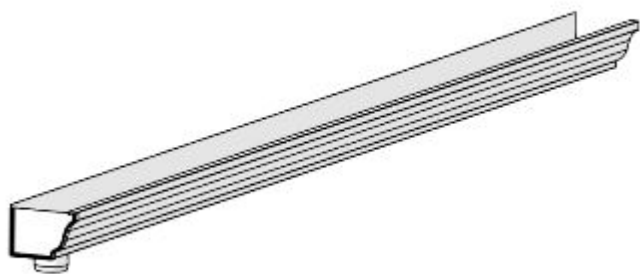

REAR LEFT GUTTER W/ OUTLET - STEP 2

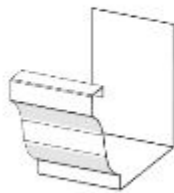

A4M04765 GUTTER SPLICE (x1)



A4M04759 GUTTER HANGER (x2)

- FLUSH BOTTOM OF GUTTER WITH BEAM AS SHOWN.
- DOWNSPOUT OUTLET MUST BE CENTERED WITH POST.
- ATTACH FIRST HANGER 3" [75mm] FROM THE INSIDE OF THE GUTTER.
- ATTACH THE SECOND HANGER APPROXIMATELY 48" [1235mm] FROM THE FIRST HANGER.
- PRE-DRILL 1/8" [3mm] PILOT HOLES FOR EASE OF ASSEMBLY.
- SEE CAULKING SHEET FOR DETAILS.

**APPLY SILICONE TO SPLICE GROOVE BEFORE INSERTING INTO GUTTER**

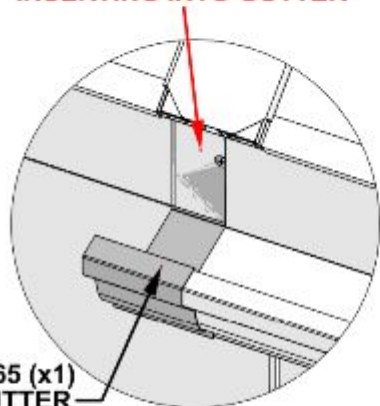

4765 (x1) GUTTER SPLICE

1480 (x2) SCREW - 1"

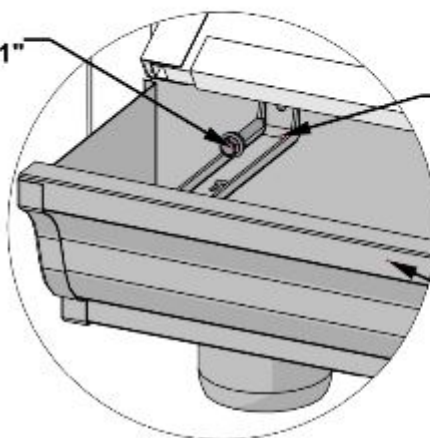

4759 (x2) GUTTER HANGER

4764 (x1) REAR LEFT GUTTER ASSEMBLY

**APPLY SILICONE TO SPLICE GROOVE BEFORE INSERTING GUTTER INTO SPLICE**

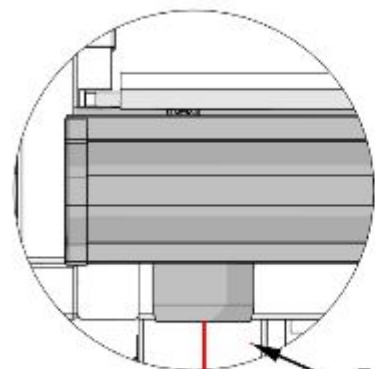
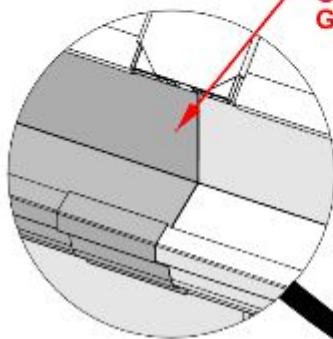

**CENTER DOWNSPOUT OUTLET ON POST**

POST

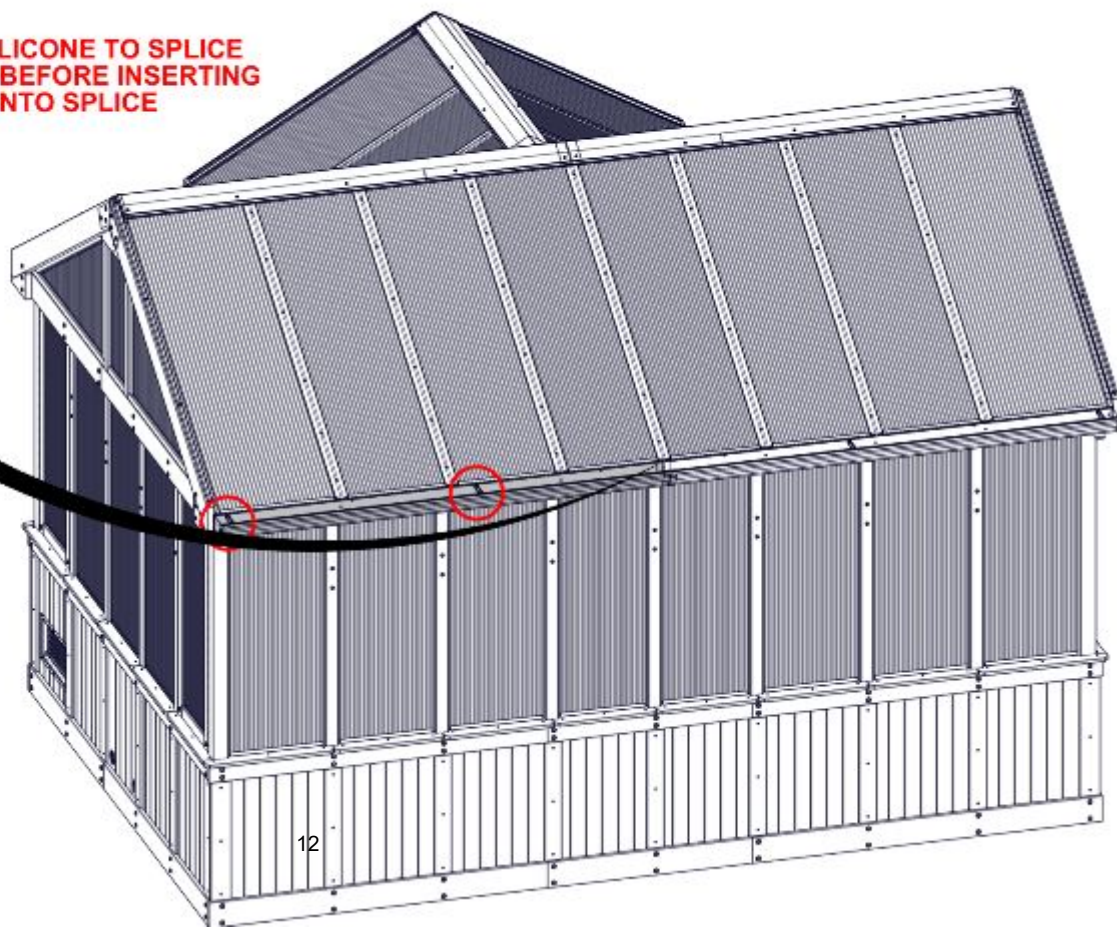

# STEP 5 - GUTTER ASSEMBLY

QTY	PART NUMBER	DESCRIPTION
2	H101480	SCREW SELF TAPPING #9x1 BLK



FRONT RIGHT GUTTER W/ OUTLET - STEP 2



A4M04759 GUTTER HANGER (x2)

- FLUSH BOTTOM OF GUTTER WITH BOTTOM BEAM AS SHOWN.
- DOWNSPOUT OUTLET MUST BE CENTERED WITH POST.
- ATTACH THE FIRST HANGER 3" [75mm] FROM THE INSIDE OF THE GUTTER.
- ATTACH THE SECOND HANGER 27" [685mm] FROM THE INSIDE OF THE GUTTER.
- PRE-DRILL PILOT HOLES FOR EASE OF ASSEMBLY.

1480 (x2) SCREW - 1"      4759 (x2) GUTTER HANGER

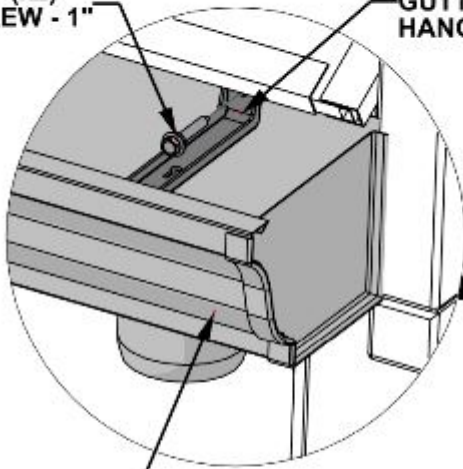

FRONT RIGHT GUTTER W/ OUTLET - STEP 2

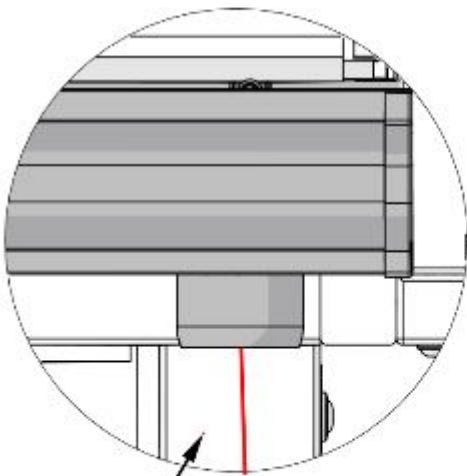
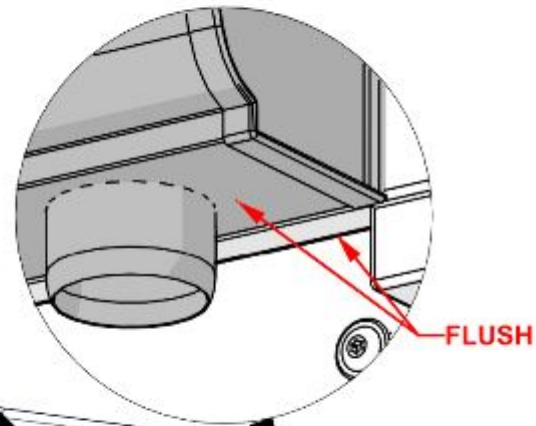

POST  
**CENTER DOWNSPOUT OUTLET ON POST**

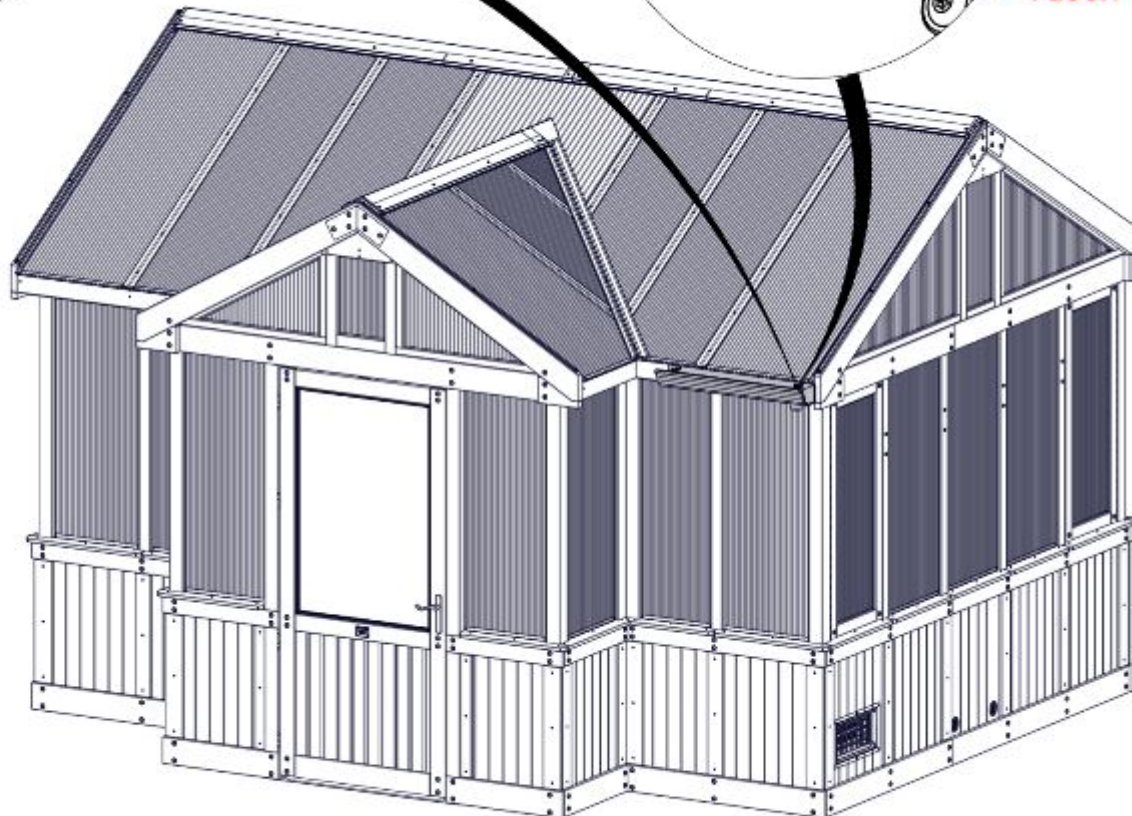

# STEP 6 - GUTTER ASSEMBLY

QTY	PART NUMBER	DESCRIPTION
2	H101480	SCREW SELF TAPPING #9x1 BLK

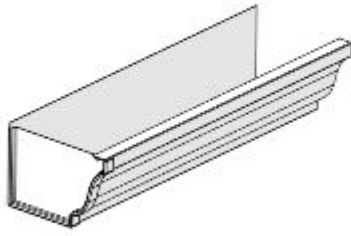

A4M04769 FRONT RIGHT GUTTER  
(x1)



A4M04759 GUTTER HANGER  
(x2)

- FLUSH BOTTOM OF GUTTER WITH BOTTOM BEAM AS SHOWN.
- DOWNSPOUT OUTLET MUST BE CENTERED WITH POST.
- ATTACH THE FIRST HANGER 3" [75mm] FROM THE INSIDE OF THE GUTTER.
- ATTACH THE SECOND HANGER 27" [685mm] FROM THE INSIDE OF THE GUTTER.
- PRE-DRILL PILOT HOLES FOR EASE OF ASSEMBLY.

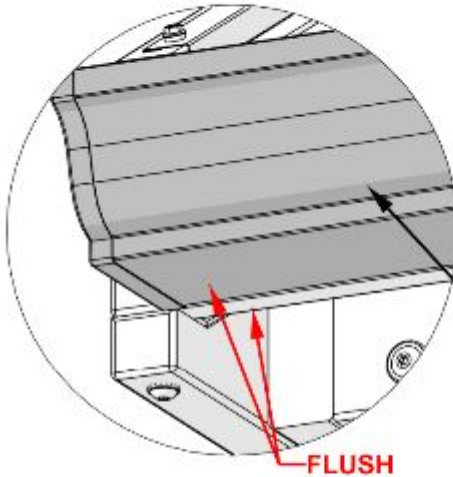

4769 (x1)  
FRONT RIGHT GUTTER

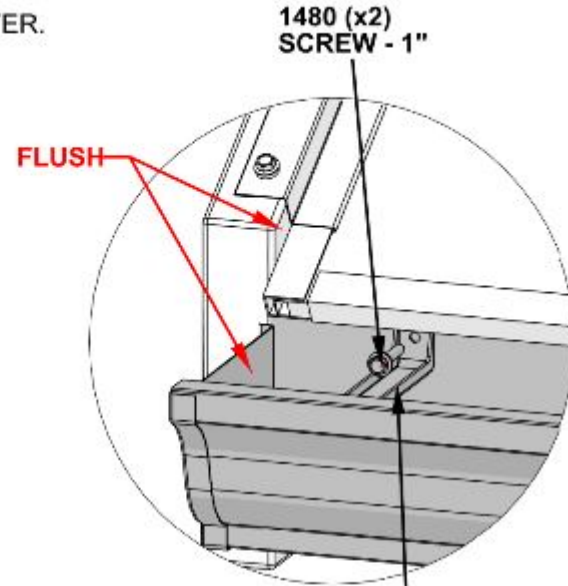

1480 (x2)  
SCREW - 1"

4759 (x2)  
GUTTER  
HANGER

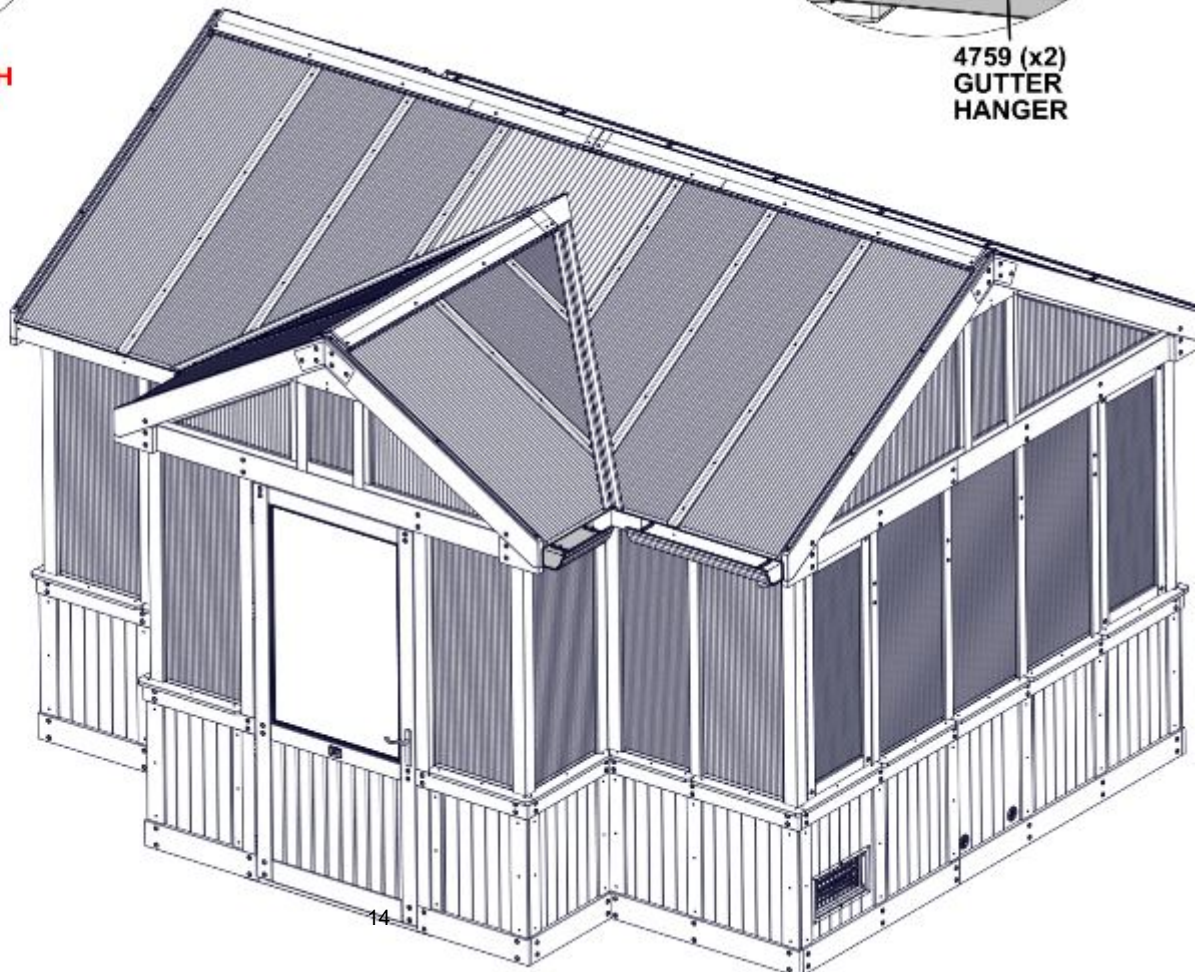

# STEP 7 - GUTTER ASSEMBLY

QTY	PART NUMBER	DESCRIPTION
4	H101480	SCREW SELF TAPPING #9x1 BLK

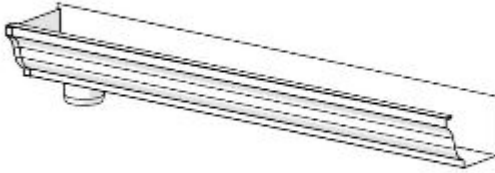

FRONT LEFT GUTTER W/ OUTLET - STEP 2

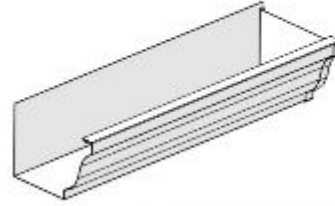

A4M04771 FRONT LEFT GUTTER (x1)



A4M04759 GUTTER HANGER (x4)

- FLUSH BOTTOM OF GUTTER WITH BOTTOM BEAM AS SHOWN.
- DOWNSPOUT OUTLETS MUST BE CENTERED WITH POST.
- PRE-DRILL PILOT HOLES FOR EASE OF ASSEMBLY.

- FOLLOW ASSEMBLY NOTES FROM STEPS 5 AND 6 FOR ASSEMBLY.
- ATTACH THE FIRST GUTTER HANGER 3" [75mm] FROM THE INSIDE OF THE GUTTER
- ATTACH THE SECOND GUTTER HANGER 27" [685mm] FROM THE INSIDE OF THE GUTTER

4759 (x4) GUTTER HANGER

1480 (x4) SCREW - 1"

FLUSH

4771 (x1) FRONT LEFT GUTTER

FLUSH

FRONT LEFT GUTTER W/ OUTLET - STEP 2

POST

CENTER DOWNSPOUT OUTLET ON POST

# STEP 8 - GUTTER ASSEMBLY

QTY	PART NUMBER	DESCRIPTION
16	H100362	SCREW PFH 8x3 BLK
16	H101205	SCREW PWH 8x15x3/4 BLK

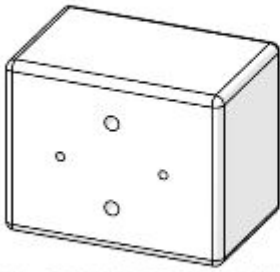

AA02 GUTTER SPACER - W4L21320  
(x4) 1 15/16"x2 3/8"x3" (50x60x76)

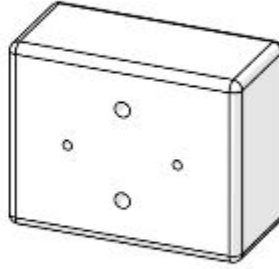

F19 GUTTER SPACER - W4L21461  
(x4) 1 7/16"x2 3/8"x3" (36x60x76)

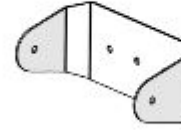

A4M04782 DOWNSPOUT CLIP  
(x8)

- ALIGN PILOT HOLES.
- AA02 SPACER GOES ON TOP, F19 SPACER GOES ON BOTTOM.
- IT IS IMPORTANT TO CENTER 4782 CLIP AND HARDWARE ON POST.
- COMPLETE ON ALL 4 CORNERS WHERE OUTLETS ARE LOCATED.

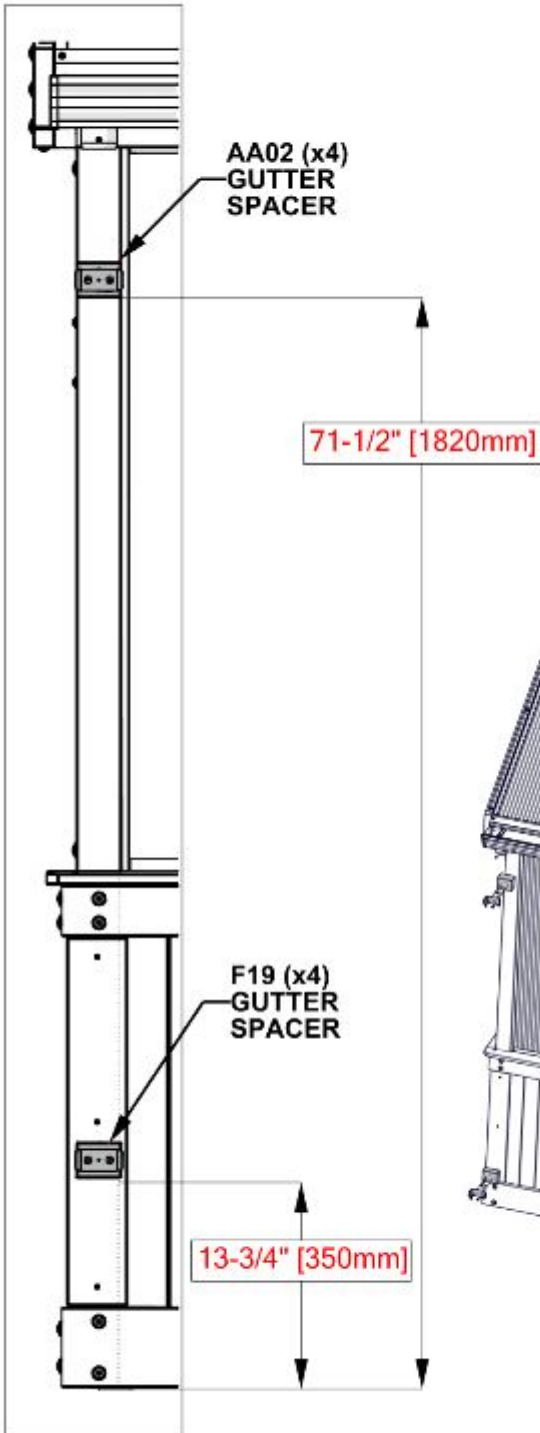

362 (x16)  
SCREW - 3"

4782 (x8)  
DOWNSPOUT  
CLIP

1205 (x16)  
SCREW - 3/4"

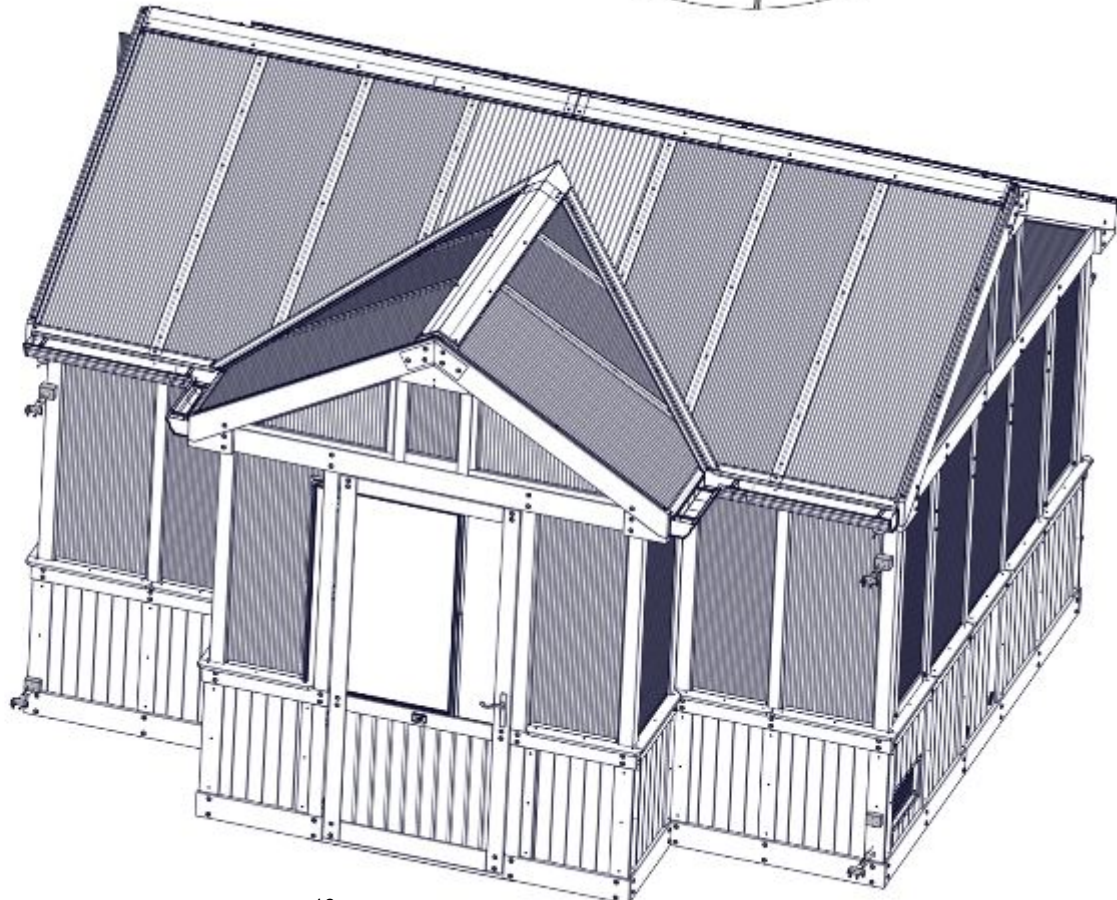
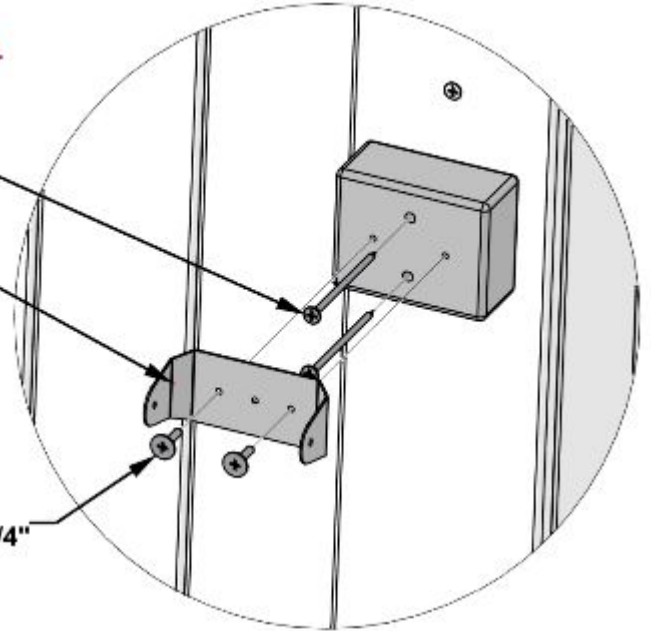

# STEP 9 - GUTTER ASSEMBLY

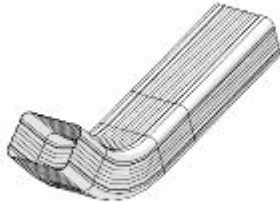

A4M06238 LONG DOWNSPOUT ELBOW  
(x4)



A4M04783 DOWNSPOUT - 5FT  
(x4)

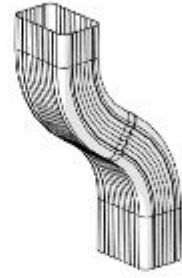

A4M05872 DOWNSPOUT OFFSET  
(x4)

- INSERT TAPERED ENDS INTO LARGER ENDS.
- NOTE ORIENTATION OF DOWNSPOUT OFFSET. SEE DOWNSPOUT OFFSET PAGE FOR DETAIL.
- COMPLETE THIS STEP 4 TIMES.

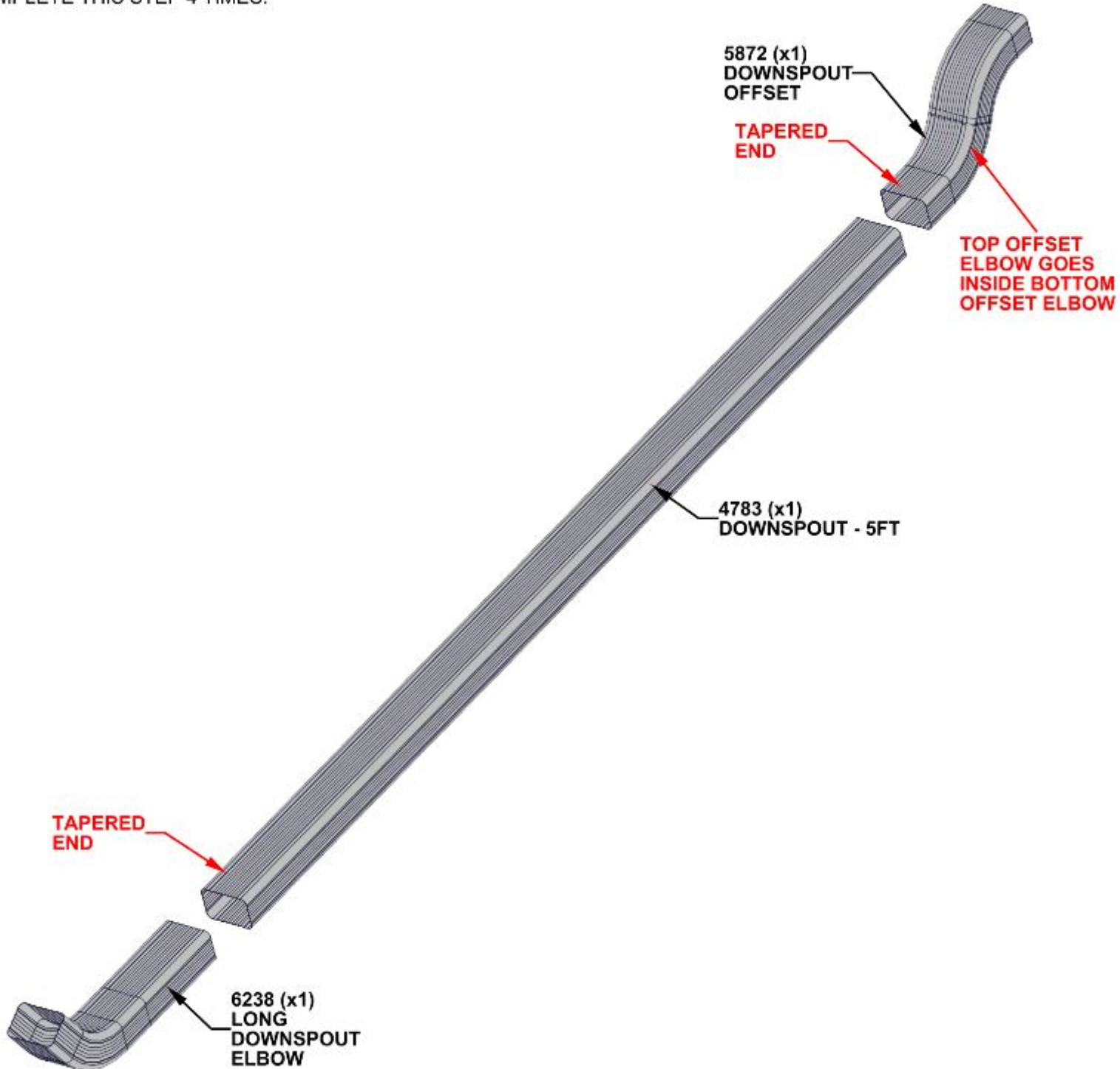

# STEP 10 - GUTTER ASSEMBLY



QTY	PART NUMBER	DESCRIPTION
4	H101414	SCREW SELF PIERCING #8x1/2 BLK

DOWNSPOUT ASSEMBLIES FROM PREVIOUS STEP

- FASTEN DOWNSPOUT TO DOWNSPOUT OUTLET USING HARDWARE PROVIDED.
- COMPLETE THIS STEP AT EACH OF THE 4 DOWNSPOUTS.

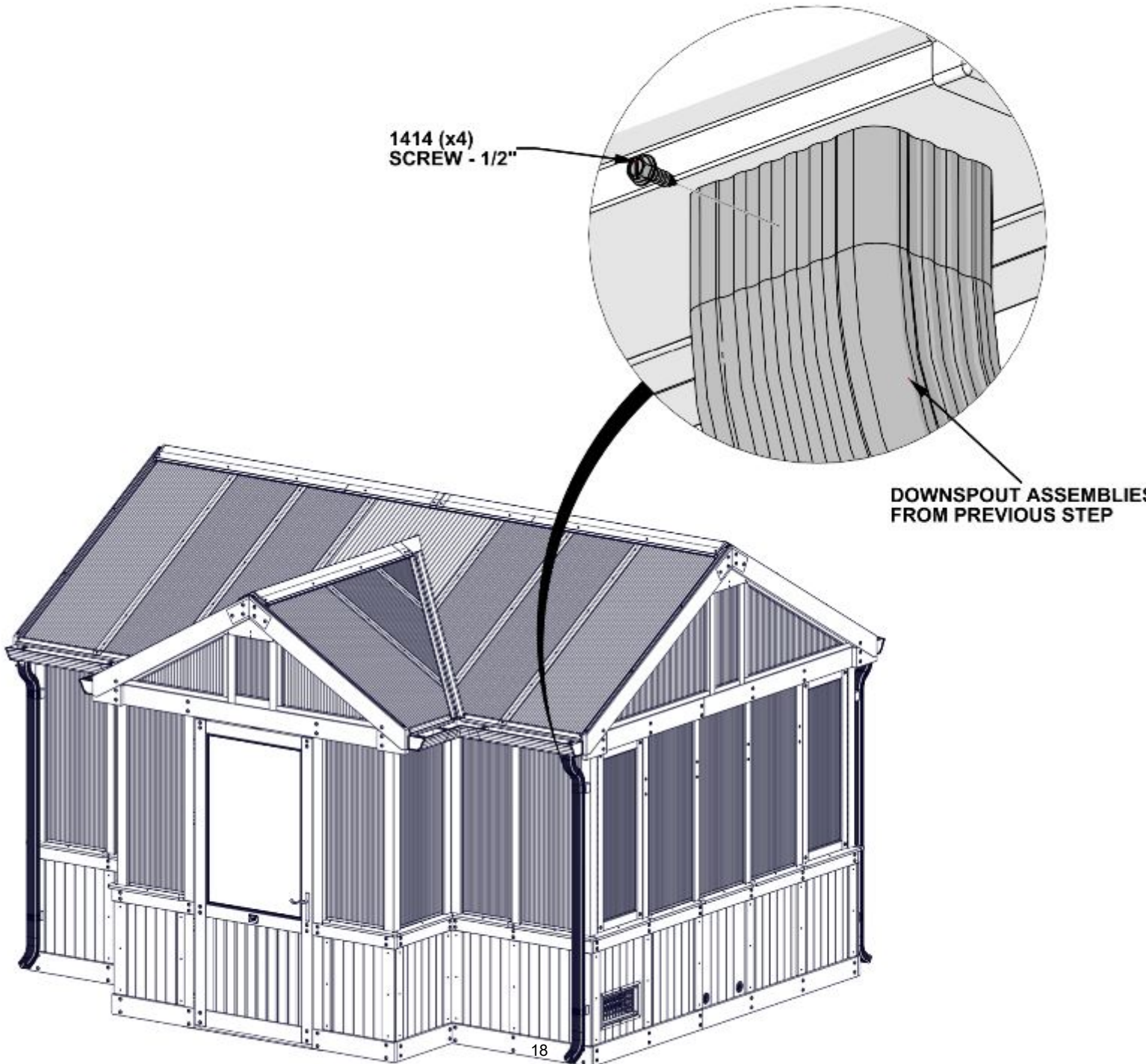

# STEP 11 - GUTTER ASSEMBLY

QTY	PART NUMBER	DESCRIPTION
16	H101414	SCREW SELF PIERCING #8x1/2 BLK

- FASTEN DOWNSPOUT CLIP TO DOWNSPOUT USING HARDWARE PROVIDED.
- COMPLETE THIS STEP AT EACH OF THE 4 DOWNSPOUTS.

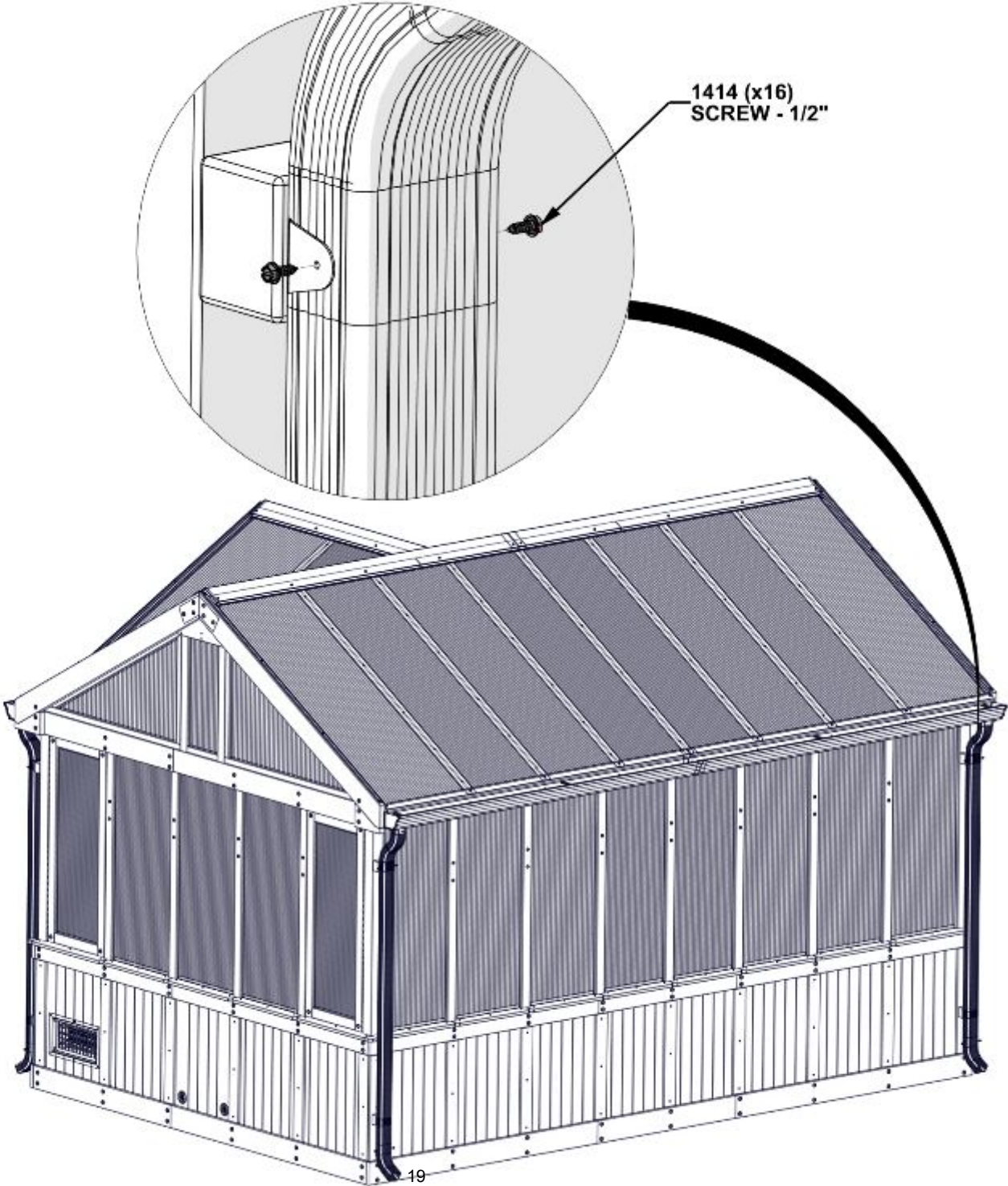

## STEP 12 - GUTTER ASSEMBLY

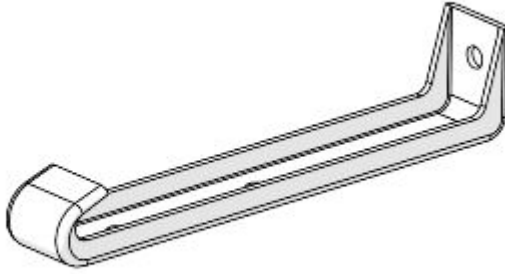

A4M04759 GUTTER HANGER  
(x4)

QTY	PART NUMBER	DESCRIPTION
4	H101480	SCREW SELF TAPPING #9x1 BLK

- ATTACH ALL REMAINING GUTTER HANGERS.
- IT IS RECOMMENDED TO EVENLY SPACE THEM APPROXIMATELY 24 [610mm] APART.

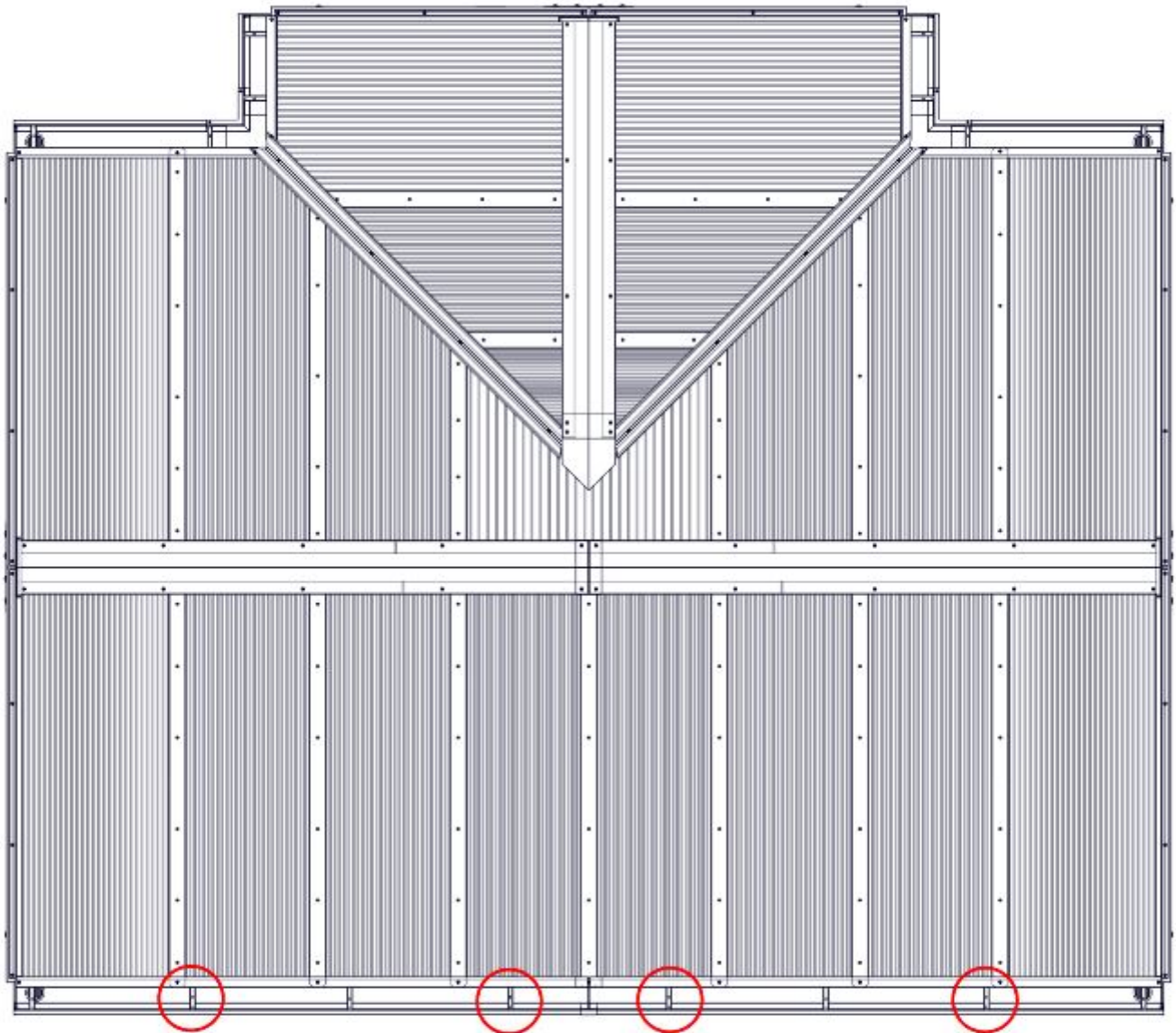

# STEP 13 - GUTTER ASSEMBLY

**CRITICAL:**

**AFTER HARDWARE AND GUTTERS ARE INSTALLED IT IS IMPORTANT THAT A HEALTHY BEAD OF SILICONE IS WORKED INTO THE OVERLAPPING JOINTS CIRCLED IN RED. THE RED LINES INDICATE THE SPLICE JOINTS THAT NEED TO CAULKED TO AVOID LEAKING. MAKE SURE SILICONE IS APPLIED TO THE CURVED SURFACE OF GUTTERING AS WELL.**

**TIP: A WET FINGER HELPS WORK SILICONE INTO SPACES.**

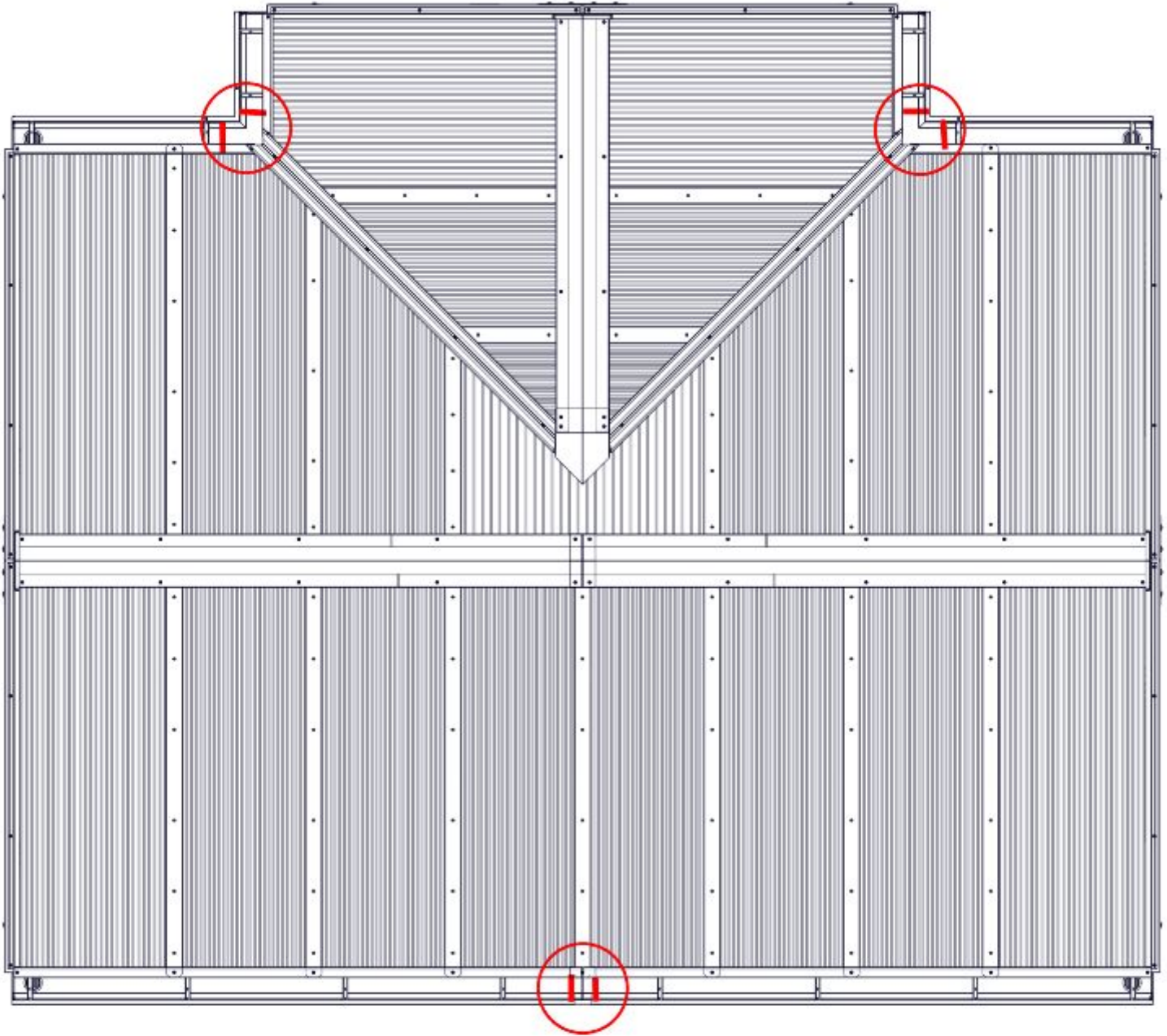

## STEP 14A - RE-INSTALL EDGE TRIM

- USING A CAULK GUN AND SILICONE TUBE, PLACE A GENEROUS BEAD OF SILICONE ACROSS THE BOTTOM OF THE EDGE TRIM AS SHOWN.
- NOTE THIS IS THE SURFACE THAT WILL TOUCH THE ROOF/POLYSHEETS.

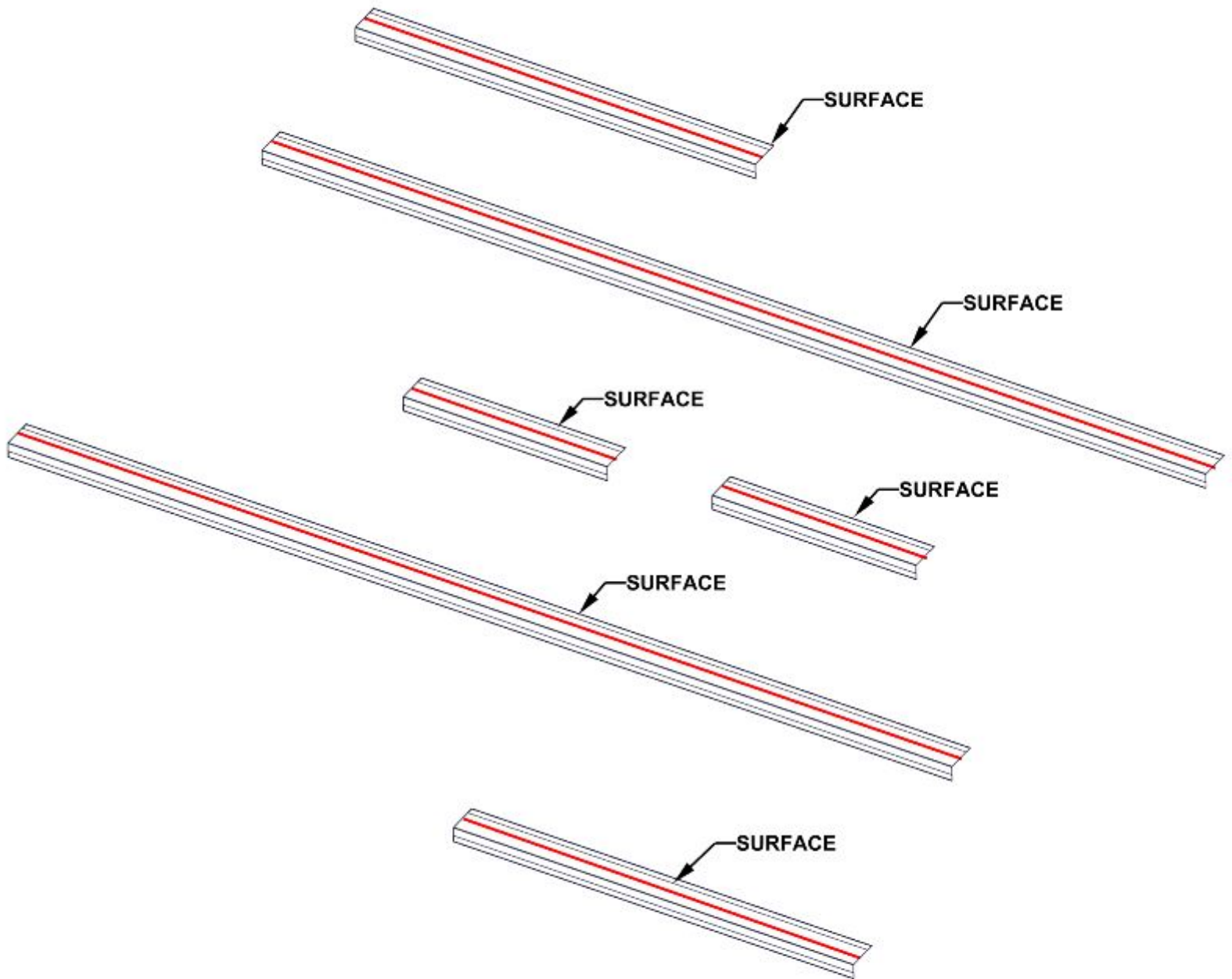

## STEP 14B - RE-INSTALL EDGE TRIM

QTY	PART NUMBER	DESCRIPTION
19	H101206	SCREW WOODGRIP 10-16X1-1/4"

- RE-ATTACH EDGE TRIM WITH HARDWARE PREVIOUSLY REMOVED
- RE-USE HOLES HARDWARE WAS REMOVED FROM.
- APPLY A GENEROUS AMOUNT OF SILICONE ALONG THE ROOF AND POLYSHEETS TO AVOID LEAKS.

