

# ASSEMBLY INSTRUCTIONS



MODEL W784.1, 90"x 54" 2P Backpacking Tent w/ vestibule

## SAFETY WARNING - DOs AND DO NOTs

EVERYONE WHO USES THIS TENT SHOULD READ THIS MANUAL AND BECOME FAMILIAR WITH ALL SAFETY WARNINGS AND PRECAUTIONS FOR SAFE USE, ASSEMBLY, CARE, MAINTENANCE, AND STORAGE. KEEP THIS MANUAL SO YOU CAN REFER TO IT LATER.

### **DANGER** CARBON MONOXIDE GAS WILL KILL YOU

Stoves, heaters, grills, lantern, candles, and other fuel-burning devices that burn propane, natural gas, charcoal, kerosene, coal, or other fuels produce a toxic gas called carbon monoxide. Because carbon monoxide gas is invisible, odorless, and colorless, a dangerous level of carbon monoxide gas can accumulate in a tent which cannot be detected by sight, smell, or taste. For these reasons:

- DO NOT use matches, lighters, stoves, heaters, grills, lanterns, candles, cooking equipment, or other fuel-burning devices inside or near a tent.
- DO NOT build fires inside or near a tent.
- DO NOT leave campfires unattended.

Your failure to follow this warning will cause death, serious injury, or permanent disability to you or others.

### **DANGER** PROTECT YOUR CHILDREN

- DO NOT leave children unattended inside a tent or in camp.
- DO NOT allow children to assemble a tent.
- DO NOT allow children to enter or exit a tent except through the door.
- DO NOT allow children to remain in a closed-up tent on hot days.

Your failure to follow this warning will cause death, serious injury, or permanent disability to your children.

### **WARNING** FLAMMABILITY WARNING KEEP ALL FLAME AND HEAT SOURCES AWAY FROM THIS TENT FABRIC

This tent is made with flame resistant fabric which meets CPAI-84 specification. IT IS NOT FIREPROOF. The fabric will burn if left in continuous contact with any flame source. The application of any foreign substance to the tent fabric may render the flame-resistant properties ineffective. Your failure to follow this warning could cause death, serious injury, or permanent disability to you or others.

#### CAMPING DO'S AND DON'TS DO NOT...

1. Do not pitch tent near open fire.
2. Do not leave campfire unattended.
3. Do not leave children unattended inside a tent.
4. Do not use heating, lighting or cooking equipment with open flames in or near tents.
5. Do not use other than recommended water repellent compounds on your tent.
6. Do not spray the tent with insecticide.
7. Do not store tent on concrete floor.

#### DO...

1. Always extinguish campfire before leaving area.
2. Exercise care when using electricity and lighting in and near tents.
3. Make certain your tent is properly ventilated in all weather conditions. In extreme weather conditions, snow could obstruct airflow and cause asphyxiation unless cleared frequently.
4. Anchor your tent securely to provide additional security from changing climatic conditions. Snow pegs, skis and/or heavy rocks may be necessary to supplement tent stakes and guy cords.
5. Take your tent down and store properly after camping.

## CARE

DO NOT LEAVE YOUR TENT SET UP IN DIRECT SUNLIGHT LONGER THAN NECESSARY. THE SUN'S ULTRAVIOLET (UV) LIGHT DEGRADES ALMOST EVERY FABRIC AND MATERIAL. IF LEFT IN SUNLIGHT FOR PROLONGED PERIODS OF TIME, FABRIC WILL FADE AND WEAKEN. DO NOT STORE TENT ON CONCRETE FLOOR. DO NOT SPRAY THE TENT WITH INSECTICIDE.

Your tent is water repellent, however, it is not waterproof. During heavy rain, some leakage may occur. Keep objects from touching the inside of the tent. Such objects may cause leakage at point of contact. If seam leakage occurs, it can be controlled by applying a seam sealer compound.

**EXERCISE CARE WHEN USING ELECTRIC DEVICES IN AND NEAR TENTS.**

Although our tents and screen houses are constructed to rigid specifications, periods of wind or rain soaking the ground may loosen the stakes and cause the uprights to sink into the ground. This will weaken the rigidity of the overall structure. Water pockets may also form in the roof if the unit is not assembled taut, possibly causing broken frames and torn fabric.

## REPLACEMENT PARTS

If you have questions or need to order a part, call 1-800-325-4121 or send an e-mail to [contactus@wenzelco.com](mailto:contactus@wenzelco.com). Have your model number or part number ready when you call. DO NOT ORDER BY REFERENCE KEY NUMBER.

Send your request for parts to:  
**Exxel Outdoors, LLC.**  
 6235 Lookout Road  
 Boulder, CO 80301

KEY NO.	MODEL W784.1, 90"x 54" 2P Backpacking Tent w/ vestibule DESCRIPTION	PART NO.	QTY REQ
A	Main Pole	W784.1M	2
	Complete Set	W784.1S	1
	Replacement Fly	W784.1F	1
	Guy Rope	A1001	4
	7inch 6mm Aluminum Stake	ALU STAKE	12

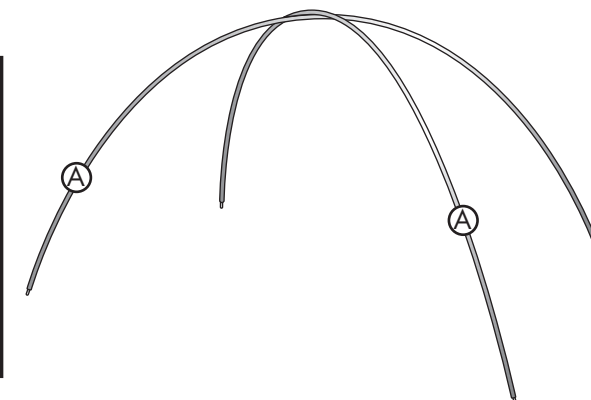

# ASSEMBLY INSTRUCTIONS



MODEL W784.1, 90" x 54" 2P Backpacking Tent w/ vestibule

**IMPORTANT:** WE ADVISE YOU TO ASSEMBLE THE TENT ONCE BEFORE GOING CAMPING TO BECOME FAMILIAR WITH THE ASSEMBLY OF THE TENT.

**NOTE:** PLEASE LOOK AT THE REPLACEMENT PARTS DIAGRAM TO SEE HOW YOUR FRAME IS ASSEMBLED.

TO PROLONG THE LIFE OF THE TENT FLOOR, SELECT A LEVEL, CLEAN AREA FOR THE CAMPSITE. TO PREVENT DAMAGE TO THE ZIPPER, UNZIP THE DOORS TO ALLOW AIR TO ENTER THE TENT.

**STEP 1:** Spread tent out flat, floor side down.

**STEP 2:** Extend the frame poles by pulling out each section and placing ends into the connectors.

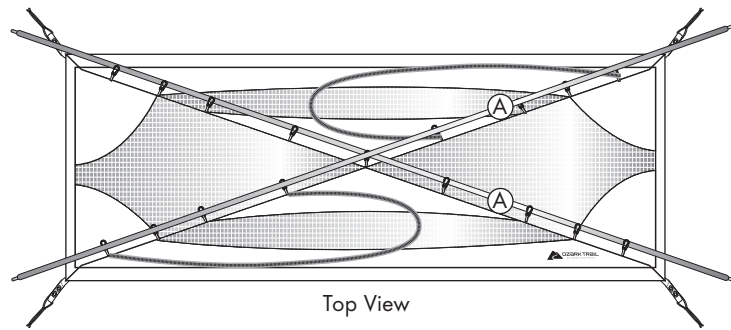

**STEP 3:** Insert the pole tips into the grommets at the back corners of the tent. From the front corners, flex the pole and insert the tip into the corresponding grommets. (Inner grommets will provide a tauter set up)

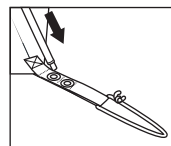

**STEP 4:** Starting at the top of the tent and working downward, attach all the clips to the poles.

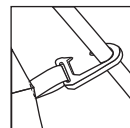

**STEP 5:** Stake down the tent by inserting stakes through the stake loops at each corner of the tent. Hammer the stakes into the ground at a 45° angle. Pull the out even and taut. If it is windy, the tent can be staked down as part of STEP 1.

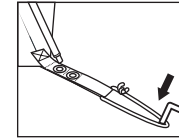

**STEP 6:** Unfold the fly and place it over the tent. Use the color-coded webbing to align the fly with the inner tent.

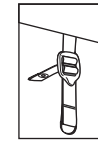

**STEP 7:** Fasten the hook and loop fasteners sewn to the fly around the tent poles.



**STEP 8:** Attach the fly to the tent by hooking the grommets over the bottom of the pole tips.

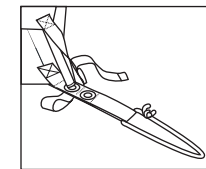

Tent should appear as shown.



**STEP 9:** Stake down the front of each vestibule by inserting a stake through the webbing loop. Make sure to pull the vestibules out even and taut.

**STEP 10:** Guy ropes have been provided for added stability. Extend each of the guy ropes and make a loop at the opposite end by using the slider (as shown). Place the loop over a tent stake and stake to the ground. Adjust the slider to make guy rope tight.

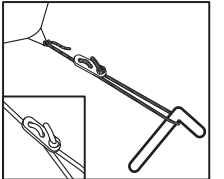

The tent should appear as shown.



**NOTE: Make sure tent is clean and dry before storing.** To take down tent, follow steps above in the reverse order. Place stakes into stake bag and poles into pole bag, which are provided. The tent should be folded into equal parts toward the center of the tent to distribute the bulk. Fold fly and lay on top of tent. Start a small tight roll, the width of the carry bag, with the pole bag placed at one end. Roll the tent tightly allowing air to escape. Once rolled, tie a string or rope around tent to hold into place. Place tent, frame and stakes into carry bag.