

REVISIONS				
ECO	REV.	DESCRIPTION	DATE	APPROVED
	A	RELEASE FOR PRODUCTION		

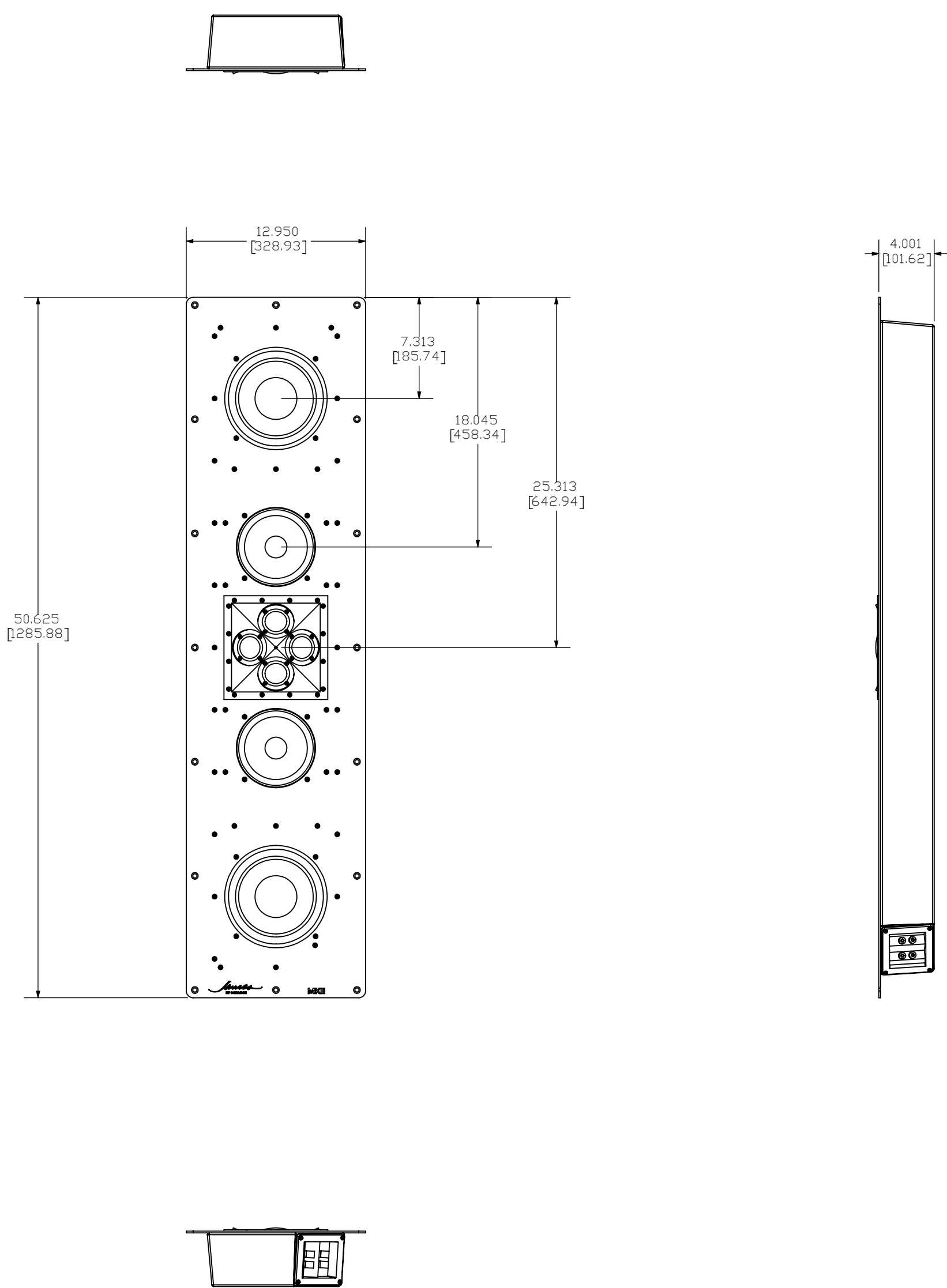

FOR
PROTOTYPE
ONLY

PROTO. APPROVAL:
7/1/25 - TCR

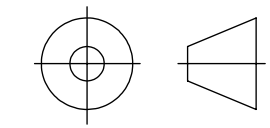

“THIRD ANGLE” PROJECTION

PROPRIETARY INFORMATION	JAMES LOUDSPEAKER	
	BE808-MKII	
THE DESIGNS, INFORMATION, AND DATA CONTAINED HEREIN ARE PROPRIETARY AND ARE SUBMITTED IN CONFIDENCE, AND SHALL NOT BE DISCLOSED, USED OR DUPLICATED IN WHOLE OR IN PART, FOR ANY PURPOSES WHATSOEVER, WITHOUT THE PRIOR WRITTEN PERMISSION OF JAMES LOUDSPEAKER LLC, 2185 PARK PL, MINDEN, NV 89423. THIS LEGEND SHALL BE MARKED ON ANY REPRODUCTIONS HEREOF IN WHOLE OR IN PART. RECEIPT OF THIS DOCUMENT SHALL BE DEEMED TO BE AN ACCEPTANCE OF THE CONDITIONS SPECIFIED HEREIN.	EXTERNAL DIMENSIONS	
	P/N: BE808-MKII	
	DWR #: 250612-JG101	
	REVISED BY:	
	DRAWN BY: J. GALLAGHER	
	DATE: 06-30-25	
	SCALE:	
	TOLERANCES: ANG: ± = .5° FRACT. ± = 1/32	
	DECIMALS: .XX ± = .01 .XXX ± = .005	
	SHEET 1 OF 5	