

Power Reclining Sofa with Console, Power Headrest & Lumbar

IMPORTANT NOTE

Read these instructions carefully, and familiarize yourself with each procedure before assembling the furniture. Check that you have all the component parts, and familiarize yourself with each part before proceeding.

Take all the fittings out of the plastic bag and separate them into groups. Ensure you have enough space to lay out all the parts before assembly. To prevent damage to the parts, we recommend that you assemble the unit on a soft, level surface.

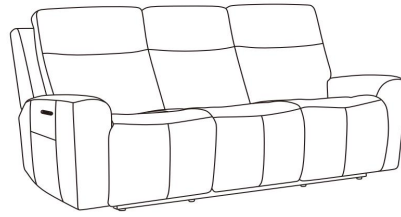

Part List

A. Back
3 pieces

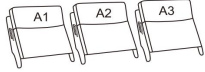

B. Seat
1 piece

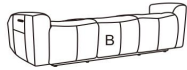

C. Wing
2 pieces



D. Transformer
2 pieces



Assembly Instructions

STEP 1

Take out the Wings (C) and Transformers (D) from the bottom of the Seat (B). (See Figure 1)

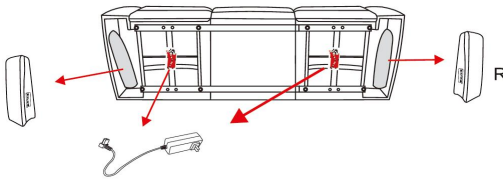

Figure 1

STEP 2

Attach the Backs (A1 A2 A3) to the Seat (B), the Left Wing (C) to the Left Back (A1), and the Right Wing (C) to the Right Back (A3). Ensure the latches fit well. (See Figure 2)

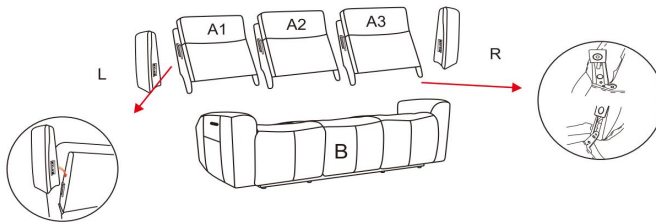

Figure 2

STEP 3

Zip the fabric on the bottom of the Backs (A1 A3) with the back of the Seat (B). (See Figure 3)

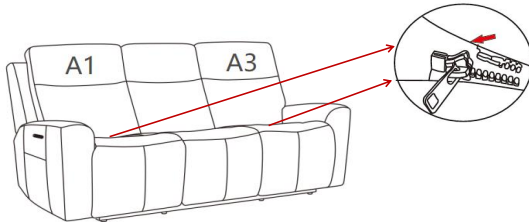

Figure 3

STEP 4

Flip up the back flaps, and remove the cables from the Backs (A1 A2 A3). Connect the headrest and lumbar cables for the Backs (A1 A3). No label for headrest and yellow for lumbar. Connect the USB and wireless charging for the Back (A2). (See Figure 4)

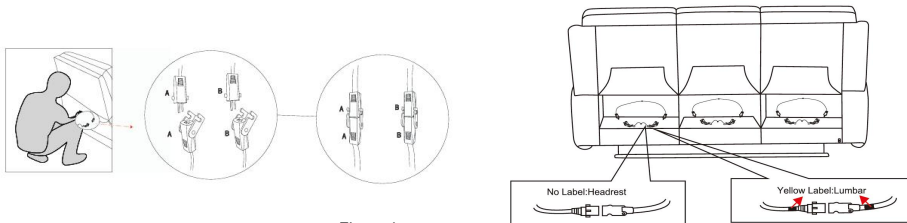

Figure 4

STEP 5

Connect the Transformers (D) into the power ports on the back of the seats. Plug two Transformers (D) into nearby outlets, still making sure they are clear of the metal base. (See Figure 5). Fasten the back flaps to the bottom of the furniture. (See Figure 6)

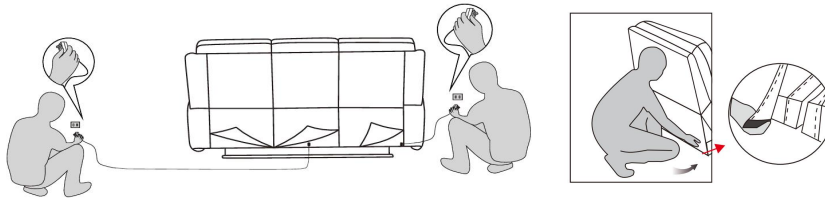

Figure 5

Figure 6

Disassembly Instructions

Unzip the zipper between Backs (A1 A3) and Seat (B), then disconnect all cables. Pull up the spring leaf in bracket, then lift Backs (A1 A2 A3) up. (See Figure 7)

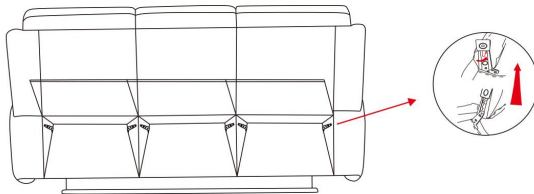
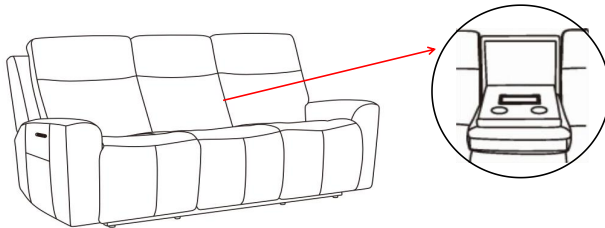

Figure 7

Drop-Down Console

When you flip down the middle back, you could see the hidden wireless charger and cup holders here.



User Guide for Wireless Charger

Attention



1. It is common for heat to be generated in wireless charging through the energy transfer process. This is part of the normal wireless energy transfer.
2. Phone should be centered on the wireless charging icon if an icon is present. The further the current must travel, charging efficiency is reduced and more energy is lost to heat.
3. Phone should be centered on the tray if an icon is not present. The further the current must travel, charging efficiency is reduced and more energy is lost to heat.
4. Make sure there aren't any foreign objects on the charger when charging. This can cause the charger to start stop multiple times if the foreign object detector senses an object.
5. Make sure to disconnect the phone from Apps and WiFi during wireless charging while charging and don't use the phone while wireless charging.

IMPORTANT NOTE

- To avoid any risk of suffocation to children or pets, dispose of all plastic bags
- To ensure proper performance, occasionally check for loose screws and tighten
- If the reclining functions are not working properly, check for loose cable connections before contacting the retailer.