

Installation Guide

Vessels Lavatory

K-2367

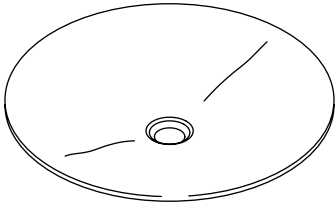

K-2368

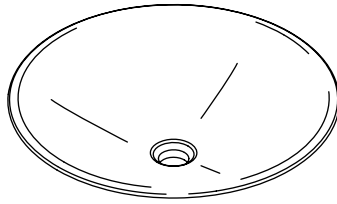

K-2369

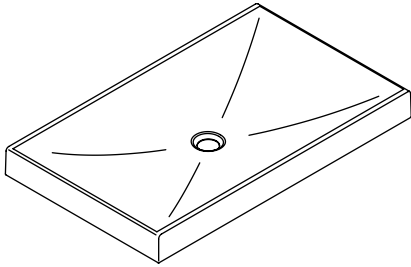

K-2370, K-14016

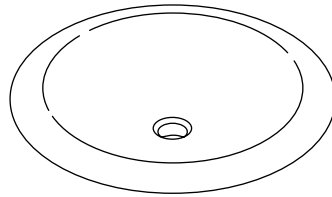

K-2371

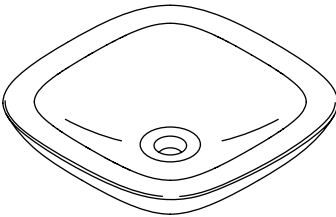

K-2373

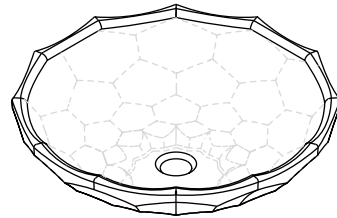

M product numbers are for Mexico (i.e. K-12345**M**)
Los números de productos seguidos de **M** corresponden a México (Ej. K-12345**M**)
Français, page "Français-1"
Español, página "Español-1"

THE BOLD LOOK
OF **KOHLER**®

1095015-2-C

Tools and Materials

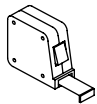

Tape Measure



Drill

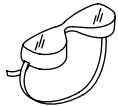

Safety Glasses



Pencil



1-5/8" Hole Bit



Adjustable Wrench



Clear Silicone Sealant

Before You Begin

NOTE: The lavatory shown in this guide may differ from your actual product. The installation steps still apply.

- Observe all local plumbing and building codes.
- Prior to installation, unpack the new lavatory and inspect it for damage. Return the lavatory to its protective carton until you are ready to install it.
- Inspect the existing drain and supply tubing. Replace if necessary.
- Kohler Co. reserves the right to make revisions in the design of products without notice, as specified in the Price Book.

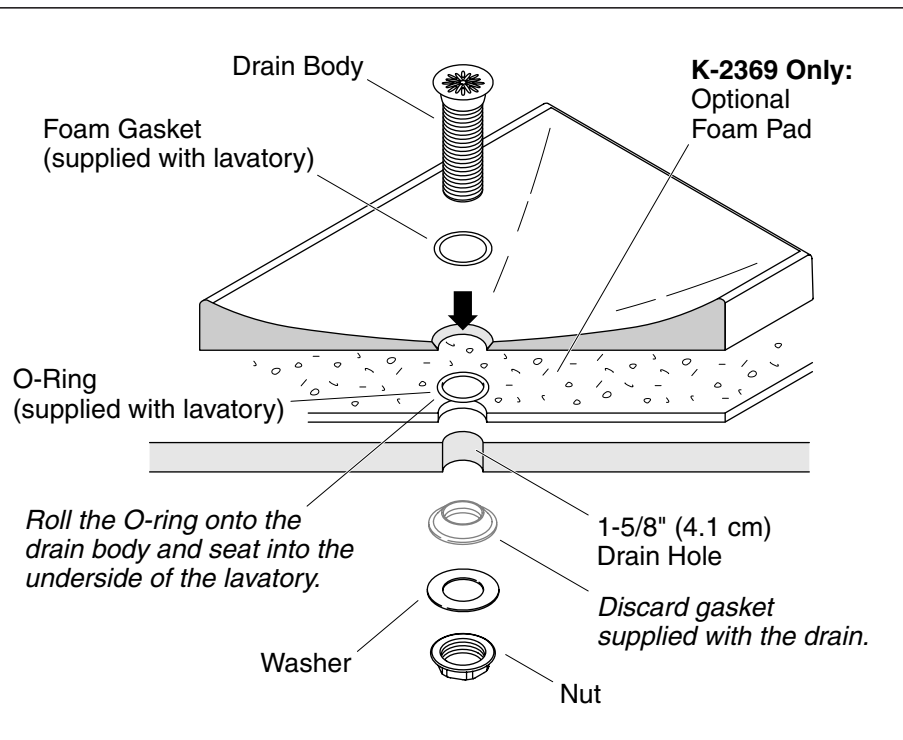

1. Install the Lavatory



CAUTION: Risk of product damage. Do not overtighten drain connection.



CAUTION: Risk of product damage. Ensure the foam gasket provided with the lavatory is properly positioned under the drain flange.

IMPORTANT! The drain must be installed using the foam gasket and O-ring provided with the lavatory. Do not use the gasket supplied with the drain.

- Position the lavatory on the countertop at the installation location.
- Trace the lavatory drain hole onto the countertop.
- Remove the lavatory and set aside.
- Drill a 1-5/8" (4.1 cm) hole, at the marked location.

NOTE: For K-2369 only: The white foam pad provided may be placed on the countertop to enhance the color of the lavatory. If you are planning to install your lavatory with the foam pad, use care to not damage or mark-up the pad.

Install the Lavatory (cont.)

- **Optional for K-2369:** Place the white foam pad on the countertop and line up the hole in the white foam pad with the drain hole.
- Discard the gasket supplied with the drain.
- Slide the foam gasket onto the drain body.
- Insert the drain body into the lavatory drain hole.
- Roll the O-ring onto the drain body. Roll the O-ring up the drain body until it is seated in the underside of the lavatory.
- Align the lavatory and drain body assembly with the drain hole in the countertop. Lower the drain body through the countertop drain hole until the lavatory rests on the countertop.
- Slide the washer onto the drain body.
- Thread the nut onto the drain body.
- Tighten the nut until secure, making sure the drain is properly centered in the lavatory. Do not overtighten.

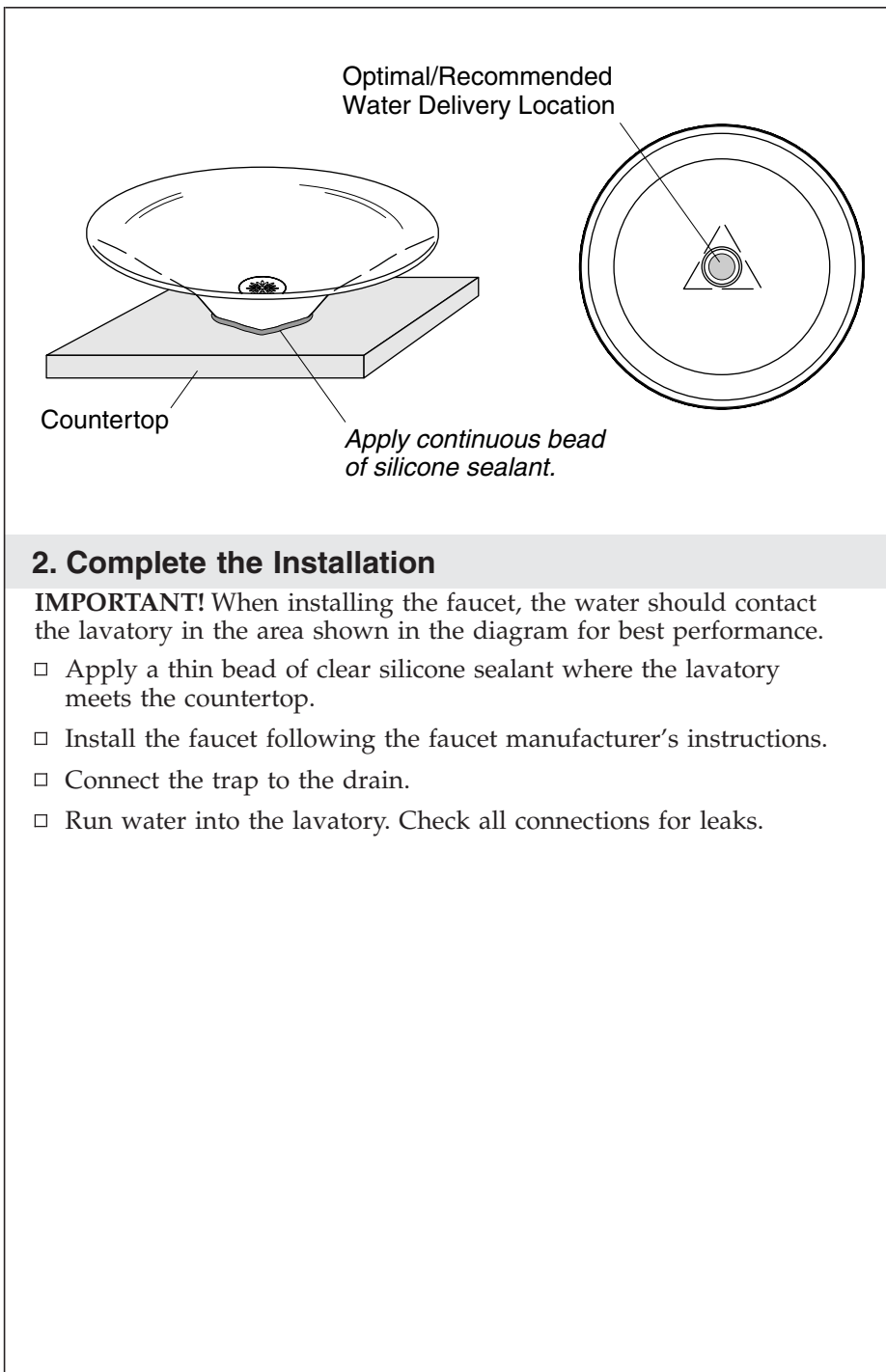

2. Complete the Installation

IMPORTANT! When installing the faucet, the water should contact the lavatory in the area shown in the diagram for best performance.

- Apply a thin bead of clear silicone sealant where the lavatory meets the countertop.
- Install the faucet following the faucet manufacturer's instructions.
- Connect the trap to the drain.
- Run water into the lavatory. Check all connections for leaks.