



# Schlage **Ease**<sup>TM</sup>

S1 SMART DEADBOLT  
S1 KEYLESS SMART DEADBOLT

Quick Start Guide

## Parts

(S1 Smart Deadbolt shown)

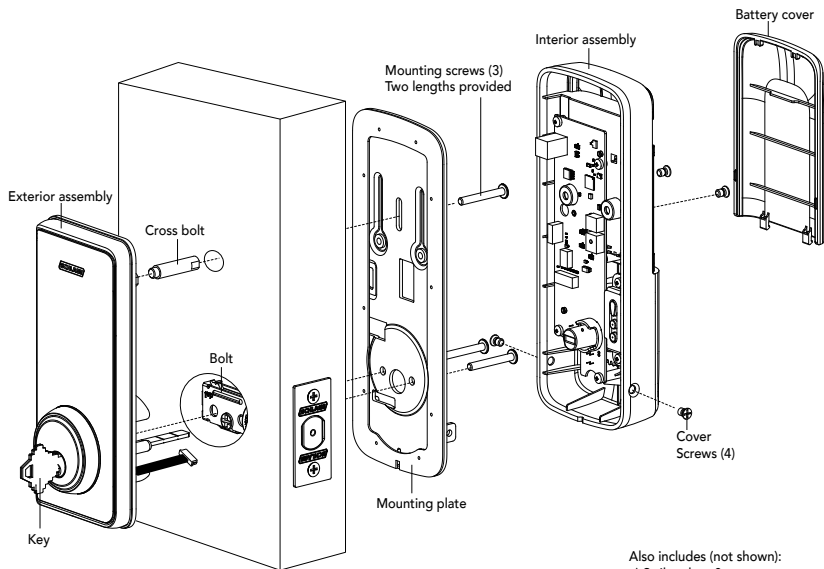

Also includes (not shown):  
a) Strike plate & screws  
b) Reinforcement plate & screws  
c) 4 x AA Alkaline batteries

For more information visit [schlage.com.au/ease](http://schlage.com.au/ease) or [schlage.co.nz/ease](http://schlage.co.nz/ease)

## Exterior assembly

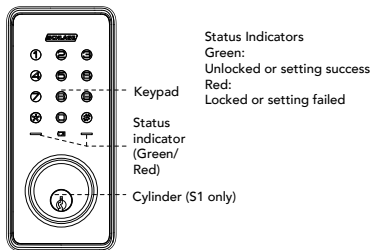

## Interior assembly

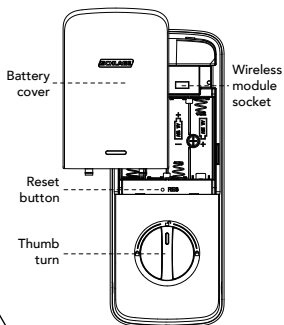

Master and User PIN codes have 4–10 digits. The default master PIN code is [12345678]. Please change it prior to programming of the lock.

## Preparing for installation

1. Measure the dimension of the hole on your door to ensure you have a 54mm hole, or use the drilling template provided.

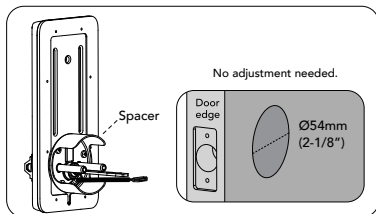

2. Adjust the deadbolt.

NOTE: Bolt ships with backset in 60mm (2-3/8") position. If required, turn the bolt case and pull to extend to 70mm (2-3/4") backset position (pictured below).



The bolt must be in retracted (unlocked) position when you are changing backset.

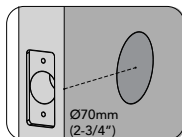
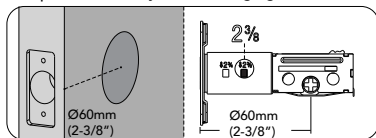

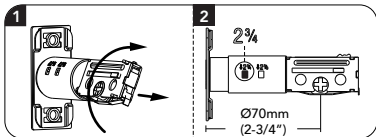

## Installation

1. Install the bolt on the door ensuring the word UP is in the upwards position.

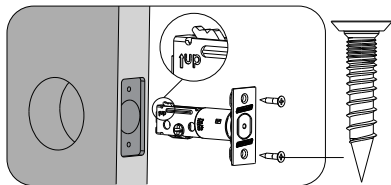

2. Use a screwdriver to test if deadbolt works smoothly.

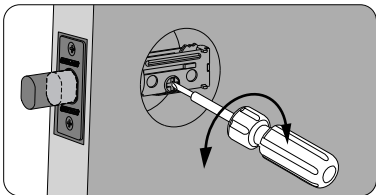

3. Make sure the bolt is in the retracted (unlocked) position.

**⚠ NOTE:** The bolt must be in retracted (unlocked) position before installing the lockset.

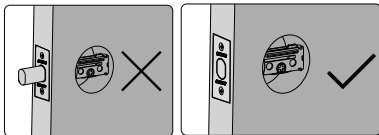

4. Hold the exterior assembly flush to the door, pull the key tailpiece and cable through the door hole.

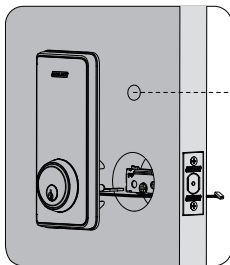

This hole is for the optional cross bolt provided for stabilising your lock. If you drilled a hole, securely tighten the post before mounting on the door.



**NOTE:** Cable must go through door hole under the bolt.

**NOTE:** The tailpiece should be kept in a horizontal position.

5. Position the inside mounting plate to sit flush on the door, ensuring the cable and tailpiece go through the holes in the mounting plate.

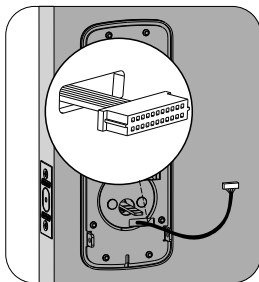

6. Secure both assemblies using the screws provided. Make sure the exterior assembly is vertically aligned. If you added the cross bolt, securely tighten the post to the exterior Ease unit with the additional screw provided.

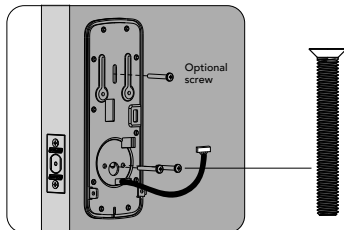

7. Attach cable assembly to the interior assembly PCB by lining up notches on top of cable connector to slots on PCB connector. Press connector in firmly until completely connected.

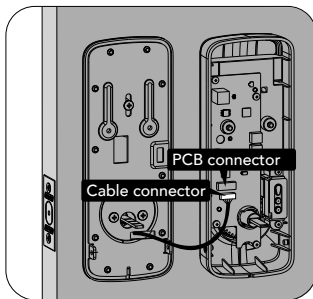

8. Install interior assembly on inside mounting plate.

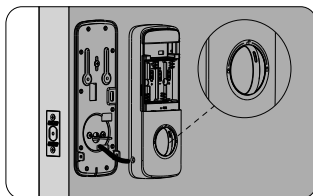

**NOTE:** The horizontal orientation of the tailpiece as you insert the inside escutcheon (thumb turn should be vertical).

9. Secure using 4 screws through the interior assembly onto the mounting plate.

**!** NOTE: Test operation using backup key and thumb turn before installing batteries, see if bolt extends smoothly.

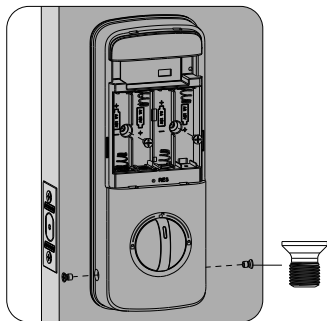

10. Reset the lock to learn the orientation of your door.

**!** NOTE: Resetting the lock before use is required and crucial for the lock to operate properly.

Settings	Factory default
Master PIN code	12345678
Auto lock	Disabled
Beeper	Enabled
Wrong code entry limit	5 times
Shutdown time	3 minutes
Away mode	Disabled
Bluetooth mode	Enabled

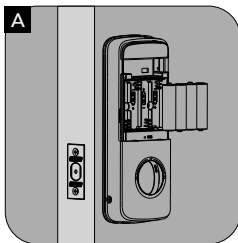

Keep your lock in "unlock" status, insert 4x AA batteries in battery pack.

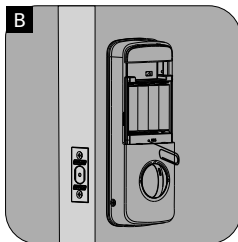

Using a pointed object, press and hold the reset button for over 5 seconds.

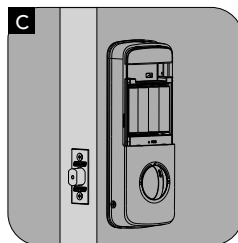

If reset is successful, the latch bolt will extend on its own to learn the orientation of the door.

11. Install battery cover.

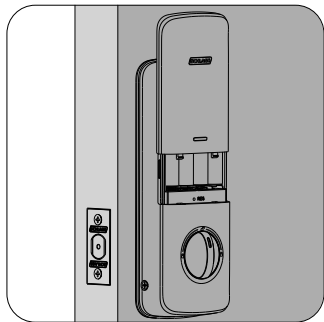

12. Install reinforcement plate and strike into door jamb.

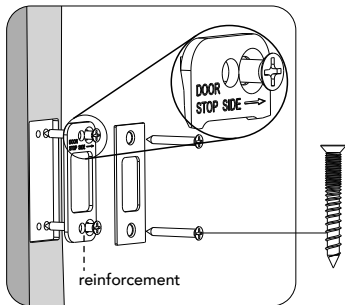

## Warnings

- Do not install batteries until the lock is completely installed on the door.
- Failure to follow these instructions could result in damage to the product and void the factory warranty.
- The accuracy of the door preparation is critical for the functioning and security of this product. Misalignment can cause performance degradation and lessening of security.
- Finish Care: This lockset is designed to provide the highest standard of product quality and performance. Care should be taken to ensure a long-lasting finish. When cleaning is required, use a soft, damp cloth. Do not use lacquer thinner, caustic soaps, abrasive cleaners or polishes as these can damage the coating and result in tarnishing.

## Lock operation

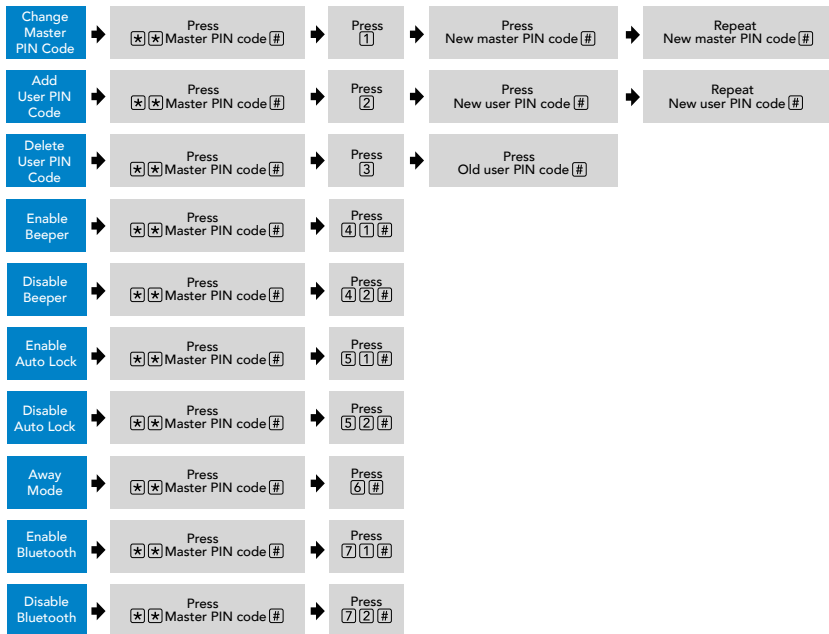

### Notes;

1. After each successful setting entry, 2 green lights and 2 beep indicators will occur.
2. The beeping sound occurs only when sound is enabled.
3. If the indicators show 3 red lights and 3 beeps, your setting has failed and the system will exit master mode. Please enter master mode to try again.
4. Refer to page 10 for guidelines on setting PIN codes.



## Definitions

### Auto lock:

After successful code entry and the unit unlocks, it will automatically re-lock after 30 seconds. This feature is disabled in default setting.

### Away mode:

This feature can be activated or deactivated in the Schlage Abode App or the lock itself. Activating away mode will disable all user codes, except master away mode. If the lock is opened with a key or manually from inside, the lock will trigger an alarm. To deactivate the away mode, you have to enter master code or deactivate in the app.

### Fake PIN code:

Random numbers that are added before or after the user PIN. This prevents the user PIN from being exposed.

### Manual mode:

Auto lock function can be adjusted to manual mode. In manual mode the lock can be locked by pressing any key on the keypad for 2 seconds, or using the thumb turn from the internal unit.

### Master mode:

The master mode should be entered by entering [\*\* Master PIN Code #] to program the lock.

### Master PIN code:

The master PIN code is used for programming and for feature settings.

### Reset button:

After reset operation, the lock will be restored to factory default settings, all user credentials will be deleted. Refer to page 6 for instructions on how to reset your lock.

### Shutdown time:

The lock will shutdown for a default of 3 minutes and not allow operation after the wrong code entry limit (5 times) has been met. When the unit is in shutdown, the light will flash if you are trying to use the keypad.

### Silent mode:

Disables the tone sound.

### Status indicators:

Located on exterior assembly.

### User PIN code:

The user PIN code operates the lock. Maximum number of user PIN codes is 20.

## Hardware specifications

Item	Specifications	Notes
External dimensions	<b>S1:</b> 161mm (L) x 70mm (W) x 25mm (D) <b>S1K:</b> 137mm (L) x 70mm (W) x 15mm (D)	Operation temperature: -20°C to 55°C
Internal dimensions	<b>S1:</b> 196mm (L) x 73mm (W) x 33mm (D) <b>S1K:</b> 196mm (L) x 73mm (W) x 33mm (D)	
Battery	AA alkaline battery x 4 (Operation voltage: 4.6~6.0V)	Lasts up to one year (10 times open/close per day)



For more information visit  
**[allegion.com.au/ease](http://allegion.com.au/ease) or [allegion.co.nz/ease](http://allegion.co.nz/ease)**

Australia  
1800 098 094  
[info.au@allegion.com](mailto:info.au@allegion.com)  
[www.allegion.com.au](http://www.allegion.com.au)

New Zealand  
0800 477 869  
[nzinfo@allegion.com](mailto:nzinfo@allegion.com)  
[www.allegion.co.nz](http://www.allegion.co.nz)

South East Asia  
+65 6488 2562  
[sea.info@allegion.com](mailto:sea.info@allegion.com)  
[www.allegion.com](http://www.allegion.com)



## Setting PIN codes

1. Master PIN code (4~10 digit):  
Default master PIN code is "12345678", please modify it after installation.  
If you forget your master PIN code, you can reset your lock back to factory settings (refer to page 6 for instructions).
2. User PIN code (4~10 digit): User PIN codes can be set up through master PIN code.  
Up to 20 user PIN codes can be stored.
3. Both master and user PIN codes don't support the following combination of numbers.



Forward number sequence



Backward number sequence



Repeat number sequence

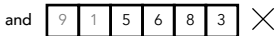
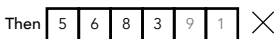
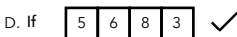

Contain existing code sequence

## How to use

### Unlock the door

1. Unlock the door from outside:  
Master/User PIN code or key



2. Unlock the door from inside:  
Manual thumb turn

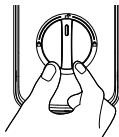

Turn the thumb turn on inside body.

### Lock the door

1. Lock the door from outside:  
Auto lock mode:  
In auto lock mode, after unlocking, the bolt will extend out automatically after 30 seconds.
2. Lock the door from inside:  
Auto lock mode:  
In auto lock mode, the device will lock automatically.

Manual mode:



Press any key on the keypad for 2 seconds.

Manual mode:

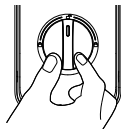

Turn the thumb turn on inside body.

## Unlock with fake PIN code

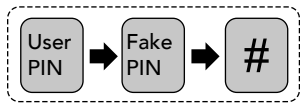
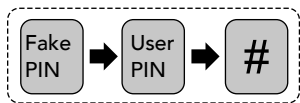

User can prevent PIN code exposure from strangers by entering random digits before or after PIN code.

## Warranty conditions

The Schlage Ease™ provides a 2 year mechanical and electronic warranty. Our goods come with guarantees that cannot be excluded under the local consumer law. You are entitled to have the goods repaired or replaced if the goods fail to be of acceptable quality and the failure does not amount to a major failure. The warranty does not cover any defect or damage which may be caused or partly caused if the goods are not properly maintained, installed or are not suitable to the specified application.

Refer to our website for our finish warranty.

## Get mobile access with Schlage Abode

For an enhanced experience and functionality, try using the Schlage Ease™ with the Schlage Abode mobile application. Simply download the Schlage Abode app from the Apple App Store or the Google Play Store. Manage and control your lock with the ease of your smart phone for greater control and access.



## Schlage Wi-Fi Bridge (AB100)

Empower your Schlage Ease™ lock with Wi-Fi capability. The Schlage Wi-Fi Bridge (AB100) pairs to your Schlage Ease™ lock, to provide you with a real-time connection through your smartphone.

Ask your retailer about the Schlage Wi-Fi Bridge (AB100), sold separately.

