

Goalrilla™

VOLLEYBALL TRAINER

MODEL NO.
B3900W

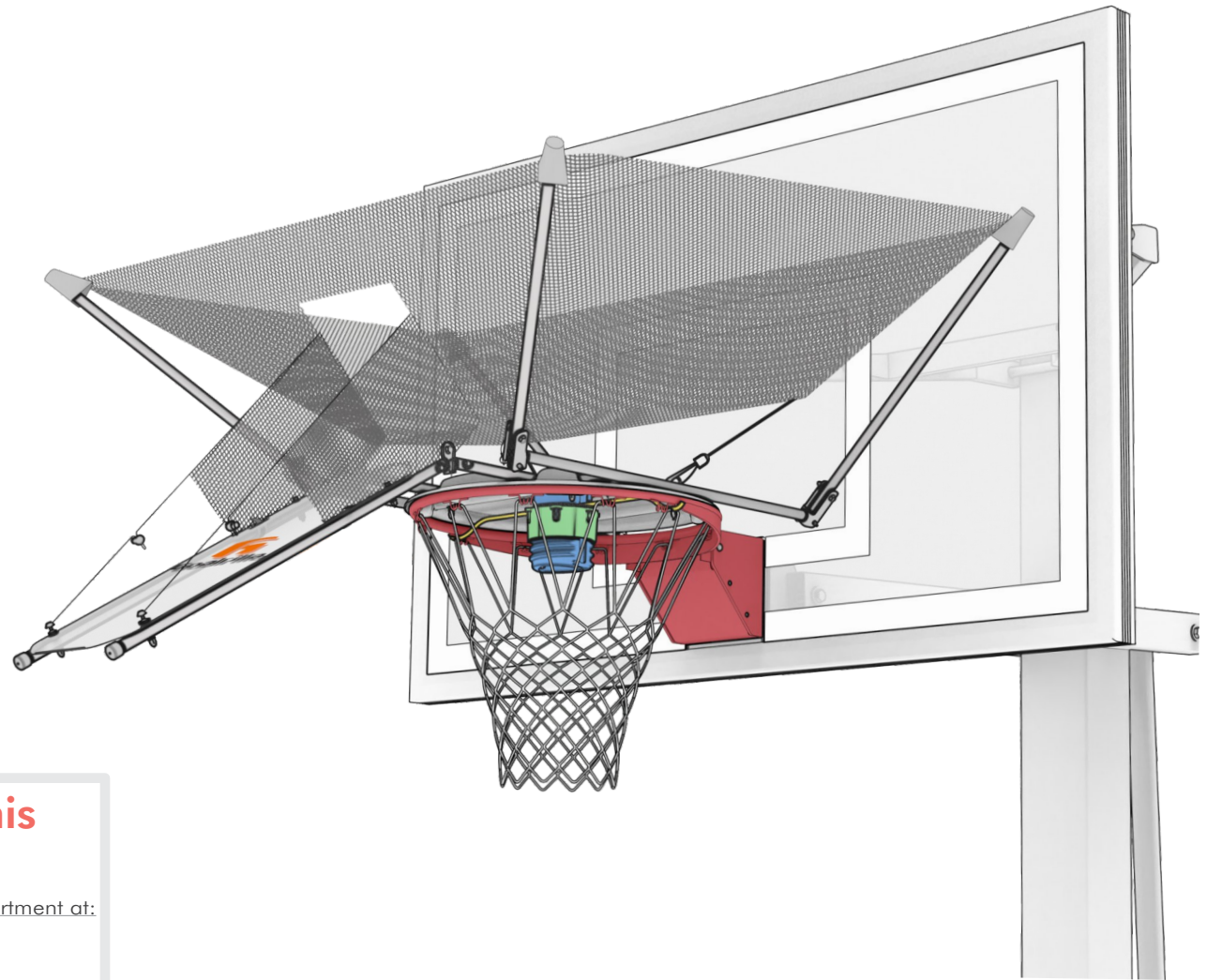

Please Do Not Return This Product to the Store!

Contact Escalade® Sports customer service department at:
Phone: 1-800-467-1421
Fax: 1-866-873-3536
E-mail: basketball@escaladesports.com

ESCALADE®
SPORTS

Escalade® Sports products may be manufactured and/or licensed under the following patents.
6120397, 5816957, 5769744, 5119741, 4911085, 4717157, D460140, D420563, 8414431
Additional patents may be pending. One or more of the listed patents and/or pending patents may cover specific product.

2L-8023-00

2023 Escalade® Sports

PRE - ASSEMBLY TIPS

1. **Read this manual carefully before starting assembly.** Read each step completely before beginning each step.
2. **Some smaller parts may be shipped inside larger parts. Check inside all parts and cartons before assembling or ordering parts.**
3. **To make assembly easier, use the Parts Identifier on page 4 & 5 to identify and sort all parts. Check all cartons for kits.**
4. **Do not tighten until instructed to do so. If parts are tightened too soon, parts may not easily fit together. Leave the plastic nut slightly loose until you are instructed to tighten it.**
5. **Save these instructions and your proof of purchase (receipt) in the event that the manufacturer has to be contacted for replacement parts.**

Required Tools:

- Ladder

Please visit our Website at:

www.Goalrilla.com

ON-LINE TROUBLE SHOOTING TECHNICAL ASSISTANCE
 PRODUCT REGISTRATION FREQUENTLY ASKED QUESTIONS
 ADDITIONAL GOALRILLA PRODUCT INFORMATION



Please Do Not Return This Product To The Store!

Contact Escalade® Sports customer service department at:

Phone: 1-800-467-1421

E-mail: basketball@escaladesports.com

Escalade Sports

Physical Location:

817 Maxwell Ave.
 Evansville, IN 47711

Mailing Address: (Correspondence Only)

PO Box 889
 Evansville, IN 47706

ESCALADE®
S P O R T S

SAFETY INSTRUCTIONS

FAILURE TO FOLLOW THESE SAFETY INSTRUCTIONS MAY RESULT IN SERIOUS INJURY, PROPERTY DAMAGE AND WILL VOID WARRANTY.

Owner must ensure that all players know and follow these rules for safe operation of the system. To ensure safety, do not attempt to assemble this system without following the instructions carefully.

Proper and complete assembly, use and supervision is essential for proper operation and to reduce the risk of accident or injury. A high probability of serious injury exists if this system is not installed, maintained, and operated properly.

- If using a ladder during assembly, use extreme caution.
- 2 people are recommended for this operation.
- Seat the rim cover correctly and tighten it with the plastic screw and plastic nut. Failure to do so could allow the trainer to separate during play.
- Ensure there are no overhead power lines within 20 ft. (7m) radius of trainer.
- Climate, corrosion or misuse could result in system failure.
- If technical assistance is required, contact our Customer Service department. The contact information is located on the cover page & page 2.

Most injuries are caused by misuse and/or not following instructions.

Use caution when using this system.

WARNING

- Do not hang from any part of the product. Doing so could cause injury and/or damage to the product.
- Check before each use for loose hardware, excessive wear, and signs of corrosion and repair before using.
- Never play on damaged equipment.
- An adult is required for installation and uninstallation of the trainer.
- When installing or removing, keep hands and fingers away from pinch points.
- Do not use the product for anything other than its intended use.
- During play, do not wear jewelry (rings, watches, necklaces, etc.).
- Do not slide, climb, or play on the product.

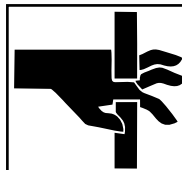

WARNING

Pinch point. Keep hands clear during operation.

PARTS LIST (NOT ACTUAL SIZE)

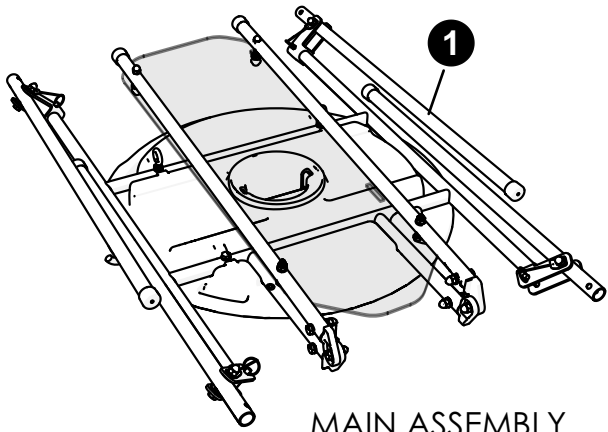

MAIN ASSEMBLY
4A-8771-00
QTY. 1

See **page 5** for main assembly replacement parts.

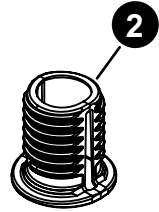

PLASTIC SCREW
3M-9132-00
QTY. 1

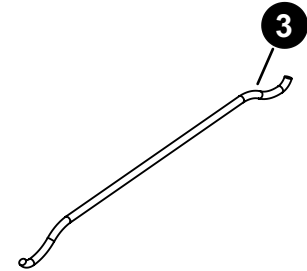

CROSS BAR
2S-9477-00
QTY. 1



PLASTIC NUT
3M-9133-00
QTY. 1

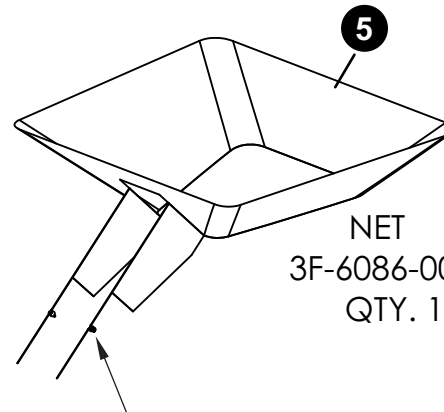

NET
3F-6086-00
QTY. 1

STRING ADJUSTMENT
BALL CLASP
3M-9474-00
QTY. 2

MAIN ASSEMBLY REPLACEMENT PARTS

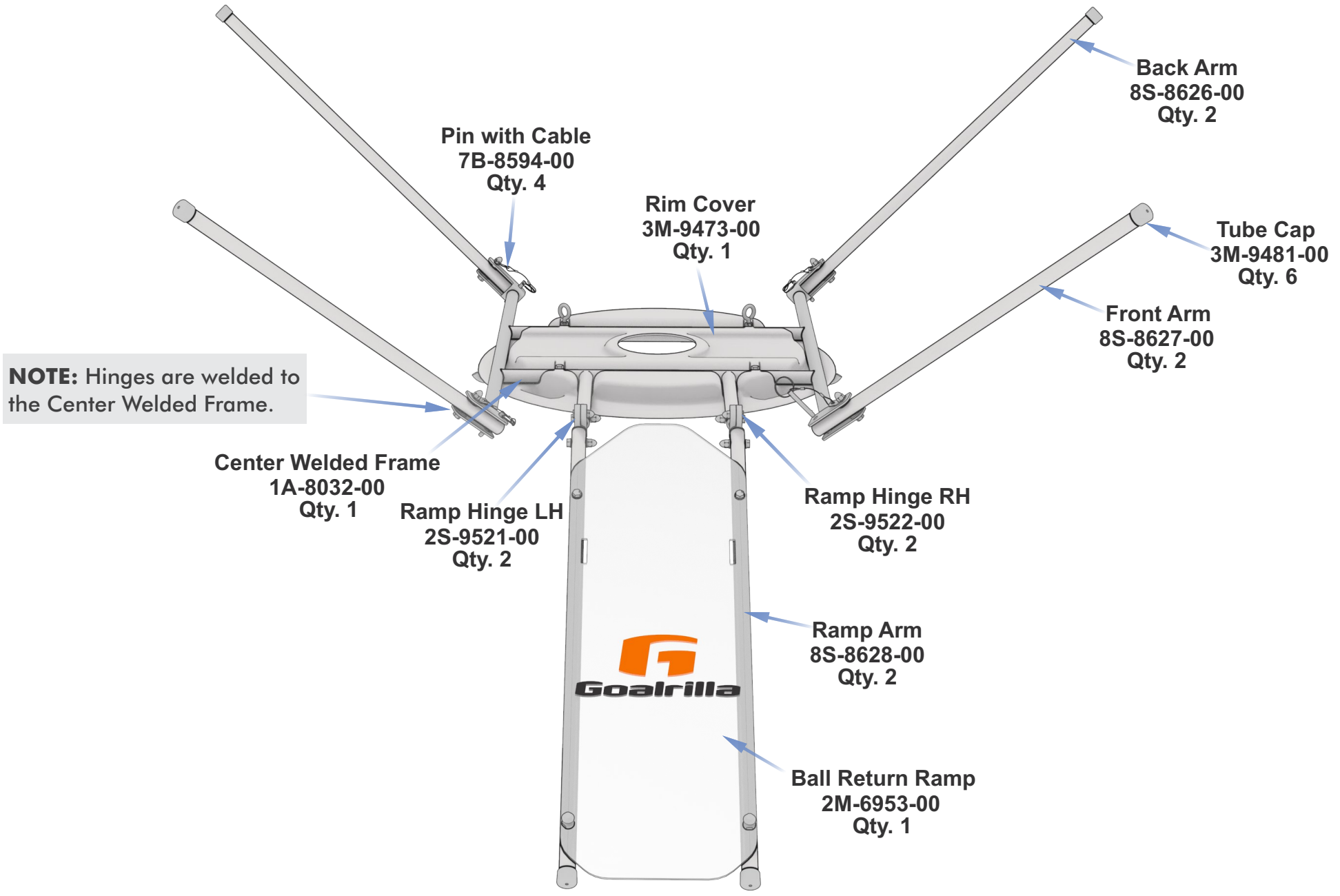

NOTE: Setting up the Volleyball trainer is easier if done on a table.

1. Unfold the Volleyball Trainer frame assembly. Unfold the Arms and insert the pins to secure the tubes in place. See **Detail A** & **Detail B**.

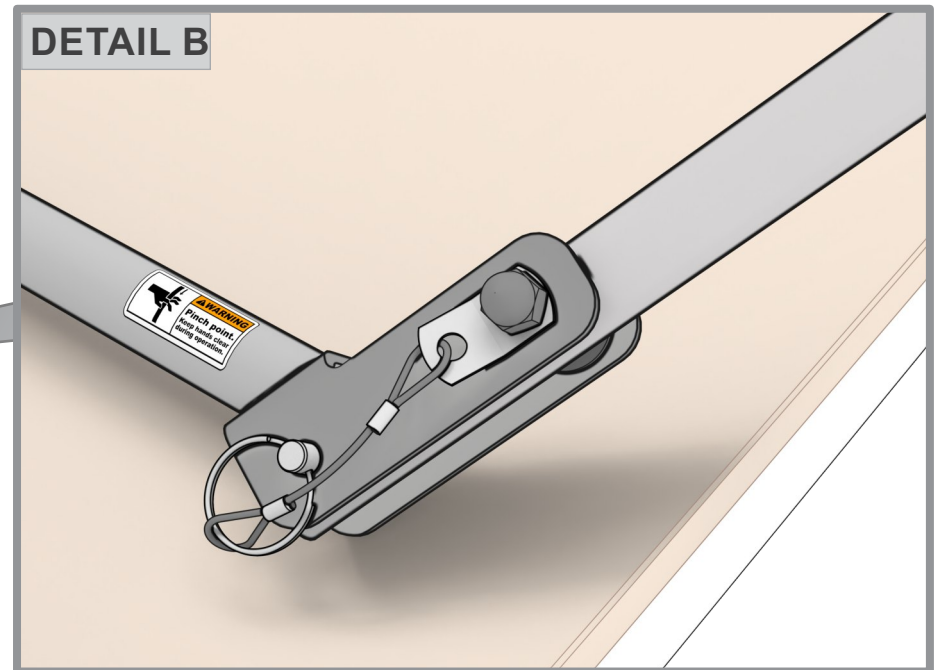
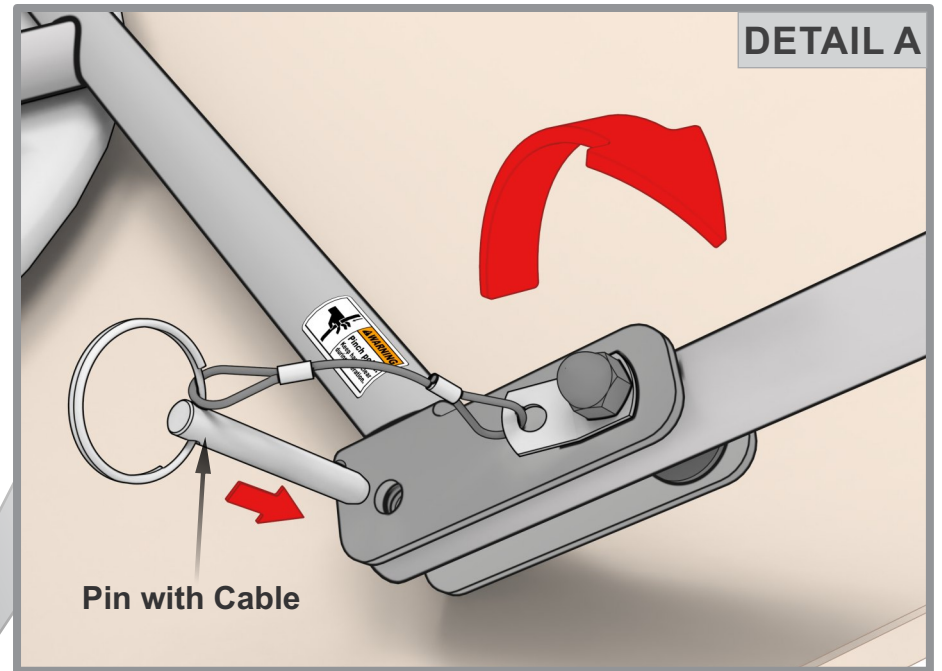
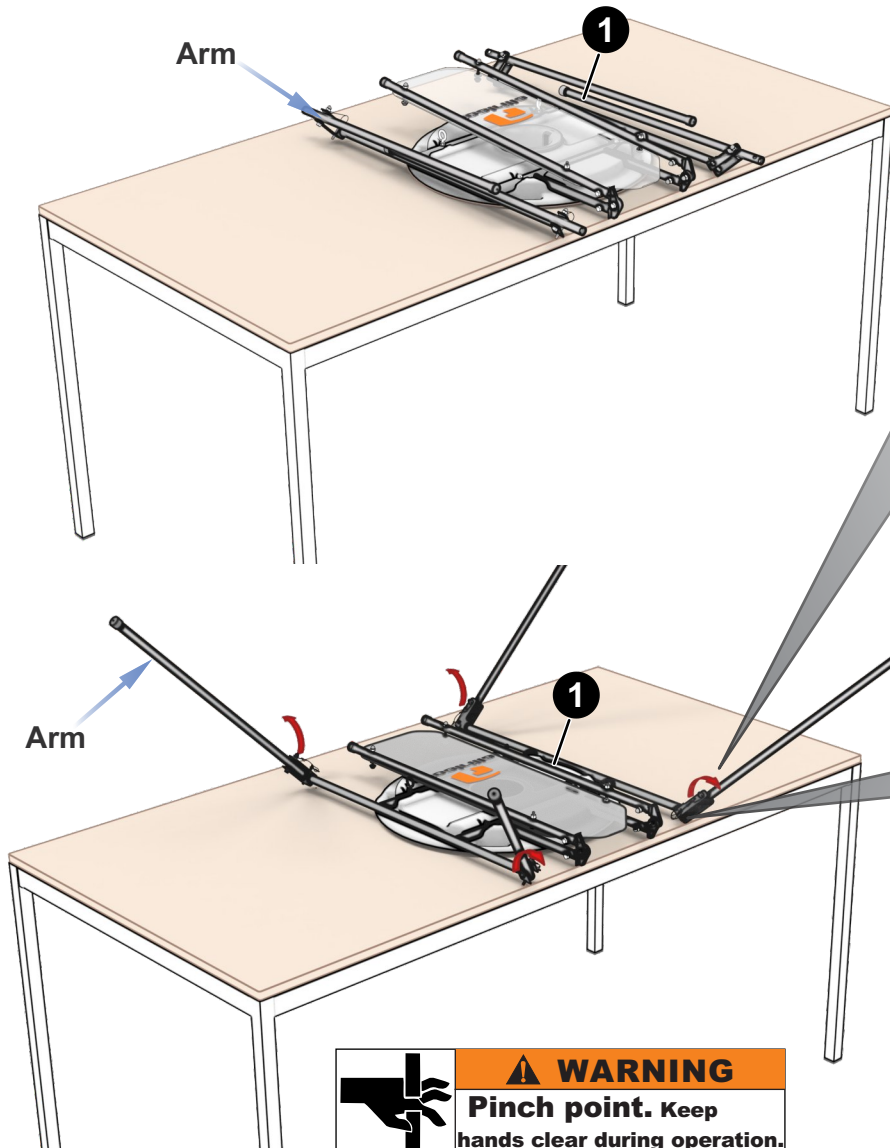

NOTE: When unfolding the Ball Return Ramp, the trainer should be on the edge of the table with the Ramp **hanging off** the table.

2. Unfold the Ball Return Ramp as shown in **Detail A**.

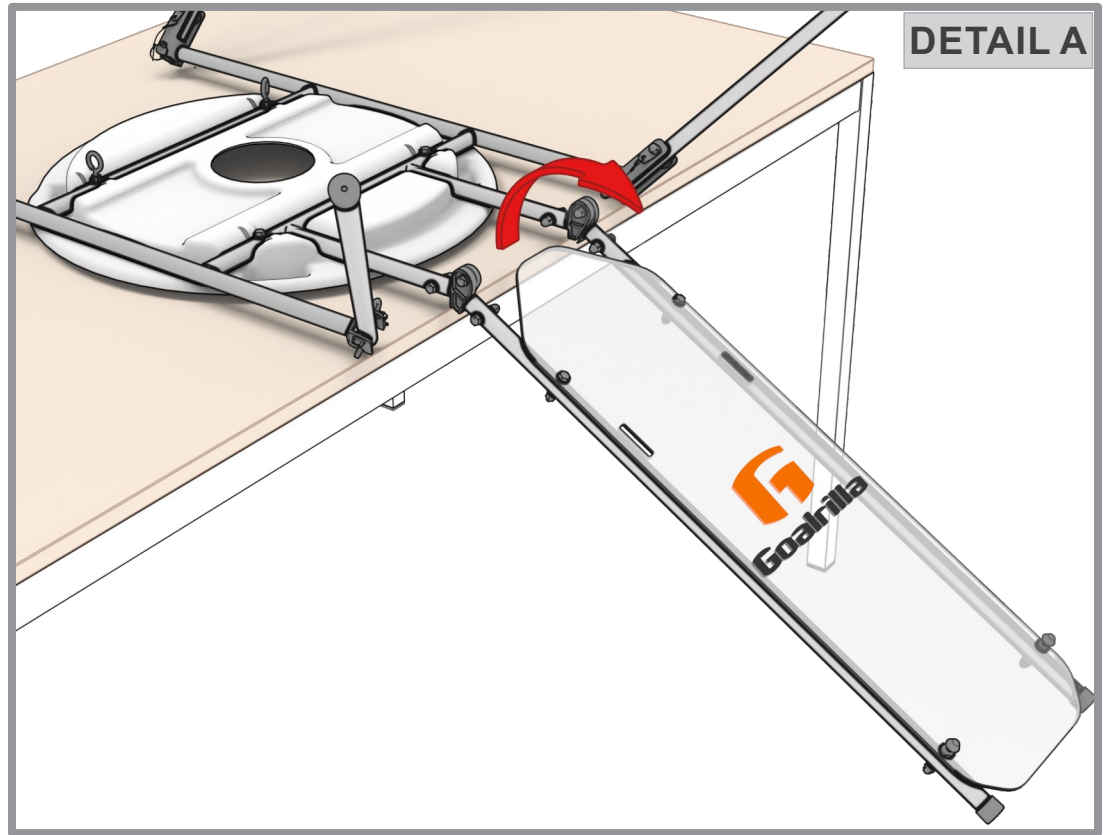
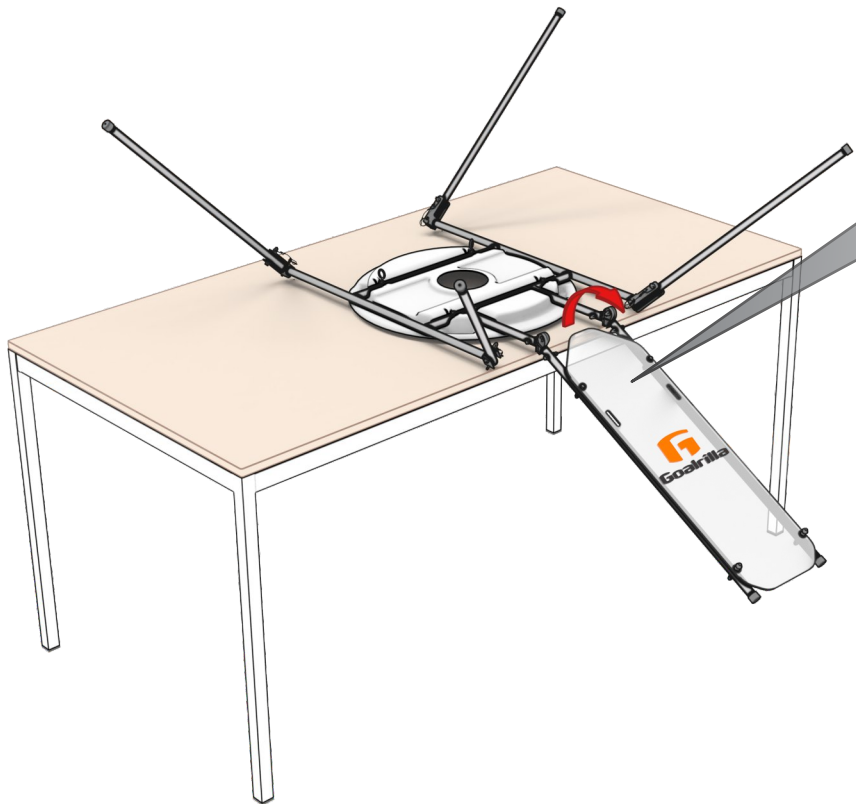

DETAIL A

NOTE: Unfold the Net (#5) and orient it, so the Ball Return Ramp opening matches the Ball Return Ramp end. The plastic hooks are attached at the bottom of the net. Make sure to have the hooks facing down.

3. Slide each Arm into the Net Sleeves as shown.

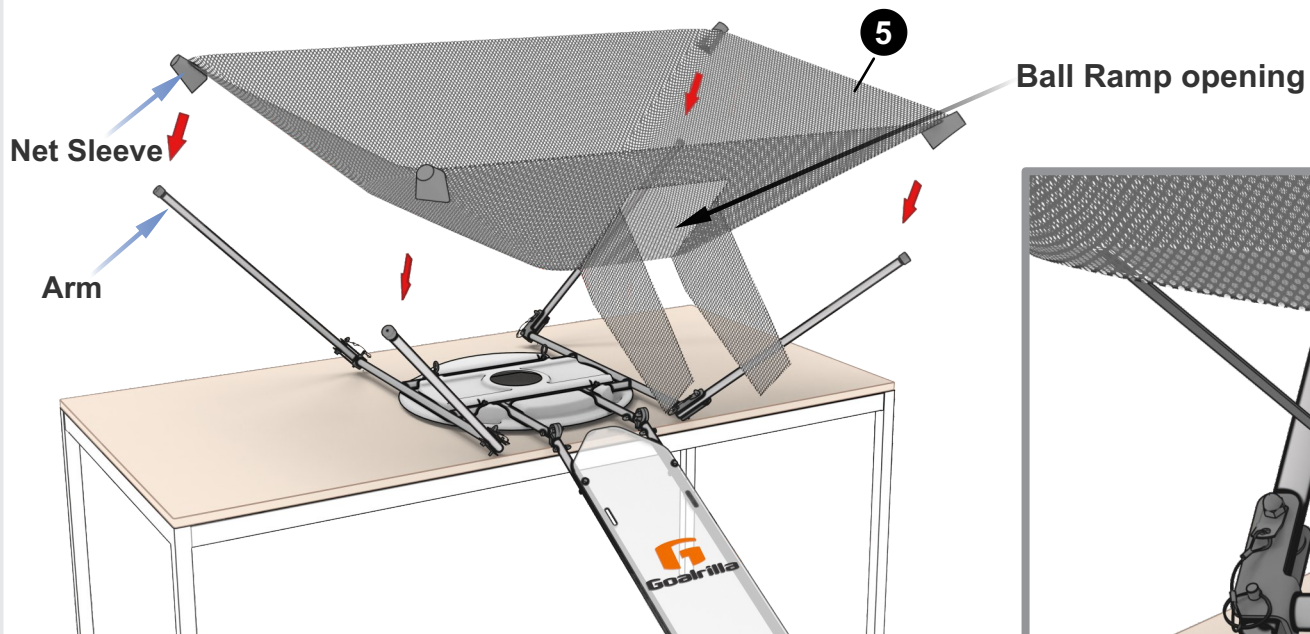

4. Secure the Net (#5) by clipping the 2 plastic hooks to the eyebolts on the main assembly. See **Detail A**.

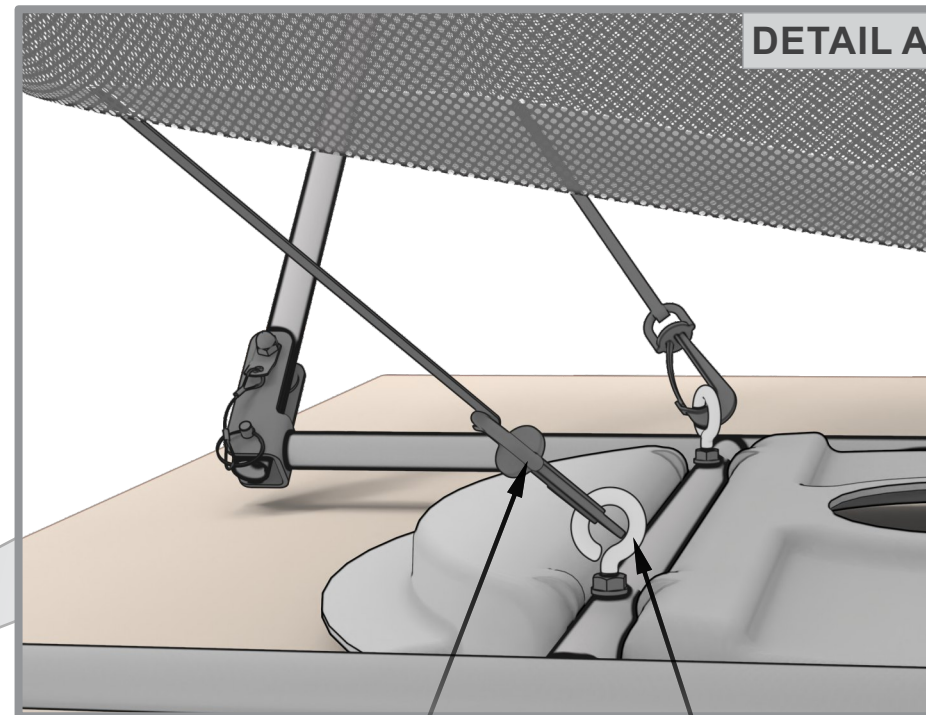
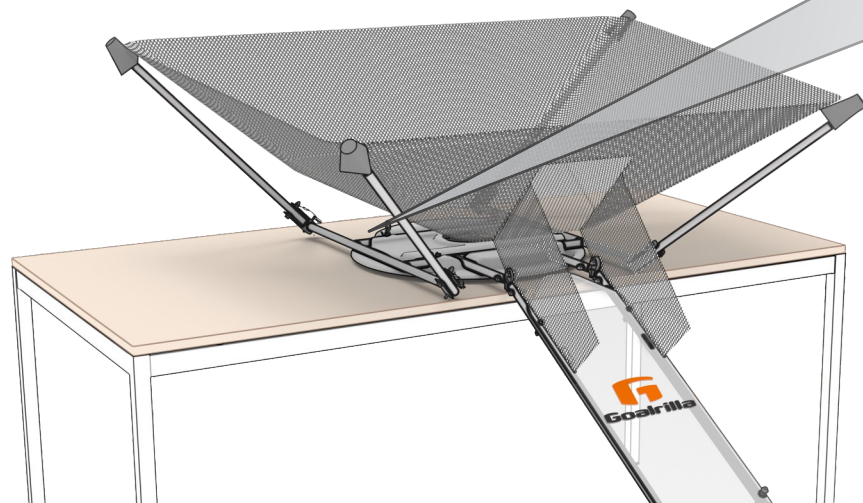

PLASTIC HOOK

EYEBOLT

5. Wrap the Hook & Loop Strap between the **Hinge** and **Bolt** as shown in **Detail A**

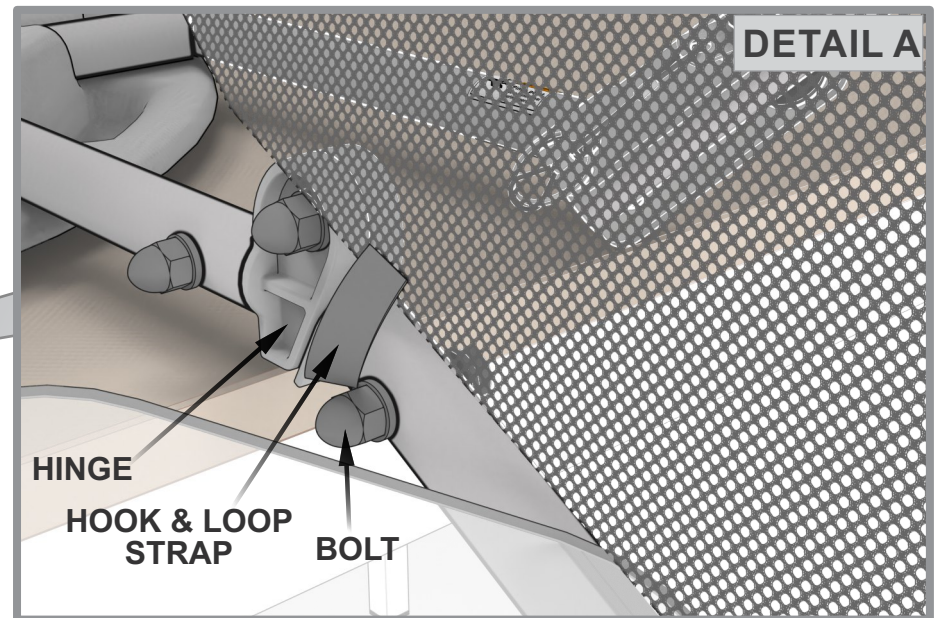
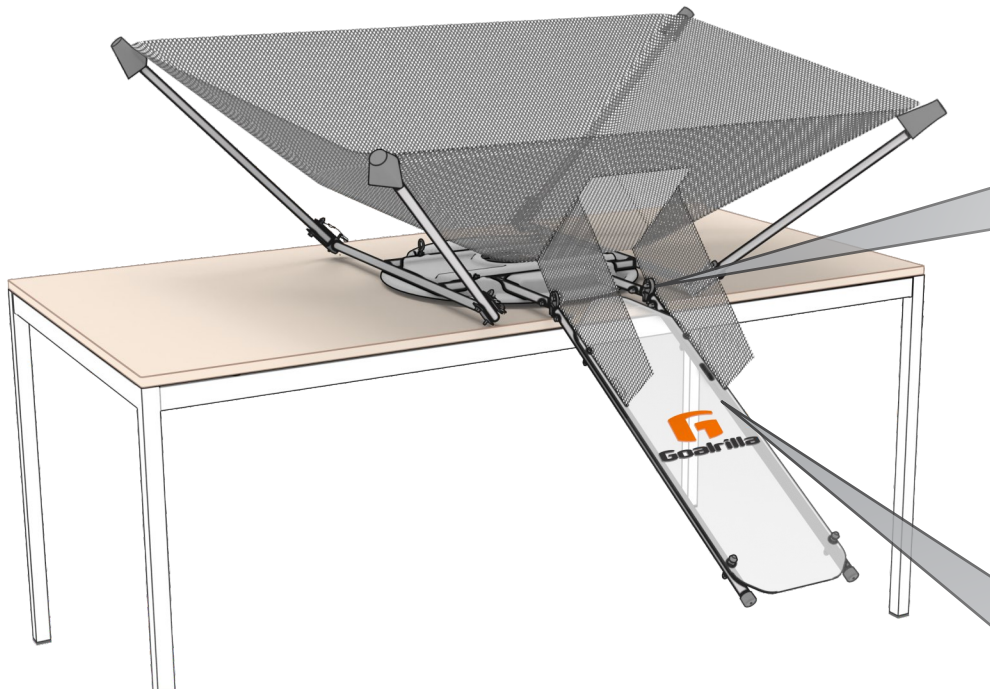

6. Insert the second Hook & Loop Strap into the Slot in the Ball Return Ramp, as shown in **Detail B**. Repeat Steps 5 and 6 for the other net side.

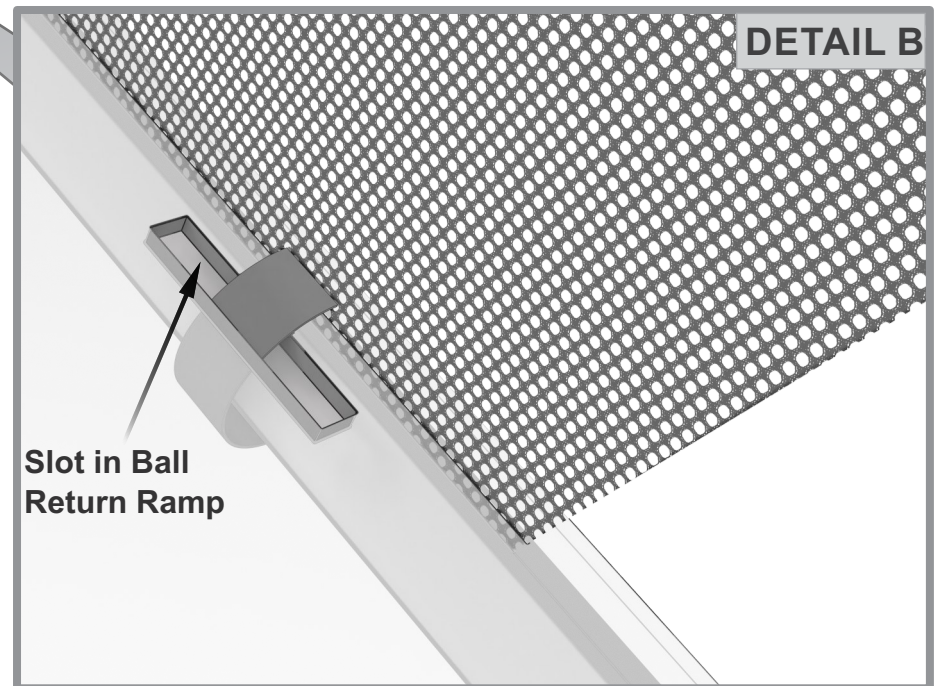

NOTE: Place the Frame assembly so that Ball Return Ramp is **hanging off** the table.

7. Loop both Net String ends onto the String Post until secure. See **Detail A & Detail B.**

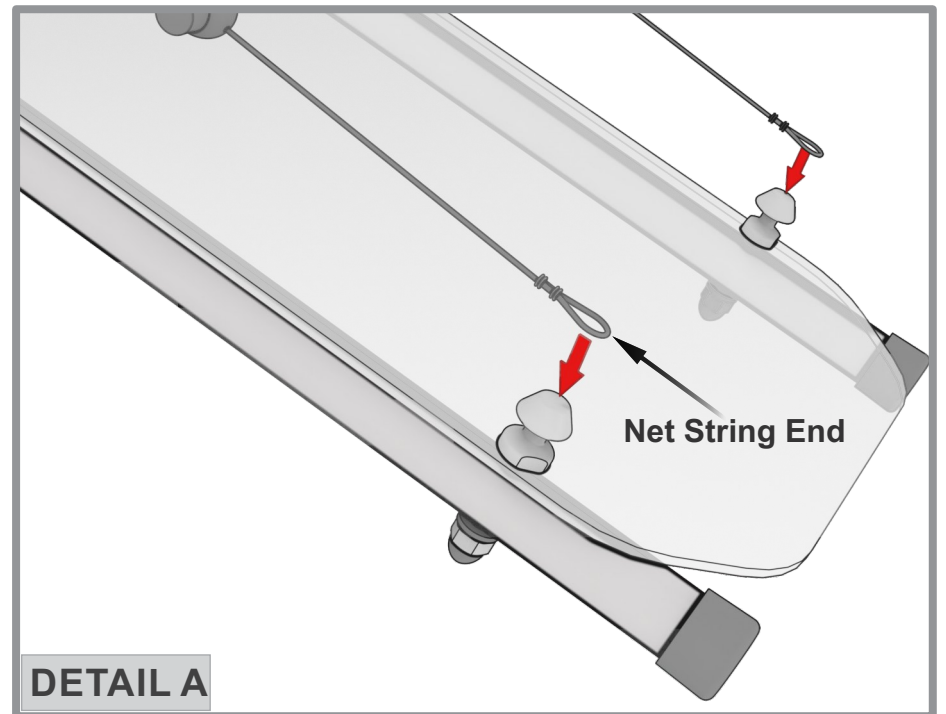
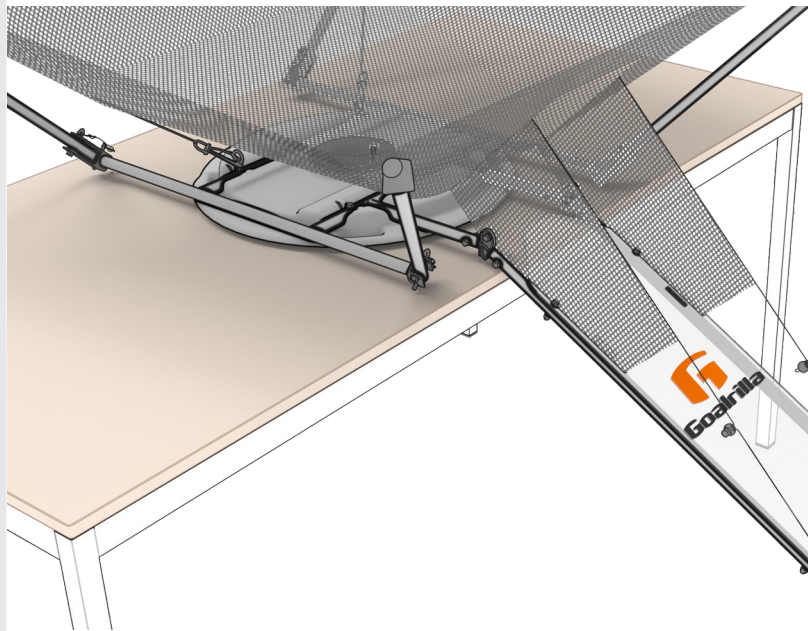

DETAIL A

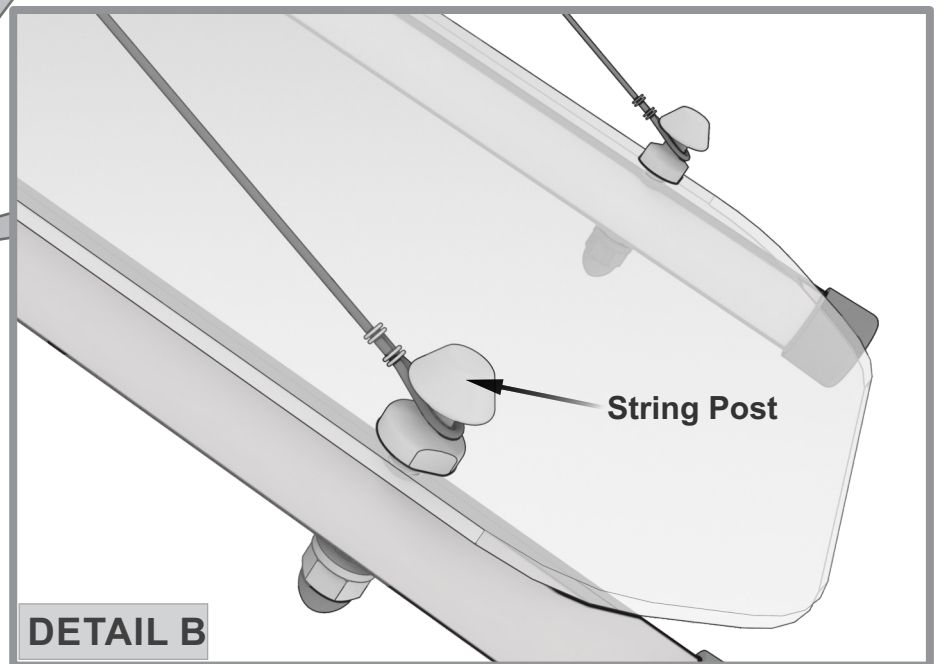

DETAIL B

8. Using the Ball Clasps on the net strings, tighten the net until the net is taut. See **Detail C**.

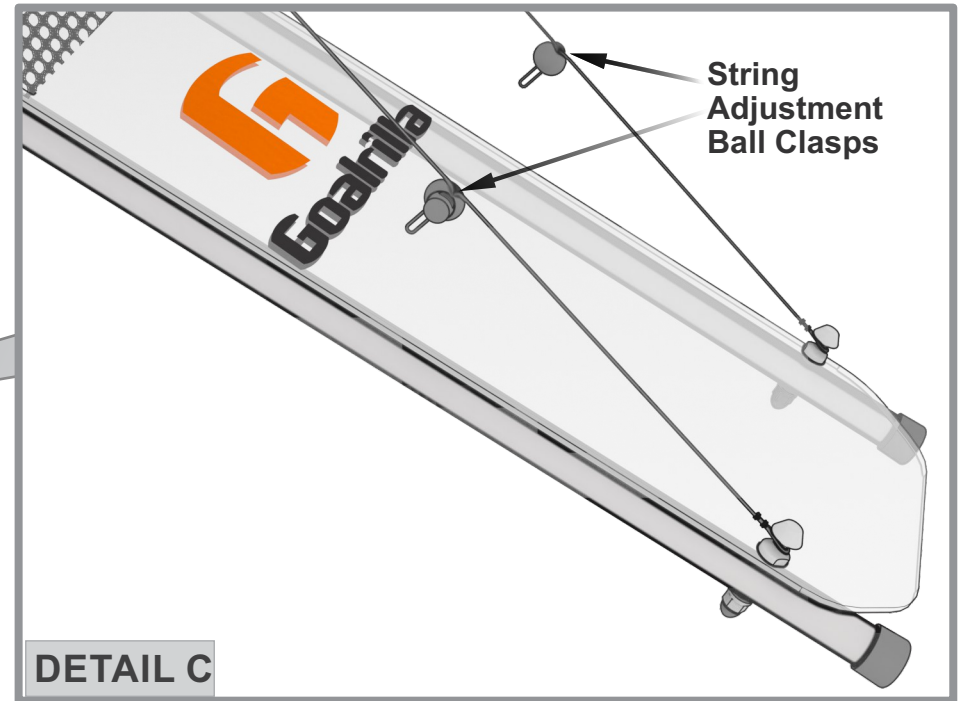
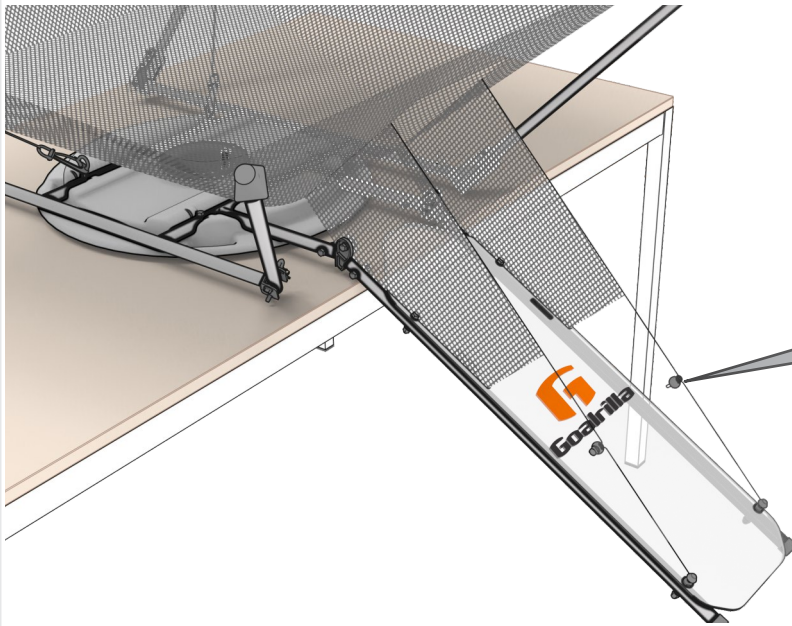

9. Insert Plastic Screw (#2) in the hole of the Rim Cover (#1). See **Detail A**.



The following steps should be performed by 2 capable adults.

10. Set the Trainer centered on the basketball rim as shown in **Detail B**. Use a ladder and have a second adult hand you the trainer.

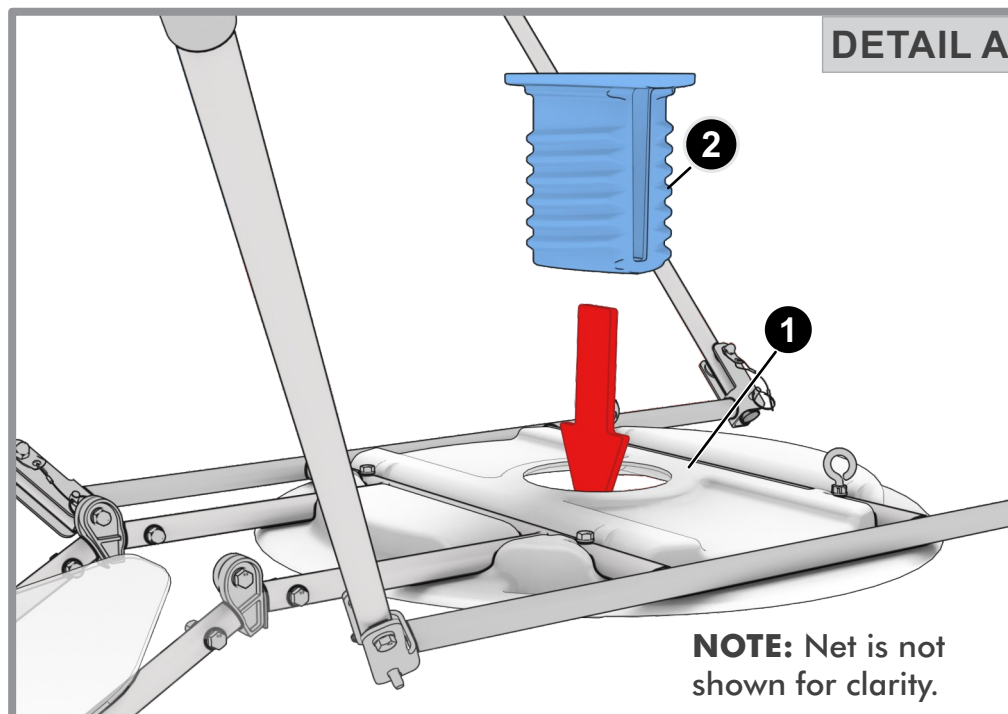

NOTE: Net is not shown for clarity.

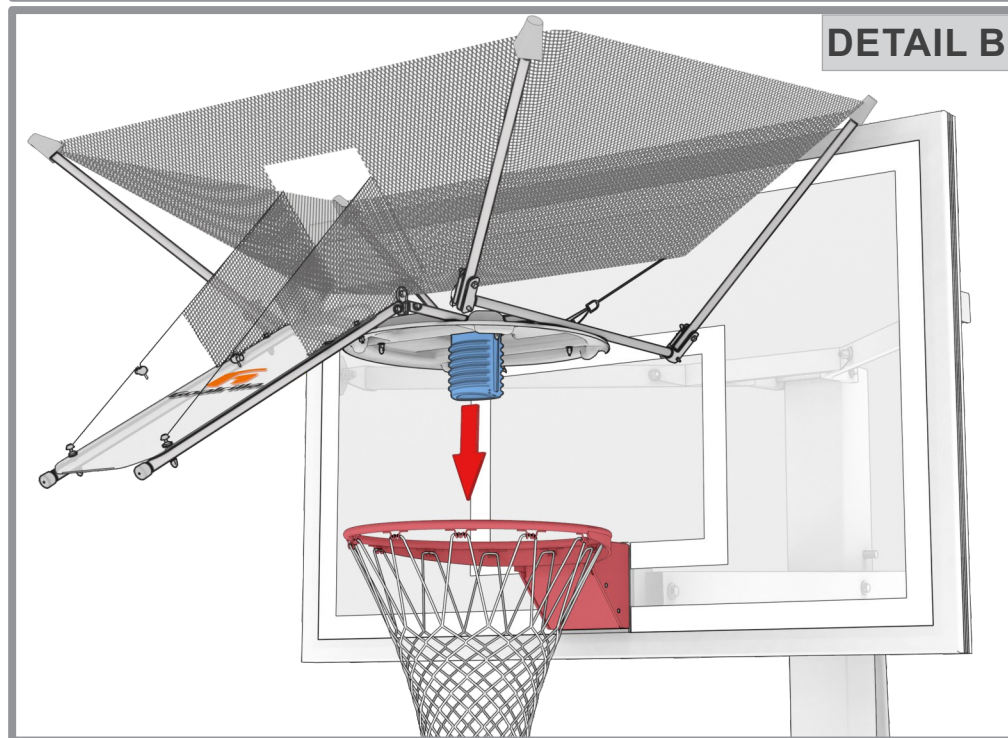

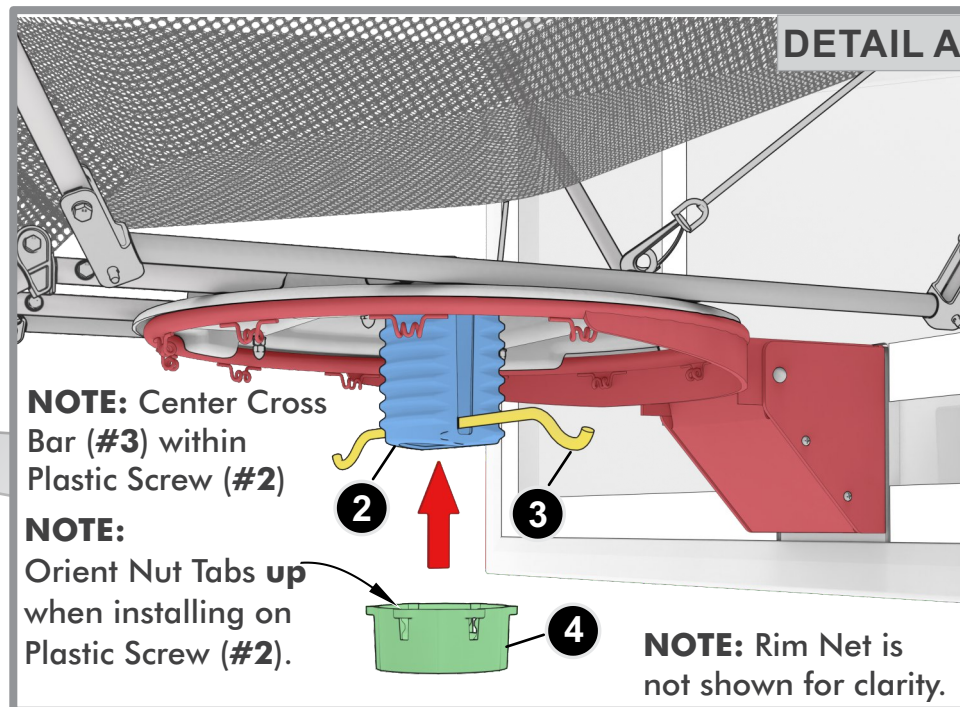
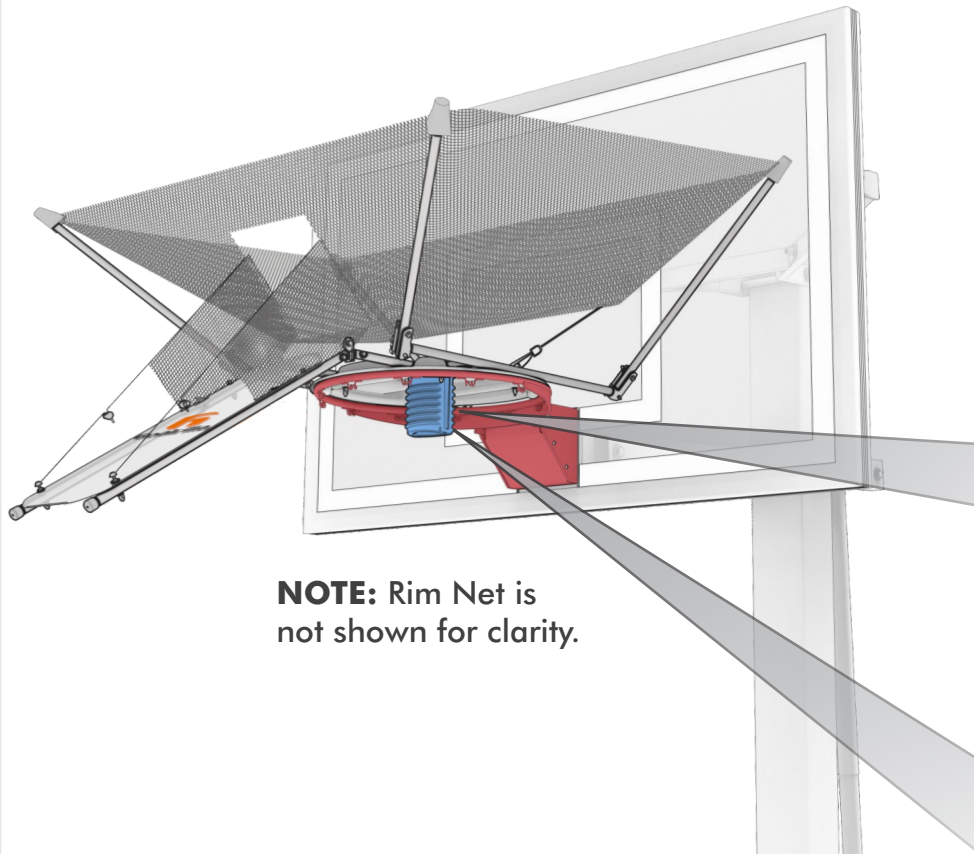

11. Insert Cross Bar (#3) through the Plastic Screw (#2) slot and center the Crossbar in the Plastic Screw as shown in **Detail A**.
12. Screw Plastic Nut (#4) onto Plastic Screw (#2) making sure to orient the tabs up. See **Detail A & Detail B**.
13. While keeping the Cross Bar (#3) centered, hand tighten the Plastic Nut (#4) and Plastic Screw (#2) until the rim is firmly clamped between the Crossbar and the Rim Cover. See **Detail B**.

NOTICE
DO NOT overtighten Plastic Nut (#4) to Plastic Screw (#2) this could damage the parts.

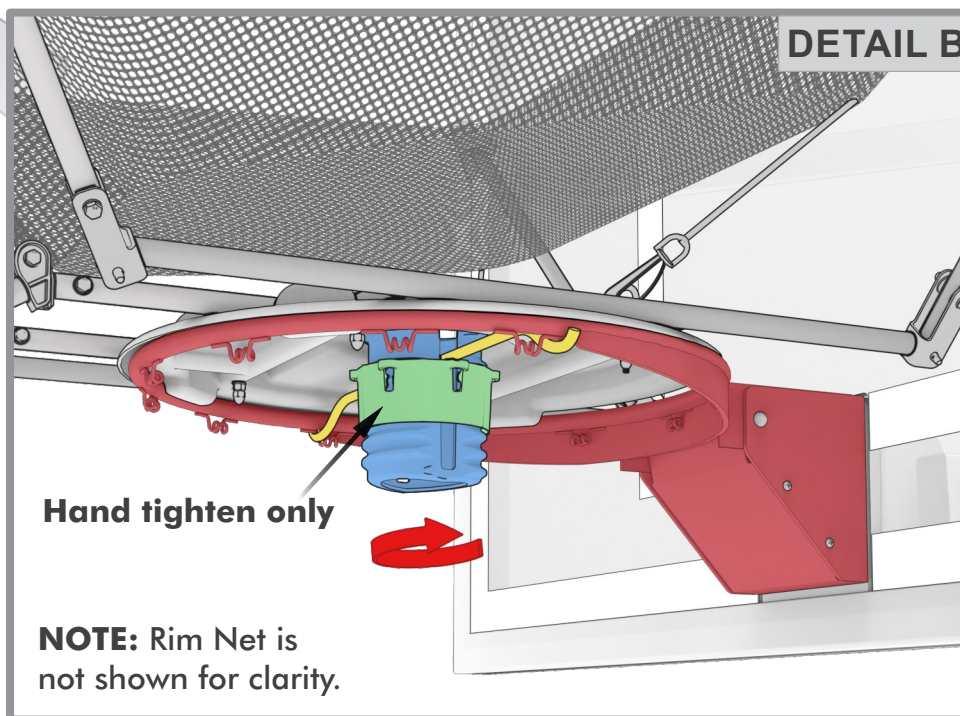

HEIGHT ADJUSTMENT:

The Volleyball trainer is height adjustable to accommodate players of different heights and skill levels. Simply turn the actuator handle on the Goalrilla basketball system to set the desired height. This feature only applies to adjustable basketball systems.

STORAGE POSITION:

To place the Volleyball Trainer in the storage position, remove the 4 quick-release pins and fold the 4 arms and ramp.

The net will stretch to allow for the front arms to fold backwards. **NOTE:** The net does not need to be removed when the Volleyball Trainer is in the storage position. When not in use, or during high winds and inclement weather, it is recommended that the trainer be stored indoors in the storage position.

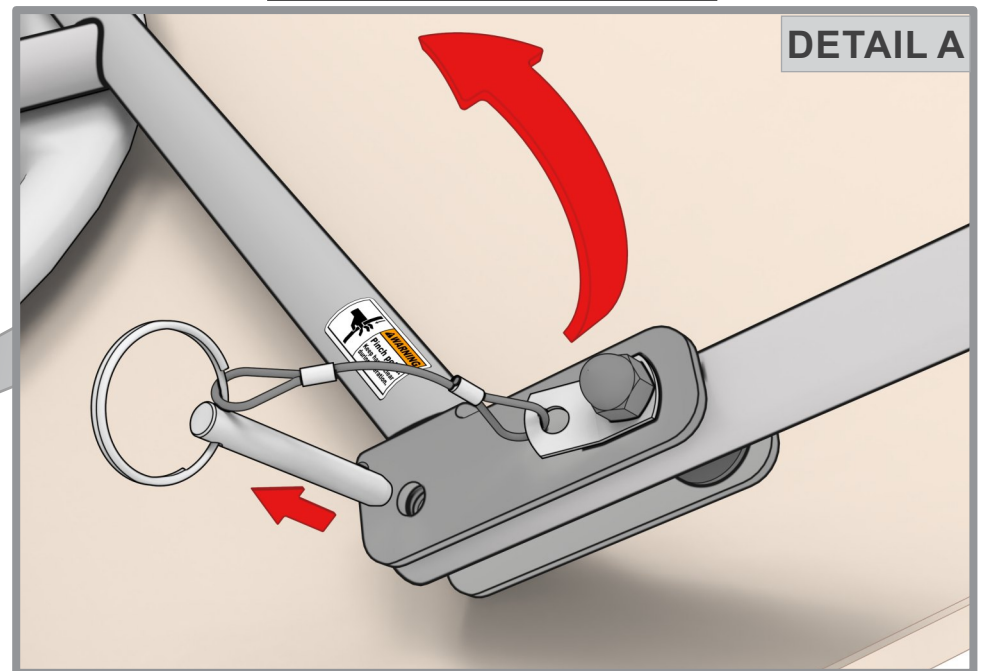
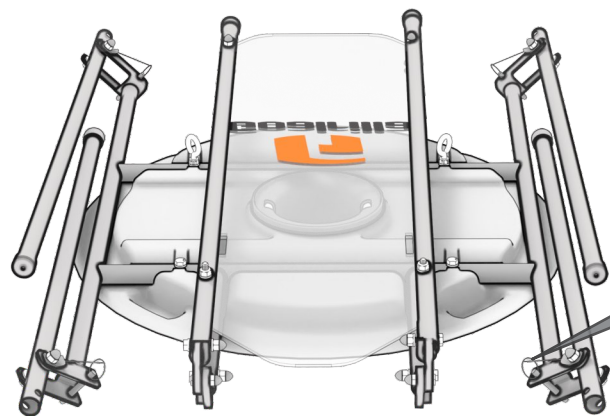

90 DAY LIMITED WARRANTY

WARRANTY COVERAGE: Escalade® Sports warrants to the original Consumer Purchaser that any Product of its manufacture is free from defects in material and workmanship. THIS WARRANTY IS VOID IF THE PRODUCT HAS BEEN DAMAGED BY ACCIDENT, UNREASONABLE USE, NEGLIGENCE, IMPROPER SERVICE, FAILURE TO FOLLOW INSTRUCTIONS PROVIDED WITH THE PRODUCT OR OTHER CAUSES NOT ARISING OUT OF DEFECTS IN MATERIAL OR WORKMANSHIP.

NOT COVERED BY THIS WARRANTY

- Any merchandise subjected to abuse, negligence, improper installation, vandalism, acts of God, alteration of product, or any other events beyond the control of Escalade® Sports.

Contact Escalade Sports Customer Service department at:

Phone: 1-888-872-4625 Warranty Dept.

Or Write Escalade® Sports at: Escalade® Sports - P.O. Box 889, Evansville, IN 47706 - Attn: Warranty Dept.

Or E-mail us at: basketball@escaladesports.com