

# Installation Guide

## Sink Strainer

P34000-00

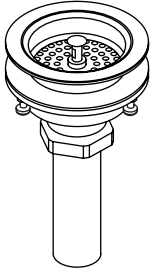

Français, page "Français-1"  
Español, página "Español-1"

1035389-2-B

KALLISTA®

## Thank You For Choosing Kallista

We appreciate your commitment to Kallista quality. Please take a few minutes to review this manual before you start installation. If you encounter any installation or performance problems, please don't hesitate to contact us. Our phone numbers and website are listed on the back cover. Thanks again for choosing Kallista.

## Tools and Materials



Adjustable  
Wrench



Plumbers  
Putty

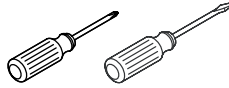

Various  
Screwdrivers

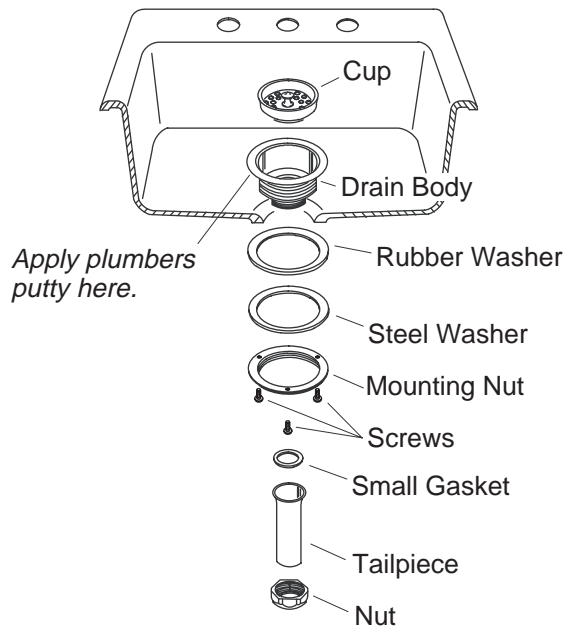

## 1. Install the Duostrainer

All information in these instructions is based upon the latest product information available at the time of publication. Kallista reserves the right to make changes in product characteristics at any time without notice.

- Apply a ring of plumbers putty or other sealant to the underside of the edge of the drain body according to the manufacturer's instructions.
- Insert the drain body in the sink.
- Partially thread the screws into the mounting nut until they protrude slightly through the mounting nut. From under the sink, slide the rubber washer and steel washer on the drain body, and then thread the mounting nut onto the drain body until it is about 1/4" (6 mm) from the sink bottom.
- Tighten the three mounting screws to draw the body tight against the basin of the sink.

**NOTE:** Do not reposition the drain body after it has been tightened.

**Install the Duostrainer (cont.)**

- Position the small gasket on the drain body.
- Align the wide end of the tailpiece with the drain or strainer body, slide the nut onto the tailpiece, and thread the nut to the drain body.
- Position the P-trap (not shown) on the end of the tailpiece.
- Tighten the P-trap nut, and remove any excess sealant.