

User manual

Steam cleaner

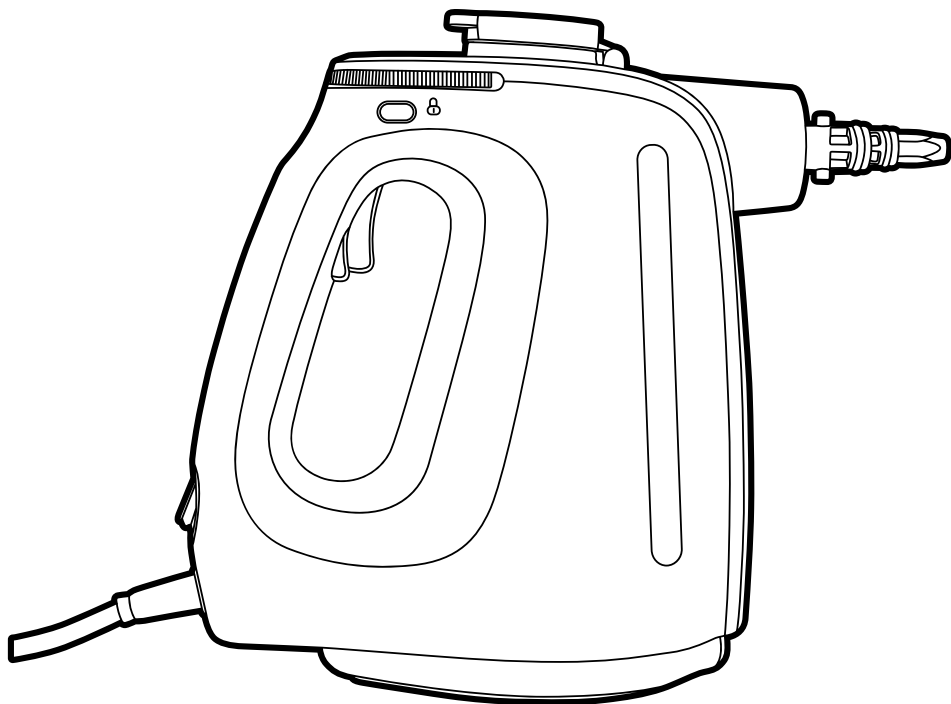

UK ONLY
To register for your extended guarantee, scan the QR code or visit guarantee.uqpic.com/beldray and register your product within 30 days of purchase. For any further queries, visit www.beldray.com.

Important safety

Please read carefully

Please retain instructions for future reference.

SAFETY INSTRUCTIONS

- When using electrical appliances, basic safety precautions should always be followed.
- Check that the voltage indicated on the rating plate corresponds with that of the local network before connecting the appliance to the mains power supply.
- This appliance can be used by children aged from 8 years and above and persons with reduced physical, sensory or mental capabilities and knowledge, if they have been supervised/instructed and understand the hazards involved.
- Children shall not play with the appliance.
- Children should not perform cleaning or user maintenance, unless they are older than 8 and supervised.
- This appliance is not a toy.
- If the power supply cord, plug or any part of the appliance is malfunctioning or if it has been dropped or damaged, cease using the product immediately to avoid potential injury.
- This appliance contains no user serviceable parts, only a qualified electrician should carry out repairs. Improper repairs may place the user at risk of harm.
- Keep the appliance and its power supply cord out of the reach of children.
- Keep the appliance out of the reach of children when it is switched on or cooling down.
- Do not immerse the appliance in water or any other liquid.
- Do not leave the appliance unattended whilst connected to the mains power supply.
- Do not remove the appliance from the mains power supply by pulling the cord; switch it off and remove the plug by hand.
- Do not pull or carry the appliance by its power supply cord.
- Do not use the appliance for anything other than its intended use.
- Do not use any parts/accessories or adaptors other than those supplied with this appliance.

- Do not use this appliance outdoors.
- Do not use the appliance on leather, wax polished furniture or floors, vinyl or laminate floors, synthetic fabrics, velvet or other delicate, steam-sensitive materials.
- Do not use the appliance on any unsealed hard floor surfaces or surfaces that have been treated with wax, as the sheen may be removed by the heat and steam action. It is always recommended to test an isolated area of the surface to be cleaned before proceeding.
- Do not touch any sections of the appliance that may become hot during use, as this could cause injury.
- Do not direct steam at people or animals or towards equipment containing electrical components, such as the interior of ovens.
- Use of an extension cord with the appliance is not recommended.
- This appliance should not be operated by means of an external timer or separate remote control system.
- This appliance is intended for domestic use only. It should not be used for commercial purposes.



CAUTION: The appliance emits very hot steam; always exercise extreme caution during use.



WARNING: Danger of scalding.

UK CE

EN | Disposal of Waste Batteries and Electrical and Electronic Equipment



This product is labelled with this crossed out wheel bin symbol in accordance with European Directive 2012/19/EC to indicate that it must not be disposed of with your other household waste. Due to the presence of hazardous substances, mixtures or components, electrical and electronic devices that are not subject to selective sorting are potentially dangerous to the environment and human health. Please check your local city office or waste disposal service for the return and recycling of this product.

Manufactured by:
Ultimate Products UK Ltd.,
Victoria Street, Manchester OL9 0DD. **UK.**
Ultimate Products Europe Ltd.,
19 Baggot Street Lower, Dublin D02 X658. **ROI.**
MADE IN CHINA.

CD181124/MD000000/V1

Description of parts

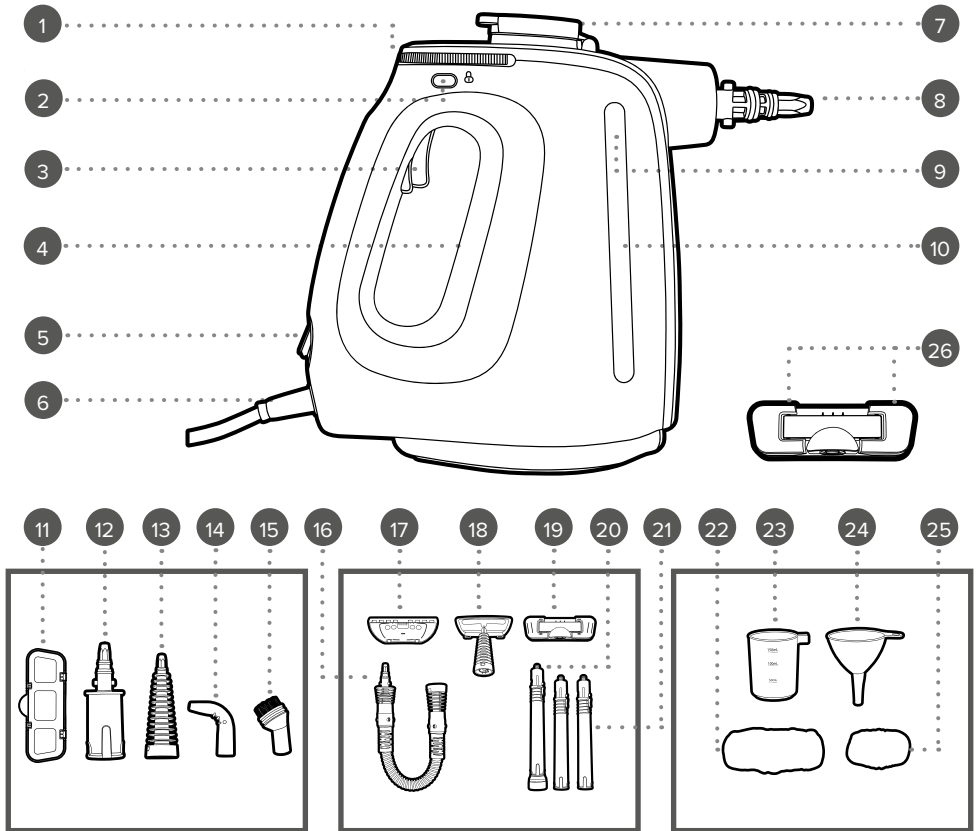

1. Indicator light
2. Safety lock
3. Trigger
4. Steam cleaner main unit
5. On/off switch
6. Cord cover
7. Top cover
8. Nozzle
9. Max. fill mark

10. Water tank
11. Carpet glider
12. Small straight nozzle
13. Straight nozzle
14. Angled nozzle
15. Round brush
16. Flexible extension hose
17. Window/mirror squeegee
18. Upholstery nozzle

19. Mop head
20. Main extension tube
21. Small extension tube (qty. 2)
22. Mop pad (qty. 2)
23. Measuring cup
24. Funnel
25. Upholstery pad
26. Mop pad tabs

Please retain instructions for future reference.

Dos and don'ts

DO:

Switch off the steam cleaner and disconnect it from the mains power supply before changing or fitting attachments.

DON'T:

Open the water tank cap whilst the appliance is still turned on.

Use attachments if they are loose, damaged or broken.

Exceed the max. fill mark.

Care and maintenance

Before attempting any cleaning or maintenance, always unplug the steam cleaner from the mains power supply and allow it to cool sufficiently.

Drain any remaining water from the water tank. Wipe the steam cleaner main body with a soft, damp cloth and allow to dry thoroughly.

The accessories are not suitable for dishwasher use. Do not use harsh or abrasive cleaners or detergents.

The mop pads are machine washable on a low heat setting. The mop pad is machine washable on a low heat setting. Always use a mild detergent and lay flat to dry. Never use bleach or fabric softener when washing the mop pad.

Descaling the water tank and removing limescale

If living in a hard water area, calcium deposits may begin to build up inside the water tank or accessories. If this occurs, it is recommended to use demineralised water with the steam cleaner. Limescale can develop over time and can affect the performance of the steam cleaner. It is recommended to remove limescale at least once a month. Use a limescale removing solution that is suitable for use with a steam cleaner. Always follow the manufacturer's instructions.

Instructions for use

Assembling the steam cleaner

Accessories can be installed directly onto the end of the general nozzle, onto the flexible hose or on the extension tubes. The flexible hose provides an extended reach, ideal for awkward corners and hard-to-clean areas. The extension tubes attached together can then be used as a floor cleaner.

Attaching the straight nozzle

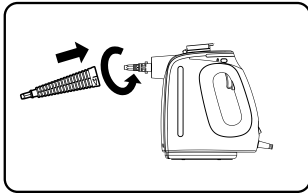

STEP 1: Holding the steam cleaner steady, push the straight nozzle firmly onto the steam cleaner and then twist it in a clockwise direction to secure it into position.

STEP 2: To remove the straight nozzle, twist it in an anticlockwise direction and pull it away from the steam cleaner.

Attaching the flexible hose

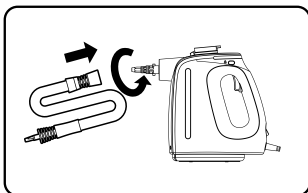

STEP 1: Holding the steam cleaner steady, push the flexible hose onto the steam cleaner and then twist it in a clockwise direction to secure it into position.

STEP 2: To remove the flexible hose, twist it in an anticlockwise direction and pull it away from the steam cleaner.

Attaching the round brush or angled nozzle

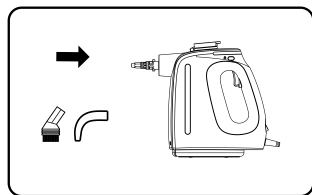

STEP 1: Once the flexible hose or straight nozzle is secure, push the round brush or angled nozzle into place over the end of the chosen attachment or add directly to the steam cleaner nozzle.

STEP 2: To remove the round brush or angled nozzle, pull it away from the nozzle firmly.



WARNING: Exercise caution when using the round brush, as it has very sharp bristles. Never hold the round brush by its bristles; always use the main body.

Attaching the mop head

The mop head can be attached to the steam cleaner by using the extension tubes to use as a steam mop.

STEP 1: Attach the main extension tube onto the steam cleaner and then twist it in a clockwise direction to secure it into position.

STEP 2: Attach the smaller extension tubes onto the steam cleaner main unit by clicking it into place.

STEP 3: Place the mop head onto the end of the extension tube ensuring that it is secure by clicking it into position.

STEP 4: Attach the mop pad by pulling it over the mop head, allowing the elasticated edges to hold it in position.

STEP 5: Lift the tabs on the mop head for the mop pad to slide in, then push down the mop head tabs to secure the mop pad in place.

STEP 6: To remove the mop head extension, twist it in an anticlockwise direction and pull it away from the steam cleaner.



CAUTION: Allow the steam cleaner to cool thoroughly before attempting to add or remove the mop pad.

Attaching the carpet glider

STEP 1: Install the mop head following the instructions in the section entitled '**Attaching the mop head**'.

STEP 2: Attach the carpet glider attachment to the mop head by pressing down on the rear of the mop head until it clicks securely into position.



NOTE: The carpet glider should only be used on carpet.

Attaching the upholstery nozzle

STEP 1: Attach the upholstery nozzle on to the steam cleaner and then twist it in a clockwise direction to secure it into position.

STEP 2: Attach the upholstery pad to the nozzle, allowing the elasticated edges to hold it in position.

STEP 3: To remove the upholstery nozzle, twist it in an anticlockwise direction and pull it away from the steam cleaner.

Attaching the window/mirror cleaner

STEP 1: Attach the window/mirror squeegee onto the upholstery nozzle by hooking the small hooks on the window/mirror squeegee through the back slots of the upholstery nozzle.

STEP 2: Push into position until the clip on the window/mirror squeegee secures to the back of the upholstery nozzle.

STEP 3: To remove the window/mirror squeegee, push the clip forwards, unfasten the hooks from the attachment slots and pull the window/mirror squeegee away from the upholstery nozzle.



CAUTION: Never use the steam cleaner on frosted or cold glass, as this may damage or crack the glass.

Filling the water tank

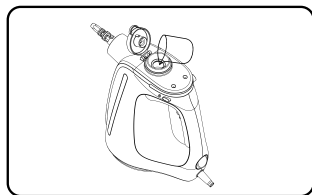

Check that the steam cleaner is turned off before attempting to fill the water tank.

STEP 1: Position the steam cleaner on a flat, stable surface.

STEP 2: Remove the water tank cap by opening the top cover.

STEP 3: Fill the measuring cup with cold water.

STEP 4: Using the funnel, carefully pour the contents of the measuring cup into the water tank, making sure that it does not overflow. If necessary, repeat step 3 until the water tank is full.

STEP 5: Replace the water tank cap by closing it down securing it into position.



NOTE: The water tank has a max. capacity of 550 ml. The water may take a couple of seconds to rise; allow time for this before adding in more, making sure that the water tank is not overfilled. Overfilling the water tank could cause excess water to be produced in the place of steam.



CAUTION: Do not attempt to fill the water tank whilst the steam cleaner is turned on, as this could cause damage to the main unit. Never add aromatic, alcoholic or detergent products into the steam cleaner, as this may damage it or make it unsafe for use.

Using the steam cleaner

STEP 1: Fill the water tank with cold tap water following the instructions in the section entitled 'Filling the water tank'.

STEP 2: Attach any accessories as required.

STEP 3: Plug in and switch on the steam cleaner at the mains power supply.

STEP 4: The power indicator light will illuminate red to signal that the steam cleaner is preheating; this will take approx. 20 seconds. Once the steam cleaner has reached the correct temperature, the power indicator light will switch off.

STEP 4: To operate the steam cleaner, press the safety lock forwards to the unlocked position and then press and hold the steam trigger.

STEP 5: To turn off the steam cleaner, press the safety lock to the locked position and press the switch to the off position. Unplug the steam cleaner from the main power supply.



NOTE: The water tank will supply approx. 15–17 minutes of continuous steam when filled with 550 ml water. It is always recommended to test an isolated area of the surface to be cleaned before proceeding. When operating the steam cleaner, ensure there is always water in the tank. If the volume of steam has reduced, turn the steam cleaner off and refill the water tank. Always empty the remaining water in the tank after every use to avoid the growth of limescale/mold.

Using the steam cleaner to clean windows and glass

STEP 1: Install the window/mirror cleaner following the instructions in the section entitled 'Attaching the window/mirror cleaner'.

STEP 2: Press the safety lock forwards to the unlocked position and hold the steam trigger. Move the window/mirror cleaner over the area to be cleaned.



NOTE: When cleaning windows, it is advised to use the steam button in short bursts. Hold the window/mirror cleaner approx. 30 cm away from any glass for the first 30 seconds of use; this will preheat it.

Using the steam cleaner as a steam mop

STEP 1: Install the mop head and attach the mop pad following the instructions in the section entitled '**Attaching the mop head**'.

STEP 2: Attach the carpet glider if necessary.

STEP 3: Press the safety lock forwards to the unlocked position and hold the steam trigger.

Using the steam cleaner to refresh clothes

STEP 1: Install the upholstery nozzle to steam cleaner following the instructions in the section entitled '**Attaching the upholstery nozzle**'.

STEP 2: Hang the clothes to be steamed.

STEP 3: Slide the safety lock forwards to the unlocked position and hold the steam trigger. Move the upholstery pad over the garment to gently steam the fabric.



NOTE: Always follow the instructions on the garment care label.

Function and accessory usage

Required use	Accessory
Cleaning or steam ironing garments.	Upholstery nozzle with upholstery pad.
Hobs and BBQ equipment.	Round brush.
Sofas, cushions or other heavy materials.	Upholstery nozzle with upholstery pad.
Tiles and sealed grout.	Straight nozzle or round brush.
Taps and sanitaryware.	Straight nozzle, angled nozzle or round brush.
Floor tiles.	Extension tubes with mop head.
Carpets.	Extension tube with mop head and carpet glider.
Shower screens, mirrors and glass.	Window/mirror cleaner.
Bathtubs, sinks, toilets and other bathroom accessories.	Straight nozzle, angled nozzle or round brush.
Car upholstery.	Upholstery nozzle with upholstery pad.
Outer surface of car alloys.	Angled nozzle or round brush.
Toys, tables and work surfaces.	Straight nozzle, angled nozzle or round brush.
Awkward, hard-to-reach areas.	Straight nozzle or angled nozzle and flexible hose.

Troubleshooting

Problem	Possible cause	Possible solution
Reduced or no steam/abnormal noise.	The water tank may be empty.	Add water to refill the water tank.
	The attachment or accessory may be blocked.	Clean the attachment or accessory.
	There is no power to the steam cleaner.	Make sure that the steam cleaner is plugged into the mains power supply.
The steam cleaner does not turn on.	There is a blown fuse.	Check the fuse by replacement.
	The power cord is not plugged in.	Plug the power cord into a mains power supply.
Water is being emitted with no steam.	The water tank has been overfilled.	Switch off and unplug the steam cleaner from the mains power supply and allow it to cool thoroughly. Empty the water tank and then refill it with 250 ml of water.
The steam button does not work.	The safety lock is in the locked position.	Press the safety lock backwards so that it is in the unlocked position.
The steam cleaner is blocked by oxidation.	There is a possible limescale build-up.	Dissolve 10 g of scale remover in 200 ml of water, pour the mixture into the water tank, leave it for 6 hours, start the steam cleaner until the water in the tank is completely depleted.

Storage

Remove all attachments, making sure that the steam cleaner has been cleaned following the instructions in the section entitled '**Care and maintenance**'. Check that the steam cleaner is cool and dry, and the water tank is empty before storing in a cool, dry place.

Specifications

Product code: BEL01987/BEL02007

Input: 220–240 V ~ 50–60 Hz

Output: 1350 W

Water tank capacity: 550 ml



Manufactured by:
Ultimate Products UK Ltd.,
Victoria Street, Manchester OL9 0DD. **UK.**
Ultimate Products Europe Ltd.,
19 Baggot Street Lower, Dublin D02 X658. **ROI.**
MADE IN CHINA.

©Beldray trademark. All rights reserved.
CD240224/MD170225/V2