

# Installation Instructions for Compact Hinges 9390 & 8390 Series

## Required Parts:

1 ea #7 X 5/8" pan washer head screw  
1 ea #7 X 5/8" flat head screw  
(for hinges with no press-in dowels)

## Optional Parts:

85° Restrictor Clip (9390.RC)  
Replacement dowels & screws

## Tools:

Phillips Screwdriver  
Hinge Boring Machine (HRBORE220SP)  
Insertion Ram for Compact Hinges (LARM7390)

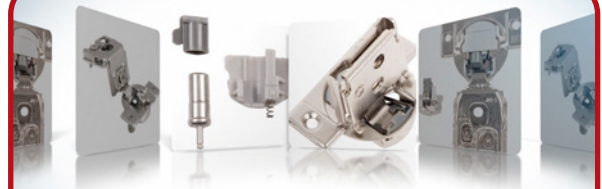

Learn about the features and benefits of these hinges.

Scan to view product video.  
<https://delivr.com/22rjp>



**9390 Series**  
No Dowels  
Soft-close





**9390 Series**  
Press-in 8 mm Dowels  
Soft-close





**8390 Series**  
No Dowels  
Self-close



**8390 Series**  
Press-in 8 mm Dowels  
Self-close

	9390 SERIES APPLICATION	3/8" Overlay	7/16" Overlay	1/2" Overlay	5/8" Overlay	3/4" Overlay	1" Overlay	1-1/4" Overlay	1-3/8" Overlay	1-1/2" Overlay
	Soft-close No Dowels			9390 200/ctn						
				9390-2C* 200/ctn						
	Soft-close Press-in 8 mm Dowels	9390-038 200/ctn	9390-716 200/ctn	9390-2-000 200/ctn	9390-058 200/ctn	9390-6-000 200/ctn	9391-000 200/ctn	9394-000 200/ctn	9393-000 200/ctn	9392-000 200/ctn
				9390-2-2C* 200/ctn				9394-2C* 200/ctn		

\*2C = 2-Cleat Hinge

	8390 SERIES APPLICATION	3/8" Overlay	7/16" Overlay	1/2" Overlay	5/8" Overlay	3/4" Overlay	1-1/4" Overlay	1-3/8" Overlay	1-1/2" Overlay
	Self Close No Dowels			8390 200/ctn					
				8390-2C* 200/ctn					
	Self Close Press-in 8 mm Dowels	8390-038 200/ctn	8390-716 200/ctn	8390-2-000 200/ctn	8390-058 200/ctn	8390-6-000 200/ctn	8394-000 200/ctn	8393-000 200/ctn	8392-000 200/ctn
				8390-2-2C* 200/ctn			8394-2C* 200/ctn		

\*2C = 2-Cleat Hinge

# Installation Instructions for Compact Hinges 9390 & 8390 Series

## 1. Bore door(s) to accommodate hinge cup and dowels (if applicable).

a. Determine the number of hinges that are needed for each door using the figure (below left).

### Number of Compact Hinges Needed

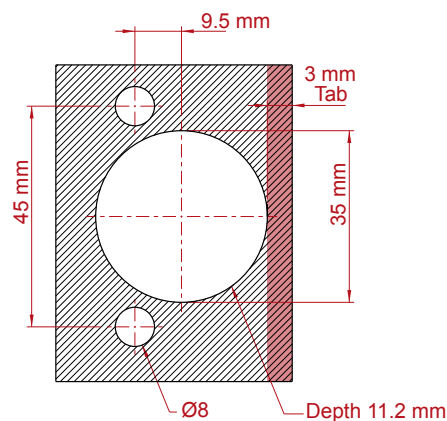
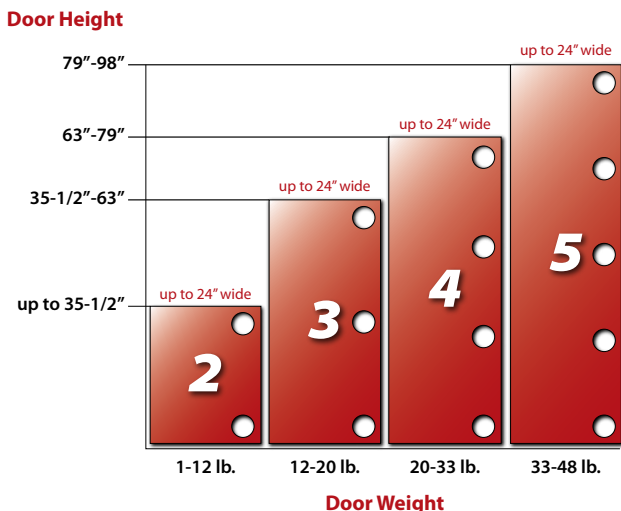

	Boring Depth	Tab
9390 Series	11.2 mm	3 mm
8390 Series	11.2 mm	3 mm

NOTE: Avoid doors that are wider than they are tall.  
Keep hinges as close to top and bottom of door as possible.  
Attach hinges and plates using all available holes.

b. Use the boring pattern (above right) to bore each door for each hinge to be attached.

NOTE: A tab of 3 mm is recommended to ensure the correct overlay for all compact hinges.

NOTE: If not using press-in dowels, skip drilling of 8 mm holes.

c. Use the cabinet door boring machine **HRBORE220SP** (sold separately) to bore the holes.

HRBORE220SP  
Hinge Boring  
Machine



Learn more about our Hinge Boring Machine.

Scan QR to view the video.

<https://delivr.com/2x3gu>



## 2. Install hinges to door.

a. For hinges with press-in dowels: Use **LARM7390** (sold separately) for pressing 9390 and 8390 series.

b. For hinges with no press-in dowels: Use 1 ea #7 X 5/8" flat head screw **7X580** to attach each hinge to the cabinet.

For hinges with press-in dowels:

LARM7390  
Insertion Ram



For hinges with no press-in dowels:

7X580  
#7 x 5/8" flat head screw

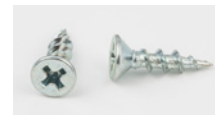

# Installation Instructions for Compact Hinges 9390 & 8390 Series

## 3. Install hinges to cabinet.

a. Use 1 ea #7 X 5/8" pan washer head screw **7X0580WCQ** to attach each hinge to the cabinet.

*\*NOTE: For face frame material greater than 3/4" thickness, special 2-cleat hinges are available in select overlays.*



**7X0580WCQ**

#7 X 5/8" pan washer head screw



\*2-Cleat Hinge

## 4. Adjust the hinge(s) as needed.

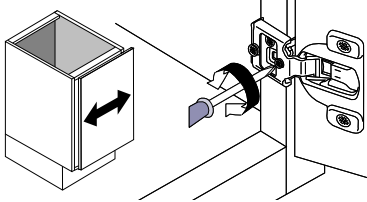
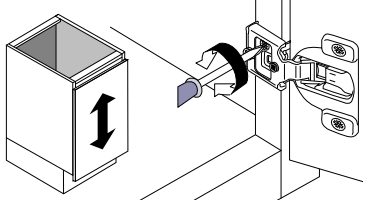
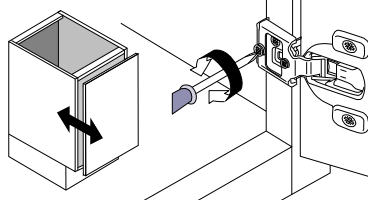
Horizontal adjustment	Vertical adjustment	Depth adjustment
Rotate front screw to increase or decrease door overlay.	Rotate center cam screw to adjust door position.	Rotate rear cam screw to adjust door position.
		

## 5. Install 85° restrictor clips as needed.

a. Align the restrictor clip **9390.RC** to the rear of the hinge cup and press in gently.



**9390.RC**

85° Restrictor Clip



Scan QR to view compact hinge restrictor clip video.

<https://delivr.com/2vmc9>

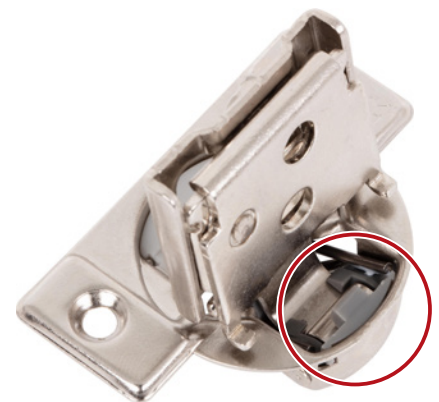
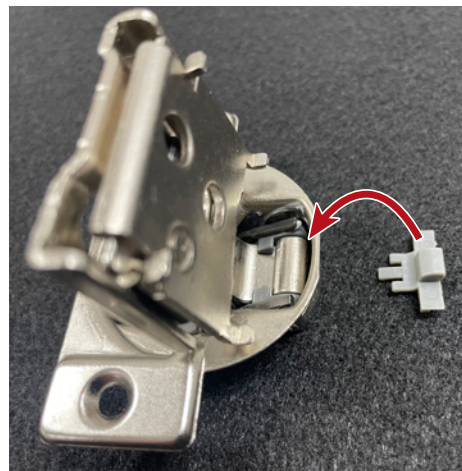

b. Cycle the hinge 3 times to ensure the clip is properly seated and the hinge opening is now limited to 85°.