



Text 1-812-652-2525
(US and Canada only, carrier fees may apply)



Visit www.maxicosi.com



Call 1-800-544-1108



Email support@djgusa.com



Learn More

©2025 Dorel Juvenile Group, Inc. (800) 951-4113 www.maxicosi.com. Styles, colors, and labeling may vary. Made in China. Distributed by Dorel Juvenile Group, Inc., 2525 State St., Columbus, IN 47201-7494. Dorel Juvenile Canada, 2233 Argentinia Road, Suite 110, Mississauga, ON L5N 2X7. Representante exclusivo en Chile: DOREL JUVENILE CHILE S.A. Av. del Parque 4161, oficina 602 A, Huechuraba, Santiago, Chile - Fono: 56 2 24971500 - www.infanti.cl - www.dorel.cl. Importado y distribuido en Perú por: COMEXA COMERCIALIZADORA EXTRANJERA S.A. SUCURSAL DEL PERÚ - Los Libertadores 455, San Isidro, Lima 27, Lima, Perú RUC 20431062870 - Fono: 4413029 - www.infanti.com.pe. En Centro América, Caribe y Ecuador por: Best Brands Group S.A. - Av. Balboa, Bay Mall Plaza, Planta Baja, local 9, Panamá. - Fono: (507) 300 2884. En Colombia por: Baby Universe S.A.S. - Vía 40 No. 77-29, Barranquilla, Colombia - Fono: (575) 353 1110. Importador: DJGM, S.A. DE C.V. Gabriel Mancera No. 1041 Col. Del Valle, Benito Juárez C.P. 03100 México, Ciudad de México R.F.C. DJG140305GN9 Tel. (55) 67199202



MAXI-COSI®

Tanza

Belt-Positioning Booster Car Seat

Your model may look different than one shown.

Read all instructions before using this booster seat.
KEEP INSTRUCTIONS FOR FUTURE USE.

⚠ Failure to follow the warnings on the labels and in the instruction manual can result in serious injury or death to your child. Serious injury may include paralysis and/or permanent brain injury.



4358-8678 04.10.25



Table of Contents

Getting Started.....	3	Cleaning the Seat Pad Set, Storage Bag, and Booster Seat.....	22
Parts of the Booster Seat.....	4	Installing the Seat Pad Set.....	23
Accessory Use.....	6	Safety Information.....	25
Booster Seat Requirements	7	LATCH Lower Anchor Bars and Vehicle Belt Information.....	26
Unfolding the Booster Seat.....	8	Child Restraint Use.....	28
Adjusting the Headrest.....	9	Vehicle Seating Position	29
Booster Seat Mode	10	Installation in Vehicle.....	30
Booster Seat Child Fit Requirements.....	12	Replacement and Expiration.....	31
Booster Seat Use in Vehicle.....	13	Registration and Safety Notices	32
Folding the Booster Seat.....	18	Warranty	33
Wash and Care.....	19	Replacement Parts List.....	35
Removing the Seat Pad Set for Cleaning.....	20		

Getting Started

To help you get started using your child's new booster seat (also known as a car seat or a child restraint), these are the four main tasks you'll need to complete.

1

Measure
Your Child

2

Unfold the
Booster Seat

3

Install the
Booster Seat in
Your Vehicle

4

Make Any
Adjustments
to Properly Fit
Your Child and
Buckle Up

Parts of the Booster Seat

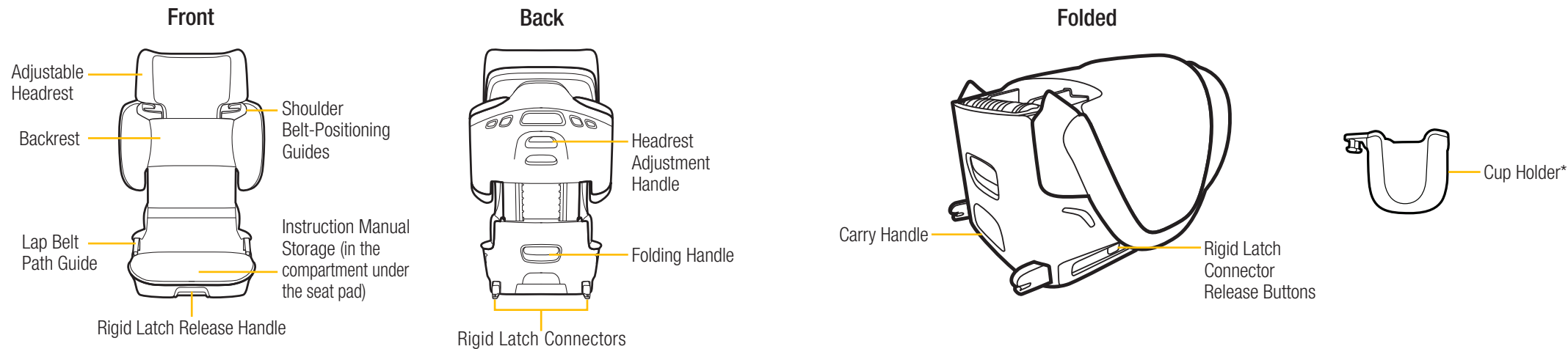

Your model may look different than one shown.

*See page 6 for accessory use.

Accessory Use

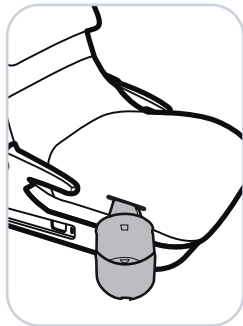

Removable Cup Holder

To install the cup holder: Insert the cup holder posts into the two holes through the slot in the seat pad and slide the cup holder into place.

To remove the cup holder: Slide the cup holder posts out of the holes in the seat pad and lift the cup holder out.



Storage Bag

Use the storage bag to carry and store the folded booster seat. Unzip the bag, place the folded booster seat in the bag, and then zip it to carry it.

⚠ WARNING

Failure to follow these instructions may result in serious injury or death to your child. Serious injury can include paralysis and/or permanent brain injury.

Be certain to measure your child's weight and height (do not guess) before using this car seat.

Your child's height, weight, and age determine how a car seat should be placed in the vehicle.

Children vary widely in body size, shape, and temperament—**please consult your doctor before switching between any modes within the limits and fit requirements of the car seat.**

Booster Seat Requirements

BOOSTER SEAT MODE

**40–100 lb (18.1–45.4 kg) and
43.4–57 in. (110.1–144.8 cm)**

In this car seat, your child can remain in the **Booster Seat** until they fit the vehicle's lap and shoulder seat belt properly without a **Booster Seat** OR outgrow any one of the above.

**Booster Seat Child Fit
Requirements PAGE 12**



School-Aged Children

Children can only use a belt-positioning booster car seat once they outgrow forward-facing harness weight or height limits. Children must use the belt-positioning booster mode until the vehicle's lap and shoulder seat belt fit them properly without the belt-positioning booster.

Unfolding the Booster Seat

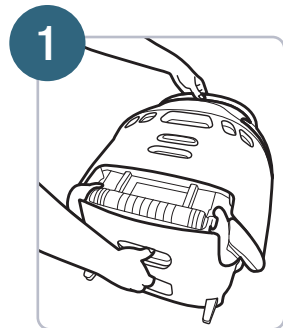

Press the folding handle and start lifting the backrest up.

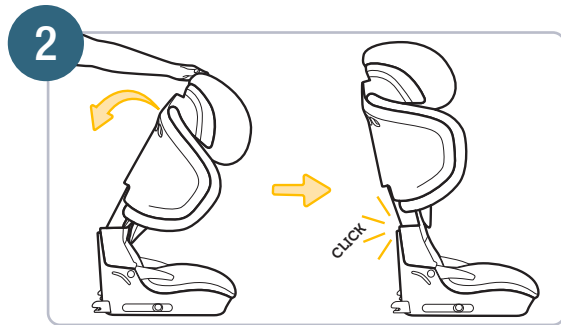

Continue to lift the backrest all the way up until it clicks into the upright position.

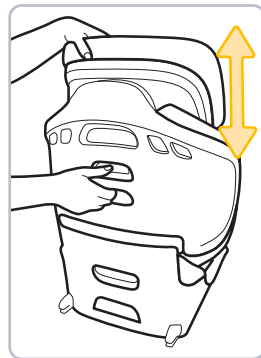

Press the headrest adjustment handle while pulling up or pushing down the headrest to raise or lower it to the desired position.

Adjusting the Headrest

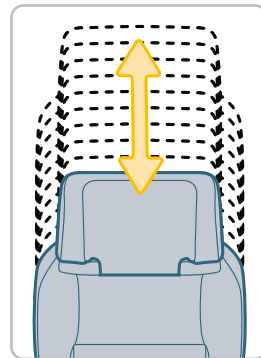

The headrest has ten height positions. Choose the one that meets the fit requirements on page 12.

Booster Seat Mode

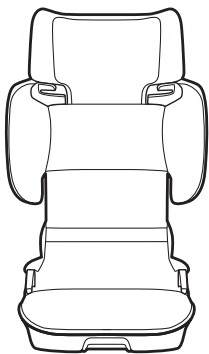

40–100 lb (18.1–45.4 kg) **and**
43.4–57 in. (110.1–144.8 cm)

In this car seat, your child can remain in the **Booster Seat** until they fit the vehicle's lap and shoulder seat belt properly without a **Booster Seat** **OR** outgrow any one of the following:

- Weight limit: 100 lb (45.4 kg); **OR**
- Height limit: 57 in. (144.8 cm); **OR**
- **Booster Seat Child Fit Requirements**
PAGE 12

Booster Seat Use in Vehicle **PAGE 13**

⚠ WARNING

Warning! Use only the vehicle's lap and shoulder belt system when restraining the child in this booster seat.



DO NOT use only the lap belt when using this seat as a booster seat. The shoulder belt **MUST** always be adjusted snugly across the child's chest.



NEVER place shoulder belt under the child's arms or behind their back.



DO NOT use this booster seat if the top of your child's ears are above the top of the booster seat's headrest.

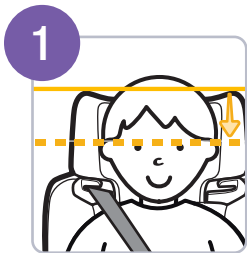

Check the head position

The top of your child's ears should **NEVER be above** the top of the booster seat's headrest. Adjust the headrest if needed (see page 9).



Check the vehicle position

DO NOT use the booster seat if your child's head is less than 5 in. (12.7 cm) below the roof of the vehicle.



Check the shoulder belt position

The shoulder belt should lay snugly across the center of your child's shoulder and across their chest.

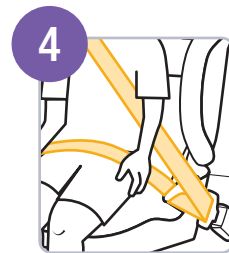

Check the lap belt position

The lap belt should lay snugly across your child's hips, **NOT on their stomach.**



Before you begin:

- Review your vehicle owner's manual to locate the LATCH: lower anchor seating positions.
- Determine whether you will be using both the rigid LATCH connectors and the lap/shoulder belt or only the lap/shoulder belt with the booster seat. See also LATCH Lower Anchor Bars and Vehicle Belt Information on page 26.

⚠ WARNING

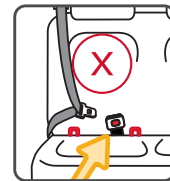

DO NOT use the LATCH system if the seat belt or seat belt buckle is not easily accessible with the booster seat secured to the anchors.

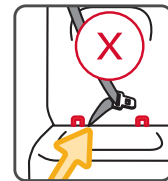

DO NOT use the LATCH system if the seat belt or seat belt buckle is between the LATCH anchors.



DO NOT use the LATCH system if the LATCH anchor bars are above the seat bight.

1

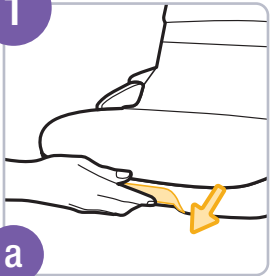

a

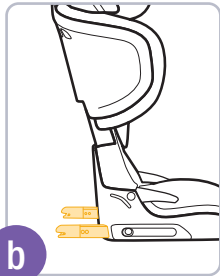

b

Extend the rigid LATCH connectors

Skip to step 2 if you are not using rigid LATCH connectors.

- a. Pull the rigid latch handle at the front of the booster seat.
- b. Both rigid latches will automatically extend from the bottom rear of the seat.

2



Place the booster seat forward facing in the vehicle

The back of the booster seat should be flat against the vehicle seatback. The vehicle seatback **MUST** be in the upright position, but you can adjust the angle slightly to better match the angle of the booster seat. Refer to the vehicle owner's manual for how to adjust the vehicle seatback.

i

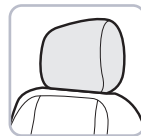

If your vehicle has a headrest that interferes with a flush booster seat fit, refer to your vehicle owner's manual to check whether it can be removed or adjusted, or if there are other seating locations to install the booster seat.

3

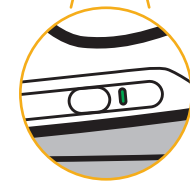

Attach the rigid LATCH connectors to the vehicle lower anchors

Skip to step 4 if you are not using rigid LATCH connectors.

- a. Align the connectors with the lower anchors. Push the booster seat towards the back of the vehicle seat while holding the rigid latch connector release buttons until both connectors are attached to the anchors. Once the connectors are attached, release the buttons and continue pushing the booster seat towards the vehicle seat and the connectors will ratchet into the booster seat as you push it into the seat cushions.
- b. Verify the booster seat is securely attached to the lower anchors by checking for the green indicators next to both rigid LATCH connector release buttons **AND** by pulling the booster seat away from the vehicle seatback.

If the green does not appear next to either button or the connectors are not properly connected to the lower anchors when you pull the booster seat away from the vehicle seatback, then make sure the connectors are fully extended. Push the booster seat back further against the vehicle seatback or repeat steps 1–3.

4



Have your child sit in the booster seat

The top of your child's ears should never be above the top of the booster seat's headrest. **DO NOT** use the booster seat if your child's head is less than 5 in. (12 cm) below the roof of the car. To adjust the headrest, see page 9.

5



Position the lap belt on your child

Route the lap belt portion of the vehicle belt under the lap belt path guide. The shoulder belt **MUST GO OVER** the lap belt path guide on the vehicle buckle side. The lap belt should lay snugly across your child's hips, not on their stomach.

6

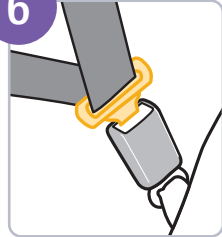

Buckle the vehicle belt

Pull the shoulder belt up to tighten it. Consult your vehicle owner's manual for proper seat belt usage.

7

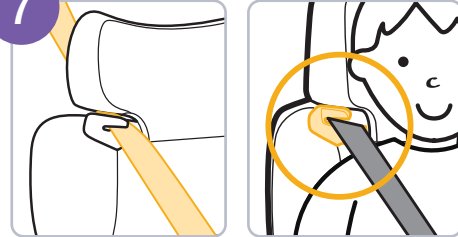

Position the shoulder belt on your child

Thread the shoulder belt through the belt-positioning guide in the headrest. Pull the shoulder belt up to tighten it so that it lies snugly across the center of your child's shoulder and across their chest, not on their face and neck.

FINISHED!

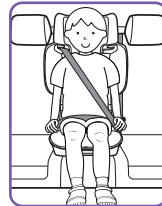

Check periodically to make sure your child has not moved out of position and loosened the shoulder belt.

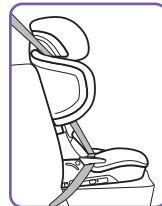

If you are not using the rigid LATCH connectors, keep the booster seat securely belted and buckled even when unoccupied.

Folding the Booster Seat



Before folding the booster seat, use the rigid LATCH release buttons to retract both connectors and remove them from the lower anchors. See page 27.

Remove the cup holder before folding the booster seat. See page 3.

To ensure the booster seat is as compact as possible when folded, move the headrest to the third to lowest position. See page 9.

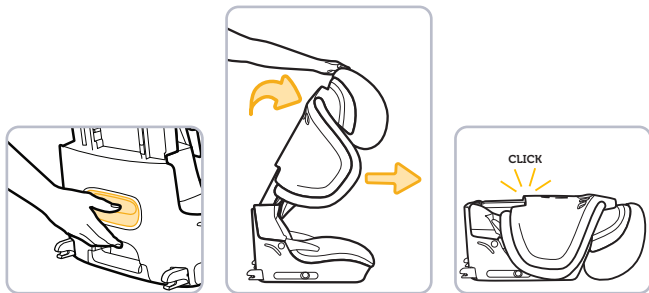

Press the folding handle and push the backrest all the way down until it clicks and is completely folded in half.

Wash and Care

Removing the Seat Pad Set for Cleaning	20
Cleaning the Seat Pad Set, Storage Bag, and Booster Seat.....	22
Installing the Seat Pad Set	23

Removing the Seat Pad Set for Cleaning



Make sure the booster seat is unfolded when removing the seat pad set. See page 8.

You may need to raise or lower the headrest for easier seat pad set removal. See page 9.

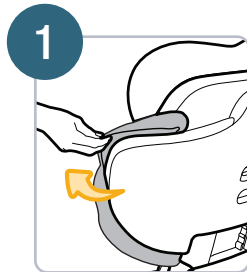

1 Gently pull the top of the pad away from the side wing.

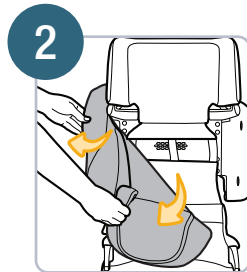

2 Continue to pull the pad off the wing and away from the seat while gently pulling the remainder of the backrest pad off the other wing until it is completely off the seat.

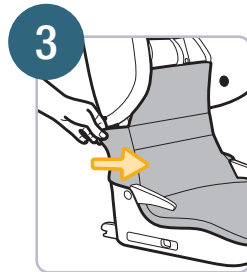

3 Gently pull the side of the seat pad below the wing away from the booster seat.



4 Gently pull the seat pad from the sides and front of the booster seat bottom.



5 Pull to separate the hook and loop fastening strip under the seat pad.



6 From the back of the seat, pull the seat pad off the headrest.

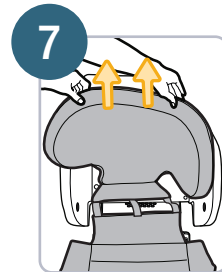

7 Lift the seat pad up and off the booster seat.

Cleaning the Seat Pad Set, Storage Bag, and Booster Seat

To clean the seat pad set and storage bag:

Machine wash separately with cold water on gentle cycle. **DO NOT** use bleach. Tumble dry separately for 10–12 minutes on low heat. Remove immediately.

To clean the booster seat:

Spot clean using warm sudsy water and a damp cloth. **DO NOT** submerge any part of the seat into water.



You may need to raise or lower the headrest for easier installation of the seat pad set. See *Adjusting the Headrest* on page 9.

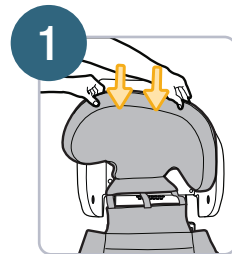

From the front of the booster seat, pull the seat pad onto the seat starting with the headrest.

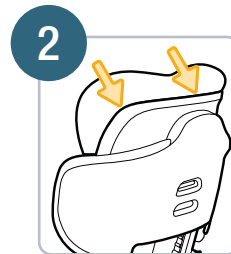

Tuck the pad in completely around the edges of the headrest.

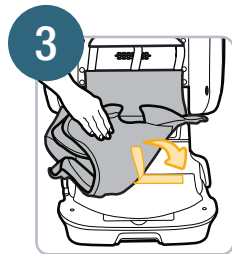

Reattach the hook and loop fastening strip under the seat pad.

Installing the Seat Pad Set



Pull the seat pad over the front of the seat. Tuck the pad completely around all edges. Make sure the side of the pads below the wings are also fully secured.

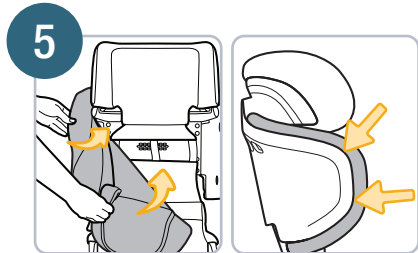

Place the backrest pad over both wings. Starting at the top of the wings and continuing around the bottom, tuck the pad completely around all edges making sure all sides of the wing pads are fully secured.

WARNING

DO NOT use the child restraint without the seat pad. Failure to do this can result in serious injury. Serious injury can include paralysis and/or permanent brain injury.

Safety Information

LATCH Lower Anchor Bars and Vehicle Belt Information	26
Child Restraint Use.....	28
Vehicle Seating Position	29
Installation in Vehicle.....	30
Replacement and Expiration	31
Registration and Safety Notices	32
Warranty	33
Replacement Parts List.....	35

LATCH Lower Anchor Bars and Vehicle Belt Information

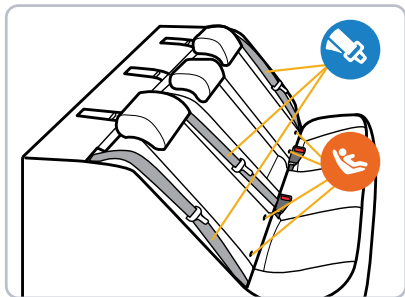

Your vehicle's features may be considerably different than those pictured here.

The lower anchors of **LATCH** (Lower Anchors and Tethers for **CH**ildren) is a universal system for installing car seats without using vehicle seat belts. The rigid LATCH connectors can **ONLY** be used in vehicles that have the lower anchor bars installed in designated seating positions. Most vehicles manufactured after September 2022 are equipped with LATCH: lower anchor bars. Check your vehicle owner's manual to see which seating positions may be equipped with LATCH: lower anchor bars. Rigid LATCH connectors cannot be used with raised LATCH anchors in the vehicle seatback.



You **MUST** review your vehicle owner's manual.

Check your vehicle owner's manual to determine the vehicle belt and seating positions available for installing a booster seat and which seating positions may be equipped with LATCH: lower anchor bars.

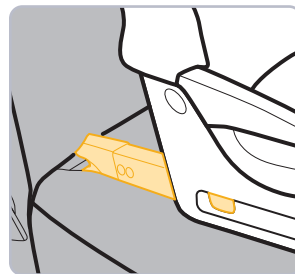

To use the rigid LATCH connectors, see page 14.

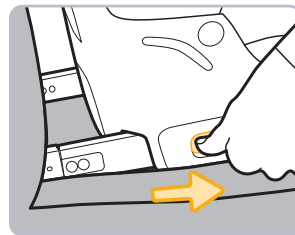

To remove the rigid LATCH connectors from the vehicle anchors: Press in the rigid LATCH connector release button and slide it towards the front of the seat to retract the connector. Repeat on the other side.



NEVER use the following with this car seat:

- Emergency locking retractor lap-only belt
- Inflatable seat belts

Child Restraint Use



This restraint is not certified for aircraft use because aircraft seats do not have shoulder belts.

WARNING

NEVER take your child out of the child restraint while the vehicle is moving.

NEVER leave your child unattended.

Placing your child in a hot child restraint may result in burns.

DO NOT use a child restraint with damaged or missing parts.

DO NOT substitute parts or try to modify the child restraint in any way.

DO NOT use any child restraint accessory except those approved by Dorel Juvenile Group.

NEVER allow any child to play with this child restraint; it is not a toy.

DO NOT remove or cover up any of the warning labels on the child restraint.

This child restraint has been certified for use in passenger vehicles.

DO NOT use in a boat, on a motorcycle, or in a cargo van or bus where there are no seat belts.

DO NOT use in a boat, on a motorcycle, or in a cargo van or bus where there are no seat belts.

DO NOT use in a boat, on a motorcycle, or in a cargo van or bus where there are no seat belts.

Read all instructions for additional warnings.

Vehicle Seating Position



According to accident statistics, children are safer when properly restrained in the rear seating positions than in the front seating positions.

Rear seating positions are statistically safer, whether you have air bags, advanced air bags, or no air bags at all.

If you are not sure where to place the car seat in your vehicle:

- Consult your vehicle owner's manual; **OR**
- Contact Dorel Juvenile Group Consumer Care Department; **OR**
- Visit your local Child Passenger Inspection Station. Go to <https://www.nhtsa.gov/vehicle-safety/car-seats-and-booster-seats> to find your closest station.

WARNING

Check the vehicle owner's manual for more information about air bag/child restraint use.



Use the child restraint only on vehicle seats that face forward.



DO NOT use on seats that face the sides or rear of the vehicle.

For vehicles without a back seat, refer to your vehicle owner's manual.

Installation in Vehicle

To avoid your child being seriously burned, take the following precautions:

- Park in the shade or where the sun does not directly hit the car seat.
- Cover the car seat with a sheet or blanket when not in use.
- Check for hot seat and buckles before placing child in car seat.

To help protect your vehicle seat's upholstery from damage: You may use an accessory approved by Dorel Juvenile Group or a single layer towel underneath and behind car seat.

WARNING

Check the vehicle belt before each use. Use only if the belt can be tightened properly and securely.

Even when unoccupied, this booster seat **MUST** be firmly secured to the vehicle with the vehicle seat belt.

In a crash or sudden stop, an unsecured booster seat could injure occupants.

DO NOT risk your child's safety.

To keep your child as safe as possible, Dorel Juvenile Group strongly recommends replacing the car seat even after a minor crash, even if it was not occupied at the time.

Replacement After a Minor Crash

The National Highway Traffic Safety Administration states that for a crash to be considered minor **ALL of the following MUST be true:**

- Vehicle able to drive away from the crash site; **AND**
- Vehicle door nearest the car seat was not damaged; **AND**
- No passengers were injured; **AND**
- Airbags did not deploy; **AND**
- There is no visible damage to the car seat.

If the crash your car seat was involved in meets **ALL** the criteria, you may not need to replace the car seat.

Replacement and Expiration

If one or more of these criteria are not true or if you are uncertain of any of your answers, replace the car seat immediately.

Replacement After a Moderate to Severe Crash

You **MUST** replace this car seat if it has been in a moderate to severe car crash.

This car seat is intended to protect a child in a single crash. During a crash, the car seat and all of its parts absorb crash energy which can deform or weaken it. Damage is not always visible. A damaged car seat **MUST** be replaced immediately.

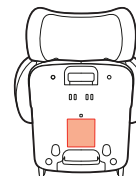

Expiration

On the bottom of the car seat, there is a date of manufacture label as shown.

DO NOT use this car seat more than 10 years after the date of manufacture.

Please complete the postage-paid registration card that came with your child restraint, and send it to us.

Child restraints could be recalled for safety reasons.

You must register this restraint to be reached in a recall.

Send your name, address, email address if available and the restraint's model number and manufacturing date to:

Dorel Juvenile Group
P.O. Box 2609
Columbus, IN 47202

or call 1-800-544-1108 or register online at www.djgusa.com/registration/carseat/us.

For recall information, call the U.S. Government's Vehicle Safety Hotline at 1-888-327-4236 (TTY: 1-800-424-9153), or go to www.NHTSA.gov.

Example of model number, manufacture date, and line code.

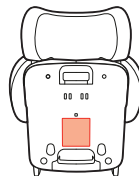

If you don't have the card or if your address changes, you will find the model number, manufacture date, and line code on the label located on the bottom of the car seat.

Dorel Juvenile Group, Inc. (DJG) warrants this product to the original retail purchaser as follows:

This product is warranted against defective materials or workmanship for one year from the date of original purchase. **An original receipt is required to validate your warranty.** DJG will, at its option, provide replacement parts or replace this product. DJG reserves the right to substitute if the part or model has been discontinued.

To make a claim under this warranty, please contact our Consumer Care Department by phone: 1-800-544-1108 or text: 1-812-652-2525. Our hours of operation are from 8:00 a.m. to 6:00 p.m. EST Monday through Thursday and from 8:00 a.m. to 4:30 p.m. on Friday.

Proof of purchase is required and shipping charges are the responsibility of the consumer.

Warranty Limitations: This warranty does not include damages which arise from misuse or abuse of this product.

Limitation of Damages: The warranty and remedies as set forth are exclusive and in lieu of all others, oral or written, expressed or implied. In no event will DJG or the dealer selling this product be liable to you for any damages, including incidental or consequential damages, arising out of the use or inability to use this product.

Limitation of warranties and other warranty terms and state law rights: Any implied warranties, including implied warranties of the merchantability and fitness for a particular purpose, shall be limited to the duration and terms of the express written warranty. Some states do not allow limitations as to how long an implied warranty lasts or the exclusion or limitation of incidental or consequential damages, so the above limitations may not apply to you.

This warranty gives you specific legal rights, and you may have other rights, which vary from state to state. Neither DJG nor the dealer selling this product authorized any person to create for it any other warranty, obligation, or liability in connection with this product.

For parts availability and questions, call, text, email, or chat. See the Consumer Care contact information on the back cover of this manual. If the requested color is not available, a similar color will be substituted. Applicable tax and shipping & handling will also be added.

- Seat Pad Set
- Storage Bag
- Cup Holder
- Instructions