

CP2000PFCRM1U
USER MANUAL

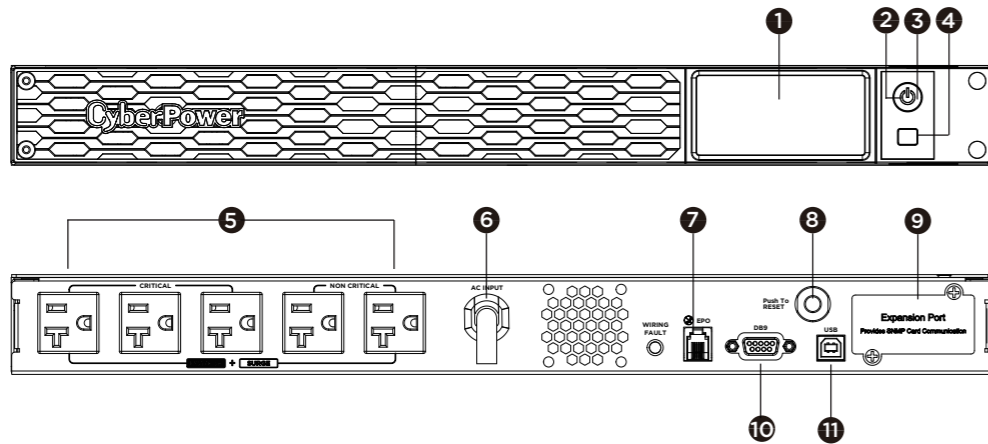

FEATURES

- 1. LCD Module Display
- 2. Power On Indicator
- 3. Power Switch
- 4. LCD Function Select Switch
- 5. Battery and Surge Protected Outlets
 - *Critical /Non-critical
- 6. AC Input (Includes L5-20R to 5-20P plug adapter)
- 7. EPO/ROO Port
- 8. Circuit Breaker
- 9. SNMP/HTTP Network Slot
- 10. DB9 port
- 11. USB Communication Port

PRODUCT REGISTRATION

Thank you for purchasing a CyberPower product. Please take a few minutes to register your product at: CyberPowerSystems.com/registration. Registration certifies your product's warranty, confirms your ownership in the event of a product loss or theft and entitles you to free technical support. Register your product now to receive the benefits of CyberPower ownership.

IMPORTANT SAFETY WARNINGS (SAVE THESE INSTRUCTIONS)

This manual contains important instructions that should be followed during installation and maintenance of the UPS and batteries. Please read and follow all instructions carefully during installation and operation of the unit. Read this manual thoroughly before attempting to unpack, install, or operate your UPS.

CAUTION! To prevent the risk of fire or electric shock, install in a temperature and humidity controlled indoor area free of conductive contaminants. (Please see specifications for acceptable temperature and humidity range.)

CAUTION! To reduce the risk of electric shock, do not remove the cover except to service the battery. Turn off and unplug the unit before servicing the batteries. There are no user serviceable parts inside except for the battery.

CAUTION! Hazardous live parts inside can be energized by the battery even when the AC input power is disconnected.

CAUTION! The UPS must be connected to an AC power outlet with fuse or circuit breaker protection. Do not plug into an outlet that is not grounded. If you need to de-energize this equipment, turn off and unplug the unit.

CAUTION! To avoid electric shock, turn off the unit and unplug it from the AC power source before installing a computer component.

CAUTION! To reduce the risk of fire, connect only to a circuit provided with 20 amperes maximum branch circuit over current protection in accordance with the National Electric Code, ANSI/NFPA 70.

CAUTION! Do not dispose of batteries in a fire. The batteries may explode.

CAUTION! Do not open or mutilate batteries. Released electrolyte is harmful to the skin and eyes. It may be toxic.

CAUTION! EPO function is provided in UPS. EPO remote switch which is Push-Back button is installed computer room outside by a phone line, and not connected any other equipment.

DO NOT USE FOR MEDICAL OR LIFE SUPPORT EQUIPMENT! CyberPower Systems does not sell products for life support or medical applications. DO NOT use in any circumstance that would affect operation and safety of life support equipment, any medical applications or patient care.

DO NOT USE WITH OR NEAR AQUARIUMS! To reduce the risk of fire or electric shock, do not use with or near an aquarium. Condensation from the aquarium can cause the unit to short out.

DO NOT USE THE UPS ON ANY TRANSPORTATION! To reduce the risk of fire or electric shock, do not use the unit on any transportation such as airplanes or ships. The effect of shock or vibration caused during transit and the damp environment can cause the unit to short out.

INSTALLING YOUR UPS SYSTEM

UNPACKING
Inspect the UPS upon receipt. The box should contain the following:

- (a) UPS
 - (b) User's manual
 - (c) USB A+B type cable
 - (d) Function setup guide
 - (e) Rail kit
 - (f) Rack mount brackets
 - (g) Emergency power off cable (gray)
 - (h) L5-20R to 5-20P adapter
- *PowerPanel® software is available on our website. Please visit www.CyberPowerSystems.com and go to the Software Section for free download.**

SUPPORTS ACTIVE PFC POWER SUPPLIES

This CyberPower UPS system supports High Efficiency power supplies with Active Power Factor Correction (Active PFC). Active PFC is used to improve the efficiency of power delivery. The current US Energy Star® Program Requirements for Computers (version 7.1) mandates Active PFC for all power supplies over 100 watts. Additionally, programs such as 80 Plus® are often used to identify high efficiency power supplies with Active PFC.

OVERVIEW

The CP2000PFCRM1U provides complete power protection from utility power that is not always consistent and features 1050 Joules of surge protection. All units provide long lasting

battery backup during power outages with maintenance free batteries. The CP2000PFCRM1U ensures consistent power to your computer system and includes software that will automatically save your open files and shutdown your computer system during a utility power loss.

AUTOMATIC VOLTAGE REGULATOR

The CP2000PFCRM1U uses Automatic Voltage Regulation (AVR) to stabilize inconsistent utility power voltage to levels that are safe for connected equipment. AVR safeguards hardware and important data files by automatically increasing low utility power to a consistent and safe output voltage while preserving battery power for outages.

DETERMINE THE POWER REQUIREMENTS OF YOUR EQUIPMENT

1. Ensure that the equipment plugged into the UPS does not exceed the UPS unit's rated capacity. If the rated capacities of the unit are exceeded, an overload condition may occur and cause the UPS unit to shut down or the circuit breaker to trip.
2. There are many factors that can affect the amount of power that your electronic equipment will require. For optimal system performance keep the load below 80% of the unit's rated capacity.

INSTALLING YOUR UPS SYSTEM - Continued
HARDWARE INSTALLATION GUIDE

1. Your new UPS may be used immediately upon receipt. However, after receiving a new UPS, to ensure the battery's maximum charge capacity, it is recommended that you charge the battery for at least 8 hours. Your UPS is equipped with an auto-charge feature. When the UPS is plugged into an AC outlet, the battery will automatically charge whether the UPS is turned on or off.
Note: This UPS is designed with a safety feature to keep the system from being turned on during shipment. The first time you turn the UPS on, you will need to have it connected to AC power or it will not power up.
2. With the UPS unit turned off and unplugged, connect your computer, monitor, and any other peripherals requiring battery backup into the battery power supplied outlets. Plug the other peripheral equipment (eg. printer, scanner, speakers, etc.) into the full time surge protection outlets. **DO NOT plug a laser printer, paper shredder, copier, space heater, vacuum, sump pump or other high-power electrical devices into this UPS. The power demands of these devices may overload and damage the UPS.**
3. Plug the UPS directly into a 2-pole, 3-wire grounded receptacle (wall outlet). Make sure the wall branch outlet is protected by a fuse or circuit breaker and does not service equipment with large electrical demands (e.g., air conditioner, copier, etc.). The warranty prohibits the use of extension cords, outlet strips, and surge strips in conjunction with the UPS unit.
4. Press the power switch to turn the unit on. The Power On indicator light will illuminate and the unit will "beep". If an overload is detected, an audible alarm will sound and the unit will emit one long beep. To correct this, turn the UPS off and unplug at least one piece of equipment from the battery power supplied outlets. Make sure the circuit breaker is depressed and then turn the UPS on.
5. To maintain optimal battery charge, leave the UPS plugged into an AC outlet at all times.
6. To store the UPS for an extended period, cover it and store with the battery fully charged. While in storage, recharge the battery every three months to ensure battery life.
7. Ensure the wall outlet and UPS are located near the equipment being attached for proper accessibility.

BASIC OPERATION

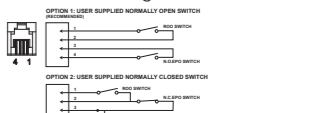
1. **LCD Module Display:** LCD Screen shows all the UPS information such as icons and messages.
2. **Power On Indicator:** Indicates the power is on.
3. **Power Switch:** Master on/off switch for equipment connected to the battery power supplied outlets.
4. **LCD Function Select Switch:** The switch can be used to select the LCD display contents, including input/output voltage and estimated run time, etc.
5. **Battery and Surge Protected Outlets:** The unit has five battery powered and surge protected outlets to ensure temporary uninterrupted operation of your equipment during a power failure. Critical /Non-critical: It is possible to program the unit in a way so that the outlet block marked as "non-Critical", (black outlets), will stop the provision of power to connected equipment after a certain period of time, thus making more runtime available for the equipment connected on the outlets marked as "Critical", (gray outlets). In other words, the user can establish runtime priority for certain connected equipment, maximizing its "availability" during a prolonged power outage. This type of control takes place with the use of the provided PowerPanel® Business software.
6. **AC Input:** Connect the AC Power cord to a properly wired and grounded outlet.
7. **EPO (Emergency Power Off) / ROO (Remote On/Off) Port:** The EPO/ROO interface is an IEC 60950 safety extra low voltage (SELV) circuit. This circuit must be separated from hazardous voltage circuits by reinforced insulation. Follow the appropriate circuit diagram below to wire the provided gray EPO cable to your EPO/ROO configuration. Connect isolated dry contacts (rated to handle 60Vdc, 30Vac RMS and 20mA maximum) and use ONLY latching switch.

8. **Circuit Breaker:** Located on the back of the UPS, the circuit breaker provides overload and fault protection.
9. **SNMP/HTTP Network Slot:** Remove the cover panel to install an optional RMCARD provides remote monitoring and management of your UPS over a network.
10. **DB9 Port:** This port is used for connecting between the UPS and equipment designed to operate with contact signals.
11. **USB Communication Port:** Allows communication between the USB port on the computer and the UPS unit.

RACK INSTALLATION (OPTION)

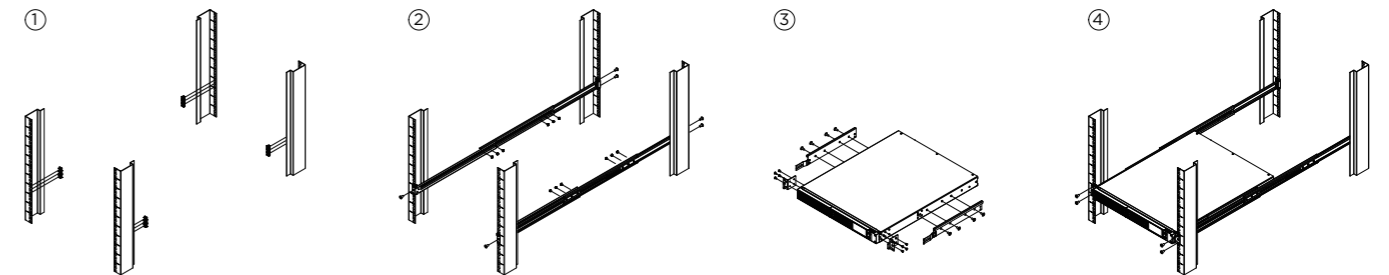
1. Insert the cage nuts into the rack's mounting holes.
2. Attach the hanging rails to the rack using the provided M5 bi-head screws. Secure the front and rear ends of the sliding rails to the rack with the provided M4 binding washer head screws.
3. Use the provided M4 flat head screws to attach the brackets and provided M5 bi-head screws for hanging brackets.
4. Lift the product upon the hanging rails and slide the unit into the rack. Affix the product to the rack with provided M5 bi-head screws.



REPLACING THE BATTERY

Read and follow the important safety instructions before servicing the batteries. Visit CyberPower official website www.cyberpowersystems.com or contact your dealer for more information about replacement batteries.

CAUTION! When replacing batteries, replace with the same number of the following battery: CyberPower / RB0690X6A
*See your dealer for replacement batteries.

CAUTION! Risk of Energy Hazard, 36V, maximum 9 Ampere-hour battery. Before replacing batteries, remove conductive jewelry such as chains, wrist watches, and rings. High energy conducted through these materials could cause severe burns.

CAUTION! The battery may present the risk of electrical shock. Do not dispose of batteries in a fire, the batteries may explode. Follow all local ordinances regarding proper disposal of batteries.

CAUTION! Do not open or mutilate batteries. Released material is harmful to the skin and eyes. It may be toxic.

CAUTION! A battery can present a risk of electrical shock and high short circuit current. The following precautions should be observed when working on batteries:
1) Remove watches rings, or other metal objects.
2) Use tools with insulated handles.

CAUTION - RISK OF EXPLOSION IF BATTERY IS REPLACED BY AN INCORRECT TYPE.

REMEMBER: Batteries are considered HAZARDOUS WASTE and must be disposed of properly. Most retailers that sell lead acid batteries collect used batteries for recycling, as required by local regulations.

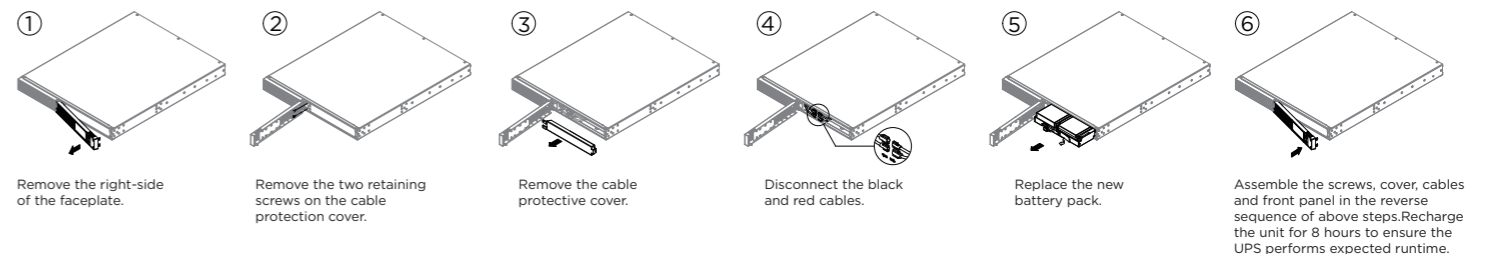

DEFINITIONS FOR ILLUMINATED LCD INDICATORS

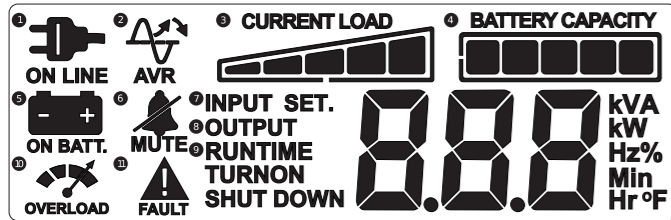

- ON LINE Icon:** This icon illuminates when the UPS is working under normal conditions.
- AVR (Automatic Voltage Regulation) Icon:** This icon appears whenever your UPS is automatically correcting low AC line voltage without using battery power. This is a normal, automatic operation of your UPS, and no action is required on your part.
- CURRENT LOAD Icon:** LOAD capacity: This meter displays the approximate output load level (in 20% increments) of the UPS battery outlets. Sensitivity setup: This meter is also used to setup the UPS sensitivity when you are in the programming mode. If the connected equipment can tolerate more power events (example: unstable power often associated with stormy weather), select Low Sensitivity and the UPS will go to Battery Mode less often. If the connected equipment is more sensitive to power events, select High Sensitivity and the UPS will go to Battery Mode more often.
- BATTERY CAPACITY Icon:** This meter displays the approximate charge level (in 20% increments) of the UPS's internal battery. During a blackout or severe brownout, the UPS switches to battery power, and the charge level will decrease.
- ON BATT Icon:** This icon will appear followed by an alarm (two short beeps) when there is a utility power loss, indicating that the UPS is now working using its internal batteries. Once the batteries are running out of power (over a period of time), the alarm will beep rapidly every 1/2 second. If this happens and main power has not been restored, it is recommended that you save your files and turn off your equipment manually as soon as possible.
NOTE: If the ON BATT icon flashes, and the ON LINE icon appear simultaneously, this indicates that the batteries are not connected properly or that the batteries are worn out.
- MUTE Icon:** This icon appears when the UPS is in silent mode. However, when there is a problem with the UPS, the alarm will still beep even in silent mode.

- Input Voltage Meter:** This meter measures the AC voltage from the wall outlet. The INPUT voltage readout is used to identify the input voltage information. This can be used as a diagnostic tool to identify the quality of input power.
- Output Voltage Meter:** This meter measures, in real time, the AC voltage that the UPS is providing to your connected equipment via the UPS outlets.
- ESTIMATED RUNTIME:** This displays the runtime estimate of the UPS with current battery capacity and load.
- OVERLOAD Icon:** This icon will appear followed by an alarm, indicating that an overload condition has been reached. To recover from the overload condition, unplug equipment from the UPS outlets until the icon disappears and the alarm stops.
- FAULT Icon:** This icon appears if there is a problem with the UPS. Press the POWER button to turn the UPS off.
E02: Charger Fault-No Charge (Contact CyberPower Systems for support.)
E11: Battery Overvoltage (Contact CyberPower Systems for support.)
E21: Output Short (Check the status of equipment connected to the UPS and then turn on the UPS again.)
E22: Overload (Unplug at least one piece of equipment from battery outlets and turn the UPS on again.)
E25: EPO (Check the EPO connector status.)

For more information about functions setup, please refer to the Function Setup Guide.

TECHNICAL SPECIFICATIONS

Model	CP2000PFCRM1U
Capacity	2000VA / 1200W
Nominal Input Voltage	120Vac
Input Frequency	60Hz +/- 3Hz
On-Battery Output Voltage	120Vac +/- 5% <small>*Under a test load of less than 60%. When the load exceeds 60%, the output voltage range may exceed 5%.</small>
AVR Function	Yes
On-Battery Output Wave Form	Sinewave
Operating Temperature	+ 32°F to 104° F / 0° C to 40° C
Operating Relative Humidity	0 to 95% non-condensing
Operating Elevation	0 - 9,843 feet / 0 - 3,000 meters
Size (W x H x D)	17.05 x 1.73 x 21.81 in. / 433 x 44 x 554 mm.
Weight	54 lbs / 24.5 kg
Battery Type	Sealed Maintenance Free Lead Acid Battery
Typical Battery Recharge Time	8 hours <small>*Recover to 90% after full load discharge.</small>
Typical Battery Life	3 to 5 years, depending on number of discharge/recharge cycles
Replacement Battery	RBO690X6A
Safety Approvals	UL1778 / CSA C22.2 No 107.3 / FCC / ICES-003 Class A

TROUBLESHOOTING

Problem	Possible Cause	Solution
Circuit breaker button is projecting from the back of the unit.	Circuit breaker has been tripped due to an overload.	Turn the UPS off and unplug at least one piece of equipment. Wait 10 seconds, reset the circuit breaker by pressing the button, and then turn the UPS on.
The UPS does not perform expected runtime.	Battery not fully charged.	Recharge the battery by leaving the UPS plugged in.
	Battery is degraded.	Contact CyberPower Systems about replacement batteries at: cyberpowersystems.com/support .
The UPS will not turn on.	The on/off switch is designed to prevent damage from rapidly turning it off and on.	Turn the UPS off. Wait 10 seconds and then turn the UPS on.
	The unit is not connected to an AC outlet.	The unit must be connected to a 120V 60Hz outlet.
	The battery is worn out.	Contact CyberPower Systems about replacement batteries at: cyberpowersystems.com/support .
PowerPanel® is inactive (all icons are gray).	Mechanical problem.	Contact CyberPower Systems at: cyberpowersystems.com/support .
	The USB cable is not connected.	Connect the USB cable to the UPS unit and an open USB port on the back of the computer. You must use the cable that came with the unit.
	The USB cable is connected to the wrong port.	Check the back of the computer for an additional USB port. Move the cable to this port.

Additional troubleshooting information can be found under "Support" at www.CyberPowerSystems.com

SYSTEM FUNCTION BLOCK DIAGRAM

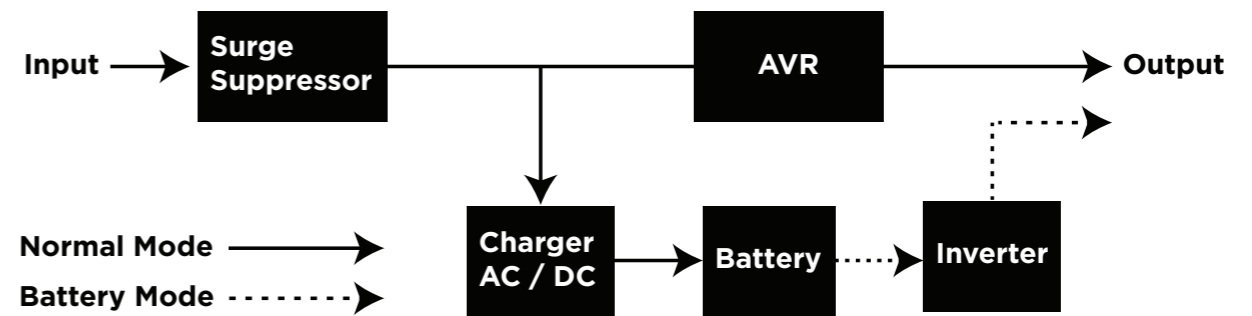

CYBERPOWER GREENPOWER UPS™ TECHNOLOGY

Advanced Energy-Saving Patented Bypass Technology

CyberPower's patented GreenPower UPS™ with Bypass Technology reduces UPS energy costs by up to 75% compared to conventional UPS models. Even when utility power is normal, conventional UPS models constantly pass power through a transformer. By contrast, under normal conditions the advanced circuitry of a GreenPower UPS™ bypasses the transformer. As a result, the power efficiency is significantly increased while decreasing waste heat, using less energy, and reducing energy costs. When an abnormal power condition occurs, the GreenPower UPS™ automatically runs power through its transformer to regulate voltage and provide "safe" power. Since utility power is normal over 88% of the time, the GreenPower UPS™ operates primarily in its efficient bypass mode. The GreenPower UPS™ is also manufactured in accordance with the Restriction on Hazardous Substances (RoHS) directive making it one of the most environmentally-friendly on the market today.



FCC COMPLIANCE STATEMENT

This device complies with part 15 of the FCC rules. Operation is subject to the following two conditions: (1) this device may not cause harmful interference, and (2) this device must accept any interference received, including interference that may cause undesired operation.



Note: This equipment has been tested and found to comply with the limits for a Class A digital device, pursuant to part 15 of the FCC Rules. These limits are designed to provide reasonable protection against harmful interference when the equipment is operated in a commercial environment. This equipment generates, uses, and can radiate radio frequency energy and, if not installed and used in accordance with the instruction manual, may cause harmful interference to radio communications. Operation of this equipment in a residential area is likely to cause harmful interference in which case the user will be required to correct the interference at his own expense.

Important: Changes or modifications not expressly approved by the party responsible for compliance could void the user's authority to operate the equipment.

Canadian Compliance Statement - CAN ICES-003 (A) / NMB-003 (A)

LIMITED WARRANTY AND CONNECTED EQUIPMENT GUARANTEE

Please visit www.CyberPowerSystems.com for a copy of the Limited Warranty and Connected Equipment Guarantee.

Where Can I Get More Information?

The application of the United Nations Convention of Contracts for the International Sale of Goods is expressly excluded. CyberPower is the warrantor under this Limited Warranty. For further information please feel free to contact CyberPower at: Cyber Power Systems (USA), Inc. 4241 12th Ave E., STE 400, Shakopee, MN 55379; call us at (877) 297-6937; or submit a web ticket online at cyberpowersystems.com/support.

DISPOSAL

Cyber Power Systems (USA), Inc. encourages environmentally sound methods for disposal and recycling of its UPS products. Please dispose and/or recycle your UPS and batteries in accordance to the local regulations of your state.



The Waste Electrical and Electronic Equipment (WEEE) Directive aims to contribute to sustainable production and consumption by contributing to the efficient use of resources and the retrieval of secondary raw materials through re-use, recycling, and other forms of recovery. The symbol on this product and/or its packaging indicates that the product must be disposed of separately from ordinary household wastes at its end of life. Contact your related WEEE management authority, local office, or your household waste disposal service about information on the recycling drop off site.

BATTERY DISPOSAL

This product contains non-spillable lead acid batteries. The used batteries are considered hazardous waste and must be disposed through recycling. Do not dispose of used batteries with your ordinary household wastes. Dispose of the batteries according to local regulations. Note: Most retailers that sell lead-acid batteries collect used batteries for recycling, as required by local regulations.



⚠WARNING: This product can expose you to chemicals including Styrene, which is known to the State of California to cause cancer, and Bisphenol A (BPA), which is known to the State of California to cause birth defects or other reproductive harm. For more information, go to www.P65Warnings.ca.gov.

© 2026 Cyber Power Systems (USA), Inc. CyberPower®, the CyberPower logo and PowerPanel® are registered trademarks of Cyber Power Systems (USA), Inc.

All rights reserved. All other trademarks used are property of their respective owners.