

CUSTOM DOOR PANEL DIMENSIONS

INTEGRATED OVERLAY PANEL

A custom door panel can be fabricated for the appliance. Handle hardware must also be provided, if needed. Finish all sides of the custom panel. They may be visible when the door is open.

SR243SS/SSPR

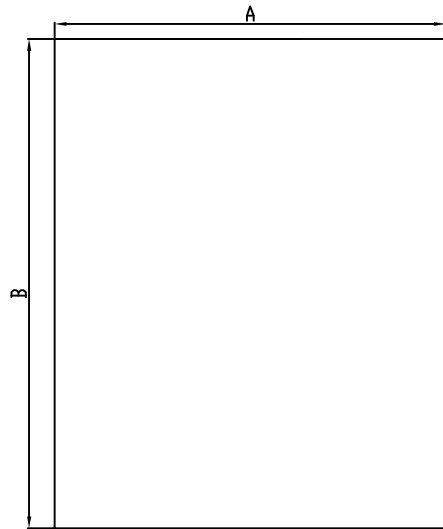

A	23-1/2" 598(mm)
B	29-1/4" 744(mm)

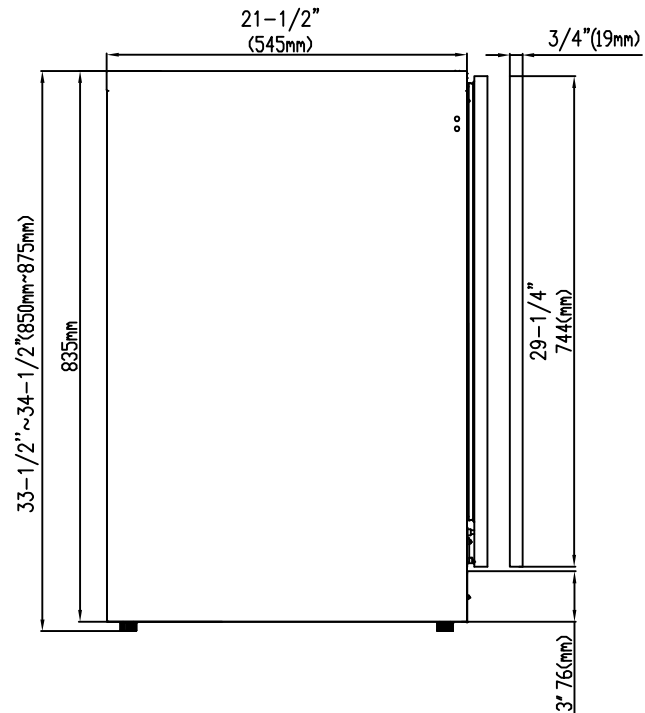

SBC243SS/SSPR , SW243S/DZSS/SSPR

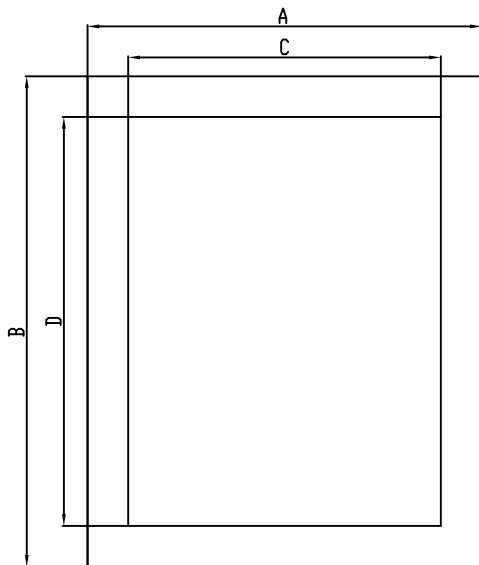

A	23-1/2" 598(mm)
B	29-1/4" 744(mm)
C	18-5/8" 474(mm)
D	24-3/8" 620(mm)

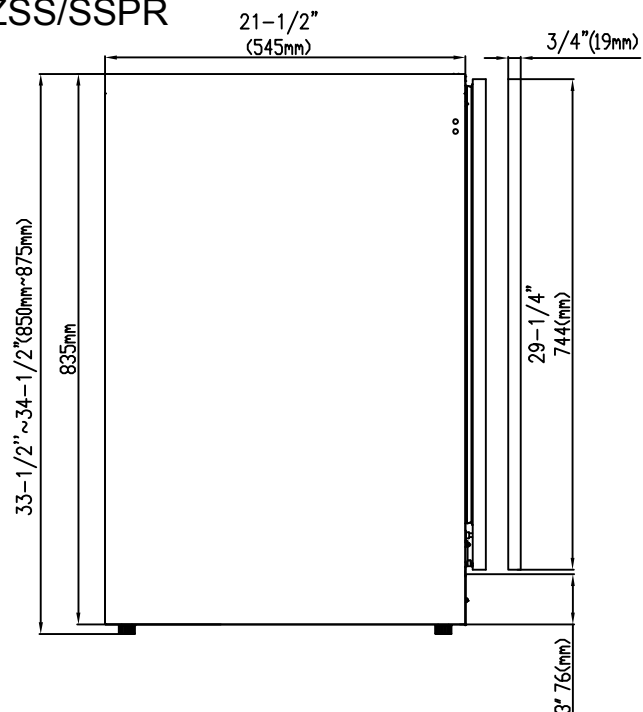

ADA INTEGRATED OVERLAY PANEL

SR243SS/SSPRADA

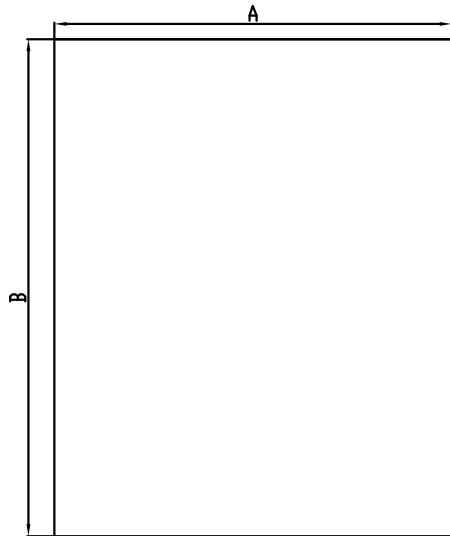

A	23-3/8" 593(mm)
B	27-7/8" 707(mm)

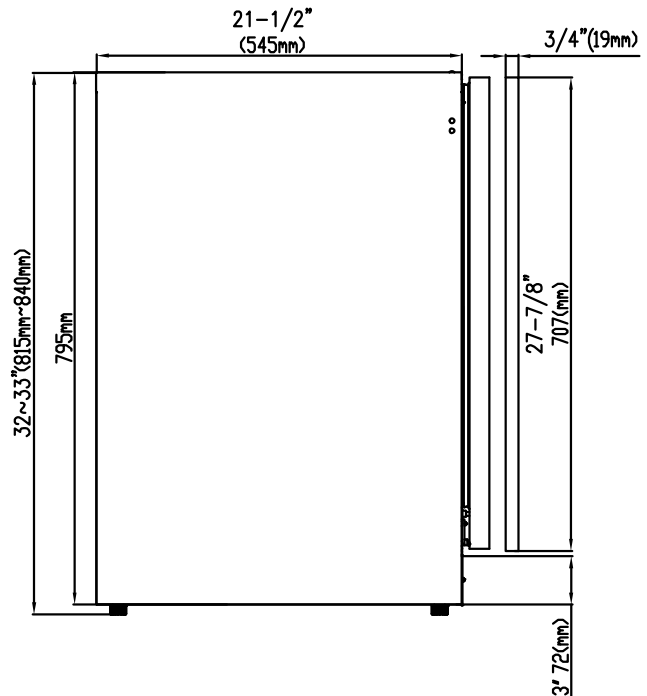

SBC243SS/SSPRADA , SW243S/DZSS/SSPRADA

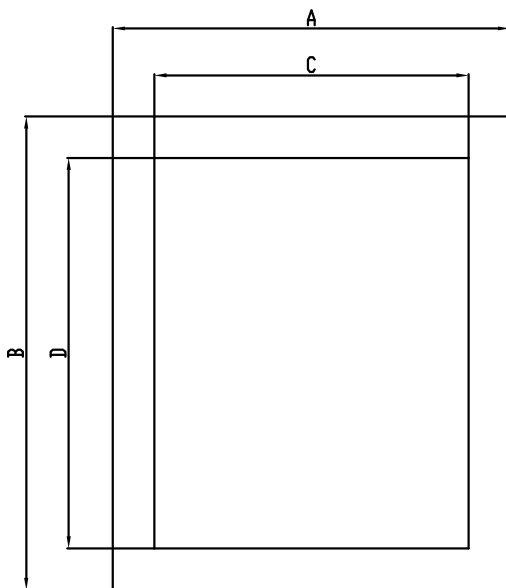

A	23-3/8" 593(mm)
B	27-7/8" 707(mm)
C	18-1/2" 469(mm)
D	23" 583(mm)

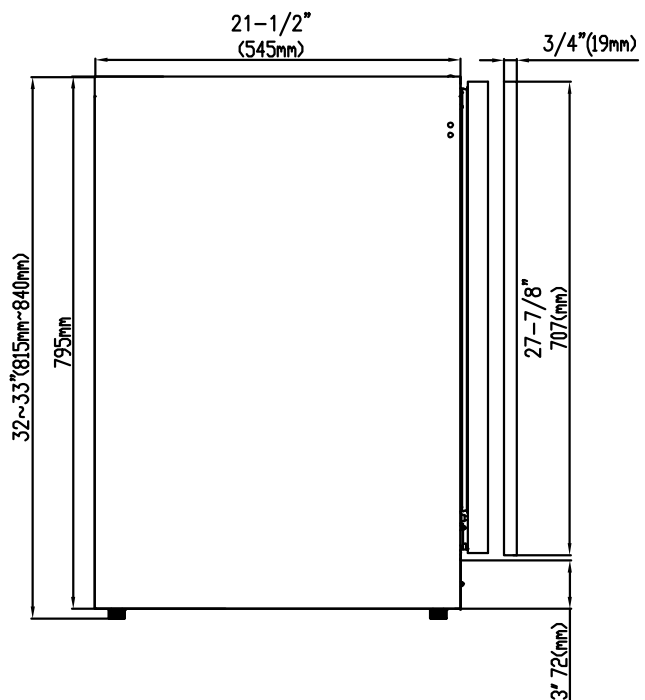

INTEGRATED OVERLAY PANEL

SRD153SS/SSPR

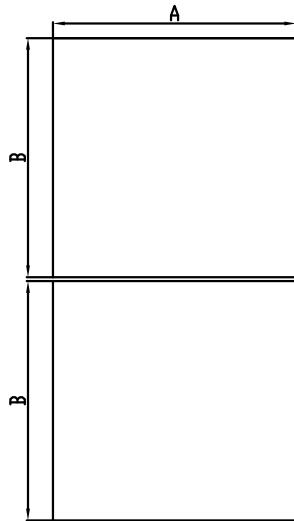

A	14-3/4" 374(mm)
B	14-3/4" 376(mm)

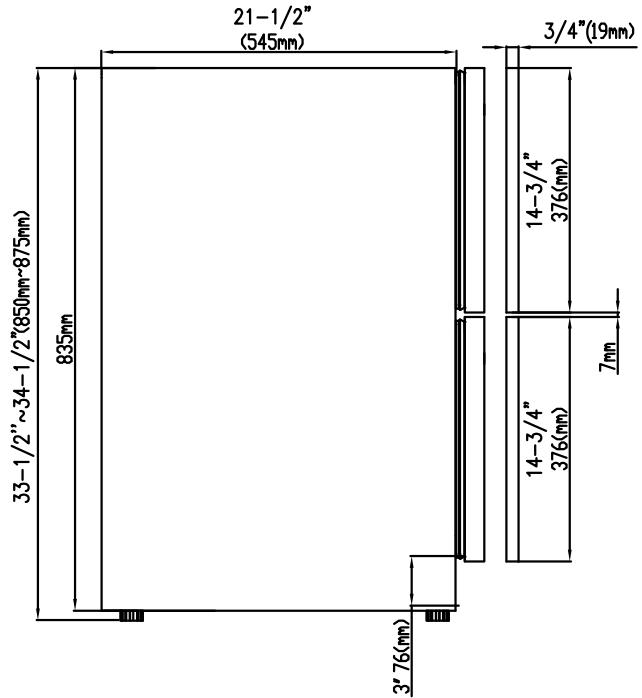

SRD243SS/SSPR

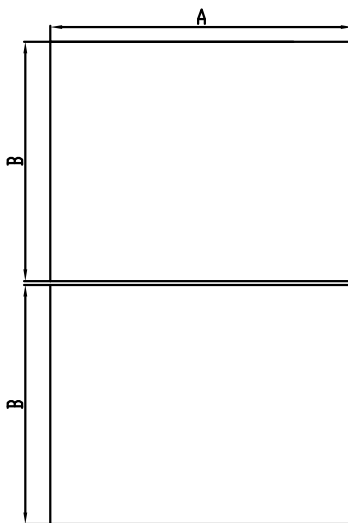

A	23-3/4" 602(mm)
B	14-3/4" 376(mm)

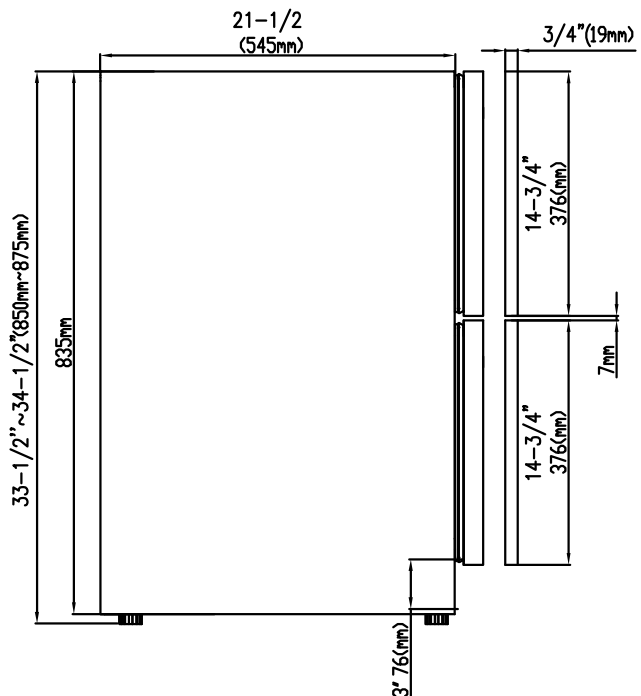

INSTALLING A CUSTOM DOOR PANEL

For Beverage Center, Wine Cooler, Refrigerator

1. Remove the door from the unit, then remove the Shaft reinforce mechanism.



2. Remove the door seal to gain access to the custom door panel mounting holes.



3. Unscrew from the door gasket slots to uninstall the door handle.

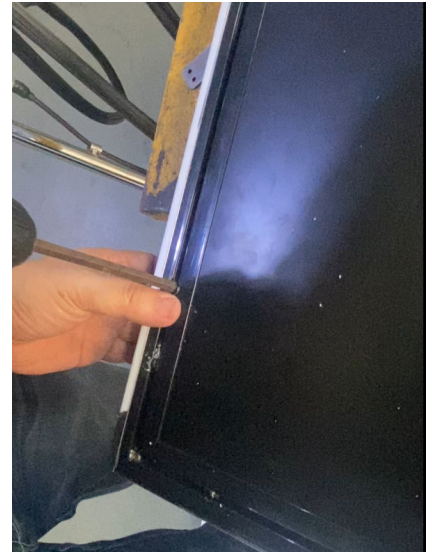

4. Flap the front panel to let the inner door separate from the stainless outer shell and draw out.

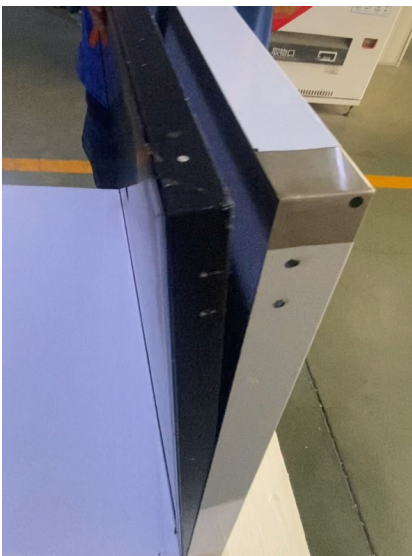

5. Align the top of the custom door pane flush with the top of the door, and adjust the overlap of the custom door panel so it is equal on both sides of the door. Secure the custom door panel to the door using ten wood screws (provided).

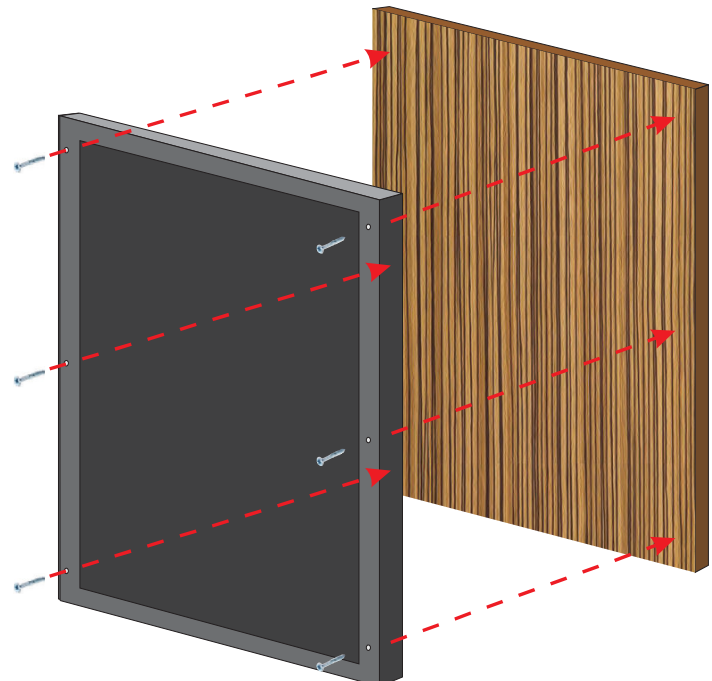

6. Install the shaft reinforcement mechanism back on top and bottom of the door, then drill the top and bottom hinge shaft holes on the door panel. Install the top and bottom shaft sleeves in to the drilled holes.

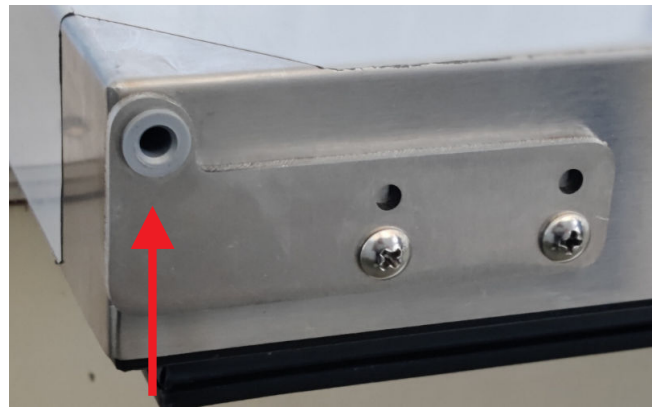
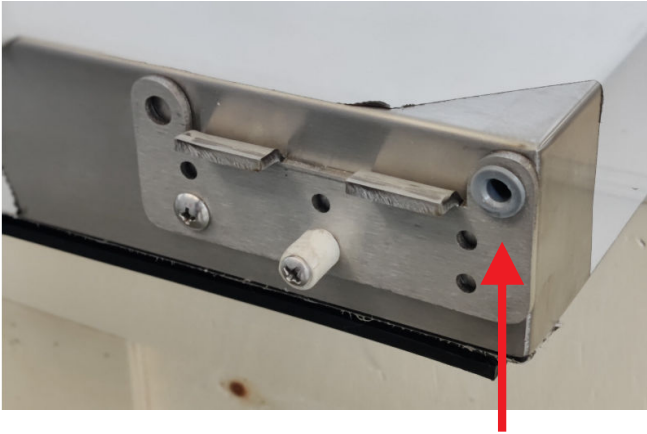

7. Reinstall the door seal. Be sure the seal is properly seated and reinstall the door to the unit.

For Drawer Refrigerator

To install door panel on drawer refrigerator:

Hold the clips to remove the drawer from the slider first, then the same procedure as above, except the drawer outer shell has two extra screws at the bottom that need to be removed before separating it from the inner door.

