

SILVERBACK

MODEL NO.

B1030 SILVERBACK ANCHOR KIT

ANCHOR SYSTEM INSTALLATION INSTRUCTIONS

⚡ WARNING ⚡

Before digging hole for anchor system, check for buried power, gas, water, and telecommunication lines! Failure to do so could result in serious or fatal injury! Contact your local utility company if unsure.

NOTE: For best results with less vibration, anchor system should be independent of court. If pouring concrete for both at same time, add an expansion joint in between.

NOTE: When digging hole, if you hit rock and cannot dig through contact a contractor.

1. Determine the location of the anchor system. The proper location is as close to the court without making contact, as shown in **Figure 1**. This, however, is a general rule. If you need to locate the anchor system in a location other than this, check system's owners manual for overhang of your system.

NOTE: Minimum of 18" rear clearance is required behind pole.

2. Assemble anchor system as follows: Thread nut (#1) to bottom of threads on anchor bolt (#3) insert threads of anchor bolt (#3) through hole on anchor plate (#2) and secure with nut (#1). Repeat this step for the remaining anchor bolts. See **Figure 2**.

NOTE: Each leg of anchor bolts should face the anchor bolt to the right. See **Detail A**.

Items needed for Anchor Installation (not included)

- 9 - 80 lb. bags of concrete (2-3 extra recommended)
- 1 - post hole digger (optional)
- 1 - 15/16" open end wrench
- 1 - 15/16" socket and ratchet (optional)
- 1 - concrete form (see note before step 3)
- 1 - wheel barrow
- 1 - garden hose
- 1 - level
- 1 - tape measure

Figure 1

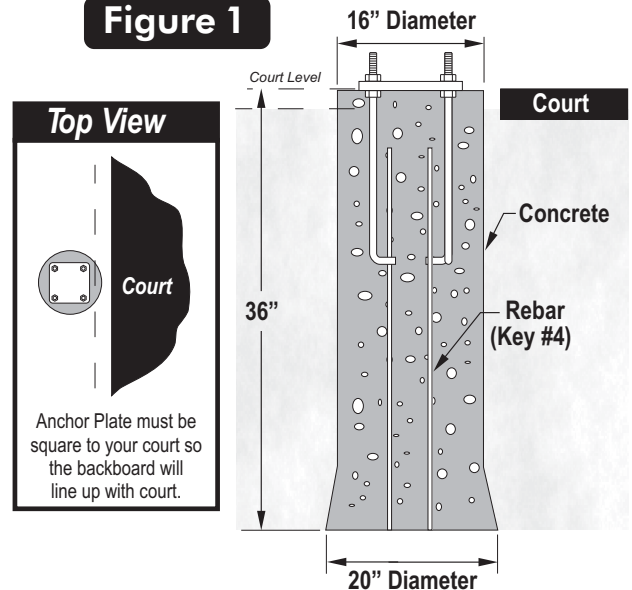

Detail A
Bottom View

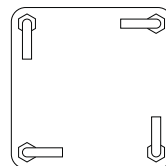
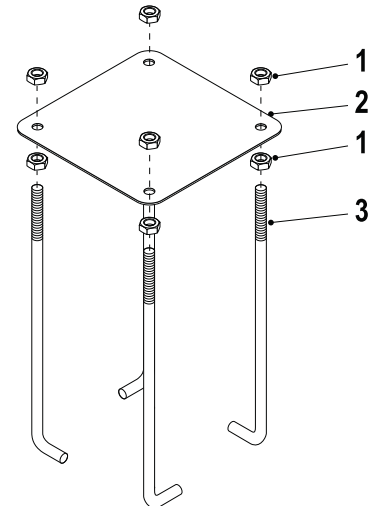

Figure 2



Note: Using a concrete form for the top 4" of the concrete is recommended. Cardboard forms can be purchased at some hardware and home stores or a wooden form can be constructed out of 2 x 4's.

Note: Failure to dig and fill hole as instructed will result in increased system vibration.

***Tip:** It is always a good idea to purchase two or three extra bags of concrete, just in case you need them. If extra bags are not used you can return them to the store.

3. Mix and pour concrete into hole. Follow instructions on concrete bag. Stop about 18" below court level.
4. Insert four reinforcement bars (Key #4) into concrete 8" apart creating a square in center on hole.
5. Place form in desired location and finish pouring concrete up to court level.
6. Push anchor system into concrete and agitate to work out voids in concrete. Immediately use a level to level and square anchor plate to playing surface. Clean off any concrete that may be on exposed threads.

Note: The bottom four nuts will be forever embedded in concrete. The top four nuts remain on bolts and are used for leveling. See your basketball system's instruction manual.

Let concrete cure for a **MINIMUM** of **72** hours.

! CAUTION !

PLACING THE POST ON THE ANCHOR SYSTEM REQUIRES AT LEAST FOUR CAPABLE ADULTS. POLE WILL WANT TO LEAN WHILE ATTEMPTING TO STAND IT UP ON ANCHOR BOLTS.

7. Locate hardware needed to mount pole to anchor bolts. You will need, eight flat washers (#5), four lock washers (#6), four hex nuts (#1) and four thread protectors (#7).
8. Put a flat washer (#5) on each anchor bolt. Lift post onto anchor system and secure with one flat washer (#5), one lock washer (#6) and one hex nut (#1) for each anchor bolt. See **Figure 3**. Tighten all four hex nuts tight.

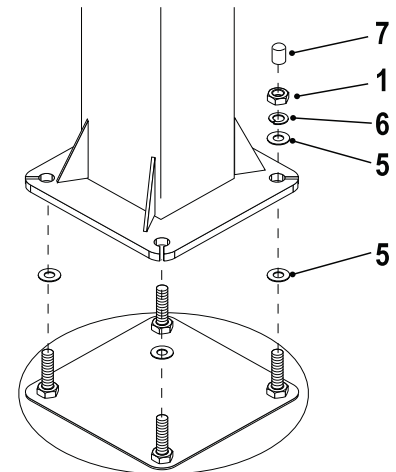
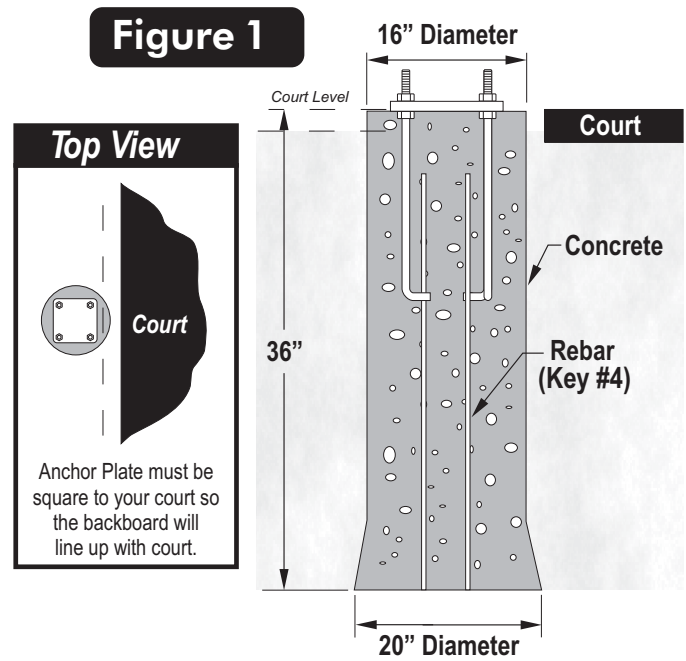

Figure 3

Key#	Part #	Description	Qty.
1	2B-6097-00	5/8-11 HEX NUT	12
2	2S-6453-00	ANCHOR TEMPLATE	1
3	2B-6112-00	5/8-11 X 14 "J" BOLT	4
4	1S-6167-00	REBAR #3 X 30"	4
5	2B-6098-01	5/8 SAE FLAT WASHER	8
6	2B-6099-00	5/8 SPLIT LOCKWASHER	4
7	3M-6469-00	5/8 THREAD PROTECTOR	4