

PART NO. AW 708PC
P-Trap with Union
 HUB X HUB WITH PLASTIC NUT

SIZE	A	B	C
1½	4 ⁵ / ₈	3 ¹⁵ / ₁₆	1¾
2	6 ¹³ / ₁₆	4 ⁷ / ₈	2 ³ / ₈

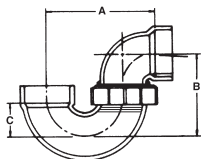

PART NO. AW 711PC
L.A. Pattern P-Trap with Union
 SLIP X HUB WITH PLASTIC NUTS

SIZE	A	B	C
1½	4 ⁵ / ₈	3 ¹⁵ / ₁₆	3¾

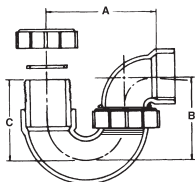
§Nut is sized to fit tubular sink tailpieces.

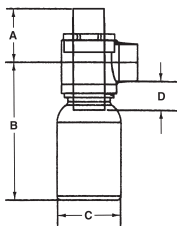

PART NO. AW 712C
Jar Trap
 SLIP X HUB

SIZE	A	B	C	D
1½	3 ¹ / ₈	8 ¹ / ₄	3 ⁷ / ₈	2

PART NO. AW 712PC
Jar Trap with Tail Piece Adaptor
 SLIP X HUB WITH PLASTIC NUTS

SIZE	A	B	C	D
1½	3 ⁵ / ₁₆	8 ⁵ / ₃₂	3 ⁷ / ₈	2

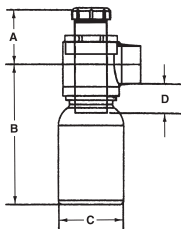
§Nut is sized to fit tubular sink tailpieces.

PART NO. AW 1512PC
CPVC Tail Piece with Nut‡
 (May be cut to length)

Supplied with a Fluoroelastomer Gasket

SIZE	A	B
1½ x 12	12	1½

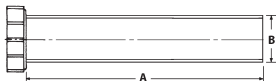

‡ Tubular O.D.