



safety 1st



SCAN HERE
TO SEE PRODUCT
COMPATIBILITY AND CAR
SEAT INSTALL VIDEOS



safety 1st



Send Us a Text: 1-812-652-2525
(US and Canada Only.
Carrier Fees May Apply)



Find Us Online:
www.safety1st.com
Email Us: support@djgusa.com



Give Us a Call: 1-800-544-1108
(Toll Free, US and Canada Only)

Replacement Parts List

- Seat Pad Set
- Harness Straps
- Lower Anchor Belt
- Chest Clip
- Base
- Buckle Assembly
- Instructions
- Canopy Hoop

For parts availability and questions, call, text, email, or chat.

If requested color is not available, similar color will be substituted. Applicable tax and shipping & handling will also be added.

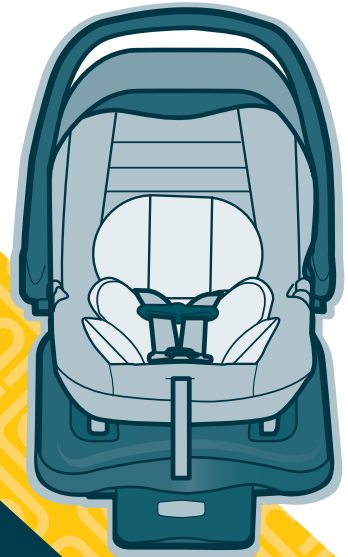

onBoard™ FLX Infant Car Seat

Your model may look different than one shown on cover.

Read all instructions BEFORE USING this car seat.

KEEP INSTRUCTIONS FOR FUTURE USE.

 Failure to follow the warnings on the labels and in the instruction manual can result in serious injury or death to your child. Serious injury may include paralysis and/or permanent brain injury.



4358-8643A
05.28.26





Getting Started

To help you get started using your child's new car seat (also known as a child restraint), these are the four main tasks you'll need to complete.

1

Measure Your Child

2

Adjust the Car Seat to Fit Your Child

3

Install the Car Seat into Your Vehicle

4

Secure Your Child in the Car Seat

Getting Started

Parts of the Car Seat.....	4
Accessory Use.....	6
Rear-Facing Use Requirements.....	7
Rear-Facing Child Fit.....	8

Making Adjustments to Car Seat

Changing Harness Strap Position.....	10
Changing Buckle Position..	12
Harness System Adjustments for Smaller Infants	14
Removing and Installing Car Seat to Base.....	17
Base Use	18
Canopy Use.....	19
Carrier Use	21
Securing Child in Car Seat	22

LATCH & Vehicle Belt Information

LATCH: Lower Anchor Belt..	25
Vehicle Belts	27

Rear-Facing Information

Rear-Facing Use with Base.....	33
Vehicle Belt Install without Base	40

Wash and Care

Removing Harness System.....	46
Removing Seat Pad Set for Cleaning.....	48
Cleaning Parts of Car Seat and Installing Seat Pad Set	50
Installing Harness System..	51

Safety Information

Aircraft Information	55
Child Restraint Use	56
Vehicle Seating Position	57
Installation in Vehicle.....	58
Replacement and Expiration of Car Seat.....	59
Registration and Safety Notices	60
Warranty	61
Troubleshooting	63

Parts of the Car Seat

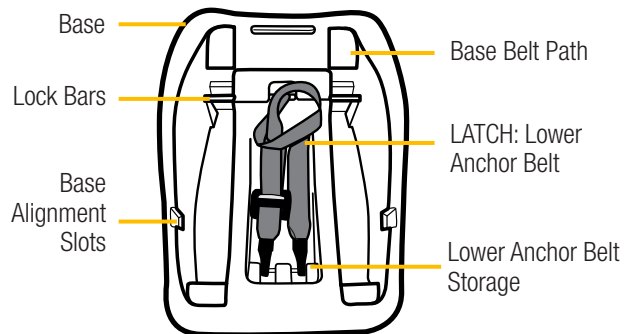
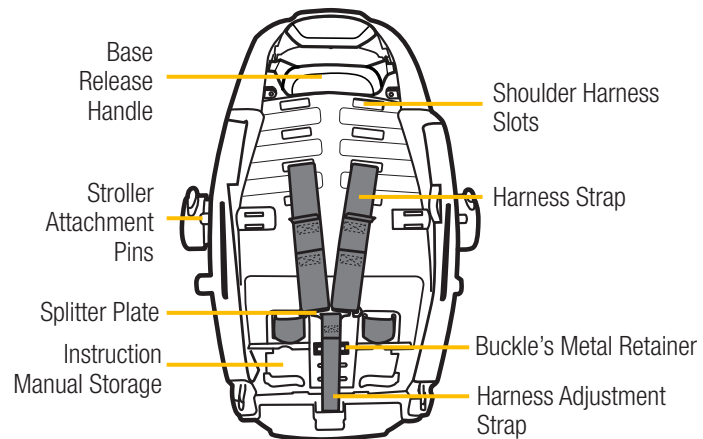
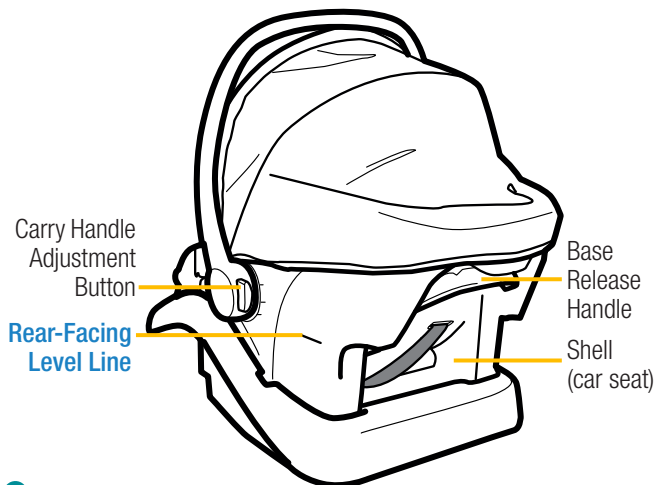
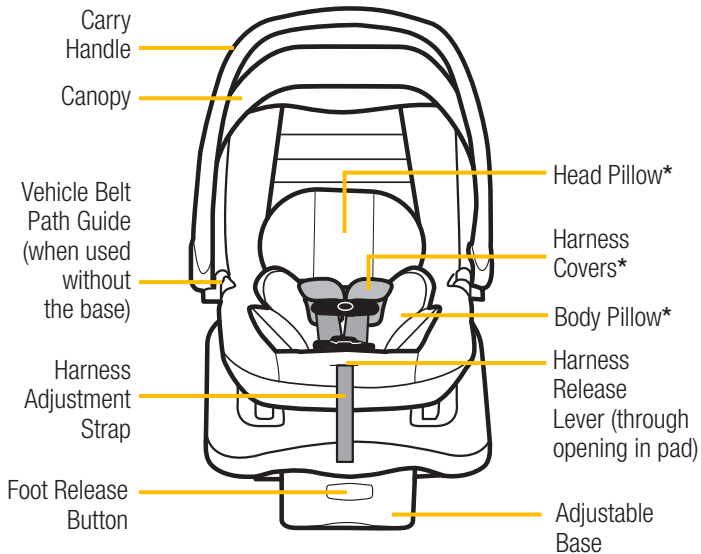

Harness System Detail

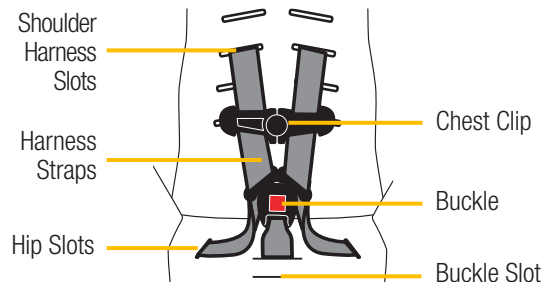

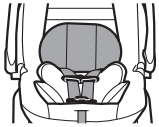

Head Pillow (on select models)

When using the head pillow, make sure it does not cover your infant's face in any way.

The head and body pillows MUST be used together.

To remove, pull the head pillow up from behind the body pillow. Reverse the order to install the head pillow.



Body Pillow (on select models)

The head and body pillows MUST be used together.

To remove, unbuckle the harness. Pull the buckle down through the slot in the body pillow. Slide it out from behind the harness straps. Reverse the order to install the body pillow.



Harness Covers (on select models)

The harness covers help provide comfort to your child's neck. If the harness covers will not allow proper positioning of the chest clip or interfere with getting a tight enough harness fit for a smaller baby, remove them and **DO NOT** use. Store until your child is large enough to use the harness covers while maintaining a properly fitting harness.

To ensure your child's comfort and safety, always position the harness covers so that the fastener opening is pointed away from your child's face to prevent irritation or contact with exposed fastener edges.

To remove, pull the fastening strips apart and pull the harness covers off of the harness strap.



⚠ WARNING

Failure to follow these instructions may result in serious injury or death to your child. Serious injury can include paralysis and/or permanent brain injury.

Be certain to measure your child's weight and height (do not guess) before using this car seat.

This car seat can only be used **REAR-FACING**.

Your child's height, weight, and age determine how the car seat should be placed in the vehicle.

Children vary widely in body size, shape, and temperament—**please consult your doctor before switching between any modes within the limits and fit requirements of the car seat.**

Infants and Toddlers

Children must ride rear-facing and remain rear-facing until they reach the maximum weight or height limits for rear-facing mode. Rear-facing child restraints installed behind another vehicle seat must be installed touching the back of the vehicle seat in front of it, or be as close as possible.



REAR-FACING

4–30 lb (1.8–13.6 kg) and 32 in. (81.3 cm) or less in height

This car seat can only be used Rear-Facing.

In this Rear-Facing only car seat, your child can use this restraint until they outgrow any one of the following:

- **Weight Limit:** 30 lb (13.6 kg); **OR**
- **Height Limit:** 32 in. (81.3 cm); **OR**
- **Rear-Facing Child Fit** requirements, see page 8



1

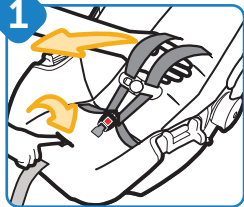

Fully loosen harness straps

Push down on the harness release lever (through the opening in the pad) while pulling out on the harness straps as shown.

2

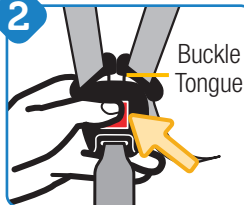

Unbuckle harness

Press in on the red button and pull out buckle tongues.

3

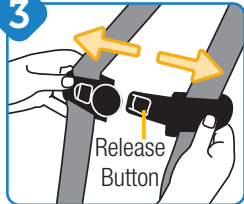

Release chest clip

Hold each side of the chest clip.

Press on the release button with your thumb and pull the chest clip apart.

4



Place child in car seat to determine proper harness fit

Your child's bottom and back should be flat against the car seat.

5

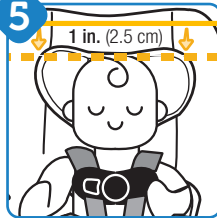

Check head position

The top of your child's head **MUST be at least 1 in. (2.5 cm) below** the top of the car seat's headrest.

6



Check harness strap position

The harness strap **MUST be placed at the shoulder** when possible, or slightly below; **NEVER** above.

7

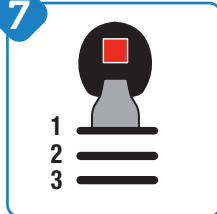

Check buckle position

- Use the slot closest to your child.
- The buckle strap **should not be underneath or behind** your child.



Check your child's fit often.

If you cannot achieve a snug harness fit for your child, see pages 14–16.

To learn how to check harness tightness, see pages 22–24.

Check the harness straps often for any wear or damage.



Changing Harness Strap Position

1

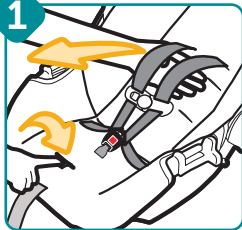

Fully loosen harness straps

Push down on the harness release lever (through the opening in the pad) while pulling out on the harness straps as shown.

2

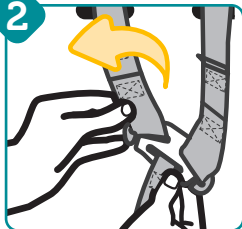

From back of car seat, remove harness strap loops from splitter plate

3

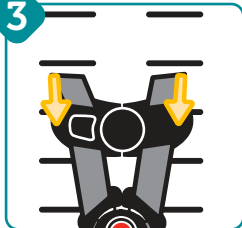

Pull harness straps out of shoulder harness slots

4

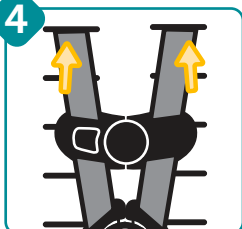

Rethread harness straps into correct shoulder harness slots for your child

For [Rear-Facing Child Fit](#), see page 5.

5

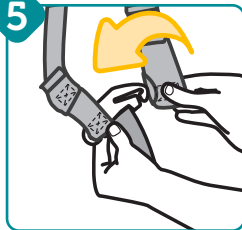

From back of car seat, attach 1st harness strap loops to splitter plate as shown

The sewn ends of the harness strap loops **MUST** face towards you.

DO NOT twist the harness strap or the harness adjustment strap.

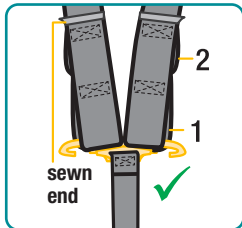

Make sure the harness strap loops are fitted **completely on** both sides of the splitter plate.



Check your child's fit often.

If you cannot achieve a snug harness fit for your child, see pages 14–16.

To learn how to check harness tightness, see pages 22–24.

Check the harness straps often for any wear or damage.



Changing Buckle Position

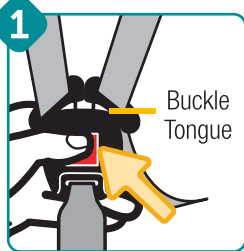

Unbuckle harness

Press in on the red button and pull out buckle tongues.

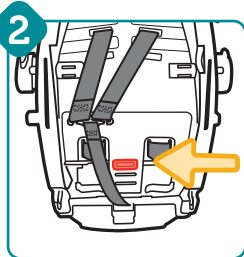

Turn car seat over

Locate the buckle's metal retainer on the bottom of the shell.

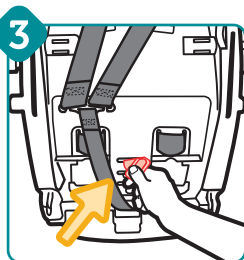

Rotate metal retainer and push it up through shell and pad



From top of car seat, pull buckle out of shell and pad



Insert buckle's metal retainer into buckle slot closest to child

The buckle **MUST** face out. The buckle strap should not be underneath or behind your child

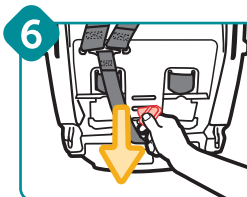

From bottom of car seat, pull metal retainer completely through pad and shell

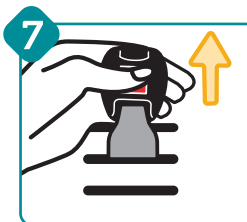

Check buckle

Pull up on the buckle to make sure it is secured.

The buckle **MUST NOT** pull out.

i Check your child's fit often. If you cannot achieve a snug harness fit for your child, see pages 14–16. To learn how to check harness tightness, see pages 22–24.

⚠ WARNING

Failure to place buckle's metal retainer completely through pad and child restraint can result in serious injury or death. Serious injury can include paralysis and/or permanent brain injury.



Harness System Adjustments for Smaller Infants



If you cannot achieve a snug harness fit for your child, you may need to adjust the buckle strap and/or harness strap length and location as shown in this section.

Adjusting Buckle Strap Length

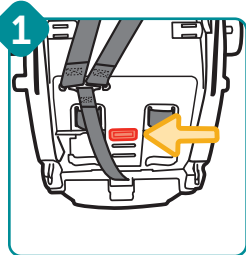

1 With buckle in 1st slot, turn car seat over

If you need to move the buckle to the 1st slot, see pages 12–13.

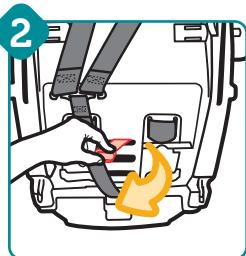

2 Pull buckle's metal retainer towards you, then push it up into middle buckle slot as shown

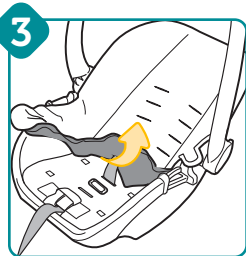

3 Pull up front of car seat pad

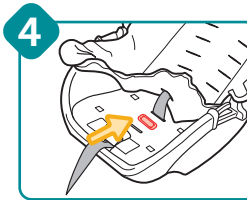

4 From top of car seat, lay metal retainer flat against shell as shown



5 Replace pad and check buckle
Pull up on the buckle to make sure it is secured.

The buckle **MUST NOT** pull out.

Adjusting Harness Strap Length

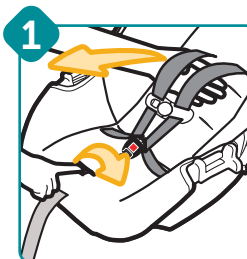

1 Fully loosen harness straps
Push down on harness release lever (through opening in pad) while pulling out on harness straps as shown.

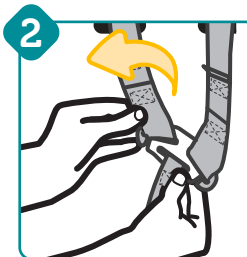

2 From back of car seat, remove harness strap loops from splitter plate

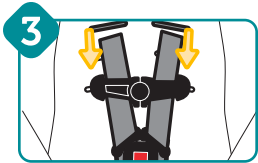

3 Pull harness straps out of shoulder harness slots

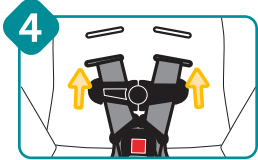

4 Rethread harness straps into correct shoulder harness slots for your child

For **Rear-Facing Child Fit**, see page 8.

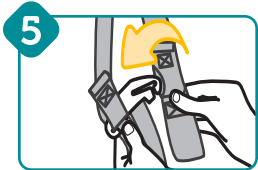

5 Attach 2nd harness strap loops to splitter plate as shown

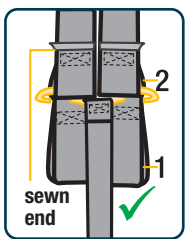
The sewn ends of the harness strap loops **MUST** face towards you.

DO NOT twist the harness strap or the harness adjustment strap.

Make sure the same harness strap loops are fitted completely on both sides of the splitter plate.

WARNING

The harness system **MUST** be installed correctly. **DO NOT** use a child restraint with damaged harness straps.



When using the passenger or driver-side locations, the car seat **MUST** be touching the back of the vehicle seat in front of it, or be as close as possible.

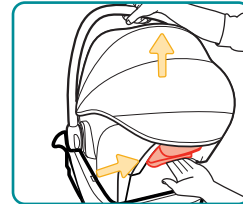

To remove car seat from base

From the back of the car seat, slide the base release handle up and lift the car seat out of the base.

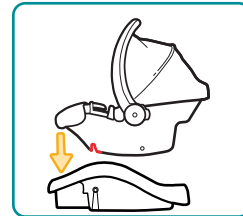

To attach car seat to base

Align the slots on the side of car seat with the lock bars in the base.

Push down firmly on the carry handle and front of the car seat to lock it to the base. You will hear a “click” when it is locked.

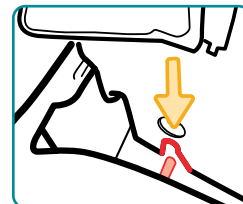

Pull up on the front two corners of the car seat by infant's feet to make sure it is locked to the base.

The carry handle **MUST** be upright and locked when installed in the vehicle.

WARNING

When installing with a base, only use this car seat with a compatible Safety 1st Infant Car Seat Base.

Failure to use a correct base can cause serious injury or death.

Failure to securely attach child restraint to base can result in serious injury or death. Serious injury can include paralysis and/or permanent brain injury.

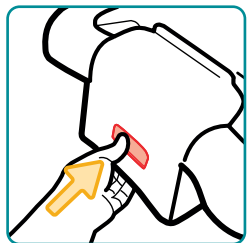

To lower base foot

Push in on the foot release button.

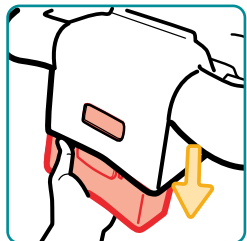

Pull the foot all the way down.

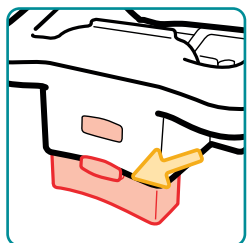

Lock the foot on the release button as shown.

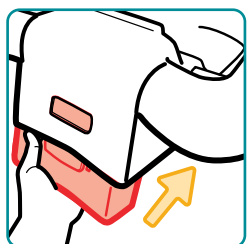

To store base foot

Pull the foot down and press in on the release button.

Push the foot up into the base to the locked position.

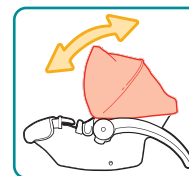
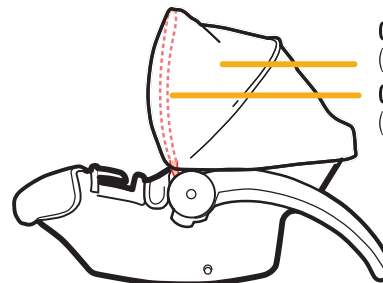

To adjust canopy

Grasp both sides of the canopy hoop and move it front to back to the desired position.

To Install Canopy

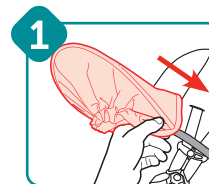

1 Slide the canopy fabric over the hoop

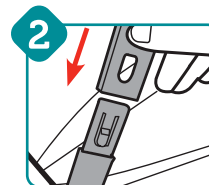

2 Insert the end of the canopy hoop onto the canopy post

Repeat with the other canopy post.

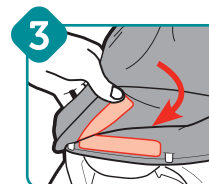

3 Attach the fastening strip on the canopy to the back of the car seat



To Remove Canopy

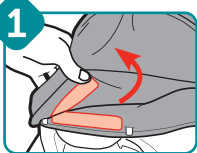

1 Undo fastening strip on back of shell

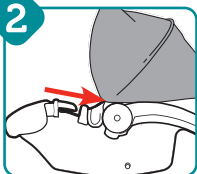

2 Locate canopy post

There is one on either side of the shell. You only need to undo one to remove the canopy.

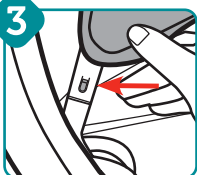

3 Pull back the canopy fabric to see the tab on the canopy post

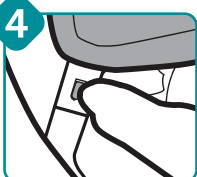

4 Press in on the tab with your thumb and pull the canopy hoop off of the canopy post

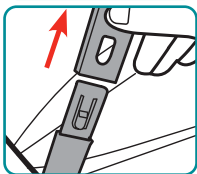

5 Slide the canopy fabric off the canopy hoop

Reverse to put back together.

To adjust carry handle

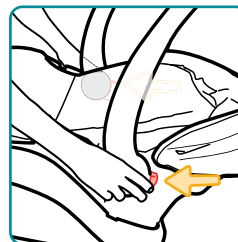

Squeeze both adjustment buttons on each side of the carry handle.

Rotate up or down to desired location. Release buttons.

Make sure both carry handle adjuster buttons are in the locked position.

Carry handle **MUST** be upright and locked when carrying and when installed in the vehicle.

⚠ WARNING

Read **ALL** instructions before using child restraint as a carrier.

NEVER use carrier unless child is properly secured.

Use only as a carrier by children weighing 4–30 pounds (1.8–13.6 kg) and 32 inches (81.3 cm) or less in height.

NEVER leave child unattended. Always keep child within arm's reach.

Suffocation Hazard: Infant carrier can roll over on soft surfaces and suffocate child. **NEVER** place carrier on beds, sofas or other soft surfaces.

Strangulation Hazard: Children have **STRANGLED** in loose or partially buckled harness straps. Fully restrain the child even when carrier is used outside the vehicle.

Fall Hazard: Child's activity can move carrier. **NEVER** place carrier on counter tops, tables, or any other elevated surface.



The carrier can fall from the shopping cart. **DO NOT** use on shopping cart.

DO NOT use the carrier if it is damaged or broken, or if any parts are missing.



Securing Child in Car Seat

1

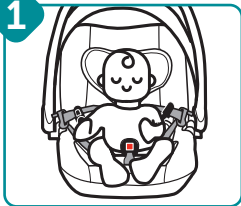

Place child in car seat

Your child's bottom and back should be flat against the car seat.

Position the harness straps over your child's shoulders and upper thighs.

2

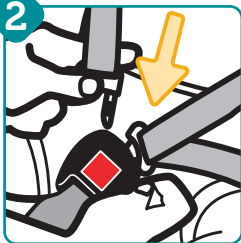

Buckle harness

Push the buckle tongues into the buckle until you hear them "click".

Pull up on the harness straps to make sure the buckle is locked.

3

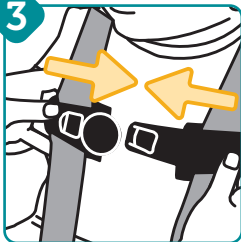

Fasten chest clip

Insert right half of the chest clip into the left half and snap together.

4

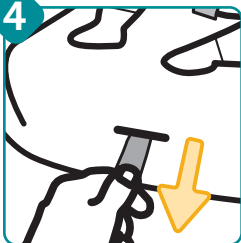

Tighten harness

Pull the harness adjustment strap straight out to snugly tighten the harness system.

5

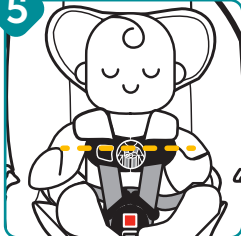

Position chest clip

Slide the chest clip up the harness straps and position it at mid-chest (even with armpits) and away from your child's neck.

6

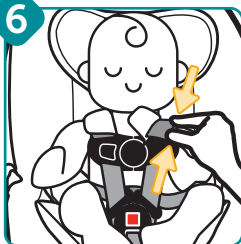

Check harness tightness

Unfasten the harness covers.

Try to pinch the harness strap at the shoulder vertically between your index finger and thumb as shown.

If your fingers slip off, the harness is tight enough.

If you can pinch the harness strap, tighten more.

Fasten the harness covers.

i

A snug strap should not allow any slack.

It lies in a relatively straight line without sagging.

It does not press on the child's flesh or push the child's body into an unnatural position.

If one side of the harness is tighter than the other, lengthen the tighter side by pulling up the harness near the hip slot.



FINISHED!

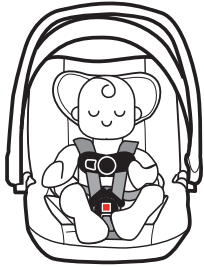

Your child is now secured in the car seat.

Check your child's fit often and make any needed adjustments to the car seat as they grow.

To remove child from car seat:

1. Loosen harness strap.
2. Unbuckle harness.
3. Release chest clip.
4. Remove child.

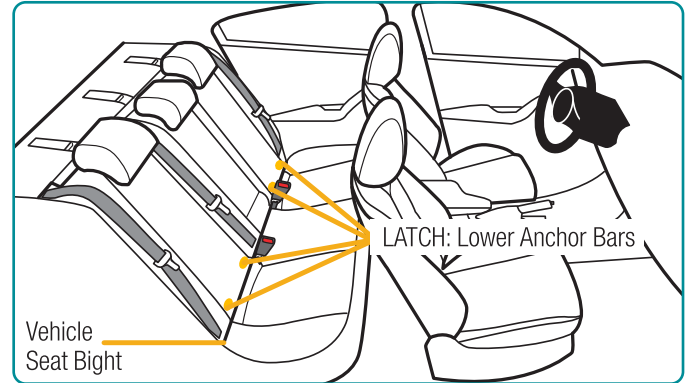

Your vehicle's features may be considerably different than those pictured here.

The lower anchors of **LATCH** (Lower Anchors and Tethers for Children) is a universal system for installing car seats without using vehicle seat belts.

The LATCH: lower anchor belt can **only** be used in vehicles that have the lower anchor bars installed in designated seating positions. Most vehicles manufactured after September 2002 are equipped with LATCH: lower anchor bars.

Check your vehicle owner's manual to see which seating positions may be equipped with LATCH: lower anchor bars.

⚠️ WARNING

Failure to fasten and tighten the harness system correctly may allow the child to be ejected from the child restraint in a crash or sudden stop causing serious injury or death. Serious injury can include paralysis and/or permanent brain injury.



DO NOT mistake comfort for safety. The harness system **MUST** be snugly adjusted.

DO NOT put snowsuits or bulky garments on your child when placing them in the child restraint.

Bulky clothing can prevent the harness straps from being tightened properly.

⚠️ WARNING

DO NOT use both the lower anchor belt and vehicle belt at the same time.

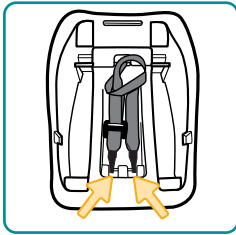

Lower anchor belt storage attachments

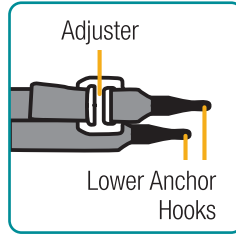

Lower anchor belt parts

To remove lower anchor belt from storage attachment on base

Squeeze the spring lever on the hooks and remove the hooks from the storage attachments.

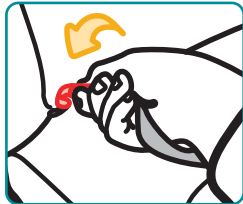

To remove lower anchor belt from vehicle's lower anchor bars

Remove the tension from the belt by pushing down on the side of the base with the adjuster. Then press the adjuster's button to loosen the belt.

Remove the hook from the anchor by squeezing the spring lever on the hook, pushing the hook back into the seat bight, and rotating the hook to the side. Then pull the hook out of the vehicle seat bight.

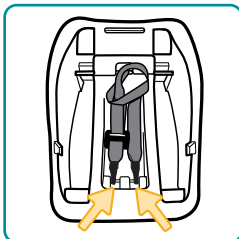

Lower anchor belt storage attachments

To store lower anchor belt

When using the vehicle belts to install or when the base is not installed in a vehicle, the lower anchor belt must be properly stored.

Attach the hooks to the storage attachments in the base.

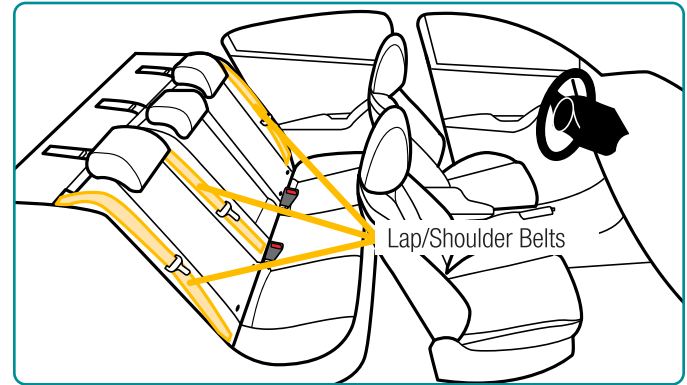

Your vehicle's features may be considerably different than those pictured here.

If LATCH: lower anchors are not an option, you **MUST** use the vehicle seat belt system to install the car seat.

Not all vehicle belts and seating positions will work with car seats.

Please go through the following steps to understand how to lock a car seat with a vehicle belt.

1

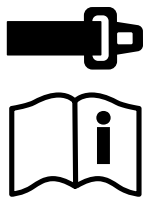

You **MUST** review your vehicle owner's manual

Your vehicle owner's manual will let you know which vehicle belts and seating positions car seats can be installed in.

2



Check how this car seat will be locked into place

The vehicle belt **MUST NOT** loosen after tightening. This means there needs to be a way to lock the vehicle belt.

The ways this can be done are:

- By using the seat belt's retractor, see step 3; **OR**
- By using the seat belt's latch plate, see step 4.

3

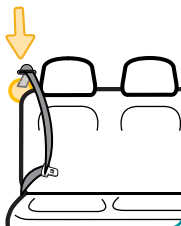

Check retractor

Retractors pull seat belts into stored positions and lock the belt to hold passengers in place.

See the next page for some common types of vehicle belt retractors that will work with this car seat.

Types of Retractors

Switchable Retractor

(most vehicles have this type)



This retractor can be switched to a locking mode.

You **MUST have the retractor in the locking mode** to use the seat belt with this car seat.

Switching to locking mode: Slowly pull the shoulder belt all the way out, then let it go back in **1–2 in.** (2.5–5 cm).

As it goes back in, you will most likely hear a ratcheting sound.

Gently pull the belt to see if it has locked. You will not be able to pull any more belt out if the lock has engaged.

Automatic Locking Retractor



This retractor always locks.

It will automatically lock after slowly pulling the seat belt out at least halfway and letting the belt go back into the retractor **1–2 in.** (2.5–5 cm).

Emergency Locking Retractor

See step 4, Check latch plates.

If the retractor does not lock, it is most likely an Emergency Locking Retractor. These retractors only lock during a sudden stop or collision.

You will need to determine if your seat belt's latch plate can lock the belt. See step 4, Check Latch Plates.



4



Check latch plates

Latch plates are the part of the vehicle belt that goes into the buckle.

To see if the latch plate locks:

1. Buckle vehicle belt.
2. Slowly pull up on the lap portion of the vehicle belt.

If the vehicle belt does not slide through the latch plate, it's locked.

If the vehicle belt slides through the latch plate, it is a **sliding latch plate**.

Sliding latch plates easily slip between the lap and shoulder portions of the belt.

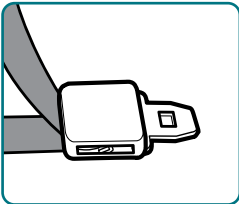

Locking Latch Plate

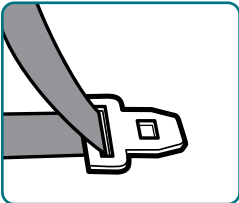

Sliding Latch Plate



NEVER use the following with this car seat:

- Emergency locking retractor lap-only belt
- Inflatable seat belts

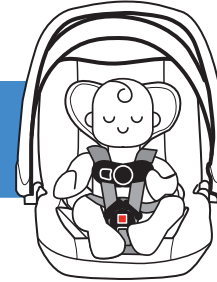

**4–30 lb (1.8–13.6 kg) and 32 in. (81.3 cm)
or less in height**

In this **Rear-Facing** only car seat, your child can use this restraint until they outgrow any one of the following:

- **Weight Limit:** 30 lb (13.6 kg); **OR**
- **Height Limit:** 32 in. (81.3 cm); **OR**
- **Rear-Facing Child Fit** requirements, see page 8.

Before installing the car seat in your vehicle, check your child's fit in the car seat.

Rear-Facing Child Fit: Page 8

Rear-Facing Vehicle Install: Page 33



⚠ WARNING



NEVER install a rear-facing child restraint in the front seat of a vehicle equipped with an active frontal airbag.

DO NOT use the lower anchor belt along with the vehicle lap or lap/shoulder belt.

DO NOT fasten multiple lower anchor hooks on the same lower anchor bar in the vehicle.

Check the vehicle belt or the lower anchor belt before each use.

Use **ONLY** if the belt can be tightened properly and locked securely in place.

Even when unoccupied, this child restraint **MUST** be firmly secured to the vehicle with the lower anchor belt or with the vehicle seat belt.

This child restraint **MUST ALWAYS** face the rear of the vehicle.

There are 2 different methods for install.

Use only one:



Vehicle Belt



LATCH: Lower Anchor Belt



Review Vehicle Owner's Manual

Determine the type of vehicle belts in your car and how to use them to lock a car seat in place **OR** where LATCH: lower anchor seating positions are located in your vehicle.

⚠ WARNING

DO NOT use both the LATCH: lower anchor belt and vehicle belt at the same time to install the base.

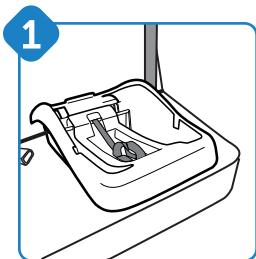

Place base **Rear-Facing** in vehicle

Center the base in the chosen seating position.

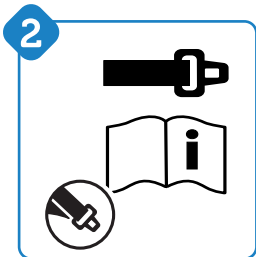

Check if your vehicle belts will work with this car seat

This is very important because **not all vehicle belts will work with car seats.**

Review pages 27–30 and your vehicle owner's manual to find out what kind of vehicle belts are in your car and how to lock a car seat in place.

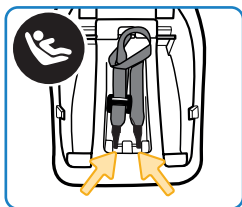

Remove lower anchor belt from storage attachments

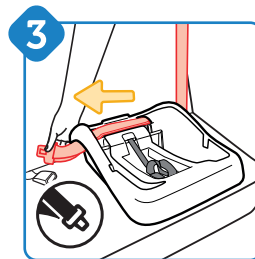

Route vehicle lap or lap/shoulder belt through base belt path

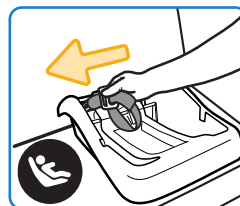

Route lower anchor belt through base belt path

The adjuster can be on either side of the car seat.

DO NOT twist belt.

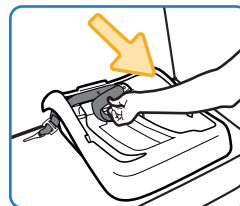

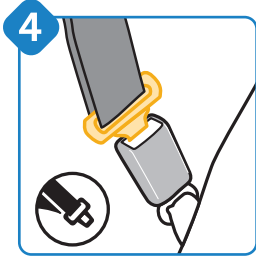

Buckle vehicle belt

If your car's vehicle belt has a switchable retractor, use it to lock the vehicle belt.

For information about switchable retractors, see page 29 or review your vehicle owner's manual.

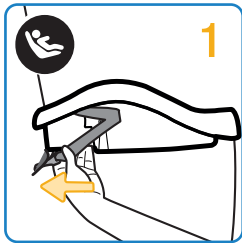

Attach lower anchor hooks to vehicle's lower anchors in seat bight

Review your vehicle owner's manual for LATCH: lower anchor locations and lower anchor belt use.

Fasten one hook to one vehicle lower anchor bar.

Always attach the hook over top of vehicle lower anchor bar. See figure 2.

Repeat for the second hook on the other side of the base.

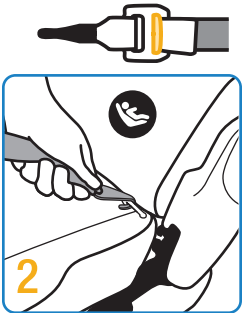

Tighten belt

Place your hand in the base.

Firmly push the base down and back towards the vehicle seat back while pulling the shoulder belt or the free end of the belt parallel with the rear-facing belt path to tighten.

You can check tightness by:

- Holding the base ONLY at the belt path with your non-dominant hand.
- Pushing and pulling from side to side.
- The base should not move more than 1 in. (2.5 cm) at the belt path.

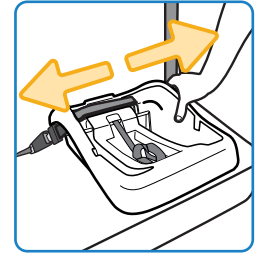

If the base moves more than 1 in. (2.5 cm), you can try:

- Pulling the belt tighter; **OR**
- Reinstalling the base; **OR**
- Changing to a different seating location; **OR**
- Switching to a different install method (LATCH or vehicle belt).



Secure child in car seat

To properly secure your child in the car seat, see pages 22–24.

Check your child's fit often and make any needed adjustments to the car seat as they grow.

7

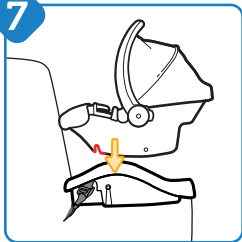

Attach car seat to base

To attach to the base, see page 17.

Pull up on the front two corners of the car seat by your child's feet to make sure it is locked to the base.



The carry handle **MUST** be upright and locked when installed in the vehicle.

8

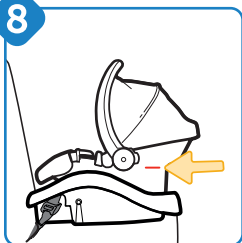

Check level line

Redo the installation if the base is not reclined correctly.

Adjust the base if needed, see page 18.

If your child cannot sit up unassisted, you may install the car seat slightly more reclined than the level line shows.

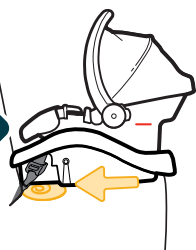

Only if necessary, you may place a tightly rolled towel(s) or foam pool noodle(s) under the front of the car seat base to help make the **Rear-Facing Level Line** parallel with the ground.

Check often to make sure padding is still in place and the belt is tight.

FINISHED!

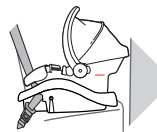

Lap/Shoulder
Belt

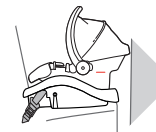

Lap Belt



LATCH: Lower
Anchor Belt

- Vehicle Belt Install without Base:** See page 40.
- LATCH: Lower Anchor Belt Install or Vehicle Belt Install with Base:** See page 33.

When using the passenger or driver-side locations, the car seat **MUST** be touching the back of the vehicle seat in front of it, or be as close as possible.



There are 2 different methods for install.

Use only one:



Lap Belt



Lap/Shoulder Belt



Secure child in car seat

To properly secure your child in the car seat, see pages 22–24. Check your child's fit often and make any needed adjustments to the car seat as they grow.

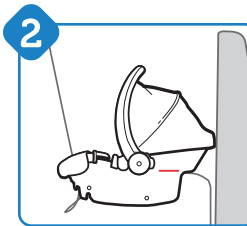

Place car seat rear facing in back seat

Center the car seat in the chosen seating position.

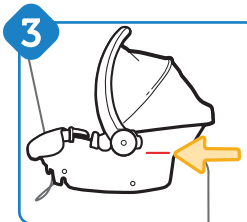

Check level line

If your child cannot sit up unassisted, you may install the car seat slightly more reclined than the level line shows.

WARNING



NEVER install a rear-facing child restraint in the front seat of a vehicle equipped with an active frontal airbag.

Check the vehicle belt before each use. Use only if the belt can be tightened properly and locked securely in place.

Even when unoccupied, this child restraint **MUST** be firmly secured to the vehicle with the vehicle seat belt.

This child restraint **MUST ALWAYS** face the rear of the vehicle.

4

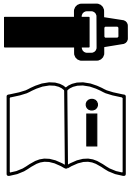

Check if your vehicle belts will work with this car seat

This is very important because **not all vehicle belts will work with car seats.**

Review pages 27–30 and your vehicle owner's manual to find out what kind of vehicle belts are in your car and how to lock a car seat in place.

5

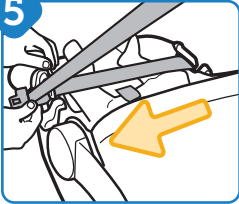

Route vehicle lap or lap portion of the lap/shoulder belt through shell belt path as shown

6

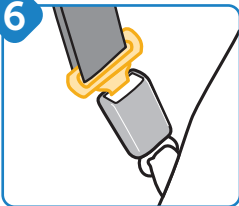

Buckle vehicle belt

If your car's vehicle belt has a switchable retractor, use it to lock the vehicle belt.

For information about switchable retractors, see page 29 or review your vehicle owner's manual.

7

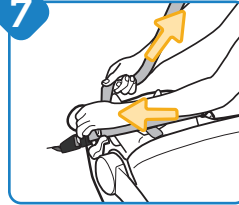

Tighten vehicle belt

Lay your forearm across the car seat at the belt path while pulling up on the belt to tighten.

8

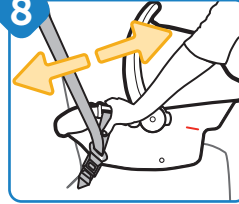

Check belt tightness

Hold the car seat at the belt path with your non-dominant hand. Push and pull from side to side. It should not move more than **1 in. (2.5 cm)** at the belt path.



If it moves more than 1 in. (2.5 cm), you can try:

- Pulling the belt tighter; **OR**
- Reinstalling the car seat; **OR**
- Changing to a different seating location

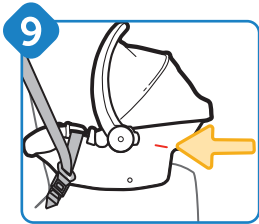

9 Recheck **Rear-Facing level line**

Redo the installation if the car seat is not reclined correctly.

If your child cannot sit up unassisted, you may install the car seat slightly more reclined than the level line shows.

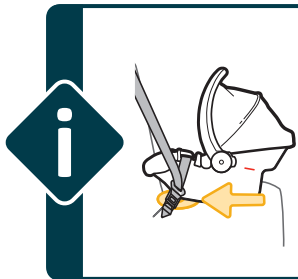

Only if necessary, you may place a tightly rolled towel(s) or foam pool noodle(s) under the front of the car seat base to help make the **Rear-Facing Level Line** parallel with the ground.

Check often to make sure padding is still in place and the belt is tight.

FINISHED!

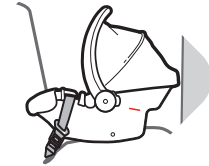
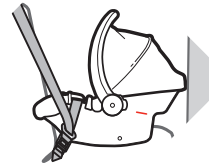

Lap/Shoulder Belt



Lap Belt

- ✓ **Vehicle Belt Install without Base:** See page 40.
- ✓ **LATCH: Lower Anchor Belt Install or Vehicle Belt Install with Base:** See page 33.

When using the passenger or driver-side locations, the car seat **MUST** be touching the back of the vehicle seat in front of it, or be as close as possible.



Removing Harness System



Only remove the harness system to clean the seat pad.

To remove accessories, see page 6.

1

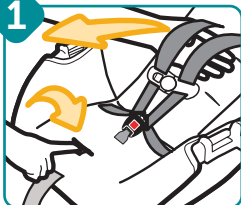

Fully loosen harness straps

2

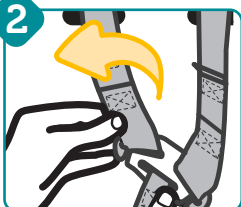

From back of car seat, remove harness strap loops from splitter plate

3

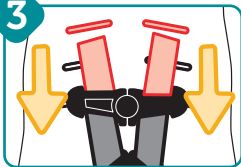

Pull harness strap out of shoulder harness slots

4

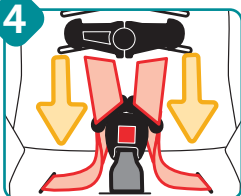

Unthread chest clip

5

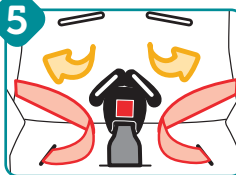

Unthread buckle
DO NOT unbuckle.

6

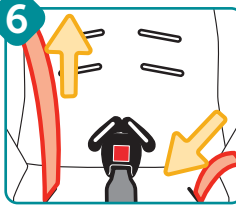

Pull harness strap out of seat

7

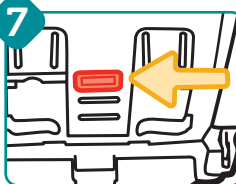

Turn car seat over

Locate the buckle's metal retainer on the bottom of the shell.

8

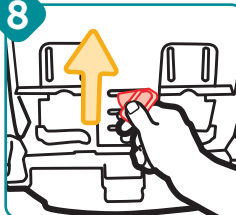

Rotate metal retainer and push it up through shell and pad as shown

9



From top of car seat, pull buckle out of shell



Removing Seat Pad Set for Cleaning



You **MUST** remove the harness system and the accessories to remove the seat pad for cleaning.

To remove accessories, see page 6.

To remove the harness system, see pages 46–47.

1

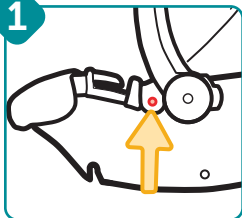

Release pad tabs

Pull down on the pad and pull the tab out of the shell.

Repeat for the other side.

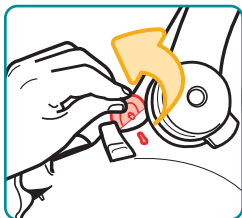

2

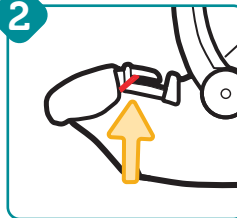

Release elastic straps

Pull the elastic strap off of the belt path guide as shown.

Repeat for the other side.

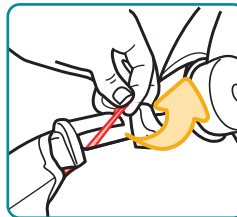

3

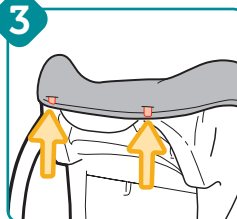

Pull pad off tabs from top of shell

4

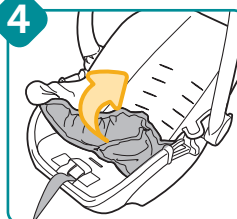

Remove pad from bottom of shell

Remove the pad from the shell.



Cleaning Pad and Accessories

Machine wash separately with cold water on a gentle cycle. Do not use bleach. Tumble dry separately for 10–12 minutes on low heat. Remove immediately.

Cleaning Harness Strap

Check the harness straps often for any wear or damage.

Spot clean using warm sudsy water and a damp cloth. Spilled food and liquids on the car seat may result in mold or bacterial growth over time. These spills could also attract insects or rodents.

Cleaning Buckle and Car Seat Shell

Spot clean using warm sudsy water and damp cloth. Do not submerge into water.

To Clean Canopy

Hand wash using warm sudsy water. Line dry.

Installing Seat Pad

1. Starting from the top of the car seat, slip the pad on the shell. Push the pad tabs at the top of the shell through the slots in the pad.
2. Pull the harness adjustment strap through the slot in the pad. Wrap the pad around the bottom of the shell.
3. Attach the tabs on the sides to the shell. Attach the elastic straps to the belt path guides.

Install the harness system. See pages 51–54.

WARNING

DO NOT use the child restraint without the seat pad or with damaged harness straps.



Insert buckle's metal retainer into buckle slot closest to child

The buckle **MUST** face out.

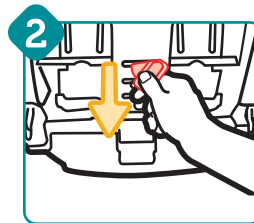

From bottom of car seat, pull metal retainer completely through pad and shell

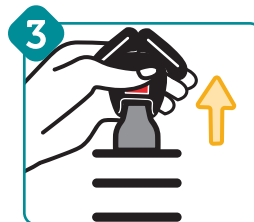

Check buckle

Pull up on the buckle to make sure it is secured.

The buckle **MUST NOT** pull out.

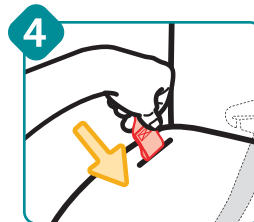

Thread harness strap

With the sewn end of the harness strap loop facing the buckle, thread the harness strap down through the hip harness slot.

5

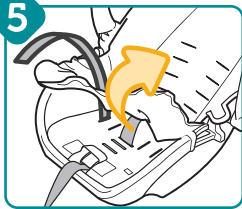

Pull up front of seat pad

6

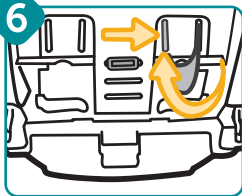

Weave harness strap in and out of shell as shown

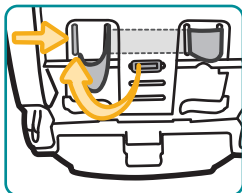
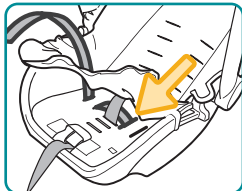

7

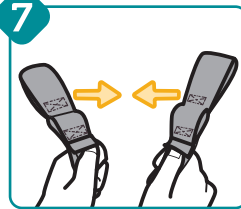

Make harness strap even

The sewn ends of the harness strap loops **must** face each other.

8

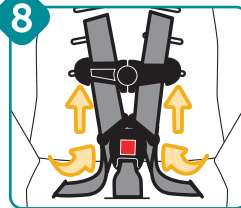

Thread buckle and chest clip

The harness strap ends go through the **back** of the buckle tongues and through the chest clip **front to back** as shown.

9

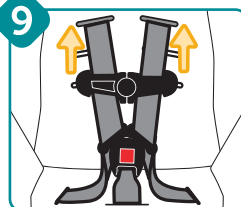

Thread harness straps into correct shoulder harness slots for your child

For **Rear-Facing Child Fit**, see page 8.



10

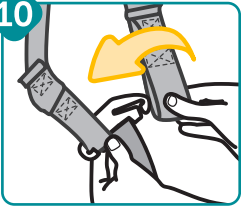

From back of car seat, attach 1st harness strap loops to splitter plate as shown

The sewn ends of the harness strap loops **MUST** face towards you.

DO NOT twist the harness strap or the harness adjustment strap.

Make sure the harness strap loops are fitted **completely on** both sides of the splitter plate.

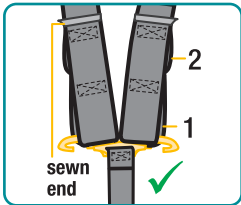

Check your child's fit often.

If you cannot achieve a snug harness fit for your child, see pages 14–16.

To learn how to check harness tightness, see pages 22–24.

Check the harness straps often for any wear or damage.

⚠️ WARNING

The harness system **MUST** be installed correctly. **DO NOT** use a child restraint with damaged harness straps.

This restraint is certified for aircraft use.

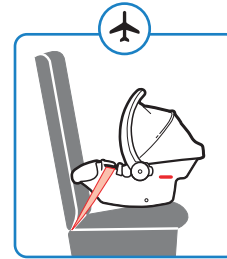

Rear-Facing Aircraft Installation

Follow the steps on pages 40–45.

You can only install this child restraint in the aircraft without the base.

Install the car seat in a window seat to avoid blocking the aisle. If the aircraft lap belt is too short, ask the flight attendant for a belt extender.

Use only on forward-facing aircraft seats. Contact the airline for their specific policies.

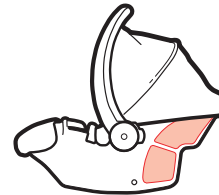

Some airlines may ask to see a label stating that this car seat is certified for aircraft use.

There is an airplane certification label located on the side of this car seat as shown.



⚠️ WARNING

NEVER take your child out of the child restraint while the vehicle is moving.

NEVER leave your child unattended. Placing your child in a hot child restraint may result in burns.

DO NOT use a child restraint with damaged or missing parts.

DO NOT use a child restraint with cut, frayed, or damaged harnesses.

DO NOT substitute parts or try to modify the child restraint in any way. **DO NOT** lubricate buckles and fasteners.

DO NOT use any child restraint accessory except those approved by Dorel Juvenile Group.

NEVER allow any child to play with this child restraint; it is not a toy.

DO NOT remove or cover up any of the warning labels or other labels on the child restraint.

This child restraint has been certified for use in passenger vehicles. **DO NOT** use in a boat, on a motorcycle, or in a cargo van or bus where there are no seat belts or tether anchors.

When installing with a base, only use this car seat with a compatible Safety 1st Infant Car Seat Base.

Read all instructions for additional warnings.



⚠️ WARNING



NEVER place a child rear-facing in a seating position with an active frontal air bag.

Check the vehicle owner's manual for more information about air bag/child restraint use.



Use the child restraint only on vehicle seats that face forward.



DO NOT use on seats that face the sides or rear of the vehicle.

For vehicles without a back seat, refer to your vehicle owner's manual.



According to accident statistics, children are safer when properly restrained in the rear seating positions than in the front seating positions.

Rear seating positions are statistically safer, whether you have air bags, advanced air bags, or no air bags at all.

If you are not sure where to place the car seat in your vehicle:

- Consult your vehicle owner's manual; **OR**
- Contact Dorel Juvenile Group Consumer Care Department; **OR**
- Visit your local Child Passenger Inspection Station. Go to <https://www.nhtsa.gov/equipment/car-seats-and-booster-seats> to find your closest station.



To avoid your child being seriously burned, take the following precautions:

- Park in the shade or where the sun does not directly hit the car seat.
- Cover the car seat with a sheet or blanket when not in use.
- Check for hot seat and buckles before placing child in car seat.

To help protect your vehicle seat's upholstery from damage: you may use an accessory approved by Dorel Juvenile Group or a single layer towel underneath and behind car seat.

WARNING

Check the vehicle belt or lower anchor belt before each use. Use only if the belt can be tightened properly and locked securely in place.

Even when unoccupied, this child restraint **MUST** be firmly secured to the vehicle with the lower anchor belt or with the vehicle seat belt.

In a crash or sudden stop, an unsecured child restraint could injure occupants.

DO NOT risk your child's safety.

To keep your child as safe as possible, Dorel Juvenile Group strongly recommends replacing the car seat even after a minor crash; even if it was not occupied at the time.

Replacement After a Minor Crash

The National Highway Traffic Safety Administration states that for a crash to be considered minor **ALL of the following MUST be true:**

- Vehicle able to drive away from the crash site; **AND**
- Vehicle door nearest the car seat was not damaged; **AND**
- No passengers were injured; **AND**
- Airbags did not deploy; **AND**
- There is no visible damage to the car seat.

If the crash your car seat was involved in meets **ALL** the criteria, you may not need to replace the car seat.

If one or more of these criteria are not true or if you are uncertain of any of your answers, replace the car seat immediately.

Replacement After a Moderate to Severe Crash

You **MUST** replace this car seat if it has been in a moderate to severe car crash.

This car seat is intended to protect a child in a single crash. During a crash, the car seat and all of its parts absorb crash energy which can deform or weaken it. Damage is not always visible. A damaged car seat must be replaced immediately.

Expiration

On the side of the car seat there is a date of manufacture label as shown.

DO NOT use this car seat more than 8 years after the date of manufacture.

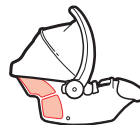



Please complete the postage-paid registration card that came with your child restraint, and send it to us. Child restraints could be recalled for safety reasons. You must register this restraint to be reached in a recall. Send your name, address, e-mail address if available and the restraint's model number and manufacturing date to:

Dorel Juvenile Group

P.O. Box 2609
Columbus, IN 47202

or call 1-800-544-1108 or register online at www.djgusa.com/registration/carseat/us.

For recall information, call the U.S. Government's Vehicle Safety Hotline at 1-888-327-4236 (TTY: 1-800-424-9153), or go to www.NHTSA.gov.

0515079 Tear Off and Mail This Part or Register Online 4348-0081D

Consumer: Just fill in your name, address and email. Please print (use dark ink).

Your Name

Your Street Address

City State Zip Code

Email Address (optional)

Model Number
AB123CDE

Model Name
S1 CARSEAT

Manufacture Date
2024/05/01

1#11-022-0035

Example of model number, line code, and manufacture date.

If you don't have the card or if your address changes, you will find the model number, manufacture date, and line code on the label located on side of shell.

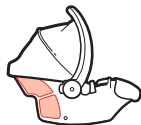

Dorel Juvenile Group, Inc. (DJG) warrants this product to the original retail purchaser as follows: This product is warranted against defective materials or workmanship for one year from the date of original purchase.

An original receipt is required to validate your warranty.

DJG will, at its option, provide replacement parts or replace this product. DJG reserves the right to substitute if the part or model has been discontinued.

To make a claim under this warranty, please contact our Consumer Care Department by phone: 1-800-544-1108 or text: 1-812-652-2525. Our hours of operation are from 8:00 a.m. to 6:00 p.m. EST Monday through Thursday and from 8:00 a.m. to 4:30 p.m. on Friday.

Proof of purchase is required and shipping charges are the responsibility of the consumer.

Warranty Limitations: This warranty does not include damages which arise from misuse or abuse of this product.

Limitation of Damages: The warranty and remedies as set forth are exclusive and in lieu of all others, oral or written, expressed or implied. In no event will DJG or the dealer selling this product be liable to you for any damages, including incidental or consequential damages, arising out of the use or inability to use this product.



Limitation of warranties and other warranty terms and state law rights: Any implied warranties, including implied warranties of the merchantability and fitness for a particular purpose, shall be limited to the duration and terms of the express written warranty.

Some states do not allow limitations as to how long an implied warranty lasts or the exclusion or limitation of incidental or consequential damages, so the above limitations may not apply to you.

This warranty gives you specific legal rights, and you may have other rights, which vary from state to state. Neither DJG nor the dealer selling this product authorized any person to create for it any other warranty, obligation, or liability in connection with this product.

1. If the car seat's buckle or harness release lever sticks or you cannot get the straps tight enough around your child:

Do not lubricate. Check around the lever and the retractor for dropped food, sticky spilled drinks, dirt, leaves, etc. Clean with warm water and/or remove the object with tweezers. If you cannot get the harness to adjust and remain tight with the buckle securely locked, **do not** use this car seat.

2. If your harness twists:

Straighten the harness each time you put your child in the car seat to help prevent twisting. Lock the buckle and tighten the harness so it will be ready for next use.

©2026 Dorel Juvenile Group, Inc. Safety 1st™ and the Safety 1st logo and design are trademarks of Dorel Juvenile Group, Inc. (800) 544-1108 www.safety1st.com. Styles, colors, and labeling may vary. Los estilos, colores y etiquetado pueden variar. Made in CHINA. Hecho en CHINA. Distributed by (distribuido por) Dorel Juvenile Group, Inc., 2525 State St., Columbus, IN 47201-7494. Dorel Juvenile Canada, 2233 Argentinia Road, Suite 110, Mississauga, ON L5N 2X7. Representante exclusivo en Chile: DOREL JUVENILE CHILE S.A. Av. del Parque 4161, oficina 602 A, Huechuraba, Santiago, Chile - Fono: 56 2 24971500 - www.infanti.cl - www.dorel.cl. Importado y distribuido en Perú por: COMEXA COMERCIALIZADORA EXTRANJERA S.A. SUCURSAL DEL PERÚ - Los Libertadores 455, San Isidro, Lima 27, Lima, Perú RUC 20431062870 - Fono: 4413029 - www.infanti.com.pe. En Centro América, Caribe y Ecuador por: Best Brands Group S.A. - Av. Balboa, Bay Mall Plaza, Planta Baja, local 9, Panamá. - Fono: (507) 300 2884. En Colombia por: Baby Universe S.A.S. - Vía 40 No. 77-29, Barranquilla, Colombia - Fono: (575) 353 1110 Importador: DJGM, S.A. DE C.V. Gabriel Mancera No. 1041 Col. Del Valle, Benito Juárez C.P. 03100 México, Ciudad de México R.F.C. DJG140305GN9 Tel. (55) 67199202