

CAT900108

paulin[®]

PINS AND CLIPS

shop.hillmangroup.ca

**SAFETY, COTTER, CLEVIS PINS
HITCH PIN CLIPS
SLOTTED SPRING PINS
TAPER PINS
CLEVIS YOKES
And more...**

HILLMAN[™]



At The Hillman Group, we stock a comprehensive range of standard and non-standard fasteners, hardware, fittings, fluid flow components and automotive products under our Hillman, Paulin, Papco, Dominion, and Pro-Tip family of brands. Our range of products are complimented by our ability to source any item in the required size and material for any type of project. Let us help standardize your range of products or create new programs with the help from our dynamic and vibrant organization. For over 100 years, the Paulin® brand has been recognized as an industry leader. Our customers are retailers, original equipment manufacturers, industrial and automotive aftermarket distributors, and plumbing and gas wholesalers.

The Hillman Group has been a customer-first organization that built a loyal customer base centred on trust, dedication and long-lasting relationships. Paulin® being the First In Fasteners, we look forward to being The Right Fastening Choice for you.

Our five strategically situated warehouses in Vancouver, Edmonton, Winnipeg, Toronto and Montreal are conveniently located to provide courteous service to all of our customers.

The items listed in our catalogue are a representation of the products available and stocked in our distribution network. Our availability may not represent all sizes available or certain applications required. Please contact your local Hillman customer service or sales representative for additional product inquiries. Our knowledgeable staff will provide you with information and solutions that are both cost effective and reliable.



TABLE OF CONTENTS **PAGE**

Cotter Pins

- Zinc Plated 5
- Bright Electro-Plated With Chromate Finish 6, 7
- 18.8 Stainless Steel 8
- Brass 9
- Assortment 10

Hammer-Lock Cotter Pins 11

Safety Pins 12

Linch Pins 12

Clevis Yokes 13

Universal Clevis Pins 14

Universal Clevis Pin With Hitch Pin Clip 15

Clevis Pins

- Bare 16
- 18.8 Stainless Steel 17

Hitch Pin Clips 18

Hitch Pins 19

Slotted Spring Pins

- High-Carbon 20, 21
- Assortment 22
- 420 Stainless Steel 23

Taper Pins 24

Garage Assortment 25

PACKAGING TYPES AVAILABLE

Clamshells



Cards



Black Boxes



Case Boxes



165
Series

Papco® COTTER PINS

PART CLASS #
808AC |

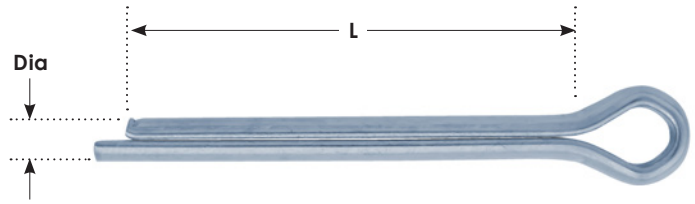

Papco® steel **COTTER PINS** are made in the extended prong style for easy insertion and locking. The length is measured under the head to the end of the shortest leg. Packaging is in standard packages of 100 pieces and all Cotter Pins are bright plated.

L = Length

Dia = Diameter

ORDER BY ITEM (PACKAGE) NUMBER

ZINC PLATED			
Dia x L	Approx. Weight (lb)/100 pcs	Black Box #	Qty
5/16 x 1	3.2600	165-444	100
5/16 x 1-1/2	4.0300	165-448	100
5/16 x 2	5.0400	165-451	100
5/16 x 2-1/4	5.1850	165-452	100
5/16 x 2-1/2	5.3300	165-453	100
5/16 x 3	5.8550	165-455	100
5/16 x 3-1/2	6.5000	165-457	100
5/16 x 4	7.2050	165-459	100
5/16 x 5	8.5000	165-461	100
3/8 x 1-1/2	6.1800	165-493	100
3/8 x 2	6.6700	165-496	100
3/8 x 2-1/2	7.8450	165-498	100
3/8 x 3	8.0000	165-500	100
3/8 x 3-1/2	9.8600	165-502	100
3/8 x 4	10.6900	165-504	100
3/8 x 5	13.3000	165-506	100
3/8 x 6	16.0000	165-509	100
1/2 x 2	22.7805	165-586	100
1/2 x 3	25.0291	165-590	50
1/2 x 3-1/2	25.4031	165-592	100
1/2 x 4	26.1513	165-594	50
1/2 x 5	27.6475	165-596	100
1/2 x 6	30.6400	165-599	25
1/16 x 1	0.1000	165-647	20
3/32 x 1-1/2	0.3000	165-695	20
1/8 x 1-1/2	0.6000	165-745	10
1/8 x 2	0.7000	165-748	10
5/32 x 2	1.3000	165-774	5
5/32 x 2-1/2	1.3000	165-776	5
3/16 x 1-1/2		165-797	5
3/16 x 2	2.0000	165-800	5
3/16 x 2-1/2	2.1000	165-802	5

GARAGE ASSORTMENT

No. 020-033

Contains 340 Cotter Pins, 7 sizes from 1/16" x 3/4" to 5/32" x 2". Packed in handy, clear plastic container. All bright plated.

020-033



165 Series **papco** **COTTER PINS**

PART CLASS #
808AC |

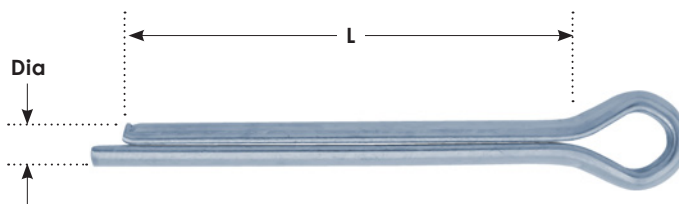

Papco® steel **COTTER PINS** are made in the extended prong style for easy insertion and locking. The length is measured under the head to the end of the shortest leg. Packaging is in standard packages of 100 pieces and all Cotter Pins are bright plated.

L = Length

Dia = Diameter

ORDER BY ITEM (PACKAGE) NUMBER

Product not available in this pack size

BRIGHT ELECTRO-PLATED WITH CHROMATE FINISH							
Dia x L	Approx. Weight (lb)/100 pcs	Clamshell #	Qty	Handy Pak #	Qty	Black Box #	Qty
1/32 x 1/2	0.0450	—	—	—	—	165-019	100
3/64 x 1/2	0.0500	—	—	—	—	165-030	100
1/16 x 1/2	0.0600	—	—	—	—	165-043	100
1/16 x 3/4	0.0700	—	—	023-702	92	165-045	100
1/16 x 1	0.0850	009-182	30	023-703	84	165-047	100
1/16 x 1-1/4	0.1100	—	—	—	—	165-049	100
1/16 x 1-1/2	0.1200	009-183	22	023-705	71	165-051	100
1/16 x 1-3/4	0.1650	—	—	—	—	165-053	100
1/16 x 2	0.2000	—	—	—	—	165-054	100
5/64 x 3/4	0.0950	—	—	—	—	165-065	100
5/64 x 1	0.1450	—	—	—	—	165-067	100
3/32 x 1/2	0.1250	—	—	023-707	71	165-087	100
3/32 x 3/4	0.1700	—	—	023-708	77	165-089	100
3/32 x 1	0.2100	009-184	20	023-709	74	165-091	100
3/32 x 1-1/4	0.2700	009-185	18	023-710	65	165-093	100
3/32 x 1-1/2	0.3200	009-186	16	023-711	59	165-095	100
3/32 x 1-3/4	0.3700	—	—	—	—	165-097	100
3/32 x 2	0.3700	009-187	12	—	—	165-098	100
3/32 x 2-1/2	0.4200	—	—	—	—	165-100	100
7/64 x 1	0.3600	—	—	—	—	165-115	100
7/64 x 1-1/2	0.4000	—	—	—	—	165-119	100
7/64 x 2	0.5650	—	—	—	—	165-122	100
1/8 x 1/2	0.4000	—	—	—	—	165-137	100
1/8 x 3/4	0.3350	—	—	—	—	165-139	100
1/8 x 1	0.4400	—	—	023-715	53	165-141	100
1/8 x 1-1/4	0.4500	009-188	12	023-716	50	165-143	100
1/8 x 1-1/2	0.6700	009-189	12	023-717	45	165-145	100
1/8 x 1-3/4	0.6250	—	—	—	—	165-147	100
1/8 x 2	0.6900	009-190	10	023-718	37	165-148	100
1/8 x 2-1/2	0.8600	—	—	—	—	165-150	100

165
Series

papco COTTER PINS

PART CLASS #
808AC |

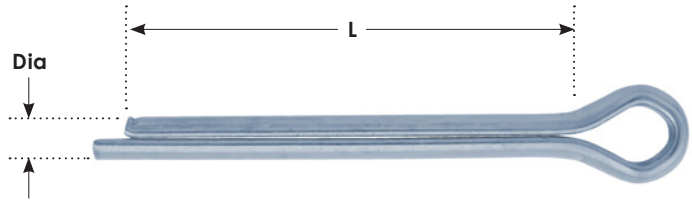

Papco® steel **COTTER PINS** are made in the extended prong style for easy insertion and locking. The length is measured under the head to the end of the shortest leg. Packaging is in standard packages of 100 pieces and all Cotter Pins are bright plated.

L = Length

Dia = Diameter

ORDER BY ITEM (PACKAGE) NUMBER

Product not available in this pack size

BRIGHT ELECTRO-PLATED WITH CHROMATE FINISH							
Dia x L	Approx. Weight (lb)/100 pcs	Clamshell #	Qty	Handy Pak #	Qty	Black Box #	Qty
1/8 x 3	1.0000	—	—	—	—	165-152	100
5/32 x 3/4	0.6300	—	—	—	—	165-165	100
5/32 x 1	0.6200	—	—	—	—	165-167	100
5/32 x 1-1/4	0.7500	—	—	—	—	165-169	100
5/32 x 1-1/2	0.8900	009-191	10	023-722	30	165-171	100
5/32 x 1-3/4	1.0000	—	—	—	—	165-173	100
5/32 x 2	1.3300	009-192	8	023-723	24	165-174	100
5/32 x 2-1/2	1.6000	—	—	—	—	165-176	100
5/32 x 3	2.0000	—	—	—	—	165-178	100
3/16 x 3/4	0.8000	—	—	—	—	165-191	100
3/16 x 1	0.9700	—	—	—	—	165-193	100
3/16 x 1-1/4	1.0950	—	—	—	—	165-195	100
3/16 x 1-1/2	1.2850	009-193	6	—	—	165-197	100
3/16 x 1-3/4	1.6000	—	—	—	—	165-199	100
3/16 x 2	1.6050	009-194	6	—	—	165-200	100
3/16 x 2-1/4	1.6600	—	—	—	—	165-201	100
3/16 x 2-1/2	1.8000	—	—	—	—	165-202	100
3/16 x 3	2.5300	—	—	—	—	165-204	100
3/16 x 3-1/2	2.6000	—	—	—	—	165-206	100
3/16 x 4	2.6700	—	—	—	—	165-208	100
1/4 x 1	2.1350	—	—	—	—	165-309	100
1/4 x 1-1/4	2.3400	—	—	—	—	165-311	100
1/4 x 1-1/2	2.0000	—	—	—	—	165-313	100
1/4 x 1-3/4	2.6700	—	—	—	—	165-315	100
1/4 x 2	3.0500	—	—	—	—	165-316	100
1/4 x 2-1/4	2.6200	—	—	—	—	165-317	100
1/4 x 2-1/2	3.3000	—	—	—	—	165-318	100
1/4 x 3	3.5950	—	—	—	—	165-320	100
1/4 x 3-1/2	4.4600	—	—	—	—	165-322	100
1/4 x 4	5.0000	—	—	—	—	165-324	100

5080 Series **papco** **COTTER PINS**

PART CLASS #
808AD |

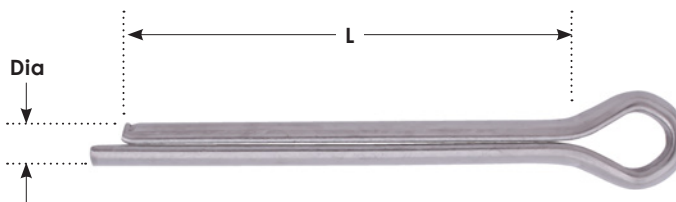

Papco® steel **COTTER PINS** are made in the extended prong style for easy insertion and locking. The length is measured under the head to the end of the shortest leg. Packaging is in standard packages of 100 pieces and all Cotter Pins are bright plated.

L = Length

Dia = Diameter

ORDER BY ITEM (PACKAGE) NUMBER

18.8 STAINLESS STEEL			
Dia x L	Approx. Weight (lb)/100 pcs	Black Box #	Qty
1/32 x 1/2		5080-019	100
1/16 x 1/2	0.0400	5080-043	100
1/16 x 3/4	0.0550	5080-045	100
1/16 x 1	0.0750	5080-047	100
1/16 x 1-1/4		5080-049	100
1/16 x 1-1/2	0.1100	5080-051	100
1/16 x 1-3/4	0.1350	5080-053	100
1/16 x 2		5080-054	100
3/32 x 1/2	0.1250	5080-087	100
3/32 x 3/4	0.1650	5080-089	100
3/32 x 1	0.2000	5080-091	100
3/32 x 1-1/4	0.2550	5080-093	100
3/32 x 1-1/2	0.2950	5080-095	100
3/32 x 1-3/4		5080-097	100
3/32 x 2	0.3750	5080-098	100
3/32 x 2-1/2		5080-100	100
1/8 x 1/2		5080-137	100
1/8 x 3/4	0.3350	5080-139	100
1/8 x 1	0.4050	5080-141	100
1/8 x 1-1/4	0.5200	5080-143	100
1/8 x 1-1/2	0.5750	5080-145	100
1/8 x 1-3/4	0.6350	5080-147	100
1/8 x 2	0.7300	5080-148	100
1/8 x 2-1/2	0.8800	5080-150	100
1/8 x 3	1.0000	5080-152	100
5/32 x 1		5080-167	100
5/32 x 1-1/4	0.8200	5080-169	100
5/32 x 1-1/2	0.9750	5080-171	100
5/32 x 1-3/4	1.0000	5080-173	100
5/32 x 2	1.3300	5080-174	100
5/32 x 2-1/2	1.4400	5080-176	100

18.8 STAINLESS STEEL			
Dia x L	Approx. Weight (lb)/100 pcs	Black Box #	Qty
5/32 x 3	1.6120	5080-178	100
3/16 x 1	8.0000	5080-193	50
3/16 x 1-1/4	1.3300	5080-195	50
3/16 x 1-1/2	1.3300	5080-197	50
3/16 x 1-3/4	1.3300	5080-199	50
3/16 x 2	1.6700	5080-200	50
3/16 x 2-1/2	2.0800	5080-202	50
3/16 x 3	2.4600	5080-204	50
3/16 x 3-1/2		5080-206	50
3/16 x 4	3.0000	5080-208	50
1/4 x 1		5080-307	50
1/4 x 1-1/4		5080-311	50
1/4 x 1-1/2		5080-313	50
1/4 x 2	2.6700	5080-316	50
1/4 x 2-1/2	3.5000	5080-318	25
1/4 x 3	4.1200	5080-320	25
1/4 x 3-1/2		5080-322	25
1/4 x 4	5.6400	5080-324	25
5/16 x 1		5080-444	50
5/16 x 2-1/2		5080-453	25
5/16 x 3		5080-455	25
5/16 x 3-1/2		5080-457	25
3/8 x 2		5080-496	25
3/8 x 3		5080-500	25
3/8 x 5		5080-506	25
3/32 x 1	0.2200	5080-691	50
1/8 x 1	0.4300	5080-741	50
1/8 x 1-1/2	0.4900	5080-745	50
1/8 x 2	0.7000	5080-748	25
5/32 x 1-1/2	0.9800	5080-771	25
3/16 x 1	1.1000	5080-793	25
3/16 x 2	1.8000	5080-800	25

020
Series

papeco COTTER PINS

UTILITY ASSORTMENT

No. 020-313

This Assortment of 1,000 Cotter Pins, in 10 popular sizes packed in individual compartments. Container is sturdy fibreboard with a hinged lid.

All bright plated.



020-313



UTILITY ASSORTMENT

No. 020-343

This assortment contains 195 large size Cotter Pins – 9 sizes from 5/32" x 2" to 3/8" x 3". Packed in a sturdy fibreboard container each size in an individual compartment. Useful for Agricultural and Construction Equipment.

All bright plated.

020-343

MASTER ASSORTMENT

No. 020-618

Contains 1230 Plated Cotter Pins, 20 sizes from 1/16" x 1/2" to 3/16" x 2". Packed in a metal, hinged lid box with moulded plastic compartments. Retail codes shown on lid label. Size: 9-3/4" W x 13-3/4" L x 2" D.



020-618



SUPER SERVICE ASSORTMENT

No. 020-805

Contains 3345 Plated Cotter Pins and Throttle Rod Retainers – 32 items. Large size, rigid metal box with high-strength plastic compartments. Large Size: 12" W x 18" L x 3" D.

For more details see page 10.

020-805

167
Series

papeo® HAMMER-LOCK COTTER PINS

PART CLASS #
808AC |

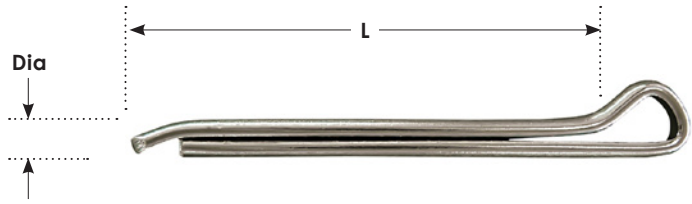

HAMMER-LOCK COTTER PINS spread automatically when hit with a hammer. The shorter shank rides over the up-turned point of the longer and locks rigidly. Twisting with a screwdriver returns pin to its original position. May also be used as standard Cotter Pins if desired.

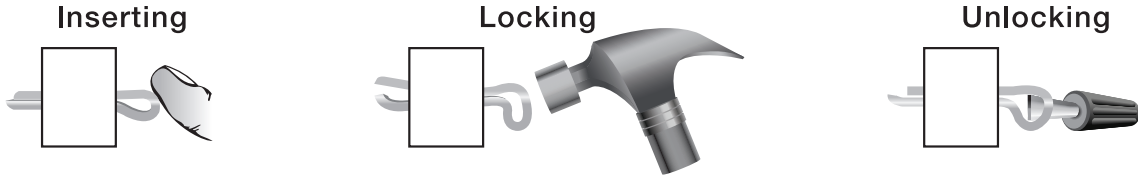

L = Length

Dia = Diameter

ORDER BY ITEM (PACKAGE) NUMBER

ZINC PLATED		
Dia x L	Black Box #	Qty
1/16 x 3/4	167-045	100
1/16 x 1	167-047	100
1/16 x 1-1/2	167-051	100
3/32 x 3/4	167-089	100
3/32 x 1	167-091	100
3/32 x 1-1/2	167-095	100
1/8 x 1	167-141	100
1/8 x 1-1/2	167-145	100
1/8 x 2	167-148	100
5/32 x 1-1/2	167-171	100
5/32 x 2	167-174	100

UTILITY ASSORTMENT

No. 020-314

Contains 800 Cotter Pins in the 10 popular sizes listed above. Each size is in an individual compartment in the sturdy fibreboard container. All bright plated.



020-314

126 Series **papco SAFETY PINS**

PART CLASS #
808A1 |

Papco® **SAFETY PINS** are made from hard drawn plated spring wire and afford positive locking action for retaining Clevis and other types of pins. Used on farm equipment, industrial applications, trucks etc. wherever safety is an issue.

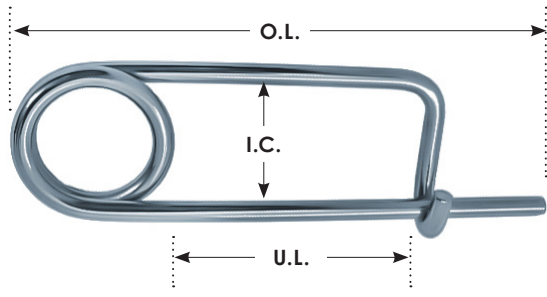

I.C. = Inside Clearance O.L. = Overall Length U.L. = Usable Length

ORDER BY ITEM (PACKAGE) NUMBER

PLATED SPRING WIRE					
Inside Clearance	Approx. Weight (lb)/100 pcs	Overall Length	Usable Length	Black Box #	Qty
3/8	0.75	1-3/4	1-1/16	126-932	10
5/8	1.8500	2-3/4	1-11/16	126-934	10
13/16		4-3/8	2-13/16	126-936	10
1-1/8	10.4500	5-3/4	3-3/4	126-938	10

126 Series **papco LINCH PINS**

PART CLASS #
808A1 |

Papco® **LINCH PINS**. Reliable and easy to use, our Linch Pins provide secure fastening and peace of mind in diverse industries.

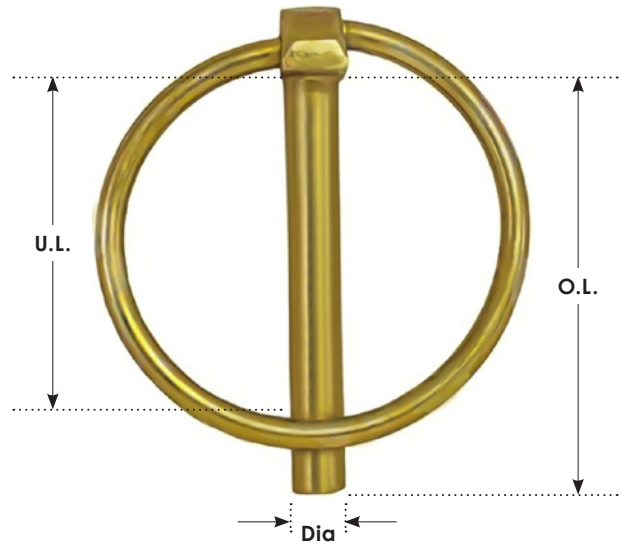

Dia = Diameter O.L. = Overall Length U.L. = Usable Length

ORDER BY ITEM (PACKAGE) NUMBER

ZINC					
Dia	Approx. Weight (lb)/100 pcs	Overall Length	Usable Length	Black Box #	Qty
3/16	2.8000	1-5/8	1-9/16	126-980	10
1/4	5.0000	1-5/8	1-3/4	126-982	10
5/16	6.7000	1-5/8	1-3/4	126-984	10
7/16	11.2500	1-5/8	1-3/4	126-986	10

255
Series

papco CLEVIS YOKES

PART CLASS #
808AA |

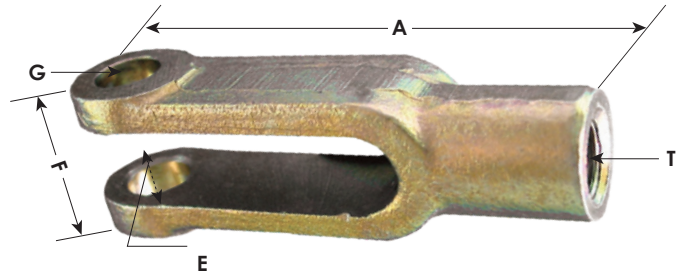

Papco® **CLEVIS YOKES** are supplied in five sizes to service all popular cars and trucks. A Yoke Assembly includes the Yoke, Clevis Pin and Cotter Pin. Standard package consists of 6 Clevis Yoke Assemblies.

Drop forged. UNF Fine Thread.

ORDER BY ITEM (PACKAGE) NUMBER

Standard Package: 6 Assemblies

STOCK No.	Size Chart					Used with S.A.E. Standard Pins	
	G	A	T	E	F	Clevis Pins	Cotter Pins
255-026	1/4	2	1/4	9/32	5/8	255-244	1/16 x 1/2
255-027	5/16	2-1/4	5/16	11/32	3/4	255-226	3/32 x 1/2
255-028	3/8	2-1/2	3/8	7/16	7/8	255-236	3/32 x 3/4
255-029	7/16	2-7/8	7/16	1/2	1	255-241	3/32 x 1
255-030	1/2	3	1/2	9/16	1	255-245	1/8 x 1

255 Series

009 Series

papeo UNIVERSAL CLEVIS PINS

PART CLASS # 808AA |

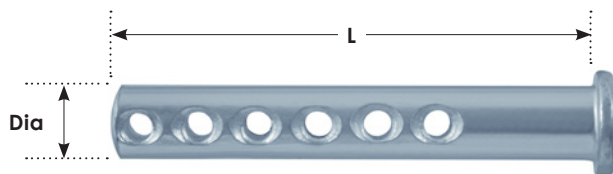

Each diameter has multiple **COTTER PIN** holes to provide wide range of grip lengths. Reduces the number of pins required for emergency coverage for cars, trucks and farm implements.

L = Length

Dia = Diameter

ORDER BY ITEM (PACKAGE) NUMBER

Product not available in this pack size

ZINC PLATED					
Dia x L	Approx. Weight (lb)/100 pcs	Clamshell #	Qty	Black Box #	Qty
1/4 x 2	2.667	009-326	2	255-044	6
5/16 x 2	4.167	009-327	2	255-054	6
3/8 x 2	6.000	009-328	2	255-064	6
7/16 x 2	8.333	—	—	255-074	6
7/16 x 3	12.667	—	—	255-076	6
1/2 x 2	10.833	—	—	255-084	6
1/2 x 3	16.583	—	—	255-086	6
5/8 x 3	26.200	—	—	255-106	6
3/4 x 3	39.917	—	—	255-126	6

UTILITY ASSORTMENT

No. 020-329

Contains 24 Universal Clevis Pins in 6 popular sizes. Packed in a sturdy fibreboard container.



020-329

GARAGE ASSORTMENT

No. 020-061

Contains 5 each of 255-044, 054, 064 Universal Clevis Pins. Each size in an individual compartment in a rigid plastic box.



020-061

255
Series

papeco® UNIVERSAL CLEVIS PIN WITH HITCH PIN CLIP

PART CLASS #
808AC |

Convenient skin-packed card contains one **UNIVERSAL CLEVIS PIN** and one **HITCH PIN CLIP**.

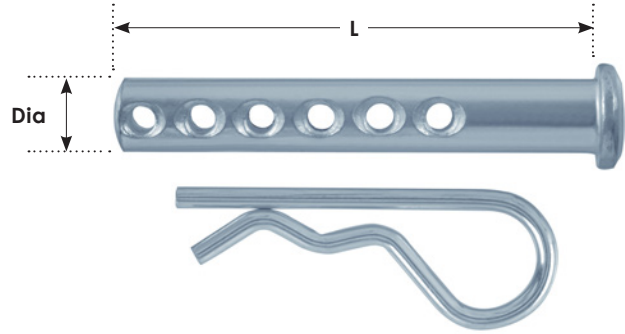

L = Length

Dia = Diameter

ORDER BY ITEM (PACKAGE) NUMBER

ZINC PLATED				
Dia x L	Approx. Weight (lb)/100 pcs	Card #	Qty	Hitch Pin Clip
1/4 x 2	1.000	255-171	2	255-303
5/16 x 2	3.500	255-173	2	255-303
3/8 x 2	3.250	255-175	2	255-307
7/16 x 2	4.750	255-177	2	255-311
7/16 x 3	6.500	255-178	2	255-311
1/2 x 2	5.500	255-179	2	255-303
1/2 x 3	8.250	255-180	2	255-303
5/8 x 3	13.750	255-182	2	255-307
3/4 x 3	17.666	255-185	2	255-311

SUPER SERVICE ASSORTMENT

No. 020-816

Contains 173 Standard and Universal Clevis Pins and Clips — 40 items.

Large size, rigid metal box with high-strength plastic compartments. Size: 12" W x 18" L x 3" D.

For more details see page 10.

020-816



5181
Series

papco® CLEVIS PINS

PART CLASS #
808AB |

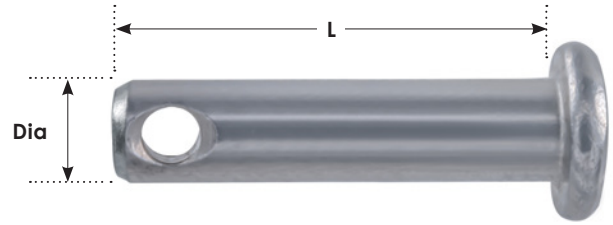

Papco® **CLEVIS PINS** excel at absorbing lateral stress and facilitating rotational movement for supported objects. These versatile pins are extensively employed in various industries, including automotive, maritime, aerospace, agriculture, and construction.

L = Length

Dia = Diameter

ORDER BY ITEM (PACKAGE) NUMBER

18.8 STAINLESS STEEL			
Dia x L	Approx. Weight (lb)/100 pcs	Black Box #	Qty
3/16 x 5/8	0.7500	5181-190	6
3/16 x 1	1.1667	5181-193	6
1/4 x 3/4	1.5000	5181-305	6
1/4 x 1	1.7500	5181-307	6
5/16 x 3/4	2.0833	5181-440	6
5/16 x 1	2.7500	5181-444	6

MASTER ASSORTMENT

No. 020-641

This well-balanced assortment is packed in a sturdy, welded, metal box with moulded plastic compartments. Each size of Clevis Pin is in an individual compartment. Complete specifications are shown on the grease-resistant lid label.



020-641

255
Series

papco HITCH PIN CLIPS

PART CLASS #
808AG |

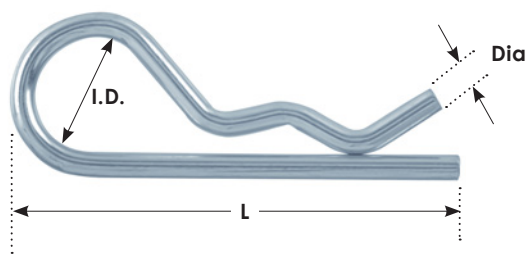

Papco® **HITCH PIN CLIPS** are made of oil-tempered spring steel wire and are bright plated. Used on agricultural implements, lawn mowers, snowmobiles, construction and automotive equipment.

L = Length Dia = Diameter I.D. = Inside Diameter

ORDER BY ITEM (PACKAGE) NUMBER

ZINC PLATED						
Dia x L	Approx. Weight (lb)/100 pcs	Fit Shaft Dia.		I.D. of Eye	Black Box #	Qty
		Min.	Max.			
3/32 x 1-5/8	1.2500	1/4	1/2	5/16	255-303	25
3/16 x 3-1/4	94.0000	5/8	1	7/8	255-306	25
3/32 x 2-5/16	1.0600	1/4	5/5	5/8	255-307	25
3/16 x 3-3/4	7.0000	7/8	1-1/4	7/8	255-308	25
5/32 x 3-5/16	4.0000	3/4	1-1/8	3/4	255-309	25
5/32 x 2-15/16	3.5600	5/8	1	3/4	255-310	25
1/8 x 2-9/16	2.1200	7/16	3/4	7/16	255-311	25
3/32 x 1-3/16	0.4200	1/4	3/8	1/4	255-313	25
3/32 x 2-1/2	1.1000	3/8	3/4	7/16	255-314	25
1/8 x 1-3/4	1.3200	1/2	3/4	7/16	255-316	25
1/4 x 4-3/8	12.6000	1	1-1/2	3/4	255-319	25
5/16 x 3-15/16	19.2400	1	1-1/2	7/8	255-320	25
3/64 x 5/8	0.1320	1/8	3/16	1/8	255-321	25
5/64 x 1-3/32	0.3600	5/16	3/8	9/64	255-325	25
1/32 x 7/16	0.0600	7/64	9/64	5/16	255-326	25



GARAGE ASSORTMENT

No. 020-073

Contains 40 Hitch Pin Clips, 6 sizes. Packed in a clear plastic box.

020-073

126
Series

papco HITCH PINS

PART CLASS #
808AG |

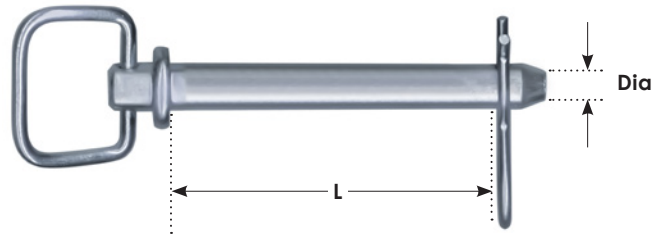

Papco® **HITCH PIN CLIPS** are made of oil-tempered spring steel wire and are bright plated. Used on agricultural implements, lawn mowers, snowmobiles, construction and automotive equipment.

L = Length

Dia = Diameter

ORDER BY ITEM (PACKAGE) NUMBER

ZINC PLATED			
Dia x L	Approx. Weight (lb)/100 pcs	Black Box #	Qty
1/2 x 4-3/4	43.4000	126-912	5
5/8 x 4-3/4	62.6000	126-914	5
5/8 x 6-1/2	80.8000	126-916	5
3/4 x 5	89.8000	126-918	5
3/4 x 7	115.0000	126-920	5
7/8 x 7-1/2	162.7000	126-922	5
1 x 7-3/4	214.4000	126-924	5

UTILITY ASSORTMENT

No. **020-338**

Contains 105 Hitch Pin Clips, 8 sizes. Packed in a sturdy, fibreboard container with individual compartments.

020-338



020
Series

papeco **SLOTTED SPRING PIN ASSORTMENTS**

Automotive uses include drive shaft coupling pins, gear shift lever pins, pump shaft pins, window regulator pins, door handle retaining pins, automatic transmission pins, etc. Also used in Agricultural Machinery and Farm equipment.

UTILITY ASSORTMENT

No. 020-319

Contains 116 pins, 12 sizes. Packed in a sturdy fibre board box with illustrated lid label showing retail price codes.



020-319

MASTER ASSORTMENT

No. 020-642

Contains 275 Pins, 20 popular sizes in a metal box with moulded plastic compartments, hinged lid, carrying handle and safety snap lock. Useful for construction and farm equipment dealers. Size: 9-3/4" W x 13-3/4" L x 2" D.



020-642

SUPER SERVICE ASSORTMENT

No. 020-819

Contains 770 Spring Pins - 32 sizes. Large size, rigid metal box with high-strength plastic compartments.

Size: 12" W x 18" L x 3" D.

For more details see page 10.



020-819

5079
Series



SLOTTED SPRING PINS

PART CLASS #
808AJ |

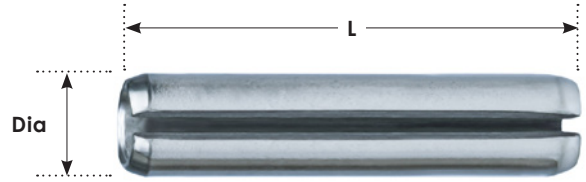

Our high-quality stainless steel **SLOTTED SPRING PINS**, designed to provide exceptional strength, reliability, and versatility for various industrial and mechanical applications. These pins are meticulously engineered to meet the demanding needs of fastening, aligning, and securing components, making them an indispensable solution for professionals and DIY enthusiasts alike.

L = Length

Dia = Diameter

ORDER BY ITEM (PACKAGE) NUMBER

420 STAINLESS STEEL		
Dia x L	Black Box #	Qty
1/16 x 1/2	5079-043	50
1/16 x 3/4	5079-045	50
3/32 x 3/4	5079-089	50
3/32 x 1	5079-091	50
5/32 x 1	5079-167	50
3/16 x 1/2	5079-189	50
3/16 x 3/4	5079-191	50
3/16 x 1	5079-193	50
3/16 x 2	5079-200	50
1/4 x 3/4	5079-307	50
3/8 x 1-1/2	5079-493	50
3/8 x 2-1/2	5079-498	50

020
Series

papeco GARAGE ASSORTMENT

GARAGE ASSORTMENT

No. 020-050

Contains 46 Taper Pins. 18 sizes from 312-001 to 020. Needed in every garage. Packed in plastic box.

020-050



GARAGE ASSORTMENT

No. 020-051

For farm Equipment use. Contains 36 Taper Pins. 10 sizes from 312-014 to 025. These large size pins are for Tractor and Farm Implement use. Combine with assortment no. 020-050 for complete coverage.

020-051



MASTER ASSORTMENT

No. 020-610

Contains 100 Taper Pins 20 sizes from 2/0 x 1" to No. 6 x 3". Packed in an all metal container with hinged lid and carrying handle.

020-610





TORONTO

900 Passmore Avenue, Toronto, ON, M1X 0C6
Tel: 416-694-3351
Fax: 416-981-7956

LAVAL

2591 Debray Street Laval, QC H7S 2J4
Tel: 1-450-688-4292
Fax: 1-450-688-4750

EDMONTON

17306 129th Avenue Edmonton, AB T5V 0C7
Tel: 1-800-262-9026
Fax: 1-780-900-0463

WINNIPEG

1670-A Inkster Blvd. Winnipeg, MB. R2X 2W8
Tel: 1-204-694-3802
Fax: 1-204-694-3804

VANCOUVER

3179 Thunderbird Cres. Burnaby, BC V5A 3G1
Tel: 1-604-421-3096
Fax: 1-604-357-1112

The Hillman Group Canada ULC

HILLMAN™