

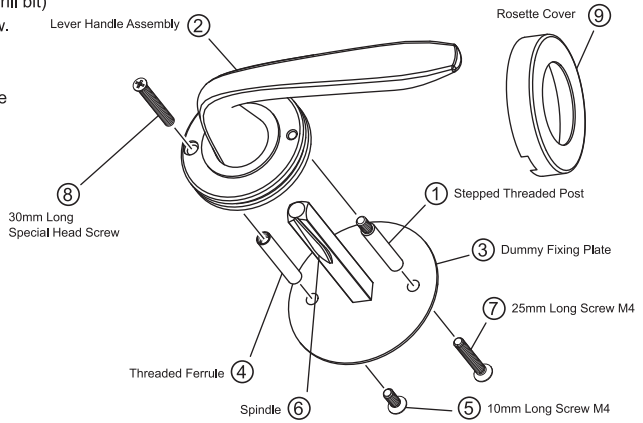

# Installation Instructions for Moda and Element Series Dummy Levers

Note: Notch in rosette cover should point to floor – refer diagram.

1. Drill one 15mm hole (using spade bit) through the door and two 6mm holes (using drill bit) through the door at required distance (backset) from door edge-refer template below.
2. Fit the stepped threaded post (1) to the threaded hole in the underside of the lever handle assembly (2).
3. On the dummy fixing plate (3), fix the threaded ferrule (4) to the fixing plate using the 10mm long screw (5).
4. Fit the dummy fixing plate to the door, and fit the lever handle assembly onto the spindle.
5. Fit the 25mm screw (7) through the fixing plate and into the stepped threaded post. Now fit the 30mm long special headed screw (8) through the lever handle assembly into the threaded ferrule. Tighten both of the mounting screws.
6. Slide the rosette cover (9) over the lever (ensuring notch in rosette cover is pointing to the floor) and fix into position (refer to diagram).



**NOTE:** Carefully follow these instructions when installing. Screws to be tightened to a recommended 2.5Nm torque.



FOLD HERE

FOLD HERE

Fit here on door edge

Fit here on door edge

template

6mm hole

15mm hole

6mm hole

BACKSET 60mm (2 3/8")

BACKSET 70mm (2 3/4")



schlage.co.nz

PDSC0050 JULY 19



ZINC 5000 JUNE 19