

SECTION A-A

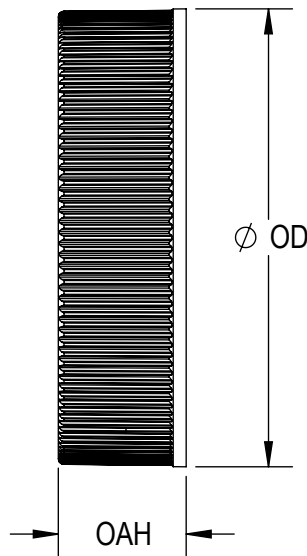

<b>Material</b>	Polypropylene	<b>Style</b>	RMX (Ribbed - Matte)
<b>Part Weight</b>	2.80 ± 0.30 g	<b>Static Torque</b>	17-26 in-lbs

**PART DIMENSIONS**

<b>E</b>	1.394 in (35.41 mm)	<b>Tolerance</b>	±0.010 in (±0.25 mm)
<b>T</b>	1.487 in (37.77 mm)	<b>Tolerance</b>	±0.010 in (±0.25 mm)
<b>H</b>	0.391 in (9.93 mm)	<b>Tolerance</b>	±0.010 in (±0.25 mm)
<b>OAH</b>	0.440 in (11.18 mm)	<b>Tolerance</b>	±0.010 in (±0.25 mm)
<b>OD</b>	1.595 in (40.51 mm)	<b>Tolerance</b>	±0.010 in (±0.25 mm)

**THREAD DETAILS**

<b>Threads Per Inch</b>	6	<b>Pitch</b>	0.167 in (4.24 mm)
<b>Thread Type</b>	Continuous Thread (CT)	<b>Bottle Landing</b>	0.050 in minimum
<b>Rib Detail</b>	128 equispaced ribs	<b>Surface Finish</b>	Ribbed side / matte top
<b>Gate Location</b>	Side		

**RECOMMENDED NECK FINISH**

<b>E</b>	1.370 in (34.80 mm)	<b>Tolerance</b>	±0.012 in (±0.30 mm)
<b>T</b>	1.464 in (37.19 mm)	<b>Tolerance</b>	±0.012 in (±0.30 mm)
<b>I</b>	0.987 in (25.07 mm)	<b>Requirement</b>	Minimum
<b>S</b>	0.046 in (1.17 mm)	<b>Tolerance</b>	±0.015 in (±0.38 mm)
<b>H</b>	0.403 in (10.24 mm)	<b>Requirement</b>	Minimum

**GENERAL TOLERANCE**

Inch Range	Tolerance	Metric Range	Tolerance
0-0.787 in	±0.006 in	0-20 mm	±0.152 mm
0.788-1.181 in	±0.008 in	21-30 mm	±0.203 mm
1.182-2.756 in	±0.012 in	31-70 mm	±0.305 mm
2.757-3.937 in	±0.016 in	71-100 mm	±0.406 mm
3.938-5.096 in	±0.020 in	101-150 mm	±0.508 mm
5.097-7.874 in	±0.024 in	151-200 mm	±0.610 mm
7.875-9.843 in	±0.032 in	201-250 mm	±0.813 mm
<b>Angular Tolerance</b> ±2°			

**DISCLAIMER**

This specification does not relieve the customer of their ultimate responsibility for the determination of the appropriate container. It is the customer's responsibility to select the appropriate packaging based upon all information at their disposal including the specific application, regulatory compliance, product compatibility and shipping requirements. WE HEREBY DISCLAIM AND EXCLUDE ANY EXPRESS OR IMPLIED WARRANTIES, INCLUDING WITHOUT LIMITATION THE IMPLIED WARRANTIES OF MERCHANTABILITY AND FITNESS FOR A PARTICULAR PURPOSE.

DISTRIBUTED BY:



REF NO.:

DWG-Q1592

DESCRIPTION:

38mm 38-400 PP Plastic Matte Top, Ribbed Sides, Cap, FSM-1 Heat Seal Liner for PE

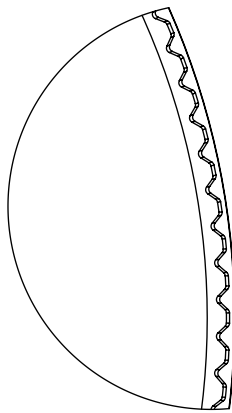
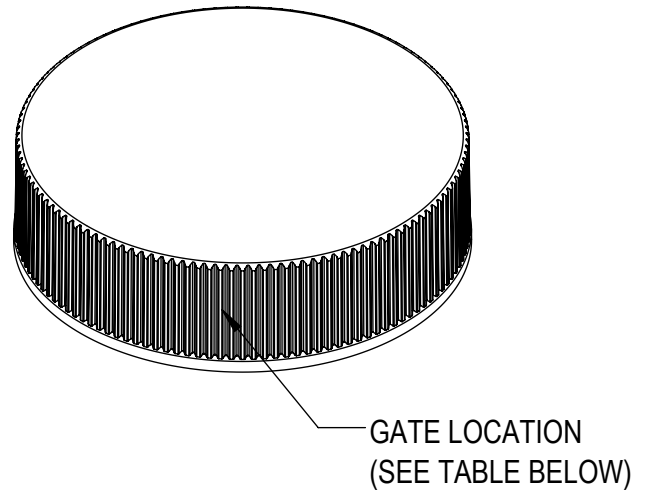
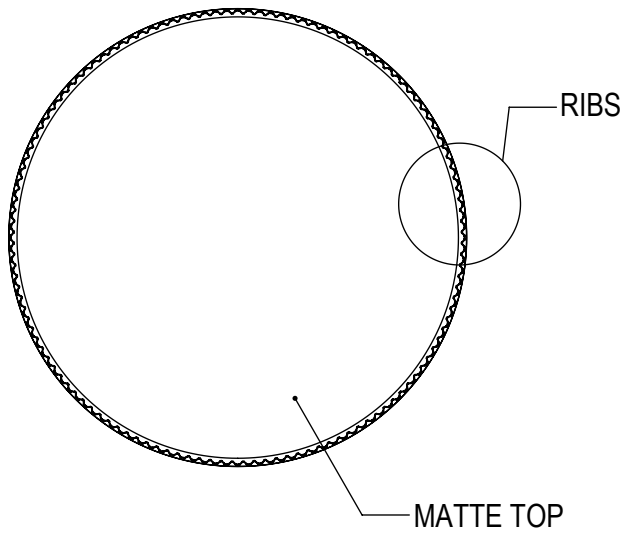

DETAIL RIBS  
SCALE 5 : 1  
(128) EQUISPACED RIBS

<b>Material</b>	Polypropylene	<b>Style</b>	RMX (Ribbed - Matte)
<b>Part Weight</b>	2.80 ± 0.30 g	<b>Static Torque</b>	17–26 in-lbs
<b>PART DIMENSIONS</b>			
<b>E</b>	1.394 in (35.41 mm)	<b>Tolerance</b>	±0.010 in (±0.25 mm)
<b>T</b>	1.487 in (37.77 mm)	<b>Tolerance</b>	±0.010 in (±0.25 mm)
<b>H</b>	0.391 in (9.93 mm)	<b>Tolerance</b>	±0.010 in (±0.25 mm)
<b>OAH</b>	0.440 in (11.18 mm)	<b>Tolerance</b>	±0.010 in (±0.25 mm)
<b>OD</b>	1.595 in (40.51 mm)	<b>Tolerance</b>	±0.010 in (±0.25 mm)
<b>THREAD DETAILS</b>			
<b>Threads Per Inch</b>	6	<b>Pitch</b>	0.167 in (4.24 mm)
<b>Thread Type</b>	Continuous Thread (CT)	<b>Bottle Landing</b>	0.050 in minimum
<b>Rib Detail</b>	128 equispaced ribs	<b>Surface Finish</b>	Ribbed side / matte top
<b>Gate Location</b>	Side		
<b>RECOMMENDED NECK FINISH</b>			
<b>E</b>	1.370 in (34.80 mm)	<b>Tolerance</b>	±0.012 in (±0.30 mm)
<b>T</b>	1.464 in (37.19 mm)	<b>Tolerance</b>	±0.012 in (±0.30 mm)
<b>I</b>	0.987 in (25.07 mm)	<b>Requirement</b>	Minimum
<b>S</b>	0.046 in (1.17 mm)	<b>Tolerance</b>	±0.015 in (±0.38 mm)
<b>H</b>	0.403 in (10.24 mm)	<b>Requirement</b>	Minimum
<b>GENERAL TOLERANCE</b>			
<b>Inch Range</b>	<b>Tolerance</b>	<b>Metric Range</b>	<b>Tolerance</b>
0–0.787 in	±0.006 in	0–20 mm	±0.152 mm
0.788–1.181 in	±0.008 in	21–30 mm	±0.203 mm
1.182–2.756 in	±0.012 in	31–70 mm	±0.305 mm
2.757–3.937 in	±0.016 in	71–100 mm	±0.406 mm
3.938–5.096 in	±0.020 in	101–150 mm	±0.508 mm
5.097–7.874 in	±0.024 in	151–200 mm	±0.610 mm
7.875–9.843 in	±0.032 in	201–250 mm	±0.813 mm
<b>Angular Tolerance</b>	±2°		

**DISCLAIMER**

This specification does not relieve the customer of their ultimate responsibility for the determination of the appropriate container. It is the customer's responsibility to select the appropriate packaging based upon all information at their disposal including the specific application, regulatory compliance, product compatibility and shipping requirements. WE HEREBY DISCLAIM AND EXCLUDE ANY EXPRESS OR IMPLIED WARRANTIES, INCLUDING WITHOUT LIMITATION THE IMPLIED WARRANTIES OF MERCHANTABILITY AND FITNESS FOR A PARTICULAR PURPOSE.

DISTRIBUTED BY:



REF NO.:

DWG-Q1592

DESCRIPTION:

38mm 38-400 PP Plastic Matte Top, Ribbed Sides, Cap, FSM-1 Heat Seal Liner for PE

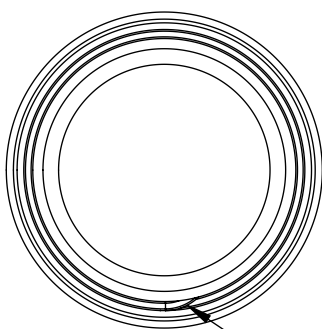
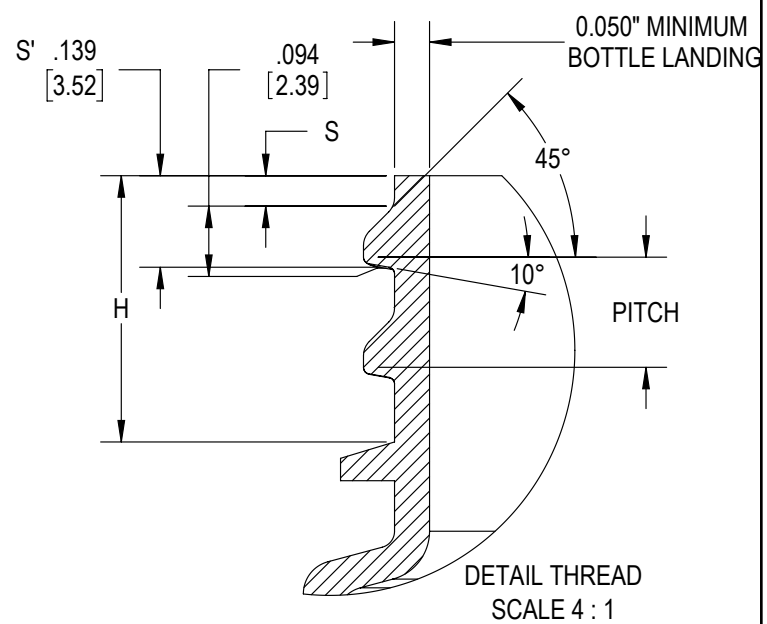
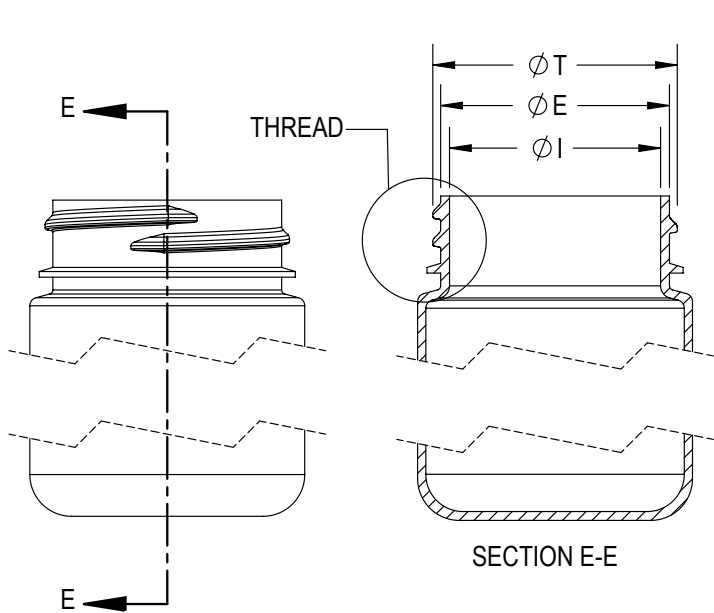

THREAD START

**Material** Polypropylene **Style** RMX (Ribbed - Matte)  
**Part Weight** 2.80 ± 0.30 g **Static Torque** 17–26 in-lbs

PART DIMENSIONS			
<b>E</b>	1.394 in (35.41 mm)	<b>Tolerance</b>	±0.010 in (±0.25 mm)
<b>T</b>	1.487 in (37.77 mm)	<b>Tolerance</b>	±0.010 in (±0.25 mm)
<b>H</b>	0.391 in (9.93 mm)	<b>Tolerance</b>	±0.010 in (±0.25 mm)
<b>OAH</b>	0.440 in (11.18 mm)	<b>Tolerance</b>	±0.010 in (±0.25 mm)
<b>OD</b>	1.595 in (40.51 mm)	<b>Tolerance</b>	±0.010 in (±0.25 mm)

THREAD DETAILS			
<b>Threads Per Inch</b>	6	<b>Pitch</b>	0.167 in (4.24 mm)
<b>Thread Type</b>	Continuous Thread (CT)	<b>Bottle Landing</b>	0.050 in minimum
<b>Rib Detail</b>	128 equispaced ribs	<b>Surface Finish</b>	Ribbed side / matte top
<b>Gate Location</b>	Side		

RECOMMENDED NECK FINISH			
<b>E</b>	1.370 in (34.80 mm)	<b>Tolerance</b>	±0.012 in (±0.30 mm)
<b>T</b>	1.464 in (37.19 mm)	<b>Tolerance</b>	±0.012 in (±0.30 mm)
<b>I</b>	0.987 in (25.07 mm)	<b>Requirement</b>	Minimum
<b>S</b>	0.046 in (1.17 mm)	<b>Tolerance</b>	±0.015 in (±0.38 mm)
<b>H</b>	0.403 in (10.24 mm)	<b>Requirement</b>	Minimum

GENERAL TOLERANCE			
<b>Inch Range</b>	<b>Tolerance</b>	<b>Metric Range</b>	<b>Tolerance</b>
0–0.787 in	±0.006 in	0–20 mm	±0.152 mm
0.788–1.181 in	±0.008 in	21–30 mm	±0.203 mm
1.182–2.756 in	±0.012 in	31–70 mm	±0.305 mm
2.757–3.937 in	±0.016 in	71–100 mm	±0.406 mm
3.938–5.096 in	±0.020 in	101–150 mm	±0.508 mm
5.097–7.874 in	±0.024 in	151–200 mm	±0.610 mm
7.875–9.843 in	±0.032 in	201–250 mm	±0.813 mm
<b>Angular Tolerance</b>	±2°		

**DISCLAIMER**

This specification does not relieve the customer of their ultimate responsibility for the determination of the appropriate container. It is the customer's responsibility to select the appropriate packaging based upon all information at their disposal including the specific application, regulatory compliance, product compatibility and shipping requirements. WE HEREBY DISCLAIM AND EXCLUDE ANY EXPRESS OR IMPLIED WARRANTIES, INCLUDING WITHOUT LIMITATION THE IMPLIED WARRANTIES OF MERCHANTABILITY AND FITNESS FOR A PARTICULAR PURPOSE.

DISTRIBUTED BY: 	REF NO.: DWG-Q1592
---------------------	-----------------------

DESCRIPTION:  
38mm 38-400 PP Plastic Matte Top, Ribbed Sides, Cap, FSM-1 Heat Seal Liner for PE