

ALOHA PLUS AFR PORCELAIN ENAMEL 60" X 32" X 16 5/8" BATHTUB



011-2674
011-2675

ALOHA PLUS AFR RIGHT-HAND
ALOHA PLUS AFR LEFT-HAND

DESCRIPTION:

The Aloha Plus AFR is a 60" x 32" x 16 5/8" bathtub – the industries #1 selling porcelain enamel bathtub is a full length bath offering exceptional performance and roominess for recess applications. Two additional inches of width means more room to bathe, and spacious 4" back ledge offers ample storage space. Construction is a one piece heavy gauge seamless steel with an acid resistant porcelain enamel finish. The Aloha Plus AFR weighs 75 lbs., easy to install into a bathtub alcove - "just set it and level it". Free standing on a full length support pad that offers added strength and sound deadening. This product is compatible or complies with ASME A112.19.1/CSA B45.2 (Standard for Enameled Steel Plumbing Fixtures), ADA (American Disabilities Act), ASTM F 462 (Safety Specification for Slip Resistant Bathing Facilities), WW-P 541 (U.S. Military Federal Specification), HUD-FHA-VA, LEED, and the Buy American Act, as applicable when installed accordingly. Available in white, bone and biscuit colors with a right and left drain. Made in the USA.

Weight: 75 lbs



ALOHA PLUS AFR PORCELAIN ENAMEL 60" X 32" X 16 5/8" BATHTUB

ALOHA PLUS AFR 5' Bathtub

60" x 32" x 16 5/8"

Raised Outlet

011-2674-00 ALOHA PLUS AFR right-hand white

011-2675-00 ALOHA PLUS AFR left-hand white

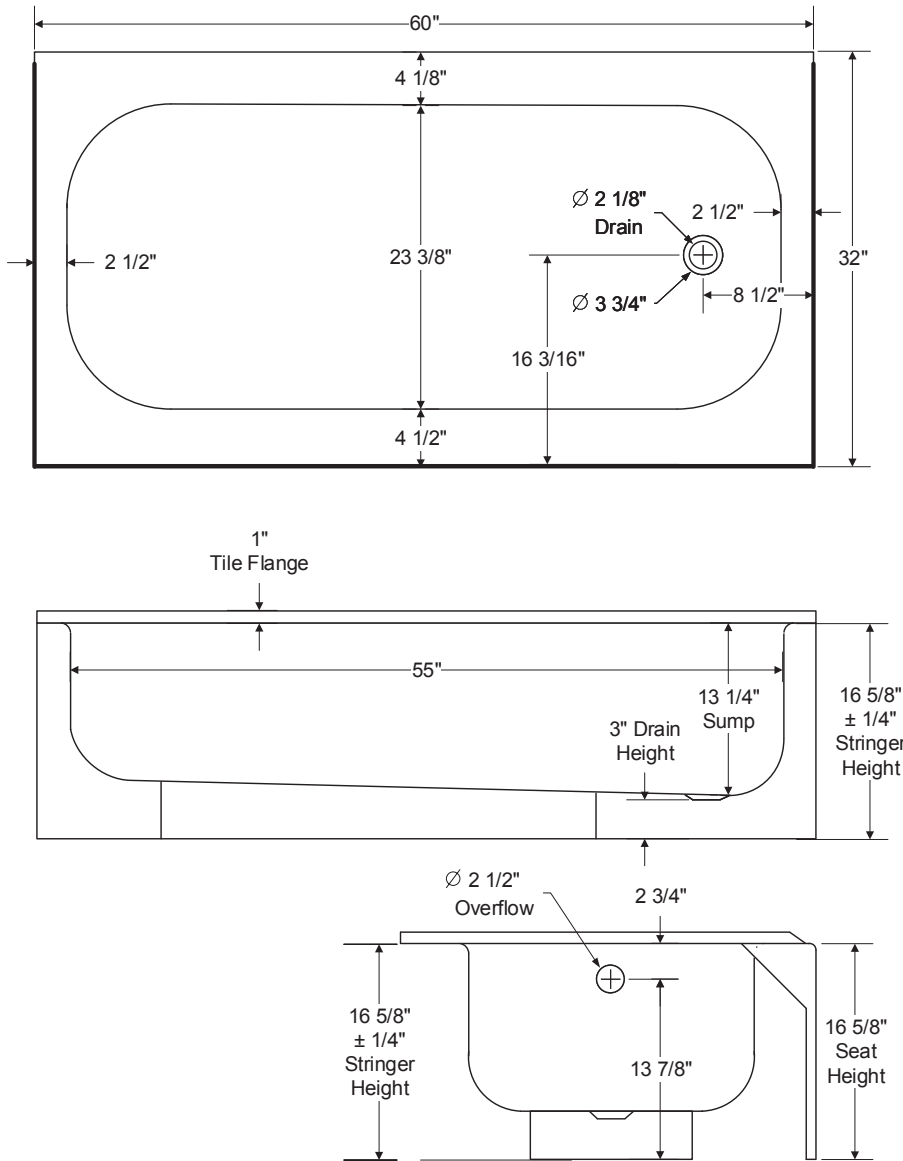

Complies with:

All fixtures are compatible or comply with ANSI, ASME, CSA, WW-P 541, HUD-FHA-VA, LEED and the "Buy America Act" where applicable when installed accordingly.

Standard Features:

"The affordable alternative to cast iron"
Full length sound deadening pad
Slip resistant bottom
Set it and level it

Made in the USA

All Dimensions +/- 1/8" unless otherwise noted.

Dimensions shown are for reference.

Actual dimensions may vary slightly and should be checked prior to installation

SS07/18

