

# ASSEMBLY INSTRUCTION

## E528 TUFTED DINING CHAIR

**A** Chair Back    **B** Seat    **C** Front Leg    **D** Lock Washer 5/16"    **E** Flat Washer 5/16"

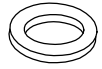
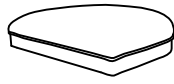
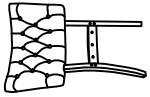

1pc

1pc

2pcs

9pcs

9pcs

**F** Allen Wrench 5/16"

**G** Bolt 5/16"\*2-1/2"

**H** Bolt 5/16"\*1-3/4"

**I** Wood Dowel Ø10x30mm

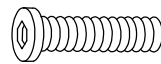
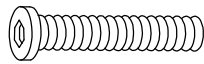

1pc

8pcs

1pc

2pcs

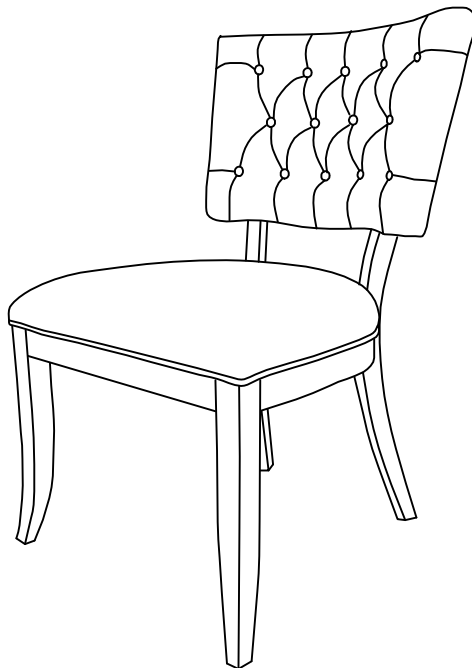

This page lists all the contents included in the box. Please take the time to identify the hardware as well as the individual components to this product. As you unpack and prepare for assembly, place the contents on a carpeted or padded area to protect them from damage.

- 1** Put the Seat (B) on a smooth flat surface, attach Front Leg (C) to the Seat (B) using Bolt (G), Lock Washer (D) and Flat Washer (E) on both of holes of Seat (B). Turn the Allen Wrench (F) in Bolt (G). But not too tight. Attach Wood Dowel (I) to Seat (B).

Take the Allen Wrench, and turn the bolts until the legs are secure. **DO NOT TIGHTEN COMPLETELY.** Stop when you feel you are adding force to tighten the bolt.

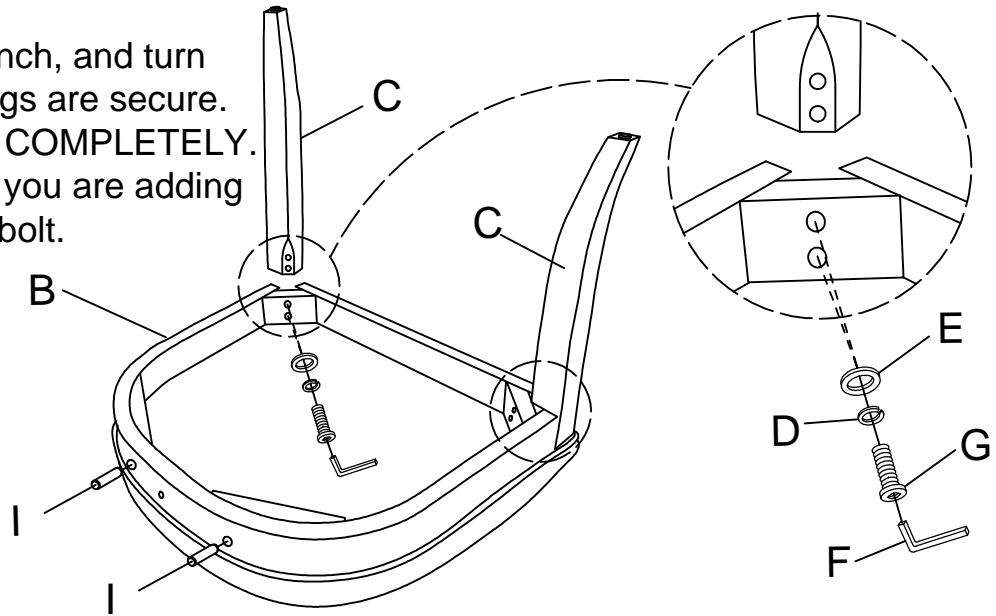

- 2** Put the Chair Back (A) on a smooth flat surface, attach the Seat (B) to the Chair Back (A) using Bolt (H), Lock Washer (D) and Flat Washer (E) on both holes of Seat (B) and Chair Back (A). Turn the Allen Wrench (F) in Bolt (H). But not too tight.

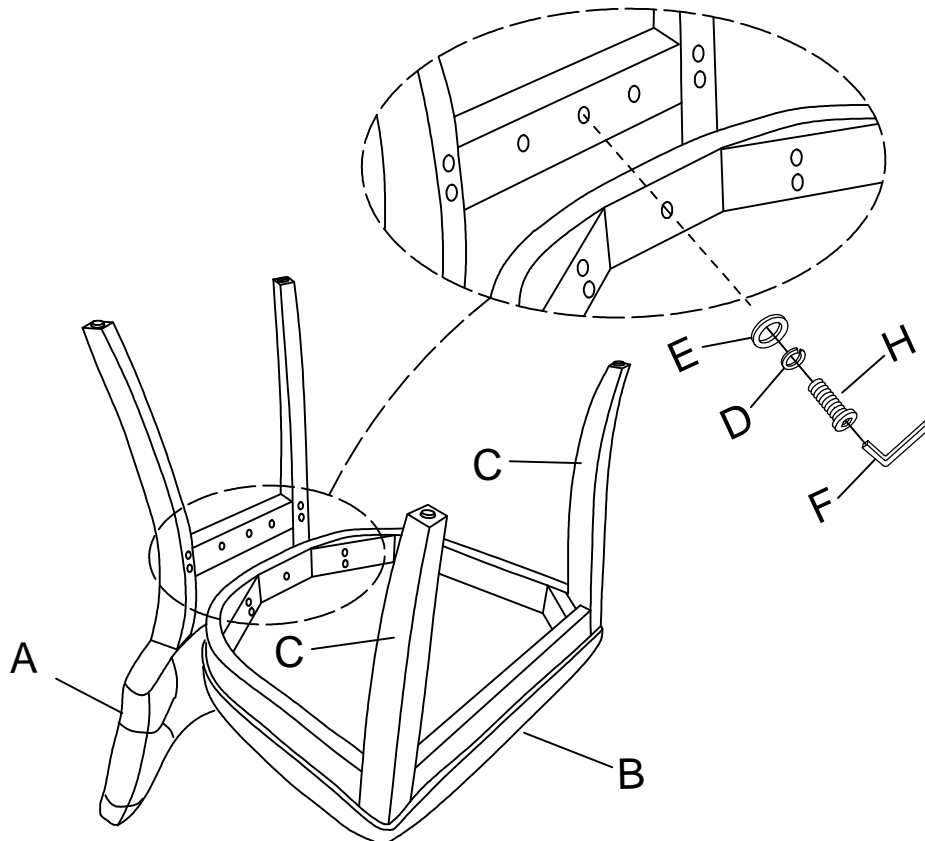

3

Use Bolt (G), Lock Washer (D) and Flat Washer (E) on both holes of Seat (B) and Chair Back (A). Turn the Allen Wrench (F) in Bolt (G).

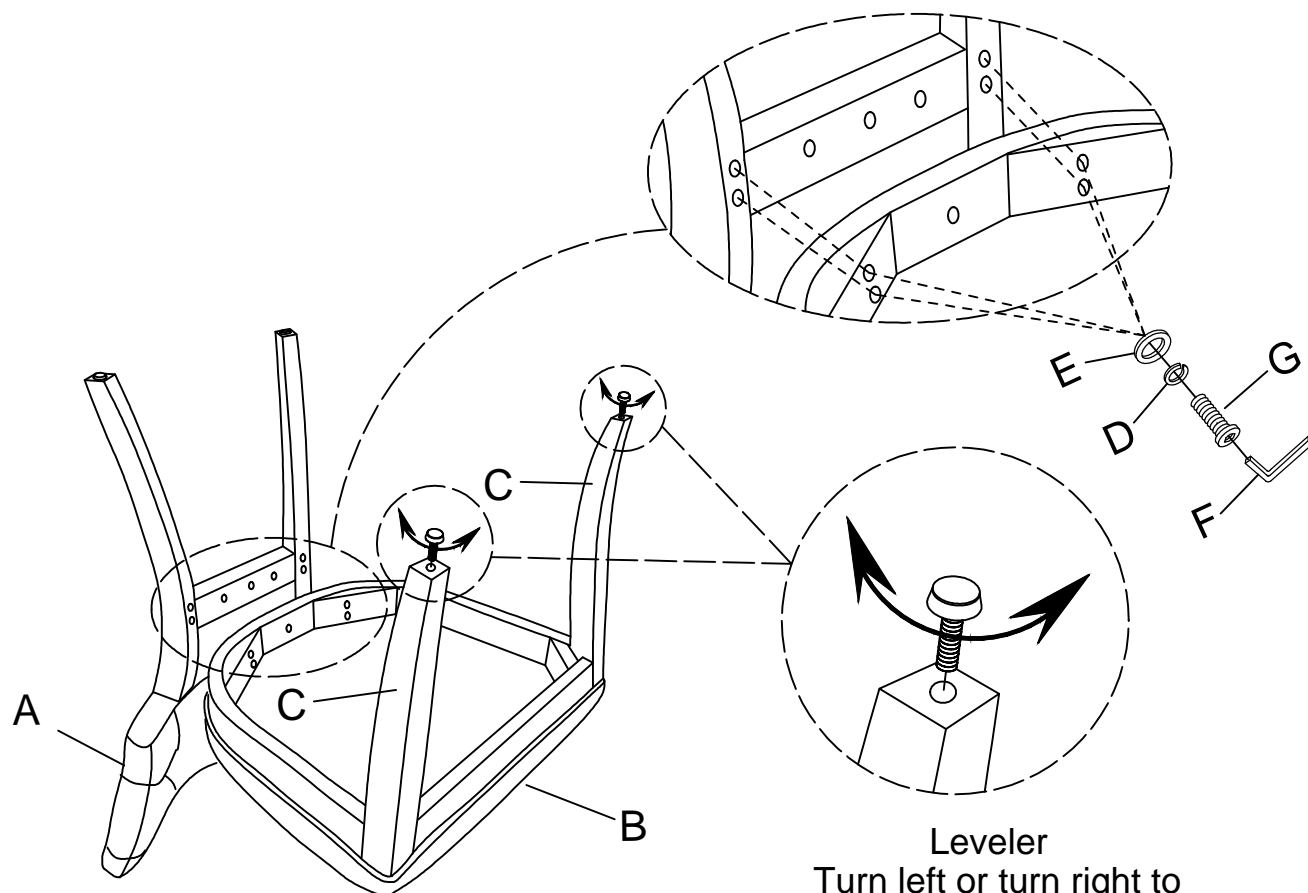

Leveler  
Turn left or turn right to  
adjust the leveler until  
the chair is stabilized.

Stand chair up on an even surface and check that it is balanced. If there is a slight wobble, apply downward pressure in the corner where a leg is uneven. Keeping pressure in that corner, tighten all bolts. If balanced, apply downward pressure evenly in the center and tighten all bolts. Do not over-tighten beyond hole depth.

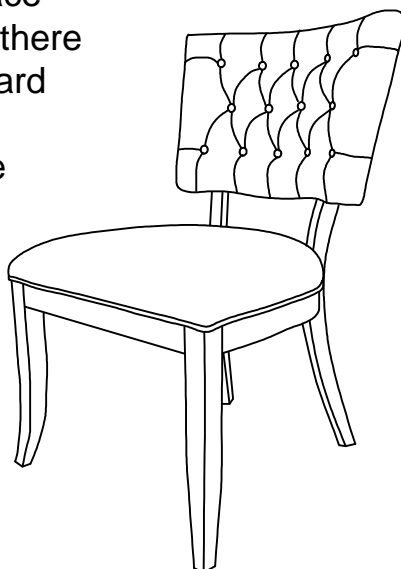

Helpful Tip:  
-Instead of applying  
downward pressure while  
reaching under to tighten  
bolts, have someone sit in  
the chair while you tighten  
the bolts.

### Cleaning & Care

Treat surface with care. Surface is resistant to scratches but is not scratch resistant. Clean surfaces with a dry or damp soft cloth. Do not use abrasive cleaners. Hardware may loosen over time. Periodically check that all connections are tight.